

Mini cozinha

Garfield



Irmãos Hinke

 **irmaoshinke**

 **47 99987-8540**

Partes do produto

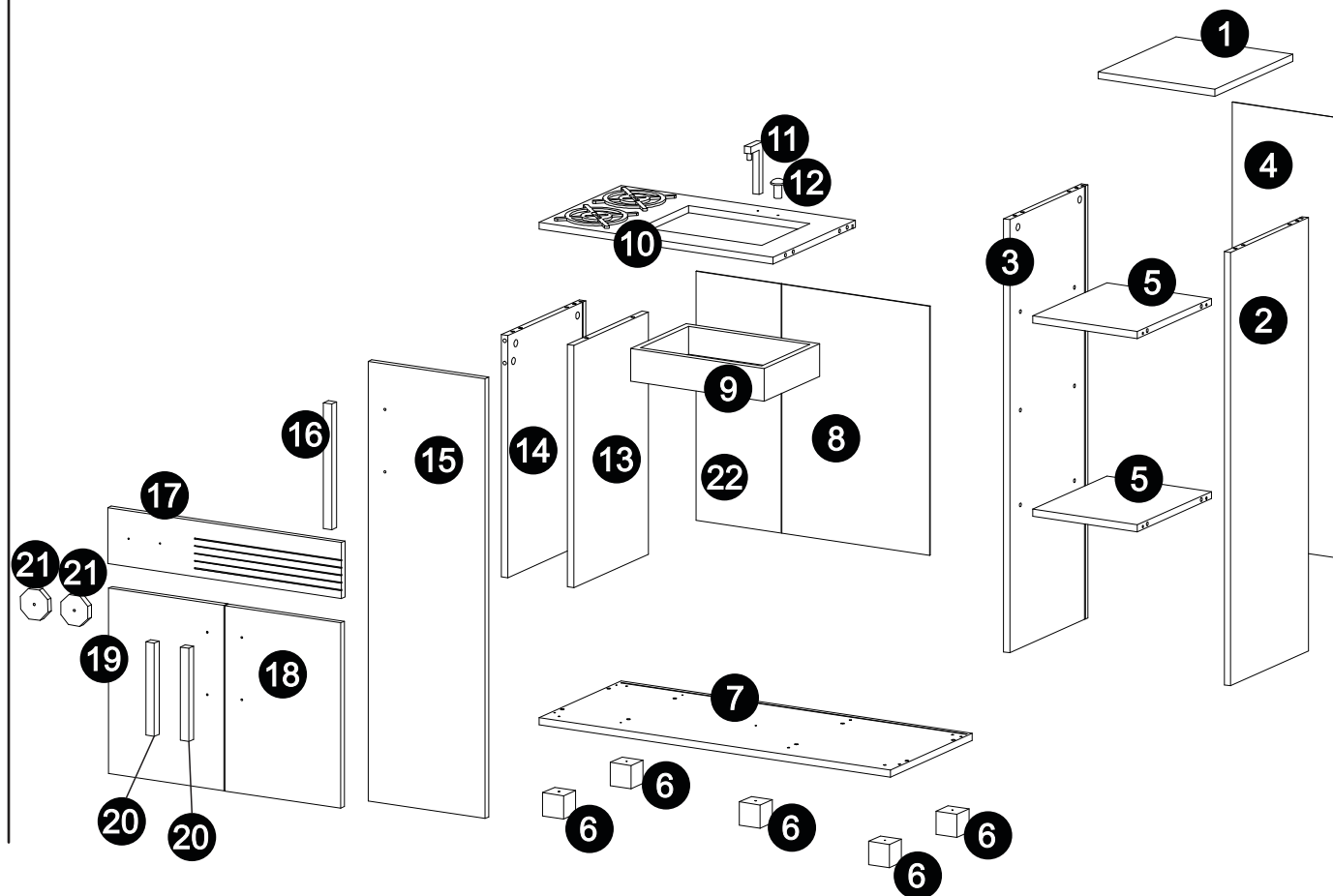

2
pessoas necessárias
para montar
o produto



40 min
tempo de montagem
aproximadamente



médio
grau de
dificuldade



não utilizar químicos
ou abrasivos
na limpeza



evitar batidas
e contato com
objetos cortantes



pano umedecido
com água seguido
de pano seco



50 Kg
capacidade máxima
suportável, distribuída
uniformemente

Ferragens

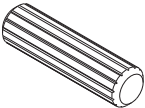

A - Cavilha 8x30 (27x)

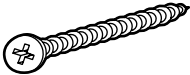

B - Parafuso 3,5x30 (31x)



C - Cantoneira (8x)

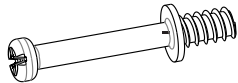

D - Parafuso Minifix (7x)



E - Tambor Minifix (7x)



F - Parafuso 3,5x14 (42x)

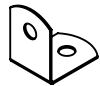

I - Cantoneira (5x)



M Dobradiça (2x)
Curva



H Dobradiça (6x)
Reta



L- Fixador fundo (3x)

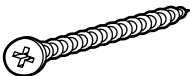

J - Parafuso 3,5x40 (2x)

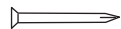

K- Pregos (3x)

Utilizar a régua abaixo para medir os componentes.

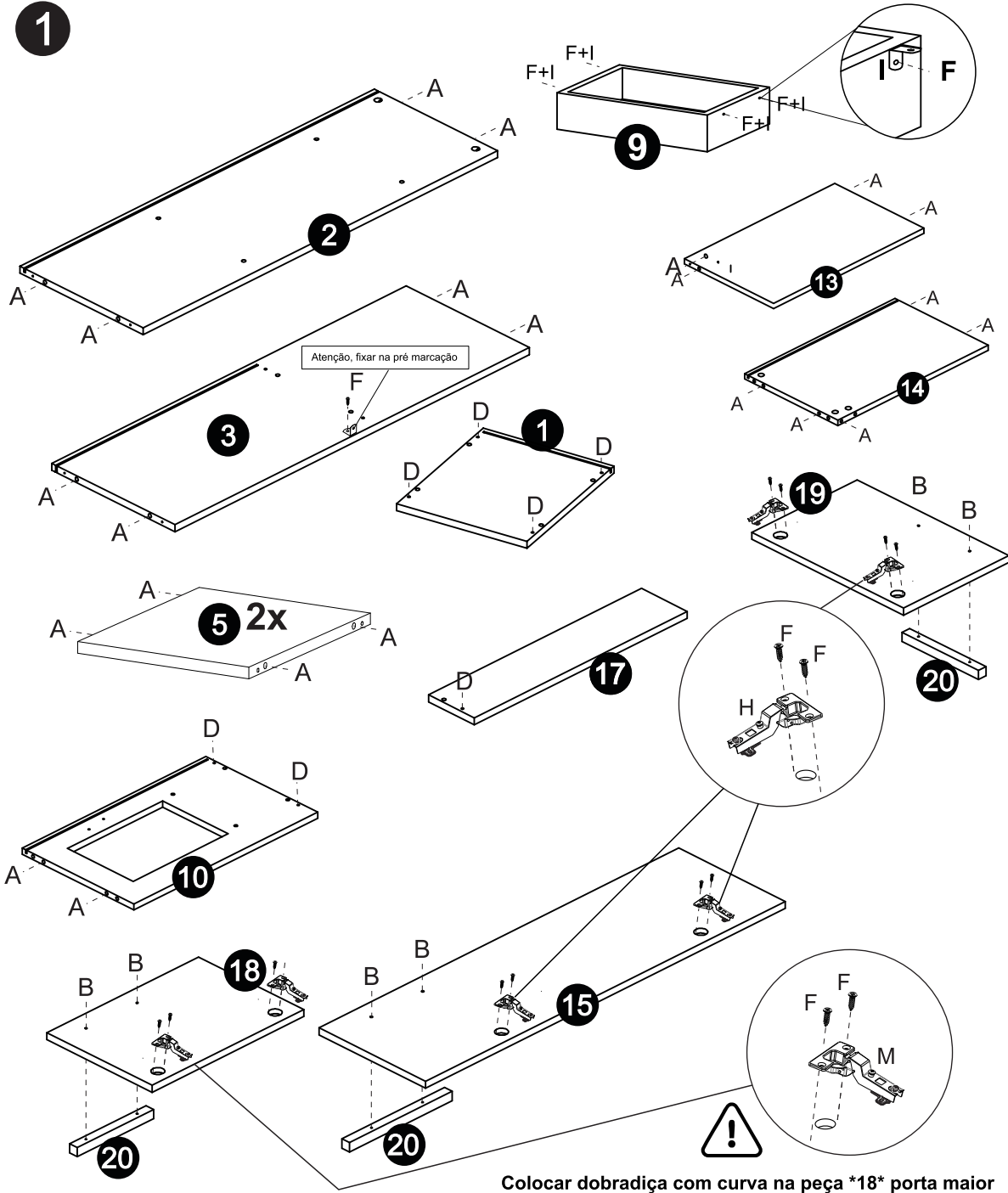
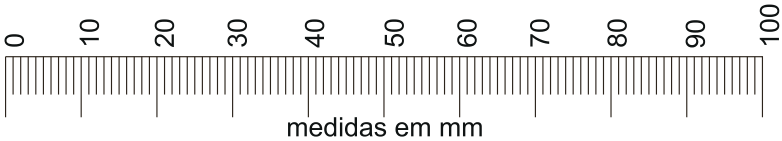

Colocar dobradiça com curva na peça *18* porta maior

Lateral peça 13 vai parafuso para fixação

2

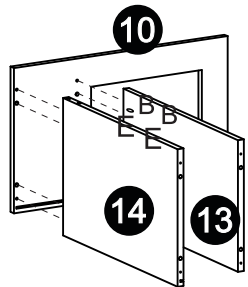

Lateral peça 14 vai minifix/tampo pra fixação



Não usar
parafusadeira
no item 'E'

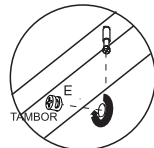

3

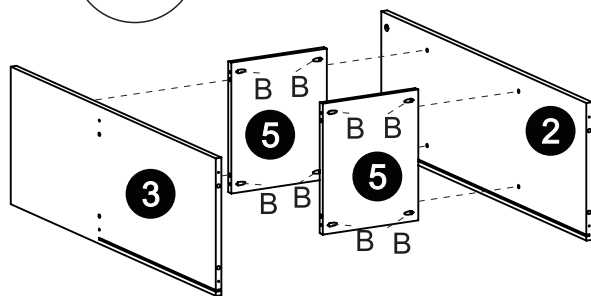
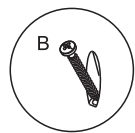

4

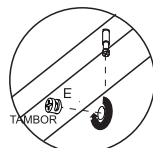
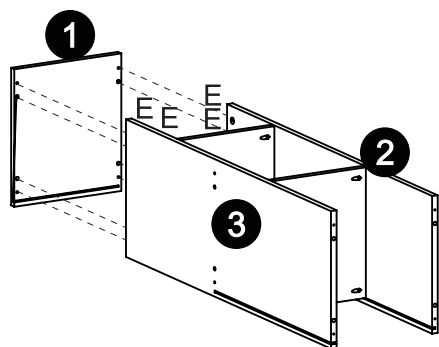

Não usar
parafusadeira
no item 'E'

5

Fixação de dentro da geladeira para
o tampo, com parafuso *B*

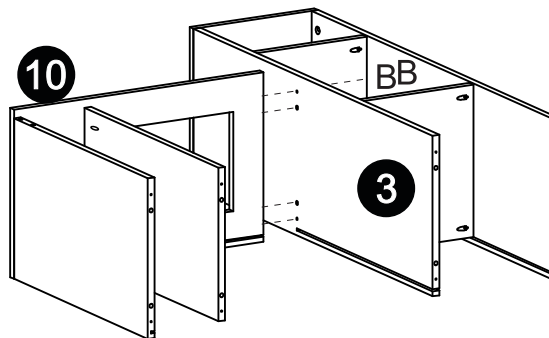

6

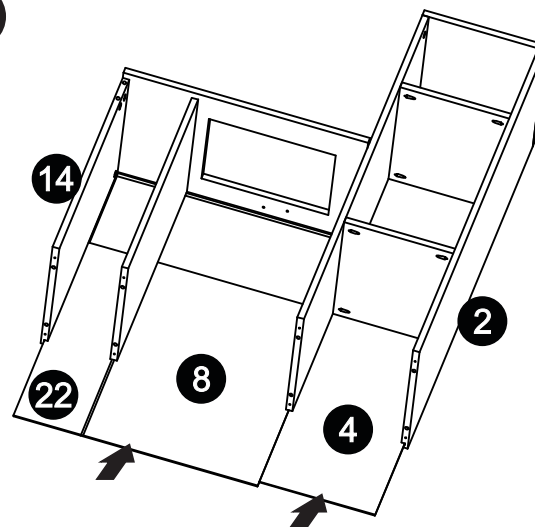

7

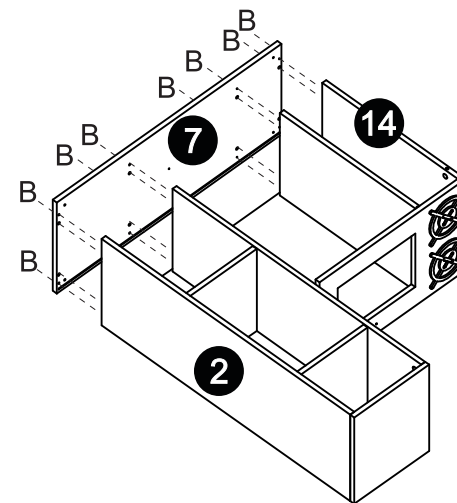

8

Fixar primeiramente a peça 17, depois os botões 21

SOMENTE BOTÕES



Atenção:

Não apertar totalmente
para que os botões girem.

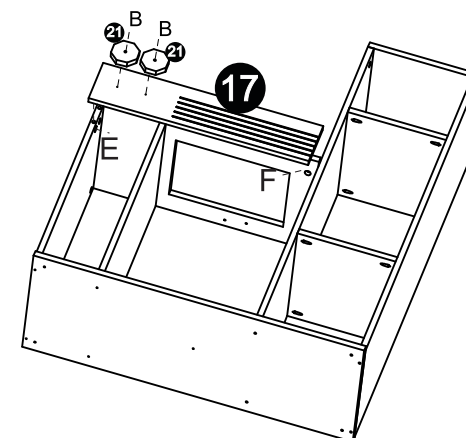

9

Fixação de torneira e abridor

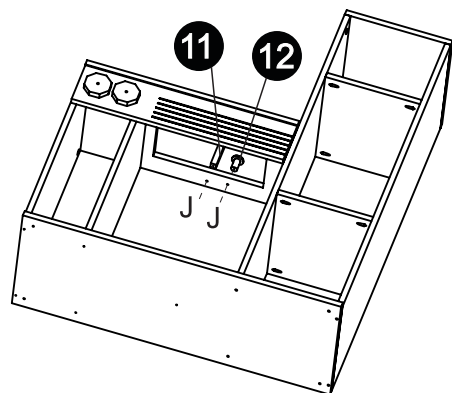

10

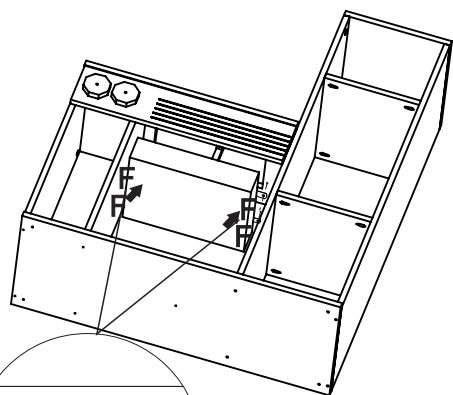

11

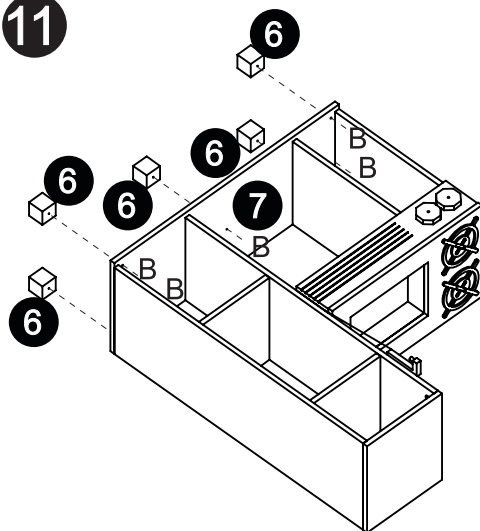

12

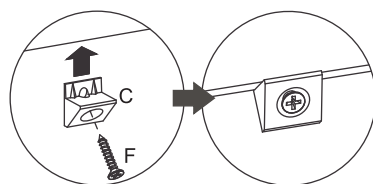
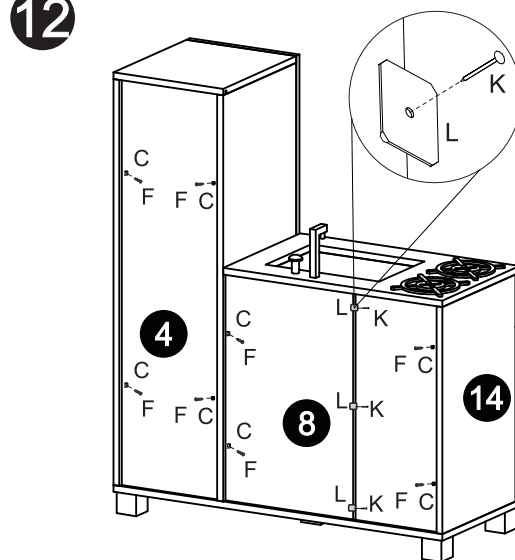

13

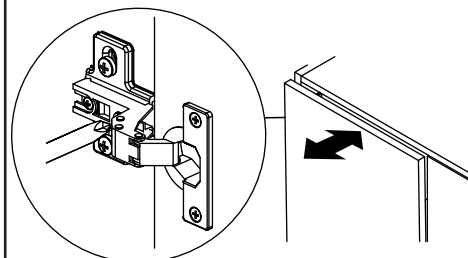
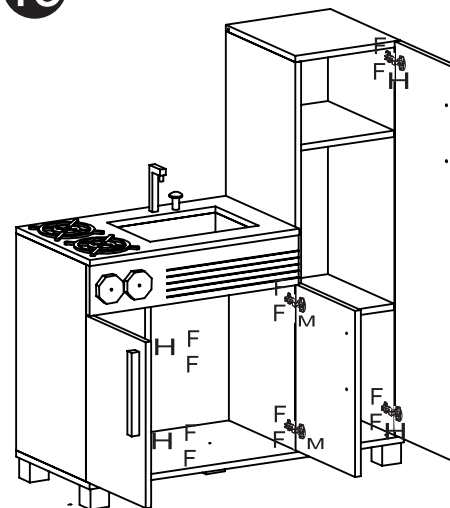

detalhe 1

Regulagem das Portas

Para regular a folga entre as portas e o armário, utilize o parafuso indicado no **detalhe 1**.
Para regular a altura da porta, deixando-as alinhadas, utilize o parafuso indicado no **detalhe 2**.
A regulagem do recobrimento da porta é feita através do parafuso indicado no **detalhe 3**.

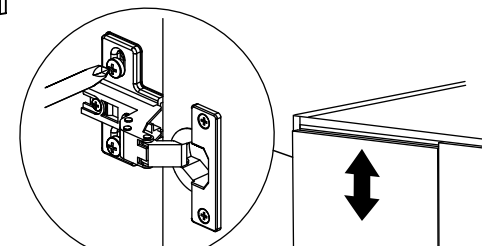

detalhe 2

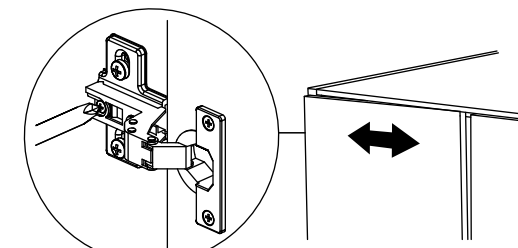

detalhe 3

capacidade de carga
(distribuídos uniformemente)



tampo

Limpeza

Use um pano levemente umedecido com água e seque com um pano seco.

'Nunca use produtos químicos ou abrasivos'

Recomendações

Evitar batidas e o contato com objetos cortantes.

CNPJ: 37.494.928/0001-80 - Irmãos Hinke LTDA