

1364

0723

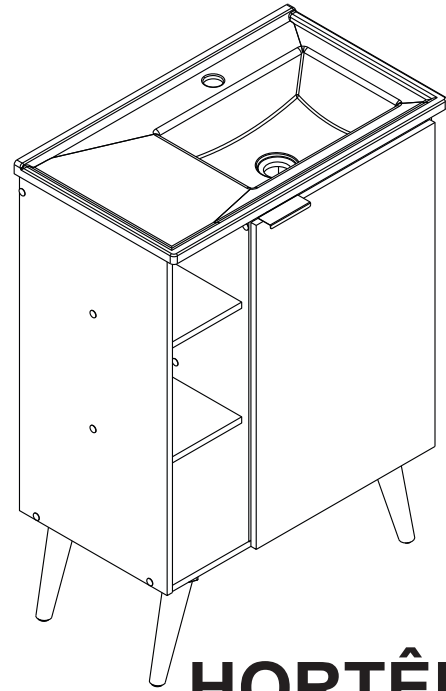
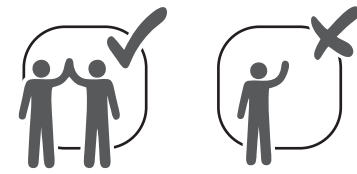

Toucador
Mueble para Baño
Bathroom cabinet

HORTÊNSIA COM PÉS
HORTÊNSIA CON PATAS
HORTÊNSIA 60 WITH FEET

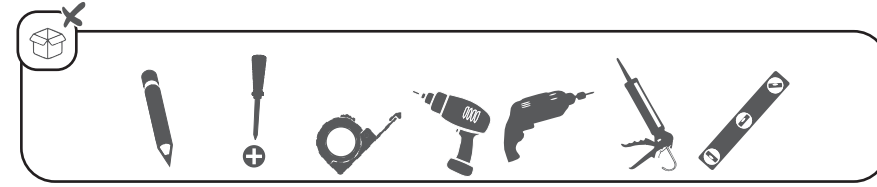

| | | | | | | | |
|---|---------------------------------------|---|---|---|-----------------------------------|---|---------------------------------------|
| A | x14 12mm | E | x17 5/32" x 1"9/16 in 4.0 x 40 mm | I | x4 | M | x2 5/16 in 8 mm |
| B | x24 15/64 x 1"3/16 6x30mm | F | x2 5/32" x 3/8" in 4.2 x 9.5 mm | J | x1 | N | x4 3/16 x 1"3/4 in 3/16 x 45 mm |
| C | x2 | G | x2 | K | x4 | O | x2 |
| D | x12 5/32 x 1 1/2 in 4.0 x 12 mm | H | x16 9/64 x 5/8 in 3.5 x 16 mm | L | x2 3/16 x 2" in 5.0 x 50 mm | | |

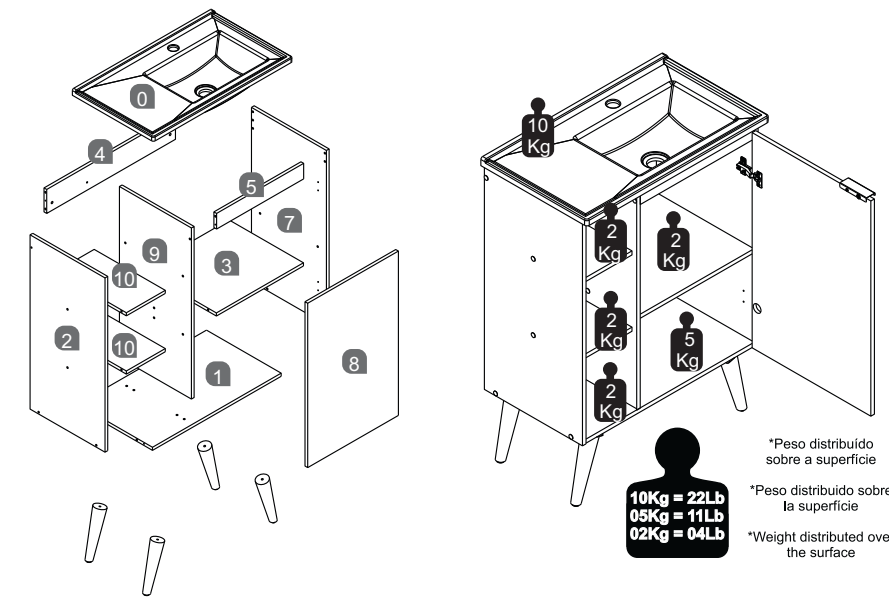

| | | |
|----|---|----|
| 0 | LAVATÓRIO / SINK / LAVAMANOS | x1 |
| 1 | BASE / BASE / BASE | x1 |
| 2 | LATERAL ESQUERDA / LEFT SIDE / LATERAL IZQUIERDO | x1 |
| 3 | PRATELEIRA / SHELF / ESTANTE | x1 |
| 4 | BARRA FUNDO 60 / BACKSIDE BAR 60 / BARRA TRASERA 60 | x1 |
| 5 | BARRA FRENTE 60 / FRONT BAR 60 / BARRA FRONTAL 60 | x1 |
| 7 | LATERAL DIREITA / RIGHT SIDE / LATERAL DERECHO | x1 |
| 8 | PORTA / DOOR / PUERTA | x1 |
| 9 | DIVISÓRIA / PARTITION / PARTICIÓN | x1 |
| 10 | PRATELEIRA MENOR / SMALLER SHELF / ESTANTE PEQUEÑO | x2 |

*Peso distribuído sobre a superfície
10Kg = 22Lb
05Kg = 11Lb
02Kg = 04Lb

*Peso distribuído sobre la superficie
*Weight distributed over the surface

01
B x24

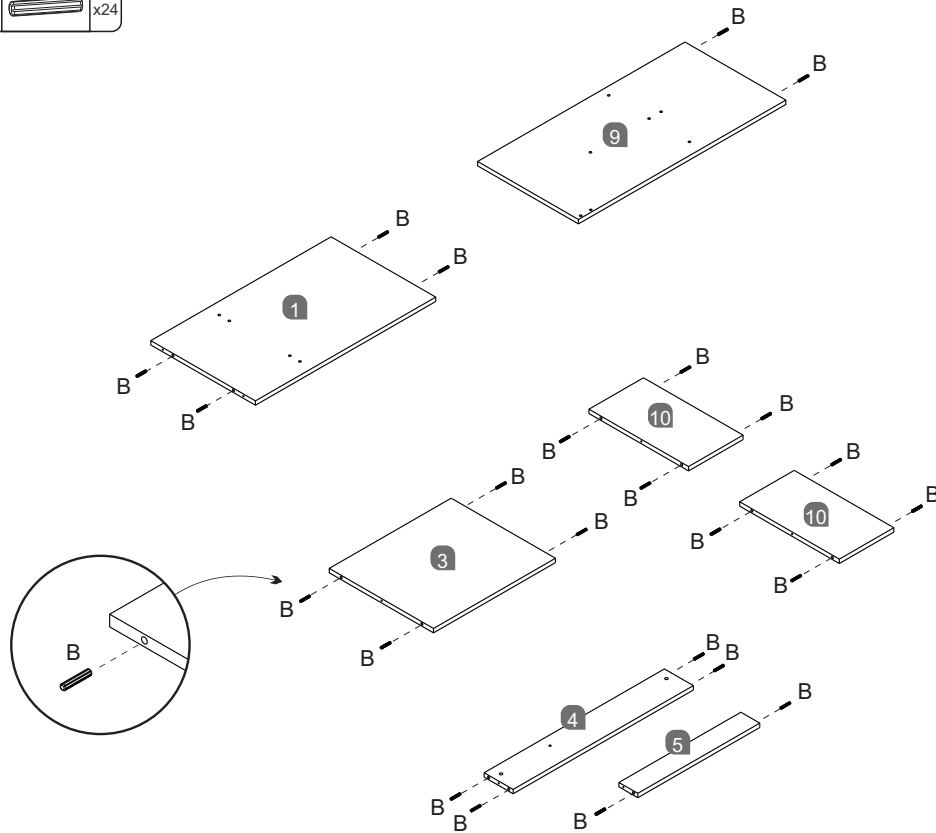

02
B x4
H x16
I x4
N x4

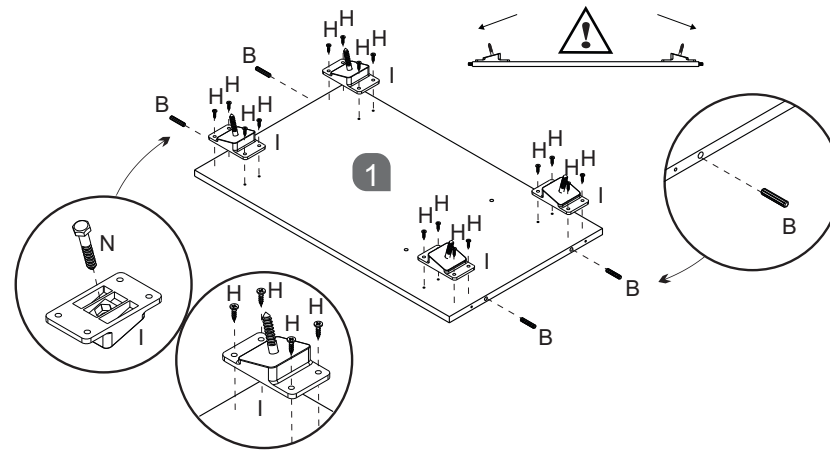

03
C x2
D x4

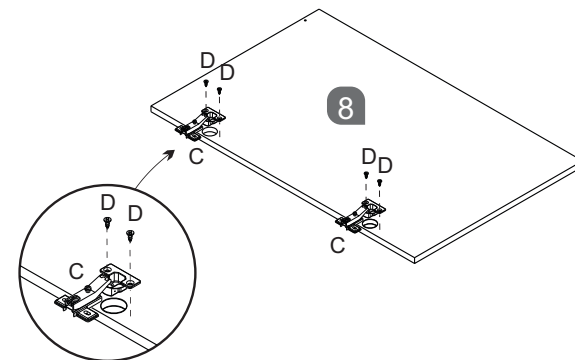

04
A x2
E x2

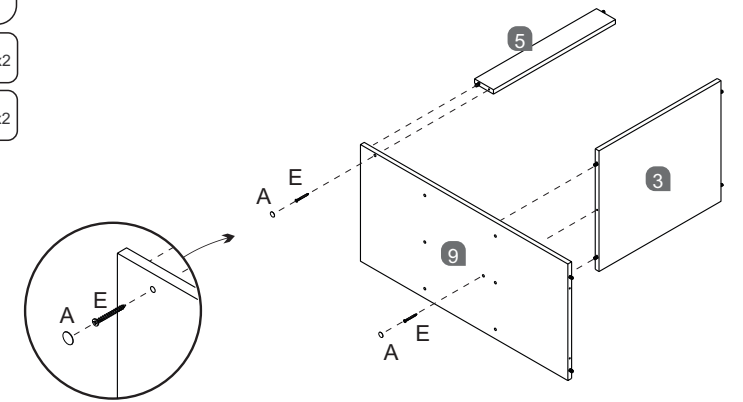

05
E x3

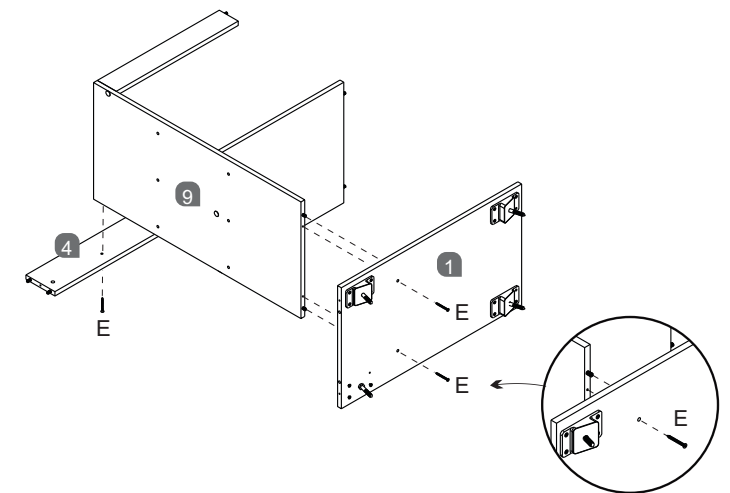

06

- A x5
- E x5

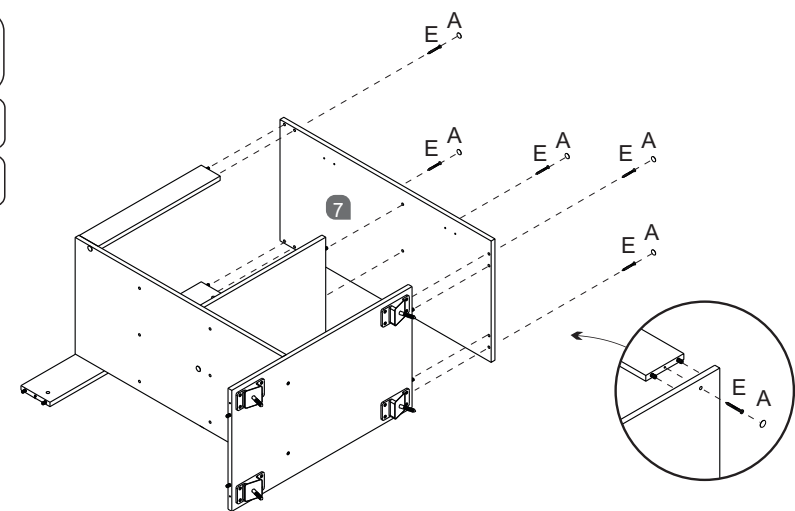

07

- A x7
- G x7

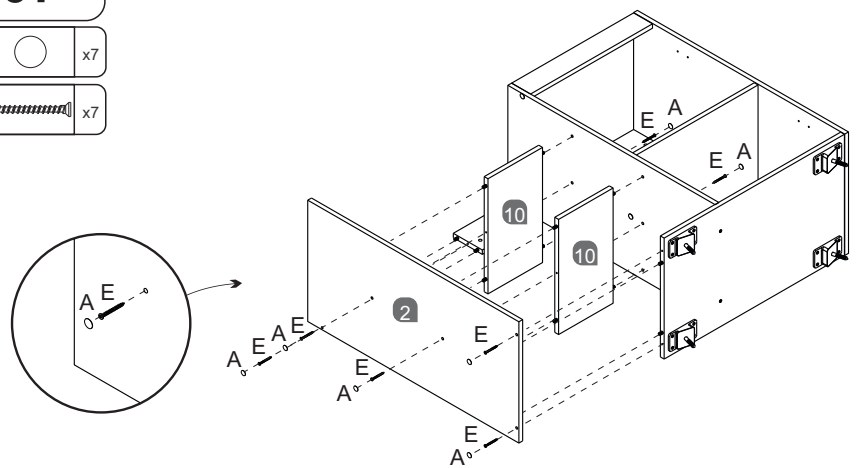

12

- D x4
- F x2
- J x1
- O x1

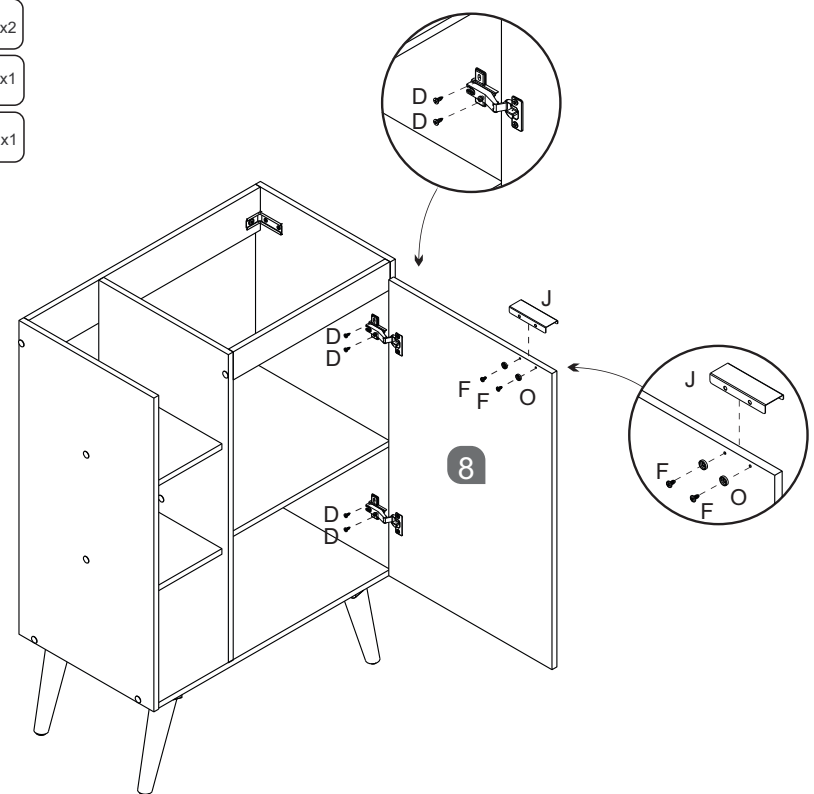

08

- K x4

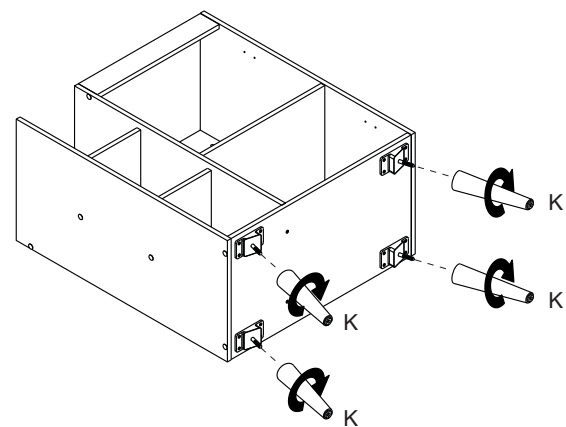

09

- D x4
- G x2

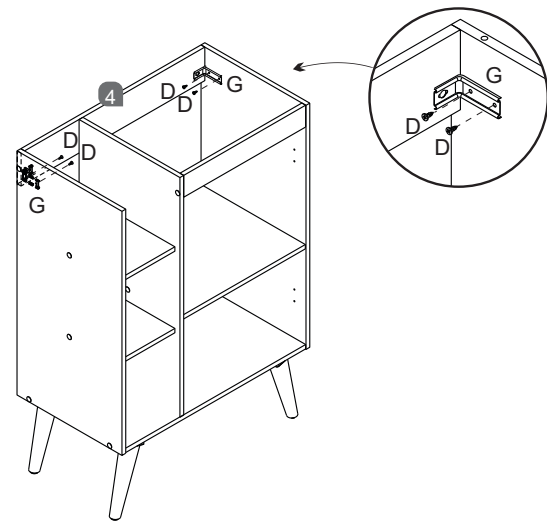

13

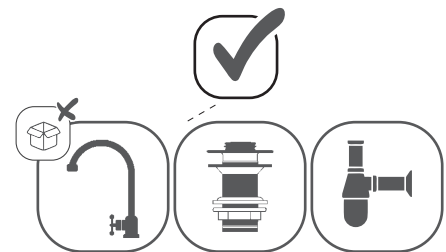
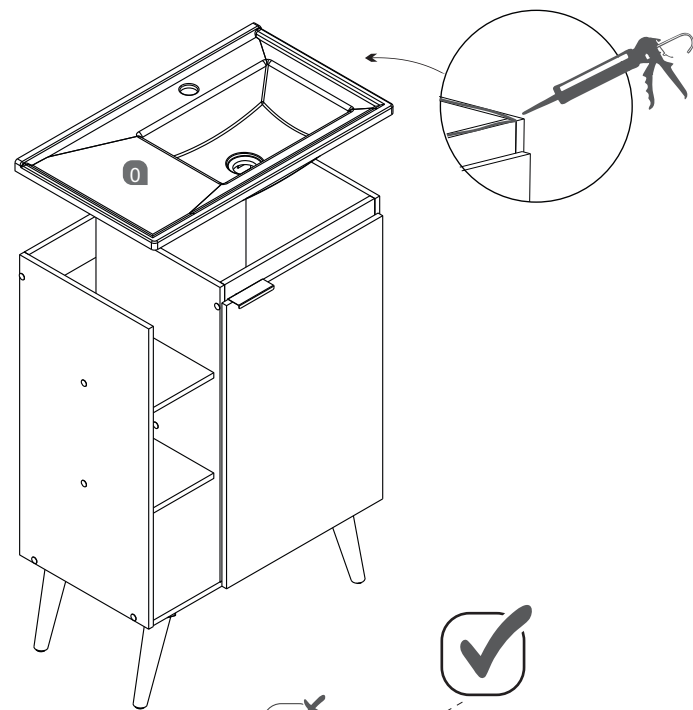

10

- M x2
- N x2

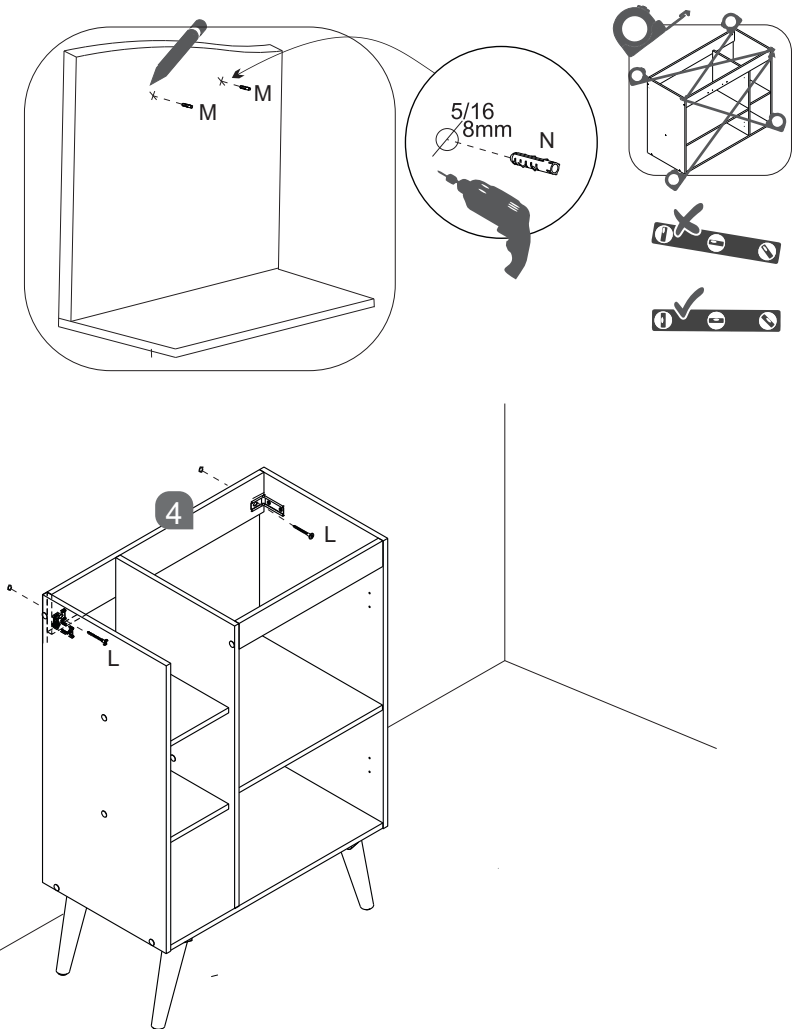

ATENÇÃO

- Limpar apenas com pano de algodão umedecido em água com sabão neutro, álcool ou produtos de limpeza multiuso;
- Não utilize produtos abrasivos, solventes ou removedores;
- O não cumprimento das recomendações de instalação e limpeza pode acarretar na perda da garantia de fabricação.

ATENCIÓN

- Limpiar únicamente con un paño de algodón humedecido en agua con jabón neutro, alcohol o productos de limpieza multiusos;
- No utilice productos abrasivos, solvente o removedores;
- El incumplimiento de los requisitos de instalación y limpieza puede resultar en la pérdida de la garantía de fabricación.

ATTENTION

- Clean only with a lightly damp cotton cloth with neutral soap, rubbing alcohol or all-purpose cleaning products;
- Do not use abrasive or solvent products;
- Failure to comply with the installation and cleaning requirements may result in the loss of the manufacturing warranty.

