

Aparência final
Final Appearance
Aspecto final

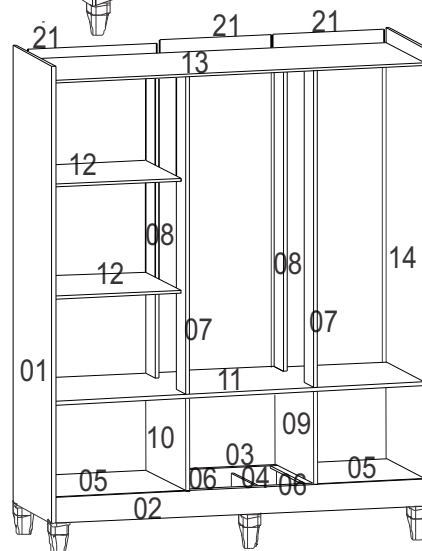

n.ºpc	DESCRIÇÃO DAS PEÇAS	DESCRIPTION OF PARTS	DESCRIPCIÓN DE PIEZAS	QT	A	B
1	LATERAL ESQ.	LEFT SIDE	LADO IZQUIERDO	1	1740	385
2	RODAPE FRONTAL	FRONT FOOTING	PIE DELANTERA	1	1479	130
3	RODAPE COSTA	COAST FOOT	PIÉ DE LA COSTA	1	1479	130
4	RODAPE INTERNO	INTERNAL FOOTING	PIE INTERIOR	1	357	100
5	BASE	BASE	BASE	2	485	383
6	APOIO DA BASE	BASE SUPPORT	SOPORTE BÁSICO	2	357	60
7	BATENTE FRENTE	FRONT STOP	PARADA DELANTERA	2	1157	80
8	BATENTE COSTA	COAST STOP	PARADA EN LA COSTA	2	1157	80
9	DIVISAO DIREITA	RIGHT DIVISION	DIVISIÓN DERECHA	1	359	385
10	DIVISAO ESQUERDA	LEFT DIVISION	DIVISIÓN IZQUIERDA	1	359	385
11	TAMPO DE GAVETA	DRAWER TOP	SUPERIOR DEL CAJÓN	1	1479	385
12	PRATELEIRAS	SHELVES	ESTANTES	2	485	335
13	CHAPEU	HAT	SOMBREIRO	1	1479	385
14	LATERAL DIR.	RIGHT SIDE	LADO DERECHO	1	1740	385
15	PORTA GRANDE	BIG DOOR	PUERTA GRANDE	4	1540	245
16	PORTA PEQUENA DIREITA	SMALL RIGHT DOOR	PUERTA PEQUEÑA DERECHA	2	1170	245
17	FRENTE DE GAVETA	DRAWER FRONT	FRENTE DEL CAJÓN	2	493	180
18	LATERAL DE GAVETA	DRAWER SIDE	LADO DEL CAJÓN	4	350	100
19	CONTRA FUNDO DE GAVETA	AGAINST DRAWER BOTTOM	CONTRA EL FONDO DEL CAJÓN	2	435	80
20	FUNDO DE GAVETA	DRAWER BOTTOM	FONDO DEL CAJÓN	2	457	358
21	FUNDO GR	GR FUND	FONDO GR	3	1560	501
22	VISTA SUPERIOR	UPPER VIEW	VISTA SUPERIOR	1	1479	70

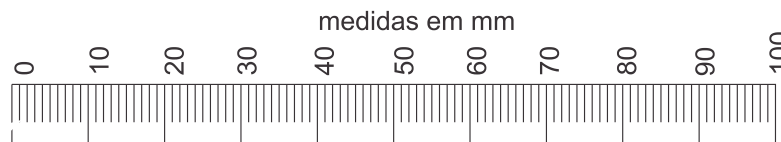
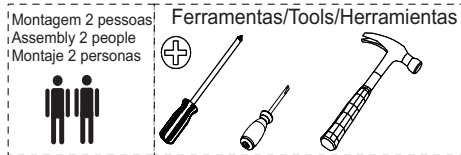

PARA A LIMPEZA E CONSERVAÇÃO DO SEU MÓVEL

For cleaning and maintaining your furniture / Para la limpieza y mantenimiento de tus muebles

- Não use produtos abrasivos como Álcool, Solventes, Acetona e etc...
Do not use abrasive products like Alcohol, solvents, etc
No utilice productos abrasivos como alcohol, solventes, acetona, etc...
- Use somente um pano macio e seco.
Use only a soft, dry cloth and.
Utilice únicamente un paño suave y seco.

Roupeiro 6 Portas LITE

Descrição / Description / Descripción	QTD
A Parafuso 3,5 X 12 Screw 3,5 x 12 Tornillo 3,5 x 12	124
B Parafuso 3,5 X 25 Screw 3,5 x 25 Tornillo 3,5 x 25	08
C Parafuso 3,5 X 40 Screw 3,5 x 40 Tornillo 3,5 x 40	20
D Cavilha 6 x 30 Peg 6 x 30 clavija 6 x 30	20
E Prego 08 x 08 Nail 08 x 08 clavo 08 x 08	114
F Prego 13 x 15 Nail 13 x 15 clavo 13 x 15	08
G Prendedor de Fundo Bottom fastener Cierre inferior	24
H Puxador Puller Arrancador	08
I Corrediça slide Corredera	02
J Sachet de cola Glue sachet bolsita de pegamento	01
K Cavilha 6 x 50 Peg 6 x 50 clavija 6 x 50	04
L Suporte U Fechado Closed U Support Suporte En U Cerrado	02
M Suporte J Aberto Open J Support Suporte Abierto J	02
N Cantoneira Corner Esquina	10
O Porca cilíndrica 9 x 12 Cylindrical Nut 9 x 12 Tuerca cilíndrica 9 x 12	28
P Dobradiça Hingé Bisagra	16
Q Calço Dobradiça Hinge Shim Cuña de Bisagra	16
R Giz de Correção Correction Chalk tiza correctora	02
S Etiqueta Label Etiqueta	01
T Cabideiro Hanger Percha	02
U Pé Cônico Conical foot Pie Cónico	06
V Parafuso 3,5 X 25 Screw 3,5 x 25 Tornillo 3,5 x 25	16
X Parafuso 4,0 X 40 Screw 4,0 x 40 Tornillo 4,0 x 40	20
Y Pino Prateleira Shelf pin Supote de estante	04

DESEMBALANDO / Unpacking / Desembalaje

Identifique todas as peças e deixe-as de pé, nunca coloque umas sobre as outras.
Utilize a própria embalagem como tapete para a montagem do produto.
Identify all the parts and leave them standing, never one on top of the other.
Use the packaging itself as rug for product assembly.
Identifica todas las piezas y déjalas en pie, nunca laas coloques una encima de otra.
Utilice el propio embalaje como tapete para montar el producto.

01

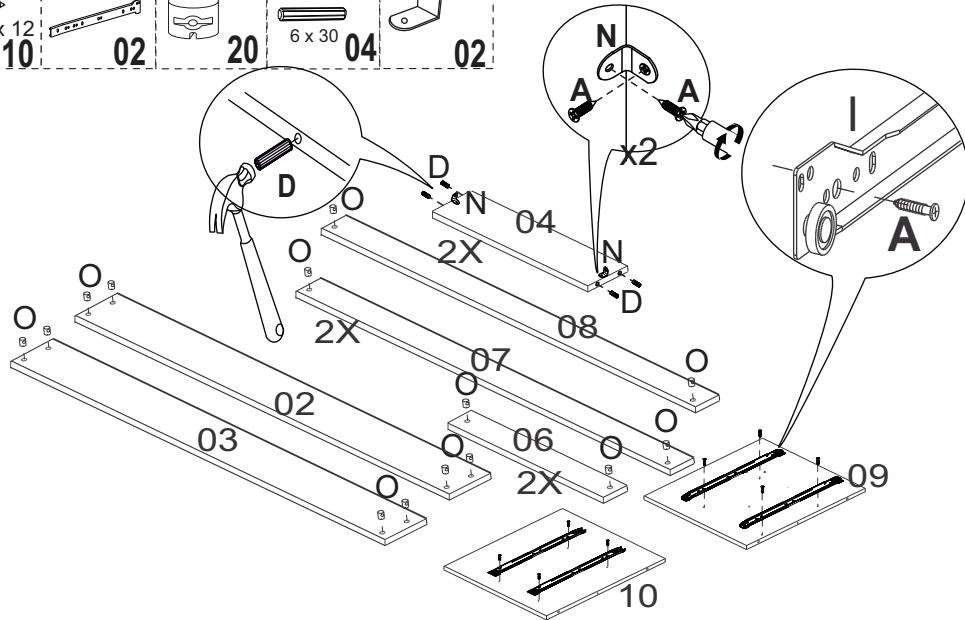

02

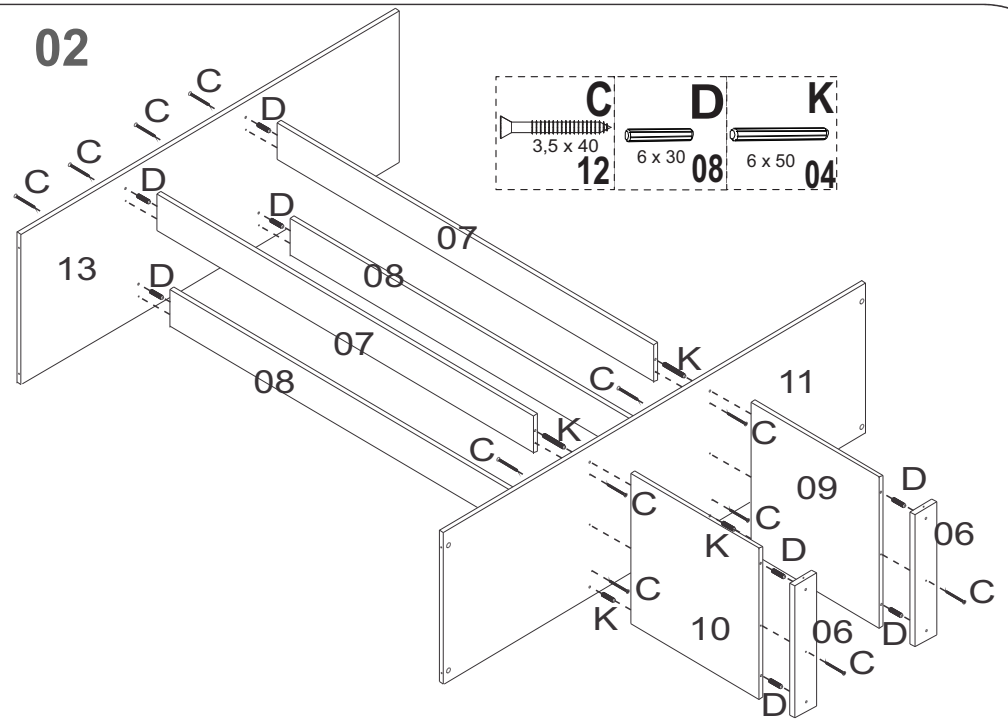
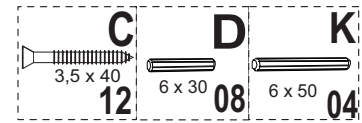

03

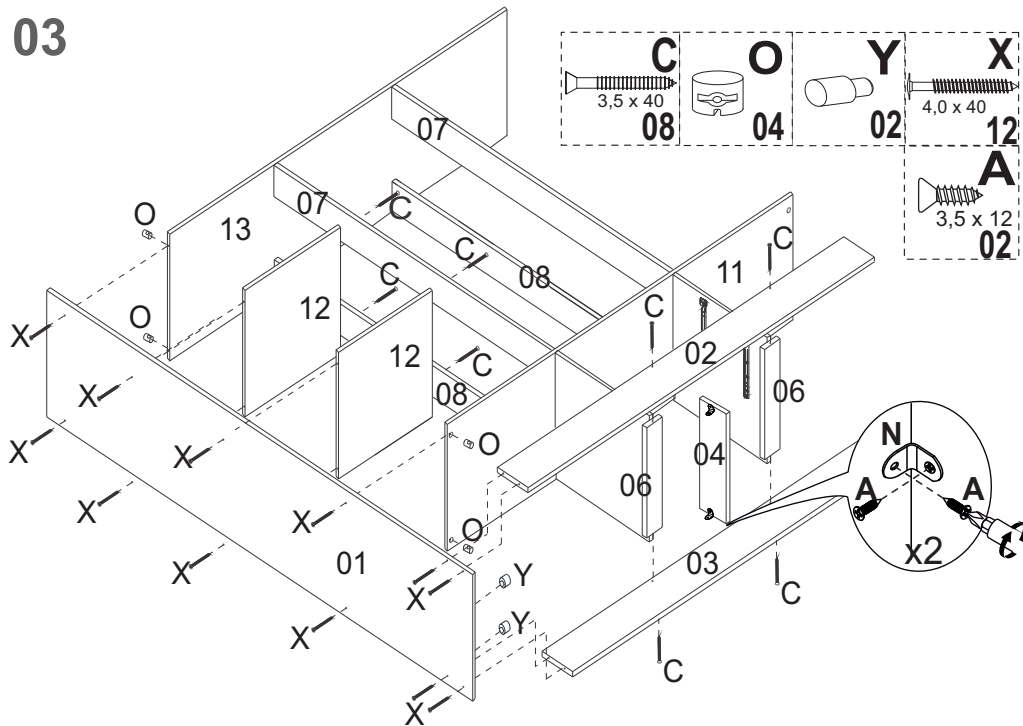
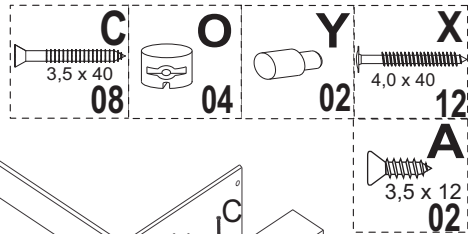

04

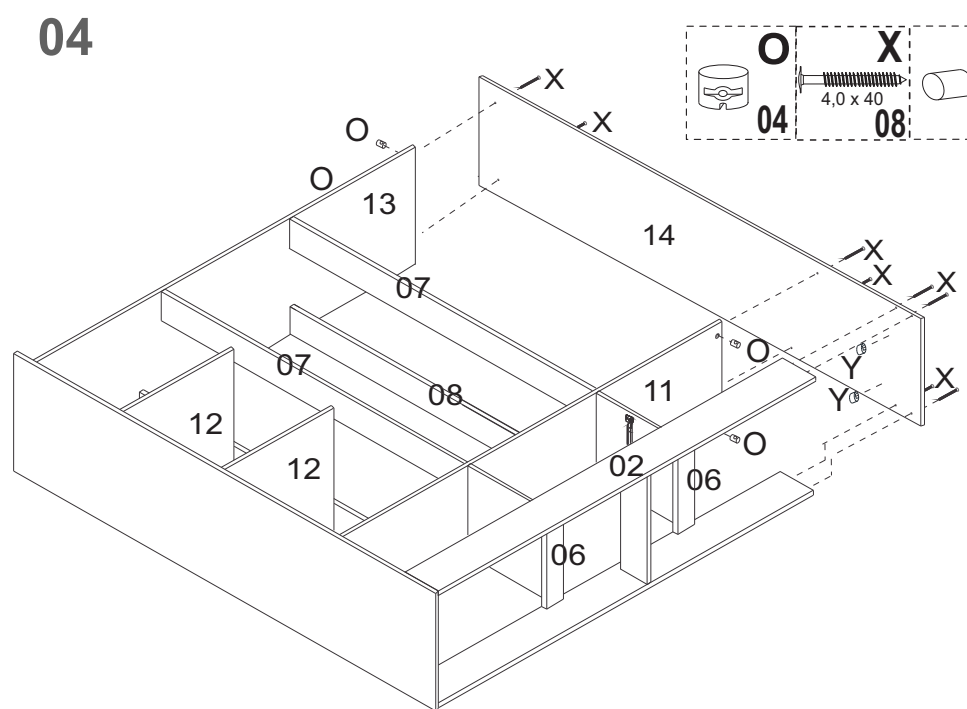
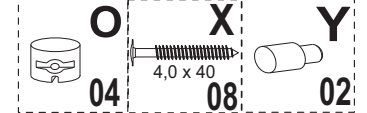

05

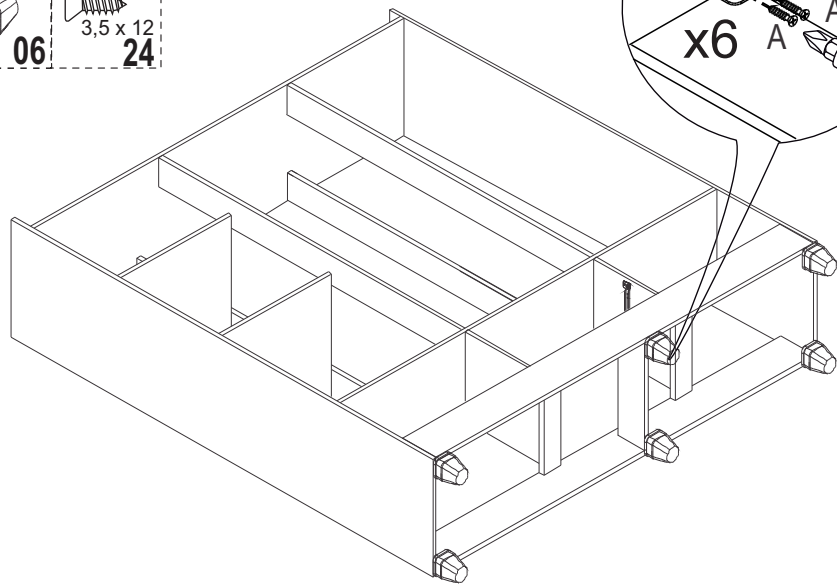
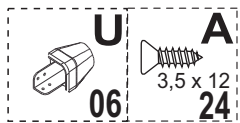

06

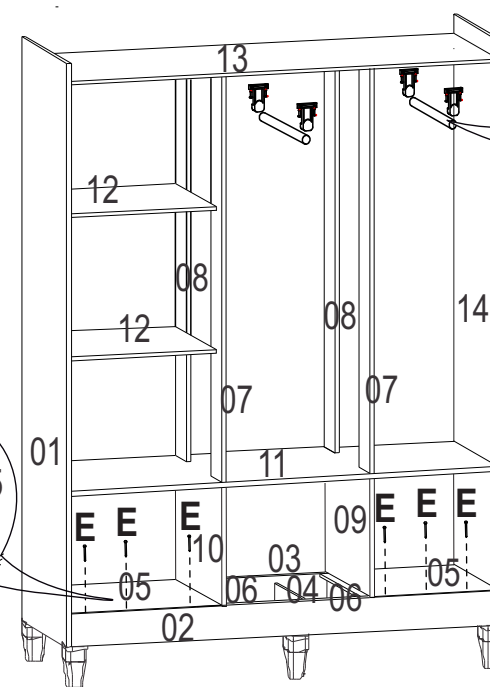
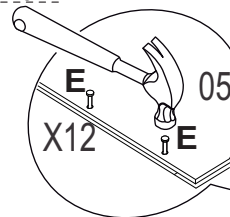
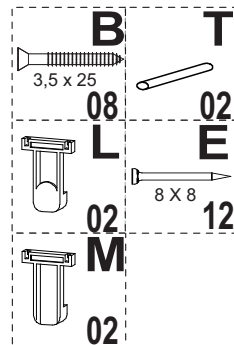

07

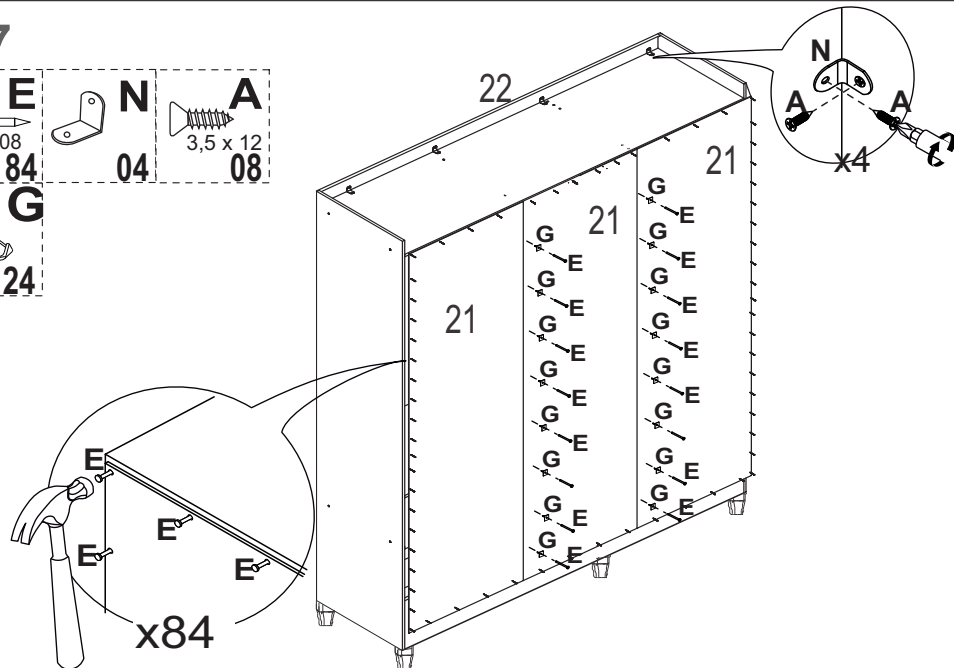
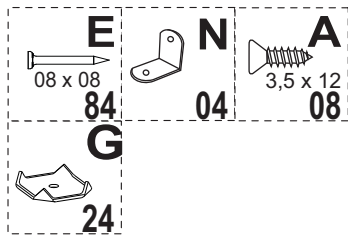

08

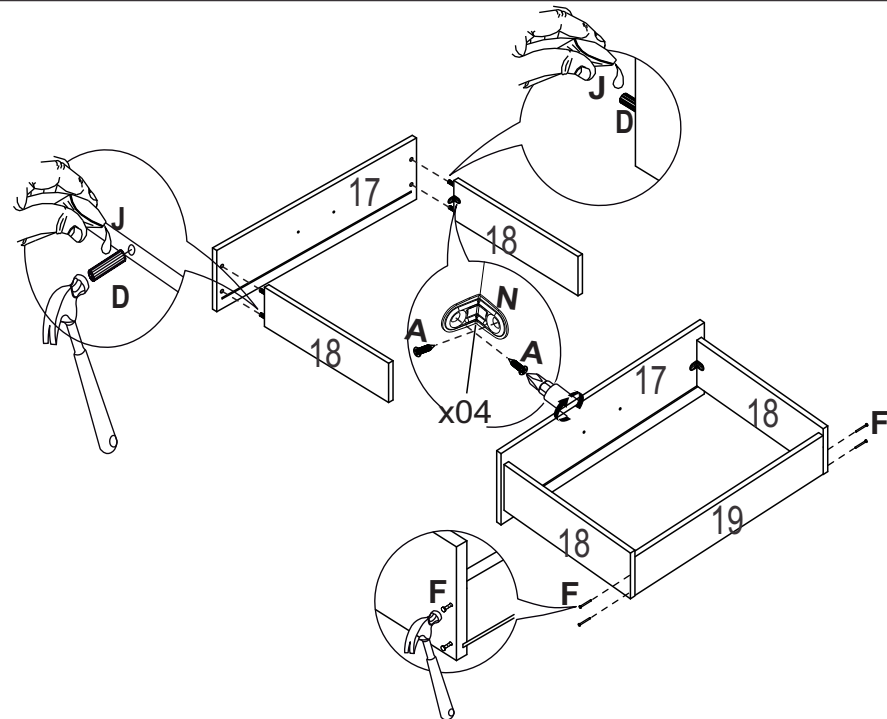
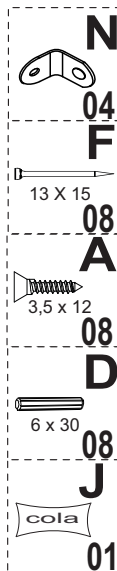

09

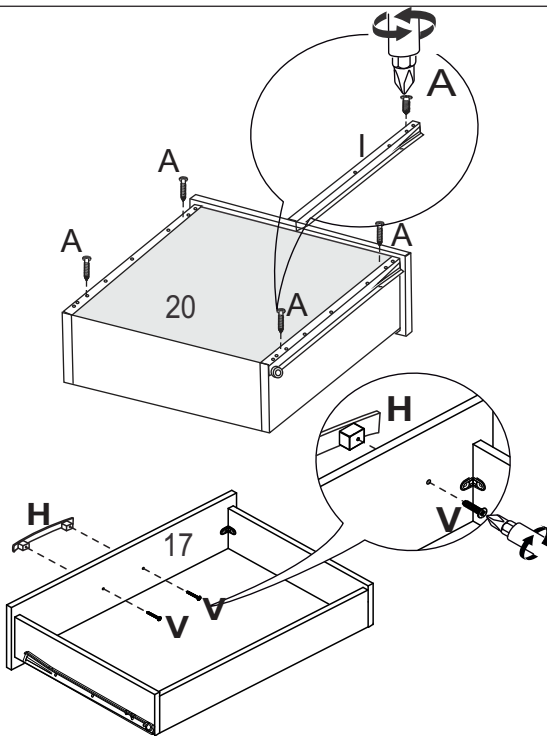
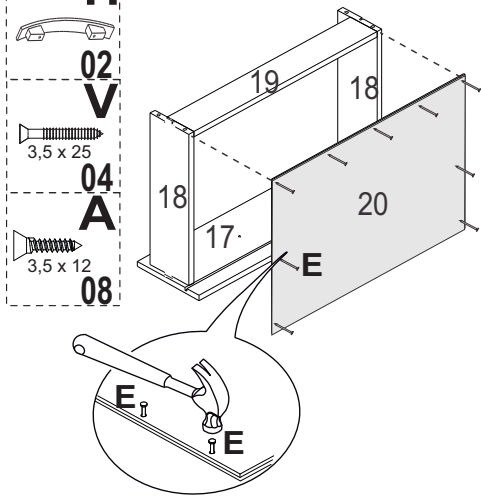
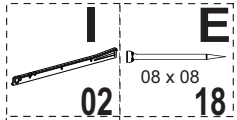

10

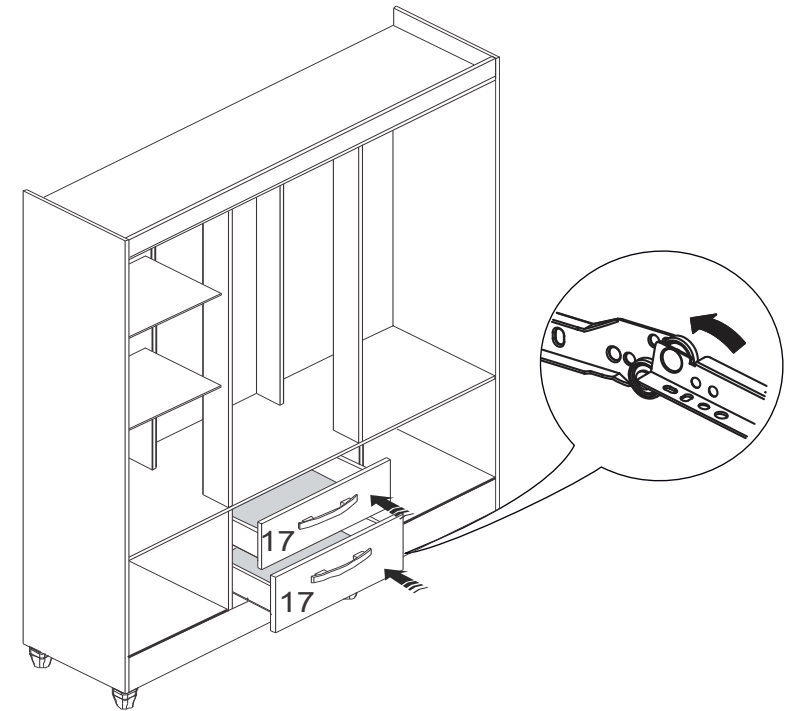

11

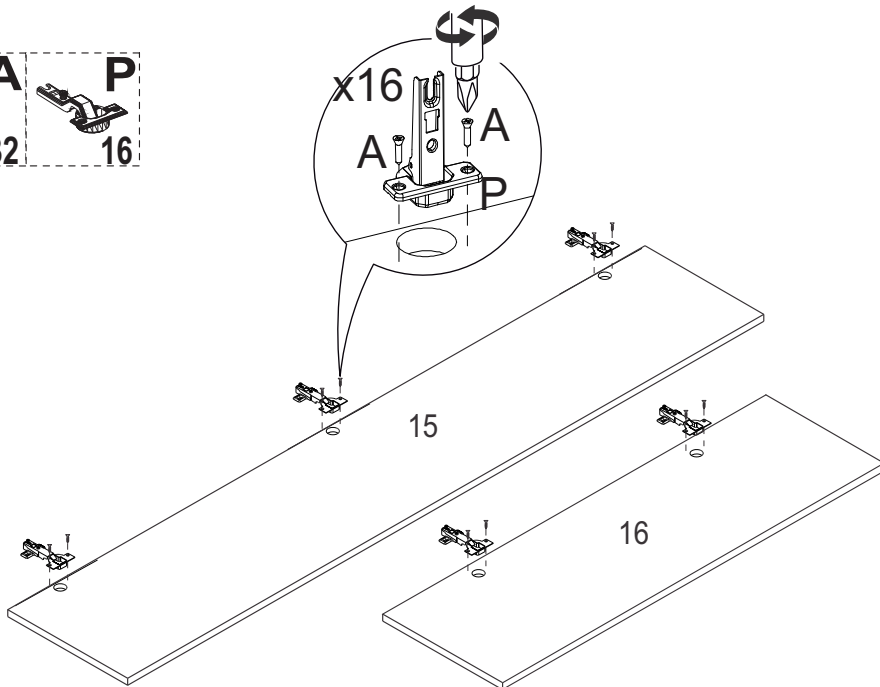
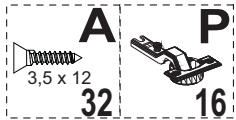

12

