



Português
English
Espanöl

Av. Paranavaí, 3263
Pq. Cidade Industrial
Cep: 87070-130 - Maringá - PR
Fone - (44) 3225-2950 - (44) 3262-9573
E-mail: moveisleao@moveisleao.com.br
Site: www.moveisleao.com.br

| n.ºpc | DESCRIÇÃO DAS PEÇAS | DESCRIPTION OF PARTS | DESCRIPCIÓN DE PIEZAS | QT | A | B |
|-------|------------------------|-----------------------|---------------------------|----|------|--------|
| 1 | LATERAL ESQUERDA | LEFT SIDE | LADO IZQUIERDO | 1 | 905 | 358 12 |
| 2 | RODAPE FRONTAL | FRONT FOOTING | PIE DELANTERO | 1 | 1043 | 130 12 |
| 3 | RODAPE COSTA | COAST FOOTER | PIE DE COSTA | 1 | 1043 | 130 12 |
| 4 | RODAPE INTERNO | INTERNAL FOOTING | PIE DE PIE INTERNO | 1 | 330 | 100 12 |
| 5 | BASE | BASE | BASE | 1 | 502 | 358 12 |
| 6 | DIVISÃO | DIVISION | DIVISIÓN | 1 | 775 | 358 12 |
| 7 | PRATELEIRAS | SHELVES | ESTANTES | 2 | 502 | 300 12 |
| 8 | TAMPO | COVER | CUBRIR | 1 | 1072 | 385 12 |
| 9 | APOIO DO TAMPO | TOP SUPPORT | SOPORTE SUPERIOR | 1 | 529 | 60 12 |
| 10 | TRAVA DAS GAVETAS | DRAWER LOCK | BLOQUEO DEL CAJÓN | 1 | 529 | 60 12 |
| 11 | LATERAL DIREITA | RIGHT SIDE | LADO DERECHO | 1 | 905 | 358 12 |
| 12 | PORTA | DOOR | PUERTA | 2 | 780 | 253 12 |
| 13 | FRENTE DE GAVETA | DRAWER FRONT | FRENTE DEL CAJÓN | 4 | 537 | 175 12 |
| 14 | LATERAL DE GAVETA | DRAWER SIDE | LADO DEL CAJÓN | 8 | 350 | 100 12 |
| 15 | CONTRA FUNDO DE GAVETA | AGAINST DRAWER BOTTOM | CONTRA EL FONDO DEL CAJÓN | 4 | 480 | 80 12 |
| 16 | FUNDO DE GAVETA | DRAWER BOTTOM | FONDO DEL CAJÓN | 4 | 510 | 355 3 |
| 17 | FUNDO DA PORTA | DOOR BOTTOM | FONDO DE LA PUERTA | 2 | 785 | 257 3 |
| 18 | FUNDO | BOTTOM | ABAJO | 2 | 800 | 268 3 |

Aparência final
Final Appearance
Aspecto final

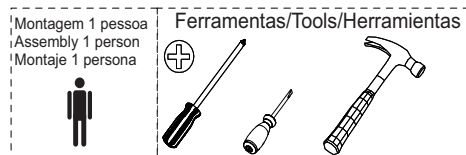
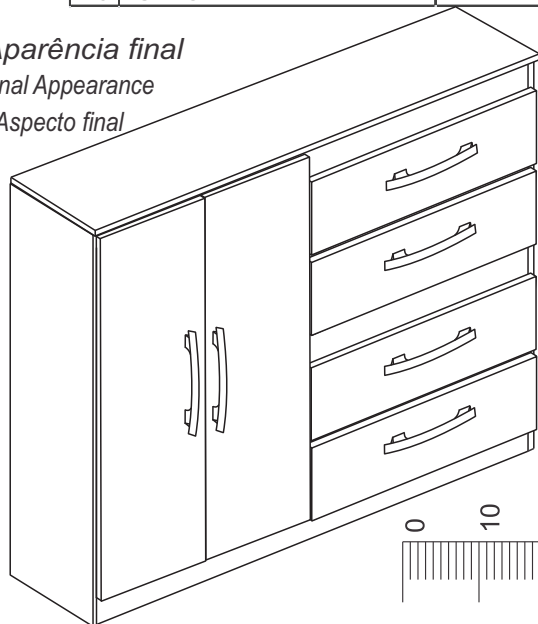

medidas em mm



PARA A LIMPEZA E CONSERVAÇÃO DO SEU MÓVEL

For cleaning and maintaining your furniture / Para la limpieza y mantenimiento de tus muebles



Não use produtos abrasivos como Álcool, Solventes, Acetona e etc...

Do not use abrasive products like Alcohol, solvents, etc

No utilice productos abrasivos como alcohol, solventes, acetona, etc...



Use somente um pano macio e seco.

Use only a soft, dry cloth and.

Utilice únicamente un paño suave y seco.

**Cômoda 4 Gavetas
2 Porta LITE**

| Descrição / Description / Descripción | QTD |
|--|-----|
| A Parafuso 3,5 X 12 Screw 3,5 x 12 Tomillo 3,5 x 12 | 84 |
| B Parafuso 4,0 X 40 Screw 4,0 x 40 Tomillo 4,0 x 40 | 18 |
| C Parafuso 3,5 X 25 Screw 3,5 x 25 Tomillo 3,5 x 25 | 12 |
| D Cavilha 6 x 30 Peg 6 x 30 clavija 6 x 30 | 22 |
| E Cantoneira Corner Esquina | 18 |
| F Corrediça slide Corredera | 04 |
| G Sachet de cola Glue sachet bolsita de pegamento | 01 |
| H Etiqueta Label Etiqueta | 01 |
| I Prego 13 x 15 Nail 13 x 15 clavo 13 x 15 | 22 |
| J Prego 08 x 08 Nail 08 x 08 clavo 08 x 08 | 96 |
| K Giz de Correção Correction Chalk tiza correctora | 02 |
| L Puxador Puller Arrancador | 06 |
| M Porca cilíndrica 9 x 12 Cylindrical Nut 9 x 12 Tuerca cilíndrica 9 x 12 | 12 |
| N Sapata 15mm 15mm Shoe Zapato 15mm | 06 |
| O PERFIL H 800MM PROFILE H 800MM PERFIL AL 800MM | 02 |
| P Pino Prateleira Shelf pin suporte de estante | 08 |
| Q Prendedor de Fundo Bottom fastener Cierre inferior | 07 |
| R Dobradiça Hinge Bisagra | 04 |
| S Calço Dobradiça Hinge Shim Cuña de Bisagra | 04 |

DESEMBALANDO / Unpacking / Desembalaje

Identifique todas as peças e deixe-as de pé, nunca coloque umas sobre as outras. Utilize a própria embalagem como tapete para a montagem do produto.

Identify all the parts and leave them standing, never one on top of the other. Use the packaging itself as rug for product assembly.

Identifica todas las piezas y déjalas en pie, nunca laas coloques una encima de otra. Utilice el propio embalaje como tapete para montar el producto.

Passo 01

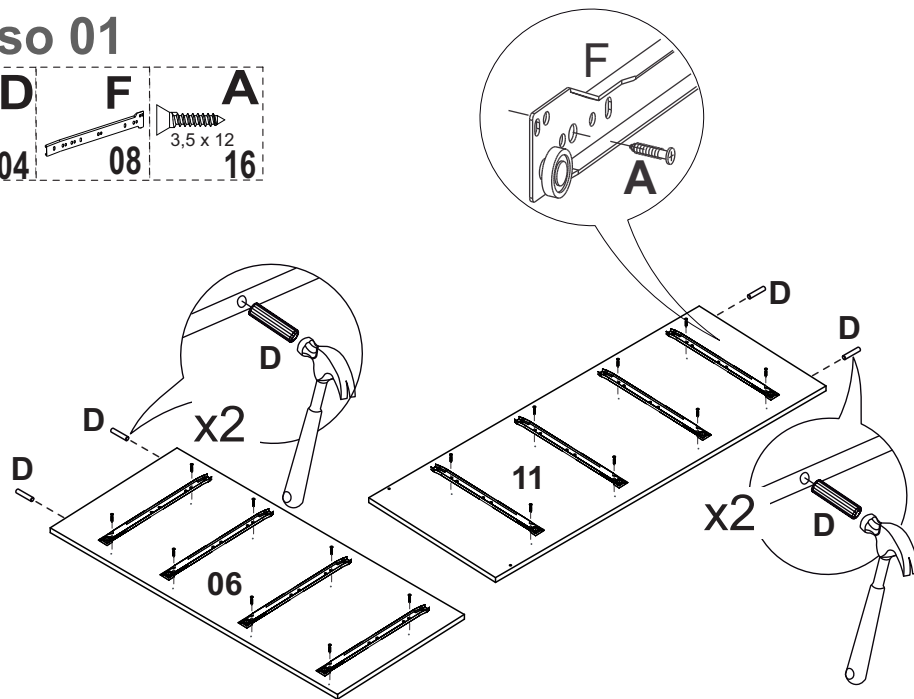
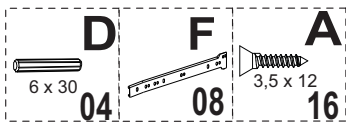

Passo 02

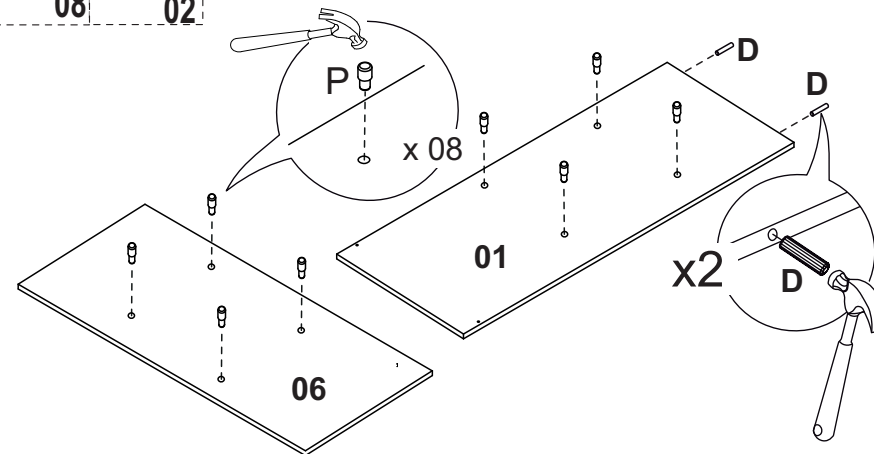
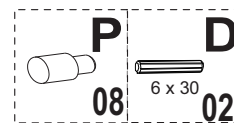

Passo 03

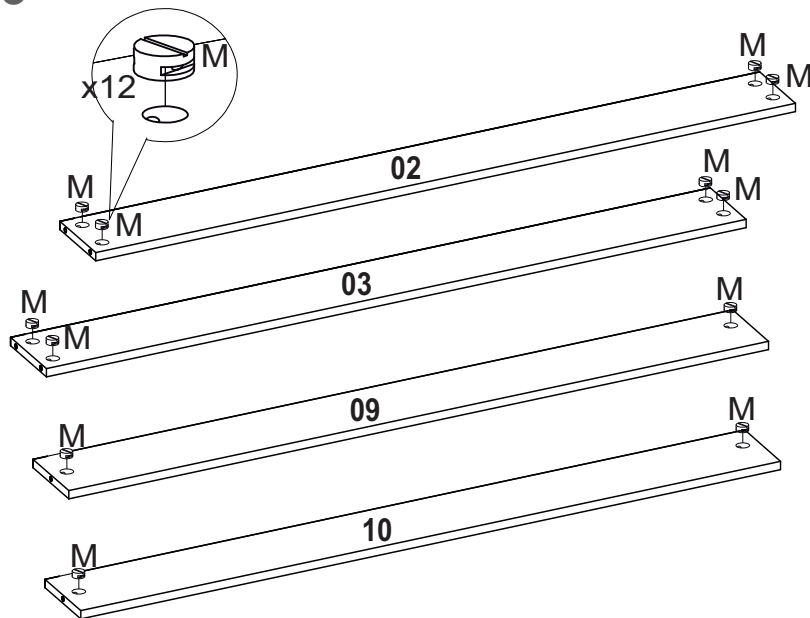

Passo 04

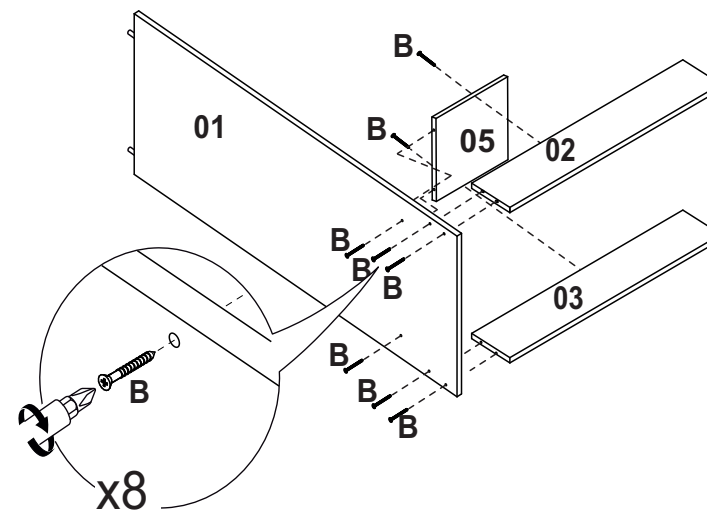
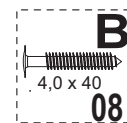

Passo 05

- B**
4,0 x 40
- N**
06
- I**
13 X 15
06

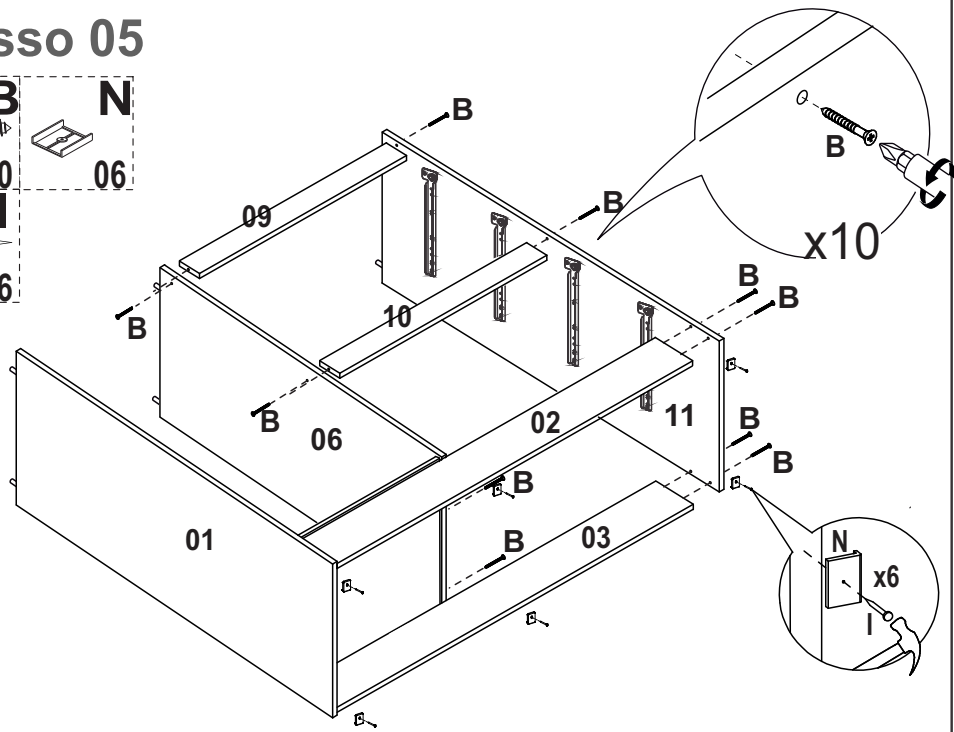

Passo 06

- E**
10
- A**
3,5 x 12
20
- G**
cola
01

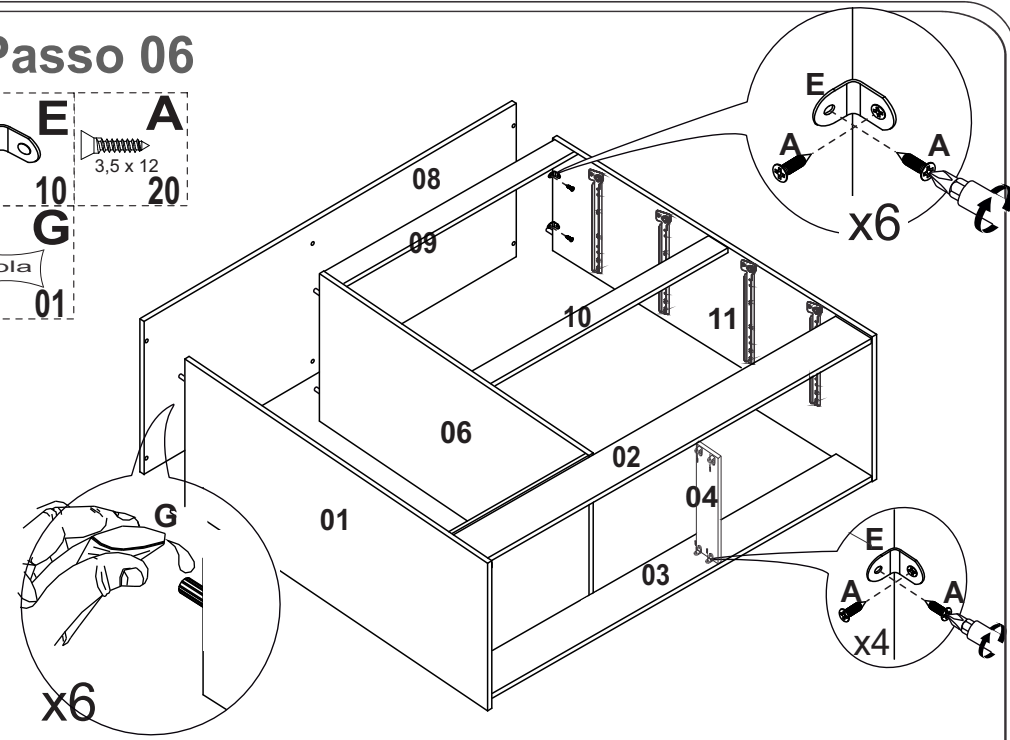

Passo 07

- J**
08 x 08
60
- Q**
07

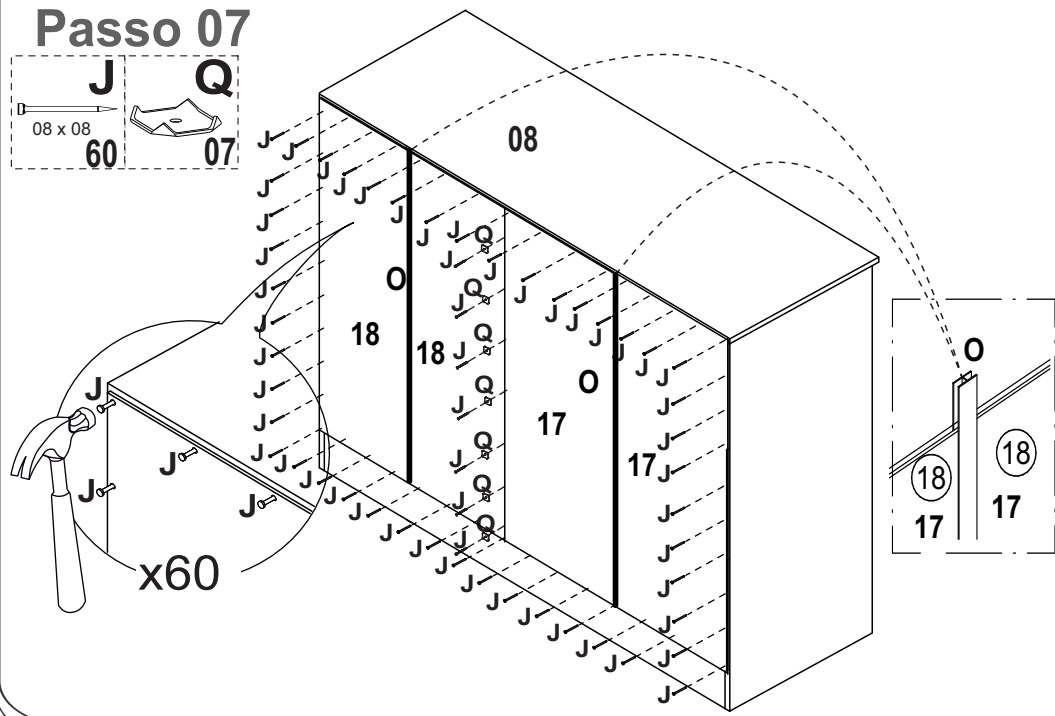

Passo 08

- E**
08
- I**
13 X 15
16
- A**
3,5 x 12
16
- D**
6 x 30
16
- G**
cola
01

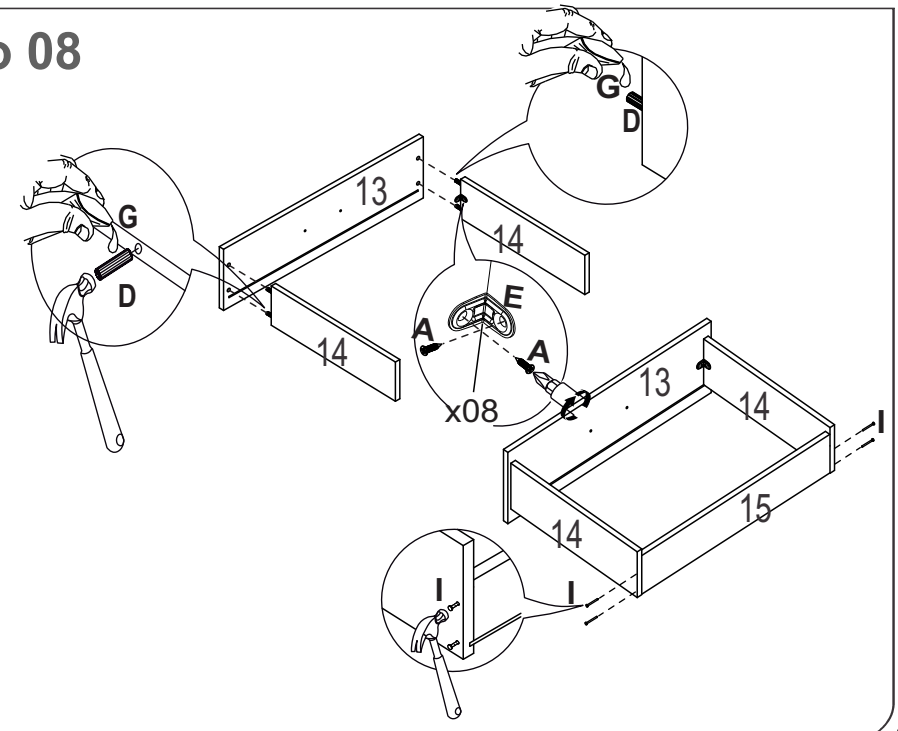

Passo 09

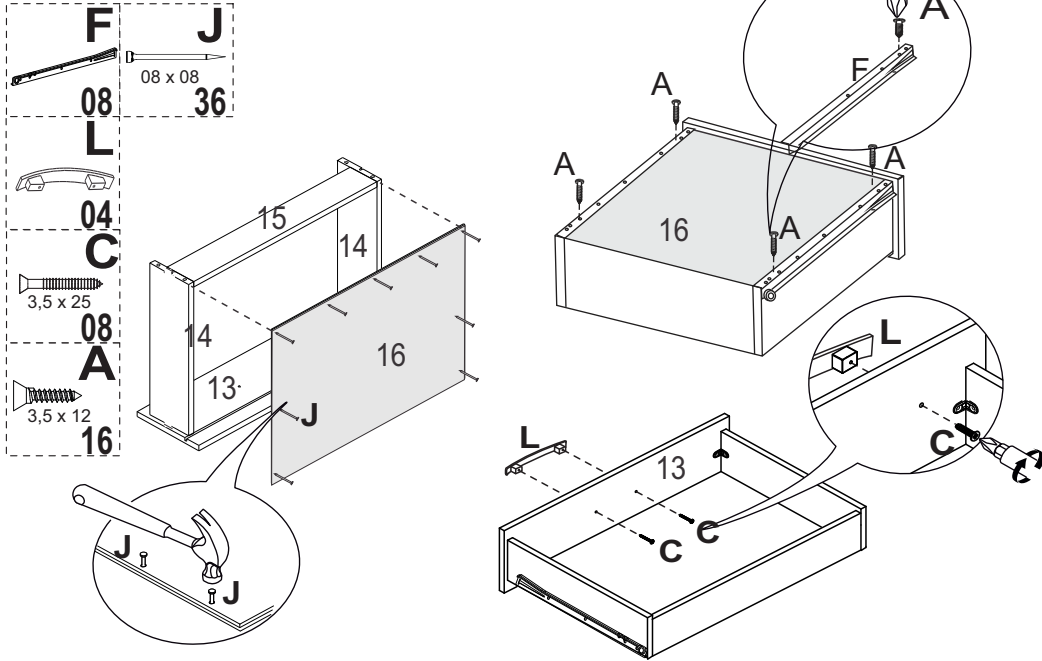

Passo 10

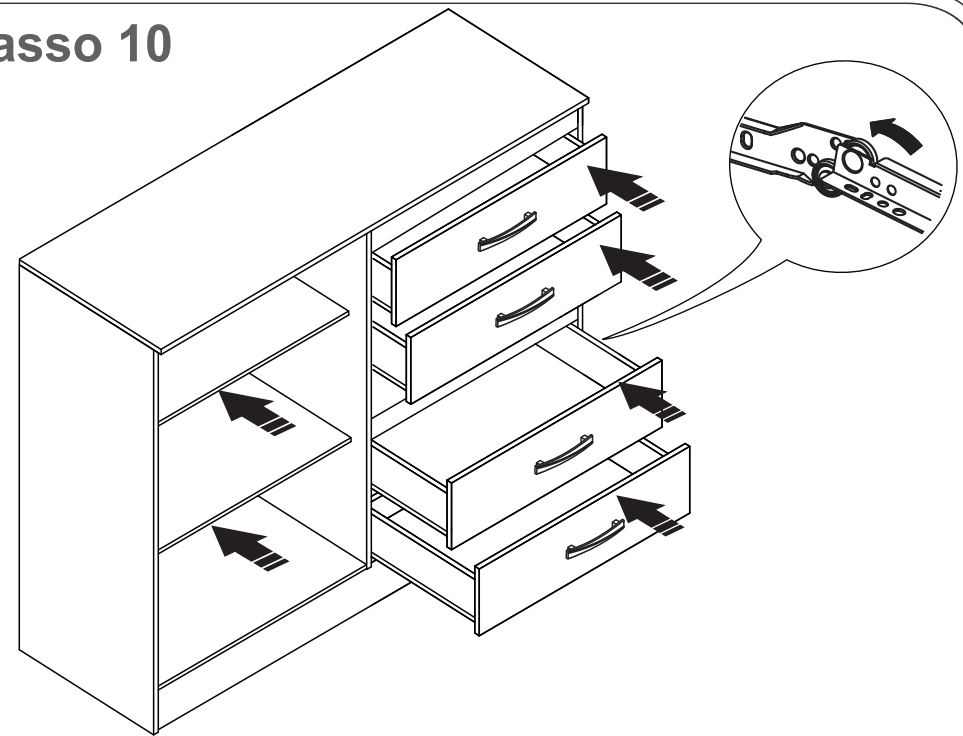

Passo 11

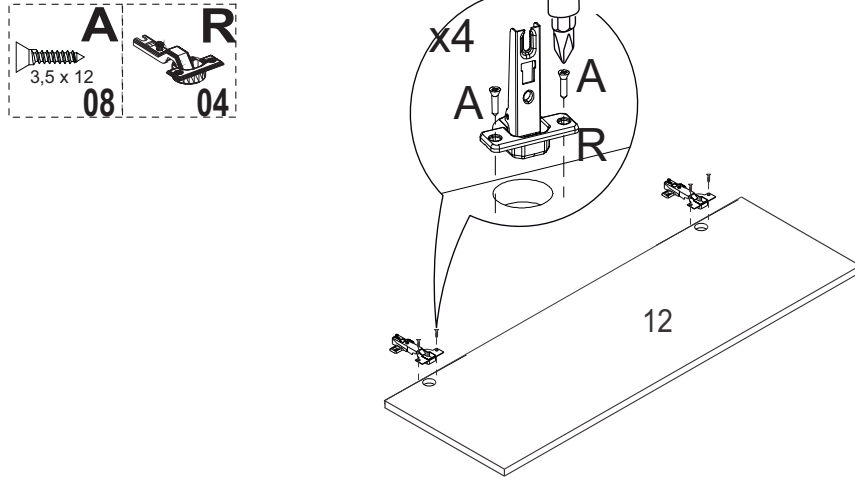

Passo 12

