



Português
English
Espanöl

Av. Paranavaí, 3263
Pg. Cidade Industrial
Cep: 87070-130 - Maringá - PR
Fone - (44) 3225-2950 - (44) 3262-9573
E-mail: moveisleao@moveisleao.com.br
Site: www.moveisleao.com.br

Cômuda 4 Gavetas 1 Porta LITE

n.ºpc	DESCRIÇÃO DAS PEÇAS	DESCRIPTION OF PARTS	DESCRIPCIÓN DE PIEZAS	QT	A	B
1	LATERAL ESQUERDA	LEFT SIDE	LADO IZQUIERDO	1	905	358
2	RODAPE FRONTAL	FRONT FOOTING	PIE DELANTERA	1	786	130
3	RODAPE COSTA	COAST FOOTER	PIE DE COSTA	1	786	130
4	RODAPE INTERNO	INTERNAL FOOTING	PIE INTERIOR	1	330	100
5	BASE	BASE	BASE	1	245	358
6	DIVISÃO	DIVISION	DIVISIÓN	1	775	358
7	PRATELEIRAS	SHELVES	ESTANTES	2	245	300
8	TAMPO	COVER	CUBRIR	1	815	385
9	APOIO DO TAMPO	TOP SUPPORT	SOPORTE SUPERIOR	1	529	60
10	TRAVA DAS GAVETAS	DRAWER LOCK	BLOQUEO DEL CAJÓN	1	529	60
11	LATERAL DIREITA	RIGHT SIDE	LADO DERECHO	1	905	358
12	PORTA	DOOR	PUERTA	1	780	253
13	FRENTE DE GAVETA	DRAWER FRONT	FRENTE DEL CAJÓN	4	537	175
14	LATERAL DE GAVETA	DRAWER SIDE	LADO DEL CAJÓN	8	350	100
15	CONTRA FUNDO DE GAVETA	AGAINST DRAWER BOTTOM	CONTRA EL FONDO DEL CAJÓN	4	479	80
16	FUNDO DE GAVETA	DRAWER BOTTOM	FONDO DEL CAJÓN	4	500	355
17	FUNDO DA PORTA	DOOR BOTTOM	FONDO DE LA PUERTA	1	785	257
18	FUNDO	BOTTOM	ABAJO	2	800	268

Aparência final
Final Appearance
Aspecto final

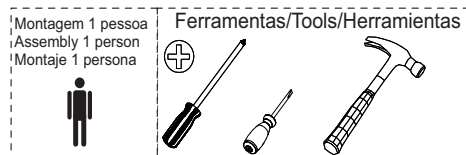
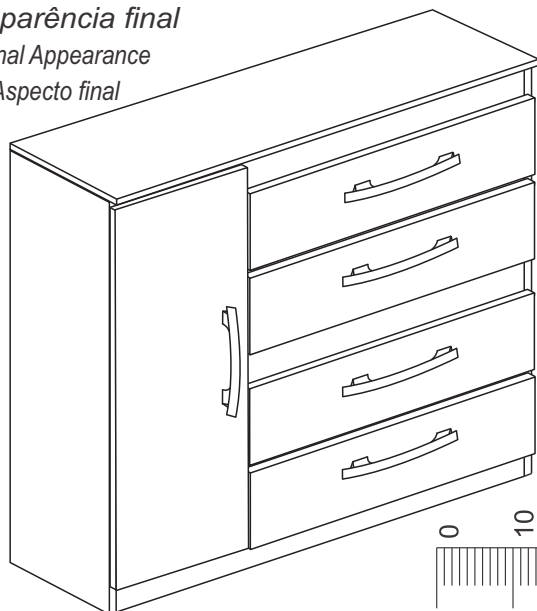

medidas em mm



PARA A LIMPEZA E CONSERVAÇÃO DO SEU MÓVEL

For cleaning and maintaining your furniture / Para la limpieza y mantenimiento de tus muebles

- Não use produtos abrasivos como Álcool, Solventes, Acetona e etc...
Do not use abrasive products like Alcohol, solvents, etc
No utilice productos abrasivos como alcohol, solventes, acetona, etc...
- Use somente um pano macio e seco.
Use only a soft, dry cloth and.
Utilice únicamente un paño suave y seco.

Descrição / Description / Descripción	QTD
A Parafuso 3,5 X 12 Screw 3,5 x 12 Tornillo 3,5 x 12	76
B Parafuso 4,0 X 40 Screw 4,0 x 40 Tornillo 4,0 x 40	18
C Parafuso 3,5 X 25 Screw 3,5 x 25 Tornillo 3,5 x 25	10
D Cavilha 6 x 30 Peg 6 x 30 clavija 6 x 30	22
E Cantoneira Corner Esquina	18
F Corrediça slide Corredera	04
G Sachet de cola Glue sachet bolsita de pegamento	01
H Etiqueta Label Etiqueta	01
I Prego 13 x 15 Nail 13 x 15 clavo 13 x 15	22
J Prego 08 x 08 Nail 08 x 08 clavo 08 x 08	86
K Giz de Correção Correction Chalk tiza correctora	02
L Puxador Puller Arrancador	05
M Porca cilíndrica 9 x 12 Cylindrical Nut 9 x 12 Tuerca cilíndrica 9 x 12	12
N Sapata 15mm 15mm Shoe Zapato 15mm	06
O PERFIL H 800MM PROFILE H 800MM PERFIL AL 800MM	01
P Pino Prateleira Shelf pin suporte de estante	08
Q Prendedor de Fundo Bottom fastener Cierre inferior	07
R Dobradiça Hinge Bisagra	02
S Calço Dobradiça Hinge Shim Cuña de Bisagra	02

DESEMBALANDO / Unpacking / Desembalaje

Identifique todas as peças e deixe-as de pé, nunca coloque umas sobre as outras.
Utilize a própria embalagem como tapete para a montagem do produto.
Identify all the parts and leave them standing, never one on top of the other.
Use the packaging itself as rug for product assembly.
Identifica todas las piezas y déjalas en pie, nunca laas coloques una encima de otra.
Utilice el propio embalaje como tapete para montar el producto.

Passo 05

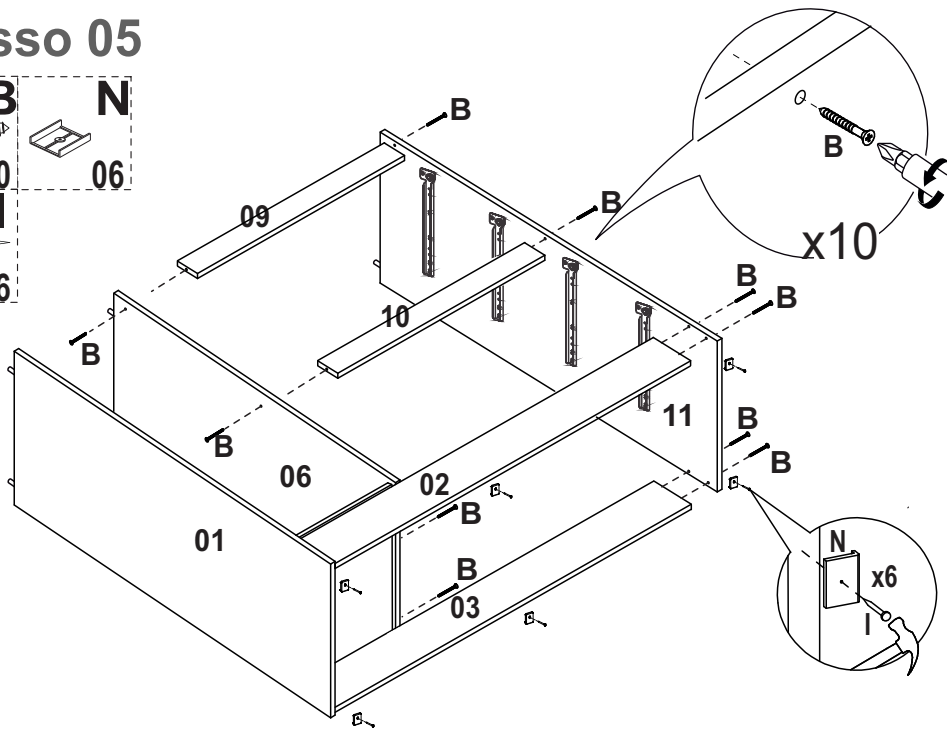
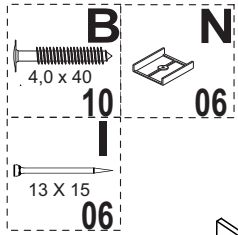

Passo 06

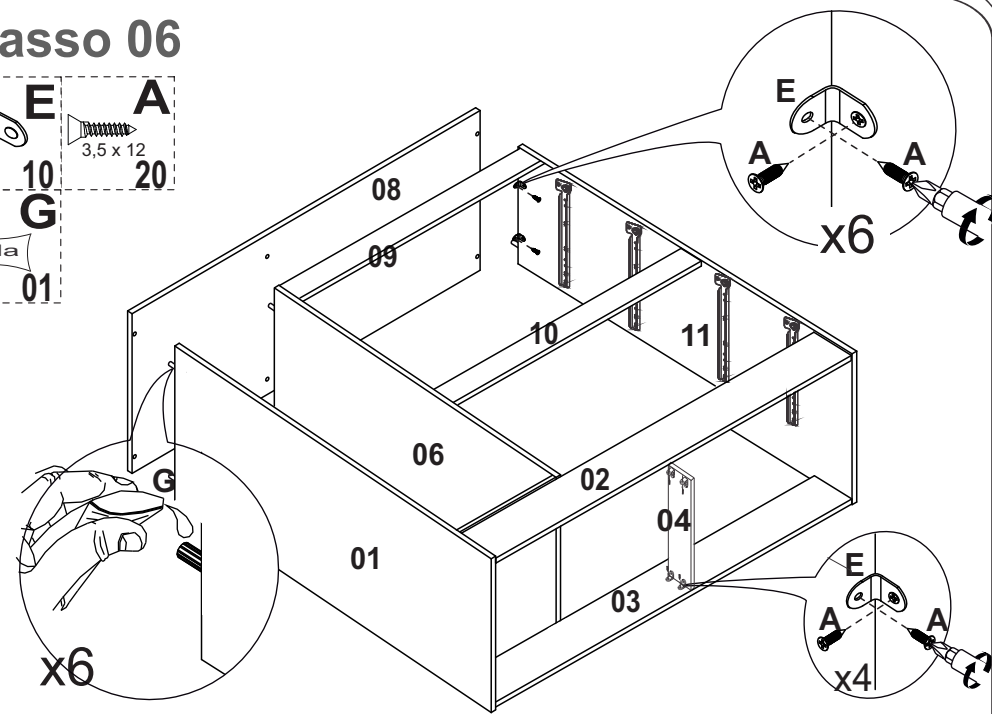
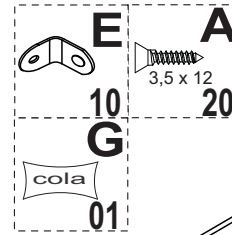

Passo 07

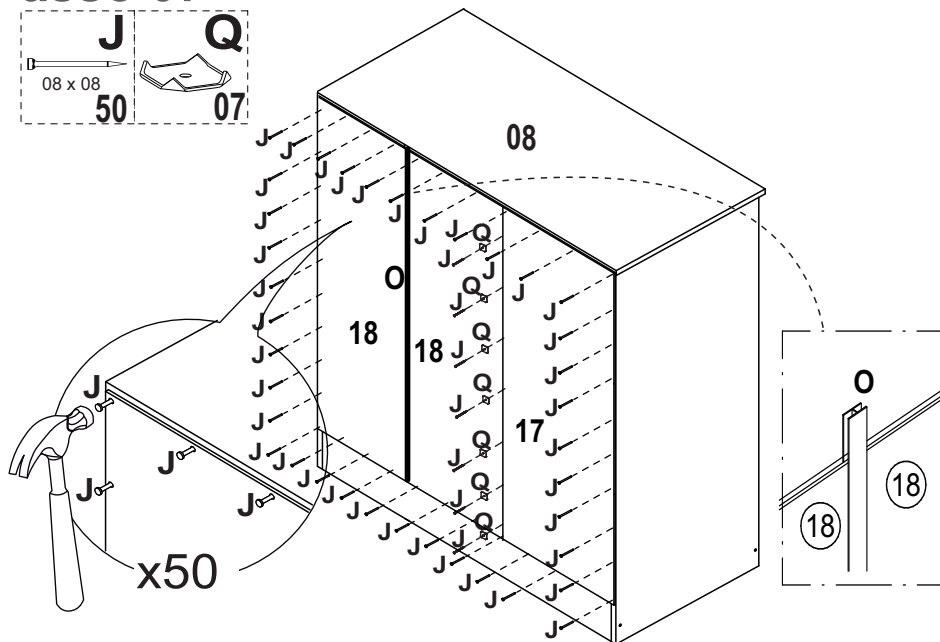
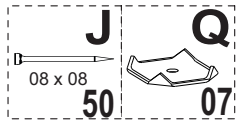

Passo 08

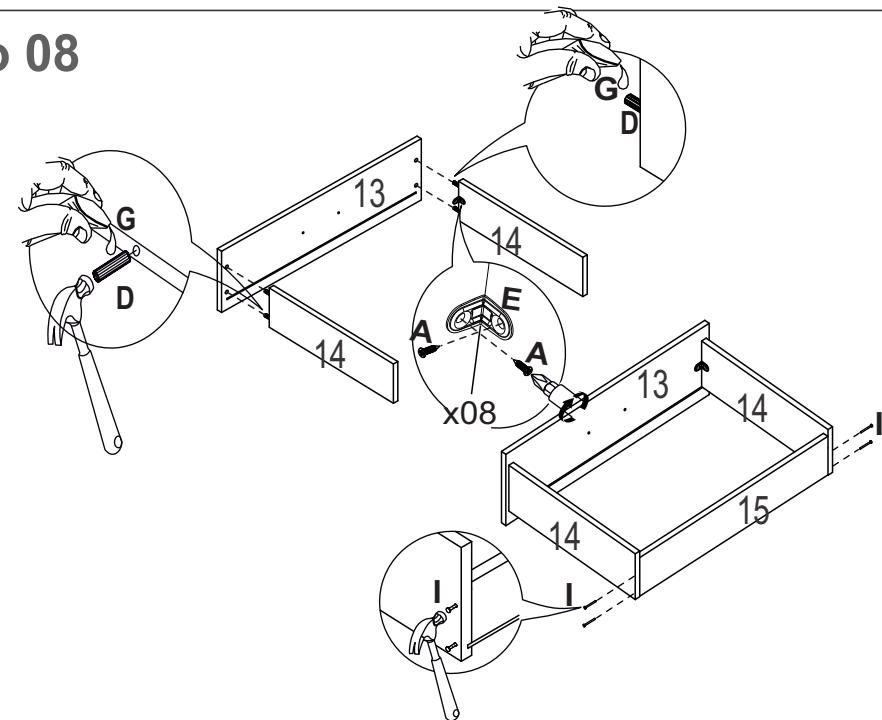
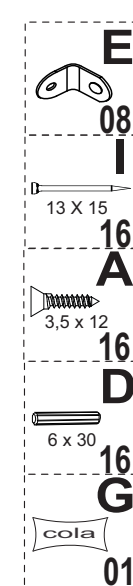

Passo 09

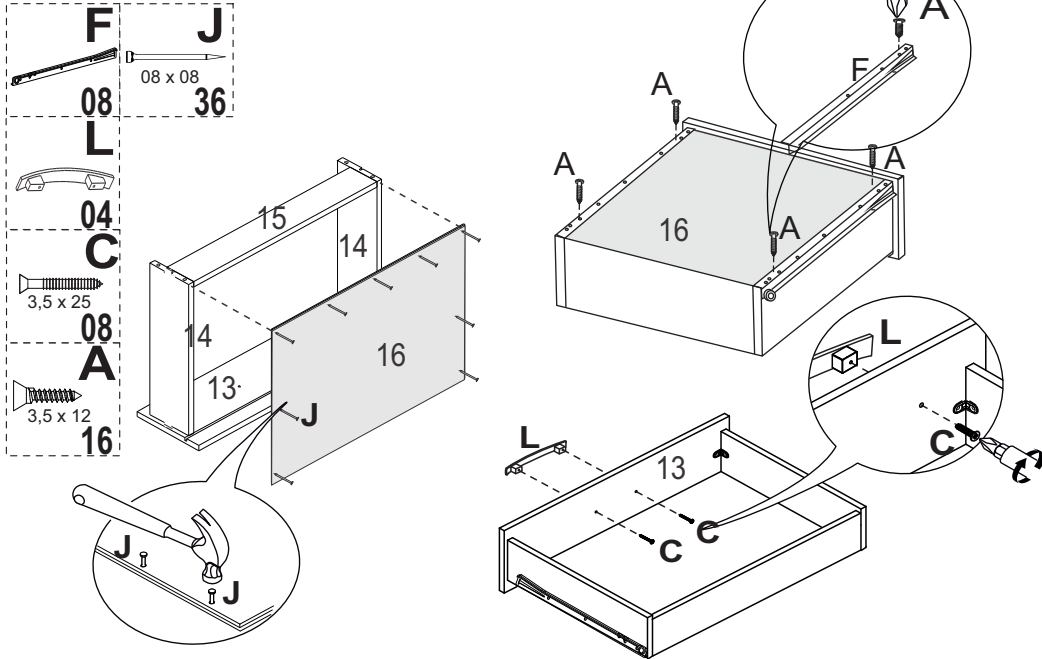

Passo 10

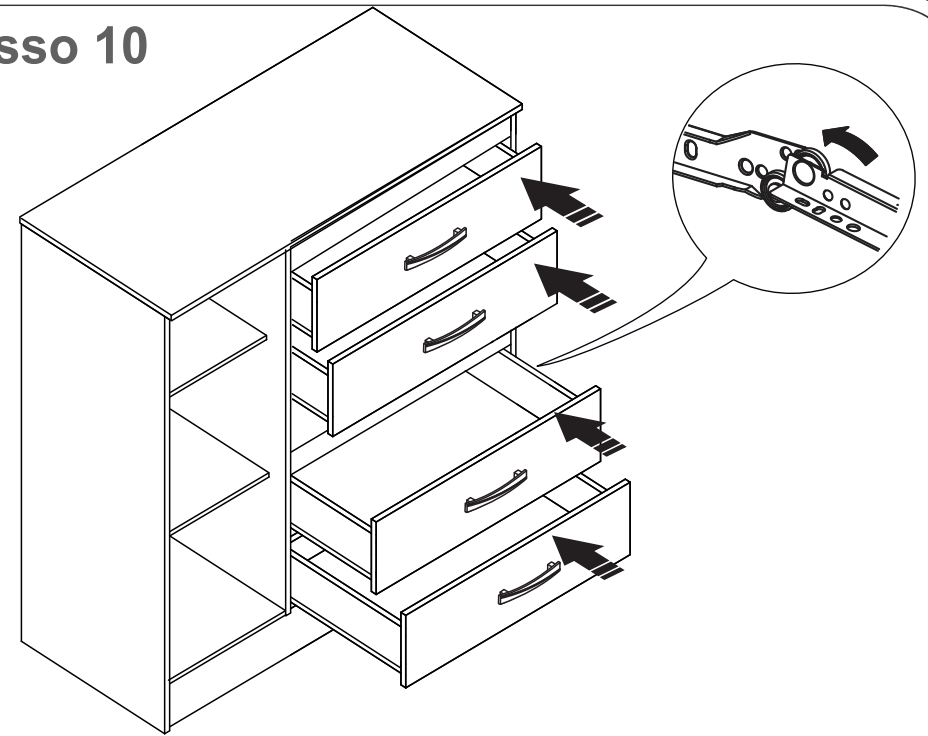

Passo 11

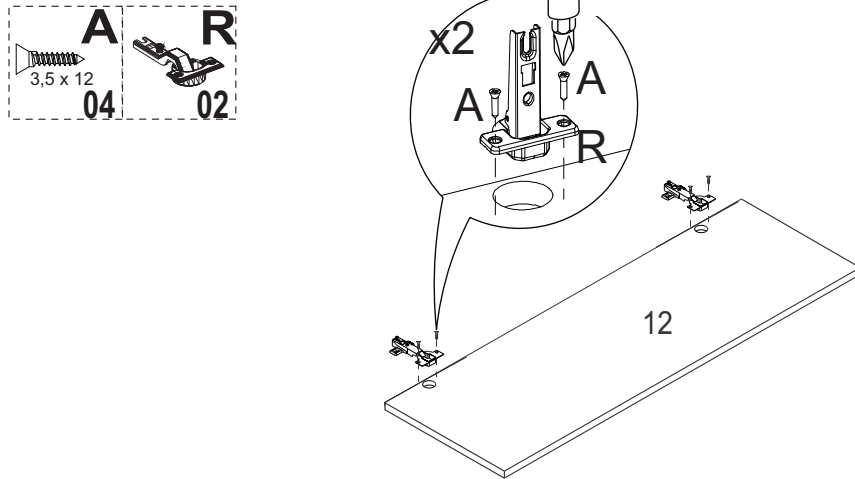

Passo 12

