

09a

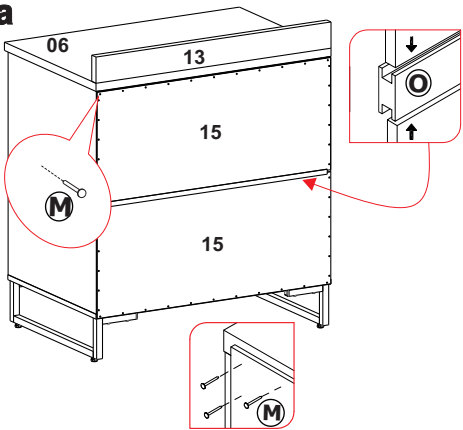

10a

Obs: Passar cola nas gavetas
 Obs: Glue in drawers
 Obs: Pegamento en cajones

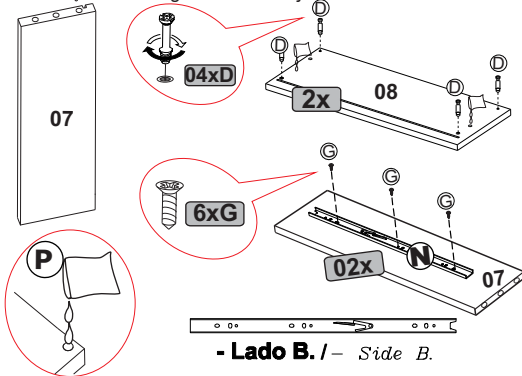

BALCÃO / COUNTER / ENCIMERA

BALCÃO COZINHA 800 C/GAVETÃO IRON

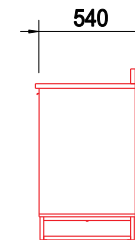
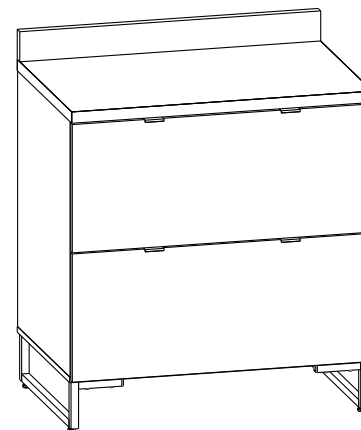
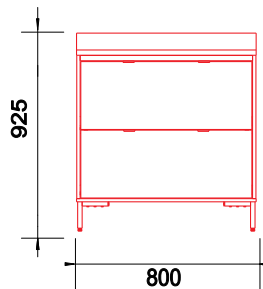

11a

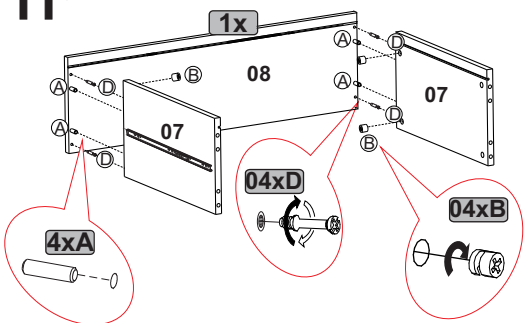

12a

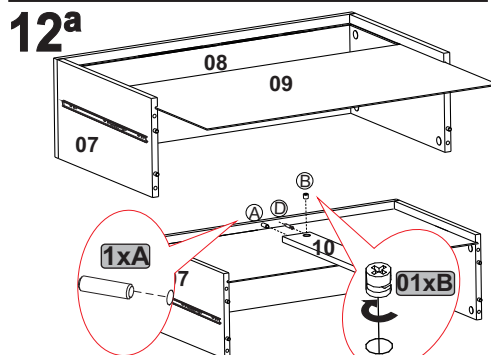

Parabéns pela aquisição de um produto de qualidade.
 Em caso de dúvidas procure a loja em que efetuou a compra.
Congratulations on your purchase of a product of quality.
 When in doubt look for the shop where you made the purchase.
Enhorabuena por la compra de un producto de calidad.
 En caso de duda buscar la tienda donde hizo la compra.

Montador
 Observe atentamente as instruções e siga rigorosamente as etapas de montagem.
 Após a montagem entregue ao cliente para a garantia do produto
Assembler
 Note the instructions carefully and strictly follow the assembly steps.
 After assembly delivered to the customer for the product warranty
Ensamblador
 tenga en cuenta las instrucciones cuidadosamente y seguir estrictamente los pasos de montaje.
 Después del montaje entregado al cliente para la garantía del producto

13a

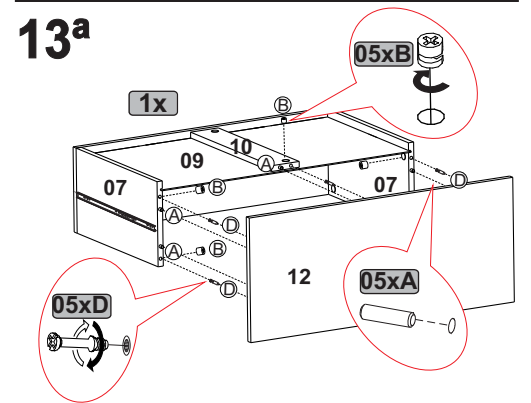

14a

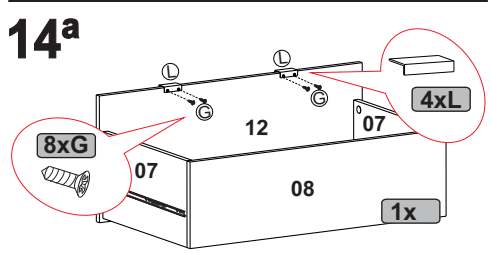

Observações:
 -Para limpeza utilize pano seco.
 Não utilize álcool ou produtos químicos tipo limpeza pesada, bem como produtos abrasivos.
 -Pouca resistência à umidade.
 - 3 meses de garantia legal contra eventuais defeitos de fabricação.
 Não é coberto pela garantia. Danos referentes ao mal uso do produtos.

Resistência
 -40KG.
Comments:
 -For cleaning only dry cloth.
 Do not use alcohol or heavy-duty cleaning chemicals as well as abrasive products.
 -Low resistance to humidity
Warranty
 - 3 months of legal warranty against any manufacturing defects.
 It is not covered by warranty. Damages for the use of the product.
Resistance
 -40kg

15a

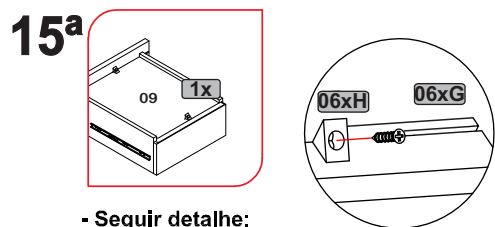

16a

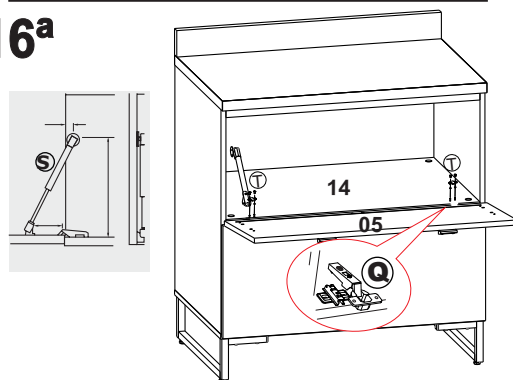

Observaciones:
 -Para La limpieza paño seco.
 No utilice alcohol ni productos químicos como la limpieza pesada y productos abrasivos
 -Poca resistencia a la humedad lo hará
Garantía
 - 3 meses de garantía legal contra cualquier defecto de fabricación.
 No está cubierto por la garantía. Los daños para el uso del producto.
Resistencia
 -40kg

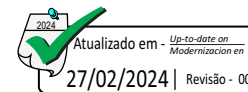

- Seguir detalhe:
 - Follow detail:
 - Seguir detalle:

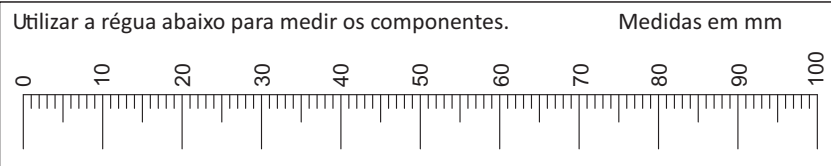

Montagem / Assembly / Montaje

Accesórios / Accessories / Accesorios

A Cavilha 8 x 30 Pin 8 x 30 Clavija 8 x 30 22	B Castanha Girofix Brow Girofix Castano Girofix 22	C Tapa Furo Tap Role Tap del Agujero 22	D Girofix c/ Soberba Girofix Whit Superb Girofix Con Soberbia 22	E Parafuso CH PH SB 4,8 X 32 Screw Tornillo 10	F Parafuso AL INT SB 7,0x60 Screw Tornillo 04
G Parafuso CH PH SB 3,5 X 14 Screw Tornillo 33	H Fixador de Fundo Bottom Fixer Fijador inferior 06	I Parafuso CH PH SB 4,0 X 35 Screw Tornillo 08	J Sapata c/ rosca Threaded shoe Zapato roscado 04	K Bucha p/ Sapata Shoe Bushing Buje para zapato 04	L Puxador Clean Puller Arrancador 04
M Pregão Nail Clavo 40	N Correções 400 Slides Correderas 01 Par	O Perfil p/ fundo Profile Perfil 01	P Saco de Cola Glue Pegamento 02	Q Dobradiça super reta 35mm Straight mug recta 35mm Bisagra reta 35mm 02	R Chave Allen Allen key Allen 01
S Pistão a gás Gas piston Piston gas 01	T Parafuso CH PH SB 3,5 X 16 Screw Tornillo 08				

Peças / Parts / Partes

01 Base 01	02 Lateral Esquerda Left Side Lado izquierdo 01	03 Lateral Direita Right Side Lado Derecho 01	04 Travessa Frontal e Traseira front and rear cross member travesaño delantero y trasero 02	05 Porta Basculante Swinging door Puerta de vaivén 01	06 Tampo Top Tapa 01
07 Lateral da gaveta Side drawer Cajón lateral 02	08 Contra-fundo Against fund Contra el fondo 01	09 Fundo da gaveta Drawer bottom Fondo del cajón 01	10 Travessa gaveta Drawer tray Bandeja del cajón 01	11 Rodapé Metálico Metallic plinth Zócalo metálico 02	12 Frente gavetão Drawer front Frente del cajón 01
13 Vista Frontal Front view Vista frontal 01	14 Prateleira fixa Fixed shelf Estante fijo 01	15 Fundo do Móvel Background Fondo de muebles 02			

Ferramentas / Tools / Herramientas

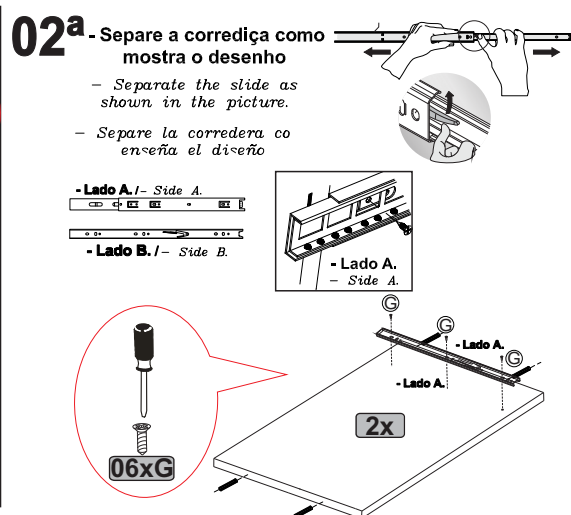
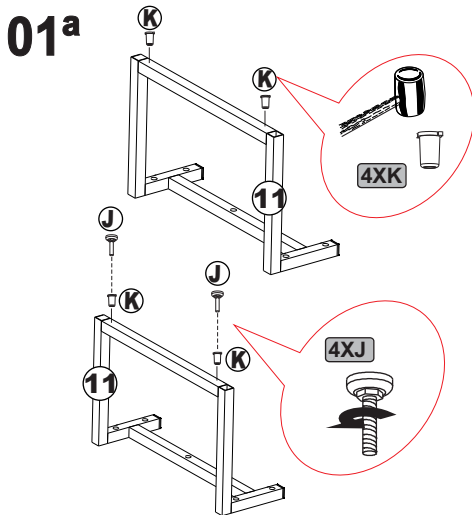

03^a

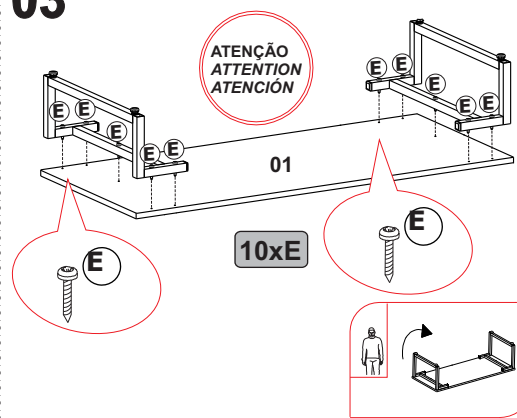

04^a

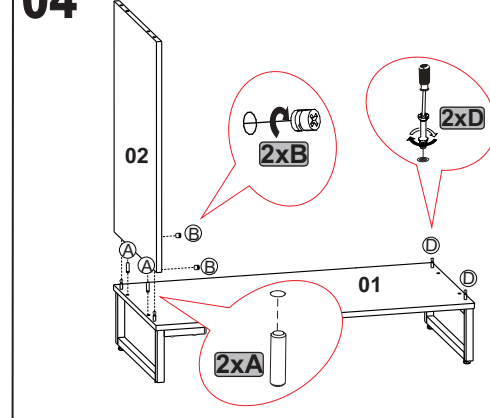

05^a

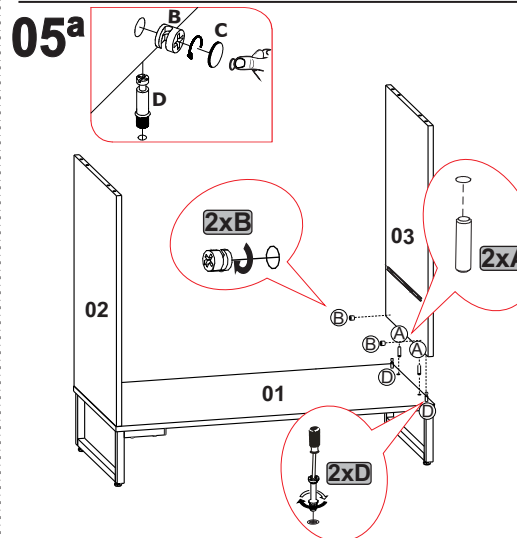

06^a

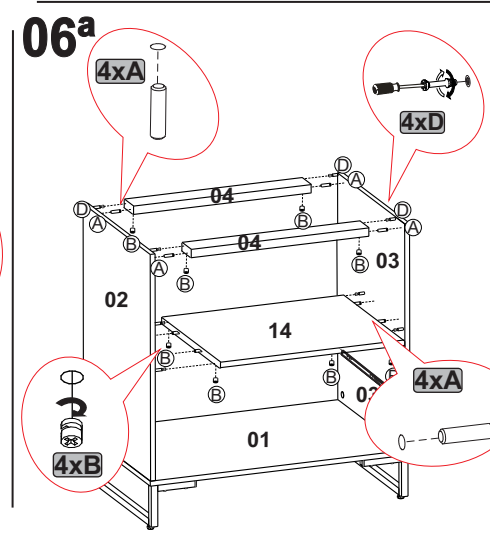

07^a

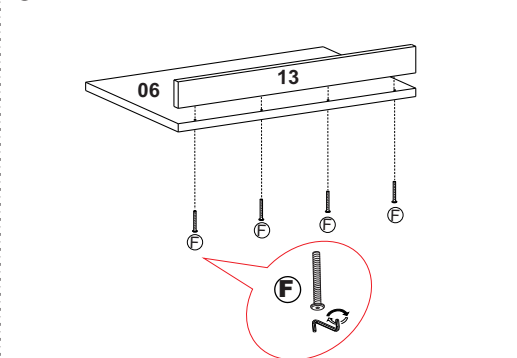

08^a

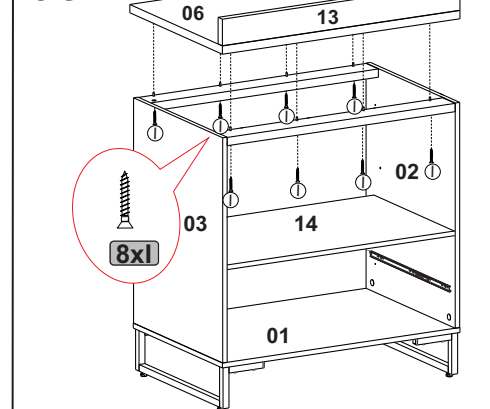

Utilizar a Chave Allen para fixação dos parafusos
Use the Allen Key to fix the screws
Utilice la llave Allen para fijar los tornillos.

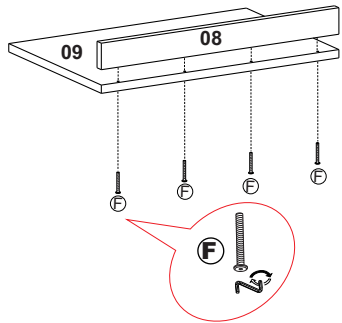
07^a

Utilizar a Chave Allen para fixação dos parafusos
Use the Allen Key to fix the screws
Utilice la llave Allen para fijar los tornillos.

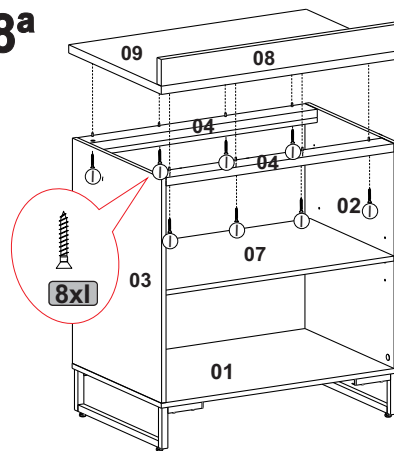
08^a

BALCÃO / COUNTER / ENCIMERA

BALCÃO COZINHA 800 C/PORTAS IRON

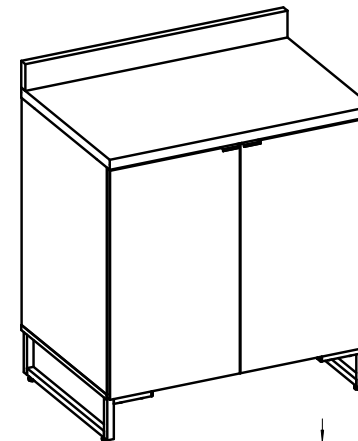
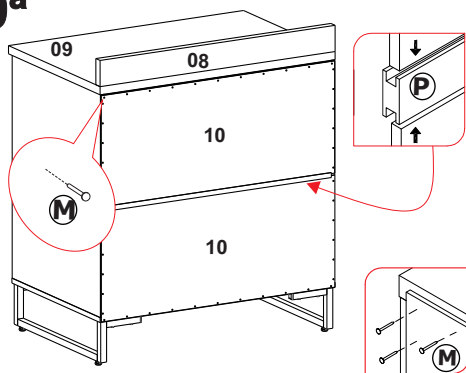
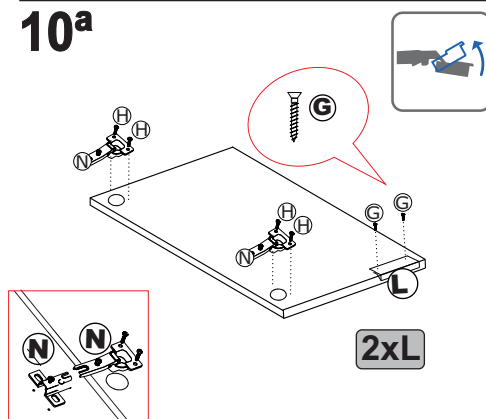
09^a10^a

Ferramentas / Tools / Herramientas



Parabéns pela aquisição de um produto de qualidade.
Em caso de dúvidas procure a loja em que efetuou a compra .
Congratulations on your purchase of a product of quality.
When in doubt look for the shop where you made the purchase.
Enhorabuena por la compra de un producto de calidad.
En caso de duda buscar la tienda donde hizo la compra.

Montador

Observe atentamente as instruções e siga rigorosamente as etapas de montagem.
Após a montagem entregue ao cliente para a garantia do produto

Assembler

Note the instructions carefully and strictly follow the assembly steps.
After assembly delivered to the customer for the product warranty

Ensamblador

tenga en cuenta las instrucciones cuidadosamente y seguir estrictamente los pasos de montaje.
Después del montaje entregado al cliente para la garantía del producto

Observações:

- Para limpeza utilize pano seco.
- Não utilize álcool ou produtos químicos tipo limpeza pesada, bem como produtos abrasivos.
- Pouca resistência à umidade.
- 3 meses de garantia legal contra eventuais defeitos de fabricação .
- Não é coberto pela garantia. Danos referentes ao mal uso do produtos.

Resistência

-40KG.

Comments:

- For cleaning only dry cloth.
- Do not use alcohol or heavy-duty cleaning chemicals as well as abrasive products.
- Low resistance to humidity

Warranty

- 3 months of legal warranty against any manufacturing defects.
It is not covered by warranty . Damages for the use of the product .

Resistance

-40kg

Observaciones:

- Para La limpieza paño seco.
- No utilice alcohol ni productos químicos como la limpieza pesada y productos abrasivos
- Poca resistencia a la humedad lo hará

Garantía

- 3 meses de garantía legal contra cualquier defecto de fabricación .
No está cubierto por la garantía . Los daños para el uso del producto.

Resistencia

-40kg

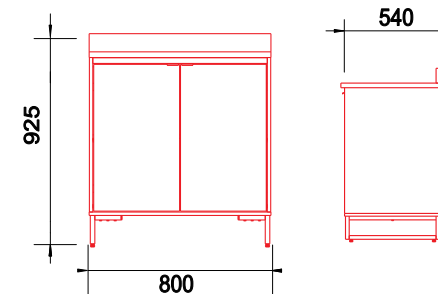
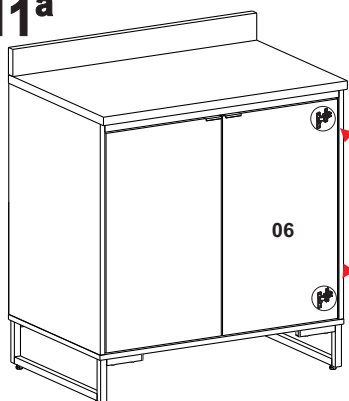
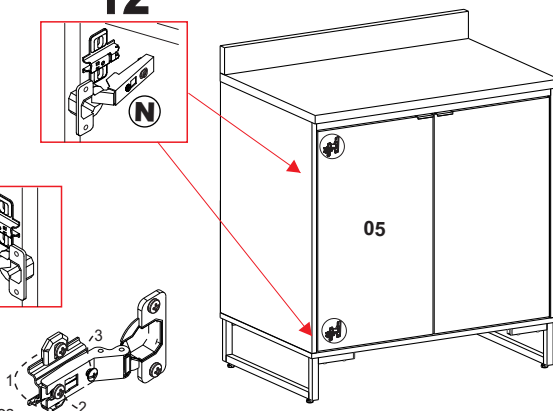
11^a12^a





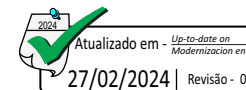









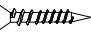

Para regulagem das portas siga as instruções conforme numeros

- 1 - Se precisar subir ou abaixar um pouco a porta desaperte um pouco os parafusos indicados com o número 1, reposicione e aperte novamente.
- 2 - Se precisar empurrar a porta um pouco mais para dentro ou puxá-la para fora, desaperte um pouco o parafuso indicado com o nº 2, reposicione
- 3 - Se precisar alinhar as portas um pouco mais para o centro ou em direção as laterais, utilize uma chave philips para girar o parafuso indicado com o nº 3 até posicionar a porta da forma desejada.



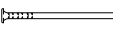

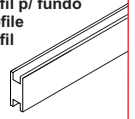







Montagem / Assembly / Montaje

Accesórios / Accessories / Accesorios

A Cavilha 8 x 30 Pin 8 x 30 Clavija 8 x 30  08	B Castanha Girofix Brow Girofix Castaño Girofix  08	C Tapa Furo Tap Role Tap del Agujero  08	D Girofix c/ Soberba Girofix Whit Superb Girofix Con Soberbia  08	E Parafuso CH PH SB 4,8 X 32 Screw Tornillo  10	F Parafuso AL INT SB 7,0x60 Screw Tornillo  04
G Parafuso CH PH SB 3,5 X 14 Screw Tornillo  04	H Parafuso CH PH SB 3,5 X 16 Screw Tornillo  16	I Parafuso CH PH SB 4,0 X 35 Screw Tornillo  08	J Sapata c/ rosca Threaded shoe Zapato roscado  04	K Bucha p/ Sapata Shoe Bushing Buje para zapato  04	L Puxador Clean Puller Arrancador  02
M Pregão Nail Clavo  40	N Dobradiça super curva 35mm Straight mug curve 35mm Bisagra curva 35mm  04	O Suporte Prateleira Shelf support Soporte de estante  04	P Perfil p/ fundo Profile Perfil  01	Q Chave Allen Allen key Allen  01	

Peças / Parts / Partes

01 Base  01	02 Lateral Esquerda Left Side Lado izquierdo  01	03 Lateral Direita Right Side Lado Derecho  01	04 Traveza Frontal e Traseira front and rear cross member travesaño delantero y trasero  02	05 Porta esquerda left door puerta izquierda  01	06 Porta direita Right door Puerta derecha  01
07 Prateleira Móvel Mobile shelf Estante Móvil  01	08 Vista Frontal Front view Vista frontal  01	09 Tampo Top Tapa  01	10 Fundo do Móvel Background Fondo de muebles  02	11 Rodapé Metálico Metallic plinth Zócalo metálico  02	

Utilizar a régua abaixo para medir os componentes.

Medidas em mm

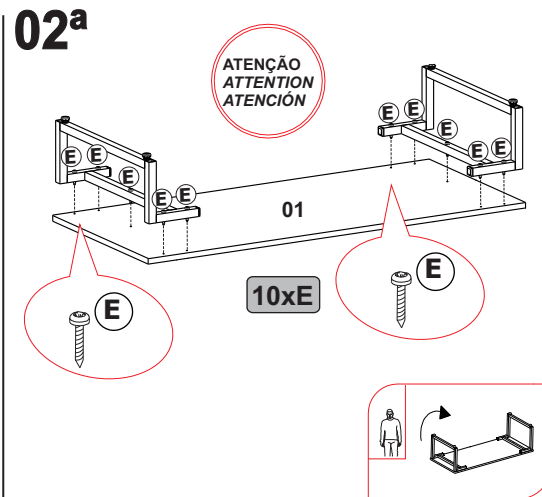
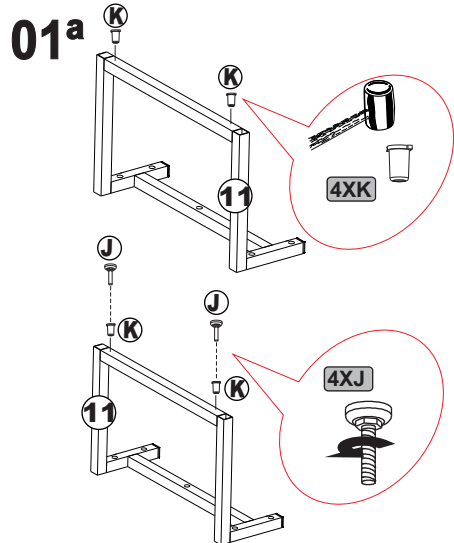

03^a

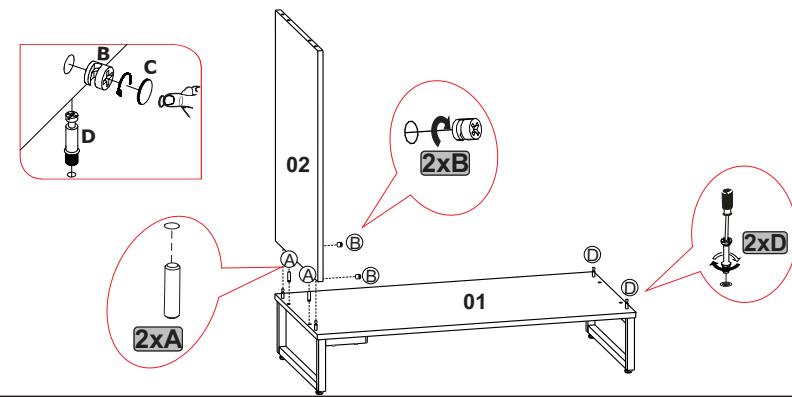

04^a

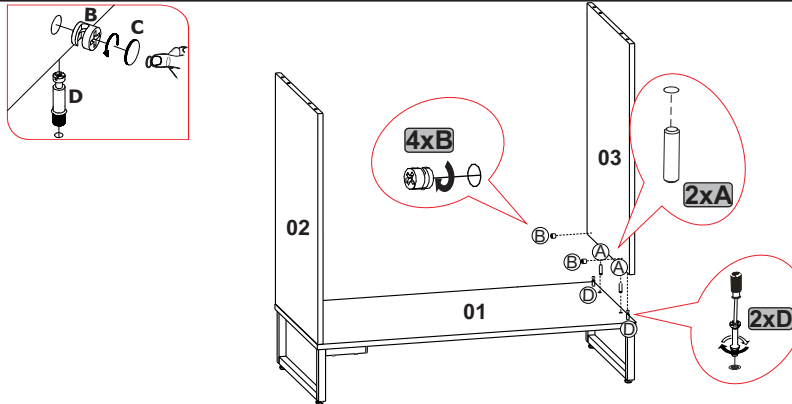

05^a

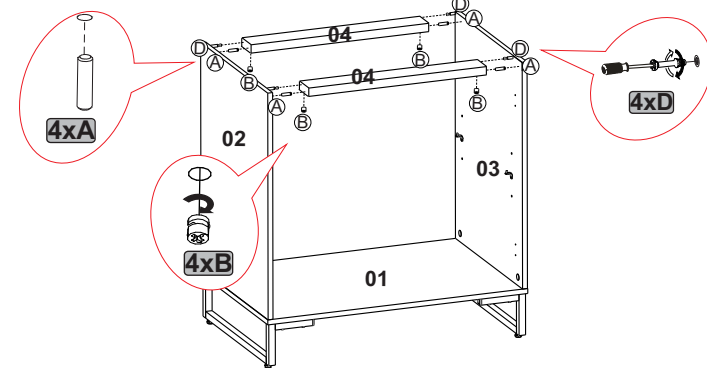

06^a

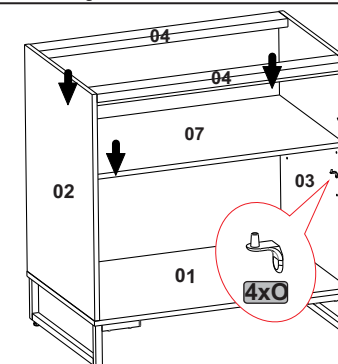

04^a

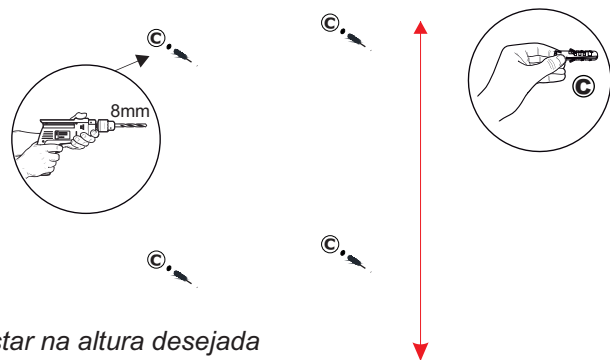

Ajustar na altura desejada
Adjust to desired height
Ajustar a la altura deseada

NICHO / NICHE / NICHO

NICHO IRON 800/1200 SEM PORTAS

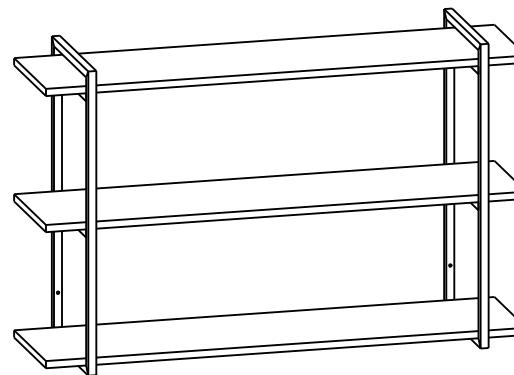

Parabéns pela aquisição de um produto de qualidade.
Em caso de dúvidas procure a loja em que efetuou a compra .
Congratulations on your purchase of a product of quality.
When in doubt look for the shop where you made the purchase.
Enhorabuena por la compra de un producto de calidad.
En caso de duda buscar la tienda donde hizo la compra.

Montador
Observe atentamente as instruções e siga rigorosamente as etapas de montagem.
Após a montagem entregue ao cliente para a garantia do produto

Assembler
Note the instructions carefully and strictly follow the assembly steps.
After assembly delivered to the customer for the product warranty

Ensamblador
tenga en cuenta las instrucciones cuidadosamente y seguir estrictamente los pasos de montaje.
Después del montaje entregado al cliente para la garantía del producto

Observações:
-Para limpeza utilize pano seco.
Não utilize álcool ou produtos químicos tipo limpeza pesada, bem como produtos abrasivos.
-Pouca resistência à umidade.
- 3 meses de garantia legal contra eventuais defeitos de fabricação .
Não é coberto pela garantia. Danos referentes ao mal uso do produtos.

Resistência
-40KG.

Comments:
-For cleaning only dry cloth.
Do not use alcohol or heavy-duty cleaning chemicals as well as abrasive products.
-Low resistance to humidity

Warranty
- 3 months of legal warranty against any manufacturing defects.
It is not covered by warranty . Damages for the use of the product .

Resistance
-40kg

Observaciones:
-Para La limpieza paño seco.
No utilice alcohol ni productos químicos como la limpieza pesada y productos abrasivos
-Poca resistencia a la humedad lo hará

Garantía
- 3 meses de garantía legal contra cualquier defecto de fabricación .
No está cubierto por la garantía . Los daños para el uso del producto.

Resistencia
-40kg

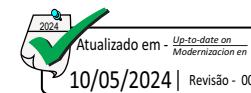

10/05/2024 | Revisão - 00

05^a

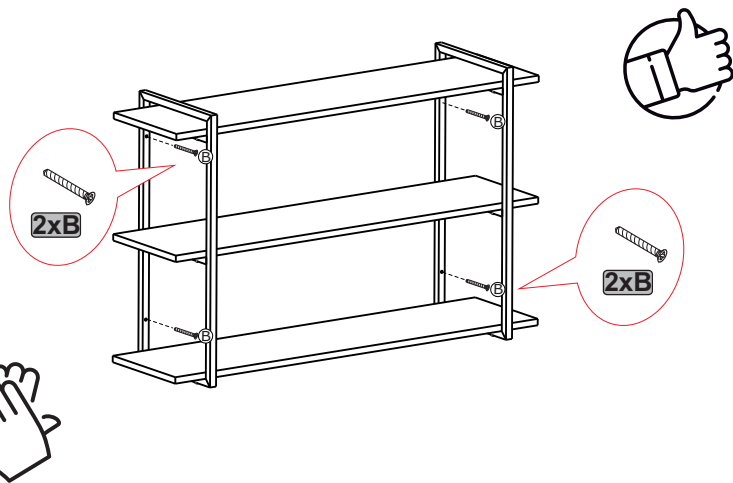

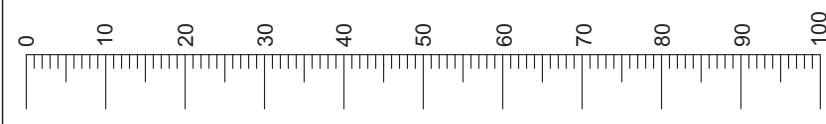

Utilizar a régua abaixo para medir os componentes.

Medidas em mm





Montagem / Assembly / Montaje

Accessories / Accessories / Accesorios

- | | | |
|--|---|--|
| A Parafuso
PA PH MQ M6X30
Screw
Tornillo
12  | B Parafuso
PA PH SB 5,0 X 60
Screw
Tornillo
04  | C Bucha
Anchor
Tarugo
04  |
|--|---|--|

Peças / Parts / Partes

- | | |
|---|--|
| 01 Prateleira fixa
Fixed shelf
Estante fijo
03  | 02 Estrutura
Structure
Estructura
02  |
|---|--|

Ferramentas / Tools / Herramientas

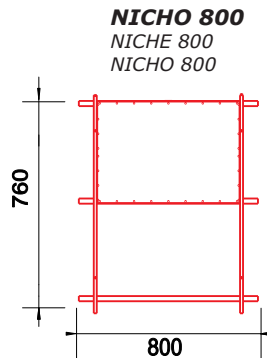
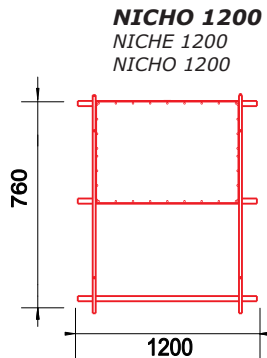
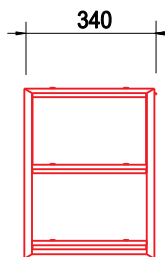
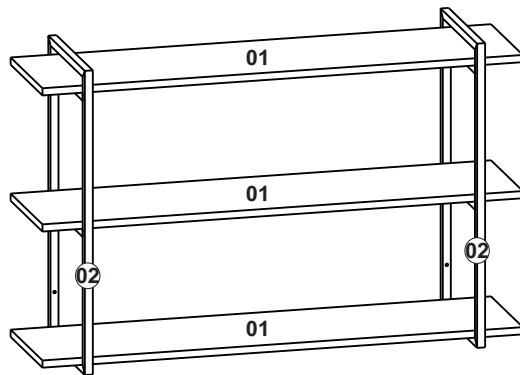

01^a

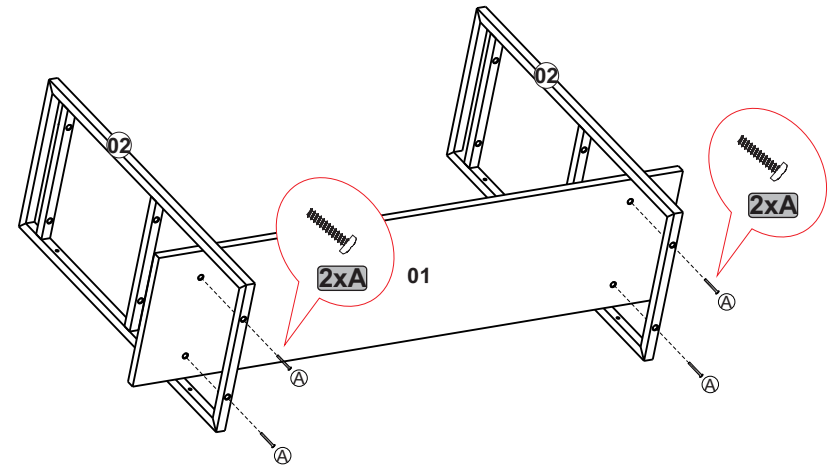

02^a

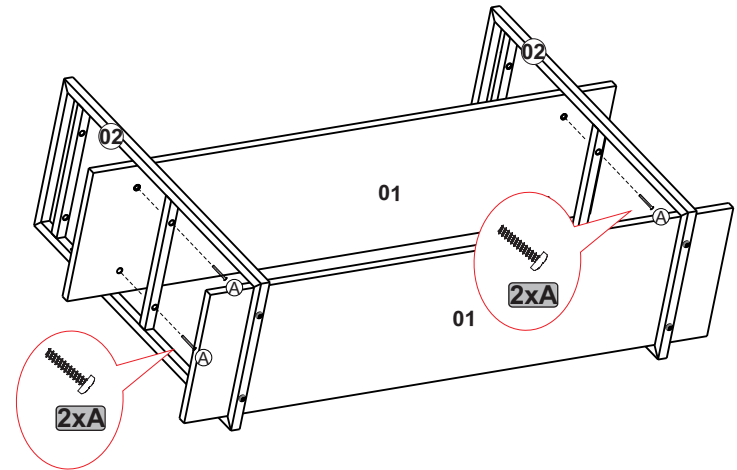

03^a

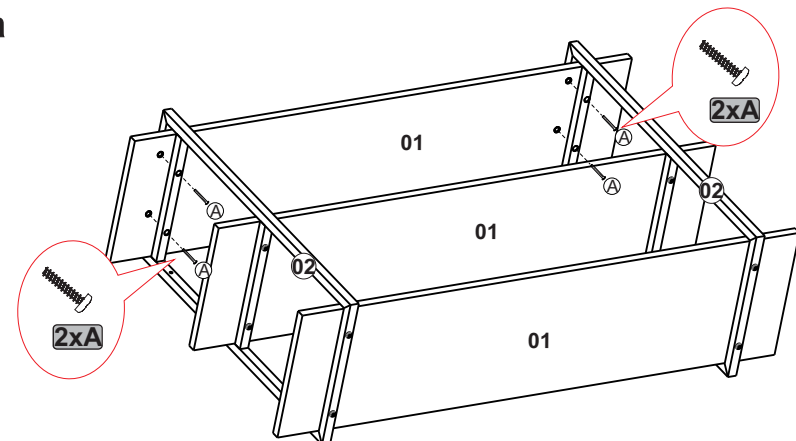

03^a

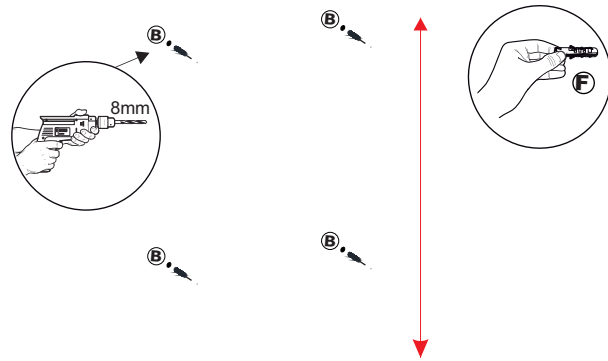

Ajustar na altura desejada
Adjust to desired height
Ajustar a la altura deseada

04^a

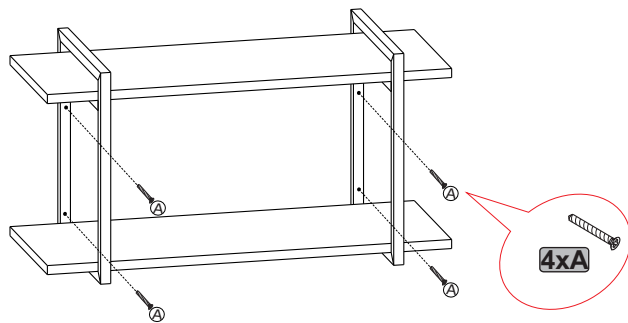

NICHO / NICHE / NICHO

NICHO 800 SEM PORTAS

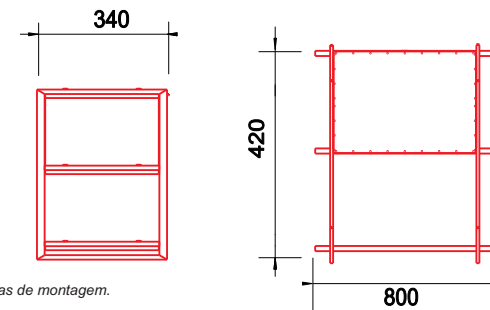
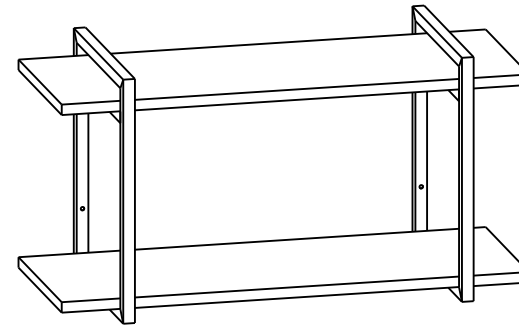

Parabéns pela aquisição de um produto de qualidade.
Em caso de dúvidas procure a loja em que efetuou a compra .
Congratulations on your purchase of a product of quality.
When in doubt look for the shop where you made the purchase.
Enhorabuena por la compra de un producto de calidad.
En caso de duda buscar la tienda donde hizo la compra.

Montador
Observe atentamente as instruções e siga rigorosamente as etapas de montagem.
Após a montagem entregue ao cliente para a garantia do produto

Assembler
Note the instructions carefully and strictly follow the assembly steps.
After assembly delivered to the customer for the product warranty

Ensamblador
tenga en cuenta las instrucciones cuidadosamente y seguir estrictamente los pasos de montaje.
Después del montaje entregado al cliente para la garantía del producto

Observações:
-Para limpeza utilize pano seco.
Não utilize álcool ou produtos químicos tipo limpeza pesada, bem como produtos abrasivos.
-Pouca resistência à umidade.
- 3 meses de garantia legal contra eventuais defeitos de fabricação .
Não é coberto pela garantia. Danos referentes ao mal uso do produtos.

Resistência
-40KG.

Comments:
-For cleaning only dry cloth.
Do not use alcohol or heavy-duty cleaning chemicals as well as abrasive products.
-Low resistance to humidity

Warranty
- 3 months of legal warranty against any manufacturing defects.
It is not covered by warranty . Damages for the use of the product .

Resistance
-40kg

Observaciones:
-Para La limpieza paño seco.
No utilice alcohol ni productos químicos como la limpieza pesada y productos abrasivos
-Poca resistencia a la humedad lo hará

Garantía
- 3 meses de garantía legal contra cualquier defecto de fabricación .
No está cubierto por la garantía . Los daños para el uso del producto.

Resistencia
-40kg

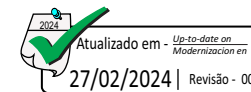

Montagem / Assembly / Montaje

Acessórios / Accessories / Accesorios

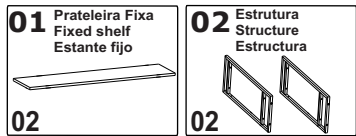
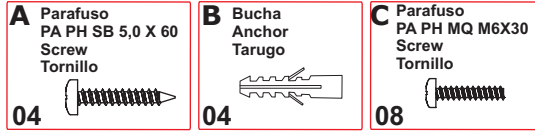

Ferramentas / Tools / Herramientas

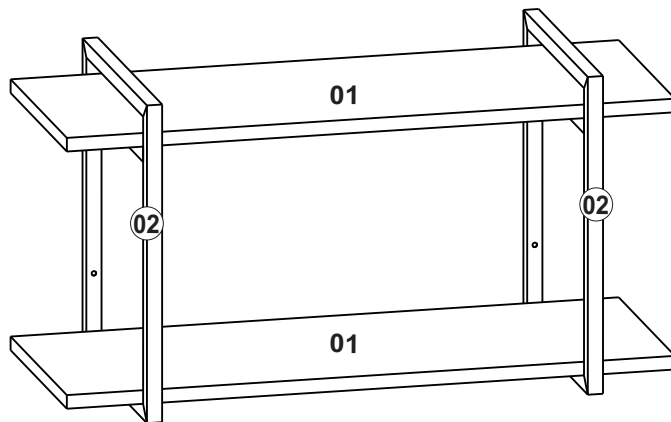

01^a

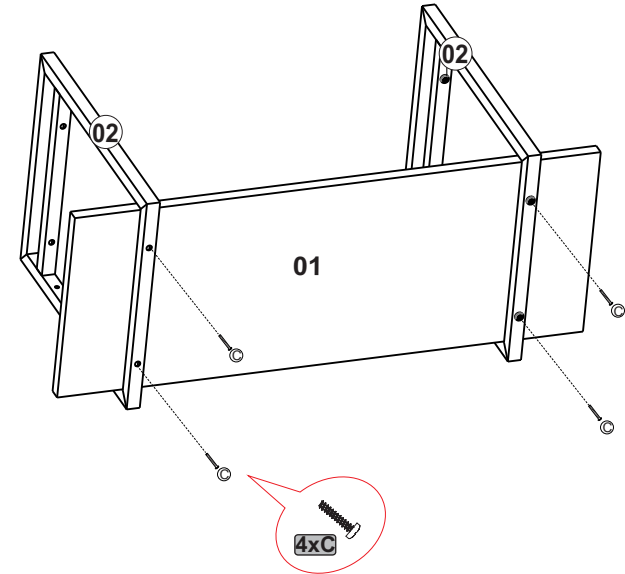

02^a

