

# IMCAL

## *Rack Studio 2.2*

*Rack Studio 2.2*  
*Estudio en rack 2.2*

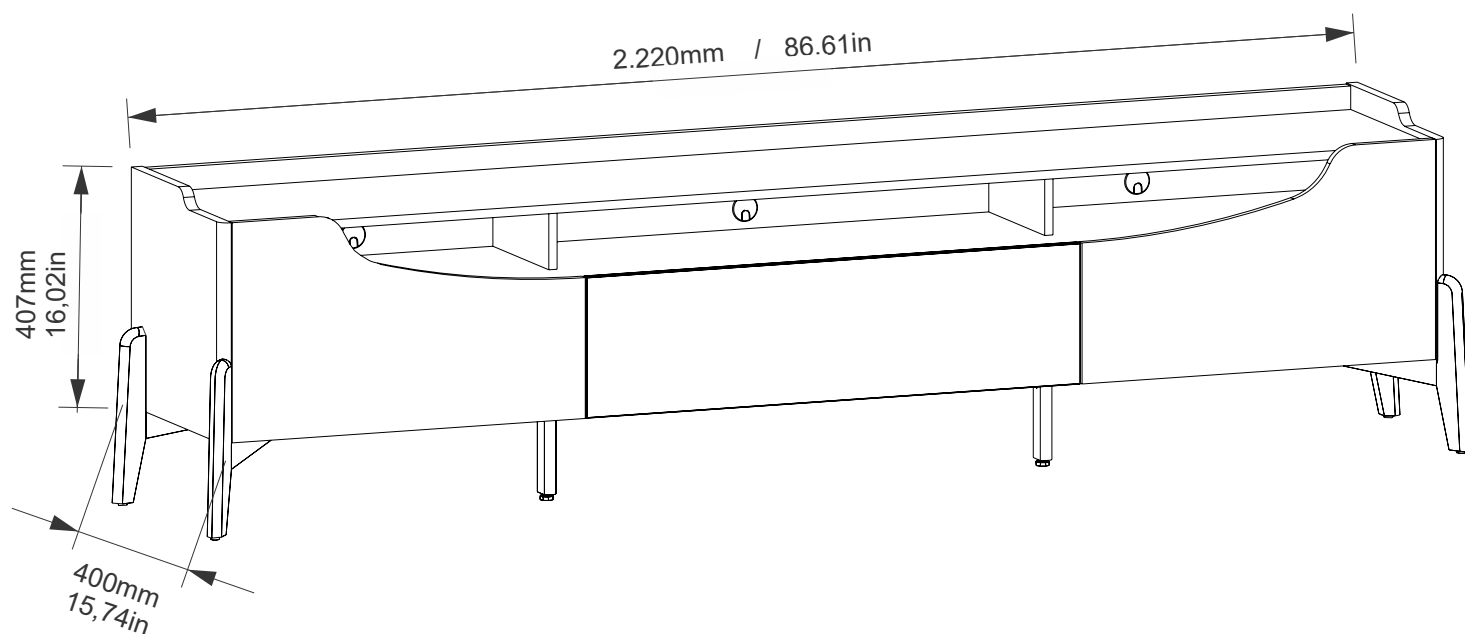

# ACESSÓRIOS

PIECES - PIEZAS

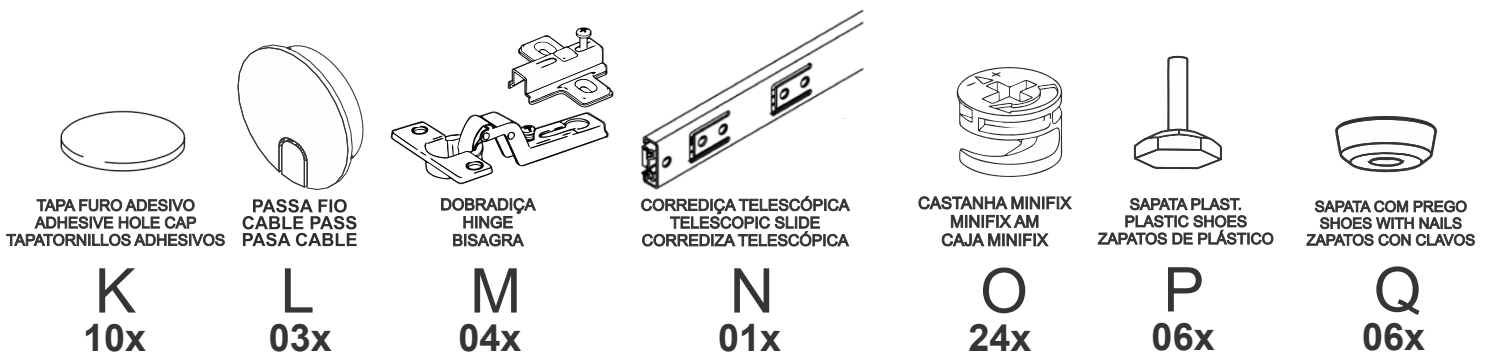
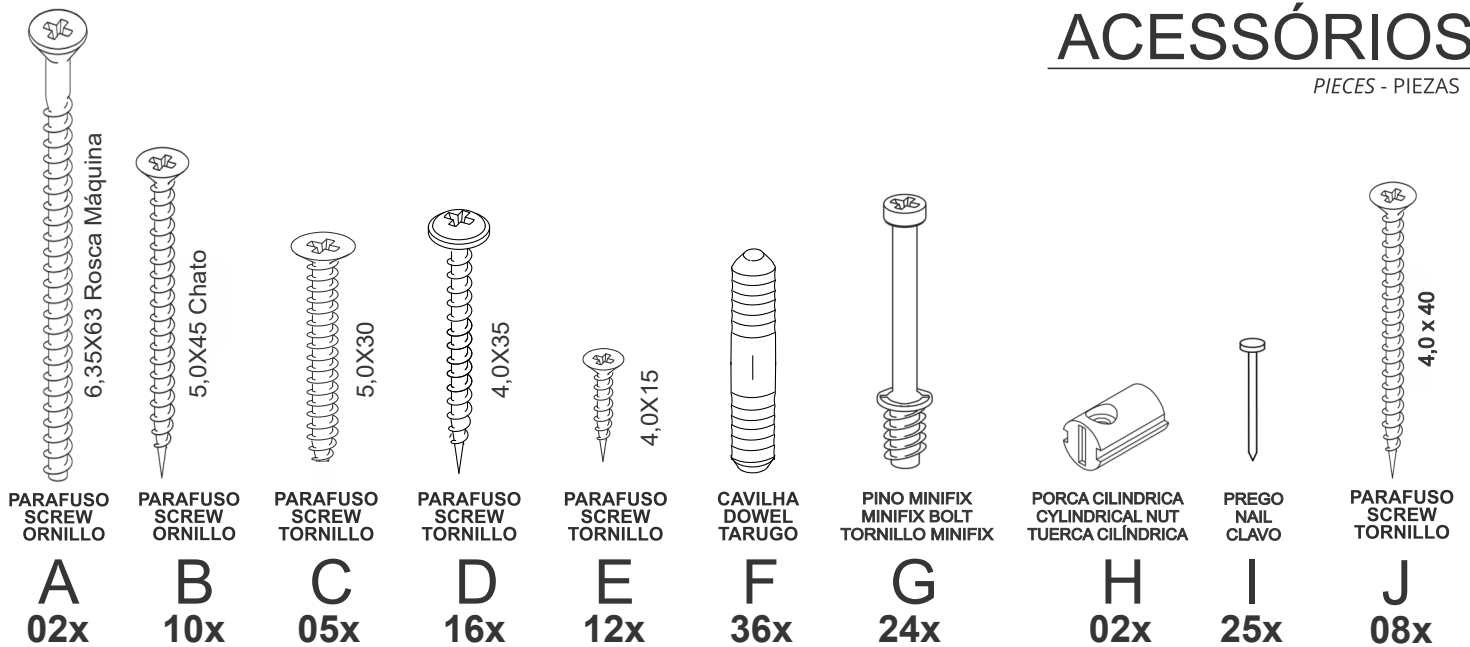

## CAPACIDADE DE CARGA

LOAD CAPACITY - CAPACIDAD DE CARGA

A CAPACIDADE DE CARGA INDICADA É DISTRIBUÍDA NAS ÁREAS DEMONSTRADAS.

THE INDICATED LOAD CAPACITY IS DISTRIBUTED IN THE SHOWN AREAS.

LA CAPACIDAD DE CARGA INDICADA ES DISTRIBUIDA EN ZONAS DEMONSTRADAS.

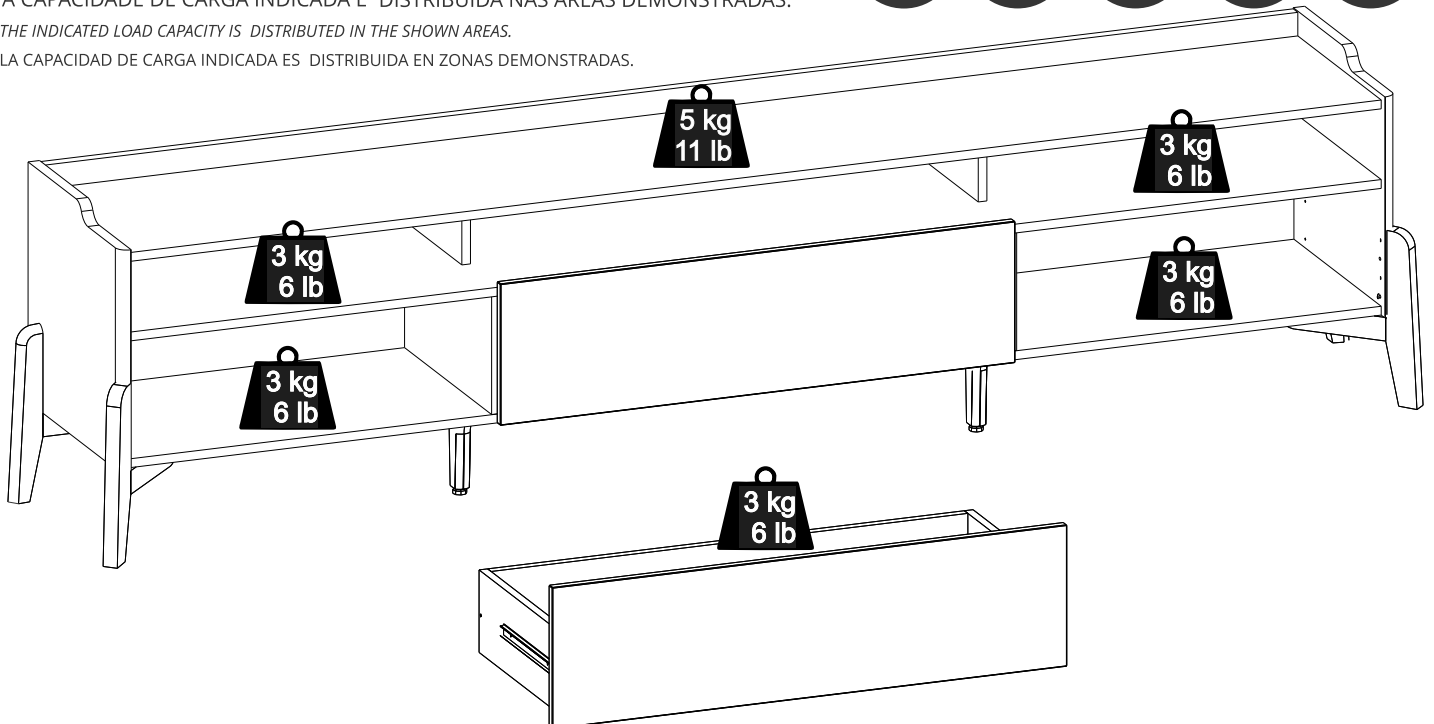

## CONSERVANDO O SEU MÓVEL / MANTENIENDO SU MOBILIARIO / MAINTAINING YOUR FURNITURE

### LIMPEZA DO MÓVEL / LIMPIANDO SU MOBILIARIO / CLEANING

Na remoção da poeira utilizar flanela limpa e levemente umedecida, em seguida flanela seca para remoção da umidade.

Para limpiar el polvo utiliza una flanela limpia y humedecida y después una flanela seca para quitar la humedad.

To remove dust use a clean flannel slightly moistened and afterwards a dry flannel to remove the humidity.

### RECOMENDAÇÕES DE USO / RECOMENDACIONES DE USO / USE RECOMMENDATIONS

Não expor a luz solar e locais úmidos.

No exponga a la luz solar y lugares húmedos.

Do not expose to sun light and humid places.

Não encostar o móvel na parede para evitar transmissão de umidade.

No apoye el mobiliario en la pared evitar la transmisión de humedad.

Do not lean the furniture in the wall to avoid humidity transmission.

## PORTUGUÊS

## INGLÊS

## ESPAÑHOL

1	PÉ FRONTAL	1	FRONT FOOT	1	PIE DELANTERO
2	PÉ TRASEIRO	2	BACK FOOT	2	PIE TRASERO
3	PÉ CENTRAL	3	CENTER FOOT	3	PIE CENTRAL
4	BASE INFERIOR	4	LOWER BASE	4	BASE INFERIOR
5	LATERAL ESQUERDA	5	LEFT SIDE	5	LADO IZQUIERDO
6	DIVISÓRIA INFERIOR ESQ.	6	LOWER LEFT PARTITION	6	PARTICIÓN INFERIOR IZQUIERDA
7	DIVISÓRIA INFERIOR DIR.	7	LOWER RIGHT PARTITION	7	PARTICIÓN INFERIOR DERECHA
8	LATERAL DIREITA	8	RIGHT SIDE	8	LADO DERECHO
9	TAMPO INTERMEDIÁRIO	9	INTERMEDIATE TOP	9	SUPERIOR INTERMEDIO
10	DIVISÓRIA SUPERIOR	10	UPPER PARTITION	10	PARTICIÓN SUPERIOR
11	TAMPO	11	COVER	11	CUBRIR
12	RÉGUA MOLDURA	12	FRAME RULER	12	REGLA DEL MARCO
13	PORTA ESQUERDA	13	LEFT DOOR	13	PUERTA IZQUIERDA
14	PORTA DIREITA	14	RIGHT DOOR	14	PUERTA DERECHA
15	FRENTE DA GAVETA	15	DRAWER FRONT	15	FRENTE DEL CAJÓN
16	LATERAL GAVETA ESQ.	16	SIDE DRAWER LEFT	16	CAJÓN LATERAL IZQUIERDO
17	LATERAL GAV. DIREITA	17	SIDE GAV. RIGHT	17	LATERAL GAV. BIEN
18	CONTRA FUNDO	18	BACKGROUND	18	FONDO
F1	FUNDO TRASEIRO	F1	BACK BOTTOM	F1	ATRÁS ABAJO
F2	FUNDO GAVETA	F2	DRAWER BOTTOM	F2	FONDO DEL CAJÓN

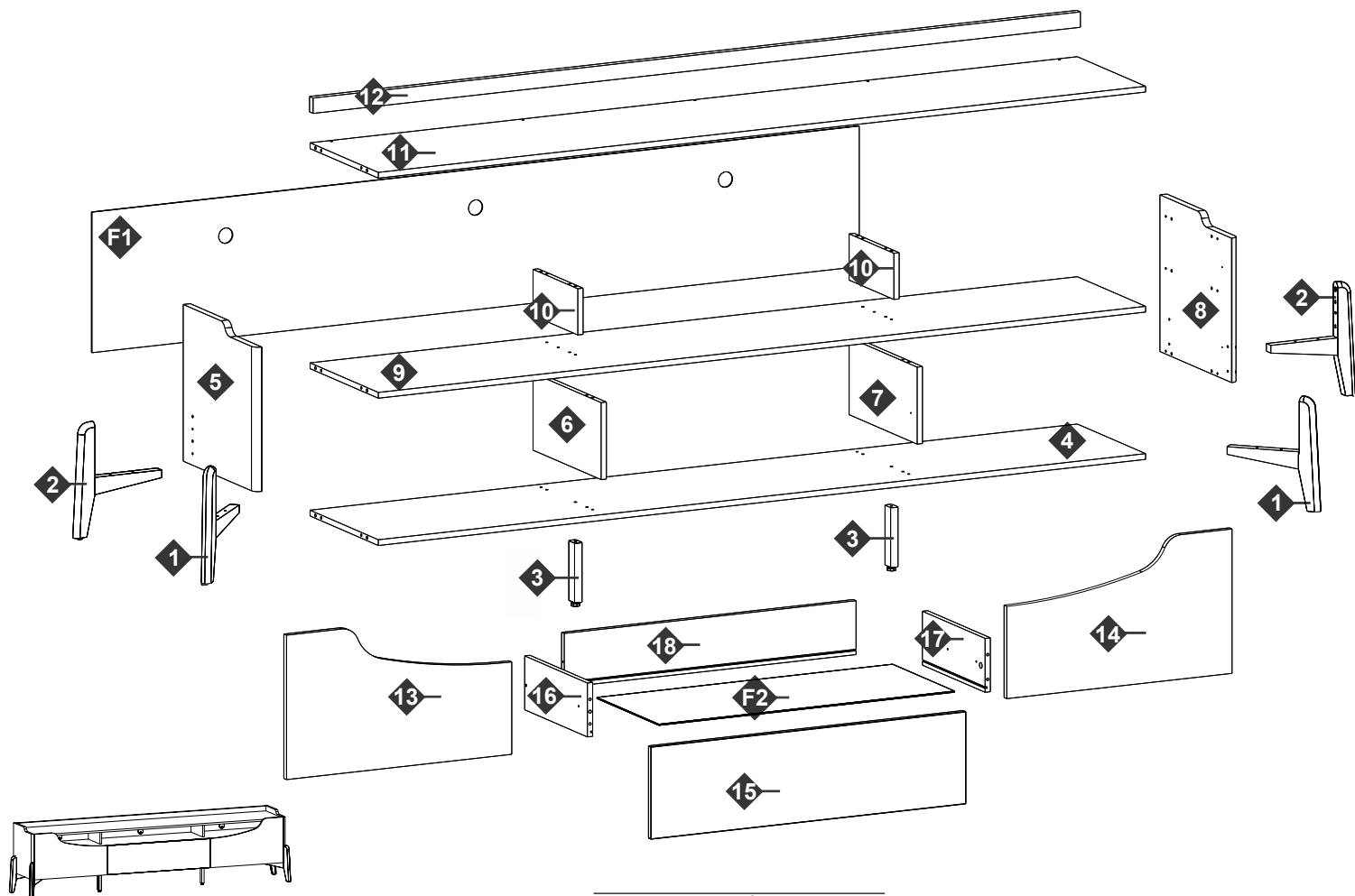

# PRÉ-MONTAGEM

PRE ASSEMBLY - PRÉ-MONTAJE

VIRAR O PRODUTO VOLTADO PARA O CHÃO, UTILIZE A EMBALAGEM PARA FORRAR O PISO E EVITAR DANOS À PINTURA.

TURN THE PRODUCT FACING THE FLOOR, USE THE PACKAGING TO COVER THE FLOOR AND PREVENT DAMAGE TO PAINT.

GIRE EL PRODUCTO HACIA EL SUELO, USE EL EMBALAJE PARA CUBRIR EL SUELO Y PREVENIR DAÑOS A LA PINTURA.

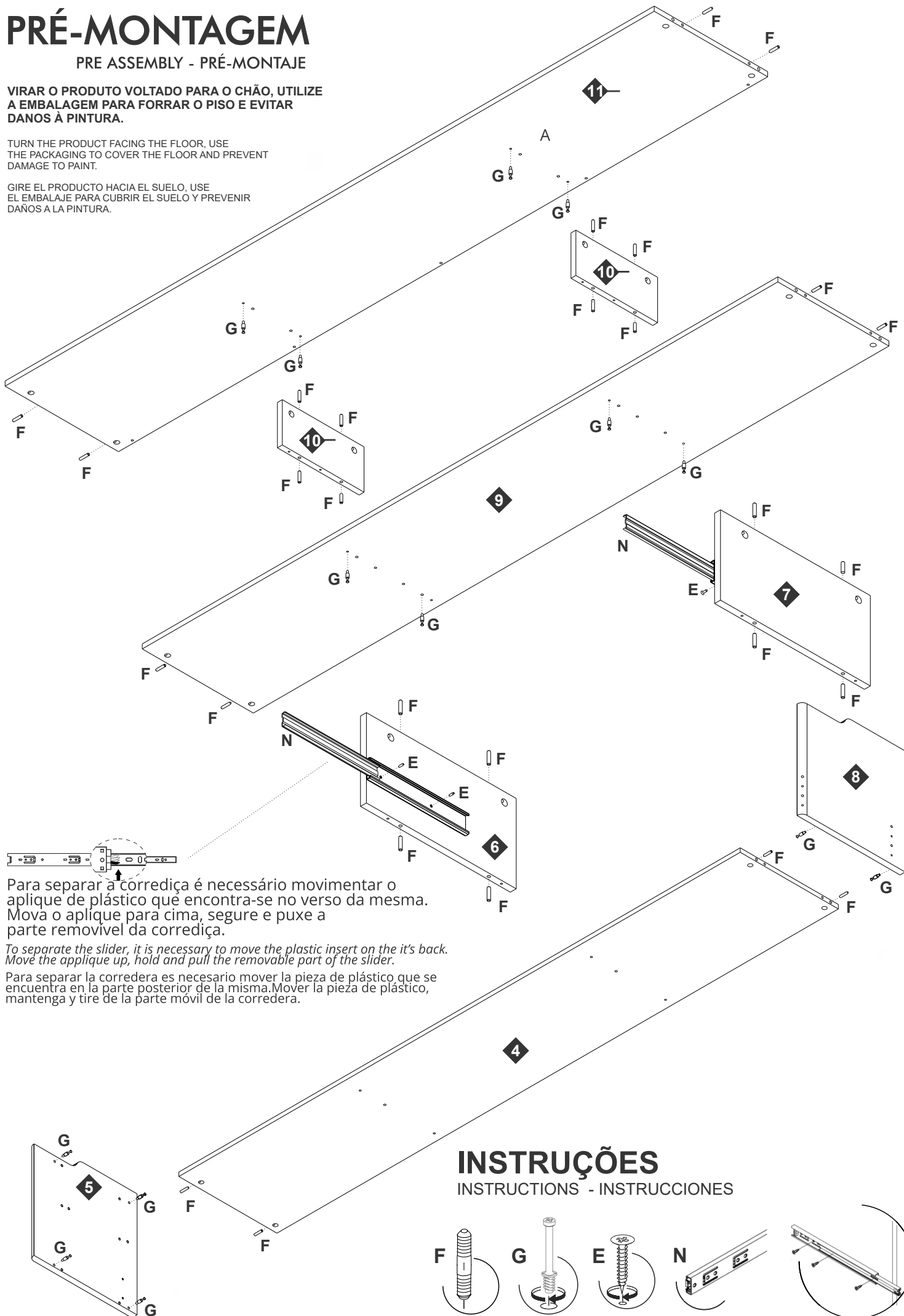

## INSTRUÇÕES

INSTRUCTIONS - INSTRUCCIONES

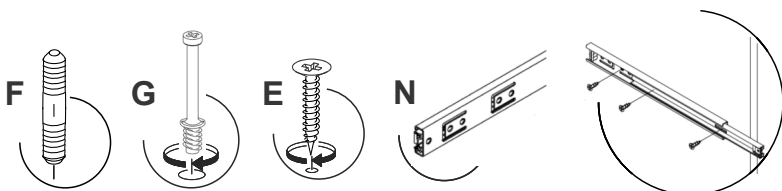

# MONTAGEM

ASSEMBLY - MONTAJE

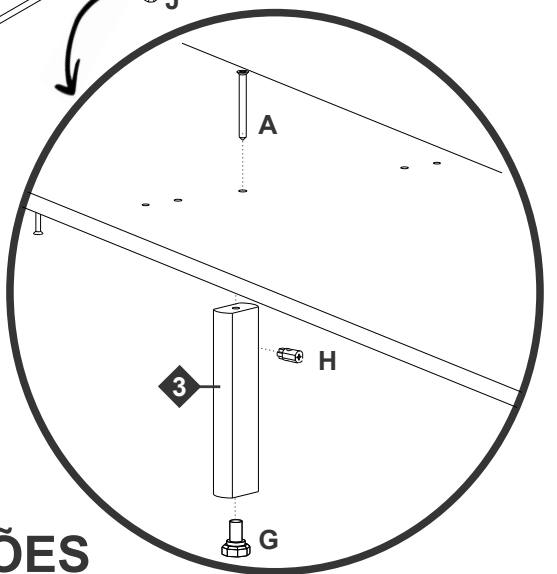
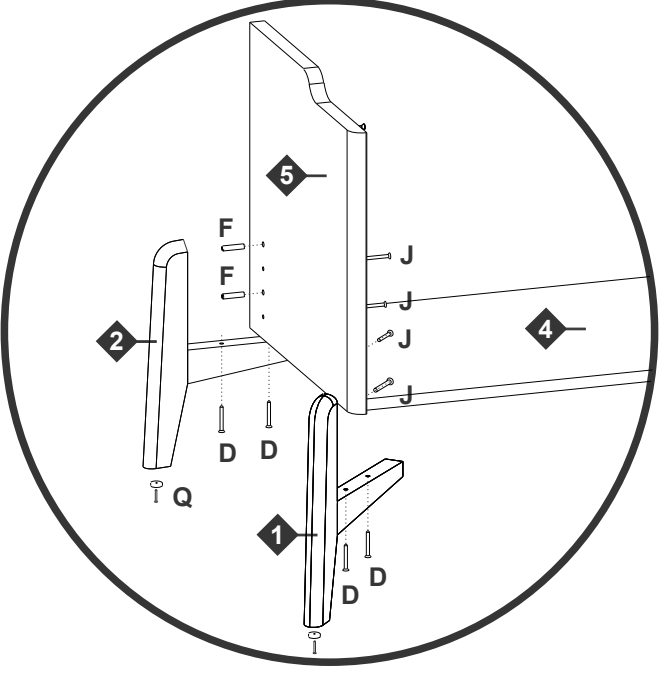
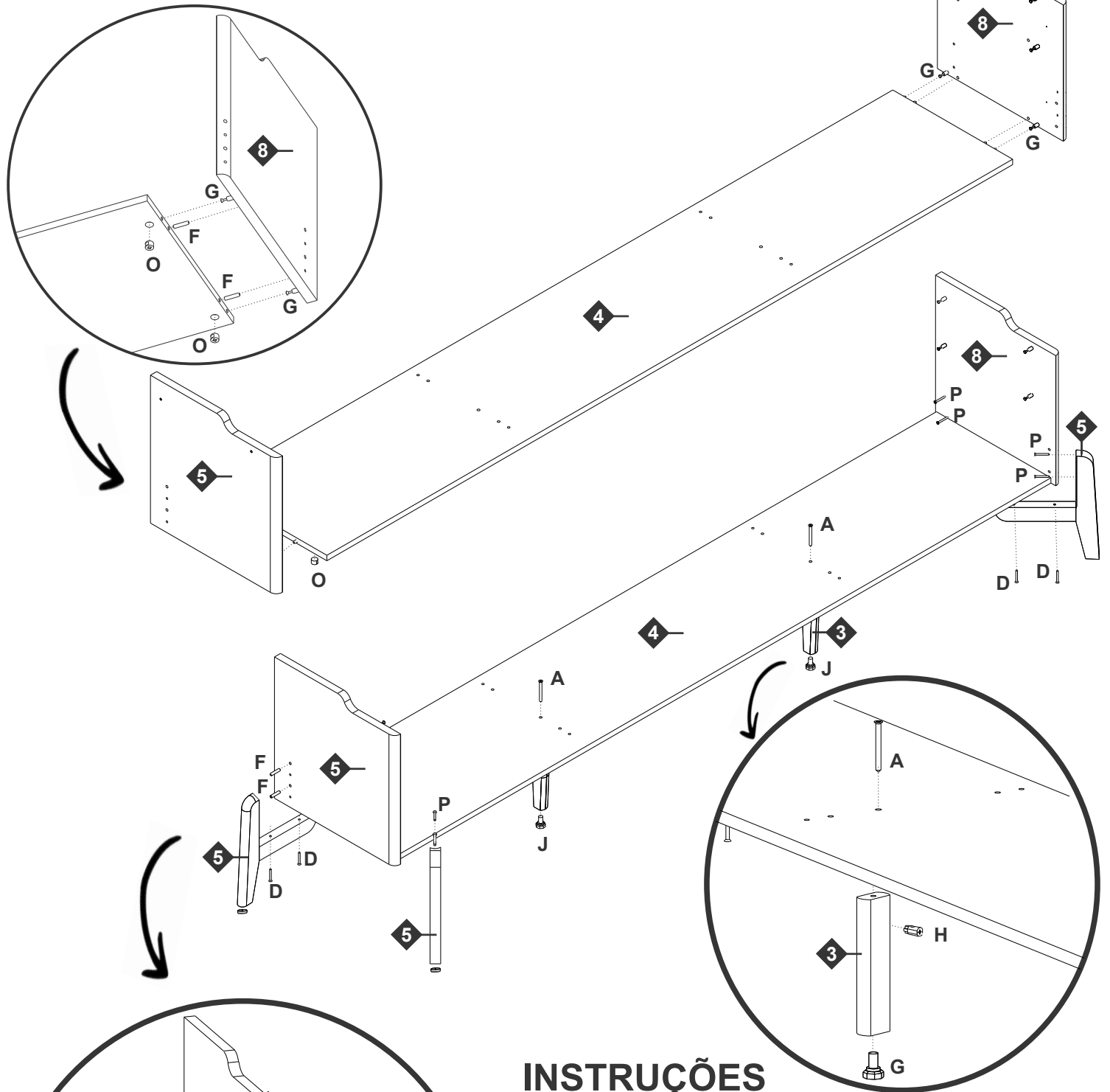

## INSTRUÇÕES

INSTRUCTIONS - INSTRUCCIONES

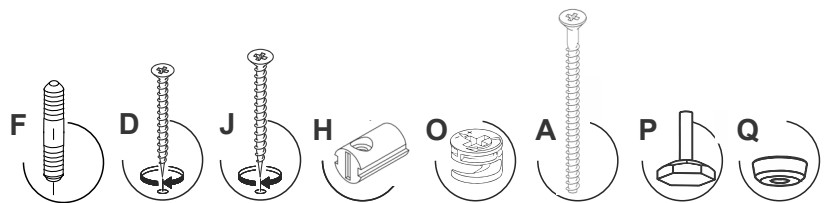

### IMPORTANTE

ATTENTION - IMPORTANTE

**A MONTAGEM DEVE SER REALIZADA POR UM PROFISSIONAL DE MONTAGEM.**

ASSEMBLY MUST BE CARRIED OUT BY AN ASSEMBLY PROFESSIONAL.  
EL MONTAJE DEBE SER REALIZADO POR UN PROFESIONAL DE MONTAJE.

# MONTAGEM

ASSEMBLY - MONTAJE

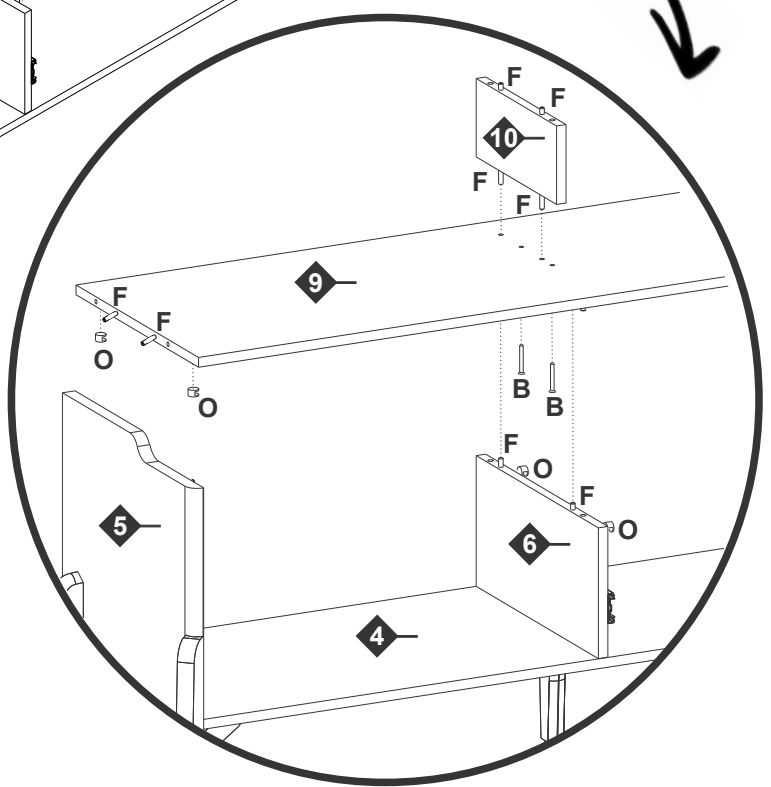
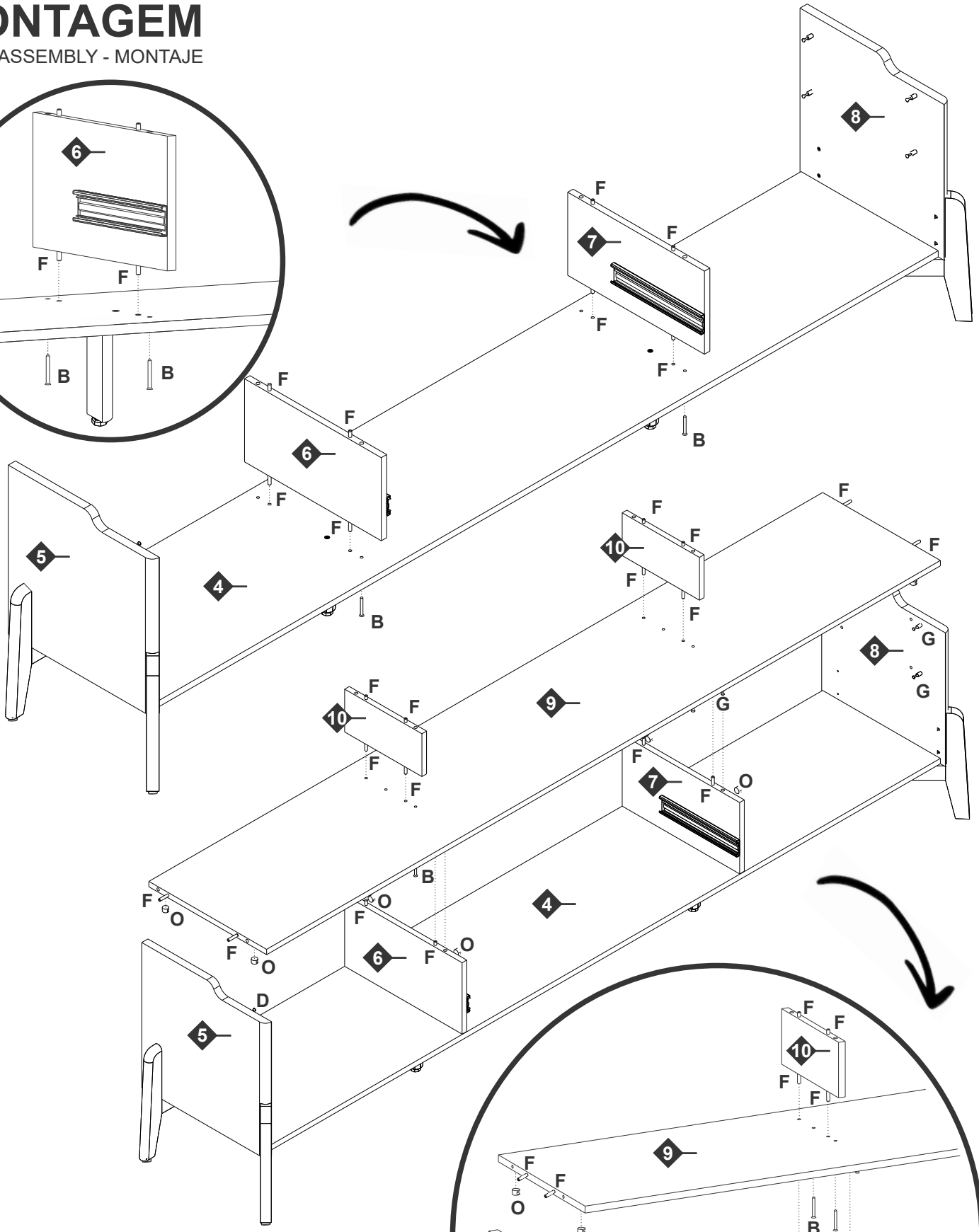
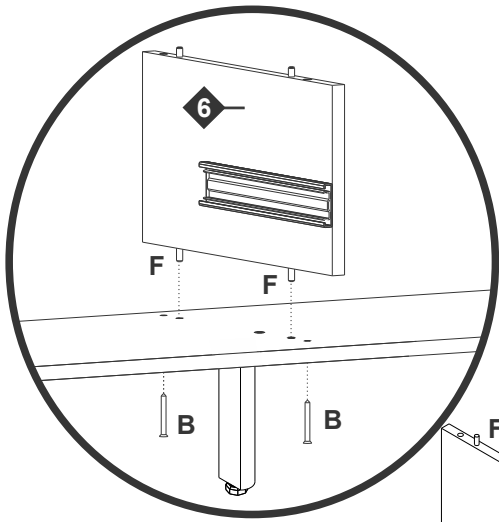

# INSTRUÇÕES

INSTRUCTIONS - INSTRUCCIONES

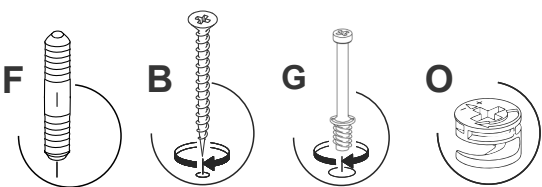

# MONTAGEM

ASSEMBLY - MONTAJE

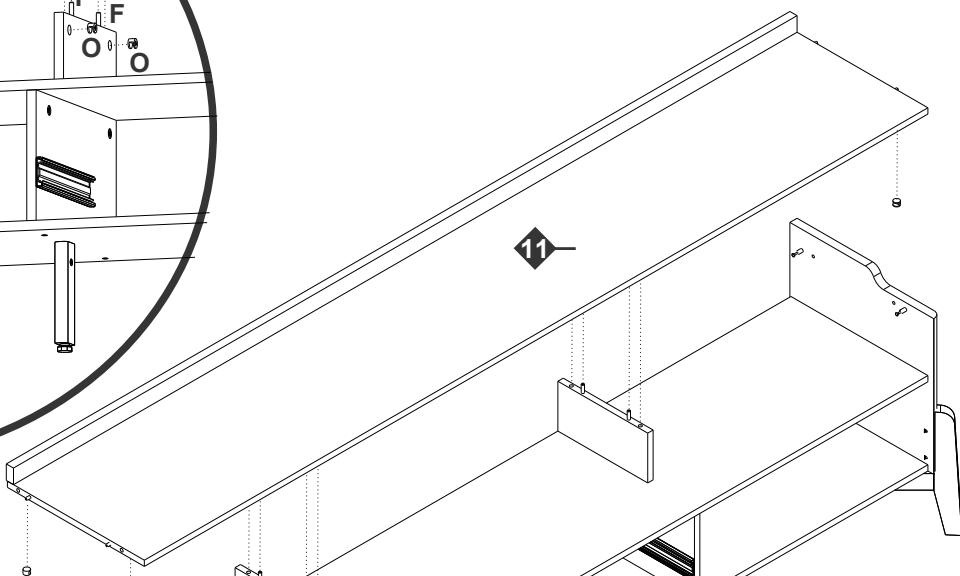
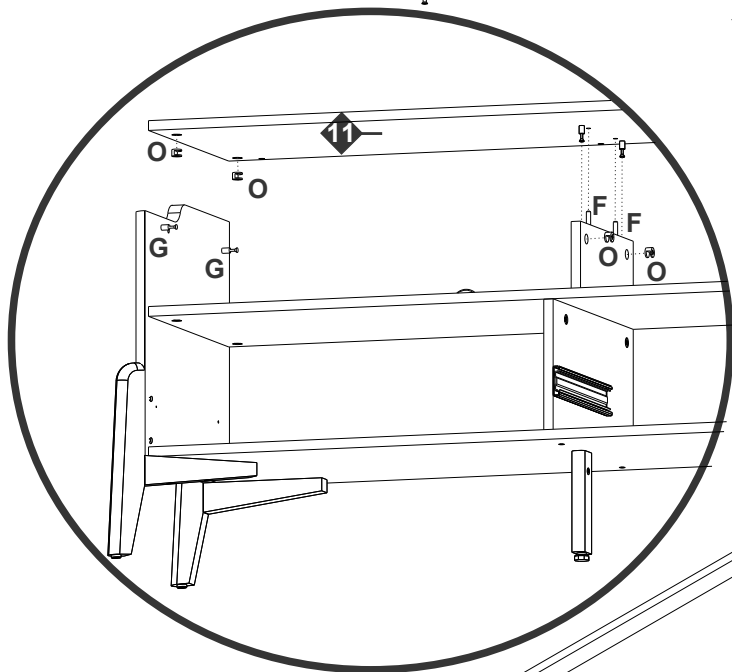
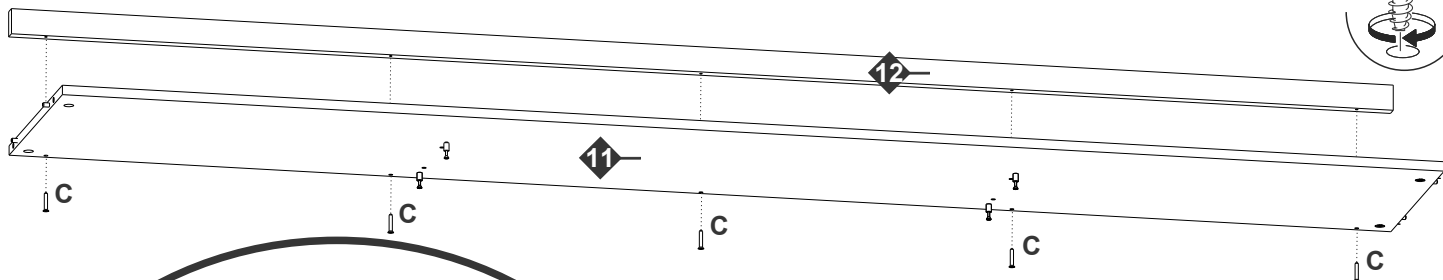
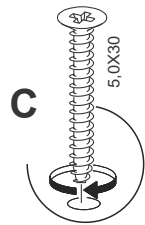

## INSTRUÇÕES

INSTRUCTIONS - INSTRUCCIONES

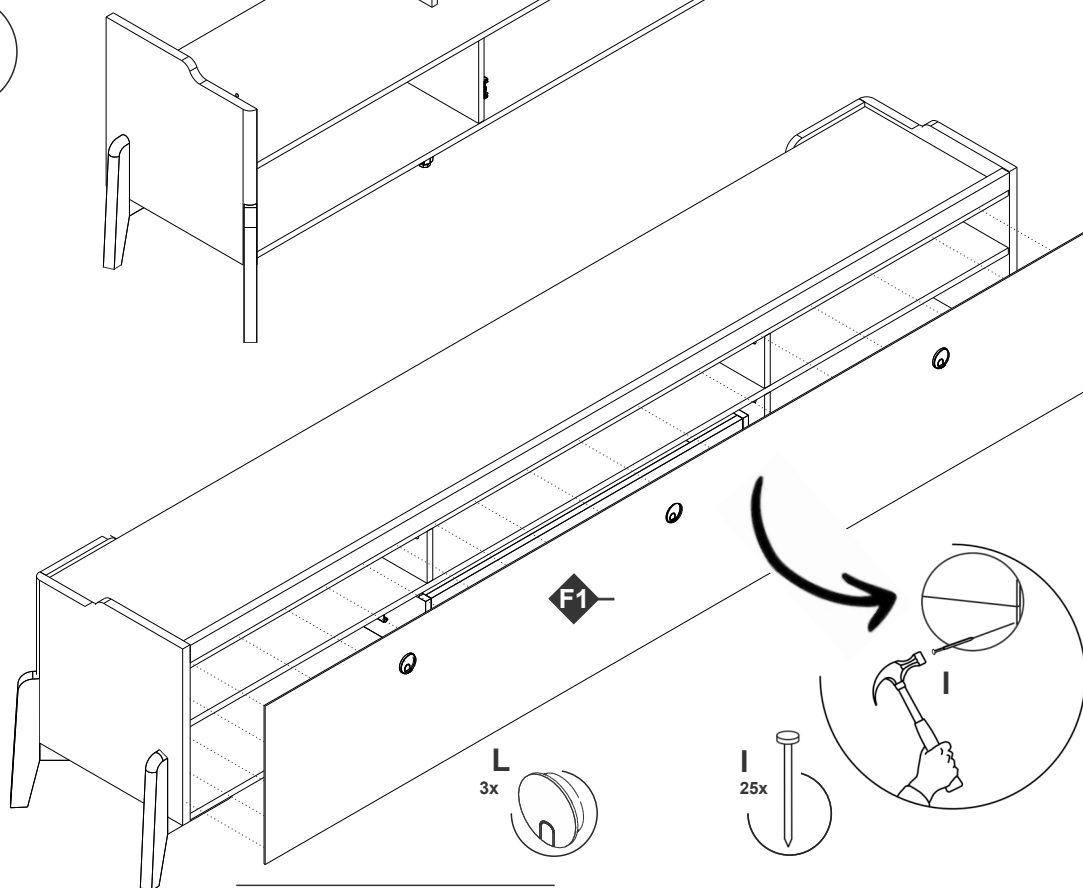
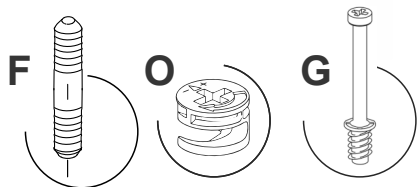

# MONTAGEM

ASSEMBLY - MONTAJE

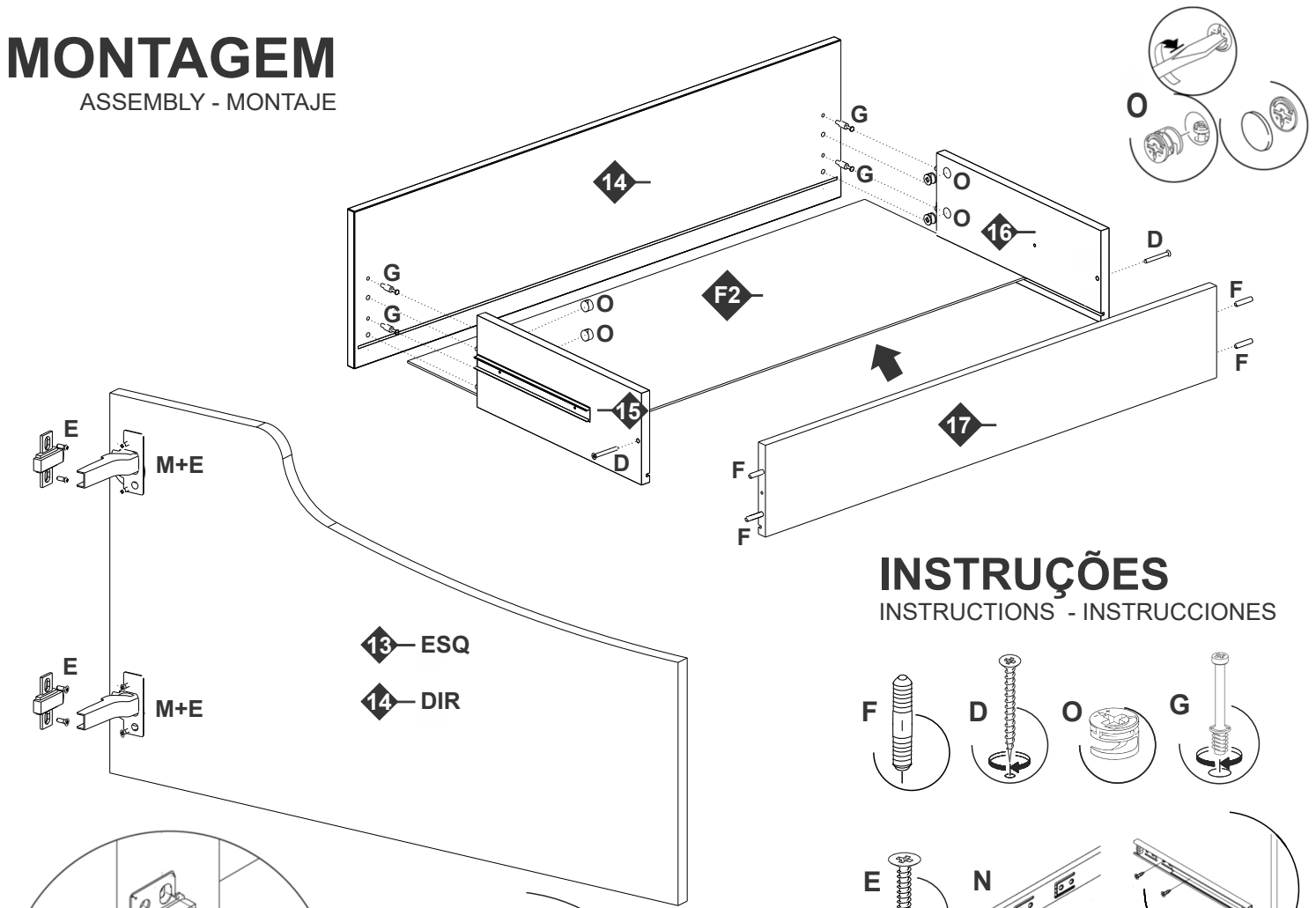

## INSTRUÇÕES

INSTRUCTIONS - INSTRUCCIONES

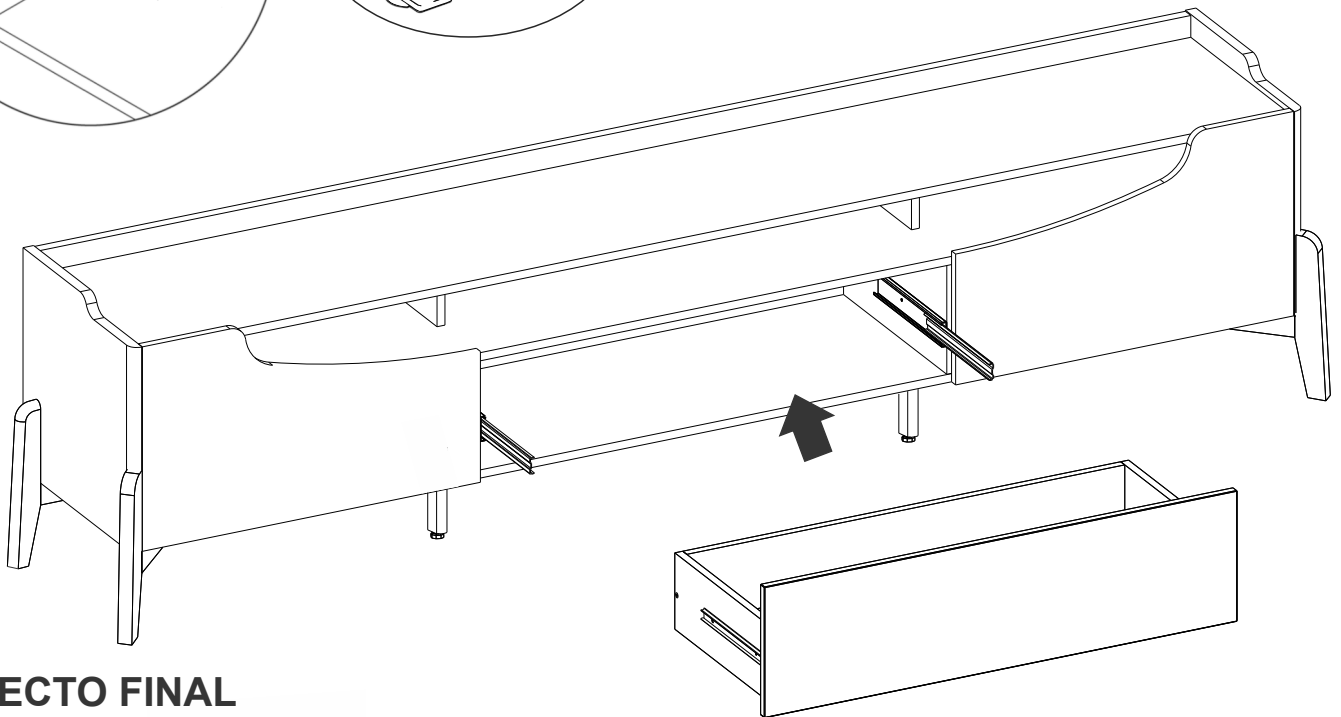
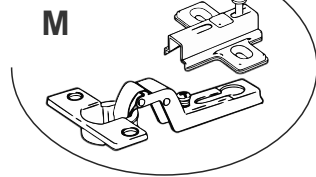
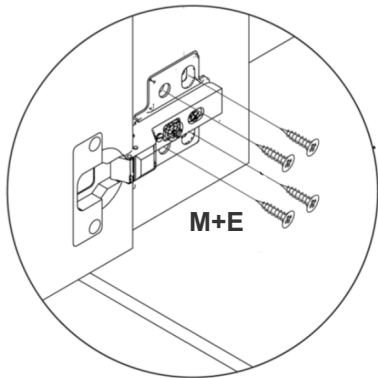
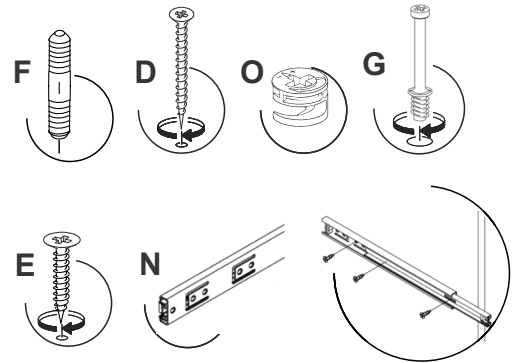

## ASPECTO FINAL

FINAL ASPECT - ASPECTO FINAL

