

Produto Concluído  
Producto terminado  
Finished Product

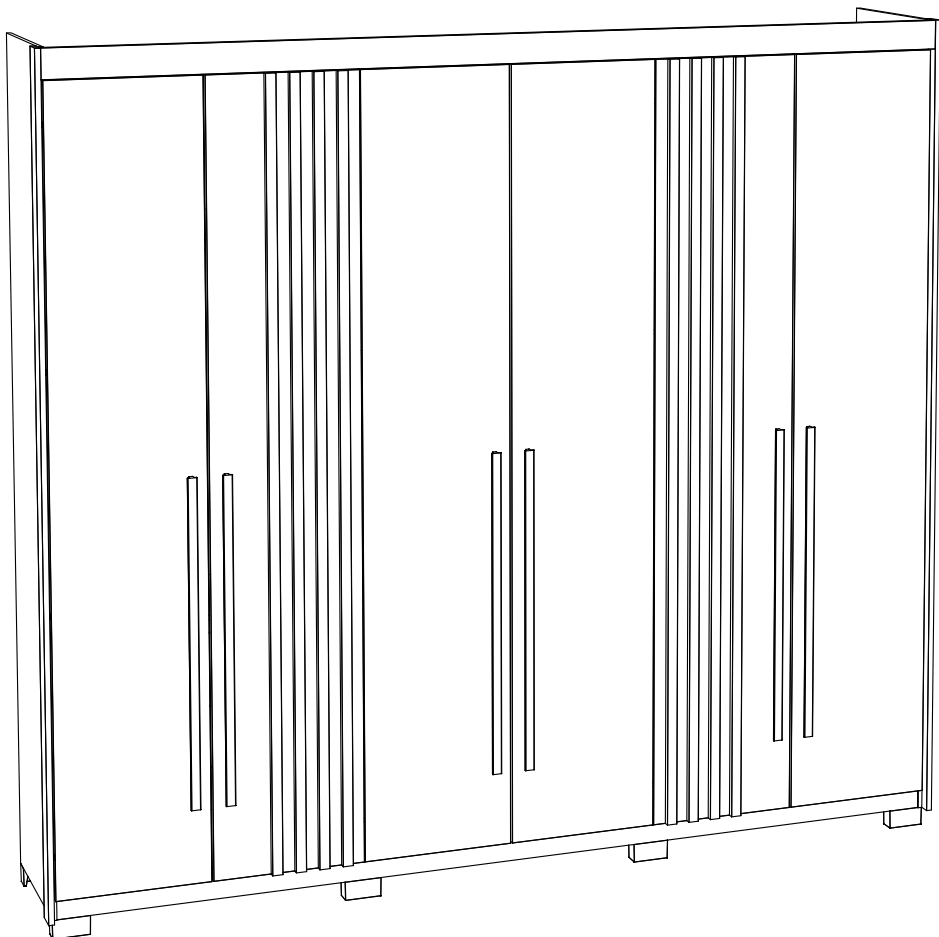

**HENN**

Ind. e Com. de Móveis Henn  
Mondai - SC - Brasil

+55 49 3674.3500

@moveishenn  
www.henn.com.br

ITM/D325-  
**INSTRUÇÕES DE  
MONTAGEM**

INSTRUCCIONES DE MONTAJE  
ASSEMBLY INSTRUCTIONS

Roupeiro Norton 6 Portas 4 Gavetas | Armario Norton 6 Puertas 4 Cajones |  
Wardrobe Norton 6 Doors 4 Drawers

D325-127 Nature/Off White

D325-128 Nature

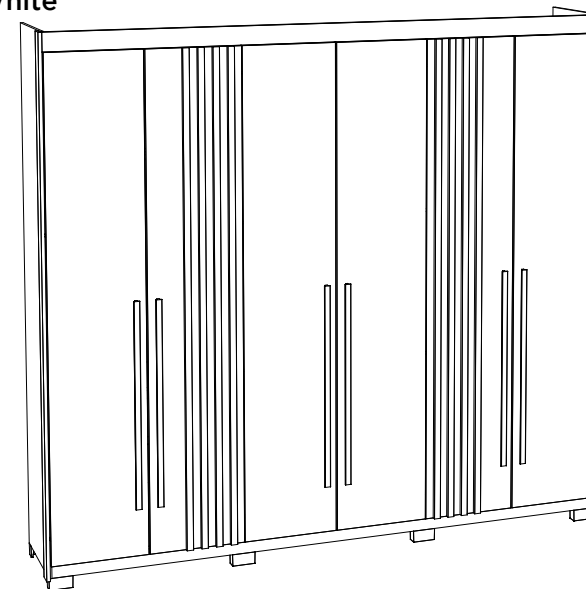

Requisitos para montagem  
Requisitos para la montaje  
Assembly Requirements

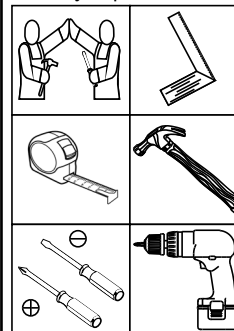

Imagens meramente ilustrativas,  
não acompanha o produto.  
Imágenes ilustrativas, no incluidas  
con el producto.  
Illustrative images, not included  
with the product.

**AVISO**

Para limpeza de seu móvel, use uma flanela seca ou umedecida, e não utilize produtos químicos que possam danificar seu produto.

**SISTEMA DE MONTAGEM**

O sistema de montagem dos produtos, funciona de acordo com a ordem crescente dos números indicados no desenho. Ex: 01, 02, 03, 04... até a conclusão da montagem.

**ASSISTÊNCIA TÉCNICA**

Para solicitação de Assistência Técnica você consumidor deverá entrar em contato com o Lojista a qual você realizou a compra deste produto e solicitar a assistência técnica das peças avariadas. A garantia abrange todas as peças, partes e componentes que eventualmente venham apresentar defeito de fabricação no prazo de 03 (três) meses, contando a partir da entrega do produto ao consumidor, mediante nota fiscal de compra. Se houver qualquer alteração na estrutura do produto ou ocorrer defeito por negligência do montador/consumidor em relação a instrução de montagem e manuseio, não será fornecido assistência técnica gratuita.

**ADVERTENCIA**

Para limpieza de su móvil, use una flanela seca o húmeda, y no utilice productos químicos que puedan dañar su producto.

**SISTEMA DE MONTAJE**

El sistema de montaje de los productos funciona de acuerdo con el orden creciente de los números indicados en el dibujo. Ej.: 01, 02, 03, 04... hasta la conclusión del montaje.

**ASISTENCIA TÉCNICA**

Para solicitar Asistencia Técnica, el consumidor debe comunicarse con el Comercio que usted realizó la compra de este producto y solicita asistencia técnica para las partes dañadas. La garantía cubre todas las partes, piezas y componentes que eventualmente puedan presentar defecto de fabricación en el plazo de 03 (tres) meses, contados a partir de la entrega del producto al consumidor, mediante factura de compra. Si se produce algún cambio en la estructura del producto o se produce un defecto por negligencia del montador/consumidor en relación con las instrucciones de montaje y manipulación, no se prestará asistencia técnica gratuita.

**NOTICE**

To clean your furniture, use a dry or wet cloth, and do not use chemicals that may damage your product.

**ASSEMBLY SYSTEM**

The products' assembly system works according to the increasing order of the indicated numbers. For example: 01, 02, 03, 04 ... to the end of the assembly.

**TECHNICAL ASSISTANCE**

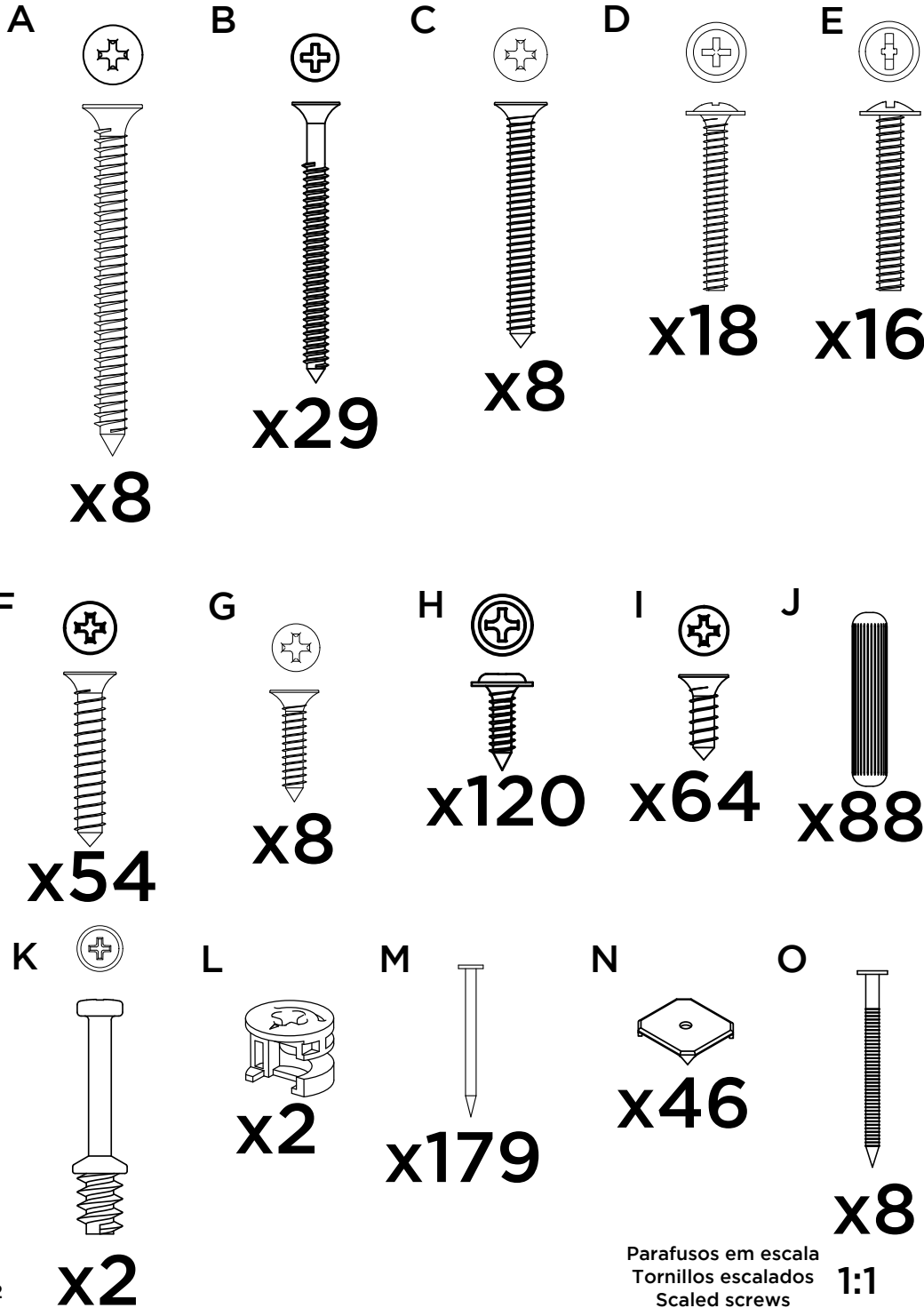

To request Technical Assistance, the consumer must contact the retailer from whom you purchased this product and request technical assistance for the damaged parts. The warranty covers all parts, parts and components that may eventually present a manufacturing defect within a period of 03 (three) months, counting from the delivery of the product to the consumer, by means of a purchase invoice. If there is any change in the structure of the product or defect occurs due to negligence of the assembler/consumer in relation to the assembly and handling instruction, free technical assistance will not be provided.

## ACESSÓRIOS | ACCESORIOS | ACCESSORIES



## PASSO 16

## ACESSÓRIOS REQUERIDOS

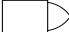
AD		74
AE		04
AF		02
AH	<b>HENN</b>	01

Pesos máximos recomendados com carga distribuída  
Peso máximo recomendado con la carga distribuida  
Recommended maximum weight with distributed load.

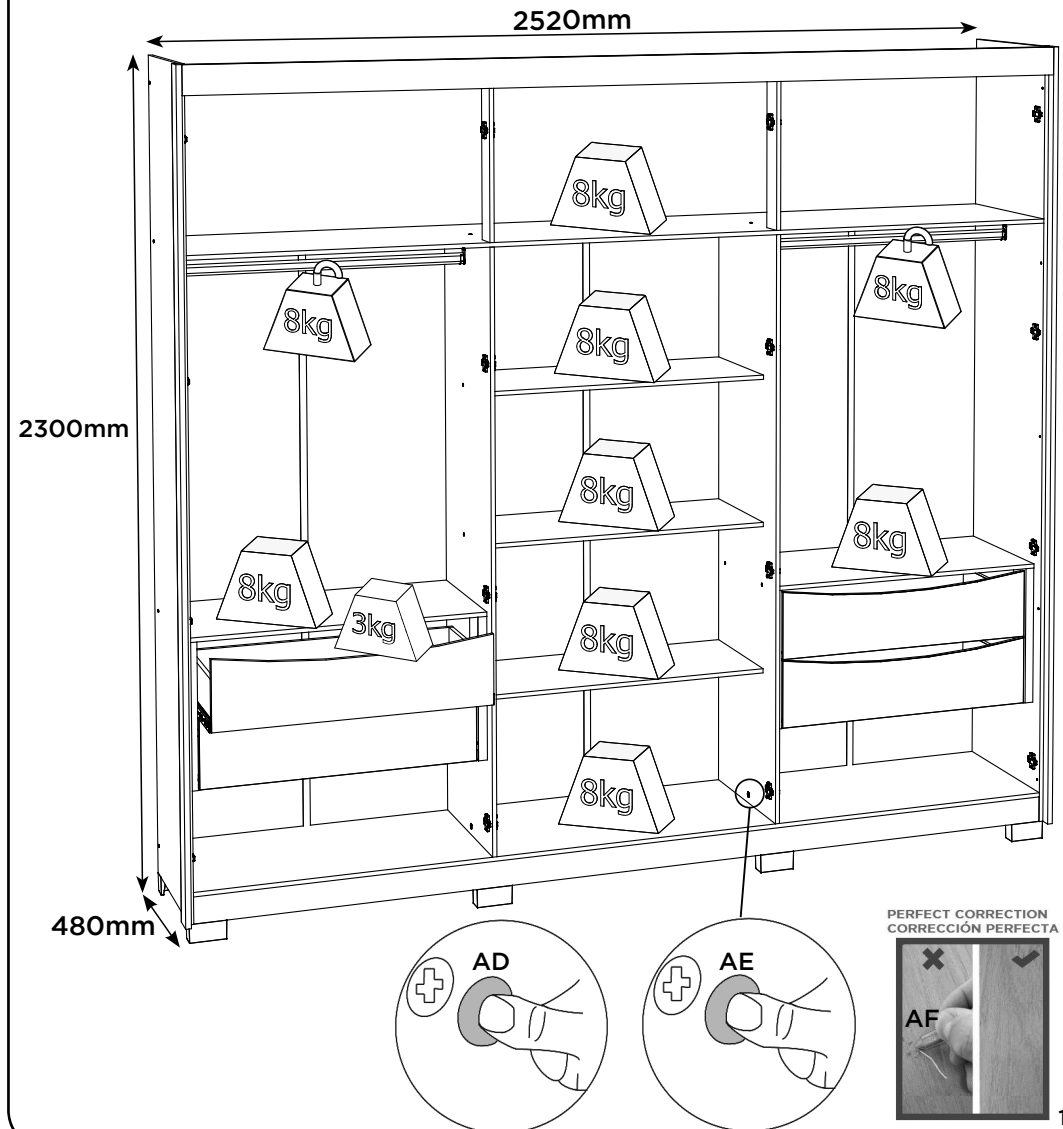

PEÇAS REQUERIDAS

ACESSÓRIOS REQUERIDOS

FERRAMENTAS NECESSÁRIAS

27	RIPA DE TRÁS	x4
----	--------------	----

G		08
I		24
O		08
Q		08
Z		04
AG		

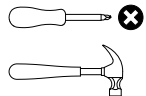

4x

3º

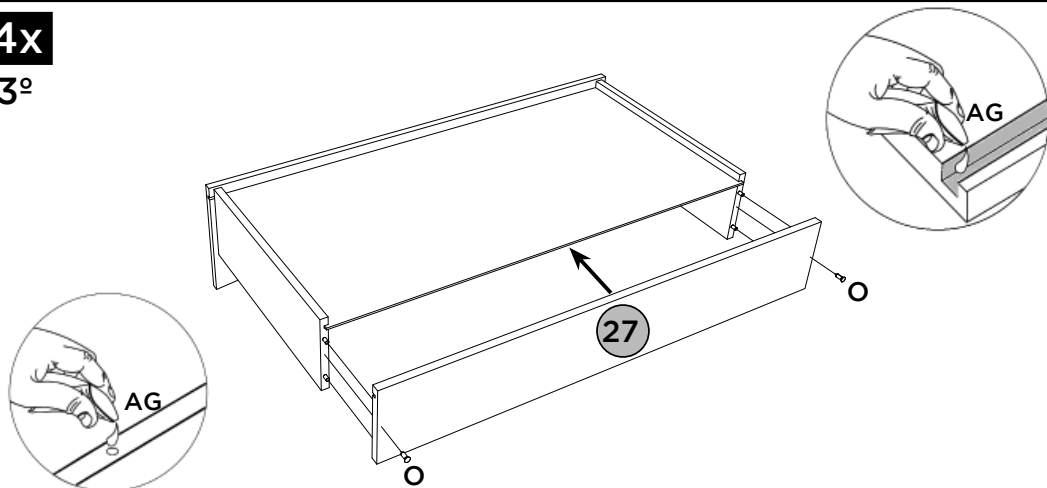

4x

4º

Deixar 3mm de distância da frente de gaveta.

Deje una separación de 3mm del frente del cajón.

Leave 3mm away from the front of the drawer.

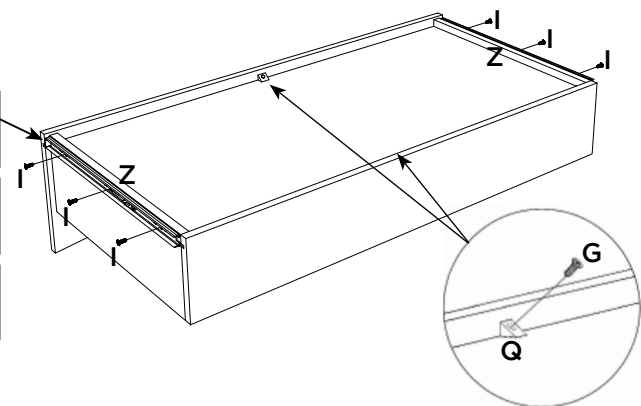

ACESSÓRIOS | ACCESORIOS | ACCESSORIES

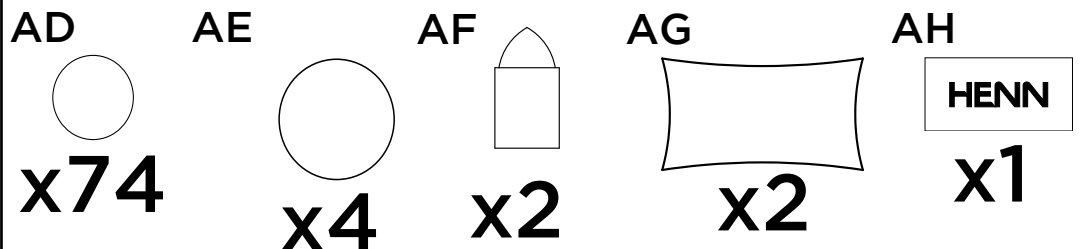
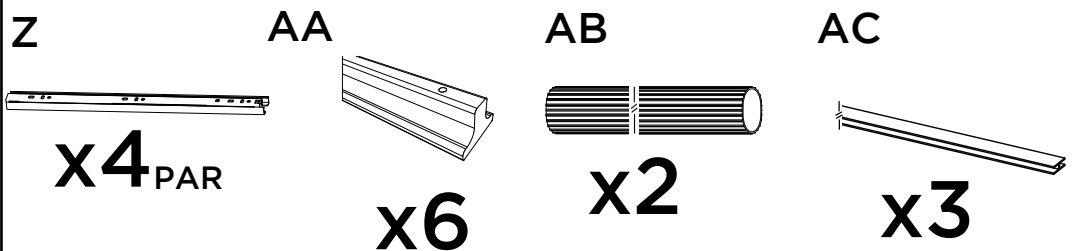
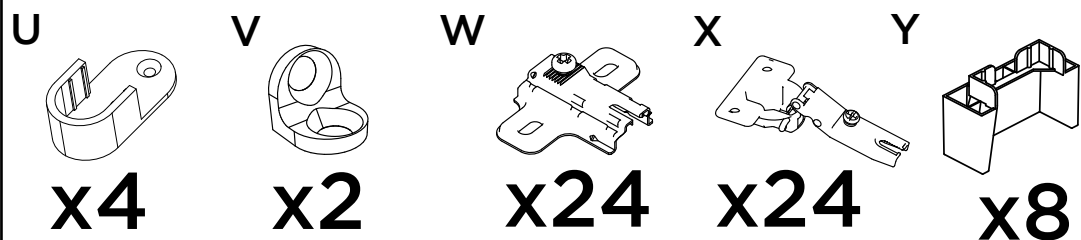
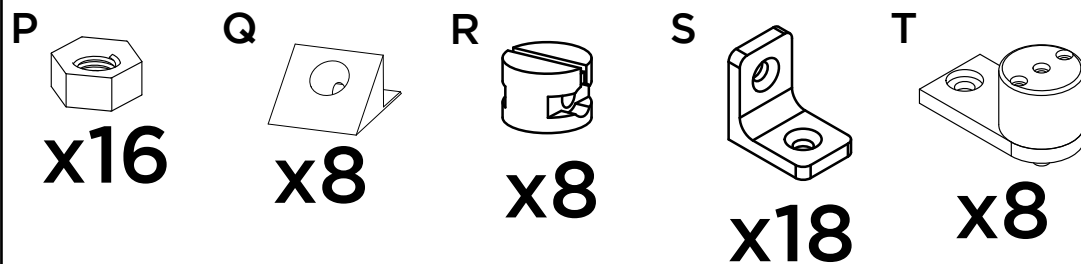

Item	Caixa Caja Box	Qtd Ctd Qty	Descrição Descripción Description	Dimensões (mm)   Dimensiones (mm)   Dimensions (mm)		
				Comprimento Largo Length	Largura Ancho Width	Espessura Grosor Thickness
1	2/3	1	RODAPÉ FRONTAL   FALDÓN DELANTERO   FRONT SKIRTING	2463	73	12
2	1/3	2	TRAVESSA DO RODAPÉ   PLACA DE RODAPIÉ   SKIRTING PLATE	415	73	12
3	2/3	1	RODAPÉ TRASEIRO   REPOSAPIÉS TRASERO   BACK FOOTBOARD	2463	73	12
4	2/3	1	BASE   BASE   BASE	2463	445	12
5	1/3	1	LATERAL ESQUERDA   LATERAL IZQUIERDA   LEFT SIDE	2250	445	12
6	1/3	1	DIVISÃO ESQUERDA   DIVISIÓN IZQUIERDA   LEFT DIVISION	1659	445	12
7=13	1/3	1	TAMPO DAS GAVETAS   TAPA DE LOS CAJONES   TOP OF DRAWERS	813	400	12
8	1/3	1	DIVISÃO DIREITA   DIVISIÓN DERECHA   RIGHT DIVISION	1659	445	12
9	1/3	3	PRATELEIRA   ESTANTE   SHELF	813	350	12
10	2/3	1	CHÃO DO MALEIRO   REPISA SUPERIOR   FLOOR OF MALEIRO	2463	445	12
11	1/3	2	RIPA DO MALEIRO   TRAVESAÑO SUPERIOR   MALEIRO'S LATH	414	73	12
12	1/3	1	LATERAL DIREITA   LADO DERECHO   RIGHT SIDE	2250	445	12
13=7	1/3	1	TAMPO DAS GAVETAS   TAPA DE LOS CAJONES   TOP OF DRAWERS	813	400	12
14	2/3	1	TAMPO SUPERIOR   TAPA SUPERIOR   TOP PANEL	2463	445	12
15	2/3	1	MOLDURA TRASEIRA   MARCO TRASERO   REAR FRAME	2486	28	15
16	2/3	2	MOLDURA LATERAL   MARCO LATERAL   LATERAL FRAME	2250	60	15
17	1/3	4	RIPA LATERAL   CINTA LATERAL   SIDE RIBBON	395	80	25
18	2/3	1	MOLDURA SUPERIOR   MARCO SUPERIOR   TOP FRAME	2486	80	15
19	2/3	1	FUNDO SUPERIOR   FONDO TOP   TOP FUND	2483	431	3
20	2/3	6	FUNDO   FONDO   BOTTOM	1675	410	3
21	3/3	4	PORTA   PUERTA   DOOR	2112	409	15
22	3/3	2	PORTA COM APLIQUE   PUERTA CON APLICARSE   DOOR WITH APPLY	2112	409	15
23	2/3	8	APLIQUE   APLICARSE   APLLY	2112	28	15
24	1/3	4	FRENTE DE GAVETA   FRENTE DE CAJÓN   FRONT OF DRAWER	755	192	12
25	2/3	8	LADO DE GAVETA   LADO DEL CAJÓN   SIDE OF DRAWER	350	122	12
26	1/3	4	FUNDO DE GAVETA RECORTADO   FONDO DEL CAJÓN RECORTADO   CROPPED DRAWER BOTTOM	725	361	3
27	1/3	4	RIPA DE TRÁS   MALLA DETRÁS   REAR LATH	738	122	12

PEÇAS REQUERIDAS			ACESSÓRIOS REQUERIDOS			FERRAMENTAS NECESSÁRIAS	
25	LADO DE GAVETA	x8	J		32		
			AG				

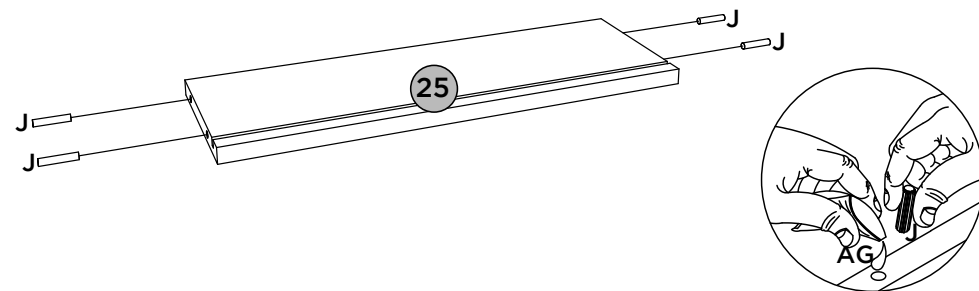

PASSO 14

PEÇAS REQUERIDAS			ACESSÓRIOS REQUERIDOS			FERRAMENTAS NECESSÁRIAS	
24	FRENTE DE GAVETA	x4	I		16		
25	LADO DE GAVETA	x8	S		08		
26	FUNDO DE GAVETA RECORTADO	x4	AG				

4x

1º

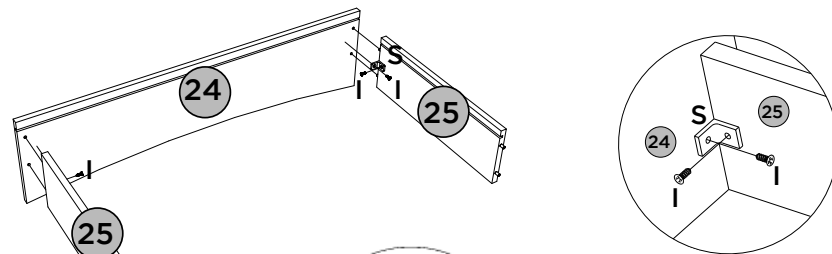

4x

2º

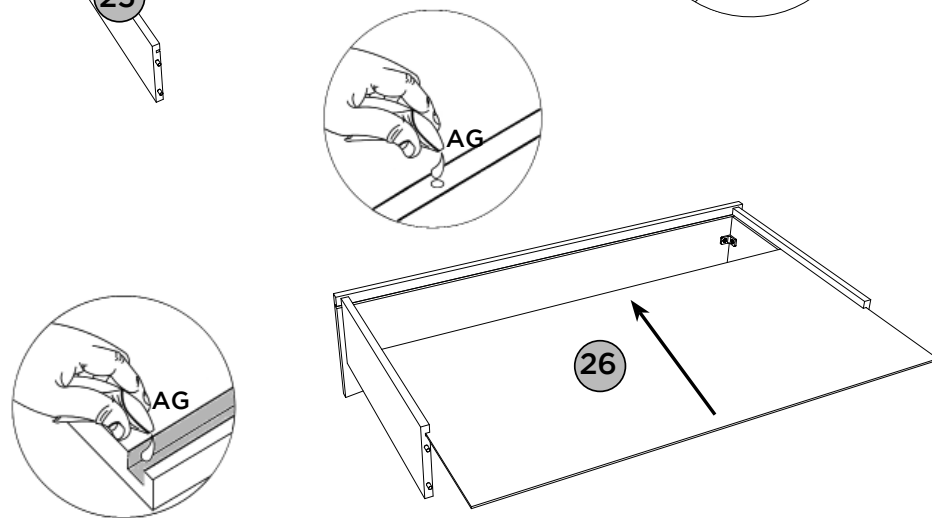

PEÇAS REQUERIDAS

21	PORTA	x4
22	PORTA COM APLIQUE	x2

ACESSÓRIOS REQUERIDOS

D		18
E		16
I		16
P		16
W		16
Z		04
AA		06
AB		02

FERRAMENTAS NECESSÁRIAS

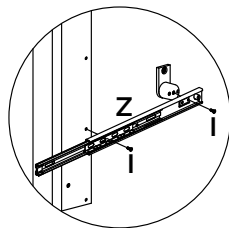
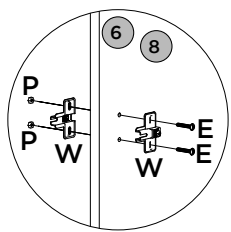
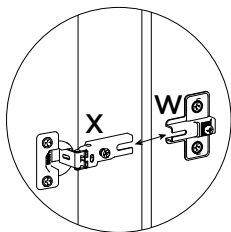
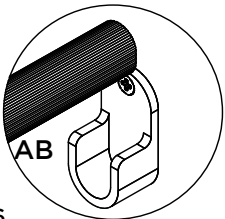
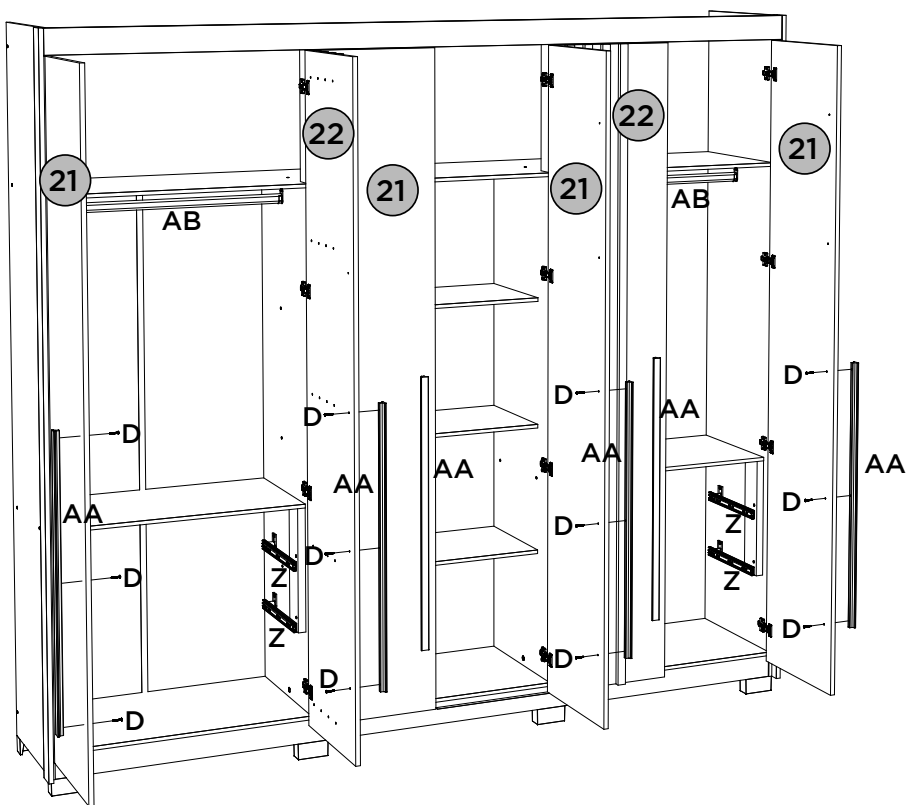
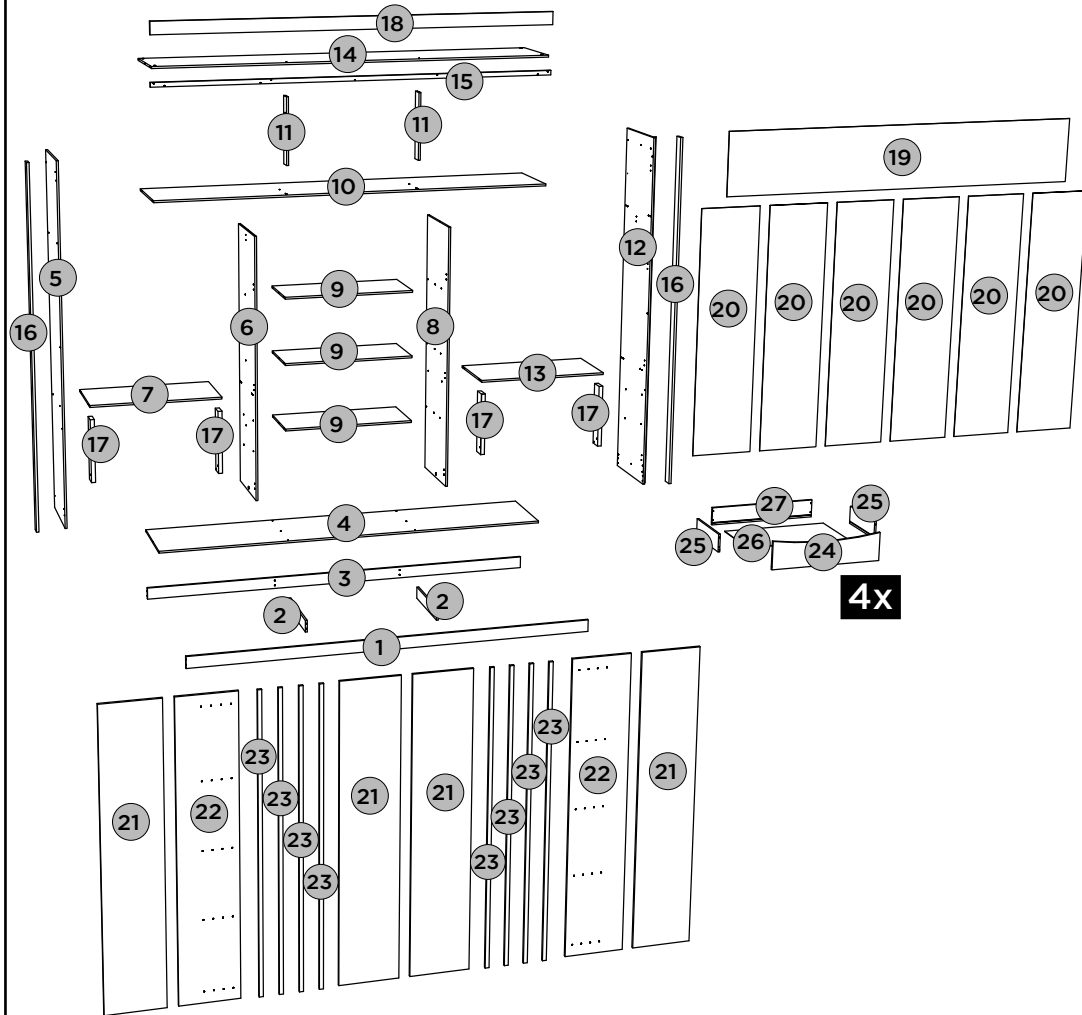
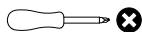

# PASSO 1

ITM/D325-

## PEÇAS REQUERIDAS

1	RODAPÉ FRONTAL	x1
2	TRAVESSA DO RODAPÉ	x2
3	RODAPÉ TRASEIRO	x1
11	RIPA DO MALEIRO	x2
18	MOLDURA SUPERIOR	x1

## ACESSÓRIOS REQUERIDOS

H		06
J		20
S		04
V		02

## FERRAMENTAS NECESSÁRIAS

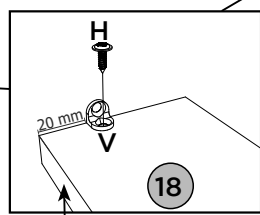
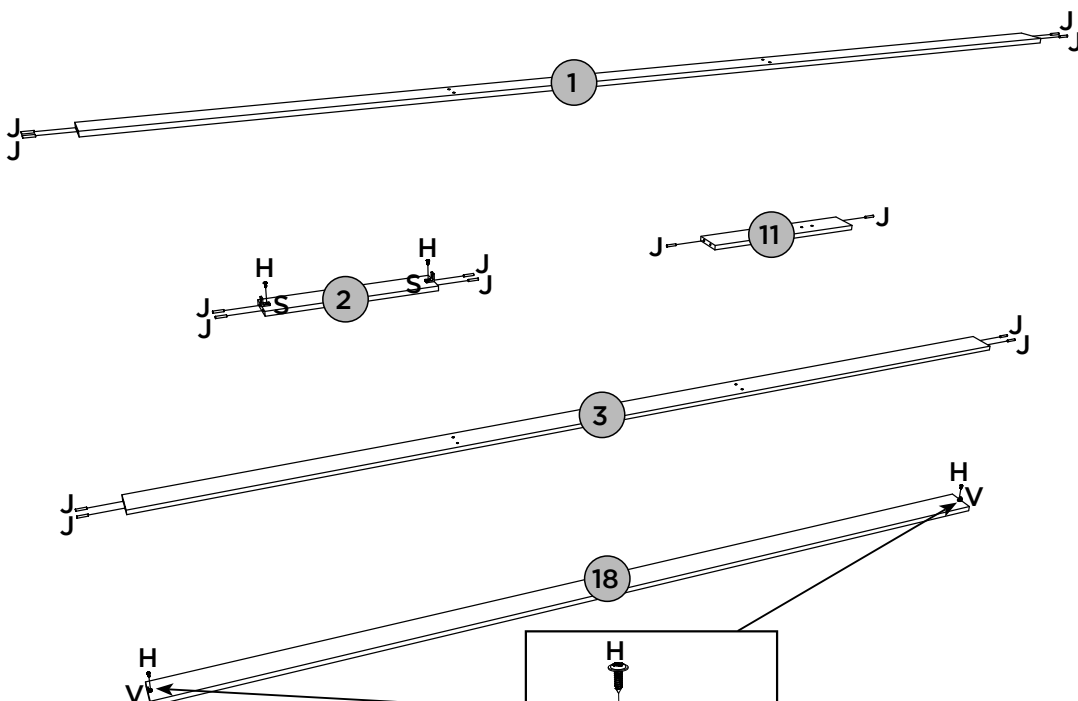
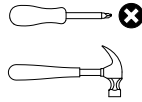

- Lado sem borda
- Lado sin borde
- Side without border

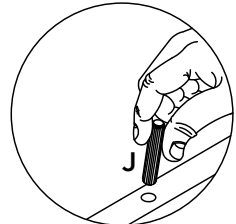
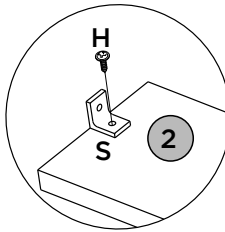

# PASSO 10

ITM/D325-

## PEÇAS REQUERIDAS

21	PORTA	x4
22	PORTA COM APLIQUE	x2

## ACESSÓRIOS REQUERIDOS

H		48
X		24

## FERRAMENTAS NECESSÁRIAS

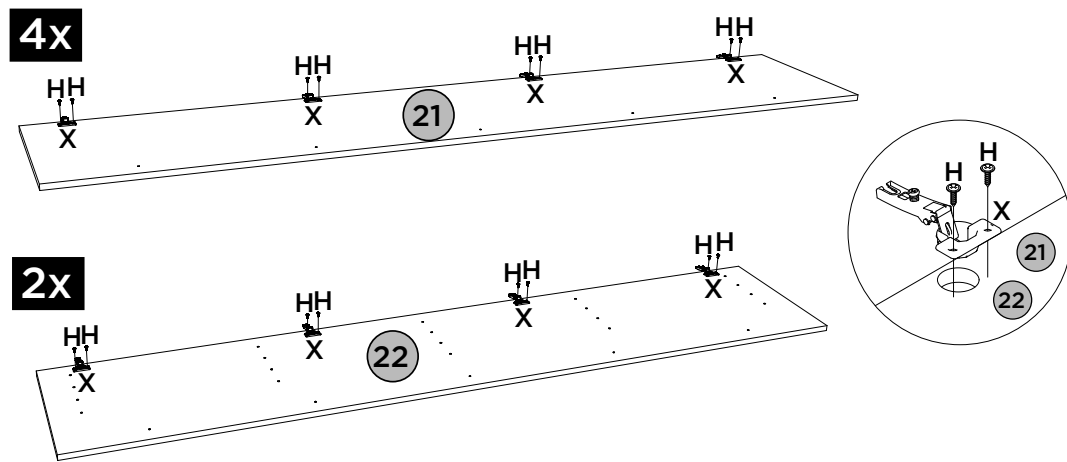
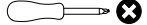

- Vídeo: Instalar e regular Dobradiças
- Video: Instale y ajuste las bisagras
- Video: Install and adjust hinges

# PASSO 11

## PEÇAS REQUERIDAS

22	PORTA COM APLIQUE	x2
23	APLIQUE	x8

## ACESSÓRIOS REQUERIDOS

F		40
---	--	----

## FERRAMENTAS NECESSÁRIAS

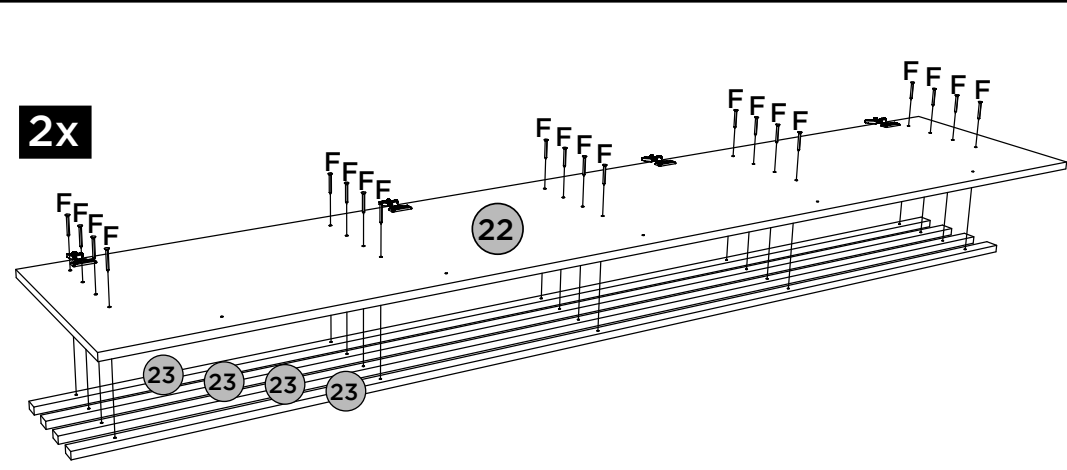
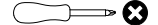

# PASSO 9

ITM/D325-

## PEÇAS REQUERIDAS

18	MOLDURA SUPERIOR	x1
19	FUNDO SUPERIOR	x1
20	FUNDO	x6

## ACESSÓRIOS REQUERIDOS

F		04
H		02
M		179
N		46
AC		03

## FERRAMENTAS NECESSÁRIAS

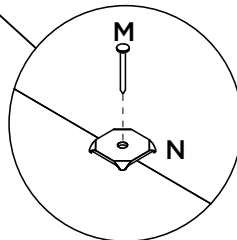
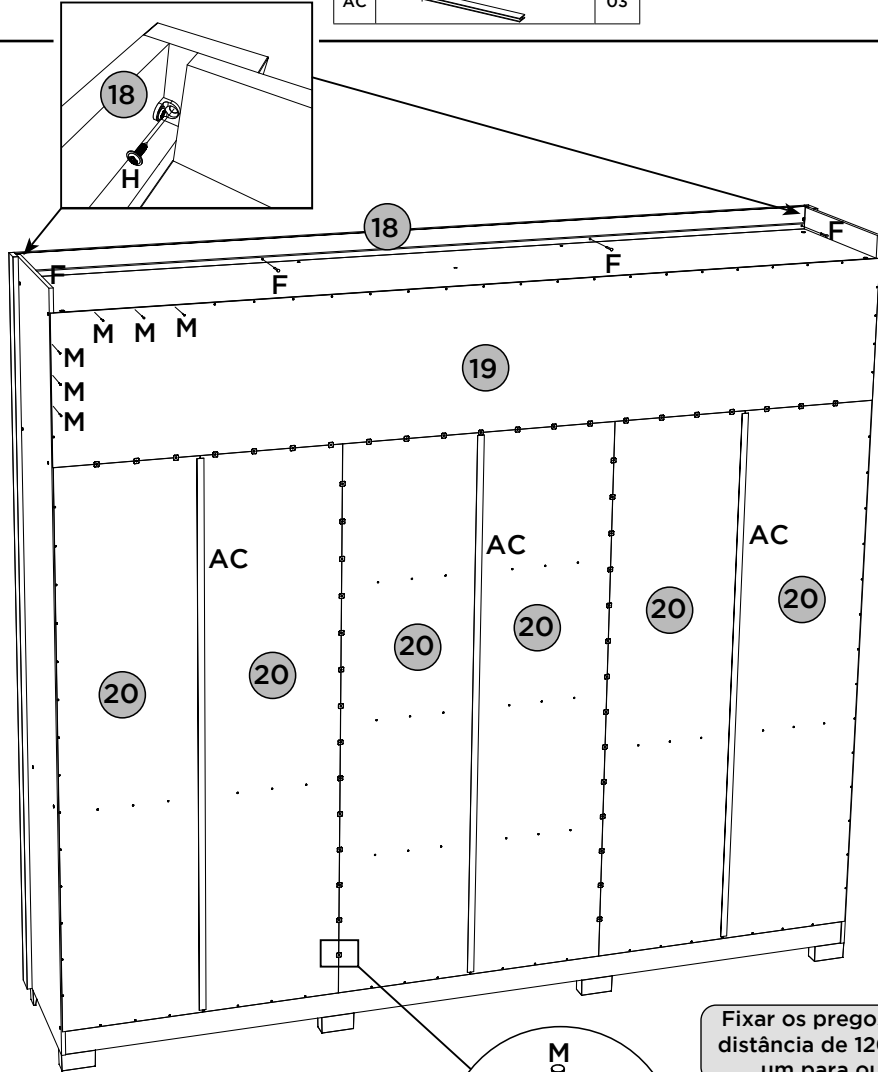
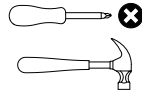

Fixar os pregos a uma distância de 120mm de um para outro.

Fijar las uñas a un distancia de 120mm uno a otro.

Fix the nails at a distance of 120mm from one to the other

# PASSO 2

ITM/D325-

## PEÇAS REQUERIDAS

4	BASE	x1
7=13	TAMPO DAS GAVETAS	x2
9	PRATELEIRA	x3
10	CHÃO DO MALEIRO	x1
14	TAMPO SUPERIOR	x1

## ACESSÓRIOS REQUERIDOS

J		28
K		02
R		08

## FERRAMENTAS NECESSÁRIAS

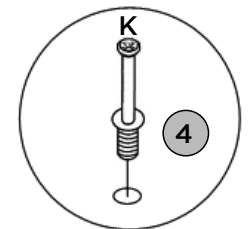
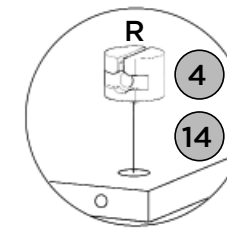
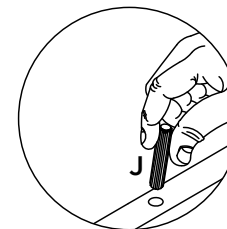
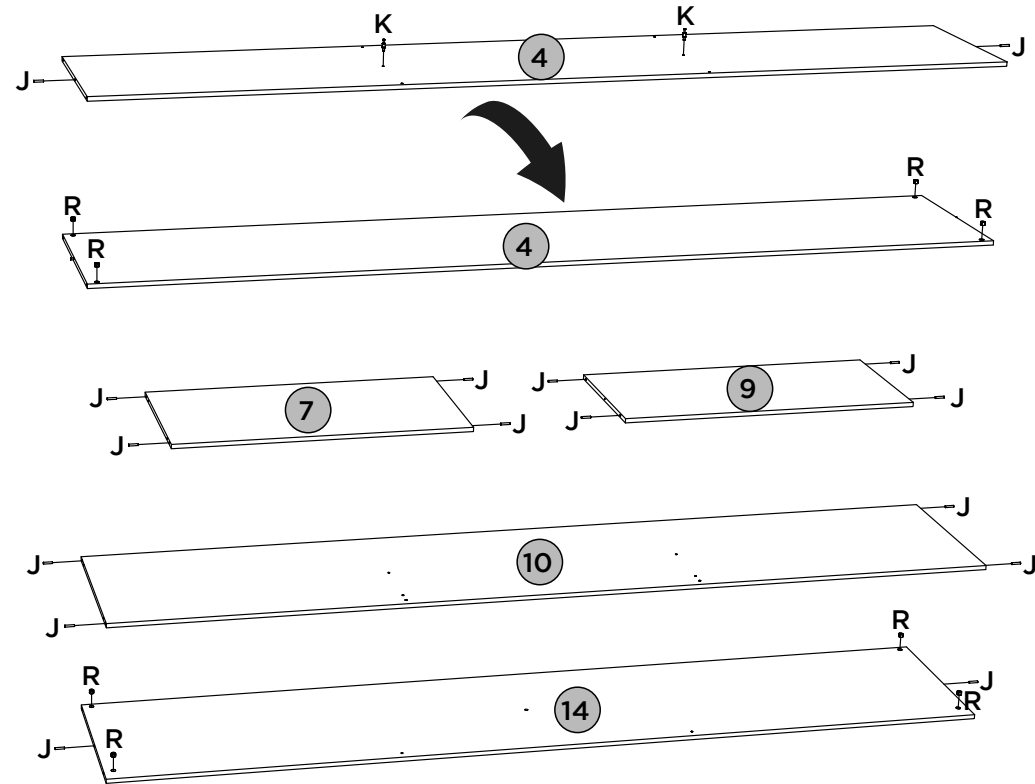
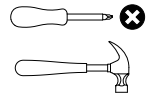

# PASSO 3

ITM/D325-

## PEÇAS REQUERIDAS

5	LATERAL ESQUERDA	x1
6	DIVISÃO ESQUERDA	x1
8	DIVISÃO DIREITA	x1
12	LATERAL DIREITA	x1

## ACESSÓRIOS REQUERIDOS

H		24
I		08
J		08
T		08
U		04
W		08

## FERRAMENTAS NECESSÁRIAS

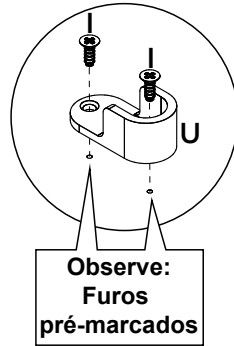
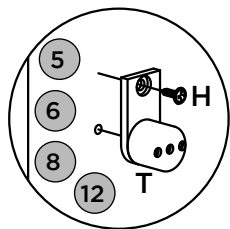
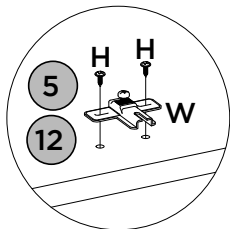
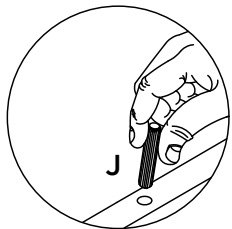
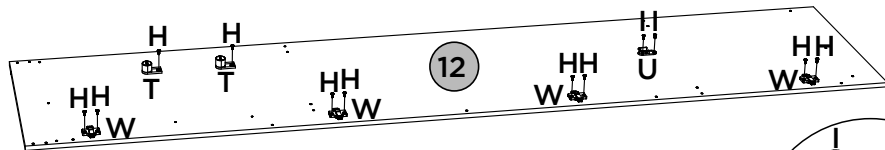
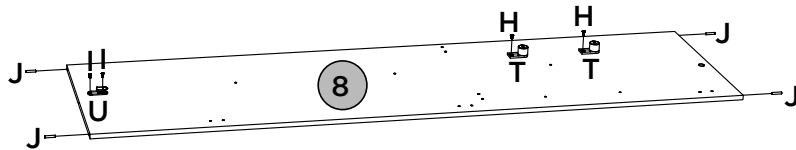
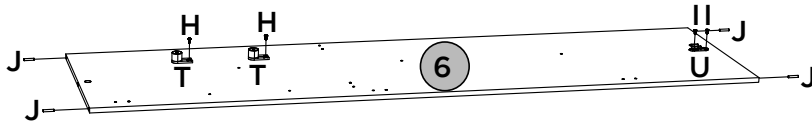
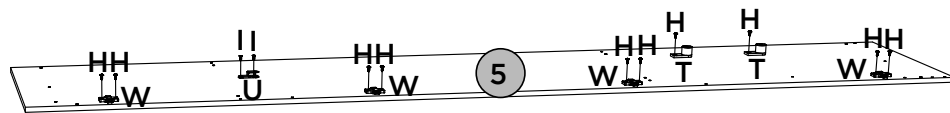
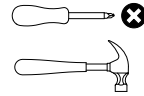

# PASSO 8

ITM/D325-

## PEÇAS REQUERIDAS

15	MOLDURA TRASEIRA	x1
16	MOLDURA LATERAL	x2
17	RIPA LATERAL	x4

## ACESSÓRIOS REQUERIDOS

B		05
C		08
F		10

## FERRAMENTAS NECESSÁRIAS

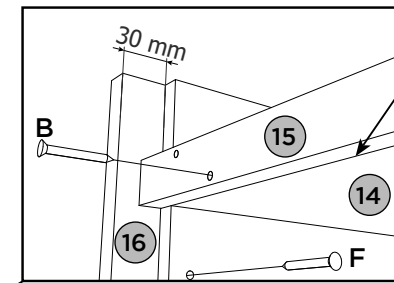
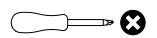

Alinhar a Moldura Traseira (15) com o Tampo Superior (14).

Alinee el Marco Trasero (15) con la Parte Superior superiores (14).

Align the Rear Frame (15) with the Top Superior (14).

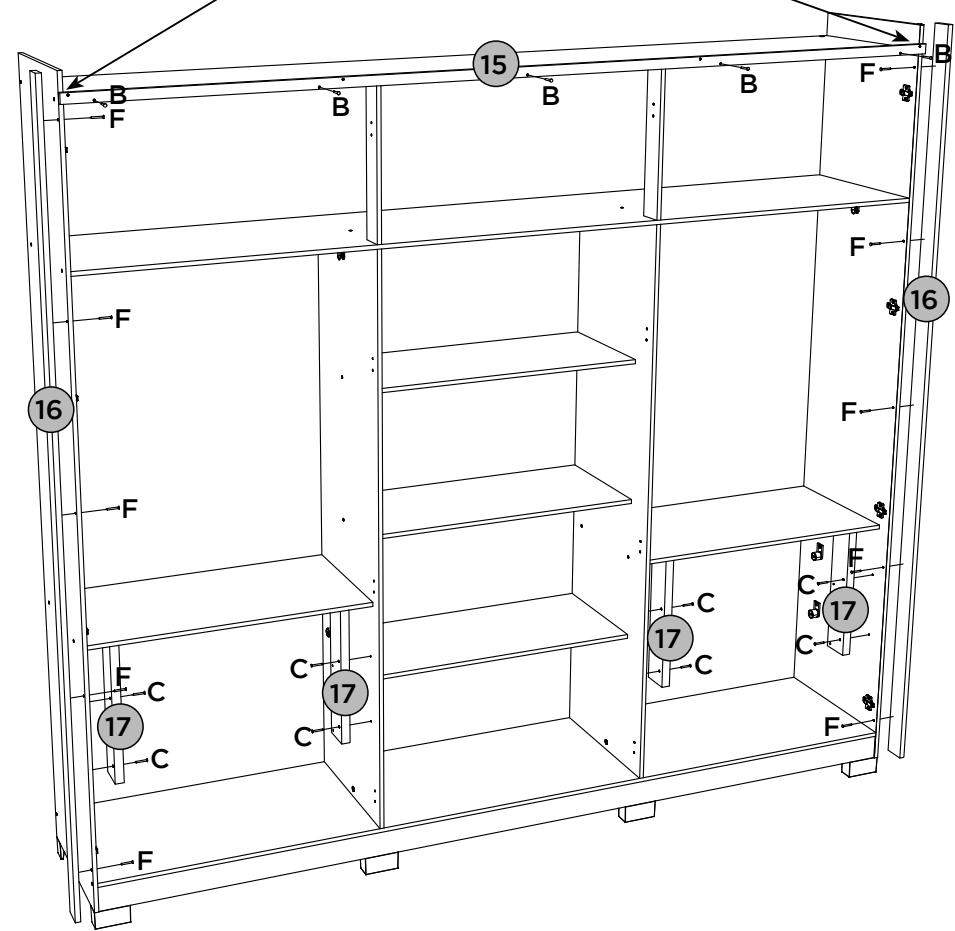



# PASSO 7

ITM/D325-

## PEÇAS REQUERIDAS

10	CHÃO DO MALEIRO	x1
11	RIPA DO MALEIRO	x2
12	LATERAL DIREITA	x1
13=7	TAMPO DAS GAVETAS	x1
14	TAMPO SUPERIOR	x1

## ACESSÓRIOS REQUERIDOS

A		06
B		14

## FERRAMENTAS NECESSÁRIAS

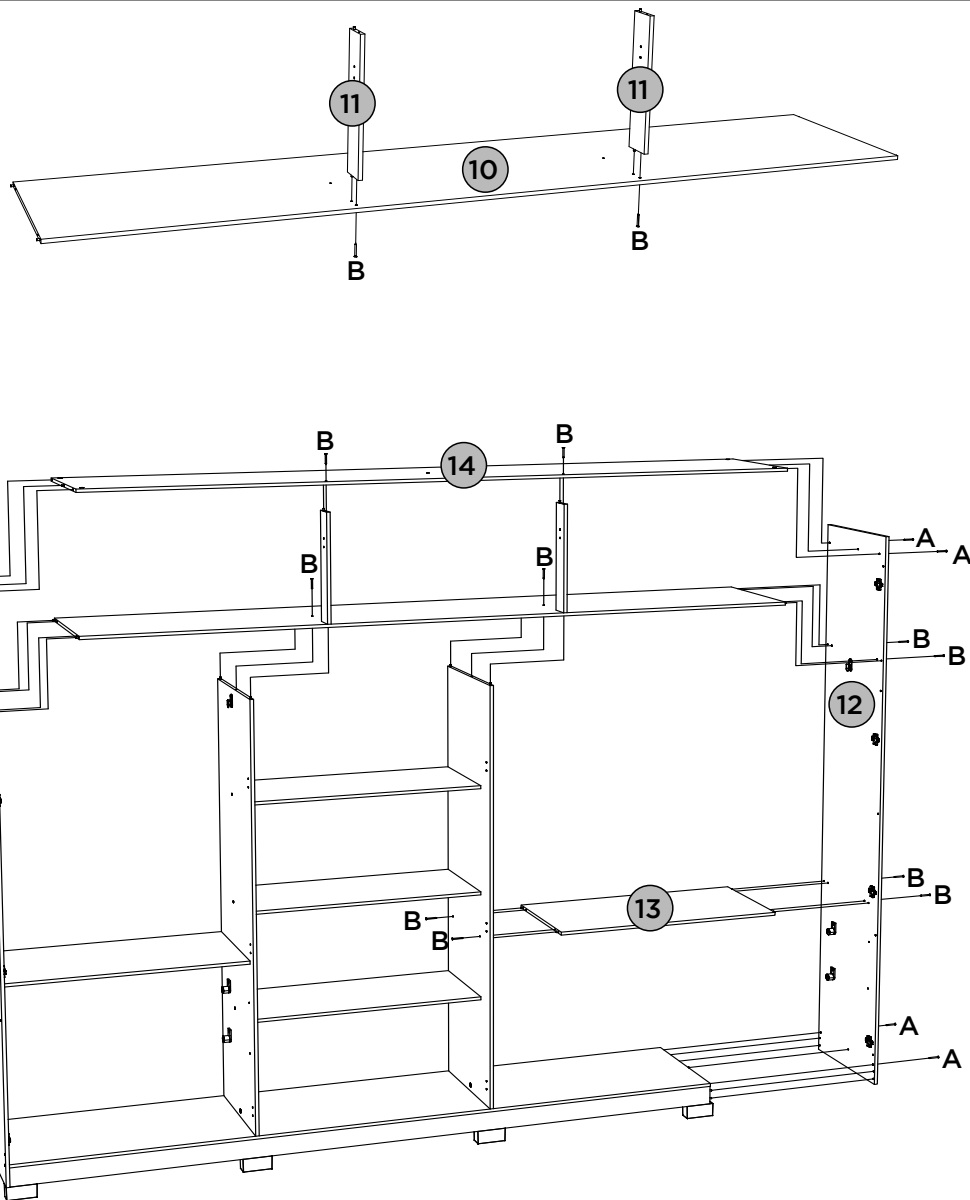

# PASSO 4

ITM/D325-

## PEÇAS REQUERIDAS

1	RODAPÉ FRONTAL	x1
2	TRAVESSA DO RODAPÉ	x2
3	RODAPÉ TRASEIRO	x1

## ACESSÓRIOS REQUERIDOS

H		04
---	--	----

## FERRAMENTAS NECESSÁRIAS

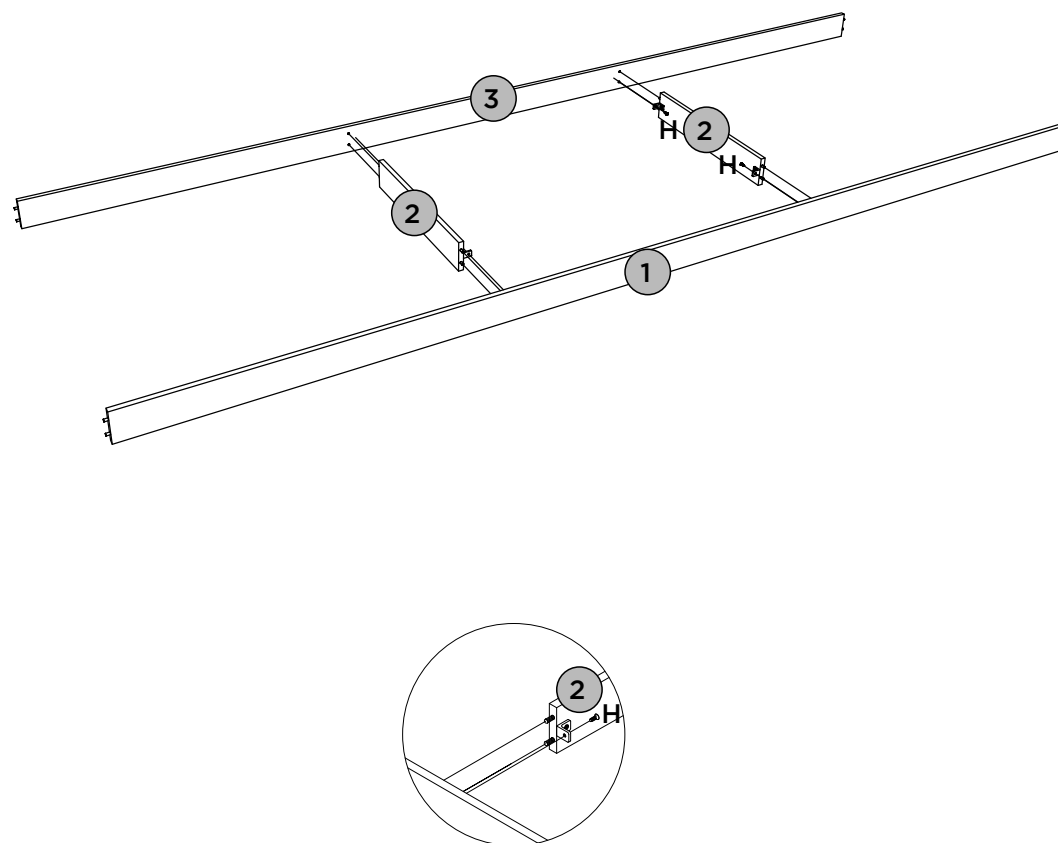
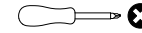

# PASSO 5

ITM/D325-

## PEÇAS REQUERIDAS

4	BASE	x1
5	LATERAL ESQUERDA	x1
6	DIVISÃO ESQUERDA	x1
7	TAMPO DAS GAVETAS	x1

## ACESSÓRIOS REQUERIDOS

A		02
B		04
H		36
L		01
S		06
Y		08

## FERRAMENTAS NECESSÁRIAS

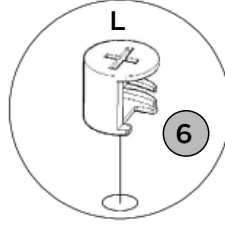
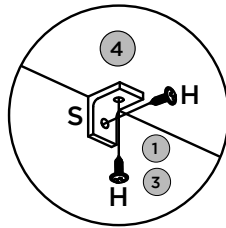
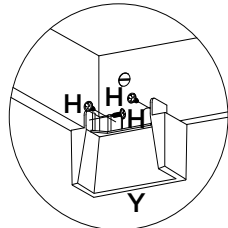
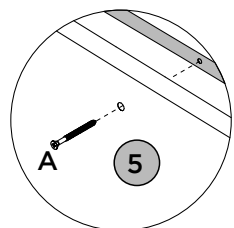
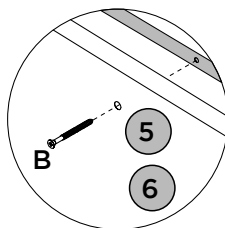
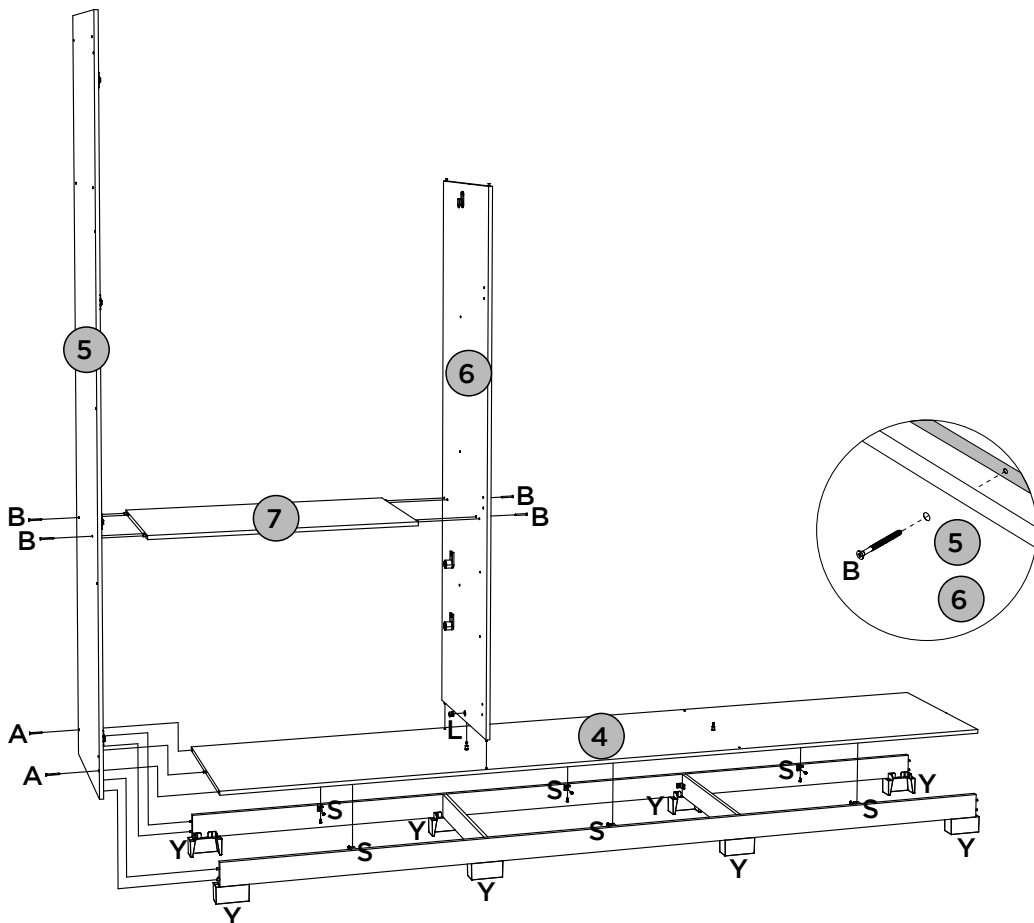
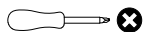

# PASSO 6

ITM/D325-

## PEÇAS REQUERIDAS

8	DIVISÃO DIREITA	x1
9	PRATELEIRA	x3

## ACESSÓRIOS REQUERIDOS

B		06
L		01

## FERRAMENTAS NECESSÁRIAS

