

\* FERRAMENTAS NECESSÁRIAS NÃO FORNECIDAS  
\* Tools Needed (not supplied)

**Sugestão da quantidade de pessoas necessárias para montagem e fixação do produto na parede.**

*Tip of the number of people required for product assembly and wall mounting.*

*Consejo de la cantidad de personas necesarias para el montaje de productos y montaje de la pared.*

2

**Montagem e Fixação**  
Mounting and Fixation  
Montaje e Fijación

01

**Importante: Passar cola nas cavilhas**  
*Mandatory to glue the dowels*  
Importante: Pasar cola en los tarugos

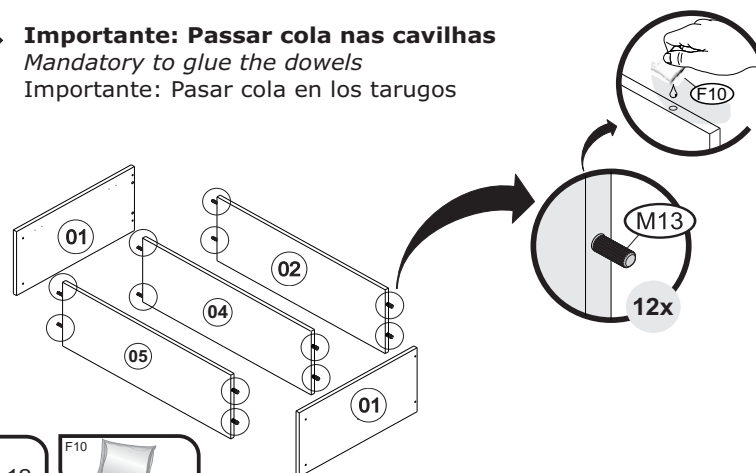

02

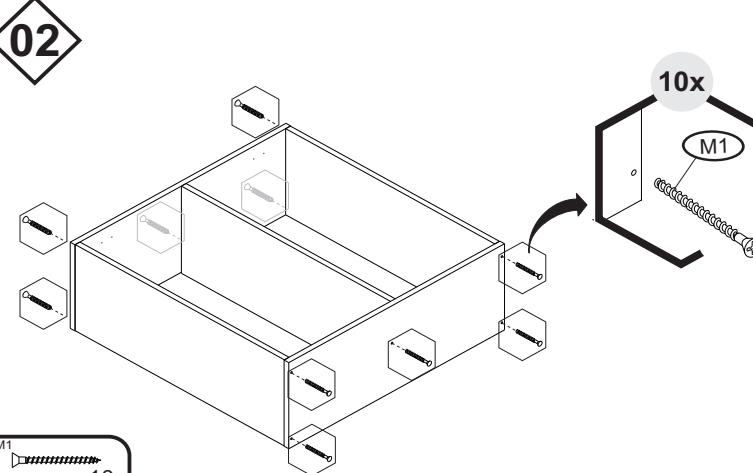
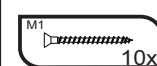

03

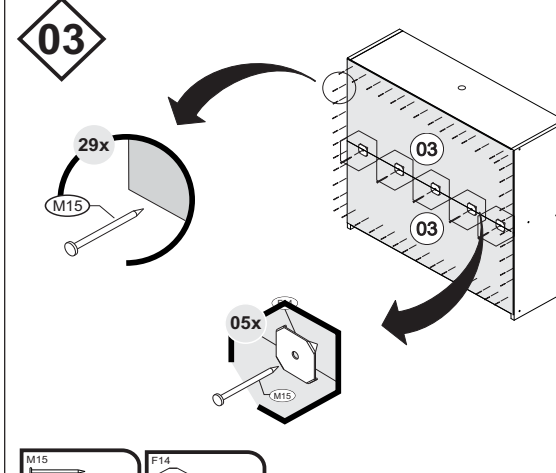

ATENÇÃO

04

**IMPORTANTE: NECESSÁRIO FIXAÇÃO NA PAREDE**  
*IMPORTANT: CABINET MUST BE ATTACHED TO THE WALL*  
**IMPORTANTE: ES NECESARIO FIJAR EN LA PARED**

8mm / 5/16"

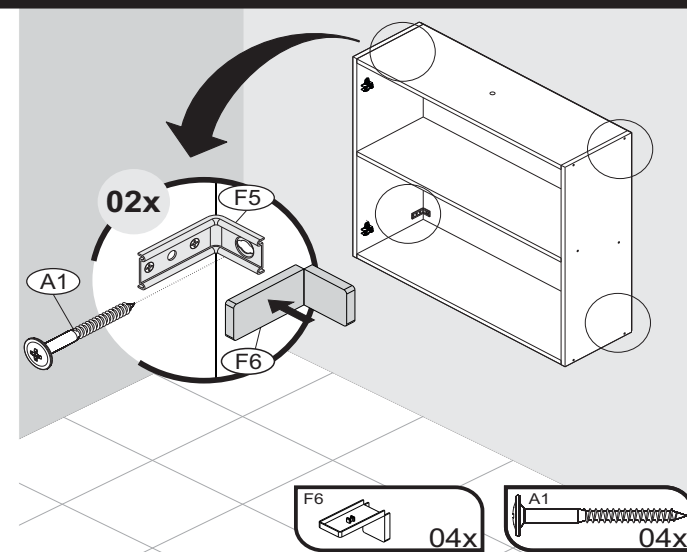
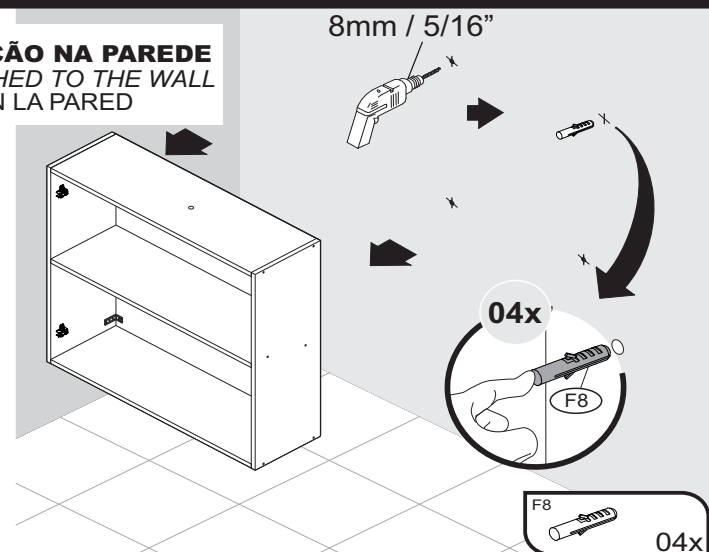
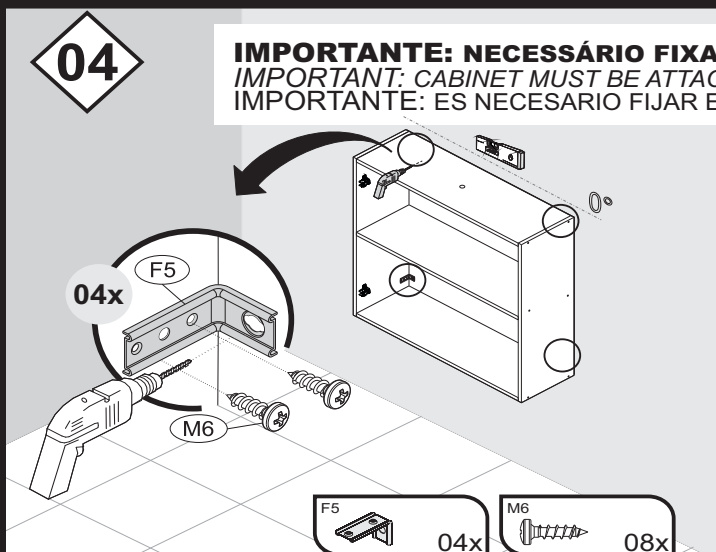

05

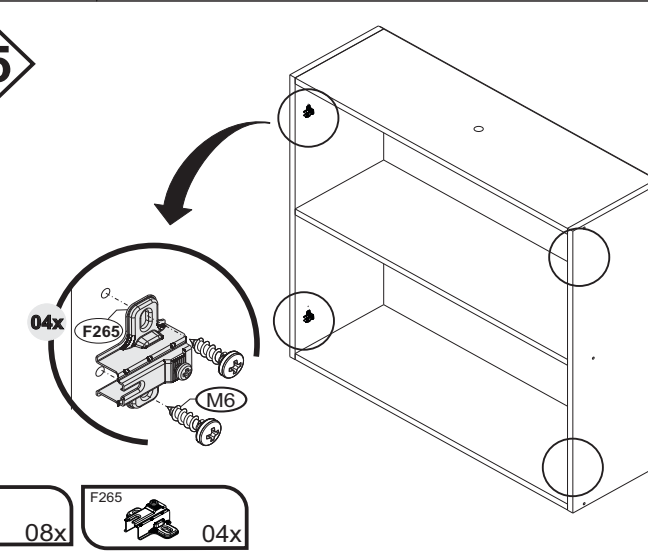

06

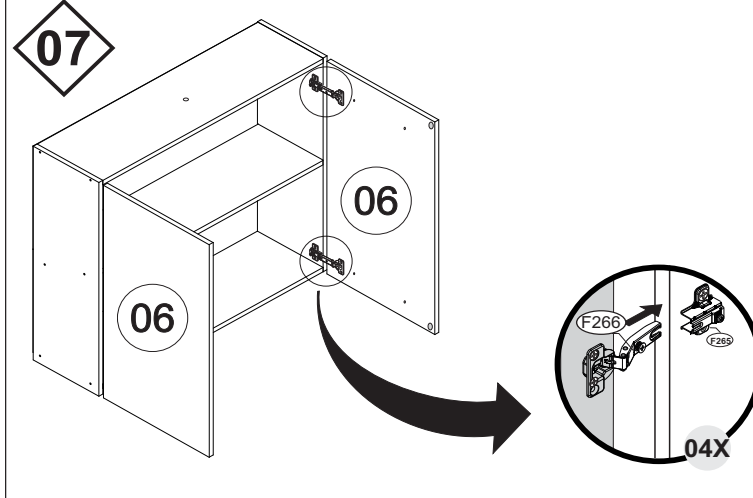
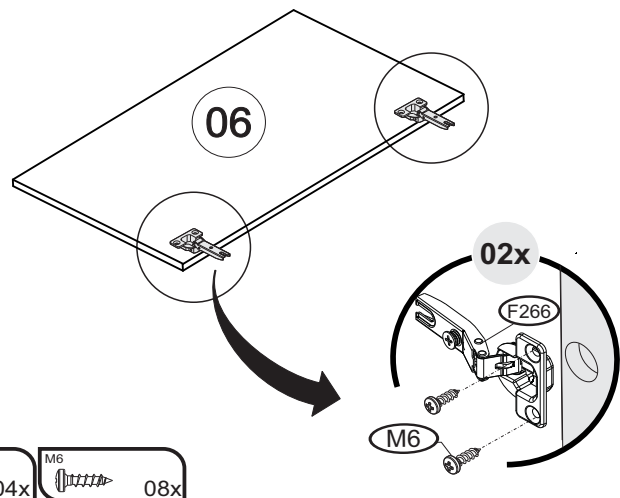

ATENÇÃO

08

**ATENÇÃO: APÓS MONTAGEM DAS PORTAS NO PRODUTO, REALIZAR FURAÇÃO PARA FIXAÇÃO DOS PUXADORES SEGUINDO AS MARCAÇÕES INDICADAS.**

*ATTENTION: AFTER ASSEMBLING THE DOORS ON THE PRODUCT, MAKEHOLES TO FIX THE HANDLES FOLLOWING THE MARKINGS INDICATED.*

*ATENCIÓN: DESPUÉS DE MONTAR LAS PUERTAS EN EL PRODUCTO, HAGA LOS AGUJEROS PARA FIJAR LAS MANIJAS SIGUIENDO LAS MARCAS INDICADAS.*

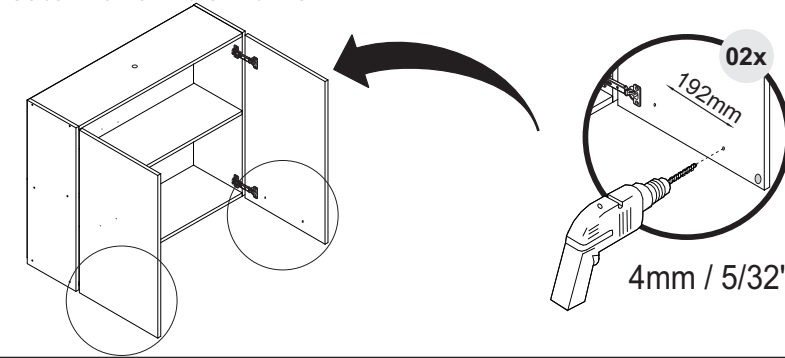

09

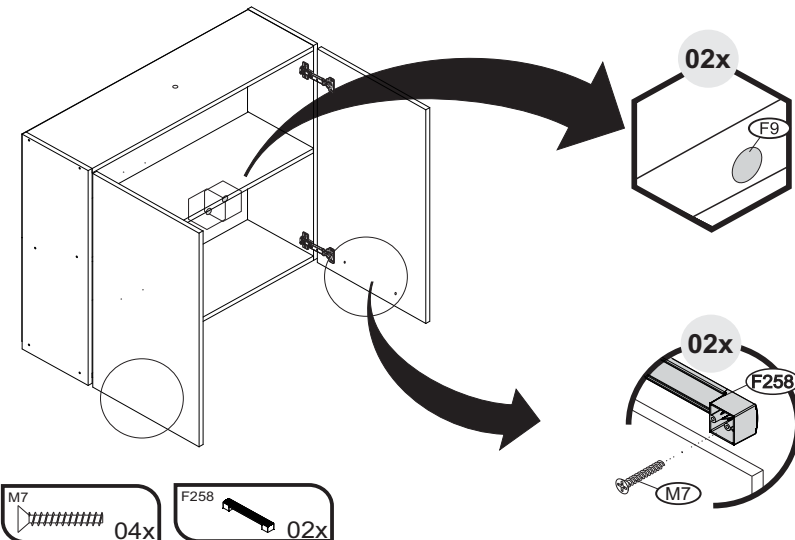
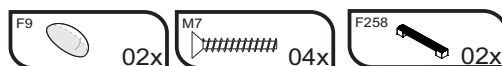

10

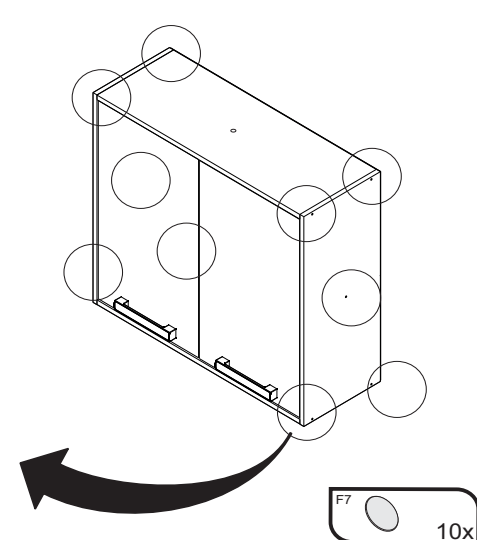
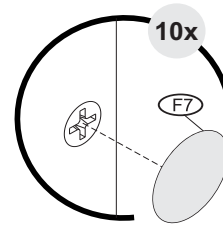

11

**UNIÃO DE MODULOS**  
*UNION OF MODULES*  
**UNIÓN DE MÓDULOS**

