

Produto Concluído
Producto terminado
Finished Product

ITM/D737-
Rev. 001

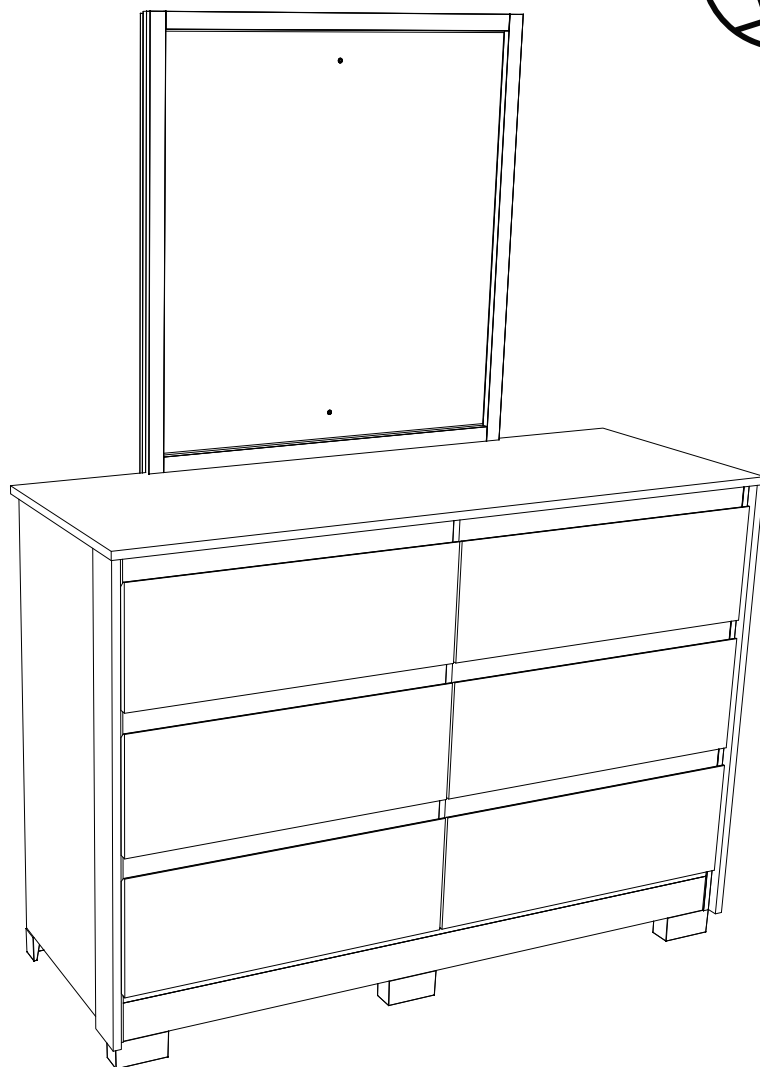

HENN

Ind. e Com. de Móveis Henn
Mondai - SC - Brasil

+55 49 3674.3500

@moveishenn
www.henn.com.br

ITM/D737-
INSTRUÇÕES DE MONTAGEM

INSTRUCCIONES DE MONTAJE
ASSEMBLY INSTRUCTIONS

Comoda Ravenna 06 Gavetas | Cómoda Ravenna 06 Cajones |
Dresser Ravenna 06 Drawers

D737-127 Nature/Off White
D737-130 Castanho HP II
D737-198 Jequitibá Brilho

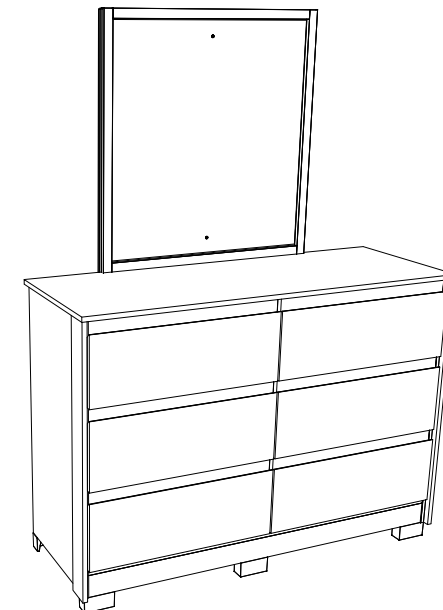
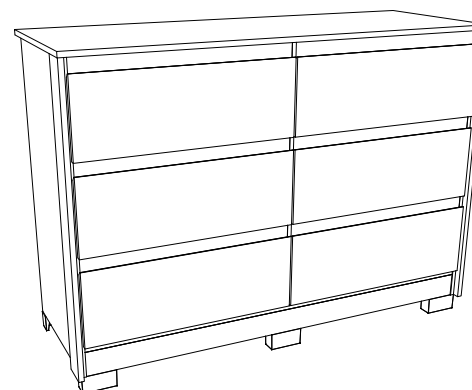

Requisitos para montagem
Requisitos para la montaje
Assembly Requirements

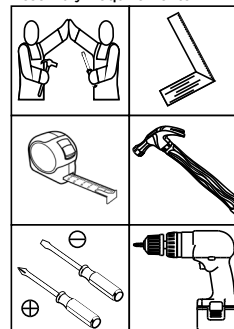

Imagens meramente ilustrativas,
não acompanha o produto.
Imágenes ilustrativas, no incluidas
con el producto.
Illustrative images, not included
with the product.

AVISO

Para limpeza de seu móvel, use uma flanela seca ou umedecida, e não utilize produtos químicos que possam danificar seu produto.

SISTEMA DE MONTAGEM

O sistema de montagem dos produtos, funciona de acordo com a ordem crescente dos números indicados no desenho. Ex: 01, 02, 03, 04... até a conclusão da montagem.

ASSISTÊNCIA TÉCNICA

Para solicitação de Assistência Técnica você consumidor deverá entrar em contato com o Lojista o qual você realizou a compra deste produto e solicitar a assistência técnica das peças avariadas. A garantia abrange todas as peças, partes e componentes que eventualmente venham apresentar defeito de fabricação no prazo de 03 (três) meses, contando a partir da entrega do produto ao consumidor, mediante nota fiscal de compra. Se houver qualquer alteração na estrutura do produto ou ocorrer defeito por negligência do montador/consumidor em relação a instrução de montagem e manuseio, não será fornecido assistência técnica gratuita.

ADVERTENCIA

Para limpieza de su móvil, use una flanela seca o húmeda, y no utilice productos químicos que puedan dañar su producto.

SISTEMA DE MONTAJE

El sistema de montaje de los productos funciona de acuerdo con el orden creciente de los números indicados en el dibujo. Ej.: 01, 02, 03, 04... hasta la conclusión del montaje.

ASISTENCIA TÉCNICA

Para solicitar Asistencia Técnica, el consumidor debe comunicarse con el Comercio que usted realizó la compra de este producto y solicita asistencia técnica para las partes dañadas. La garantía cubre todas las partes, piezas y componentes que eventualmente puedan presentar defecto de fabricación en el plazo de 03 (tres) meses, contados a partir de la entrega del producto al consumidor, mediante factura de compra. Si se produce algún cambio en la estructura del producto o se produce un defecto por negligencia del montador/consumidor en relación con las instrucciones de montaje y manipulación, no se prestará asistencia técnica gratuita.

NOTICE

To clean your furniture, use a dry or wet cloth, and do not use chemicals that may damage your product.

ASSEMBLY SYSTEM

The products' assembly system works according to the increasing order of the indicated numbers. For example: 01, 02, 03, 04 ... to the end of the assembly.

TECHNICAL ASSISTANCE

To request Technical Assistance, the consumer must contact the retailer from whom you purchased this product and request technical assistance for the damaged parts. The warranty covers all parts, parts and components that may eventually present a manufacturing defect within a period of 03 (three) months, counting from the delivery of the product to the consumer, by means of a purchase invoice. If there is any change in the structure of the product or defect occurs due to negligence of the assembler/consumer in relation to the assembly and handling instruction, free technical assistance will not be provided.

ACESSÓRIOS | ACCESORIOS | ACCESSORIES

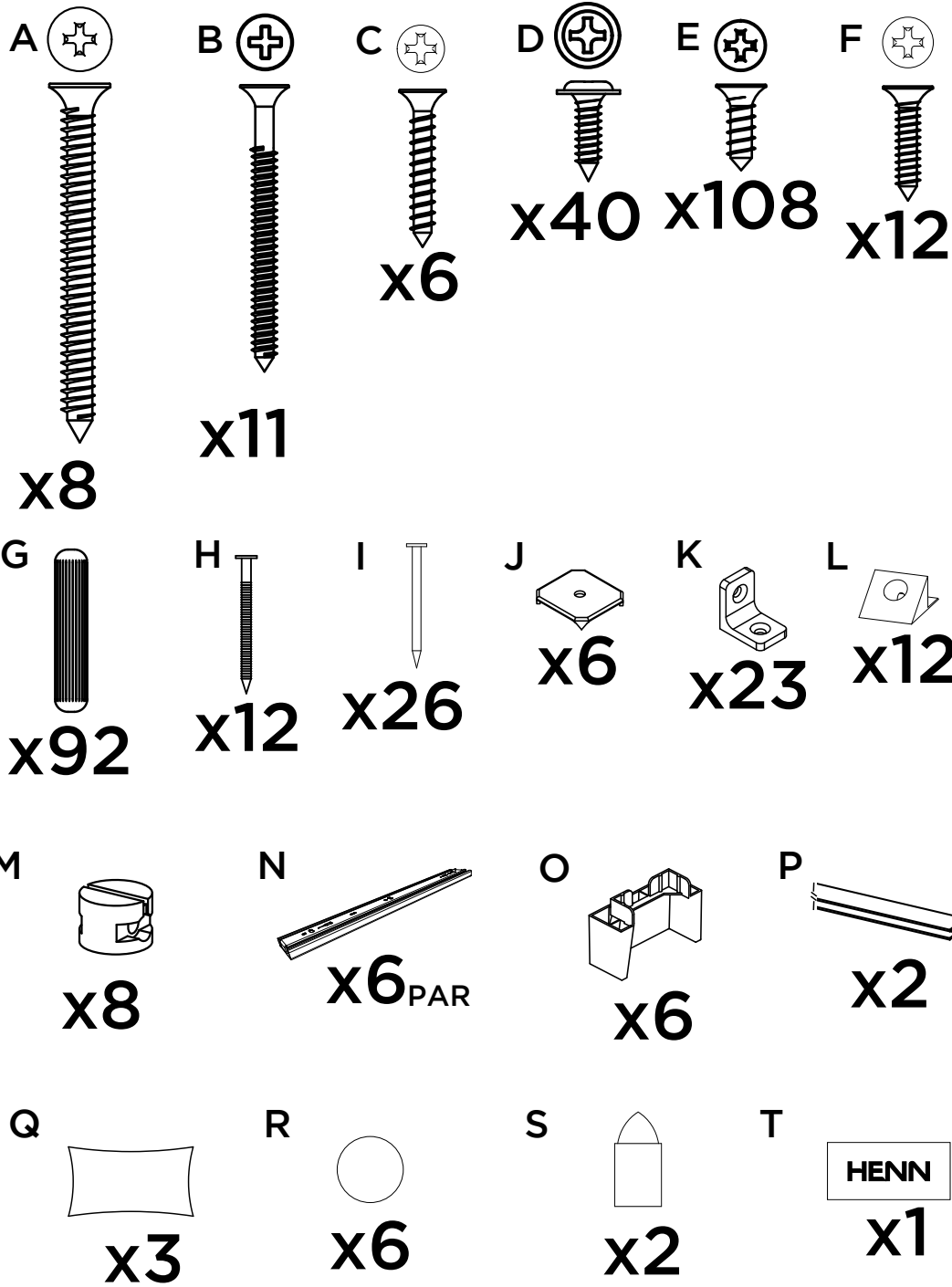

Parafusos em escala
Tornillos escalados
Scaled screws

PASSO 16

ACESSÓRIOS REQUERIDOS KIT

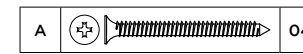

FERRAMENTAS NECESSÁRIAS

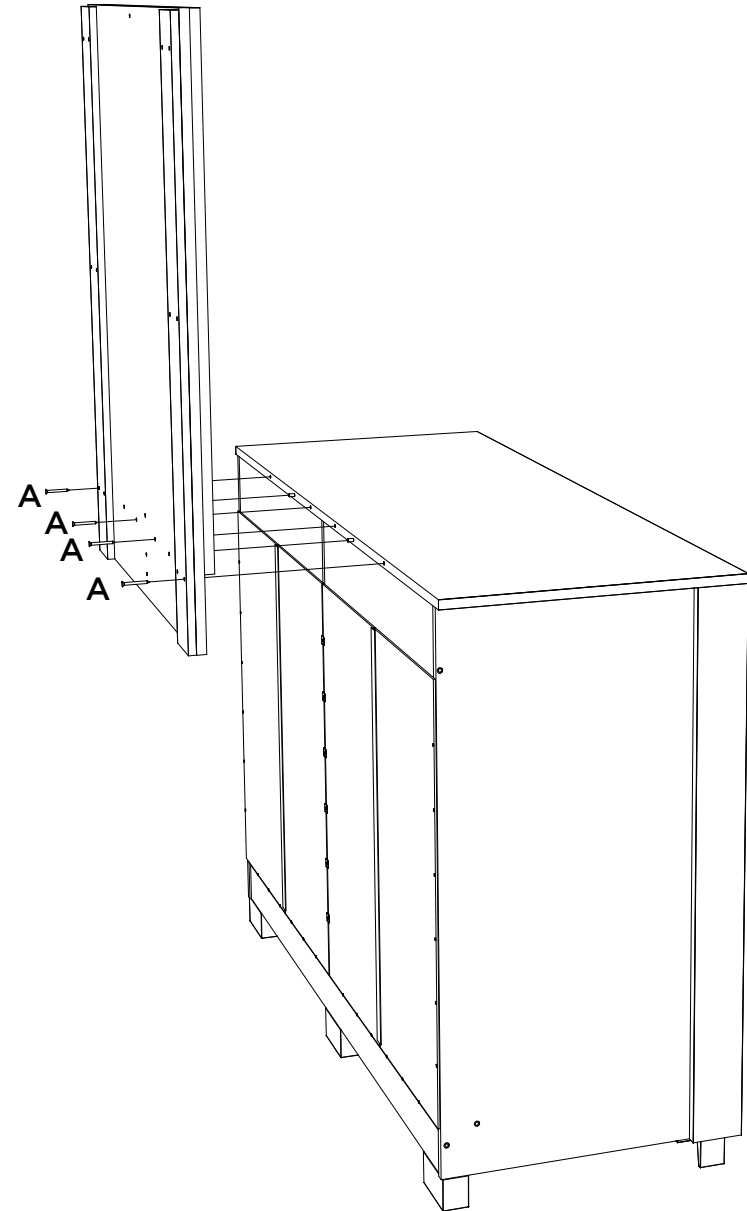
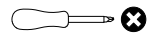

PASSO 14

ITM/D737-

PEÇAS REQUERIDAS

1	FUNDO ESPELHO	x1
2	ESPELHO	x1
3	TRAVESSA LATERAL	x2
4	TRAVESSA INFERIOR SUPERIOR	x2

ACESSÓRIOS REQUERIDOS KIT

B		12
---	---	----

FERRAMENTAS NECESSÁRIAS

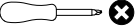

Esse Kit Espelho é opcional e é vendido separadamente (O967-64).

Este juego de espejos es opcional y se vende por separado (O967-64).

This Mirror Kit is optional and sold separately (O967-64).

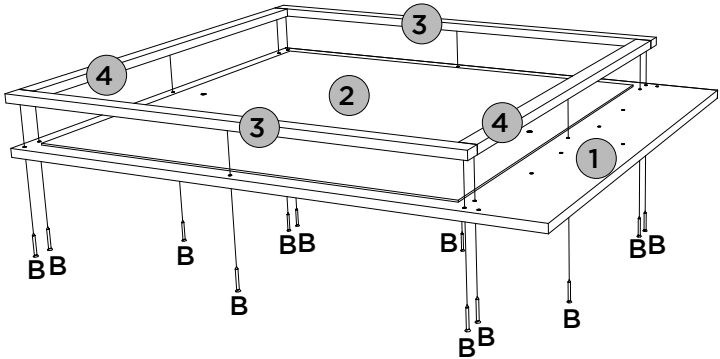

PASSO 15

PEÇAS REQUERIDAS

5	TRAVESSA ESTRUTURAL	x2
---	---------------------	----

ACESSÓRIOS REQUERIDOS KIT

B		10
---	--	----

FERRAMENTAS NECESSÁRIAS

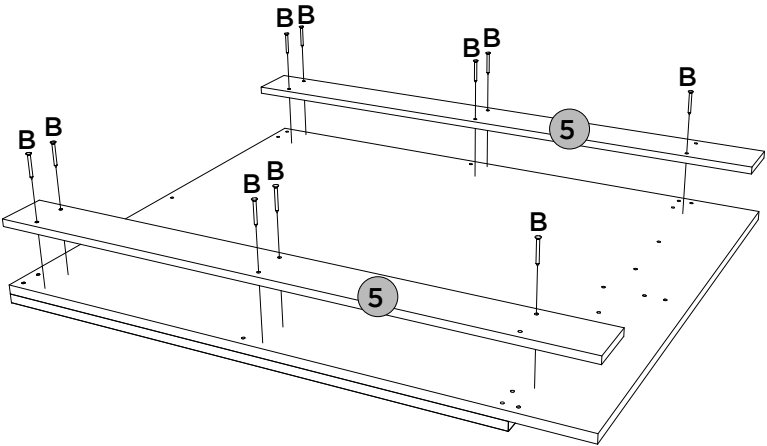
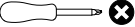

LISTA DE PEÇAS | LISTA DE PIEZAS | LIST OF PIECES

ITM/D737-

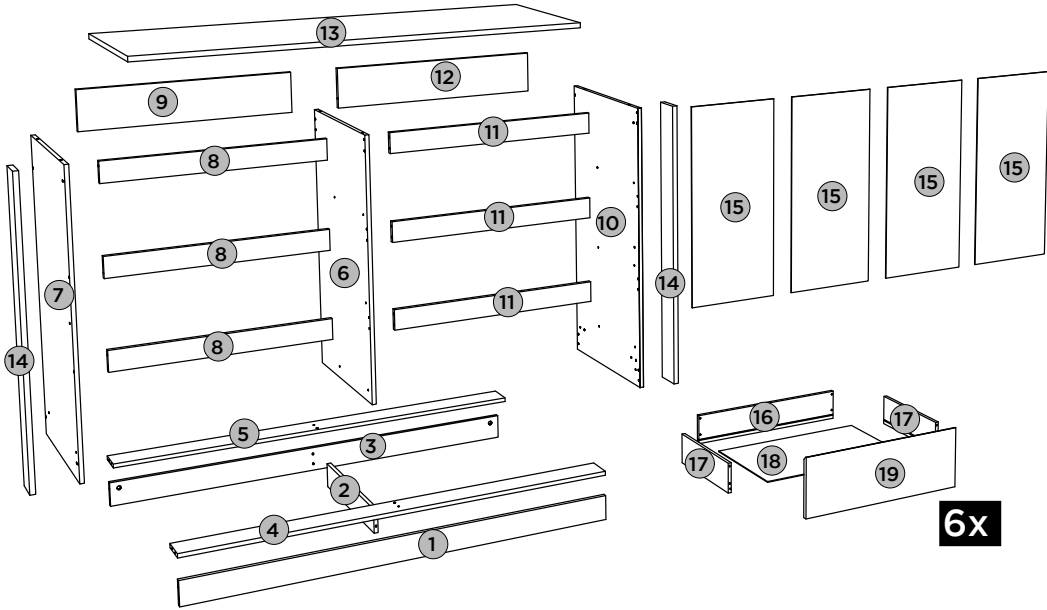

Item	Caixa Caja Box	Qty	Descrição Descripción Description	Dimensões (mm) Dimensiones (mm)		
				Comprimento Largo Length	Largura Ancho Width	Espesura Grosor Thickness
1	1/1	1	RODAPÉ FRONTAL PIE DE PÁGINA FRONTAL FRONT FOOTER	1240	73	12
2	1/1	1	TRAVESSA DO RODAPÉ TRAVESANO DE PIE DE PÁGINA FOOTER CROSSPIECE	425	73	12
3	1/1	1	RODAPÉ TRASEIRO ZÓCALO TRASERO REAR FOOTER	1240	73	12
4	1/1	1	TRAVESSA BASE FRONTAL TRAVESAÑO DE LA BASE DELANTERA FRONT BASE CROSSPIECE	1240	80	12
5	1/1	1	TRAVESSA BASE TRASEIRA TRAVESAÑO BASE TRASERO REAR BASE CROSS MEMBER	1240	80	12
6	1/1	1	DIVISÃO DIVISIÓN DIVISION	780	455	12
7	1/1	1	LATERAL ESQUERDA LATERAL IZQUIERDA LEFT SIDE	865	455	12
8=11	1/1	6	TRAVESSA GAVETA BANDEJA DEL CAJÓN DRAWER TRAY	614	60	12
9=12	1/1	2	TRAVESSA TRASEIRA MAIOR TRAVESAÑO TRASERO MÁS GRANDE LARGE REAR CROSS MEMBER	614	120	12
10	1/1	1	LATERAL DIREITA LATERAL DERECHA RIGHT SIDE	865	455	12
11=9	1/1	6	TRAVESSA GAVETA BANDEJA DEL CAJÓN DRAWER TRAY	614	60	12
12=10	1/1	2	TRAVESSA TRASEIRA MAIOR TRAVESAÑO TRASERO MÁS GRANDE LARGE REAR CROSS MEMBER	614	120	12
13	1/1	1	TAMPO CUBRIR COVER	1296	475	15
14	1/1	2	MOLDURA LATERAL MARCO LATERAL SIDE FRAME	865	80	15
15	1/1	4	FUNDO CRU FONDO CRUDO RAW BACKGROUND	681	313	3
16	1/1	6	RIPA DE TRÁS TABILLA TRASERA BACK CLAPBOARD	594	110	12
17	1/1	12	LADO DE GAVETA LADO DEL CAJÓN DRAWER SIDE	350	110	12
18	1/1	6	FUNDO DE GAVETA FONDO DEL CAJÓN DRAWER BOTTOM	581	361	3
19	1/1	6	FRENTE DE GAVETA FRENTE DEL CAJÓN DRAWER FRONT	622	220	15

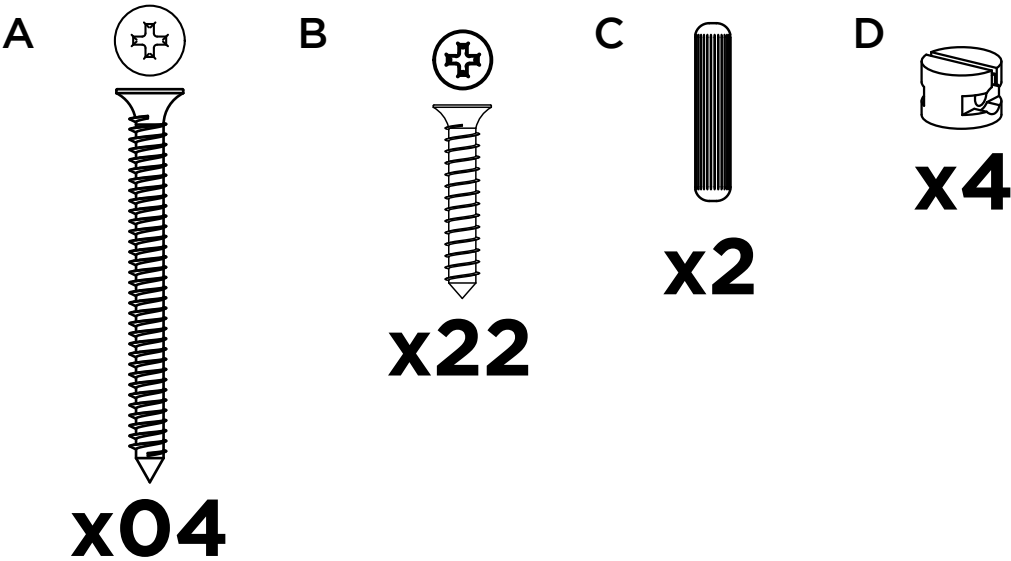

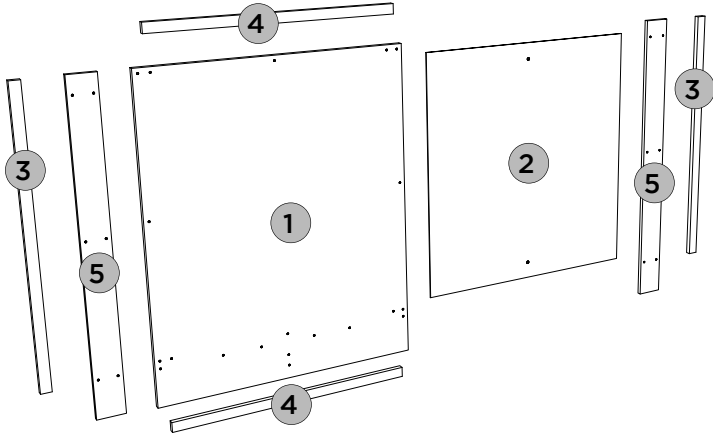

LISTA DE PEÇAS | LISTA DE PIEZAS | LIST OF PIECES



Item	Caixa Caja Box	Qty	Descrição Descripción Description	Dimensões (mm) Dimensiones (mm) Dimensions (mm)		
				Comprimento Largo Length	Largura Ancho Width	Espessura Grosor Thickness
1	1/1	01	FUNDO ESPELHO FONDO DEL ESPEJO MIRROR BACKGROUND	937	766	15
2	1/1	01	ESPELHO ESPEJO MIRROR	750	700	3
3	1/1	02	TRAVESSA LATERAL TRAVESAÑO LATERAL SIDE CROSSPIECE	817	766	15
4	1/1	02	TRAVESSA INFERIOR SUPERIOR TRAVESAÑO INFERIOR SUPERIOR UPPER BOTTOM CROSSPIECE	706	30	15
5	1/1	02	TRAVESSA ESTRUTURAL TRAVESAÑO ESTRUCTURAL STRUCTURAL CROSSPIECE	934	80	12

ACESSÓRIOS REQUERIDOS

R		06
S		02
T	HENIN	01

Pesos máximos recomendados com carga distribuída
Peso máximo recomendado con la carga distribuida
Recommended maximum weight with distributed load.

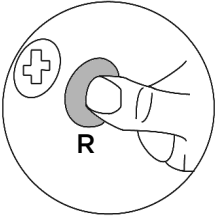
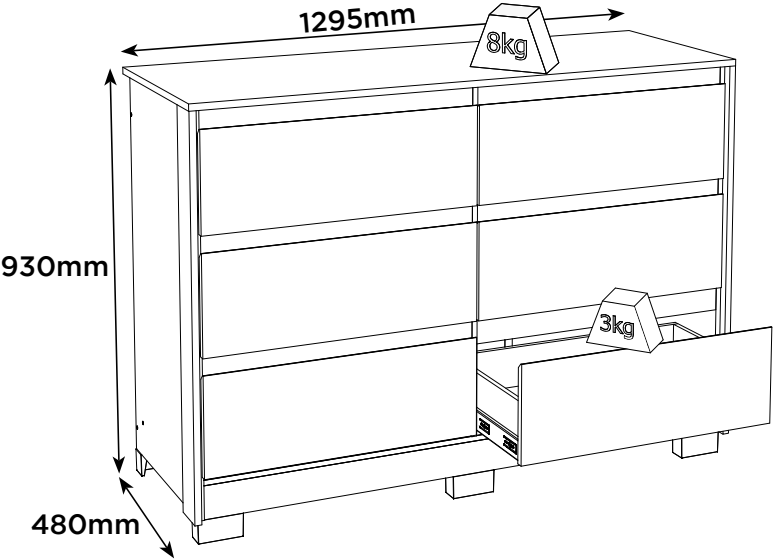

PERFECT CORRECTION
CORRECCIÓN PERFECTA

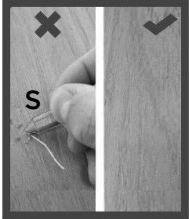

Produto Concluído
Producto terminado
Finished Product

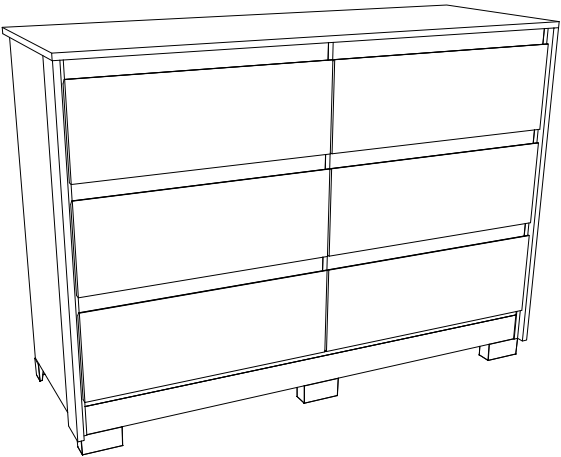

PASSO 12

ITM/D737-

PEÇAS REQUERIDAS

19	FRENTE DE GAVETA	x6
----	------------------	----

ACESSÓRIOS REQUERIDOS

E		60
F		12
K		12
L		12
N		06
Q		

FERRAMENTAS NECESSÁRIAS



6x
3º

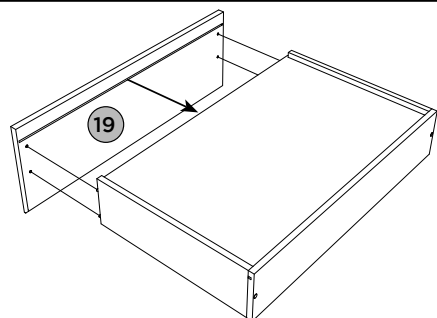

6x
4º

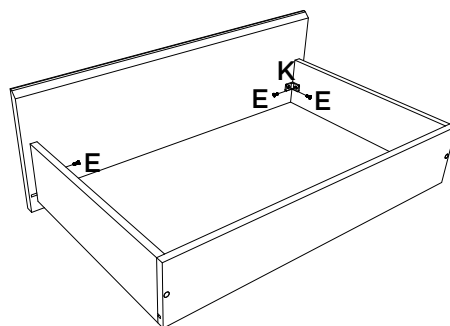
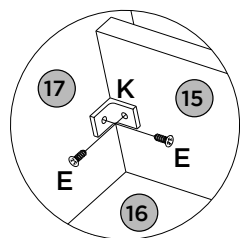

6x
5º

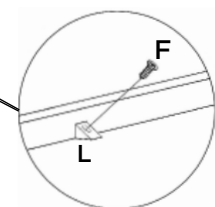
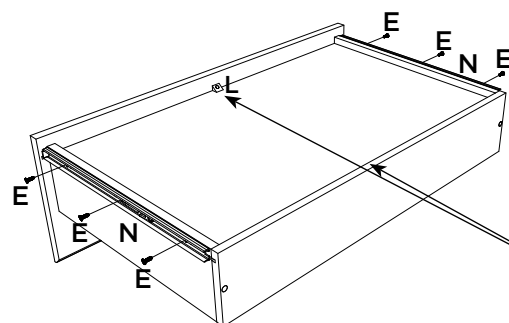

PASSO 1

ITM/D737-

PEÇAS REQUERIDAS

1	RODAPÉ FRONTAL	x1
2	TRAVESSA DO RODAPÉ	x1
3	RODAPÉ TRASEIRO	x1
4	TRAVESSA BASE FRONTAL	x1
5	TRAVESSA BASE TRASEIRA	x1

ACESSÓRIOS REQUERIDOS

D		02
G		12
K		02
M		08

FERRAMENTAS NECESSÁRIAS

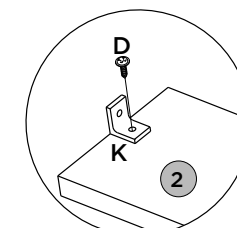
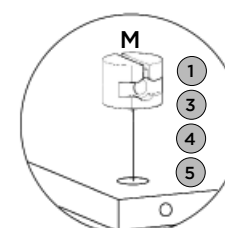
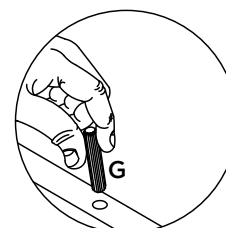
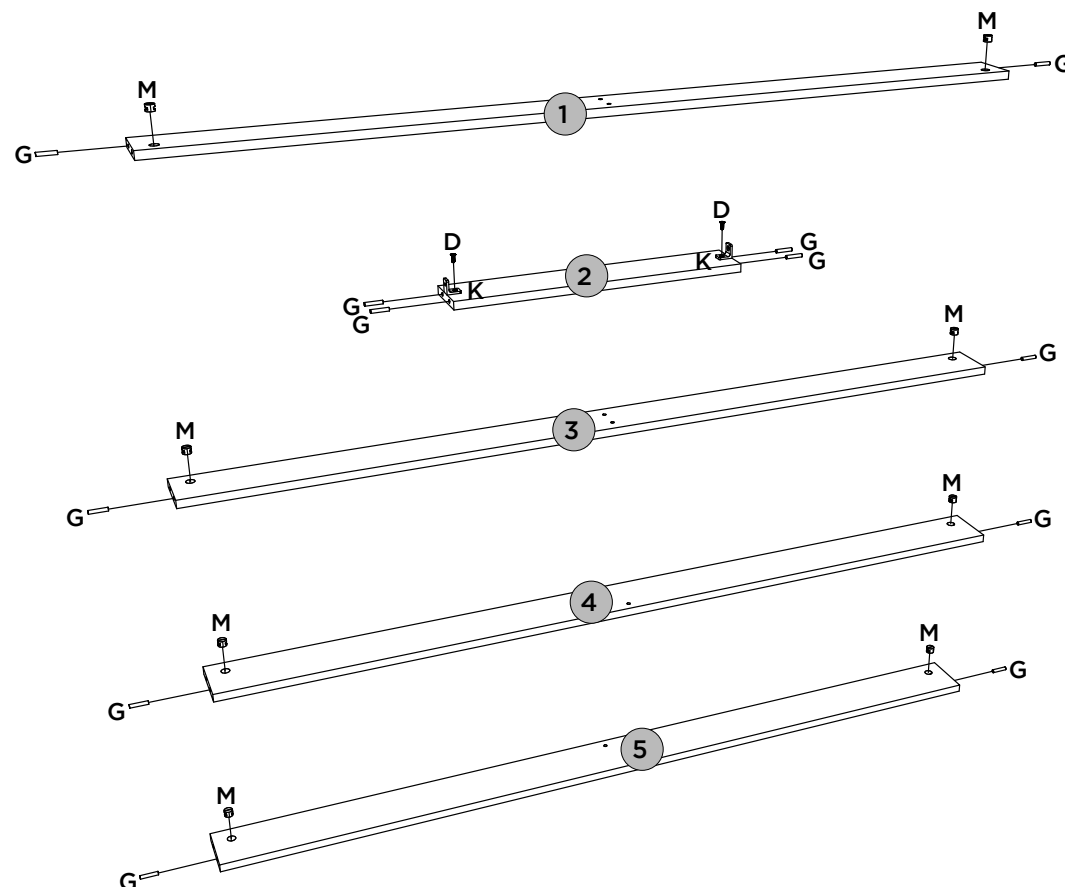
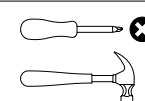

PASSO 2

ITM/D737-

PEÇAS REQUERIDAS

6	DIVISÃO	x1
7	LATERAL ESQUERDA	x1
8=11	TRAVESSA GAVETA	x6
9=12	TRAVESSA TRASEIRA MAIOR	x2
10	LATERAL DIREITA	x1

ACESSÓRIOS REQUERIDOS

E		36
G		32
N		06

FERRAMENTAS NECESSÁRIAS

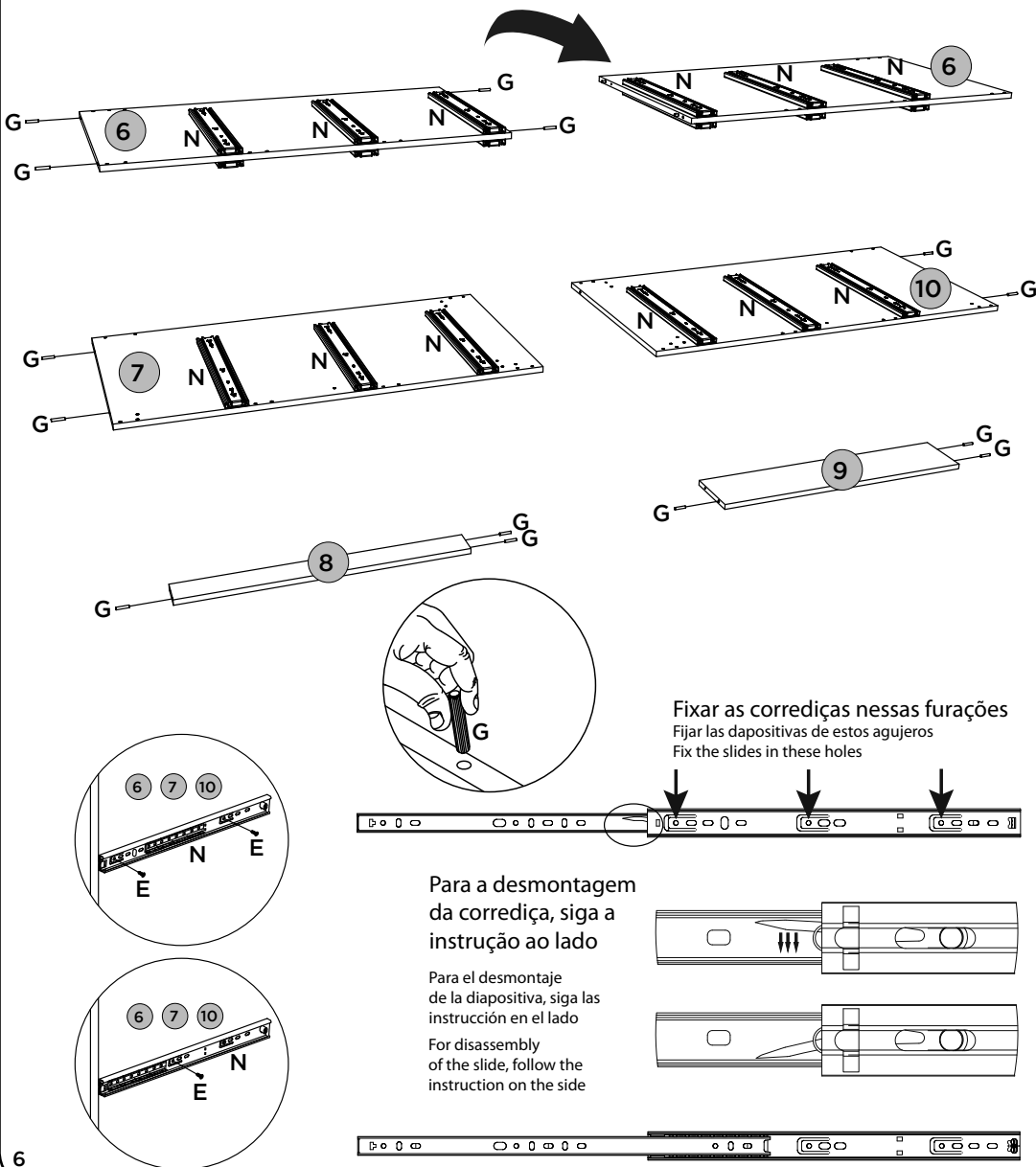
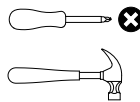

PASSO 10

ITM/D737-

PEÇAS REQUERIDAS

17	LADO DE GAVETA	x12
----	----------------	-----

ACESSÓRIOS REQUERIDOS

G		48
Q		

FERRAMENTAS NECESSÁRIAS

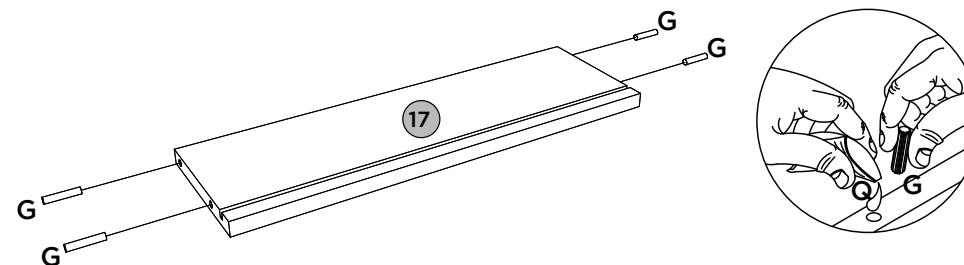

PASSO 11

PEÇAS REQUERIDAS

16	RIPA DE TRÁS	x6
17	LADO DE GAVETA	x12
18	FUNDO DE GAVETA	x6

ACESSÓRIOS REQUERIDOS

H		12
Q		

FERRAMENTAS NECESSÁRIAS

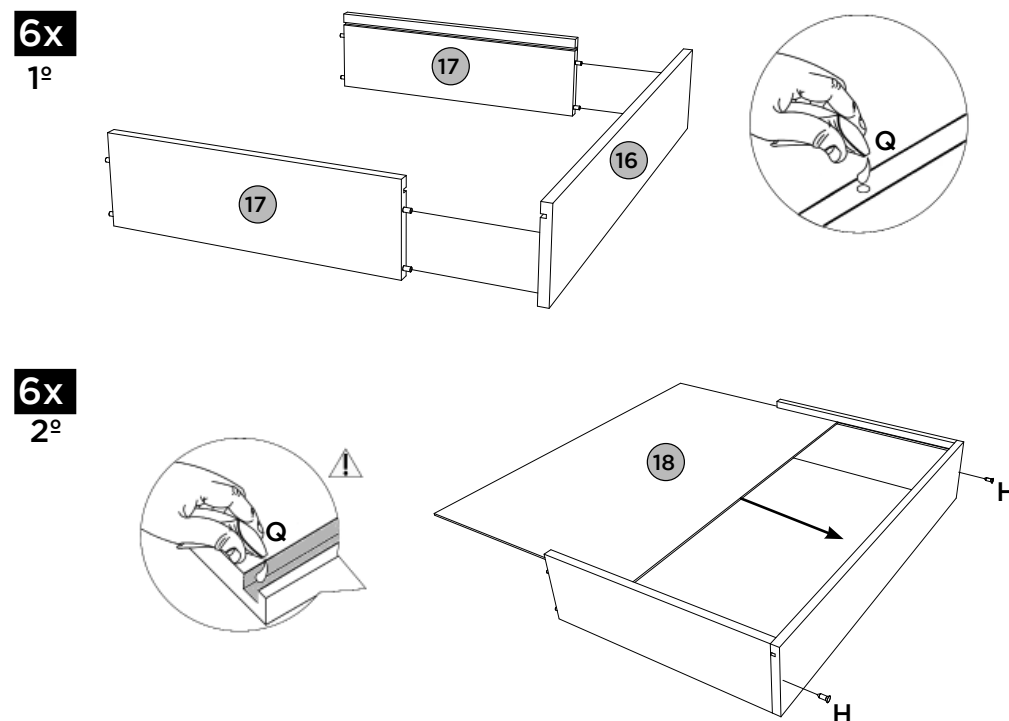



PASSO 9

ITM/D737-

PEÇAS REQUERIDAS

15	FUNDO	x4
----	-------	----

ACESSÓRIOS REQUERIDOS

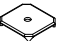
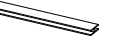
E		12
I		26
J		06
P		02

FERRAMENTAS NECESSÁRIAS

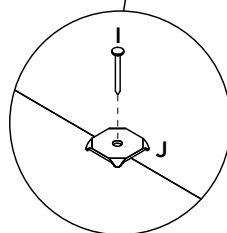
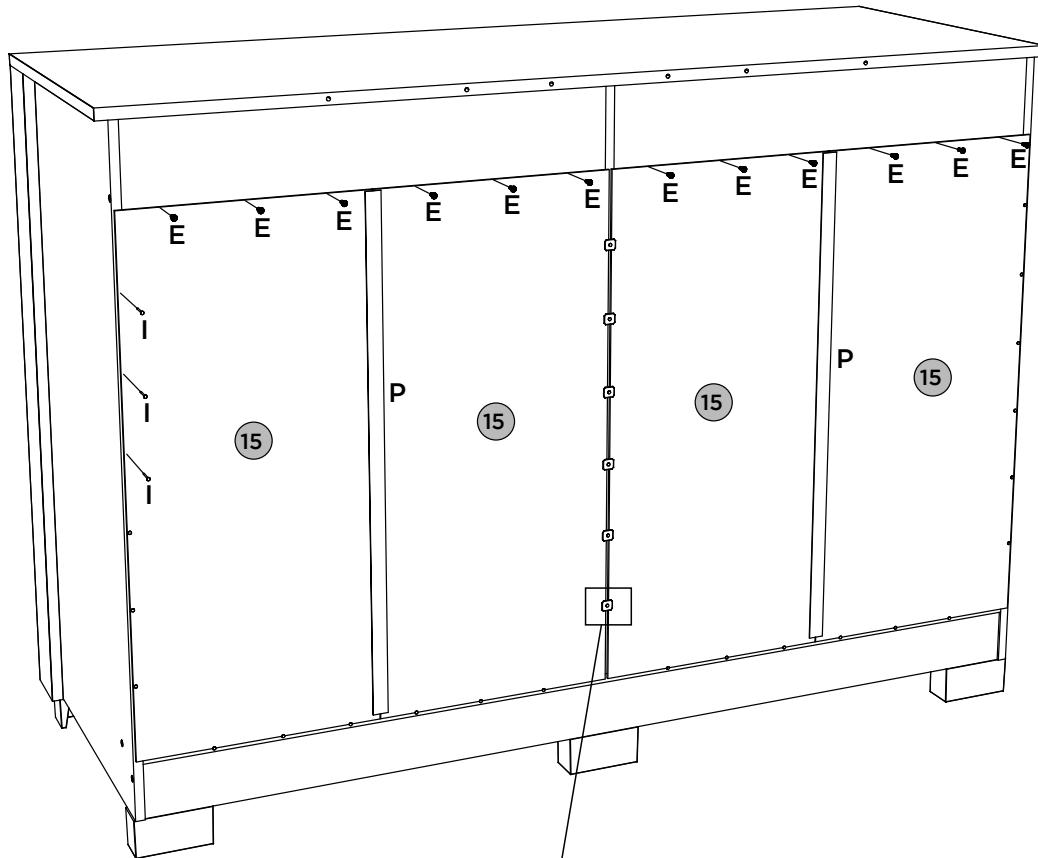
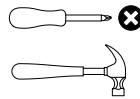

Fixar os pregos a uma distância de 100mm de um para outro.

Fijar las uñas a un distancia de 100mm uno a otro.

Fix the nails at a distance of 100mm from one to the other

PASSO 3

ITM/D737-

PEÇAS REQUERIDAS

1	RODAPÉ FRONTAL	x1
2	TRAVESSA DO RODAPÉ	x1
3	RODAPÉ TRASEIRO	x1

ACESSÓRIOS REQUERIDOS

D		02
---	---	----

FERRAMENTAS NECESSÁRIAS

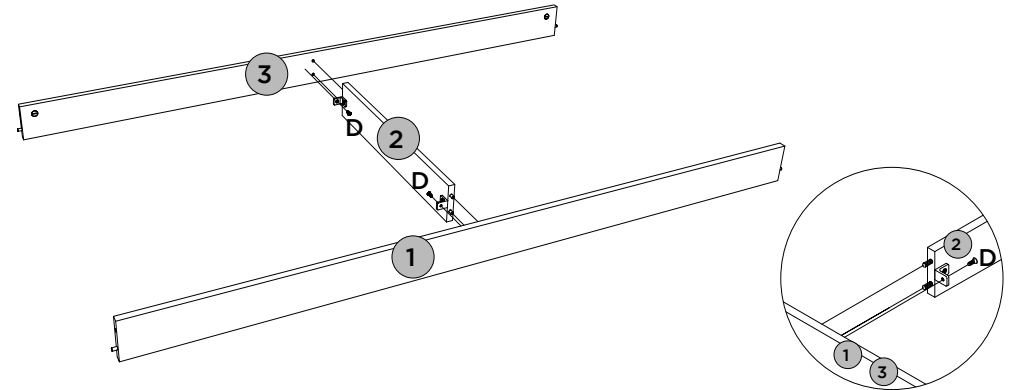
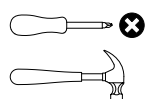

PASSO 4

PEÇAS REQUERIDAS

4	TRAVESSA BASE FRONTAL	x1
5	TRAVESSA BASE TRASEIRA	x1
6	DIVISÃO	x1

ACESSÓRIOS REQUERIDOS

B		02
---	---	----

FERRAMENTAS NECESSÁRIAS

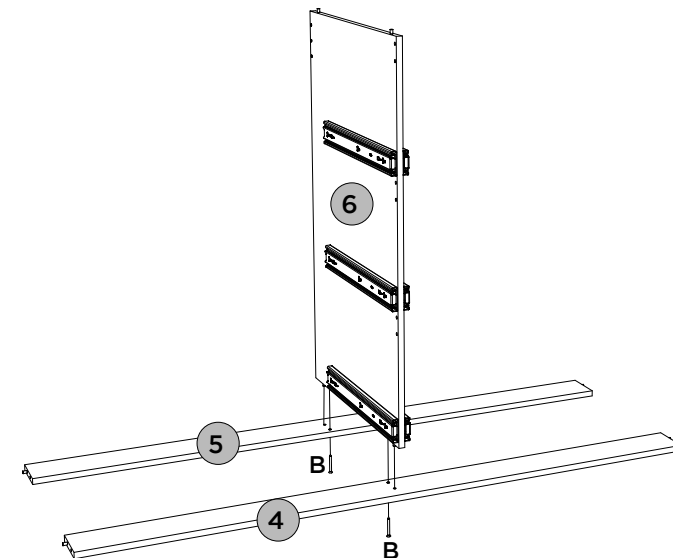
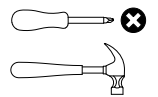





PASSO 5

ITM/D737-

PEÇAS REQUERIDAS

7	LATERAL ESQUERDA	x1
8	TRAVESSA GAVETA	x3
9	TRAVESSA TRASEIRA MAIOR	x1

ACESSÓRIOS REQUERIDOS

A		04
B		05
D		26
K		04
O		06

FERRAMENTAS NECESSÁRIAS

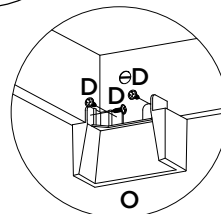
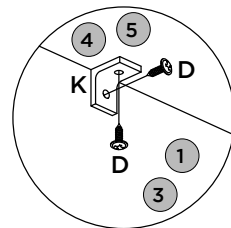
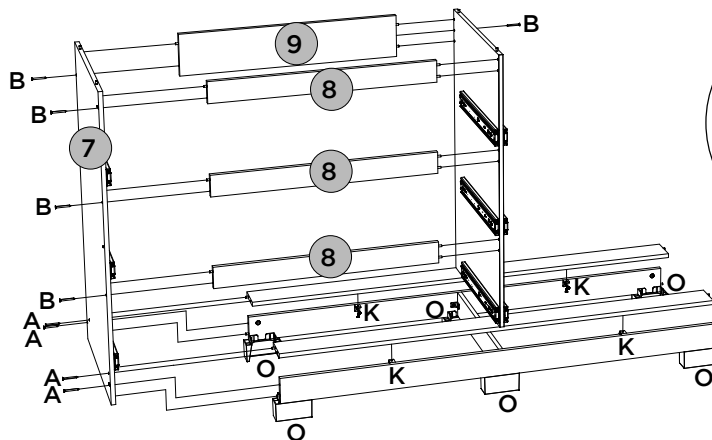
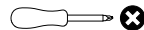



PASSO 6

PEÇAS REQUERIDAS

10	LATERAL DIREITA	x1
11	TRAVESSA GAVETA	x3
12	TRAVESSA TRASEIRA MAIOR	x1

ACESSÓRIOS REQUERIDOS

A		04
B		04

FERRAMENTAS NECESSÁRIAS

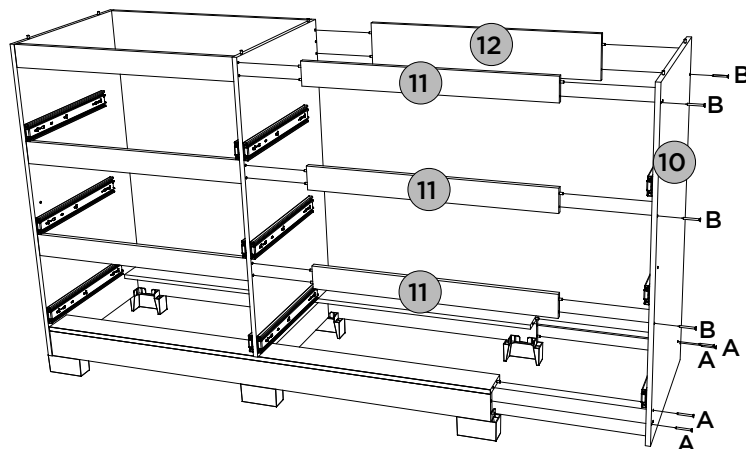
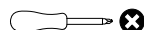

PASSO 7

ITM/D737-

PEÇAS REQUERIDAS

13	TAMPO	x1
----	-------	----

ACESSÓRIOS REQUERIDOS KIT

C		x2
D		x4

FERRAMENTAS NECESSÁRIAS

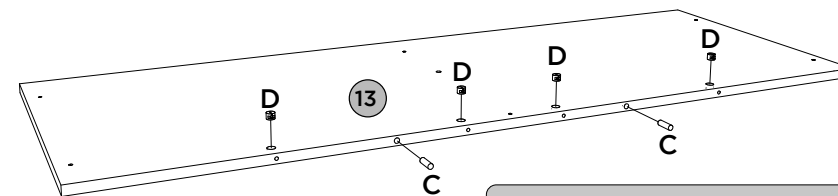

Se o Kit (O967-64) for adquirido, é necessário inserir a porca cilíndrica (D) e a cavilha (C) no Tampo (13) antes de ser fixado ao produto.

Si se compra el Kit (O967-64), es necesario insertar la tuerca cilíndrica (D) y el pasador (C) en la Tapa (13) antes de fijarla al producto.



If the Kit (O967-64) is purchased, it is necessary to insert the cylindrical nut (D) and the pin (C) in the Cover (13) before fixing it to the product.

PASSO 8

PEÇAS REQUERIDAS

13	TAMPO	x1
14	MOLDURA LATERAL	x2

ACESSÓRIOS REQUERIDOS

C		06
D		10
K		05

FERRAMENTAS NECESSÁRIAS

