

Limpar o número da peça com pano levemente umedecido com álcool



Clean the part number with a cloth slightly dampened with alcohol



Limpiar el número de la pieza con un paño ligeramente humedecido con alcohol.

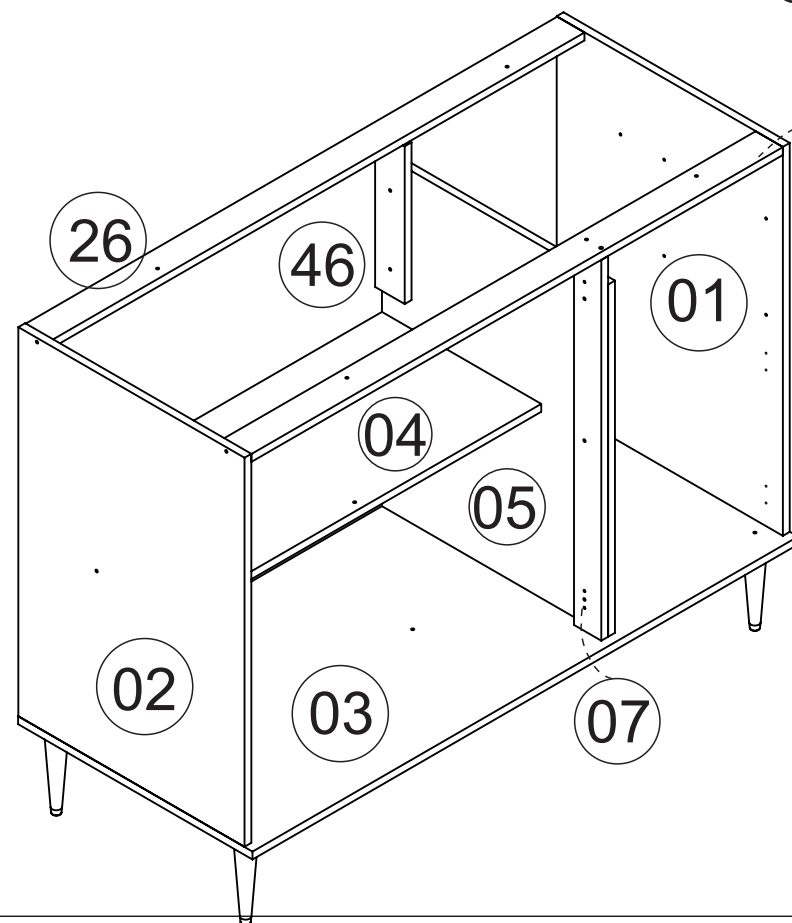

06

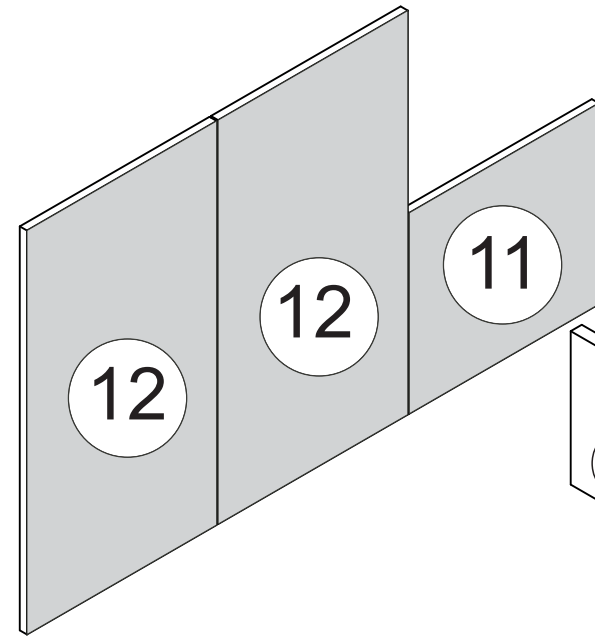

A		CAVILHA Ø6X30 CLAVIJA Ø6X30 WOOD DOWEL Ø6X30	23
B		PARAFUSO CC 3,5X14 TORNILLO CC 3,5X14 SCREW CC 3,5X14	22
C		PARAFUSO CC 3,5X40 TORNILLO CC 3,5X40 SCREW CC 3,5X40	17
DB		DOBRADIÇA BISAGRA HINGE	06
F		PARAFUSO CF 4,5X50 TORNILLO CF 4,5X50 SCREW CF 4,5X50	06
M		PREGO 10X10 NAIL	80
Z		PARAFUSO CF 3,5X25 TORNILLO CF 3,5 X 25 SCREW CF 3,5X25	23
U		ADESIVO TAPA FURO ADHESIVO STICKER	05
V		COLA PEGAMENTO GLUE	01
PE		PÉ PIE FOOT	05
PX		PUXADOR TIRADOR HANDLE	05
G		SUPORTE FIXAÇÃO SOPORTE DE FIJACIÓN FIXING SUPPORT	01
H		PROTEÇÃO SUP CANTONEIRA PROTECCIÓN ANGLE BRACKET	01
I		BUCHA PLÁSTICA CASQUILLO BUSHING	01
CR		CORREDIÇA 350 CORREDERA SLIDE	02
X		FIXADOR COSTA FIJADOR DE ESPALDA BACK FIXER	08

Lista de ferragens
Lista de materiales
Hardware list

Lista de peças / Parts lists / Lista de piezas

REF	DESC	COMP	LARG	ESP	QTD.
IS1500-01	LATERAL DIREITA/LADO DERECHO/RIGHT SIDE	740	497	15	1
IS1500-02	LATERAL ESQUERDA/LADO IZQUIERDO/LEFT SIDE	740	497	15	1
IS1500-03	BASE/BASE/BASE	1199	515	15	1
IS1500-04	PRATELEIRA/ESTANTE/SHELF	784	350	15	1
IS1500-05	DIVISAO/DIVISION/DIVISION	670	497	15	1
IS1500-06	TRAVESSA FRONTAL/TRAVESAN~I/LONG PLATE	1168	60	15	1
IS1500-07	PILASTRA/PILLAR/PILAR	724	60	15	1
IS1500-11	PORTA/PUERTA/DOOR	396	363	15	1
IS1500-12	PORTA/PUERTA/DOOR	396	730	15	2
IS1500-15	LATERAL GAVETA/CAJÓN LATERAL/SIDE DRAWER	380	82	15	4
IS1500-18	COSTA GAVETA/FONDO DEL CAJÓN/FONDO/BACK	314	82	15	2
IS1500-20	FRENTE GAVETA/FRENTE DE CAJÓN/DRAWER FRONT	396	180	15	2
IS1500-26	TRAVESSA TRASERA/TRAVESAN~I/LONG PLATE	1168	60	15	1
IS1500-46	TRAVESSA SUSTENTACAO/TRAVESAN~I/LONG PLATE	300	65	15	1
IS1500-60	COSTA/FONDO/BACK	383	342	3	2
IS1500-61	COSTA/FONDO/BACK	373	1190	3	2

J		TAMBOR MINIFIX TAMBOR MINIFIX MINIFIX DRUM	04
K		TAMBOR MINIFIX TORNILLO MINIFIX MINIFIX SCREW	04



FERRAMENTAS NECESSÁRIAS:
HERRAMIENTAS NECESARIAS:
NECESSARY TOOLS:

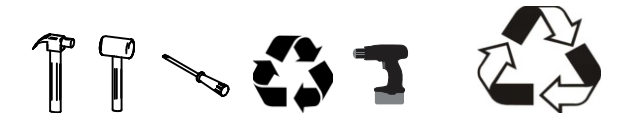

"IMPORTANTE LER COM ATENÇÃO E GUARDAR PARA EVENTUAIS CONSULTAS".

"IMPORTANTE LEER CON ATENCIÓN Y GUARDAR PARA EVENTUALES CONSULTAS".
"IMPORTANT TO READ CAREFULLY AND SAVE FOR ANY QUERIES".

IS 1500

Instruções de Montagem / Assembly Instructions / Instrucciones de Montaje

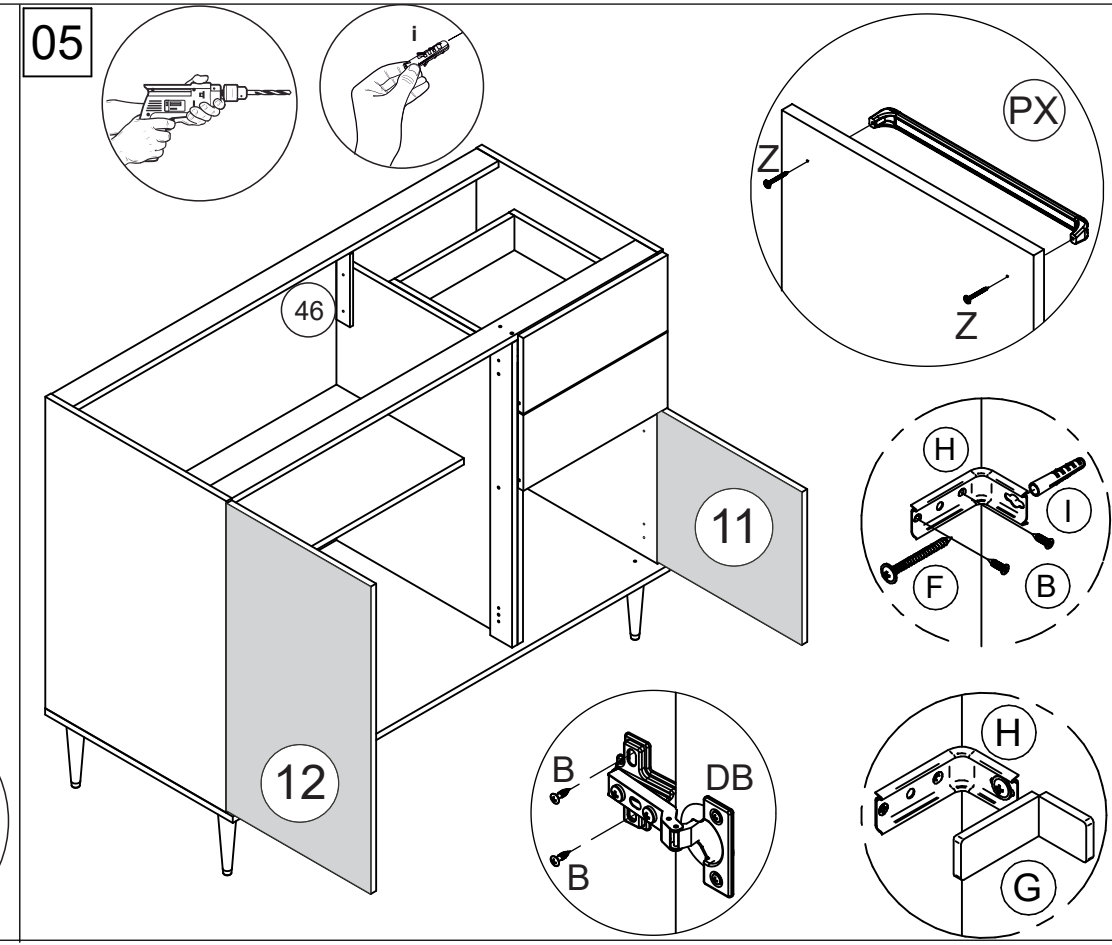
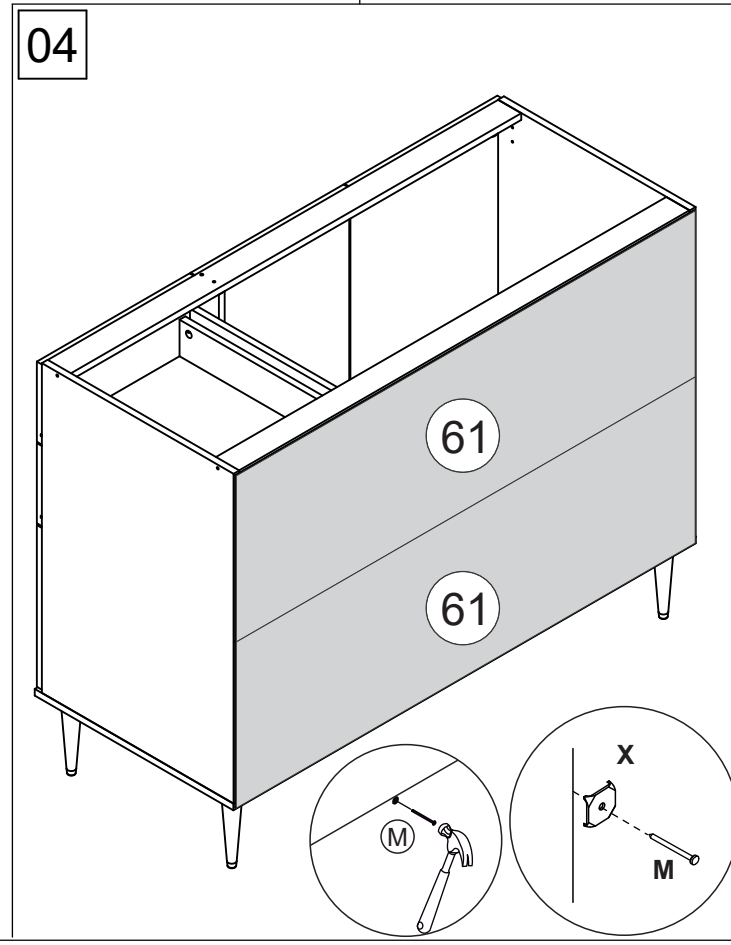
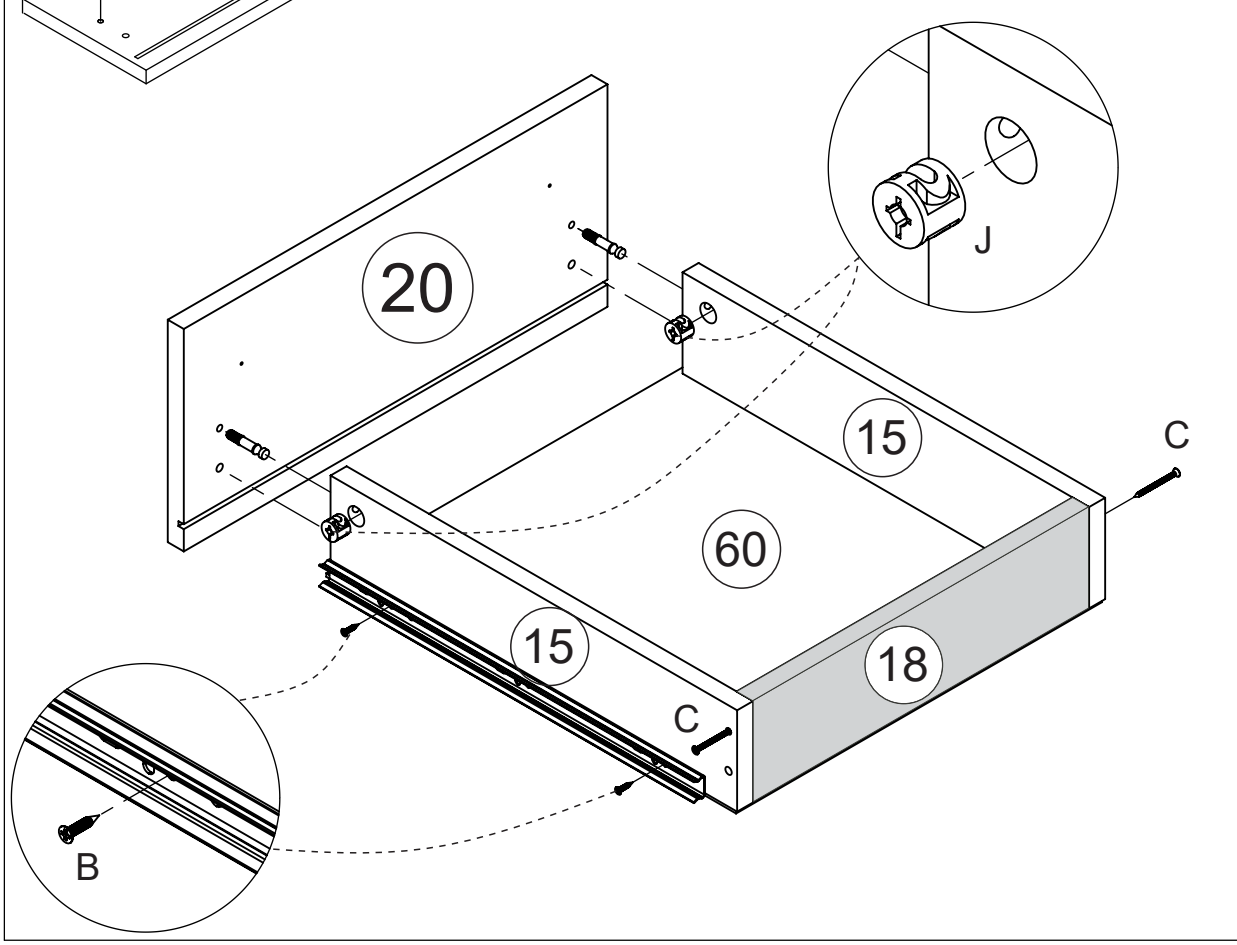
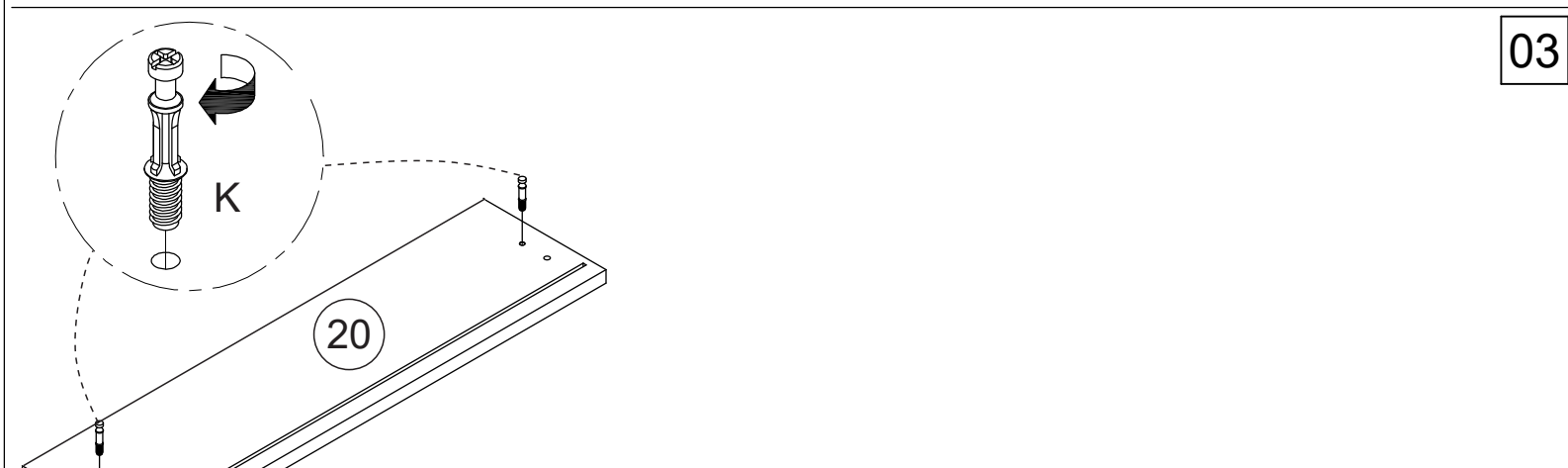
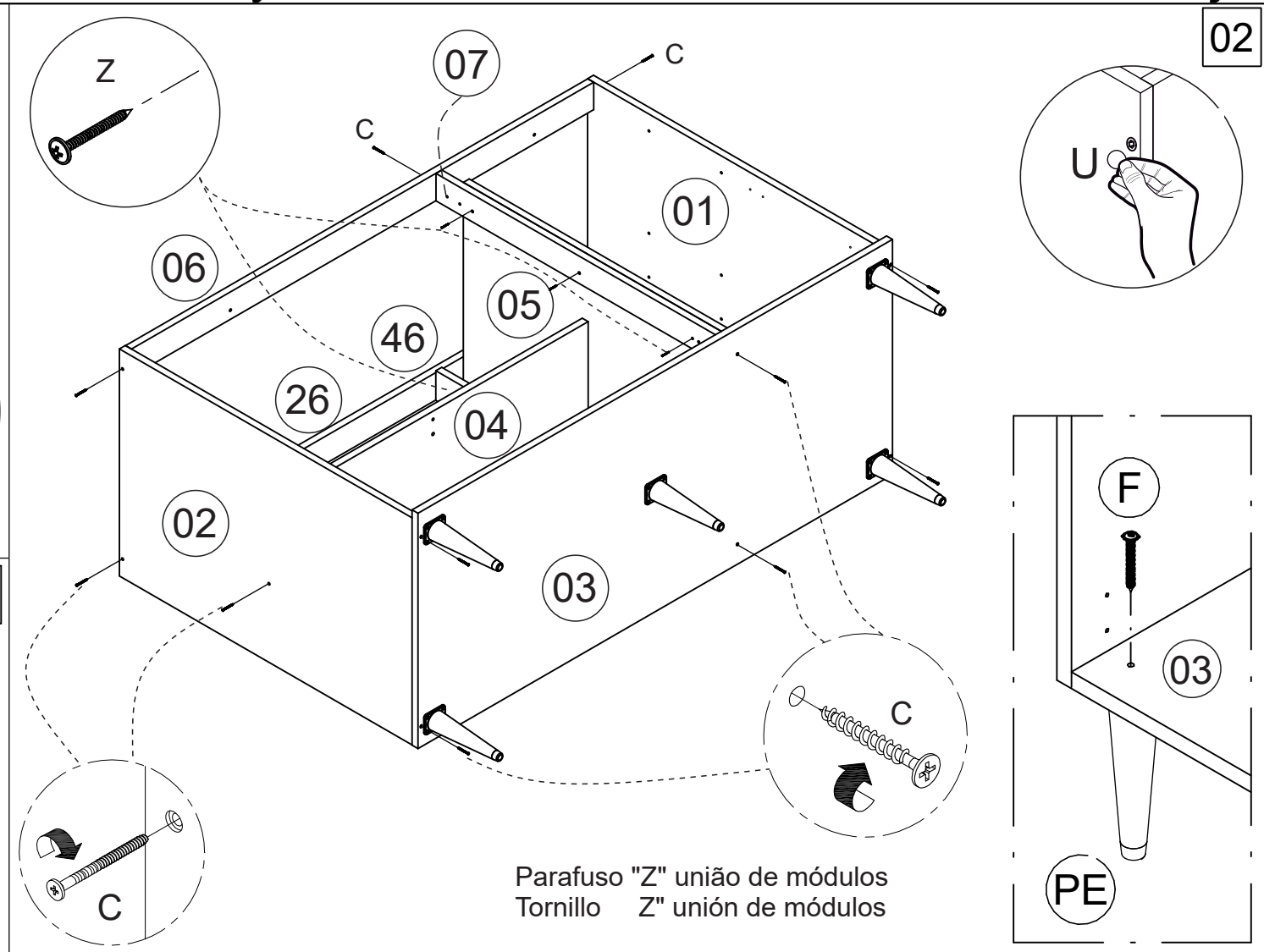
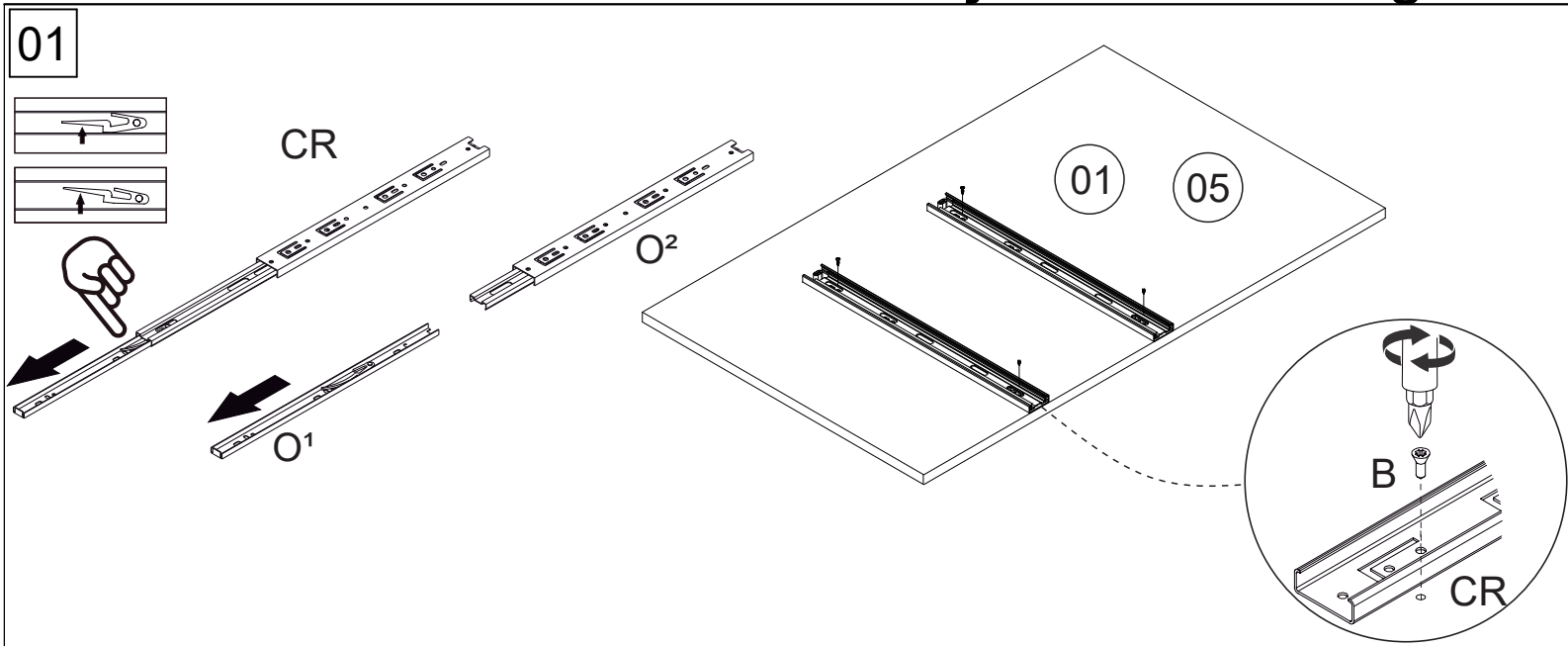

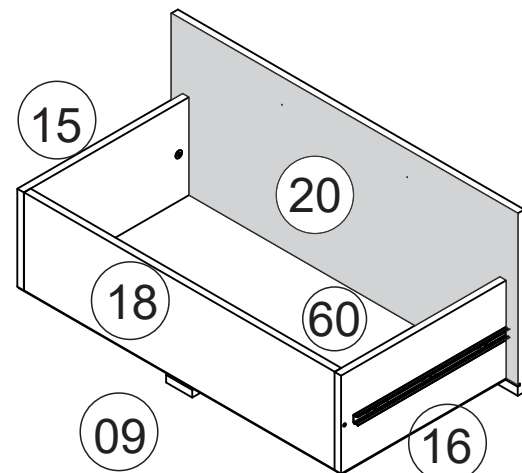
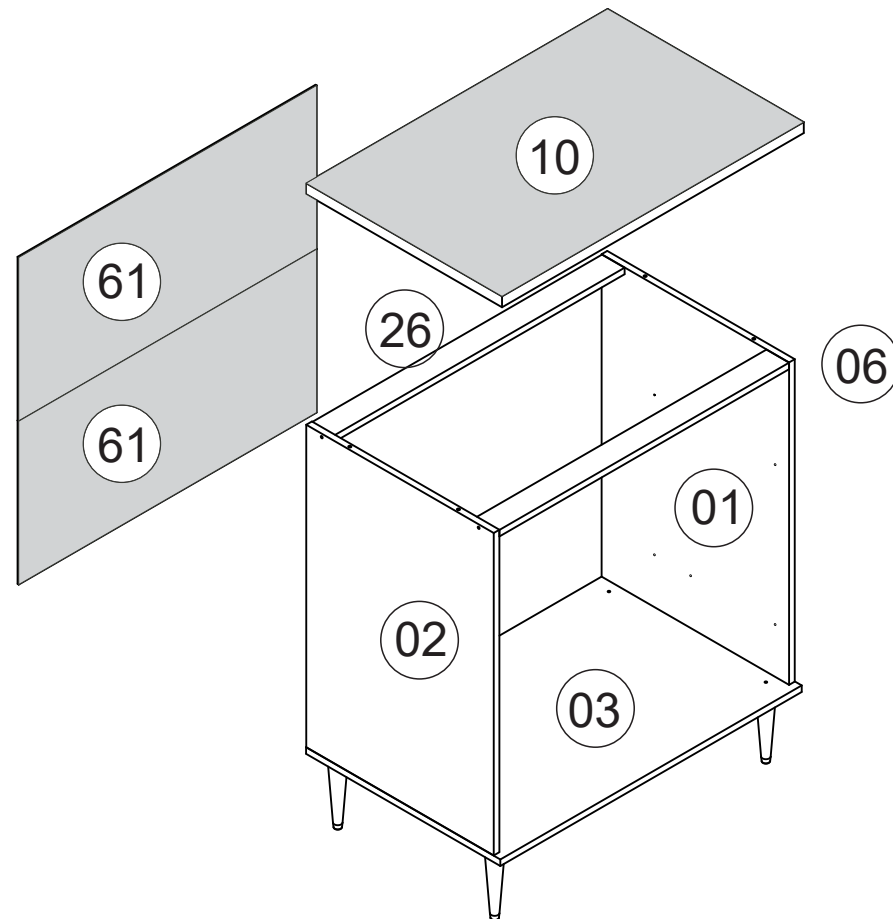

Lista de ferragens

Lista de materiales Hardware list

A		CAVILHA Ø6X30 CLAVIJA Ø6X30 WOOD DOWEL Ø6X30	30
B		PARAFUSO CC 3,5X14 TORNILLO CC 3,5X14 SCREW CC 3,5X14	26
C		PARAFUSO CC 3,5X40 TORNILLO CC 3,5X40 SCREW CC 3,5X40	14
F		PARAFUSO CF 4,5X50 TORNILLO CF 4,5X50 SCREW CF 4,5X50	05
M		PREGO 10X10 CLAVO 10X10 NAIL	75
Z		PARAFUSO CF 3,5X25 TORNILLO CF 3,5 X 25 SCREW CF 3,5X25	11
U		ADESIVO TAPA FURO STICKER	04
V		COLA PEGAMENTO GLUE	01
PE		PÉ PIE FOOT	04
PX		PUXADOR TIRADOR HANDLE	02
G		SUPORTE FIXAÇÃO SOPORTE DE FIJACIÓN FIXING SUPPORT	01
H		PROTEÇÃO SUP CANTONEIRA PROTECCIÓN ANGLE BRACKET	01
I		BUCHA PLÁSTICA CASQUILLO BUSHING	01
H		PERFIL PERFIL PROFILE	01
CR		CORREDIÇA 350 CORREDERA SLIDE	02

Lista de peças / Parts lists / Lista de piezas

REF	DESC	COMP	LARG	ESP	QTD.
IS1511-01	LATERAL DIREITA/LADO DERECHO/RIGHT SIDE	740	497	15	1
IS1511-02	LATERAL ESQUERDA/LADO IZQUIERDO/LEFT SIDE	740	497	15	1
IS1511-03	BASE/BASE/BASE	799	515	15	1
IS1511-06	TRAVESSA FRONTAL/TRAVESAN~I/LONG PLATE	768	60	15	1
IS1511-09	APOIO/SOPORTE/SHELF	380	60	15	2
IS1511-10	TAMPO/TAPA/TOP	800	520	25	1
IS1511-15	LATERAL GAVETA DIR/CAJÓN LATERAL/SIDE DRAWER	380	195	15	2
IS1511-16	LATERAL GAVETA ESQ/CAJÓN LATERAL/SIDE DRAWER	380	195	15	2
IS1511-18	COST GAVETA ESQ/CAJÓN COSTADO/SIDE DRAWER	714	195	15	2
IS1511-20	FRENTE GAVETA/FRENTE DE CAJÓN/DRAWER FRONT	796	363	15	2
IS1511-26	TRAVESSA TRASERA/TRAVESAN~I/LONG PLATE	768	60	15	1
IS1511-60	COSTA/FONDO/BACK	383	742	3	2
IS1511-61	COSTA/FONDO/BACK	375	790	3	2

J		TAMBOR MINIFIX TAMBOR MINIFIX MINIFIX DRUM	04
K		TAMBOR MINIFIX TORNILLO MINIFIX MINIFIX SCREW	04

FERRAMENTAS NECESSÁRIAS:

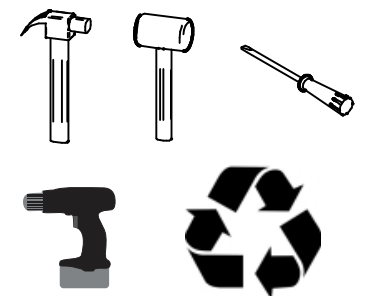

FERRAMENTAS NECESSÁRIAS: HERRAMIENTAS NECESSÁRIAS: NECESSARY TOOLS:



**"IMPORTANT LER COM ATENÇÃO
E GUARDAR PARA EVENTUAIS
CONSULTAS".**

**"IMPORTANT LEER CON ATENCIÓN Y GUARDAR PARA
EVENTUALES CONSULTAS".
"IMPORTANT TO READ CAREFULLY AND SAVE FOR ANY
QUERIES".**



Limpar o número da peça com pano levemente umedecido com álcool



Clean the part number with a cloth slightly dampened with alcohol



Limpiar el número de la pieza con un paño ligeramente humedecido con alcohol.

IS 1511

Instruções de Montagem / Assembly Instructions / Instrucciones de Montaje

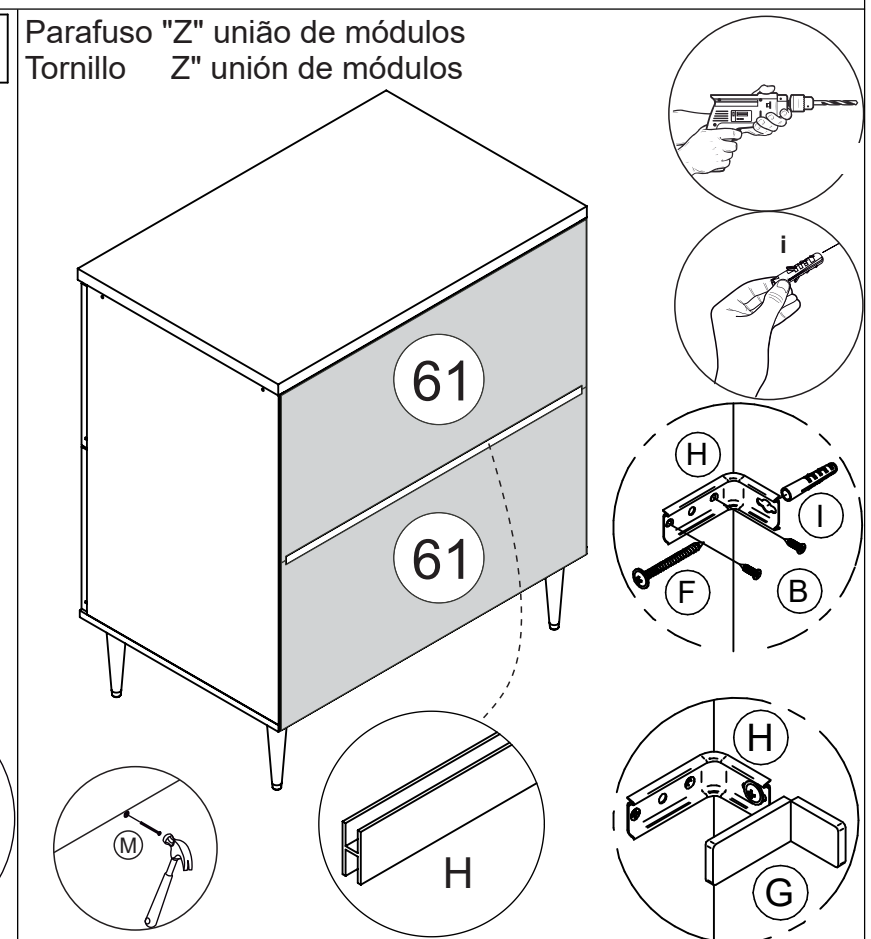
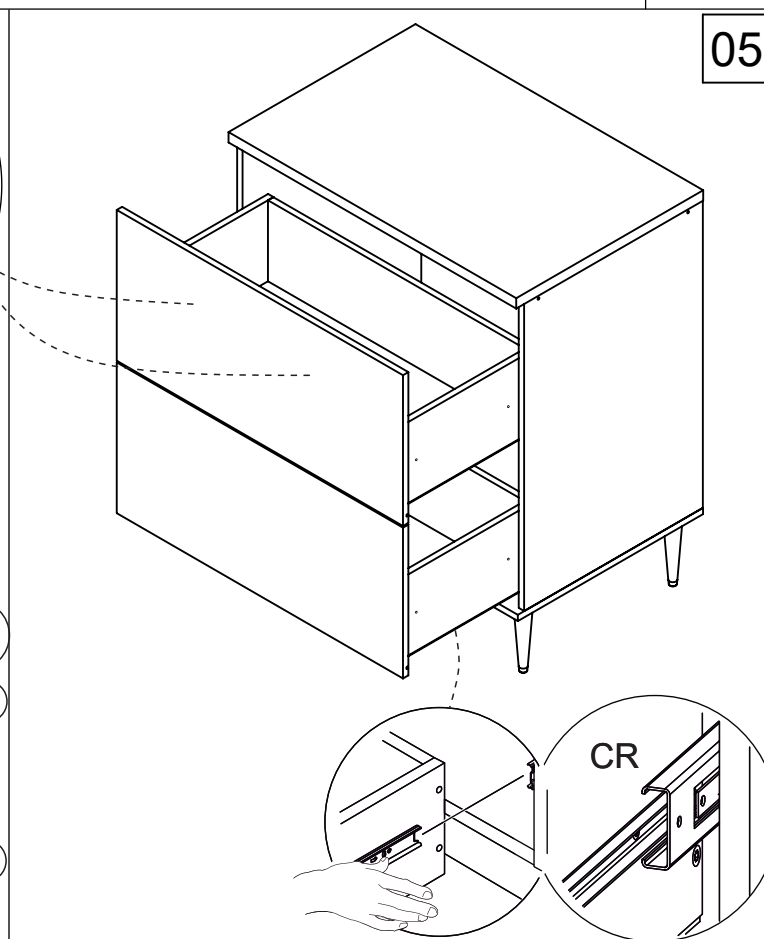
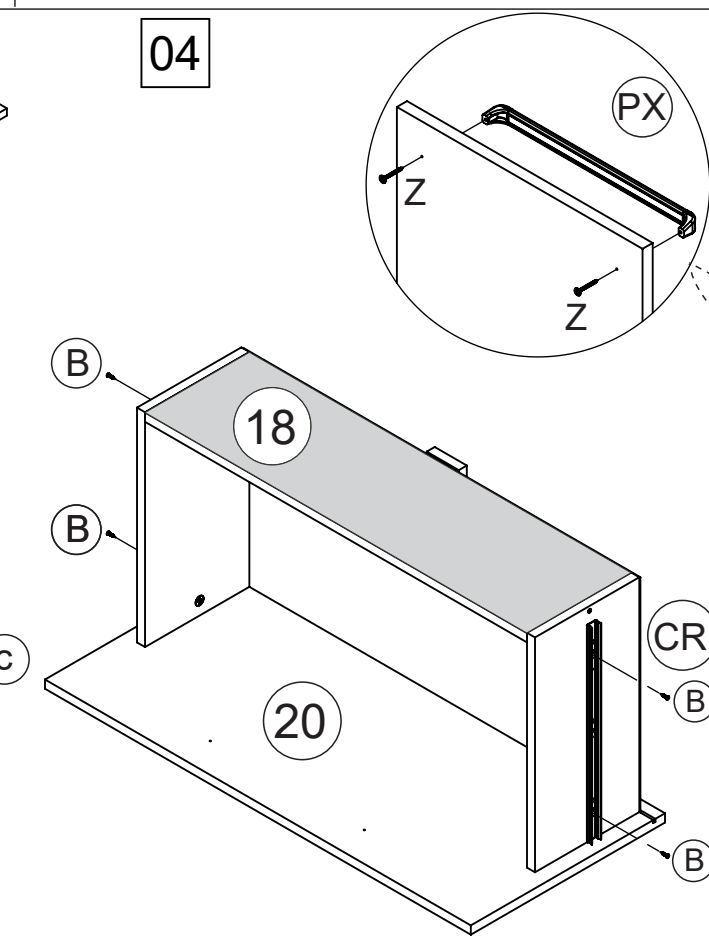
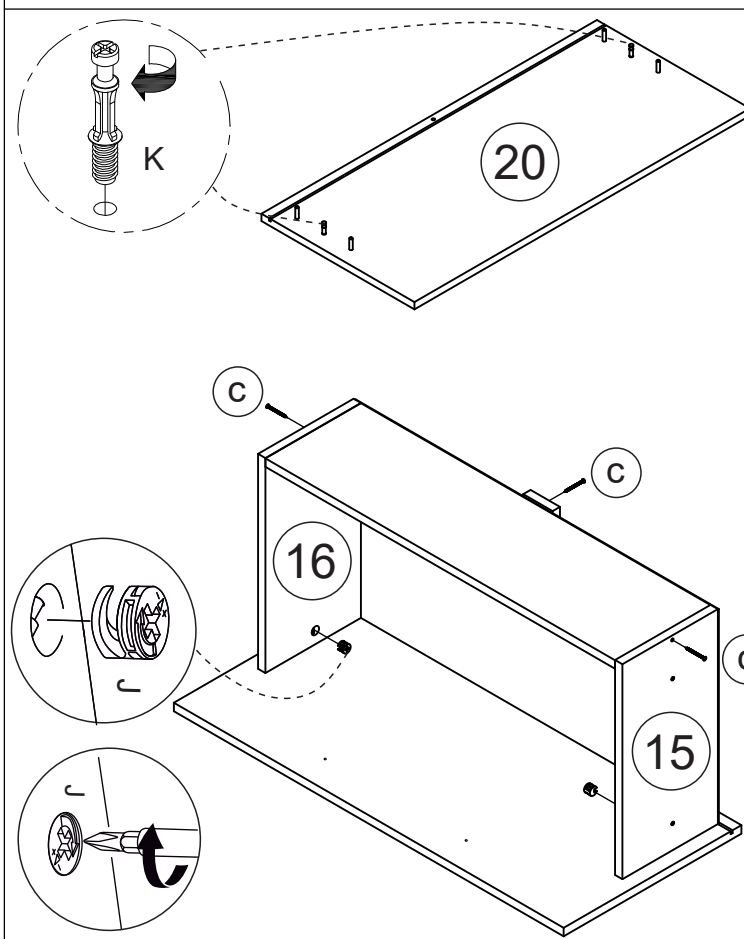
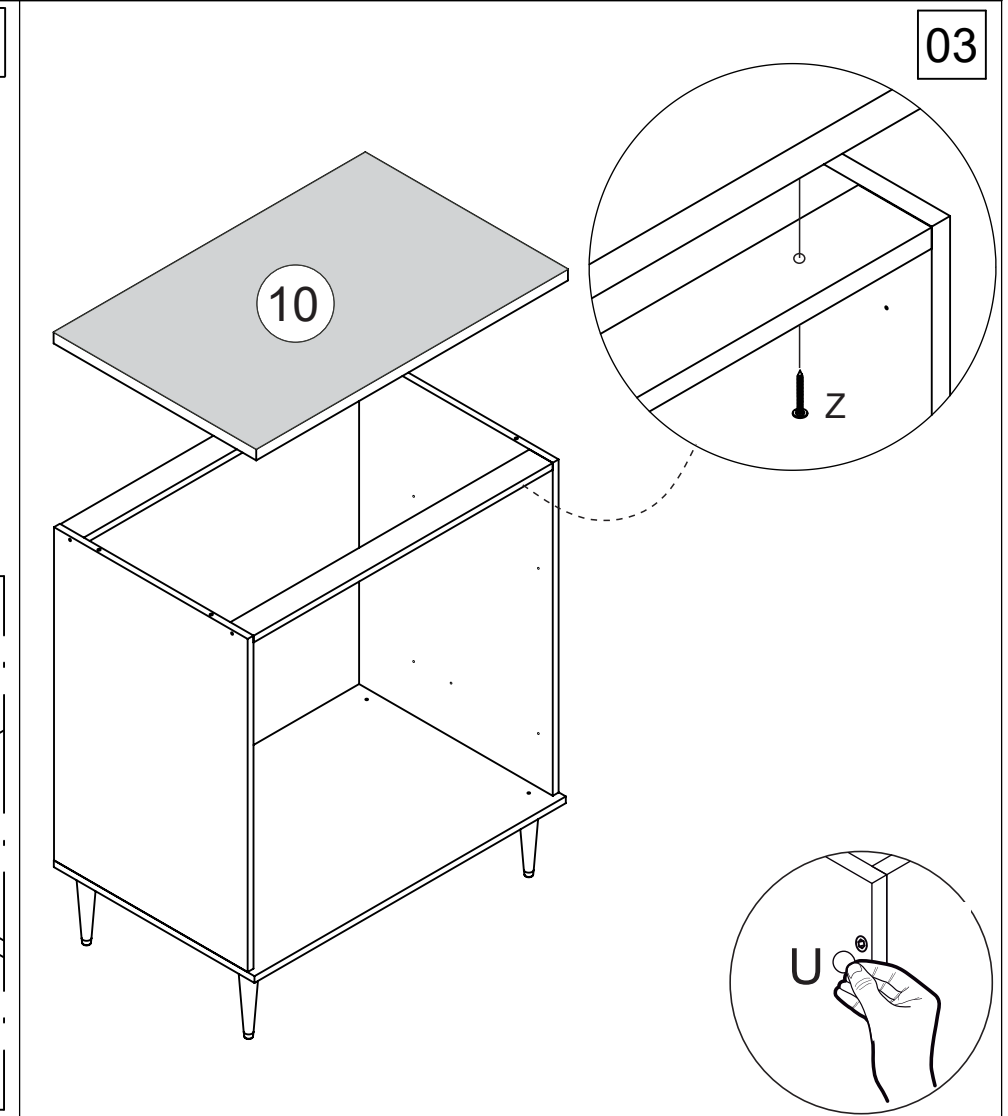
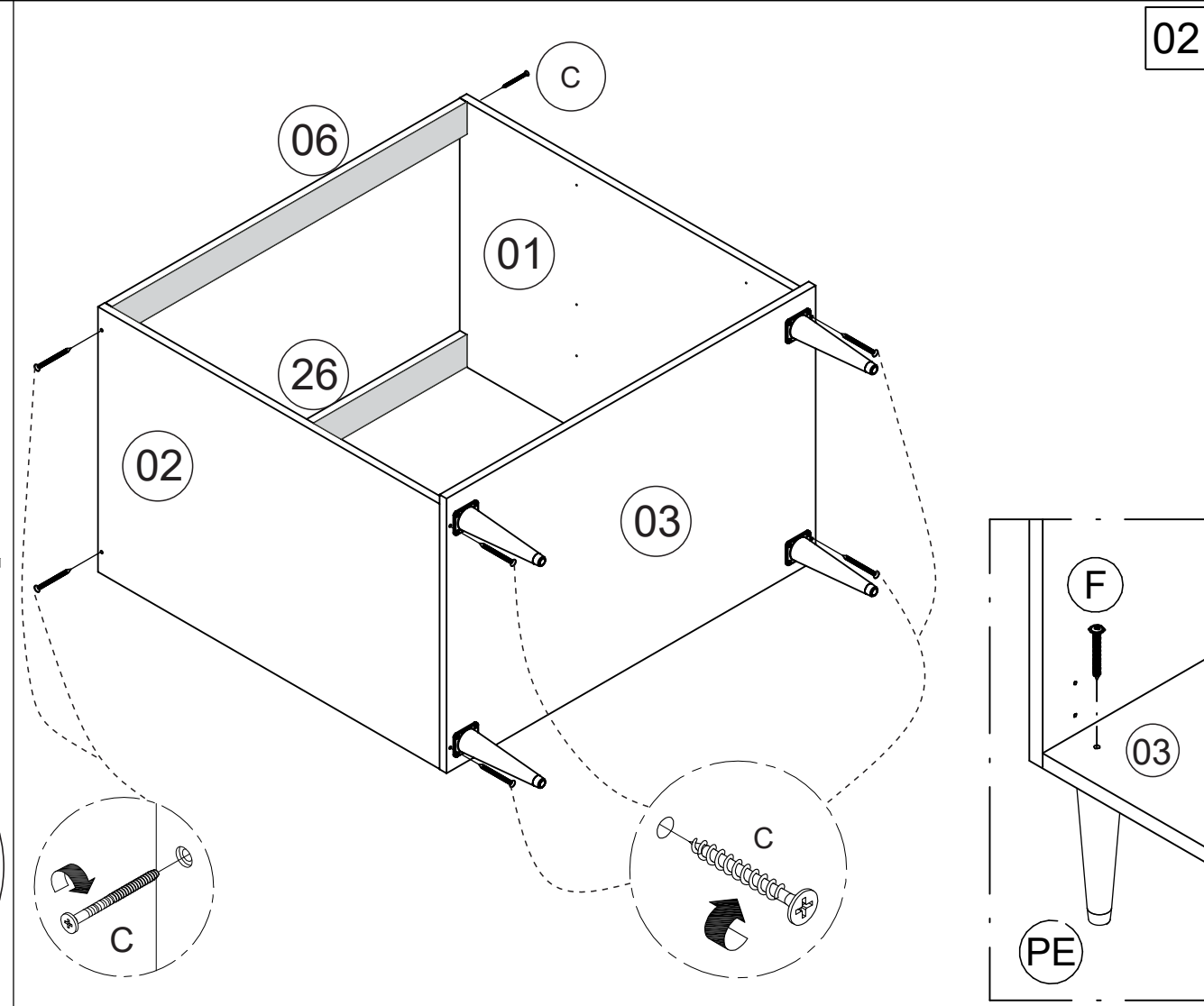
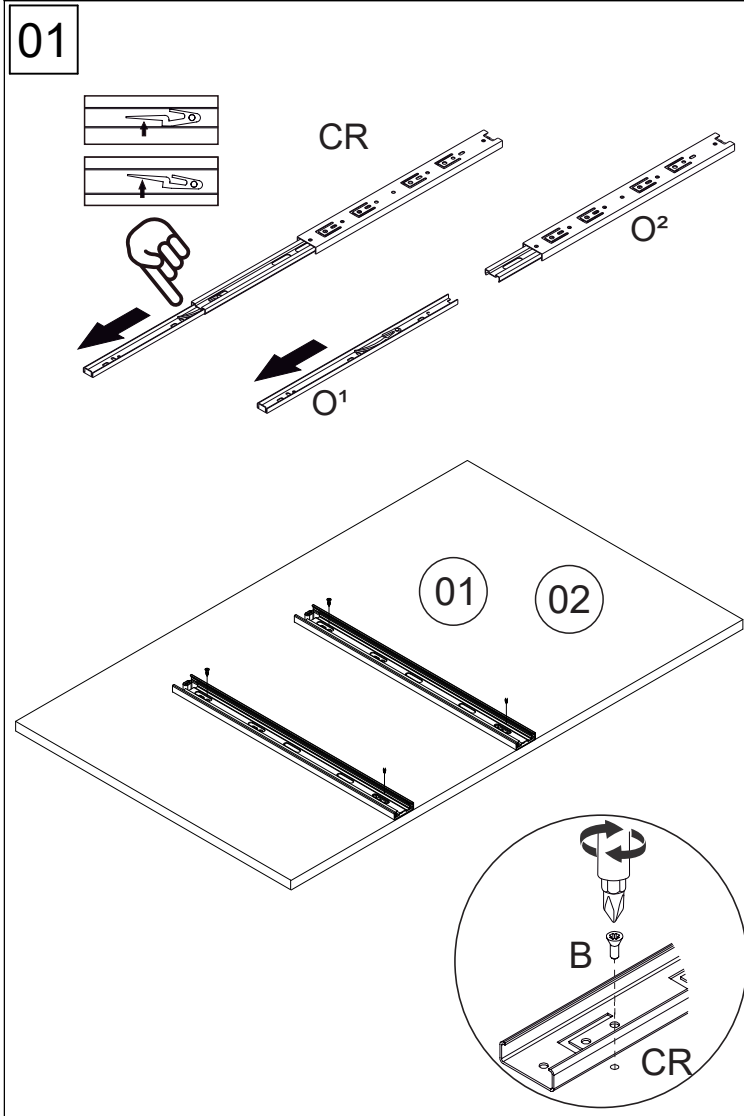

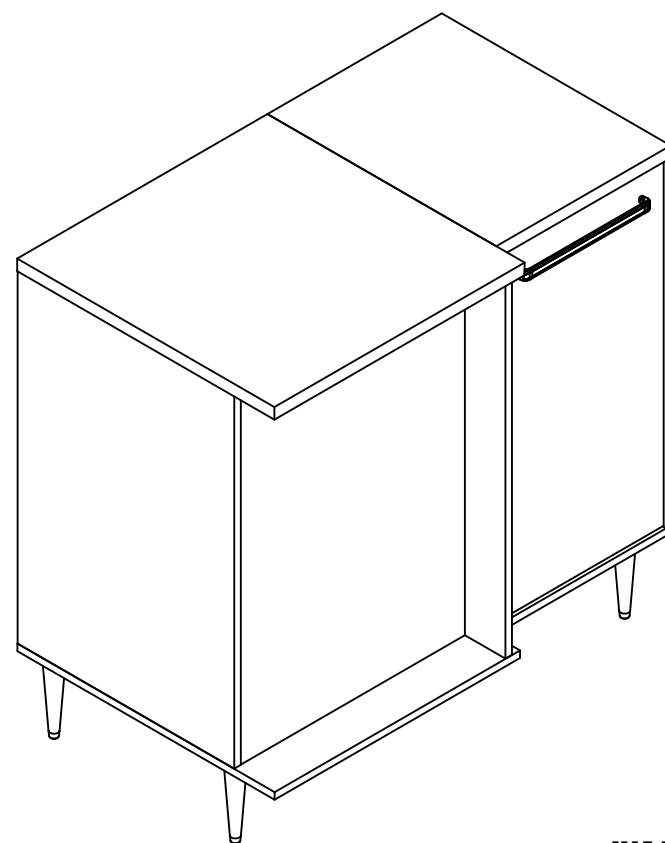
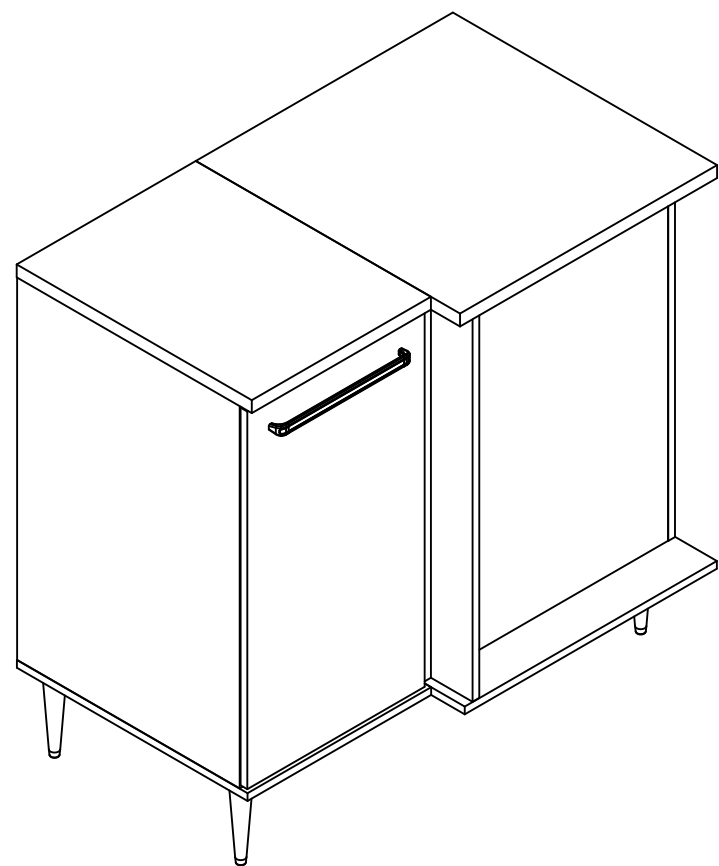

Lista de peças / Parts lists / Lista de piezas

REF	DESC	COMP	LARG	ESP	QTD.
IS1515-01	LATERAL DIREITA/LADO DERECHO/RIGHT SIDE	740	497	15	1
IS1515-02	LATERAL ESQUERDA/LADO IZQUIERDO/LEFT SIDE	740	497	15	1
IS1515-03	BASE/BASE/BASE	590	515	15	1
IS1515-04	PRATELERA/ESTANTE/SHELF	350	942	15	1
IS1515-06	TRAVESSA FRONTAL/PLATO/PLATTER	364	60	15	1
IS1515-07	PILASTRA EXTERNA/PILASTO EXTERNO	740	93	15	1
IS1515-10	TAMPO/TAPA/TOP	590	520	25	1
IS1515-12	PORTA /PUERTA/DOOR	396	730	15	1
IS1515-21	LATERAL /LADO/SIDE	740	578	15	1
IS1515-26	TRAVESSA TRASERA/PLATO/PLATTER	60	942	15	1
IS1515-30	TAMPO/TAPA/TOP	454	520	25	1
IS1515-33	BASE/BASE/BASE	458	515	15	1
IS1515-61	COSTA/FONDO/BACK	966	350	3	1

FERRAMENTAS NECESSÁRIAS:
HERRAMIENTAS NECESARIAS:
NECESSARY TOOLS:



Lista de ferragens Lista de materiales Hardware list

Letter	Image	Description	QTD.
A		CAVILHA Ø6X30 CLAVIJA Ø6X30 WOOD DOWEL Ø6X30	11
B		PARAFUSO CC 3,5X14 TORNILLO CC 3,5X14 SCREW CC 3,5X14	30
C		PARAFUSO CC 3,5X40 TORNILLO CC 3,5X40 SCREW CC 3,5X40	14
DB		DOBRADIÇA BISAGRA HINGE	02
F		PARAFUSO CF 4,5X50 TORNILLO CF 4,5X50 SCREW CF 4,5X50	06
Z		PARAFUSO CF 3,5X25 TORNILLO CF 3,5X25 SCREW CF 3,5X25	13
U		ADESIVO TAPA FURO ADHESIVO STICKER	06
M		PREGO 10X10 CLAVO 10X10 NAIL	35
V		COLA PEGAMENTO GLUE	01
PX		PUXADOR TIRADOR HANDLE	01
PE		PÉ PIE FOOT	05
E		CHAPA FIXAÇÃO PLACA DE FIJACIÓN FIXING PLATE	03
L		CANTONERA ESQUINERO CORNER	08
S		SUPORTE PRATELERA SOPORTE DE ESTANTE SHELF SUPPORT	04

"IMPORTANTE LER COM ATENÇÃO E GUARDAR PARA EVENTUAIS CONSULTAS".

"IMPORTANTE LEER CON ATENCIÓN Y GUARDAR PARA EVENTUALES CONSULTAS".
"IMPORTANT TO READ CAREFULLY AND SAVE FOR ANY QUERIES".



Limpar o número da peça com pano levemente umedecido com álcool



Clean the part number with a cloth slightly dampened with alcohol



Limpiar el número de la pieza con un paño ligeramente humedecido con alcohol.

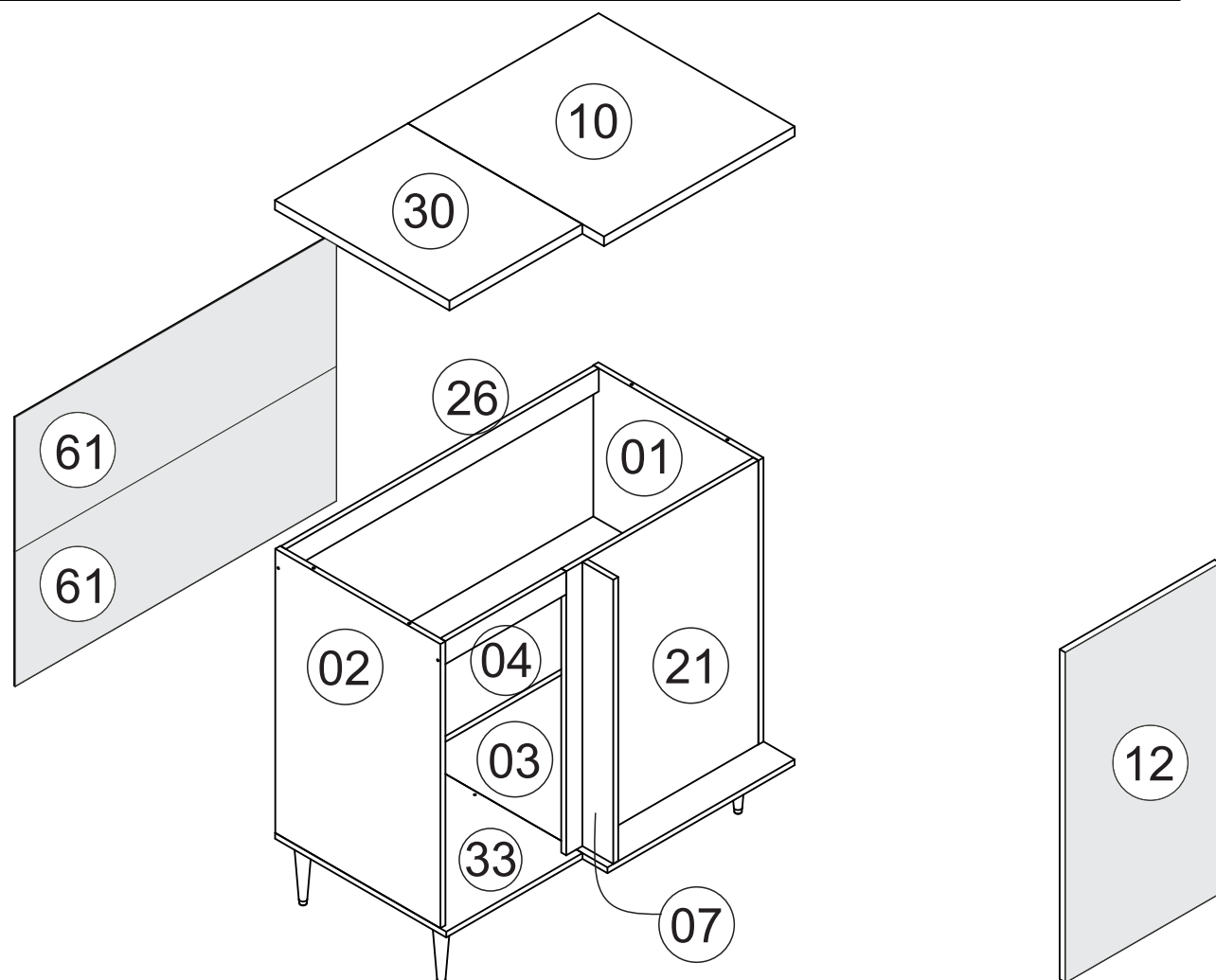

G		PROTEÇÃO SUP CANTONEIRA PROTECCIÓN ANGLE BRACKET	01
H		SUPORTE FIXAÇÃO SOPORTE DE FIJACIÓN FIXING SUPPORT	01
I		BUCHA PLÁSTICA CASQUILLO BUSHING	01

IS 1600 Aereo 120

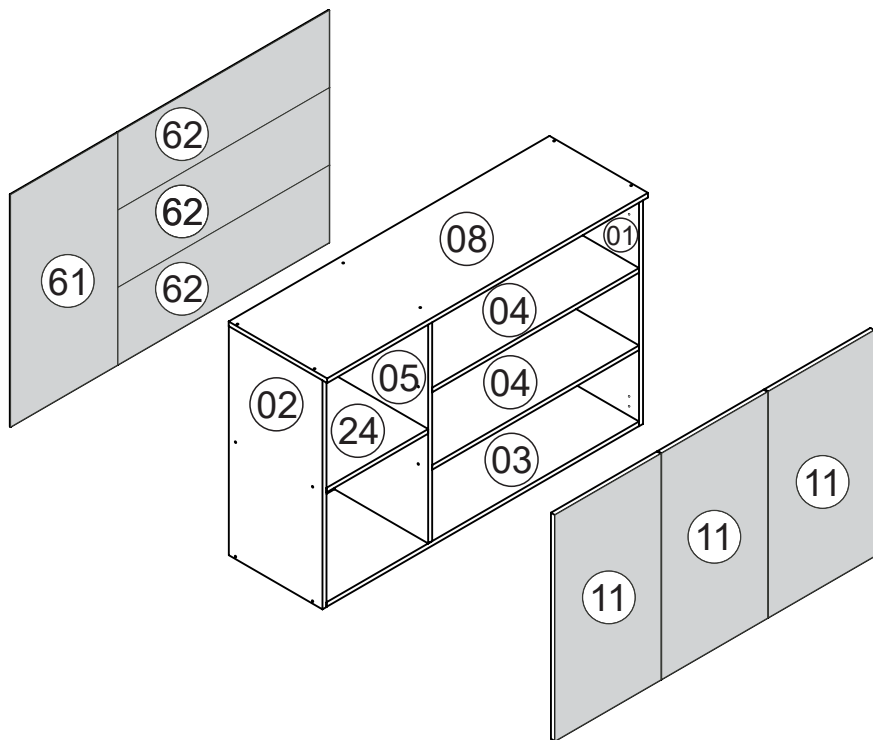
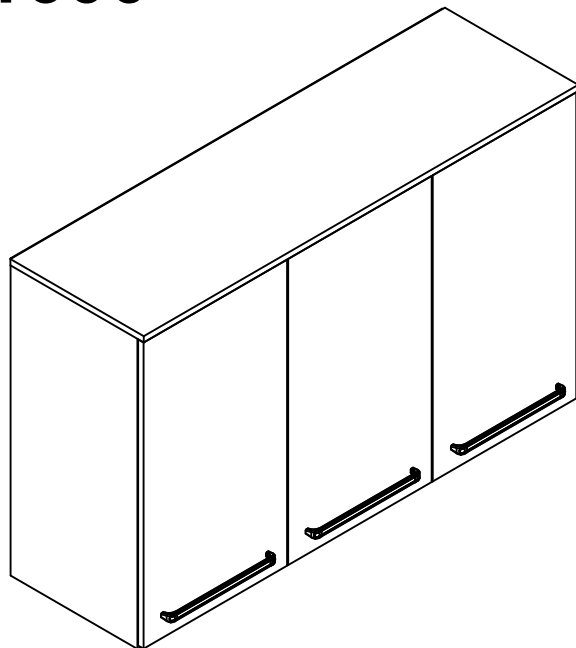

A		CAVILHA Ø6X30 CLAVIJA Ø6X30 WOOD DOWEL Ø6X30	24
B		PARAFUSO CC 4X14 TORNILLO CC 4X14 SCREW CC 4X14	06
C		PARAFUSO CC 4X40 TORNILLO CC 4X40 SCREW CC 4X40	24
DB		DOBRADIÇA BISAGRA HINGE	06
F		PARAFUSO CF 4,5X50 TORNILLO CF 4,5X50 SCREW CF 4,5X50	03
M		PREGO 10X10 CLAVO 10X10 NAIL	65
U		ADESIVO TAPA FURO ADHESIVO STICKER	06
X		FIXADOR COSTAS FIJADOR PRARA FONDO BACK SUPPORT	15
Z		PARAFUSO CC 3,5X25 TORNILLO CC 3,5X25 SCREW CC 3,5X25	10
G		SUPORTE FIXAÇÃO SOPORTE DE FIJACIÓN FIXING SUPPORT	03
H		PROTEÇÃO SUP CANTONEIRA PROTECCIÓN ANGLE BRACKET	03
I		BUCHA PLÁSTICA CASQUILLO BUSHING	03
PX		PUXADOR TIRADOR HANDLE	03
V		COLA PEGAMENTO GLUE	01

01

Assembly Instructions / Instrucciones de Montaje
Instruções de Montagem /

FERRAMENTAS NECESSÁRIAS:
HERRAMIENTAS NECESARIAS:
NECESSARY TOOLS:



**"IMPORTANTE LER COM ATENÇÃO
E GUARDAR PARA EVENTUAIS
CONSULTAS".**

**"IMPORTANTE LEER CON ATENCIÓN Y GUARDAR PARA
EVENTUALES CONSULTAS".**
**"IMPORTANT TO READ CAREFULLY AND SAVE FOR ANY
QUERIES".**



Limpar o número da peça com pano
levemente umedecido com álcool



Clean the part number with a cloth
slightly dampened with alcohol





Limpiar el número de la pieza con
un paño ligeramente humedecido
con alcohol.

Lista de peças / Parts lists / Lista de piezas

REF	DESC	COMP	LARG	ESP	QTD.
IS1600-01	LATERAL DIREITA/LADO DERECHO/RIGHT SIDE	740	350	15	1
IS1600-02	LATERAL ESQUERDA/LADO IZQUIERDO/LEFT SIDE	740	350	15	1
IS1600-03	BASE/BASE/BASE	1168	350	15	1
IS1600-04	PRATELERA/ESTANTE/DIVISION	771	350	15	1
IS1600-05	DIVISAO/DIVISION/DIVISION	724	350	15	1
IS1600-08	CHAPEU/SOMBRERO/HAT	1199	368	15	1
IS1600-11	PORTA/PUERTA/DOOR	396	730	15	3
IS1600-24	PRATELERA/ESTANTE/DIVISION	382	350	15	1
IS1600-61	COSTA/FONDO/BACK	400	750	3	1
IS1600-62	COSTA/FONDO/BACK	250	790	3	3

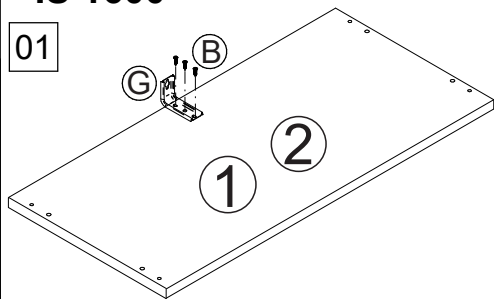
01



 Ferragem G faceada com a peça

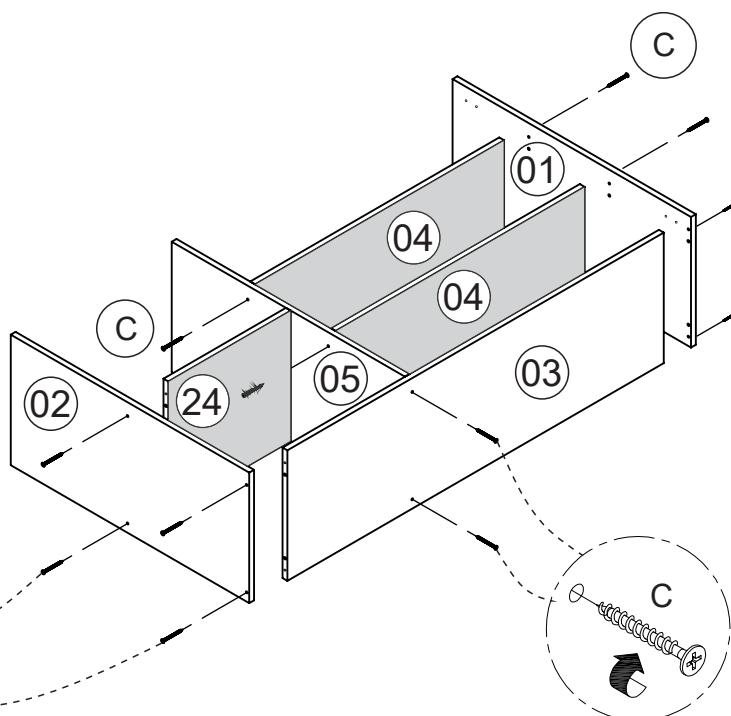
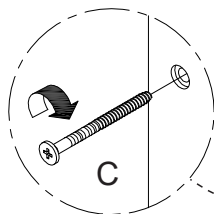

02

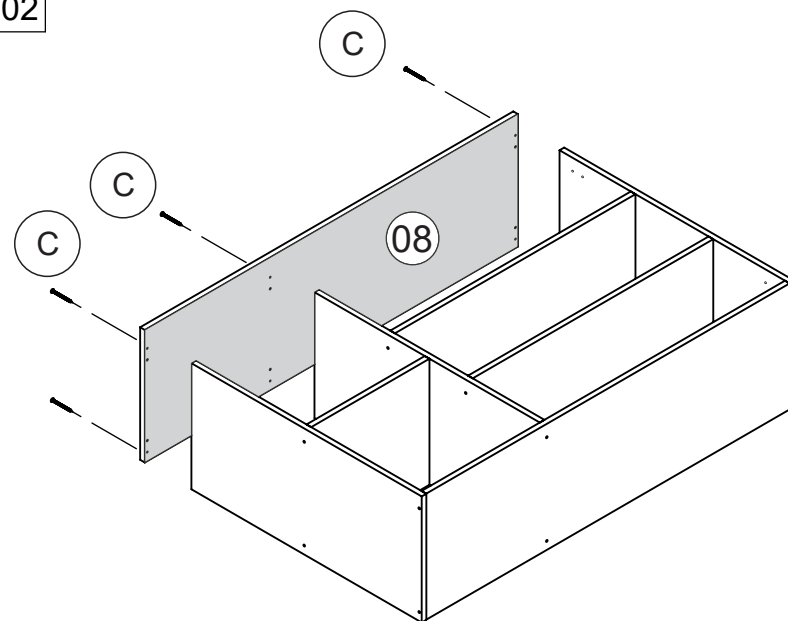

Parafuso "Z" união de módulos
Tornillo "Z" unión de módulos

03

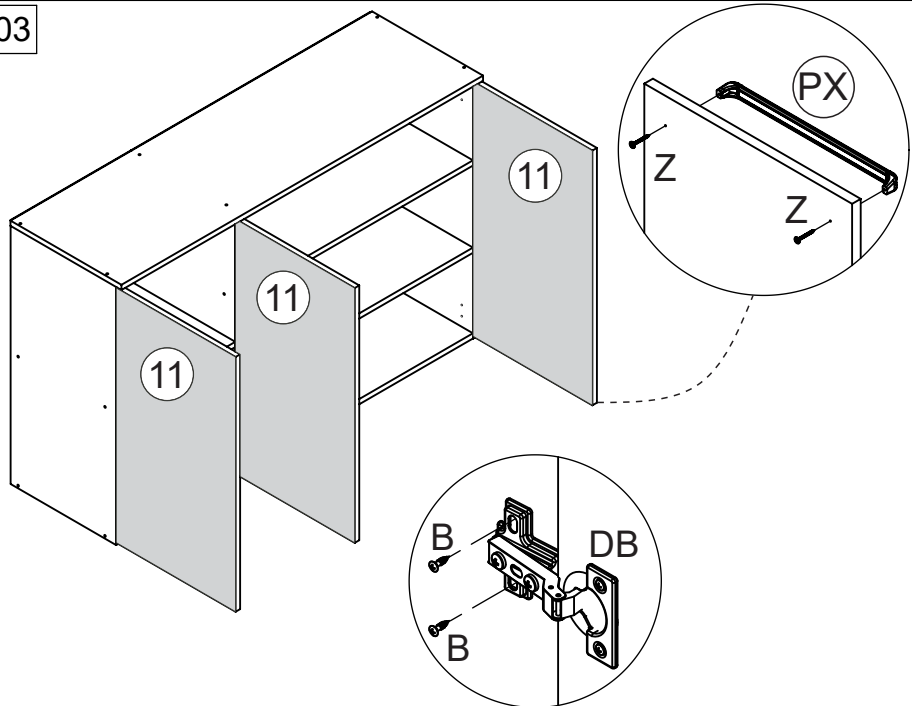

04

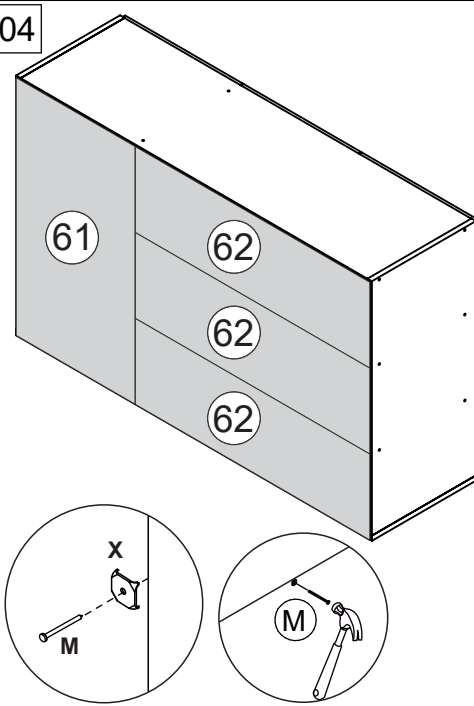

05

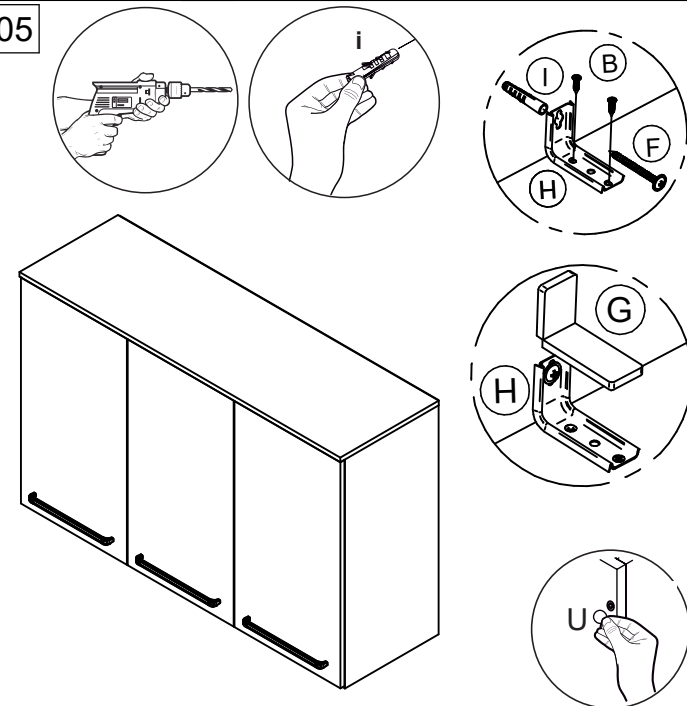

IS 1601 Aereo 80

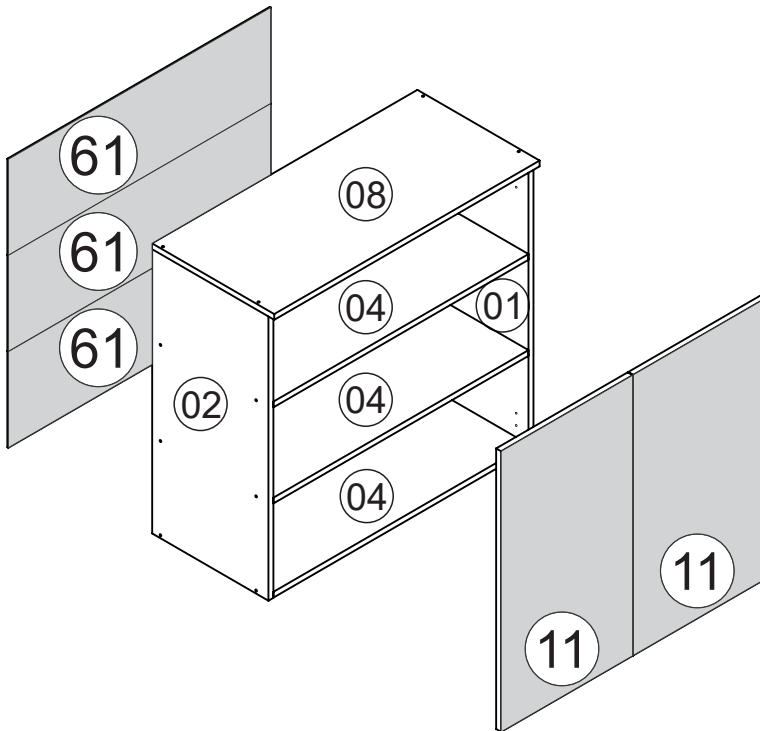
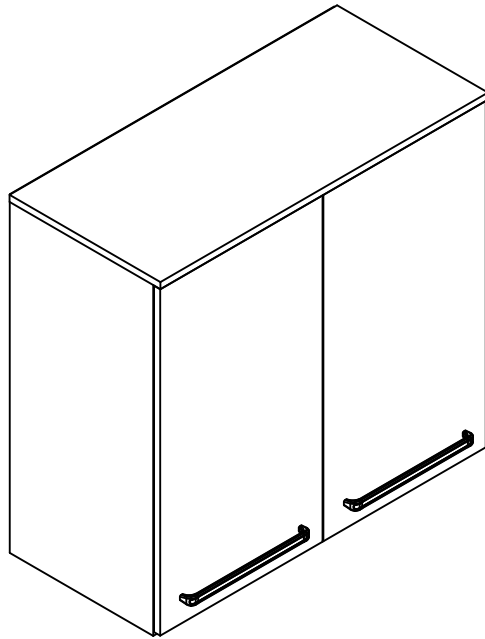

A		CAVILHA Ø6X30 CLAVIJA Ø6X30 WOOD DOWEL Ø6X30	16
B		PARAFUSO CC 4X14 TORNILLO CC 4X14 SCREW CC 4X14	04
C		PARAFUSO CC 4X40 TORNILLO CC 4X40 SCREW CC 4X40	16
DB		DOBRADIÇA BISAGRA HINGE	04
F		PARAFUSO CF 4,5X50 TORNILLO CF 4,5X50 SCREW CF 4,5X50	02
M		PREGO 10X10 CLAVO 10X10 NAIL	45
U		ADESIVO TAPA FURO ADHESIVO STICKER	10
Z		FIXADOR COSTAS FIJADOR PRARA FONDO BACK SUPPORT	10
Z		PARAFUSO CC 3,5X25 TORNILLO CC 3,5X25 SCREW CC 3,5X25	08
G		SUPORTE FIXAÇÃO SOPORTE DE FIJACIÓN FIXING SUPPORT	02
H		PROTEÇÃO SUP CANTONEIRA PROTECCIÓN ANGLE BRACKET	02
I		BUCHA PLÁSTICA CASQUILLO BUSHING	02
PX		PUXADOR TIRADOR HANDLE	02
V		COLA PEGAMENTO GLUE	01

Assembly Instructions / Instrucciones de Montaje
Instruções de Montagem /

FERRAMENTAS NECESSÁRIAS:
HERRAMIENTAS NECESARIAS:
NECESSARY TOOLS:

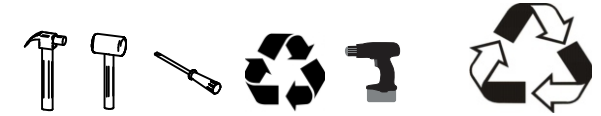

**"IMPORTANTE LER COM ATENÇÃO
E GUARDAR PARA EVENTUAIS
CONSULTAS".**

**"IMPORTANTE LEER CON ATENCIÓN Y GUARDAR PARA
EVENTUALES CONSULTAS".**

**"IMPORTANT TO READ CAREFULLY AND SAVE FOR ANY
QUERIES".**



Limpar o número da peça com pano levemente umedecido com álcool



Clean the part number with a cloth slightly dampened with alcohol



Limpiar el número de la pieza con un paño ligeramente humedecido con alcohol.

Lista de peças / Parts lists / Lista de piezas

REF	DESC	COMP	LARG	ESP	QTD.
IS1601-01	LATERAL DIREITA/LADO DERECHO/RIGHT SIDE	740	350	15	1
IS1601-02	LATERAL ESQUERDA/LADO IZQUIERDO/LEFT SIDE	740	350	15	1
IS1601-04	PRATELERA/ESTANTE/DIVISION	768	350	15	3
IS1601-08	CHAPEU/SOMBREIRO/HAT	800	368	15	1
IS1601-11	PORTA/PUERTA/DOOR	396	730	15	2
IS1601-61	COSTA/FONDO/BACK	790	248	3	3

01

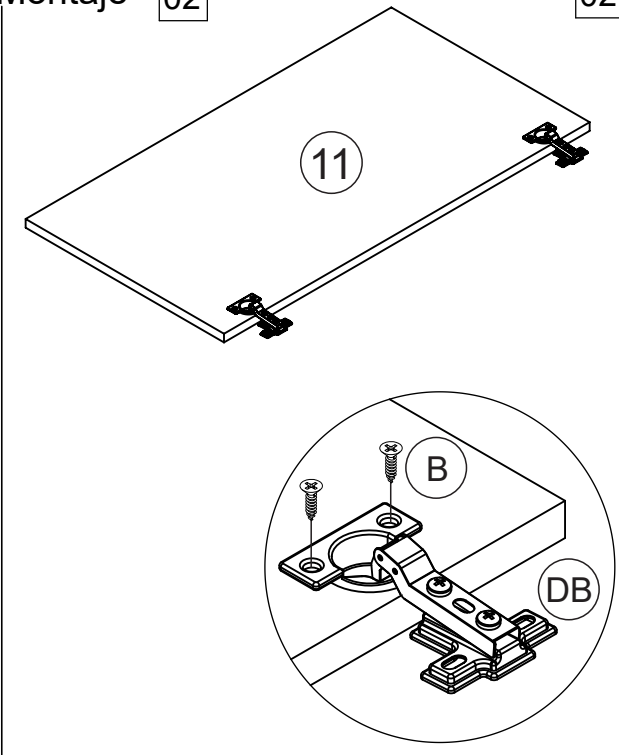
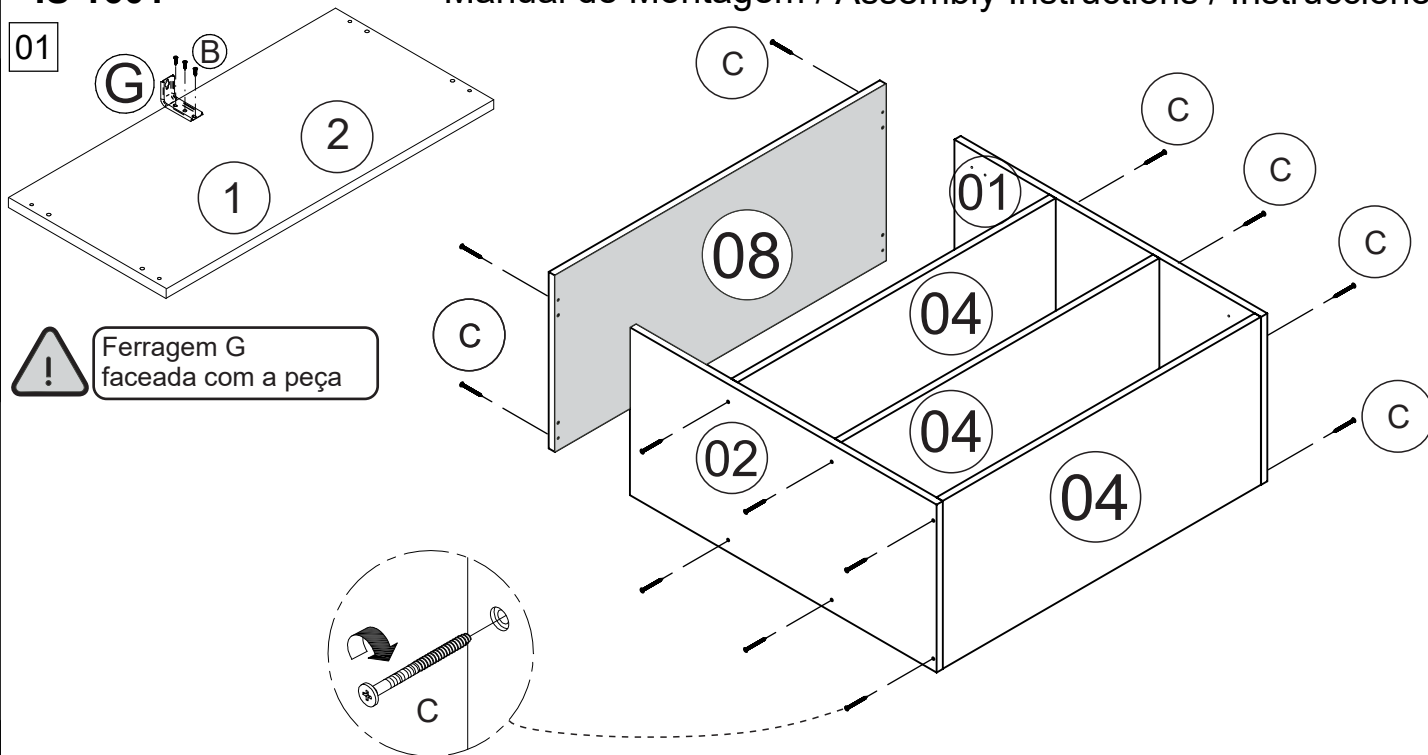

03

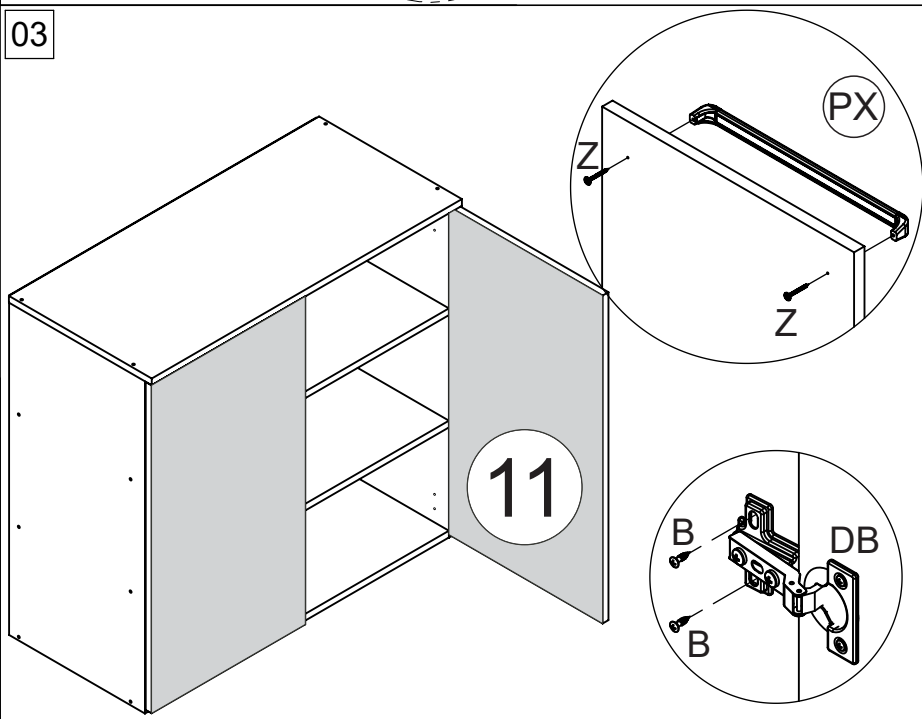

04

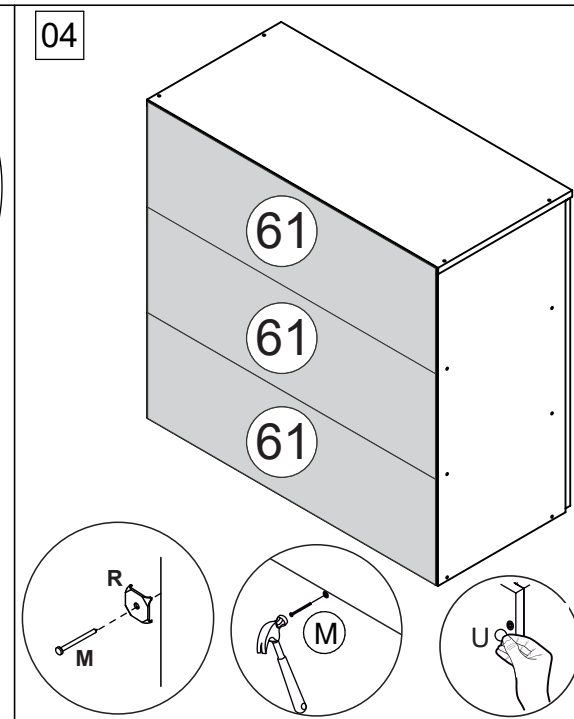

05

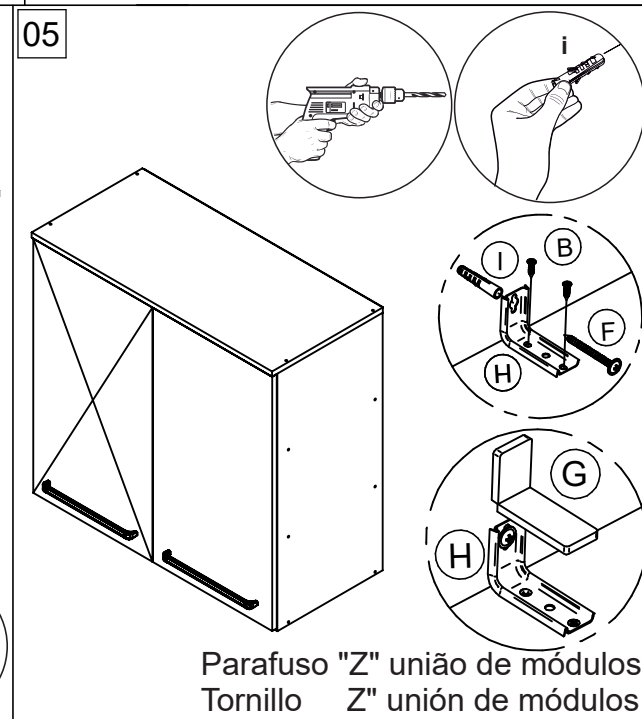

Parafuso "Z" união de módulos
Tornillo "Z" unión de módulos

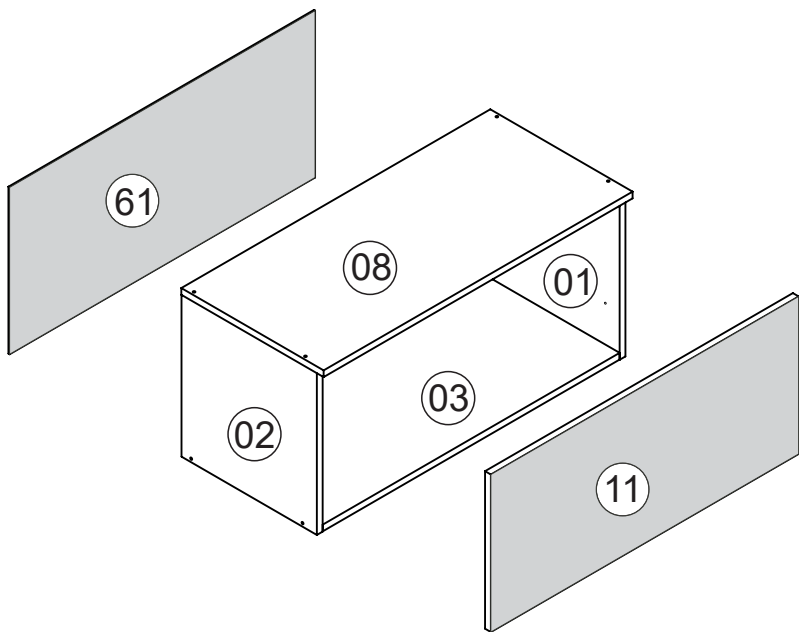
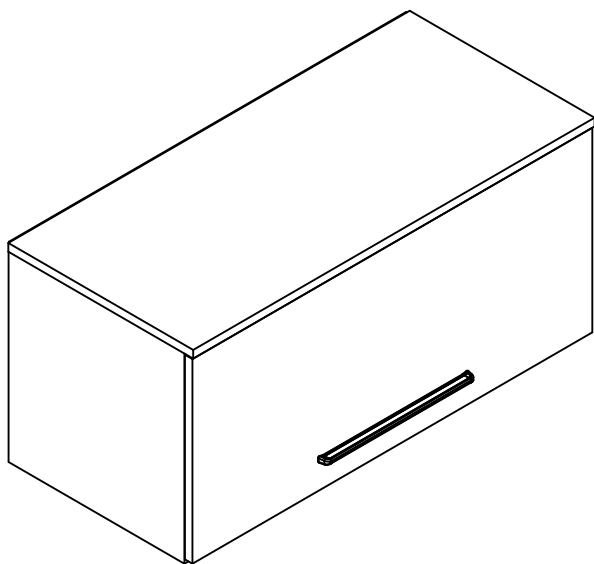

A		CAVILHA Ø6X30 CLAVIJA Ø6X30 WOOD DOWEL Ø6X30	08
B		PARAFUSO CC 4X14 TORNILLO CC 4X14 SCREW CC 4X14	02
C		PARAFUSO CC 4X40 TORNILLO CC 4X40 SCREW CC 4X40	08
DB		DOBRADIÇA BISAGRA HINGE	02
F		PARAFUSO CF 4,5X50 TORNILLO CF 4,5X50 SCREW CF 4,5X50	01
M		PREGO 10X10 CLAVO 10X10 NAIL	25
U		ADESIVO TAPA FURO ADHESIVO STICKER	04
G		PROTEÇÃO SUP CANTONEIRA PROTECCIÓN ANGLE BRACKET	01
H		SUPORTE FIXAÇÃO SOPORTE DE FIJACIÓN FIXING SUPPORT	01
I		BUCHA PLÁSTICA CASQUILLO BUSHING	01
Z		PARAFUSO CC 4X30 TORNILLO CC 4X30 SCREW CC 4X30	05
PX		PUXADOR TIRADOR HANDLE	01
P		PISTAO PISTON PISTON	01

FERRAMENTAS NECESSÁRIAS:
HERRAMIENTAS NECESARIAS:
NECESSARY TOOLS:



**"IMPORTANT LER COM ATENÇÃO
E GUARDAR PARA EVENTUAIS
CONSULTAS".**

**"IMPORTANT LEER CON ATENCIÓN Y GUARDAR PARA
EVENTUALES CONSULTAS".**

**"IMPORTANT TO READ CAREFULLY AND SAVE FOR ANY
QUERIES".**



Limpar o número da peça com pano levemente umedecido com álcool



Clean the part number with a cloth slightly dampened with alcohol



Limpiar el número de la pieza con un paño ligeramente humedecido con alcohol.

Lista de peças / Parts lists / Lista de piezas

REF	DESC	COMP	LARG	ESP	QTD.
IS1611-01	LATERAL DIREITA/LADO DERECHO/RIGHT SIDE	362	350	15	1
IS1611-02	LATERAL ESQUERDA/LADO IZQUIERDO/LEFT SIDE	362	350	15	1
IS1611-03	BASE/BASE/BASE	768	350	15	1
IS1611-08	CHAPEU/SOMBREIRO/HAT	800	368	15	1
IS1611-11	PORTA/PUERTA/DOOR	796	352	15	1
IS1611-61	COSTA/FONDO/BACK	373	790	3	1

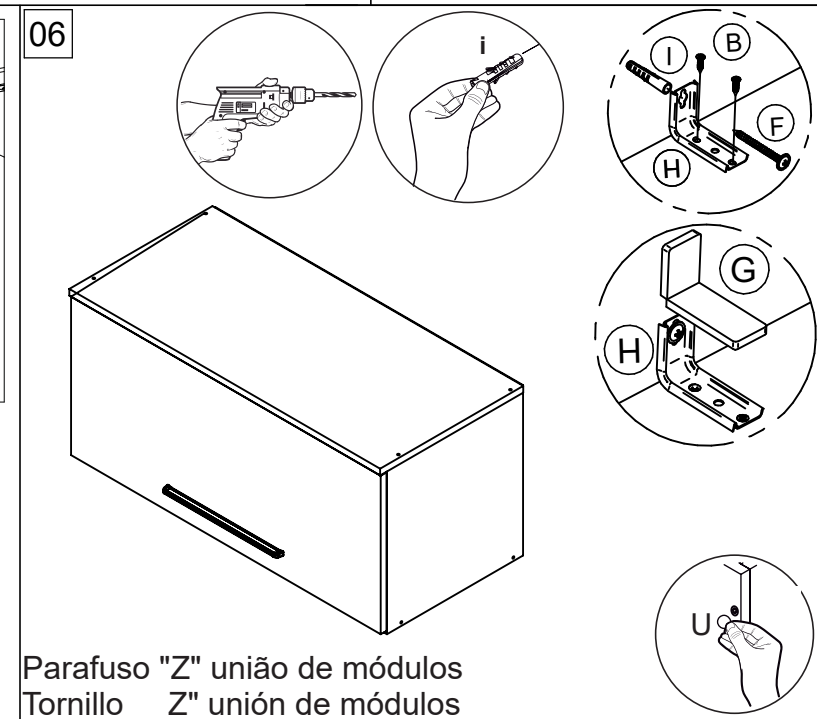
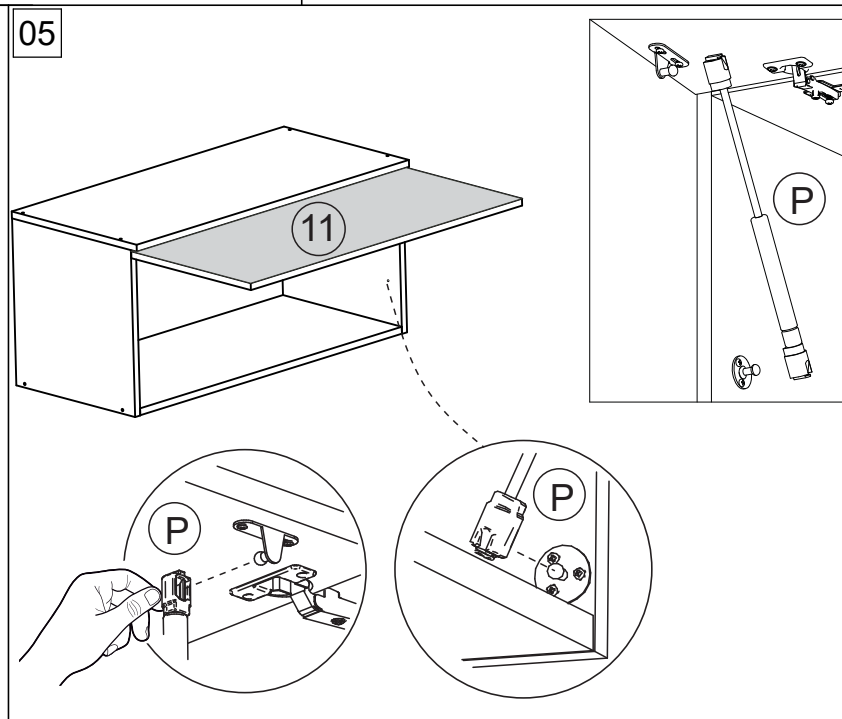
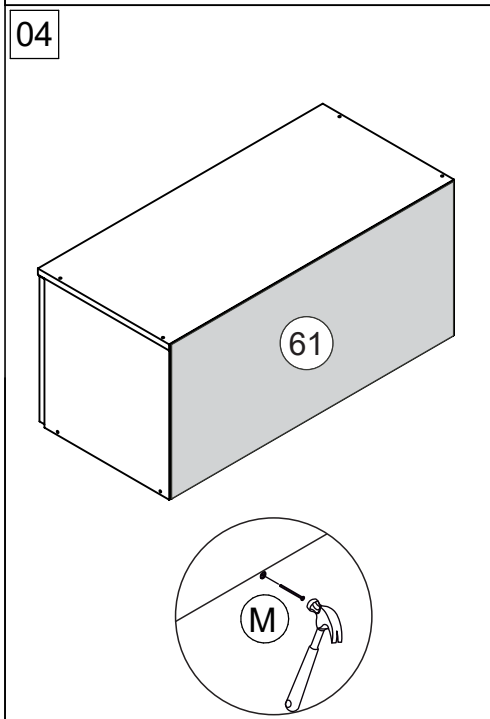
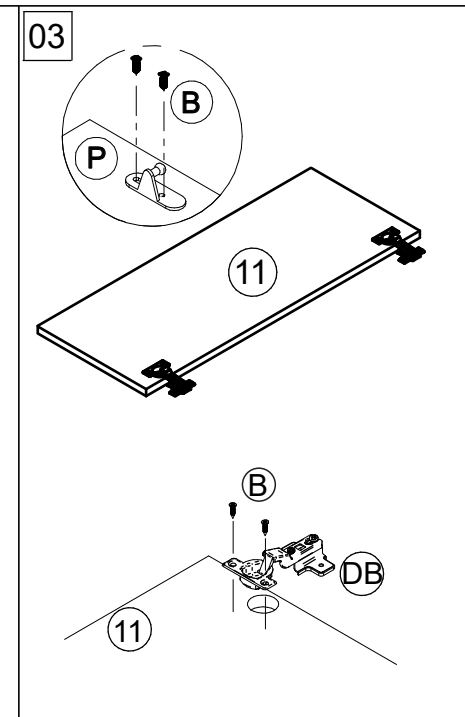
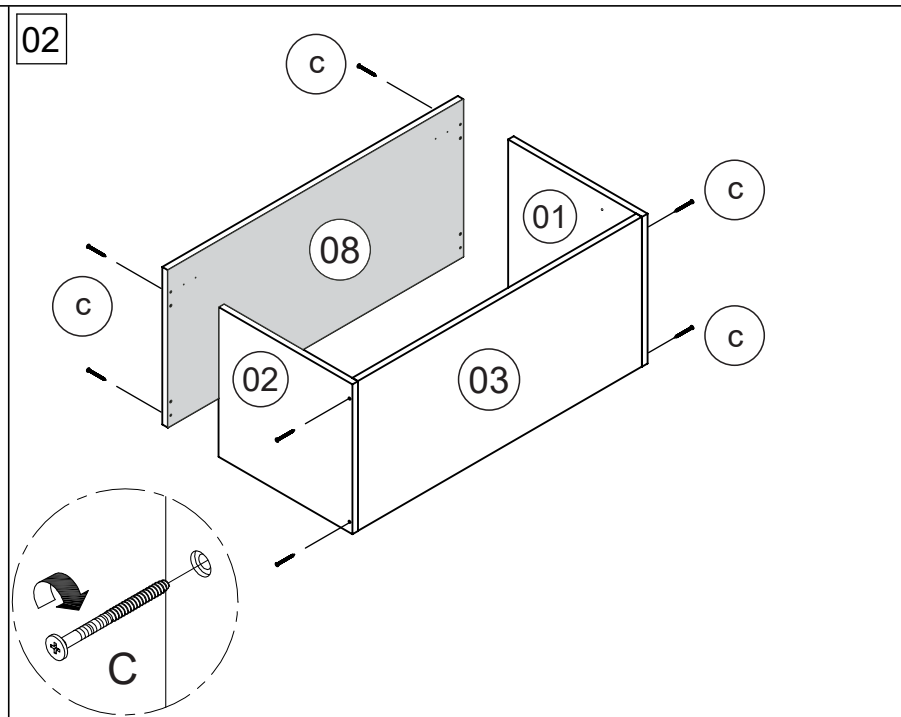
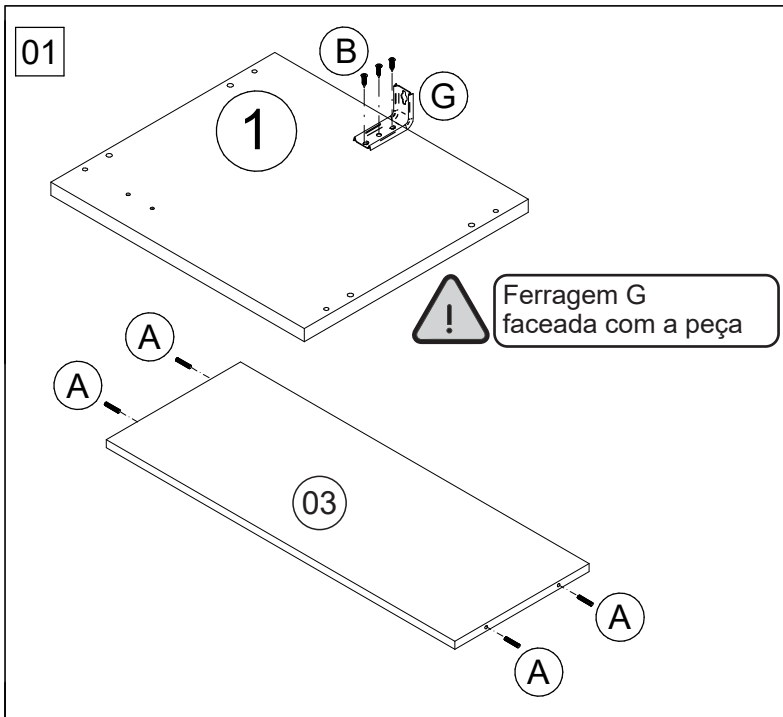

Lista de peças / Parts lists / Lista de piezas

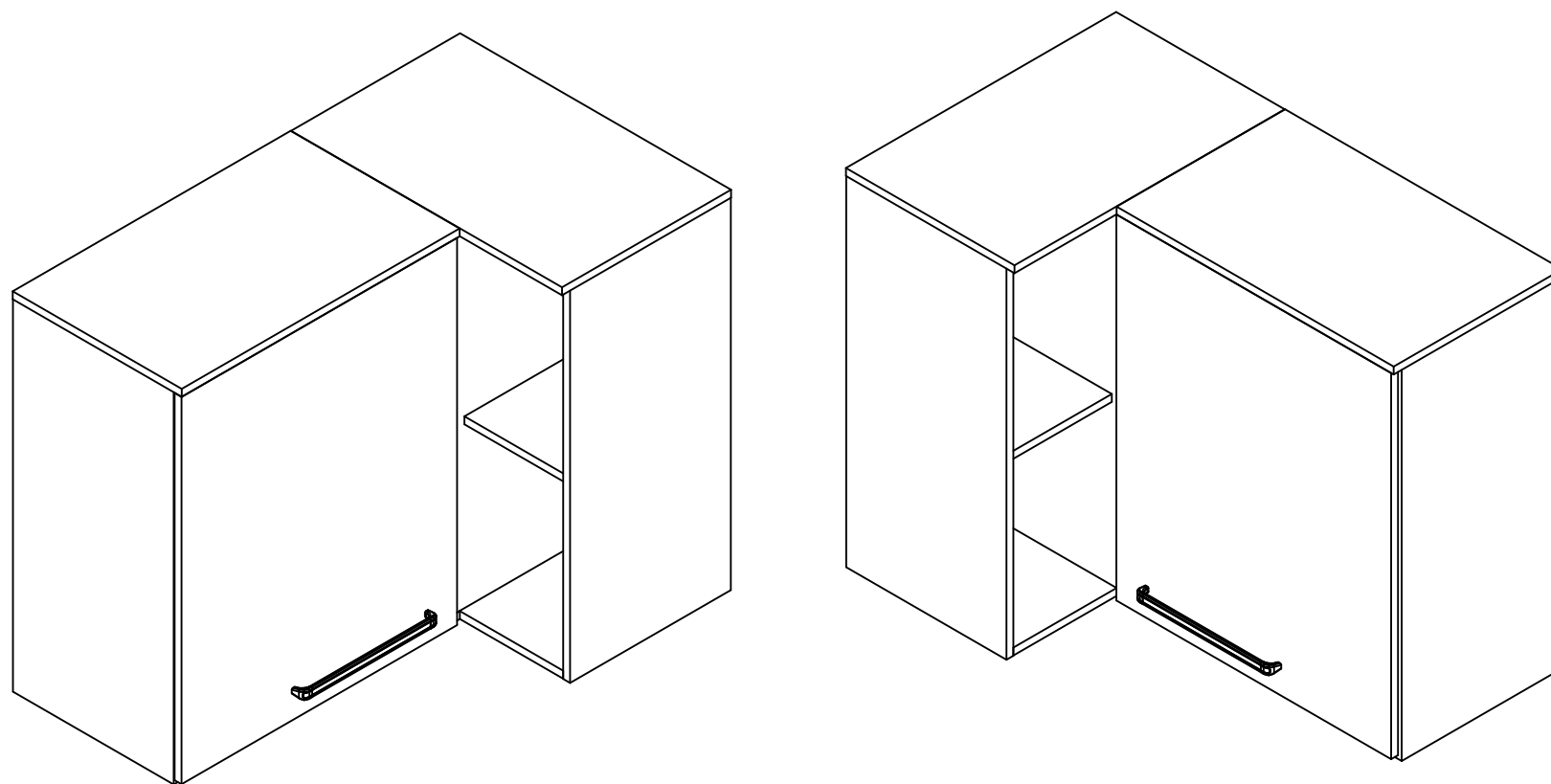

REF	DESC	M1	M2	M3	QTD
IS1615-01	LATERAL DIREITA/LADO DERECHO/RIGHT SIDE	740	350	15	1
IS1615-02	LATERAL ESQUERDA/LADO IZQUIERDO/SIDE	740	350	15	1
IS1615-03	BASE/BASE/BASE	608	350	15	1
IS1615-04	PRATELERA/ESTANTE/SHELF	225	340	15	1
IS1615-05	DIVISORIA/DIVISION/DIVISION	724	445	15	1
IS1615-07	PILASTRA EXTERNA/PILASTO EXTERNO	724	114	15	2
IS1615-08	CHAPEU/SOMBRERO/HAT	605	368	15	1
IS1615-11	PORTA /PUERTA/DOOR	540	730	15	1
IS1615-23	BASE MENOR/BASE/BASE	575	350	15	1
IS1615-24	PRATELERA/ESTANTE/SHELF	958	318	15	1
IS1615-28	CHAPEU/SOMBRERO/HAT	590	368	15	1
IS1615-61	COSTA/FONDO/BACK	748	600	3	1
IS1615-62	COSTA/FONDO/BACK	748	350	3	1
IS1615-63	COSTA/FONDO/BACK	748	245	3	1
IS1615-64	COSTA/FONDO/BACK	748	338	3	1

Lista de ferragens Lista de materiales Hardware list

A		CAVILHA Ø6X30 CLAVIJA Ø6X30 WOOD DOWEL Ø6X30	16
B		PARAFUSO CC 3,5X14 TORNILLO CC 3,5X14 SCREW CC 3,5X14	18
C		PARAFUSO CC 3,5X40 TORNILLO CC 3,5X40 SCREW CC 3,5X40	20
DB		DOBRADIÇA BISAGRA HINGE	02
F		PARAFUSO CF 4,5X50 TORNILLO CF 4,5X50 SCREW CF 4,5X50	03
Z		PARAFUSO CF 3,5X25 TORNILLO CF 3,5X25 SCREW CF 3,5X25	06
U		ADESIVO TAPA FURO ADHESIVO STICKER	06
M		PREGO 10X10 CLAVO 10X10 NAIL	55
V		COLA PEGAMENTO GLUE	01
PX		PUXADOR TIRADOR HANDLE	01
S		SUPORTE PRATELERA SOPORTE DE ESTANTE SHELF SUPPORT	06
X		FIXADOR COSTA FIJADOR DE ESPALDA BACK FIXER	05
G		PROTEÇÃO SUP CANTONEIRA PROTECCIÓN ANGLE BRACKET	03
H		SUPORTE FIXAÇÃO SOPORTE DE FIJACIÓN FIXING SUPPORT	03
I		BUCHA PLÁSTICA CASQUILLO BUSHING	03

FERRAMENTAS NECESSÁRIAS:
HERRAMIENTAS NECESARIAS:
NECESSARY TOOLS:



**"IMPORTANTE LER COM ATENÇÃO
E GUARDAR PARA EVENTUAIS
CONSULTAS".**

**"IMPORTANTE LEER CON ATENCIÓN Y GUARDAR PARA
EVENTUALES CONSULTAS".**

**"IMPORTANT TO READ CAREFULLY AND SAVE FOR ANY
QUERIES".**



Limpar o número da peça com pano levemente umedecido com álcool



Clean the part number with a cloth slightly dampened with alcohol



Limpiar el número de la pieza con un paño ligeramente humedecido con alcohol.

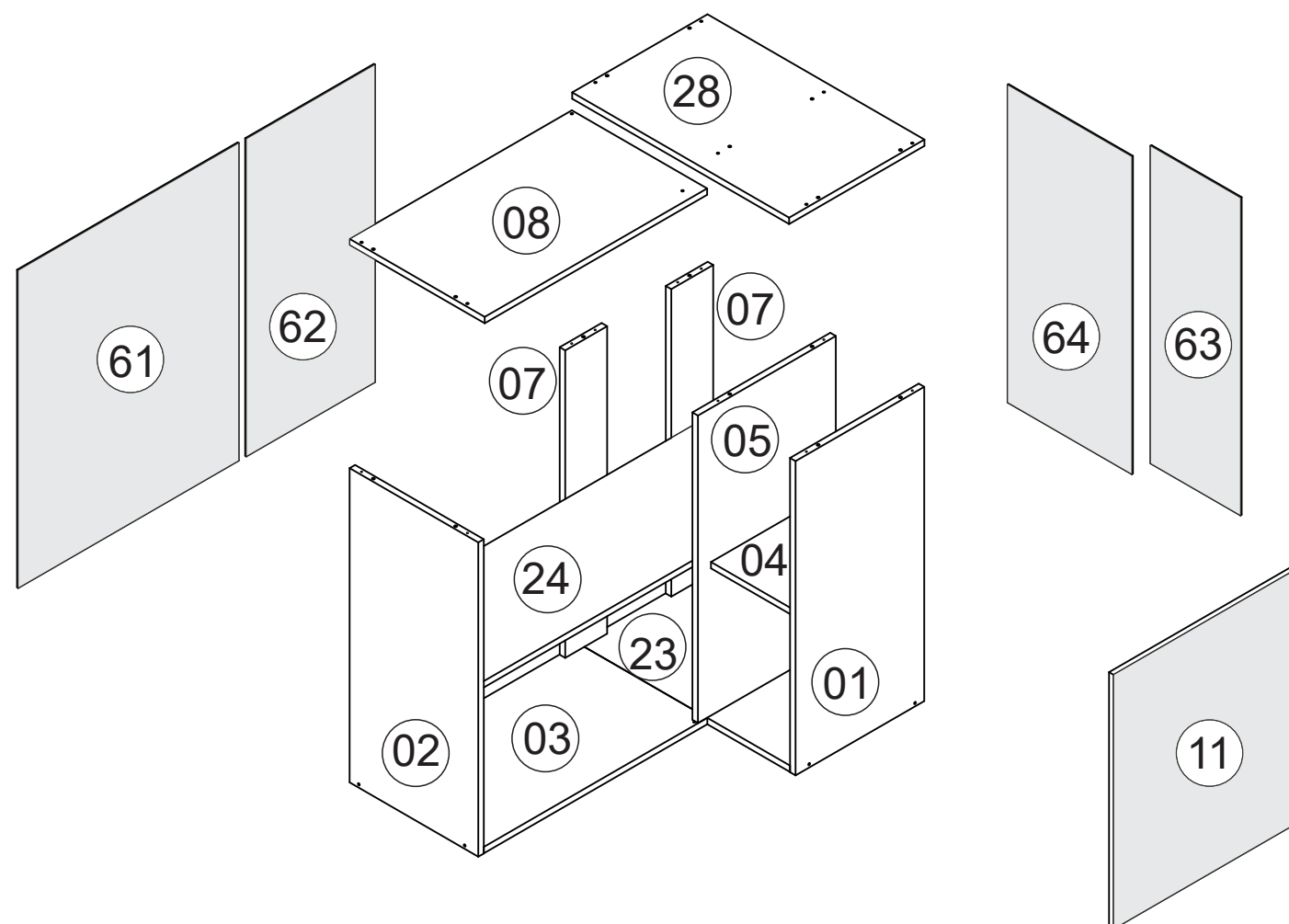

IS 1615

Instruções de Montagem / Assembly Instructions / Instrucciones de Montaje

01

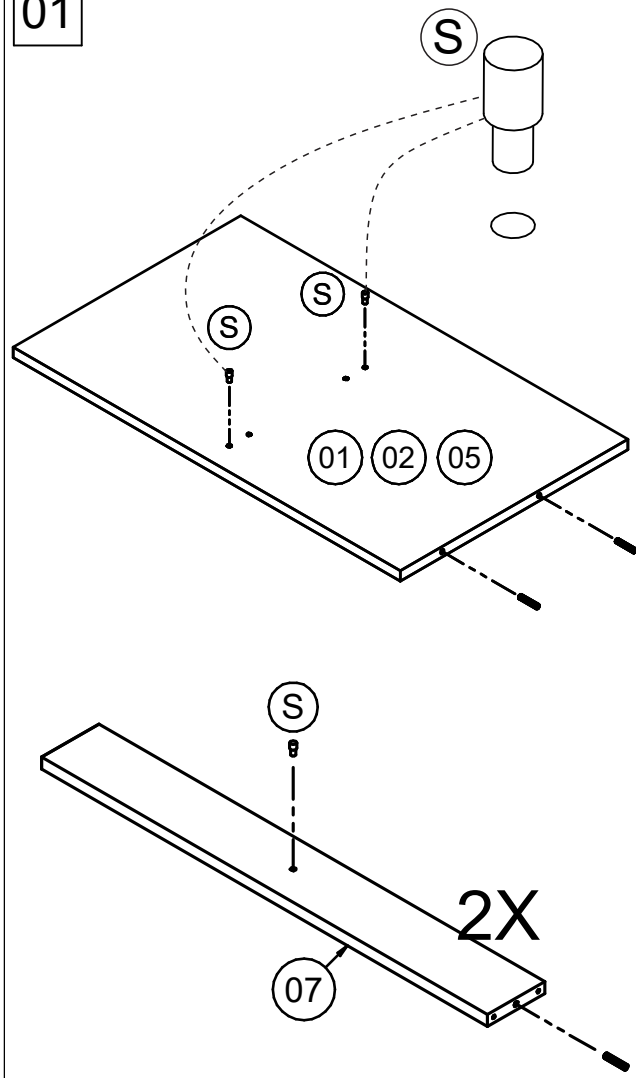

LADO ESQUERDO

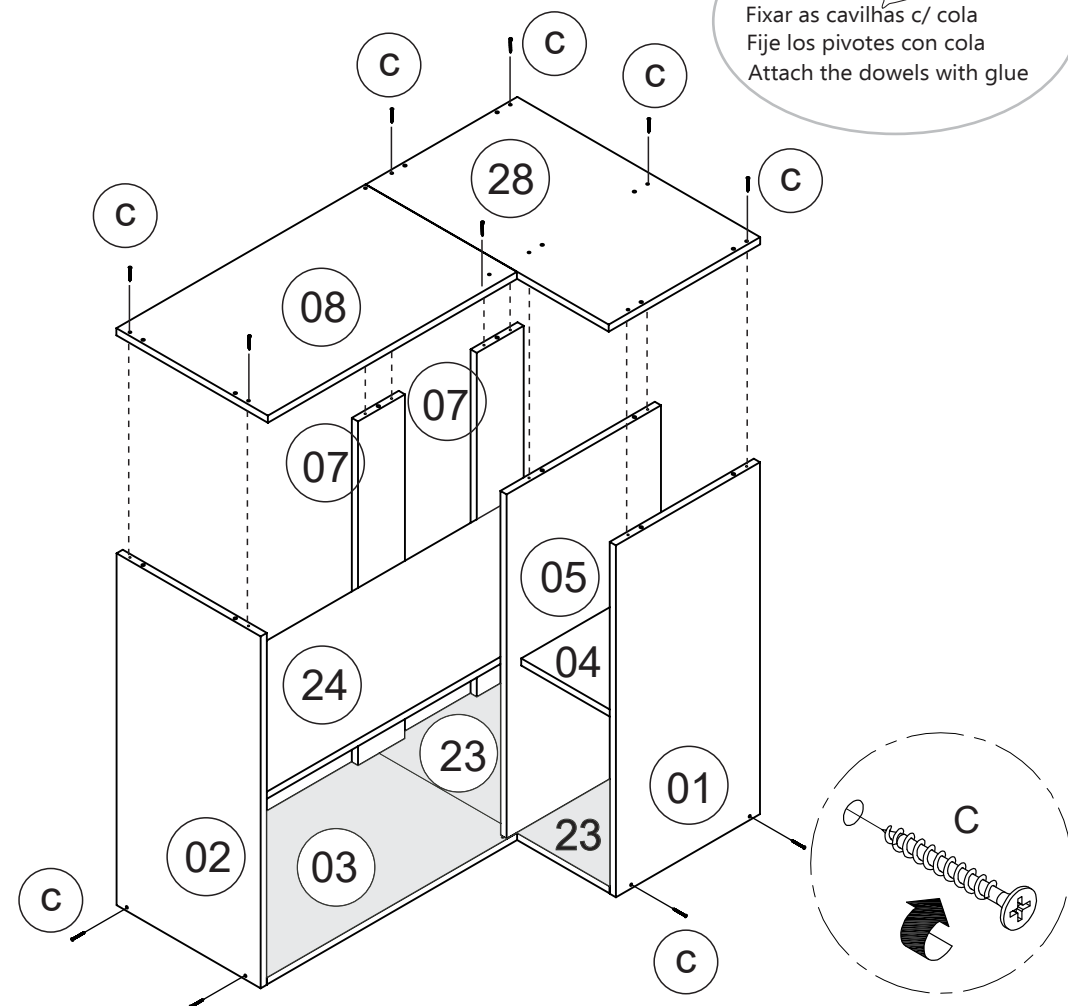

02

LADO DIREITO

Inserir Prateleira "24"

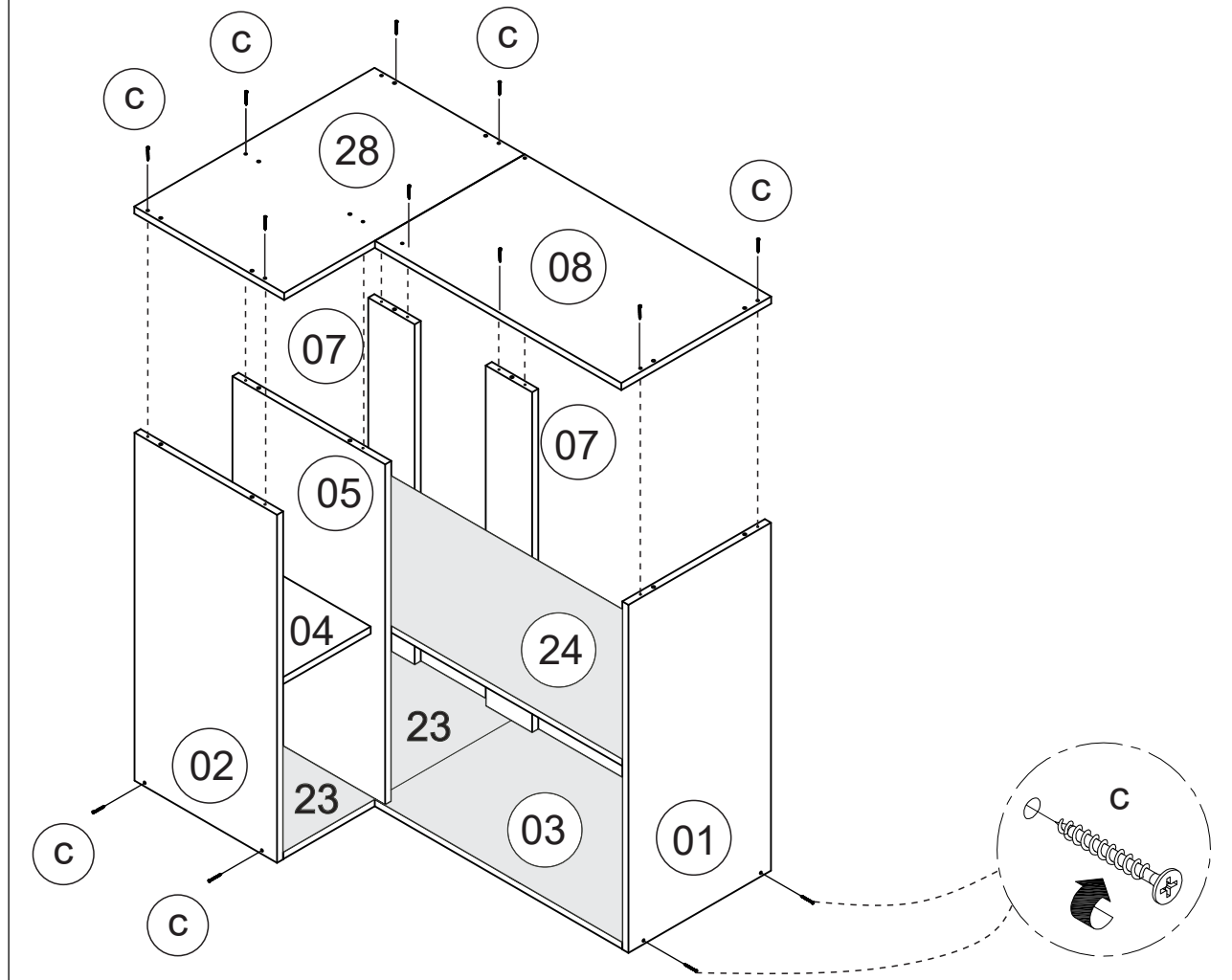

03

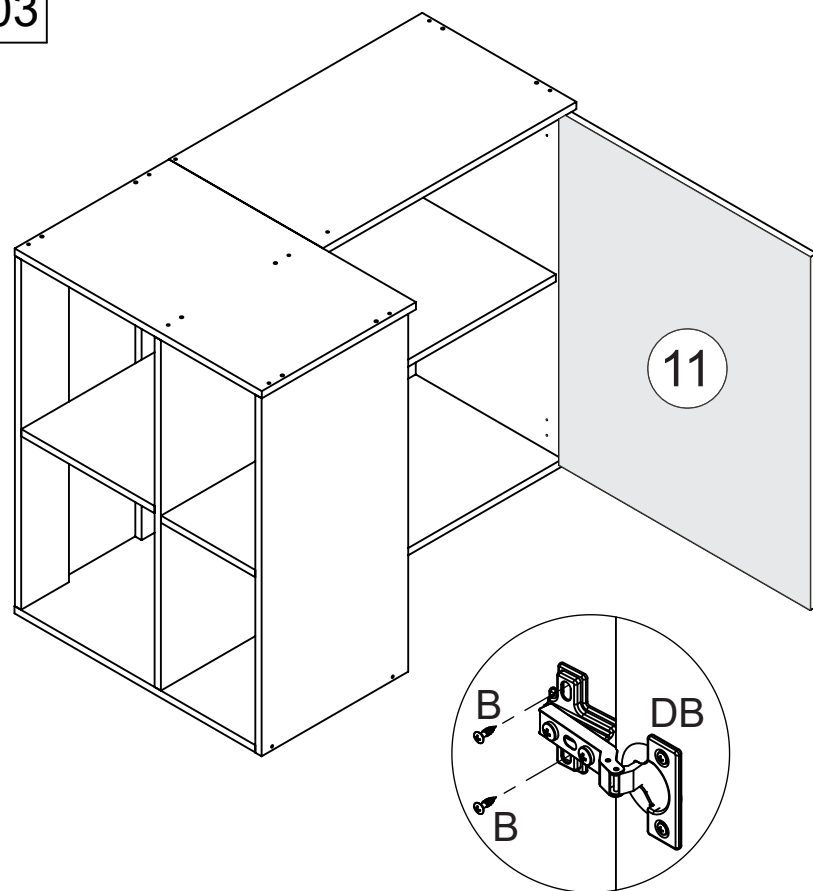

04

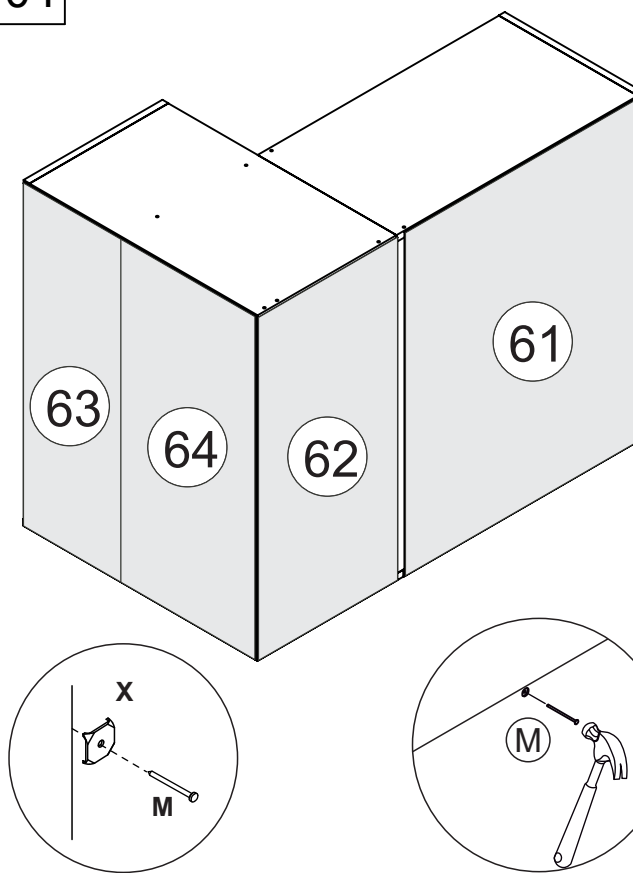

05

Parafuso "Z" união de módulos
Tornillo "Z" unión de módulos

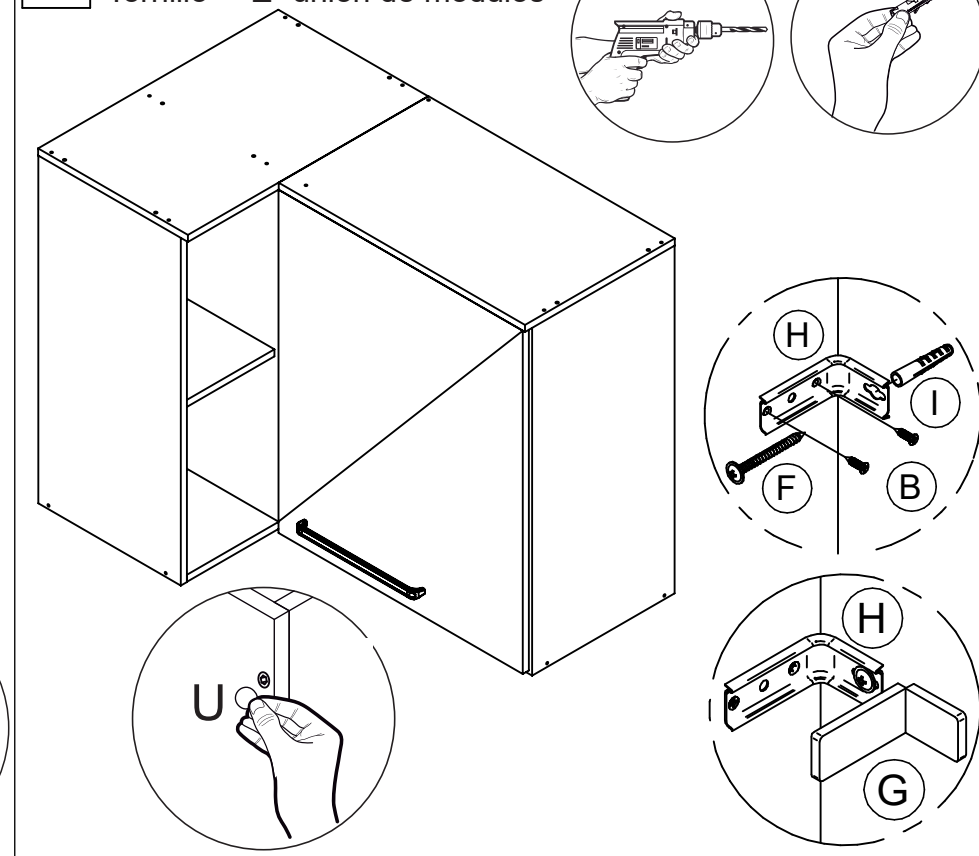

Instruções de montagem

Assembly Instructions / Instrucciones de Montaje

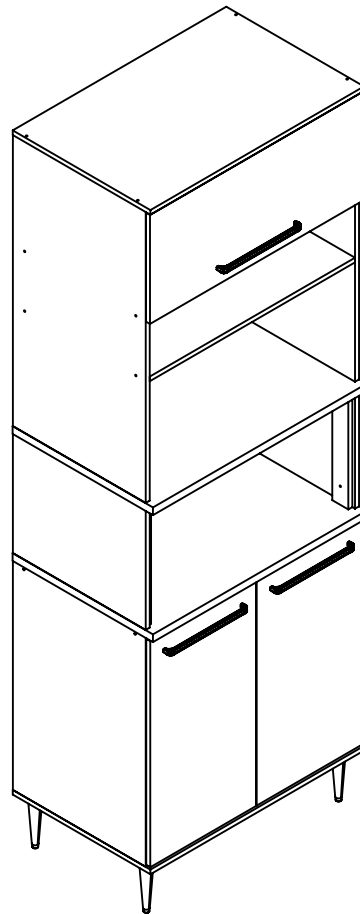

IS 1802

IS 1702

Instruções de montagem Assembly Instructions / Instrucciones de Montaje

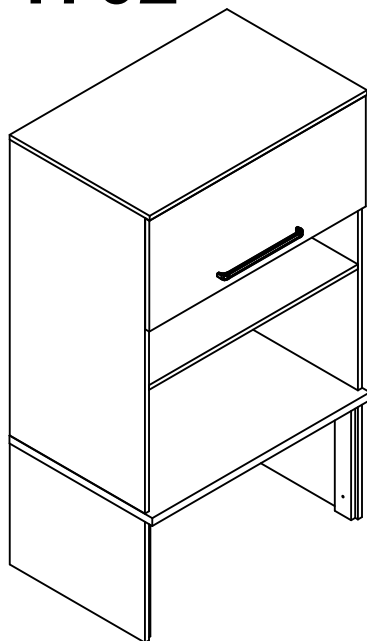

REF	DESC	COMP	LARG	ESP	QTD.
IS1702-01	LATERAL DIR/LADO DERECHO/RIGHT SIDE	385	497	15	1
IS1702-02	LATERAL ESQ/LADO IZQUIERDO/LEFT SIDE	385	497	15	1
IS1702-04	PRATELERA/ESTANTE/SHELF	768	497	15	1
IS1702-07	APOIO FORNO/SOPORTE HORNO/	385	60	15	1
IS1702-08	CHAPEU/SOMBRERO/HAT	800	515	15	1
IS1702-10	TAMPO/TAPA/TOP	800	520	25	1
IS1702-11	PORTA/PUERTA/DOOR	796	352	15	1
IS1702-21	LATERAL DIR/LADO DERECHO/RIGHT SIDE	940	497	15	1
IS1702-22	LATERAL ESQ/LADO IZQUIERDO/LEFT SIDE	940	497	15	1
IS1702-61	COSTA/COSTA/COAST	790	366	3	1
IS1702-62	COSTA/COSTA/COAST	790	193	3	2
IS1702-63	COSTA/COSTA/COAST	790	410	3	1

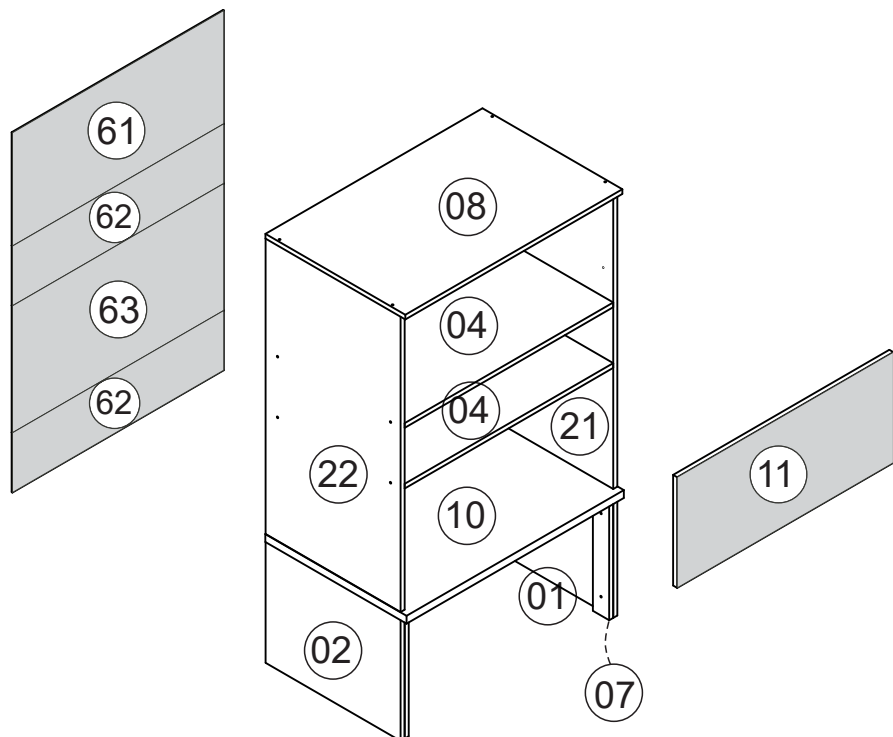

"IMPORTANTE LER COM ATENÇÃO E GUARDAR PARA EVENTUAIS CONSULTAS".

A		CAVILHA Ø6X30 CLAVIJA Ø6X30 WOOD DOWEL Ø6X30	24
B		PARAFUSO CC 3,5X14 TORNILLO CC 3,5X14 SCREW CC 3,5X14	02
C		PARAFUSO CC 3,5X40 TORNILLO CC 3,5X40 SCREW CC 3,5X40	20
DB		DOBRADIÇA BISAGRA HINGE	02
F		PARAFUSO CF 4,5X50 TORNILLO CF 4,5X50 SCREW CF 4,5X50	01
M		PREGO 10X10 CLAVO 10X10 NAIL	55
Z		PARAFUSO CF 3,5X25 TORNILLO CF 3,5 X 25 SCREW CF 3,5X25	09
U		ADESIVO TAPA FURO ADHESIVO STICKER	06
V		COLA PEGAMENTO GLUE	01
PX		PUXADOR TIRADOR HANDLE	01
G		SUPORE FIXAÇÃO SOPORTE DE FIJACIÓN FIXING SUPPORT	01
H		PROTEÇÃO SUP CANTONEIRA PROTECCIÓN ANGLE BRACKET	01
I		BUCHA PLÁSTICA CASQUILLO BUSHING	01
X		FIXADOR COSTA FIJADOR DE ESPALDA BACK FIXER	12
J		TAMBOR MINIFIX TAMBOR MINIFIX MINIFIX DRUM	04
K		PARAFUSO MINIFIX TORNILLO MINIFIXO MINIFIX SCREW	04
P		PISTAO PISTON PISTON	01

1 IS 1702

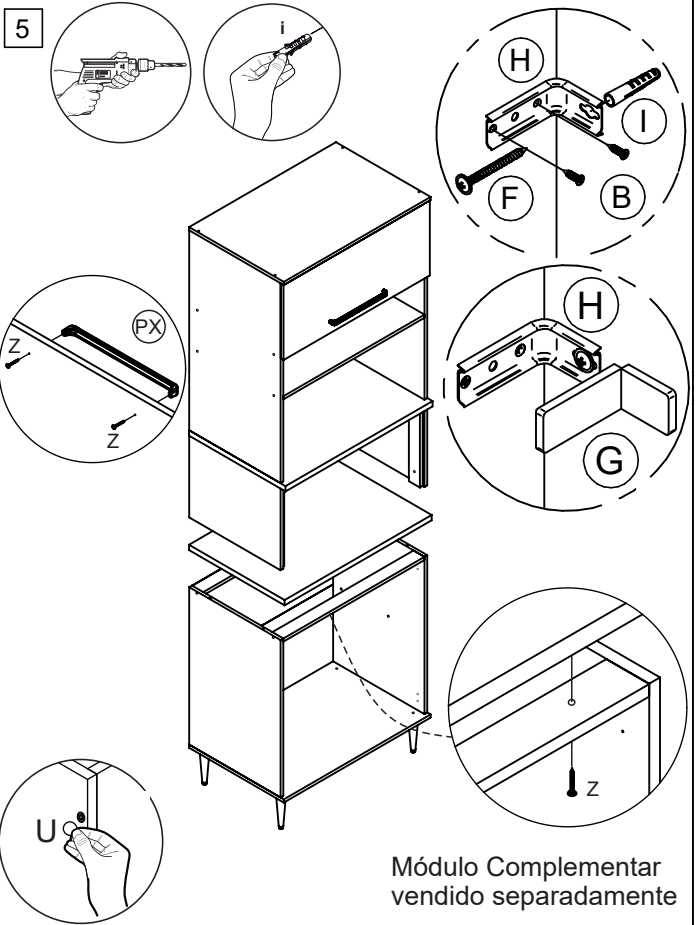
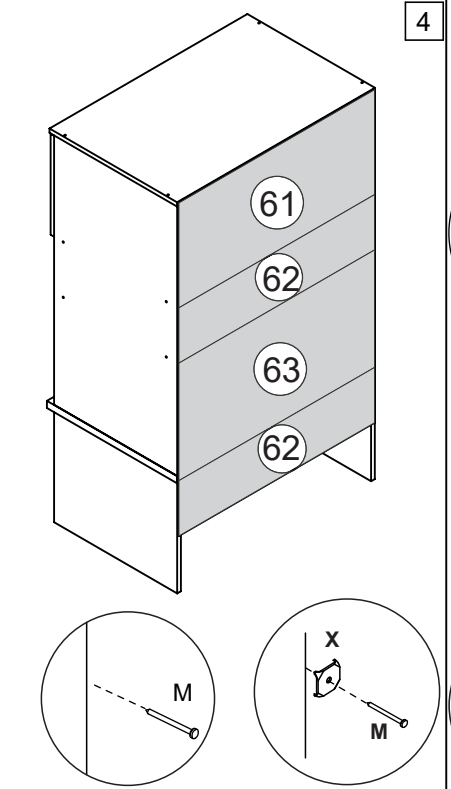
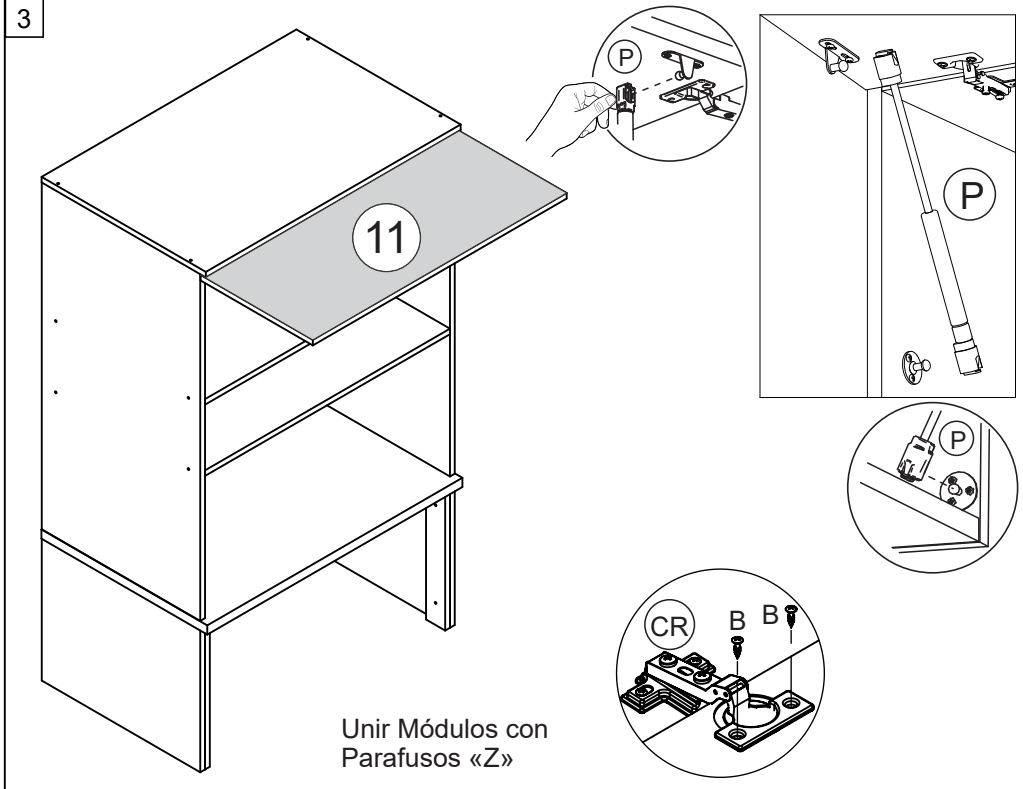
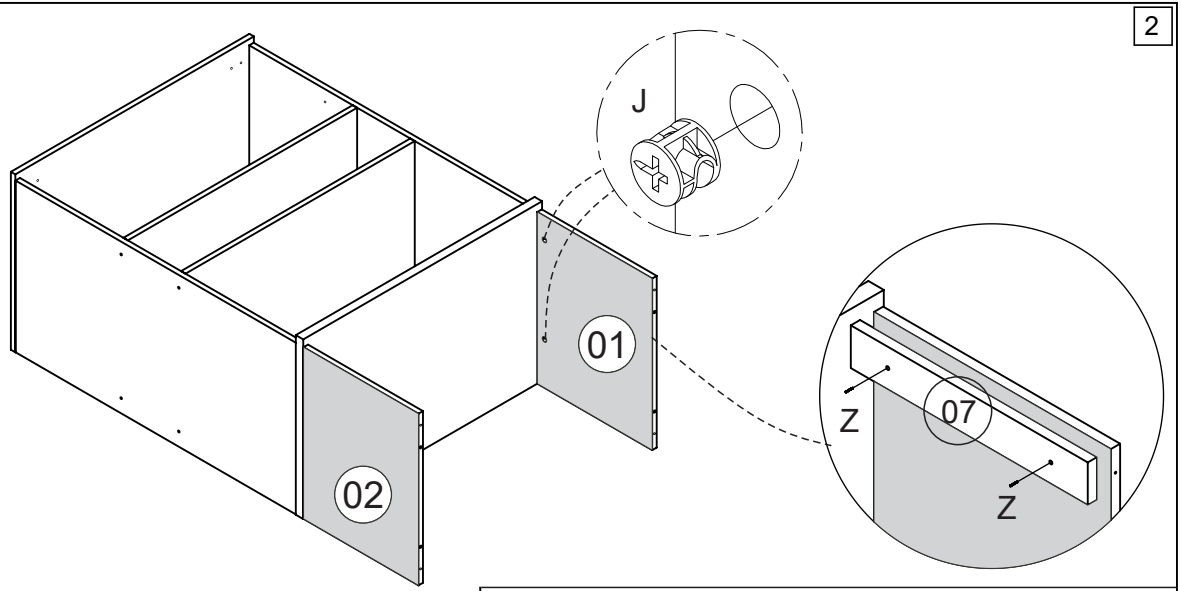
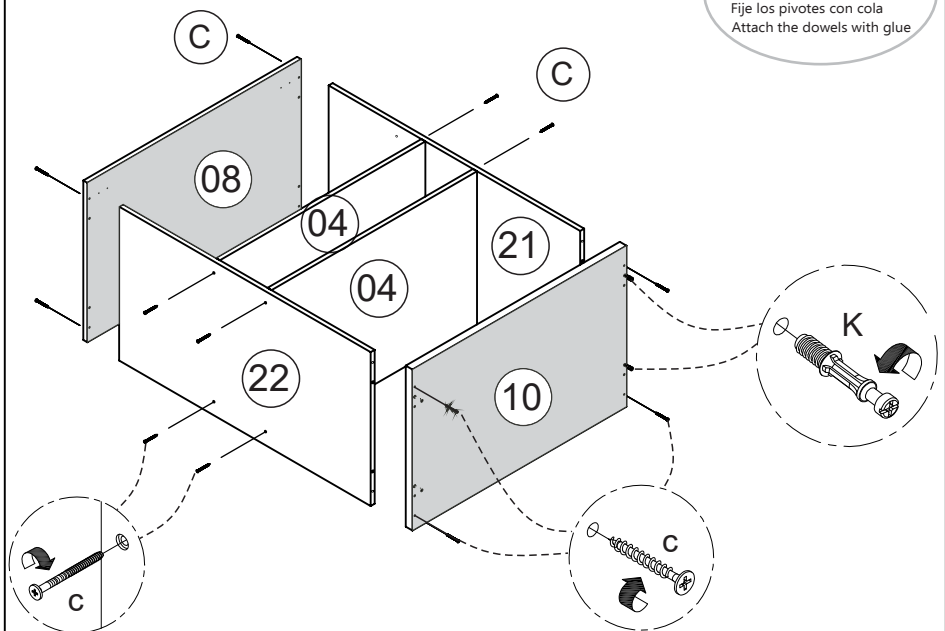

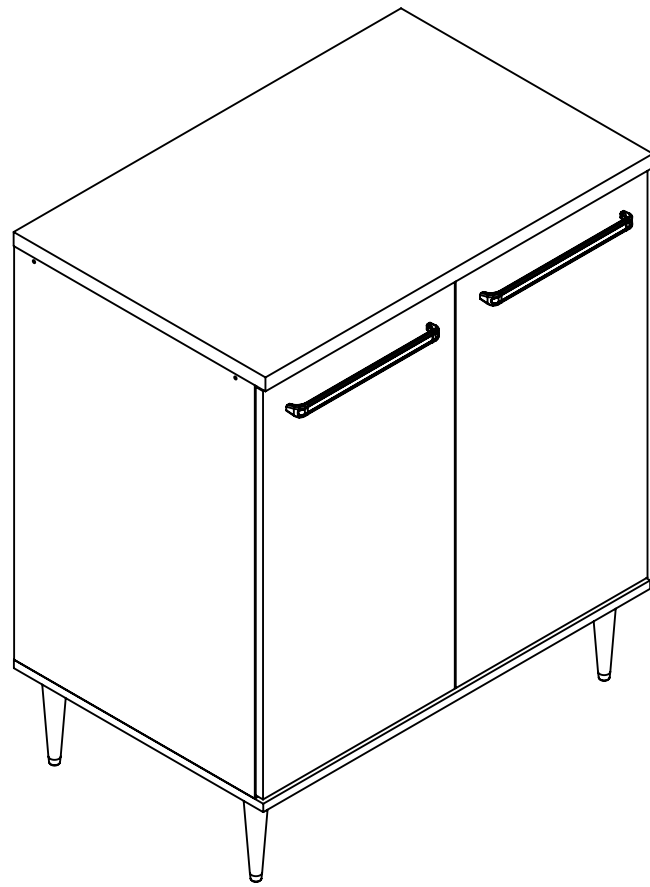

**Lista de ferragens
Hardware list
Lista de materiales**

A		CAVILHA Ø6X30 CLAVIJA Ø6X30 WOOD DOWEL Ø6X30	16
B		PARAFUSO CC 3,5X14 TORNILLO CC 3,5X14 SCREW CC 3,5X14	02
C		PARAFUSO CC 3,5X40 TORNILLO CC 3,5X40 SCREW CC 3,5X40	08
DB		DOBRADIÇA BISAGRA HINGE	04
F		PARAFUSO CF 4,5X50 TORNILLO CF 4,5X50 SCREW CF 4,5X50	05
Z		PARAFUSO CF 3,5X25 TORNILLO CF 3,5X25 SCREW CF 3,5X25	11
U		ADESIVO TAPA FURO ADHESIVO STICKER	04
G		PROTEÇÃO SUP CANTONEIRA PROTECCIÓN ANGLE BRACKET	01
H		SUPORTE FIXAÇÃO SOPORTE DE FIJACIÓN FIXING SUPPORT	01
I		BUCHA PLÁSTICA CASQUILLO BUSHING	01
M		PREGO 10X10 CLAVO 10X10 NAIL	45
V		COLA PEGAMENTO GLUE	01
PX		PUXADOR TIRADOR HANDLE	02
PE		PÉ PIE FOOT	04
X		FIXADOR COSTA FIJADOR DE ESPALDA BACK FIXER	05

Lista de peças / Parts lists / Lista de piezas

REF	DESC	COMP	LARG	ESP	QTD.
IS1501-01	LATERAL DIREITA/LADO DERECHO/RIGHT SIDE	740	497	15	1
IS1501-02	LATERAL ESQUERDA/LADO IZQUIERDO/LEFT SIDE	740	497	15	1
IS1501-03	BASE/BASE/BASE	799	515	15	1
IS1501-04	PRATELEIRA/ESTANTE/SHELF	768	350	15	1
IS1501-06	TRAVESSA FRONTAL/TRAVESAN~I/LONG PLATE	768	60	15	1
IS1501-10	TAMPO/TAPA/TOP	800	520	25	1
IS1501-12	PORTA/PUERTA/DOOR	396	730	15	2
IS1501-26	TRAVESSA TRASERA/TRAVESAN~I/LONG PLATE	768	60	15	1
IS1501-61	COSTA/FONDO/BACK	375	790	3	2

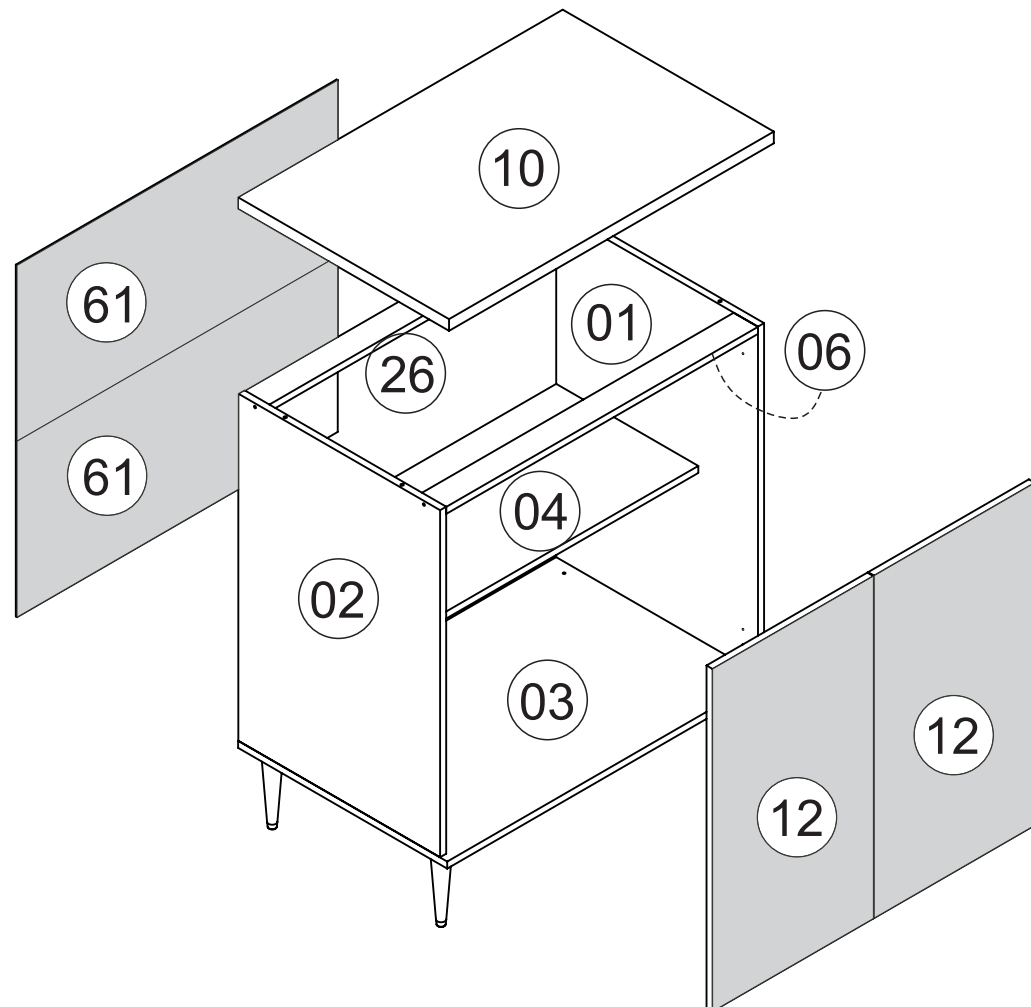

FERRAMENTAS NECESSÁRIAS:
HERRAMIENTAS NECESARIAS:
NECESSARY TOOLS:



**"IMPORTANTE LER COM ATENÇÃO
E GUARDAR PARA EVENTUAIS
CONSULTAS".**

"IMPORTANTE LEER CON ATENCIÓN Y GUARDAR PARA
EVENTUALES CONSULTAS".

"IMPORTANT TO READ CAREFULLY AND SAVE FOR ANY
QUERIES".

IS 1501

Instruções de Montagem / Assembly Instructions / Instrucciones de Montaje

01

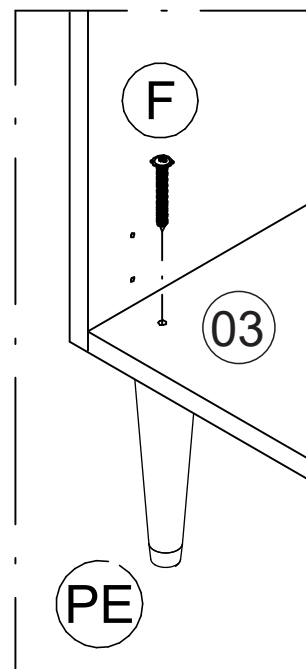
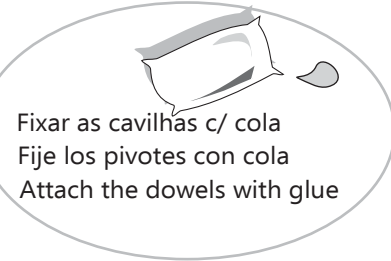
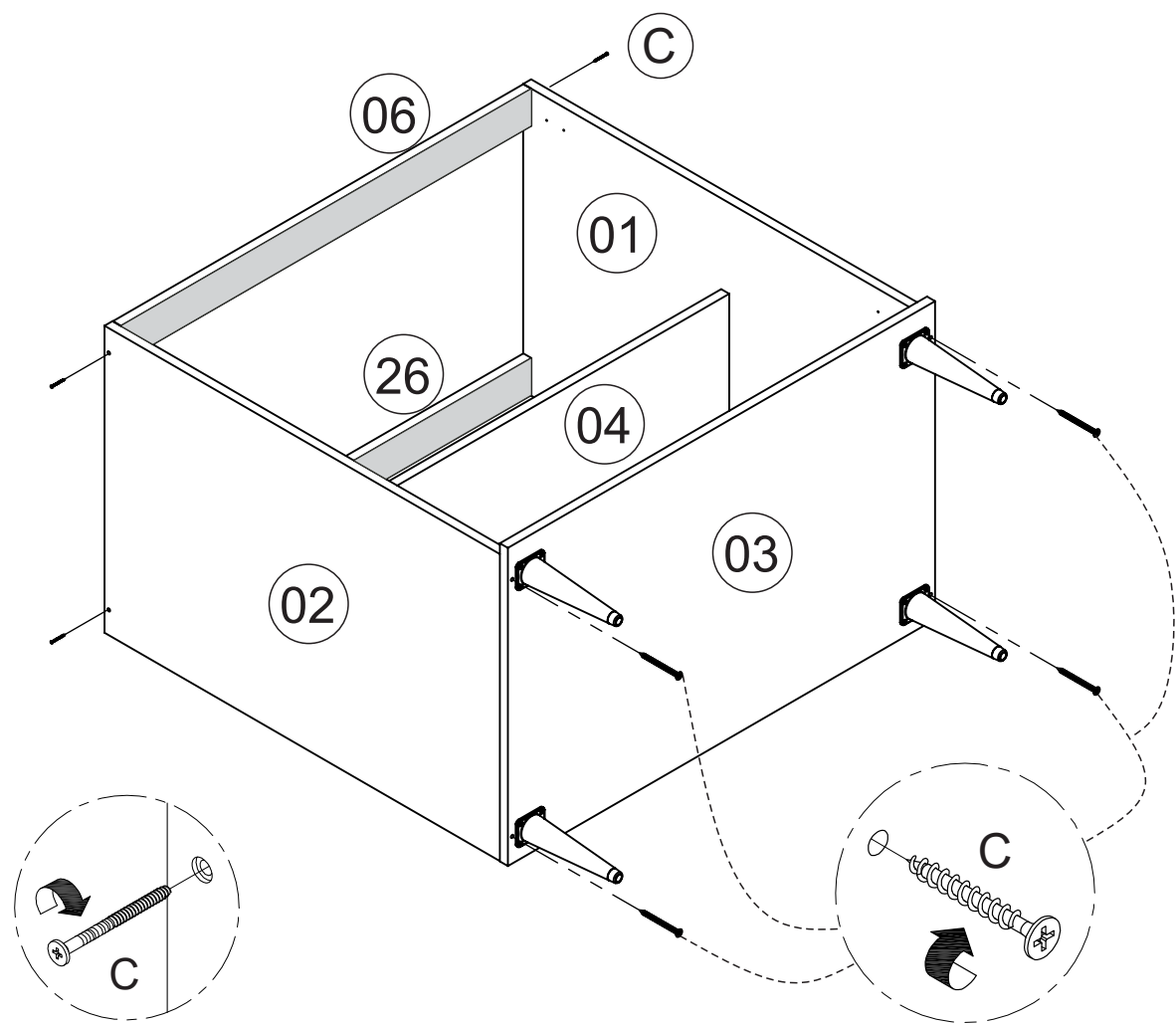

02

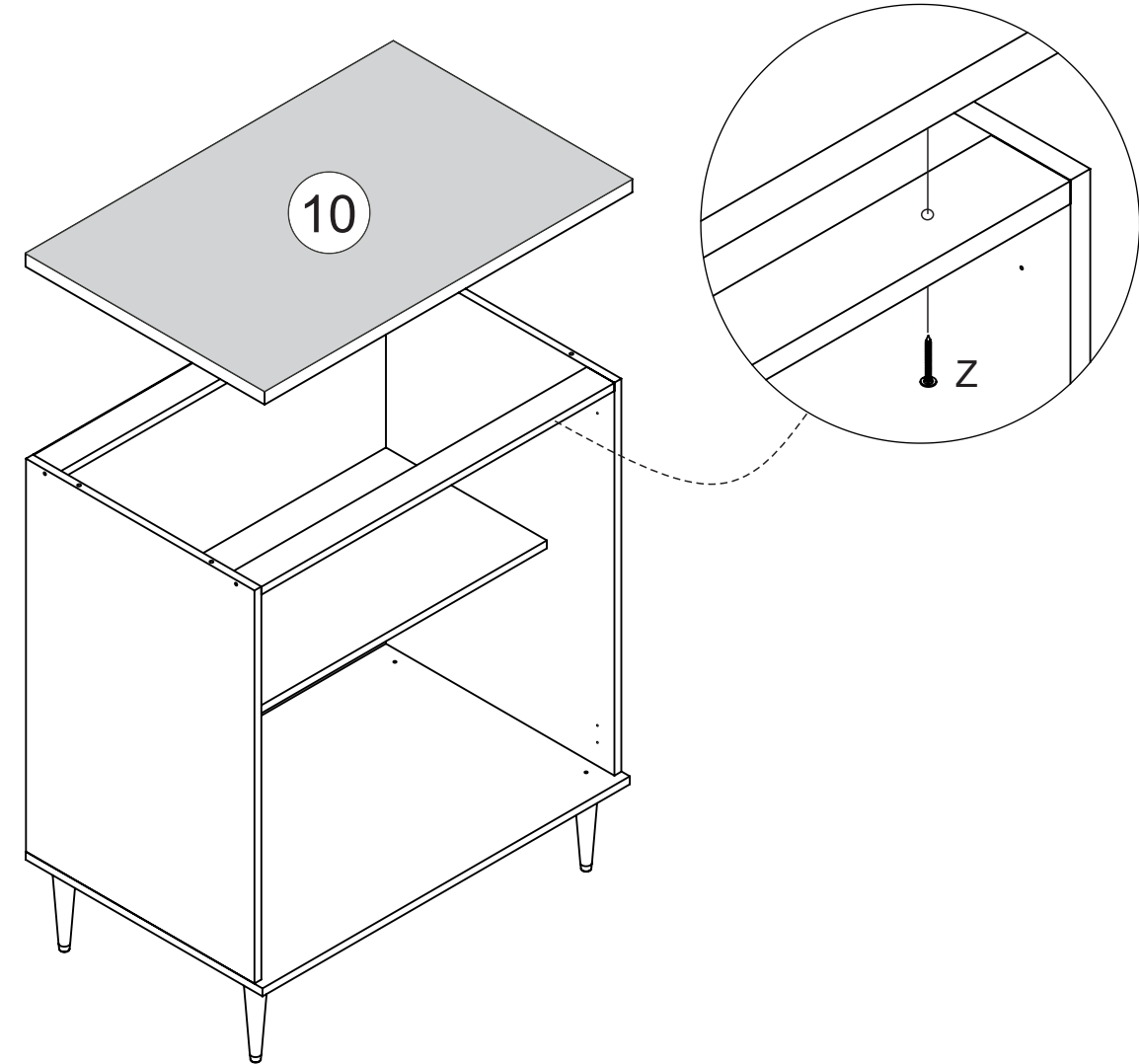

03

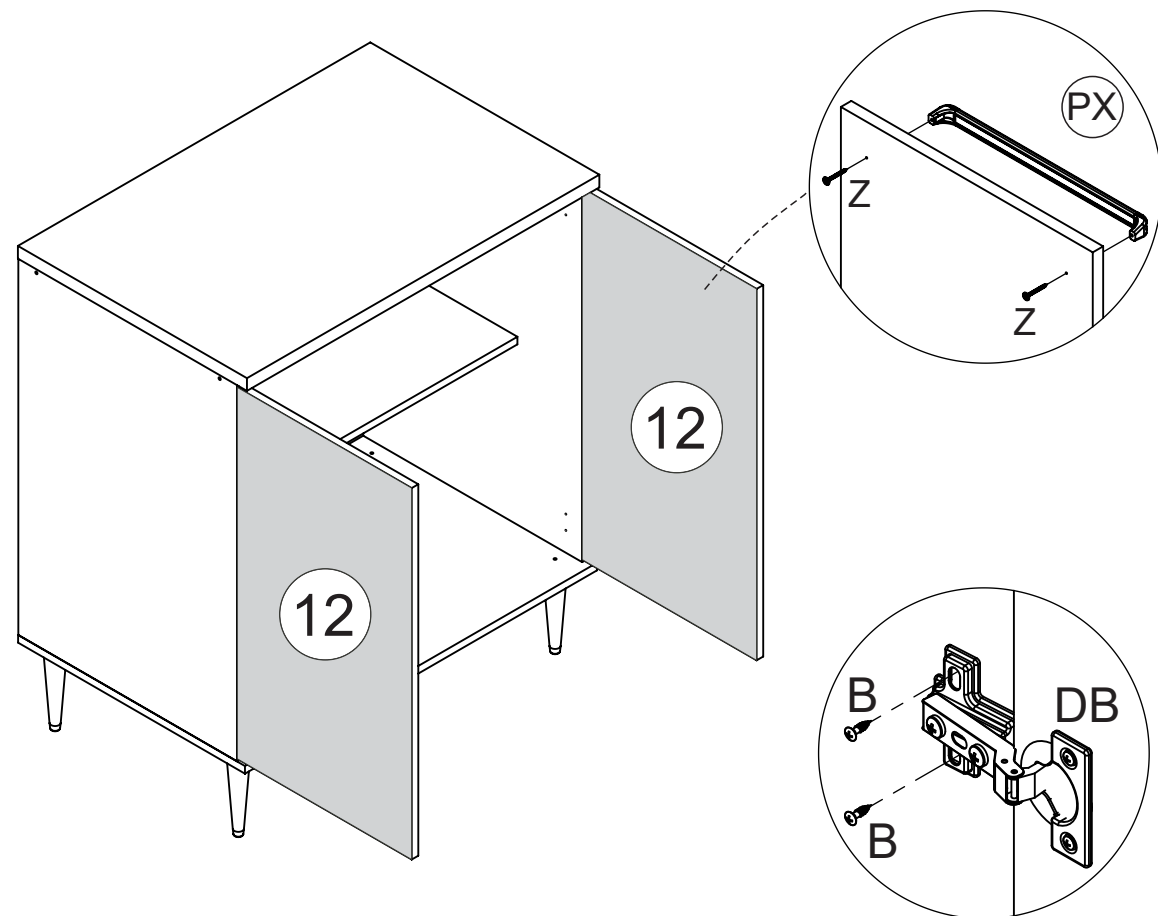

04

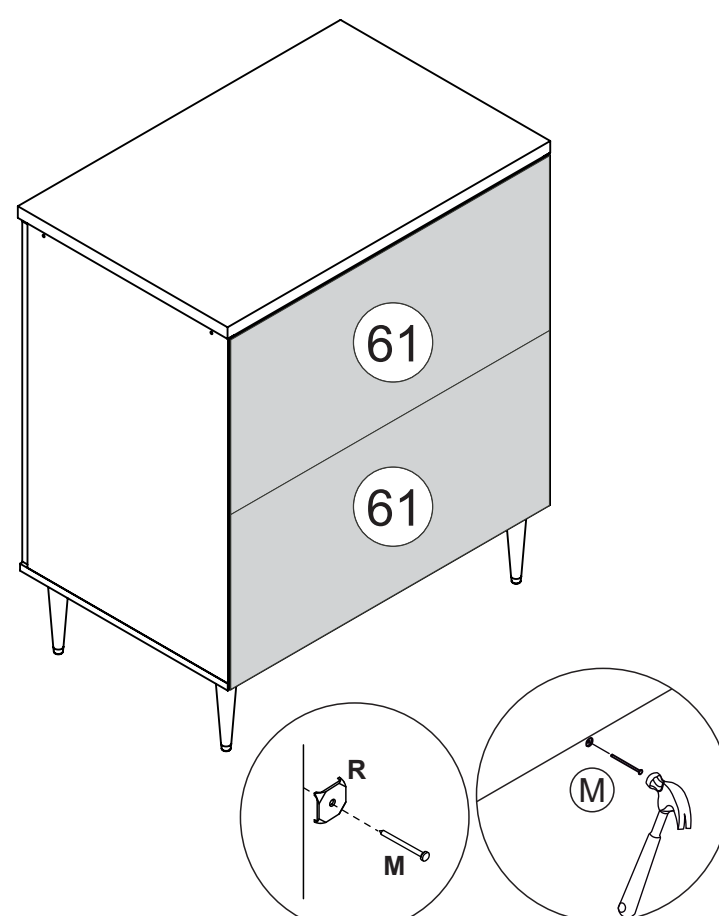

05

Parafuso "Z" união de módulos
Tornillo "Z" unión de módulos

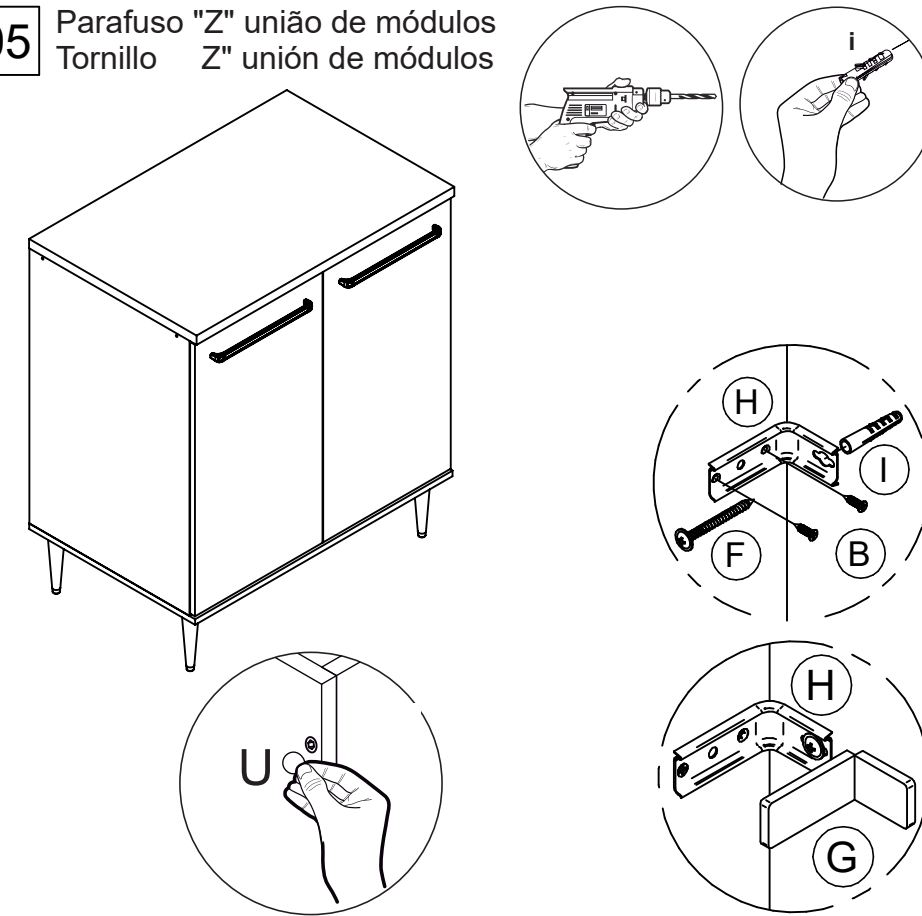

Instruções de montagem

Assembly Instructions / Instrucciones de Montaje

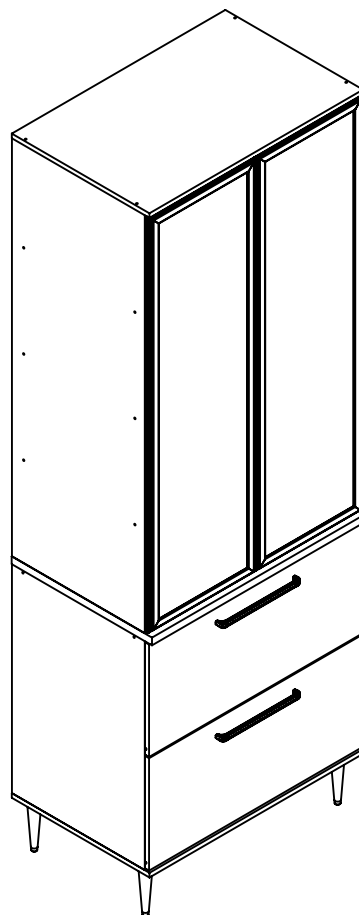

IS 1852

IS 1704

Instruções de montagem Assembly Instructions / Instrucciones de Montaje

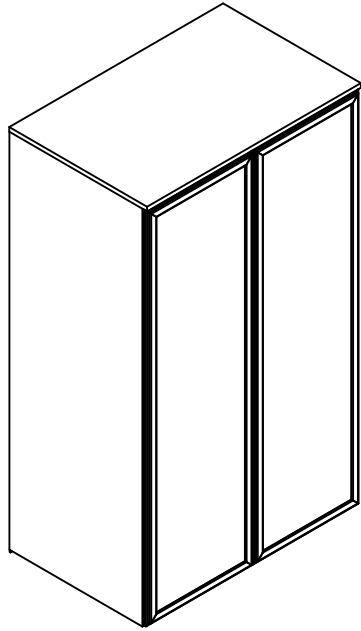

REF	DESC	COMP	LARG	ESP	QTD.
IS1704-01	LATERAL DIR/LADO DERECHO/RIGHT SIDE	1350	497	15	1
IS1704-02	LATERAL ESQ/LADO IZQUIERDO/LEFT SIDE	1350	497	15	1
IS1704-04	PRATELERA/ESTANTE/SHELF	768	497	15	2
IS1704-08	CHAPEU/SOMBREIRO/HAT	800	515	15	1
IS1704-11	PORTA/PUERTA/DOOR	396	1342	15	2
IS1704-24	PRATELERA/ESTANTE/SHELF	768	495	15	1
IS1704-61	COSTA/COSTA/COAST	790	343	3	4

A		CAVILHA Ø6X30 CLAVIJA Ø6X30 WOOD DOWEL Ø6X30	20
B		PARAFUSO CC 3,5X14 TORNILLO CC 3,5X14 SCREW CC 3,5X14	02
C		PARAFUSO CC 3,5X40 TORNILLO CC 3,5X40 SCREW CC 3,5X40	20
DB		DOBRADIÇA BISAGRA HINGE	06
F		PARAFUSO CF 4,5X50 TORNILLO CF 4,5X50 SCREW CF 4,5X50	01
M		PREGO 10X10 CLAVO 10X10 NAIL 10X10	60
Z		PARAFUSO CF 3,5X25 TORNILLO CF 3,5 X 25 SCREW CF 3,5X25	04
U		ADESIVO TAPA FURO ADHESIVO STICKER	10
V		COLA PEGAMENTO GLUE	01
X		FIXADOR COSTAS FIJADOR PRARA FONDO BACK SUPPORT	12
Y		PULSADOR LEGUMBRES PULSE	02
Y1		PULSADOR LEGUMBRES PULSE	02
Y2		BATENTE SOLAPA FLAP	02

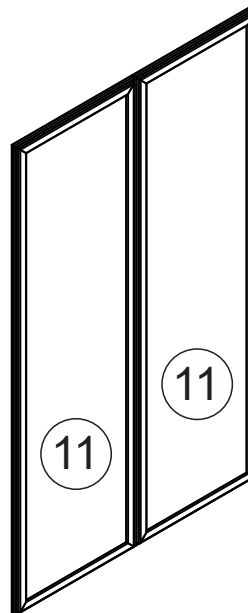
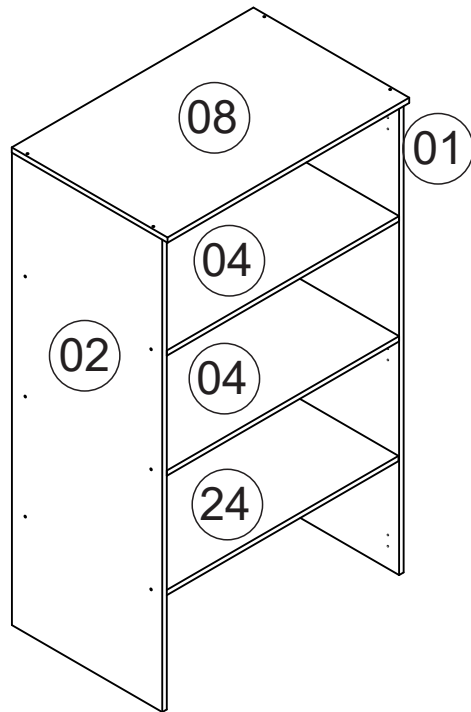
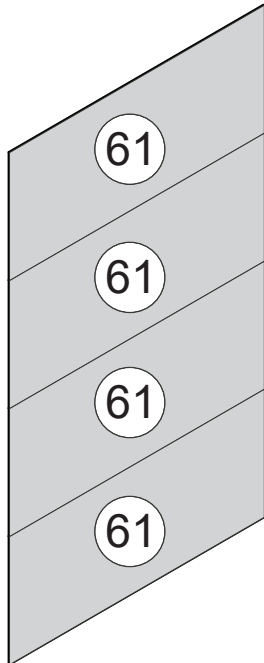

"IMPORTANTE LER COM ATENÇÃO E GUARDAR PARA EVENTUAIS CONSULTAS".

G		SUPORTE FIXAÇÃO SOPORTE DE FIJACIÓN FIXING SUPPORT	01
H		PROTEÇÃO SUP CANTONEIRA ANGLE BRACKET	01
I		BUCHA PLÁSTICA CASQUILLO BUSHING	01

1 **IS 1704**

Fixar as cavilhas c/ cola
Fije los pivotes con cola
Attach the dowels with glue

2

370 mm

370 mm

3

310 mm

310 mm

4

61

61

61

61

X

M

5

Unir Módulos con Parafusos «Z»

Módulo Complementar vendido separadamente



Lista de ferragens

Lista de materiales Hardware list

A		CAVILHA Ø6X30 CLAVIJA Ø6X30 WOOD DOWEL Ø6X30	30
B		PARAFUSO CC 3,5X14 TORNILLO CC 3,5X14 SCREW CC 3,5X14	26
C		PARAFUSO CC 3,5X40 TORNILLO CC 3,5X40 SCREW CC 3,5X40	14
F		PARAFUSO CF 4,5X50 TORNILLO CF 4,5X50 SCREW CF 4,5X50	05
M		PREGO 10X10 CLAVO 10X10 NAIL	75
Z		PARAFUSO CF 3,5X25 TORNILLO CF 3,5 X 25 SCREW CF 3,5X25	11
U		ADESIVO TAPA FURO STICKER	04
V		COLA PEGAMENTO GLUE	01
PE		PÉ PIE FOOT	04
PX		PUXADOR TIRADOR HANDLE	02
G		SUPORTE FIXAÇÃO SOPORTE DE FIJACIÓN FIXING SUPPORT	01
H		PROTEÇÃO SUP CANTONEIRA PROTECCIÓN ANGLE BRACKET	01
I		BUCHA PLÁSTICA CASQUILLO BUSHING	01
H		PERFIL PERFIL PROFILE	01
CR		CORREDIÇA 350 CORREDERA SLIDE	02

Lista de peças / Parts lists / Lista de piezas

REF	DESC	COMP	LARG	ESP	QTD.
IS1511-01	LATERAL DIREITA/LADO DERECHO/RIGHT SIDE	740	497	15	1
IS1511-02	LATERAL ESQUERDA/LADO IZQUIERDO/LEFT SIDE	740	497	15	1
IS1511-03	BASE/BASE/BASE	799	515	15	1
IS1511-06	TRAVESSA FRONTAL/TRAVESAN~I/LONG PLATE	768	60	15	1
IS1511-09	APOIO/SOPORTE/SHELF	380	60	15	2
IS1511-10	TAMPO/TAPA/TOP	800	520	25	1
IS1511-15	LATERAL GAVETA DIR/CAJÓN LATERAL/SIDE DRAWER	380	195	15	2
IS1511-16	LATERAL GAVETA ESQ/CAJÓN LATERAL/SIDE DRAWER	380	195	15	2
IS1511-18	COST GAVETA ESQ/CAJÓN COSTADO/SIDE DRAWER	714	195	15	2
IS1511-20	FRENTE GAVETA/FRENTE DE CAJÓN/DRAWER FRONT	796	363	15	2
IS1511-26	TRAVESSA TRASERA/TRAVESAN~I/LONG PLATE	768	60	15	1
IS1511-60	COSTA/FONDO/BACK	383	742	3	2
IS1511-61	COSTA/FONDO/BACK	375	790	3	2

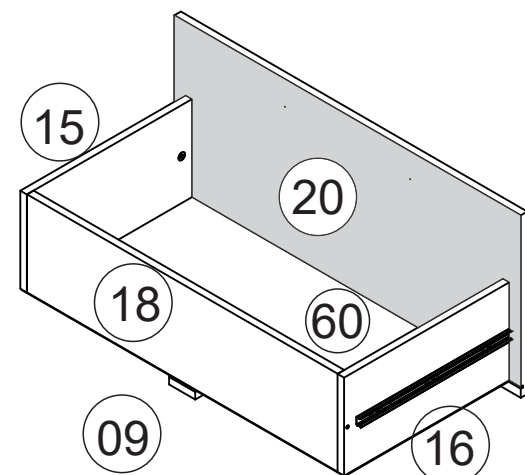
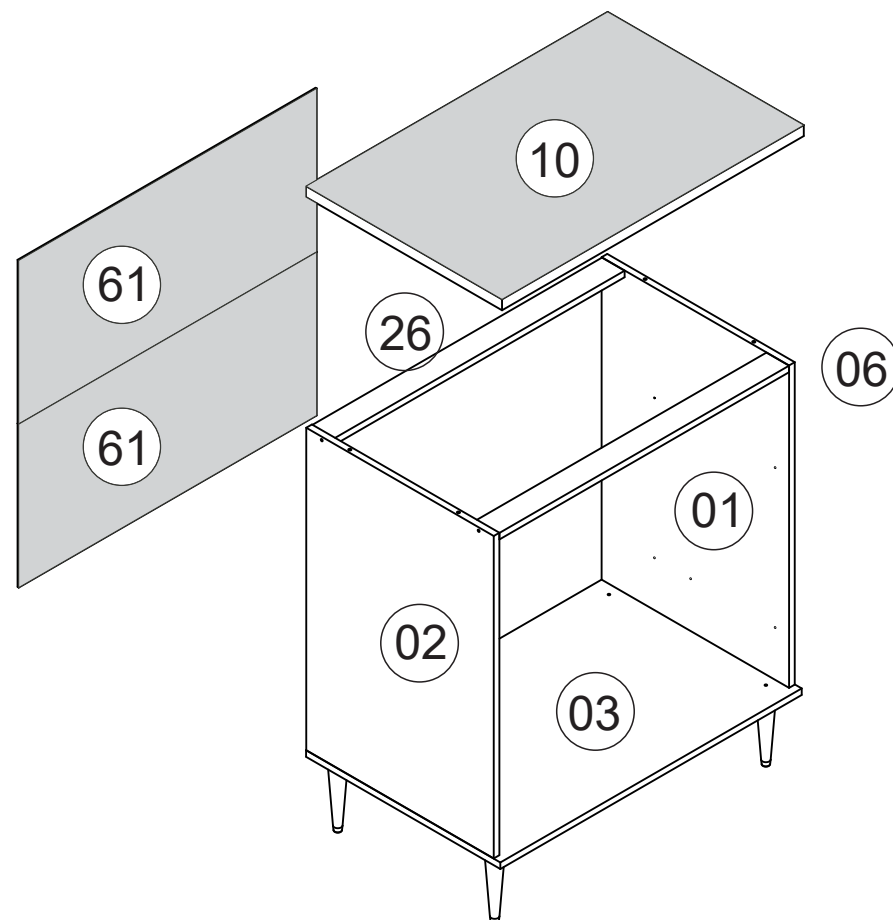

FERRAMENTAS NECESSÁRIAS:

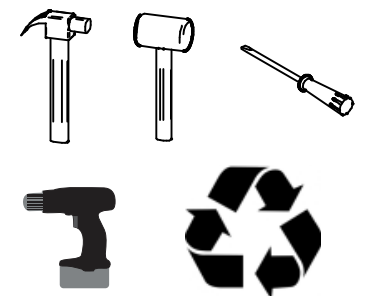

FERRAMENTAS NECESSÁRIAS: HERRAMIENTAS NECESARIAS: NECESSARY TOOLS:

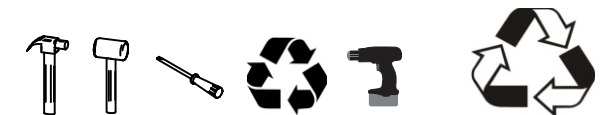

"IMPORTANTE LER COM ATENÇÃO E GUARDAR PARA EVENTUAIS CONSULTAS".

"IMPORTANTE LEER CON ATENCIÓN Y GUARDAR PARA EVENTUALES CONSULTAS".

"IMPORTANT TO READ CAREFULLY AND SAVE FOR ANY QUERIES".

IS 1511

Instruções de Montagem / Assembly Instructions / Instrucciones de Montaje

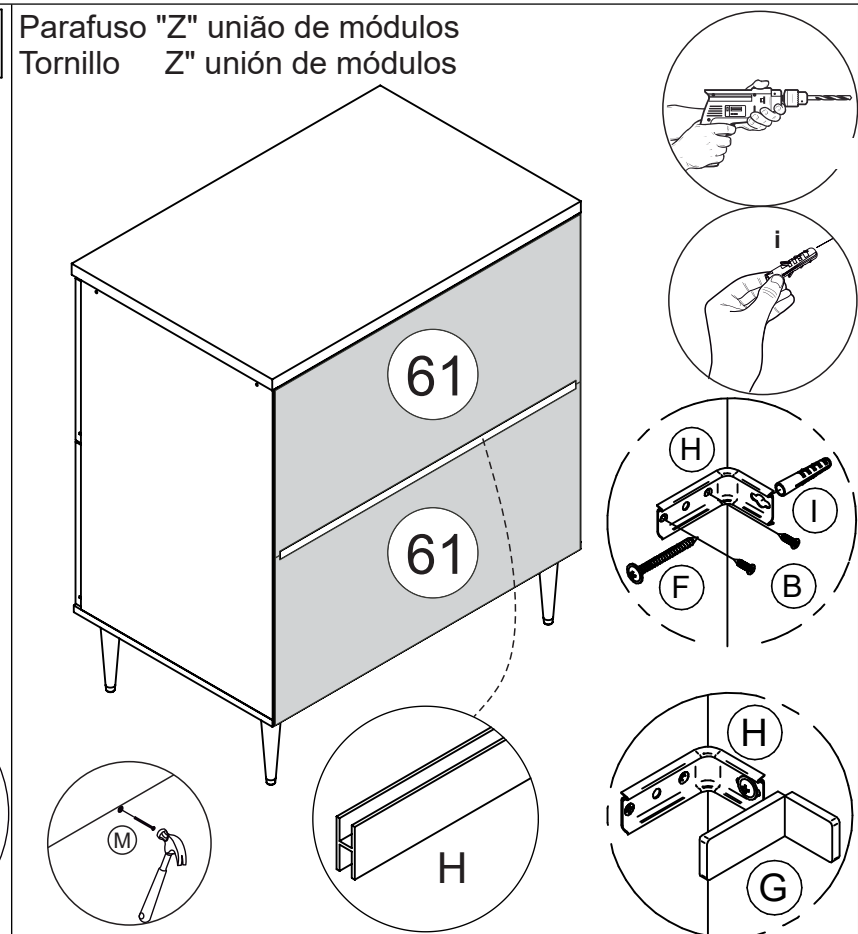
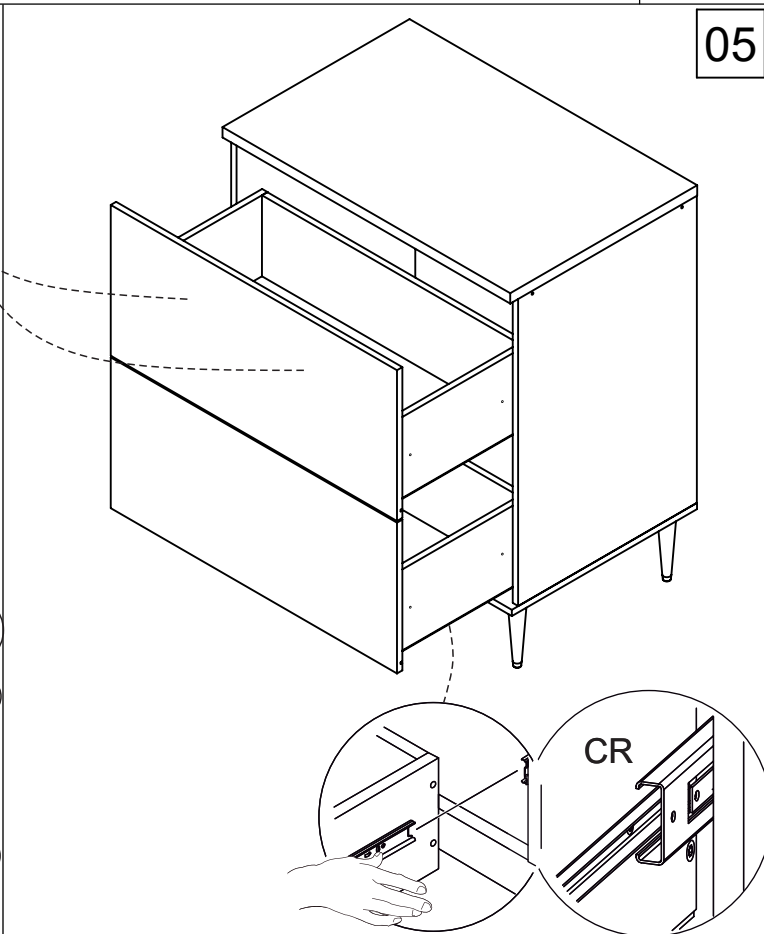
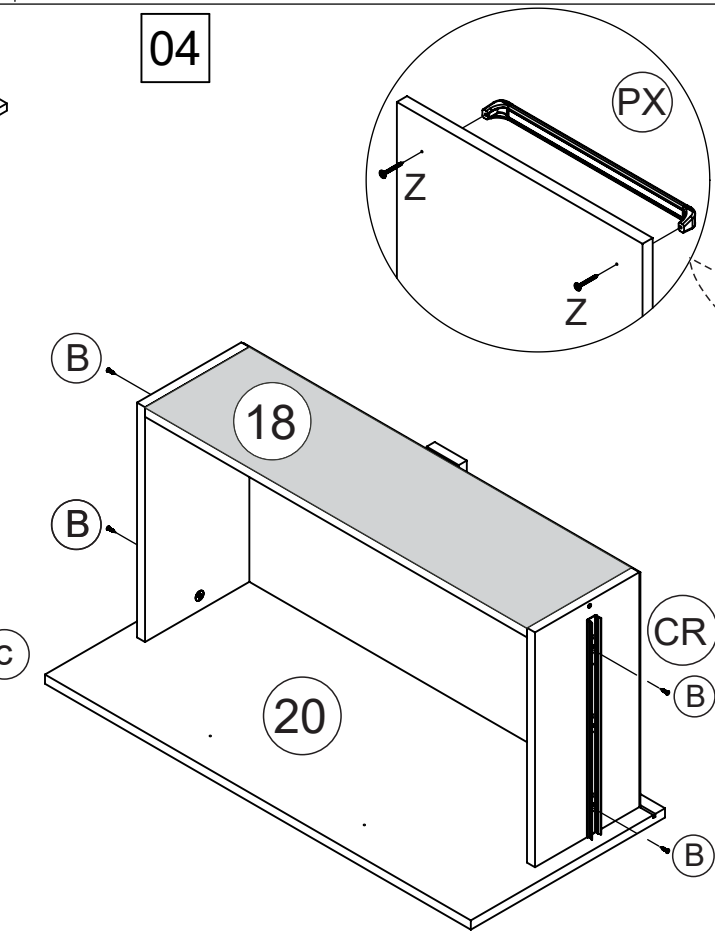
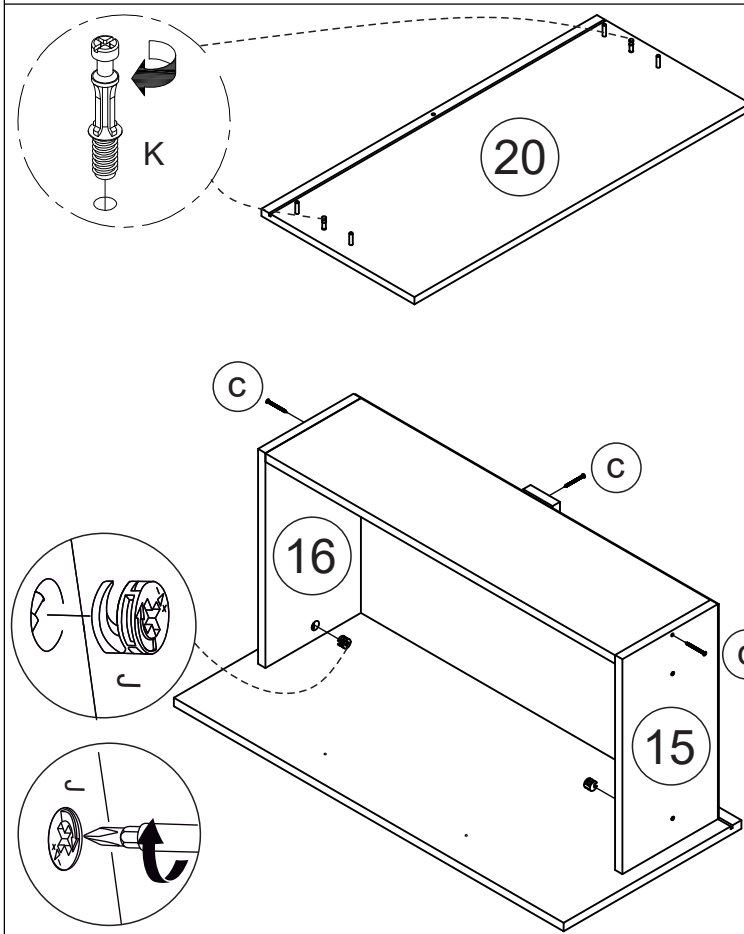
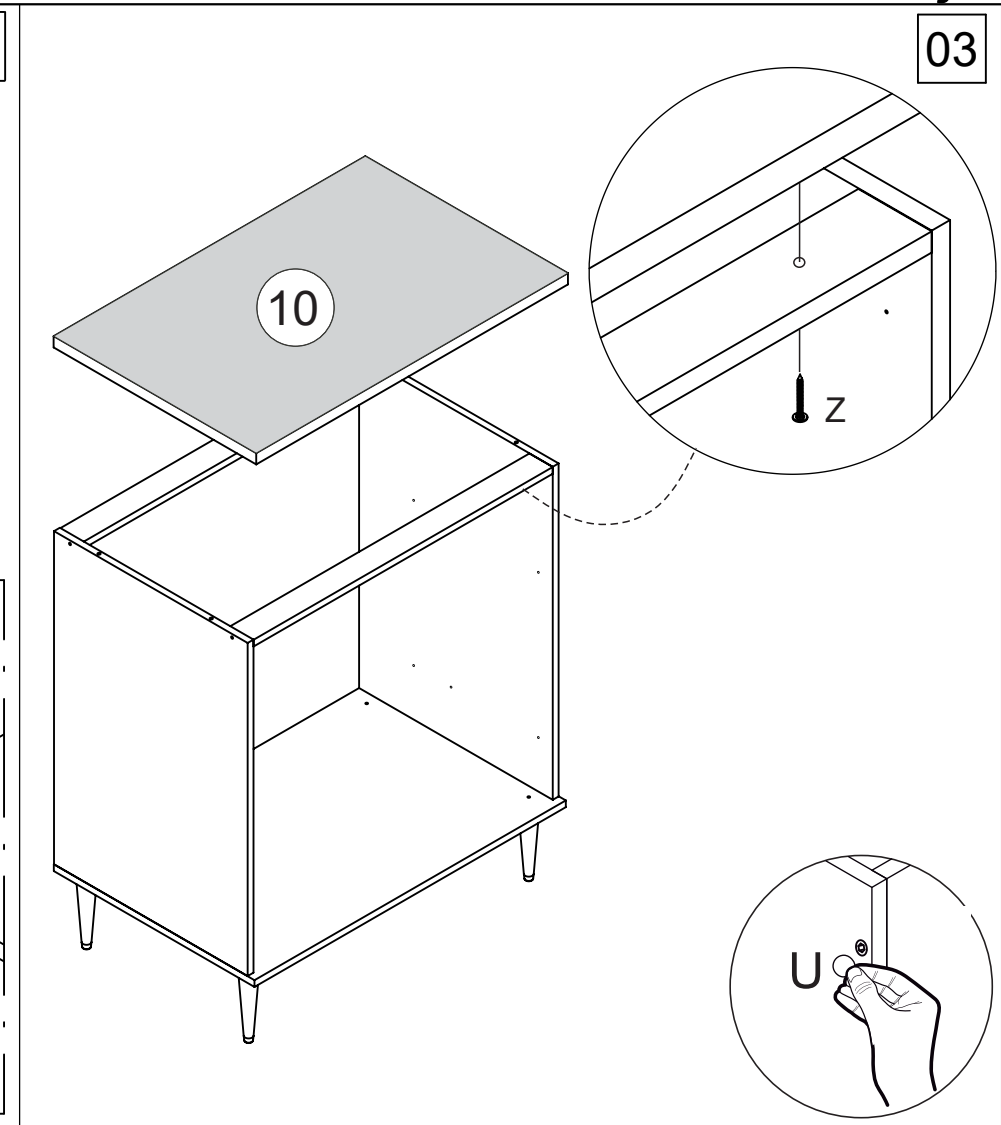
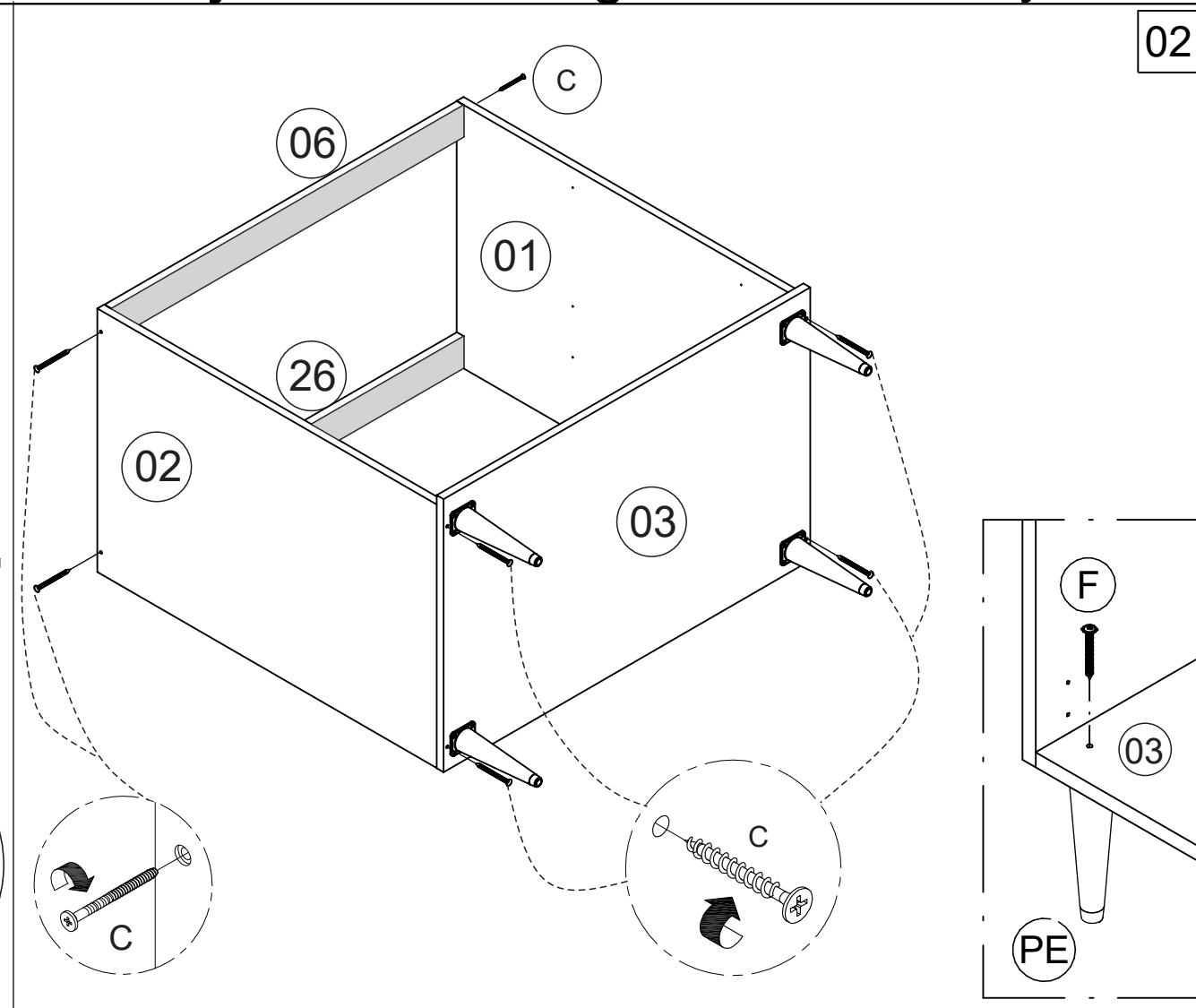
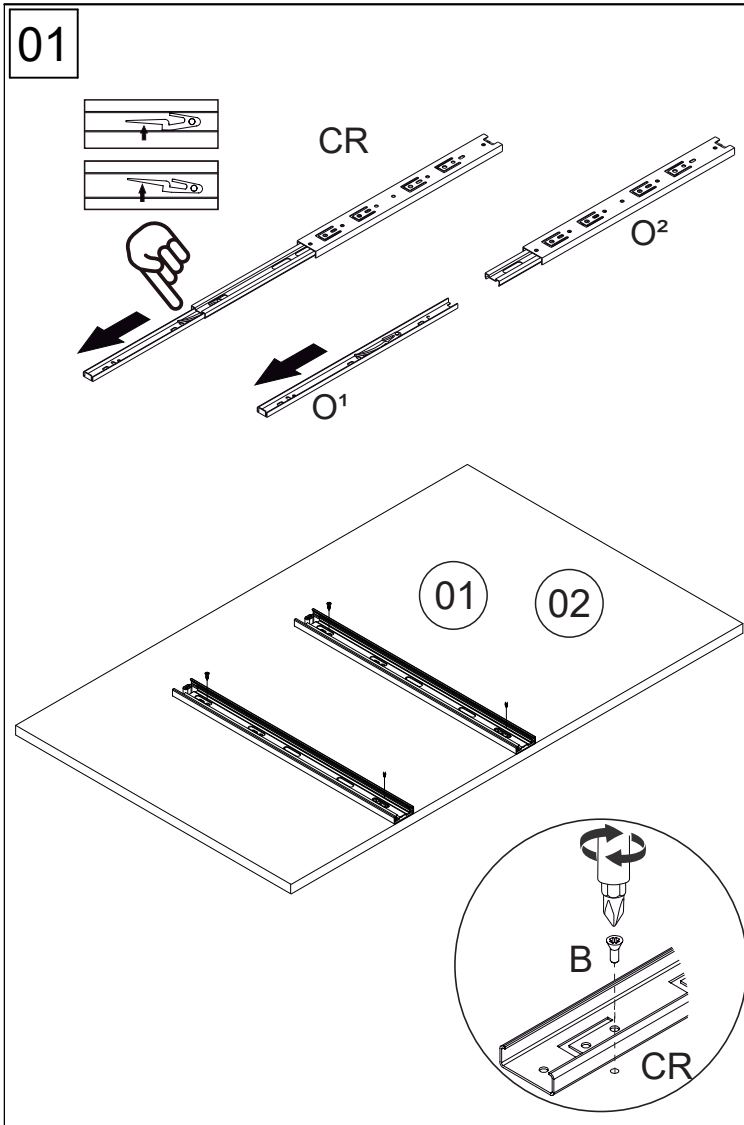

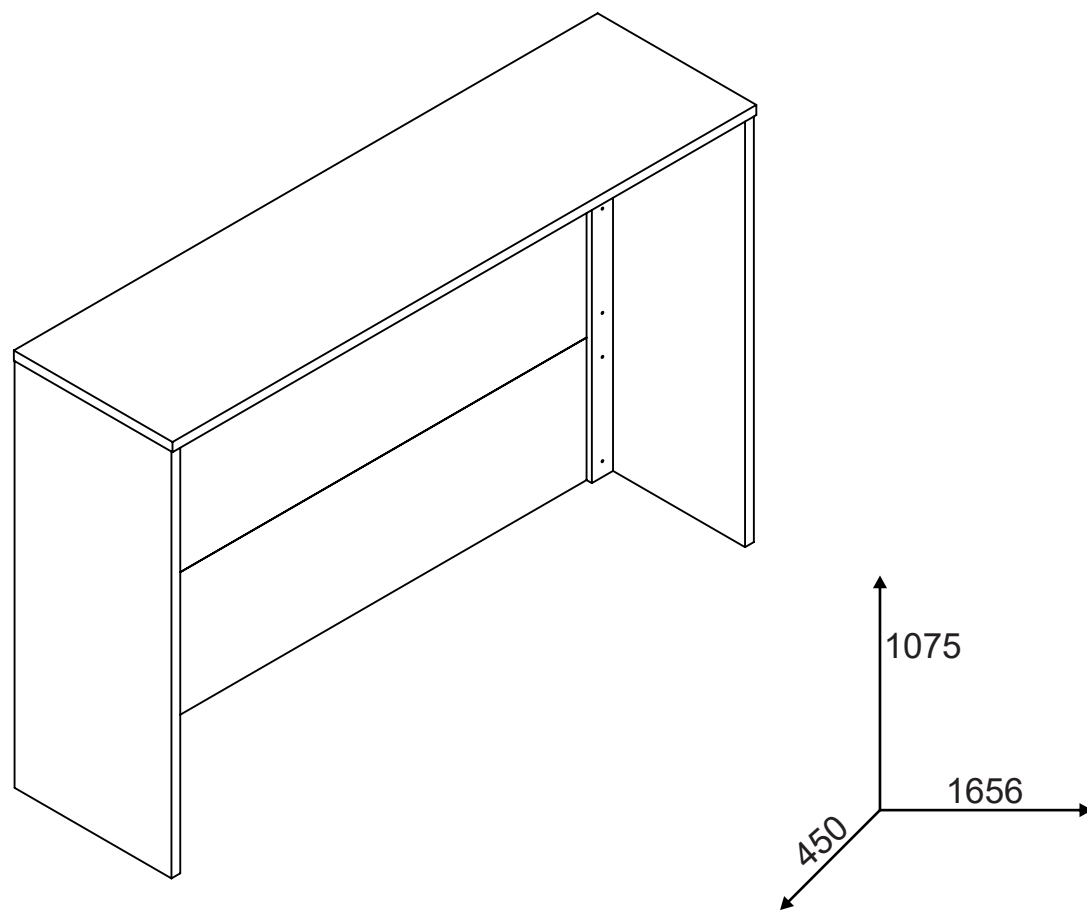

Lista de peças / Parts lists / Lista de piezas

REF	DESC	M1	M2	M3	QT
IS1750-01	LATERAL DIREITA/LADO DERECHO/RIGHT SIDE	1050	445	25	1
IS1750-02	LATERAL ESQUERDA/LADO IZQUIERDO/LEFT SIDE	1050	445	25	1
IS1750-07	PILASTRA/PILAR/PILLAR	1482	60	15	1
IS1750-09	PAINEL/PANEL/PANEL	1602	350	15	3
IS1750-10	TAMPO/TAPA/TOP	1656	450	25	1
IS1750-19	MOLDURA/MARCO/FRAME	1050	60	15	2

Lista de ferragens Lista de materiales Hardware list



A		CAVILHA Ø6X30 CLAVIJA Ø6X30 WOOD DOWEL Ø6X30	22
B		PARAFUSO CC 3,5X14 TORNILLO CC 3,5X14 SCREW CC 3,5X14	07
Z		PARAFUSO CF 3,5X25 TORNILLO CF 3,5 X 25 SCREW CF 3,5X25	18
K		TAMBOR MINIFIX TORNILLO MINIFIJO MINIFIX SCREW	16
J		TAMBOR MINIFIX TAMBOR MINIFIX MINIFIX DRUM	16
V		COLA PEGAMENTO GLUE	01
W		SAPATA PLASTICO ZAPATO PLASTICO PLASTIC SHOE	07

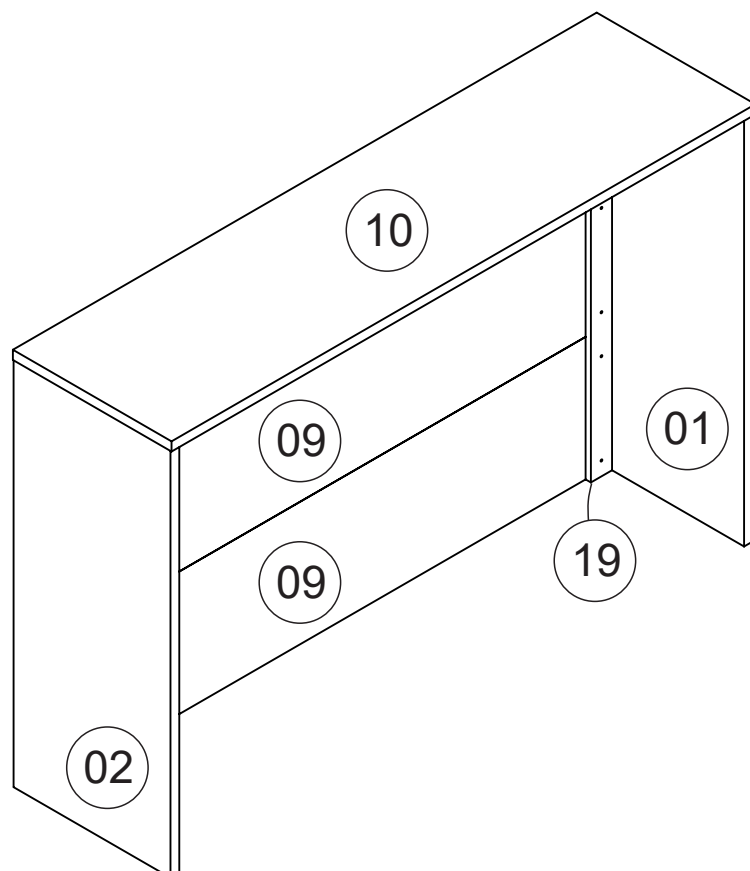

INSTRUÇÕES DE MONTAGEM ASSEMBLY'S INSTRUCTIONS INSTRUCCIONES DE MONTAJE

"**IMPORTANT LER COM ATENÇÃO E GUARDAR PARA EVENTUAIS CONSULTAS**".

"**IMPORTANT LEER CON ATENCIÓN Y GUARDAR PARA EVENTUALES CONSULTAS**".

"**IMPORTANT TO READ CAREFULLY AND SAVE FOR ANY QUERIES**".



Limpar o número da peça com pano levemente umedecido com álcool



Clean the part number with a cloth slightly dampened with alcohol



Limpiar el número de la pieza con un paño ligeramente humedecido con alcohol.

IS 1750

Instruções de Montagem / Assembly Instructions / Instrucciones de Montaje

