

Produto Concluído  
Producto terminado  
Finished Product

ITM/D313-  
Rev 000

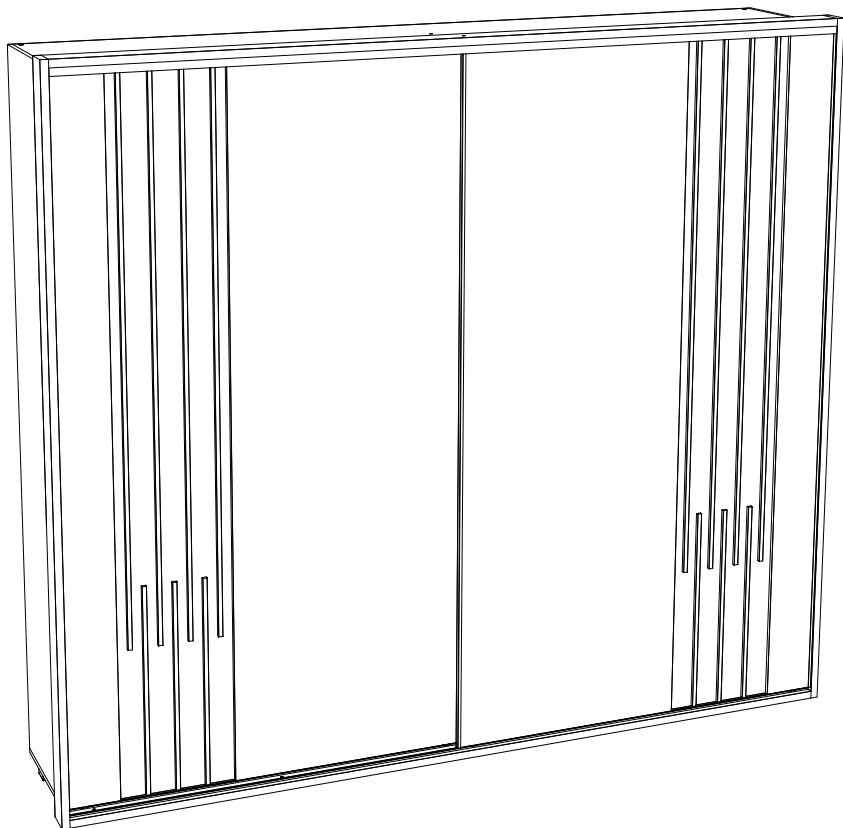

**HENN**

Ind. e Com. de Móveis Henn  
Mondai - SC - Brasil

+55 49 3674.3500

@moveishenn  
www.henn.com.br

ITM/D313-  
**INSTRUÇÕES DE  
MONTAGEM**

INSTRUCCIONES DE MONTAJE  
ASSEMBLY INSTRUCTIONS

Roupeiro Vicenza 2 Portas Deslizantes | Vicenza Armario 2 Puertas  
Correderas | Vicenza Wardrobe 2 Sliding Doors

D313-127 Nature/Off White  
D313-131 Cinza

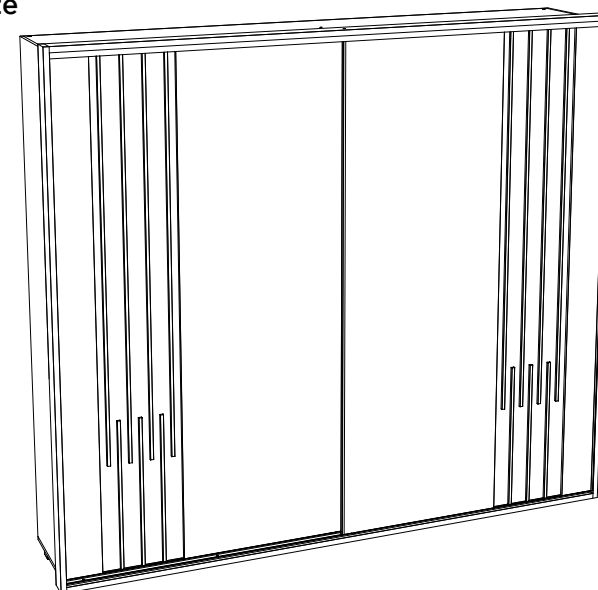

Requisitos para montagem  
Requisitos para la montaje  
Assembly Requirements

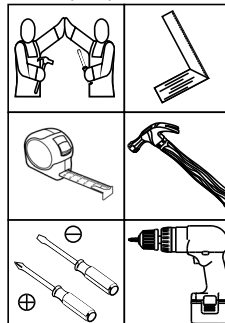

Imagens meramente ilustrativas,  
não acompanha o produto.  
Imágenes ilustrativas, no incluidas  
con el producto.  
Illustrative images, not included  
with the product.

**AVISO**

Para limpeza de seu móvel, use uma flanela seca ou umedecida, e não utilize produtos químicos que possam danificar seu produto.

**SISTEMA DE MONTAGEM**

O sistema de montagem dos produtos, funciona de acordo com a ordem crescente dos números indicados no desenho. Ex: 01, 02, 03, 04... até a conclusão da montagem.

**ASSISTÊNCIA TÉCNICA**

Para solicitação de Assistência Técnica você consumidor deverá entrar em contato com o Lojista o qual você realizou a compra deste produto e solicitar a assistência técnica das peças avariadas. A garantia abrange todas as peças, partes e componentes que eventualmente venham apresentar defeito de fabricação no prazo de 03 (três) meses, contando a partir da entrega do produto ao consumidor, mediante nota fiscal de compra. Se houver qualquer alteração na estrutura do produto ou ocorrer defeito por negligência do montador/consumidor em relação a instrução de montagem e manuseio, não será fornecido assistência técnica gratuita.

**ADVERTENCIA**

Para limpieza de su móvil, use una flanela seca o húmeda, y no utilice productos químicos que puedan dañar su producto.

**SISTEMA DE MONTAJE**

El sistema de montaje de los productos funciona de acuerdo con el orden creciente de los números indicados en el dibujo. Ej.: 01, 02, 03, 04... hasta la conclusión del montaje.

**ASISTENCIA TÉCNICA**

Para solicitar Asistencia Técnica, el consumidor debe comunicarse con el Comercio que usted realizó la compra de este producto y solicita asistencia técnica para las partes dañadas. La garantía cubre todas las partes, piezas y componentes que eventualmente puedan presentar defecto de fabricación en el plazo de 03 (tres) meses, contados a partir de la entrega del producto al consumidor, mediante factura de compra. Si se produce algún cambio en la estructura del producto o se produce un defecto por negligencia del montador/consumidor en relación con las instrucciones de montaje y manipulación, no se prestará asistencia técnica gratuita.

**NOTICE**

To clean your furniture, use a dry or wet cloth, and do not use chemicals that may damage your product.

**ASSEMBLY SYSTEM**

The products' assembly system works according to the increasing order of the indicated numbers. For example: 01, 02, 03, 04 ... to the end of the assembly.

**TECHNICAL ASSISTANCE**

To request Technical Assistance, the consumer must contact the retailer from whom you purchased this product and request technical assistance for the damaged parts. The warranty covers all parts, parts and components that may eventually present a manufacturing defect within a period of 03 (three) months, counting from the delivery of the product to the consumer, by means of a purchase invoice. If there is any change in the structure of the product or defect occurs due to negligence of the assembler/consumer in relation to the assembly and handling instruction, free technical assistance will not be provided.

ACESSÓRIOS | ACCESORIOS | ACCESSORIES

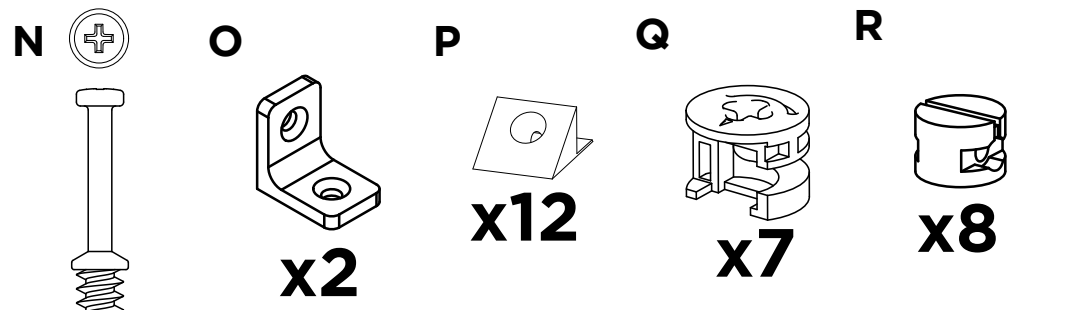
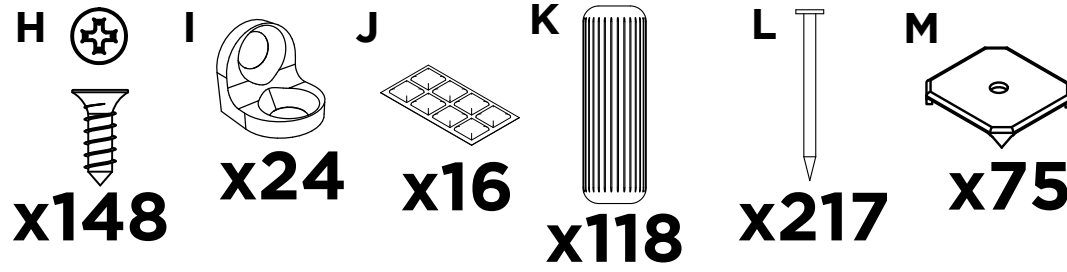
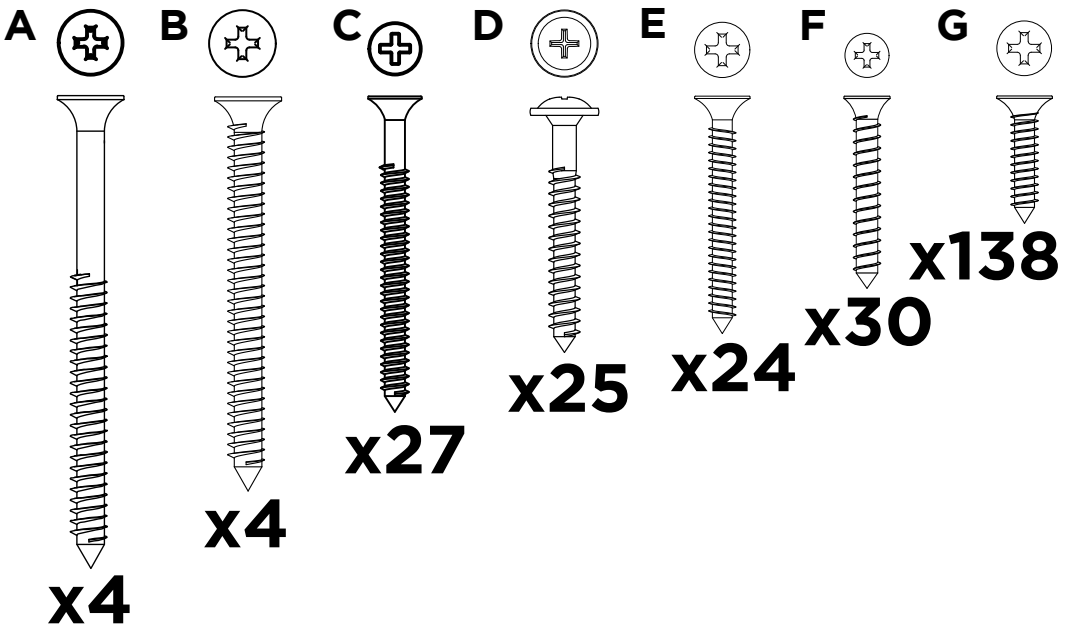

Parafusos em escala  
Tornillos escalados  
Scaled screws **1:1**

PASSO 21

ACESSÓRIOS REQUERIDOS

AC		02
AD		07
AF		50
AG	<b>HENN</b>	01

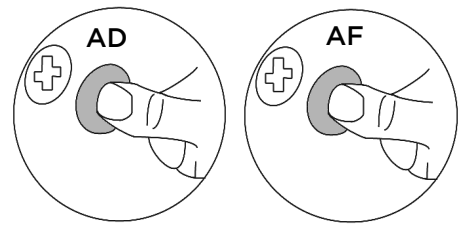
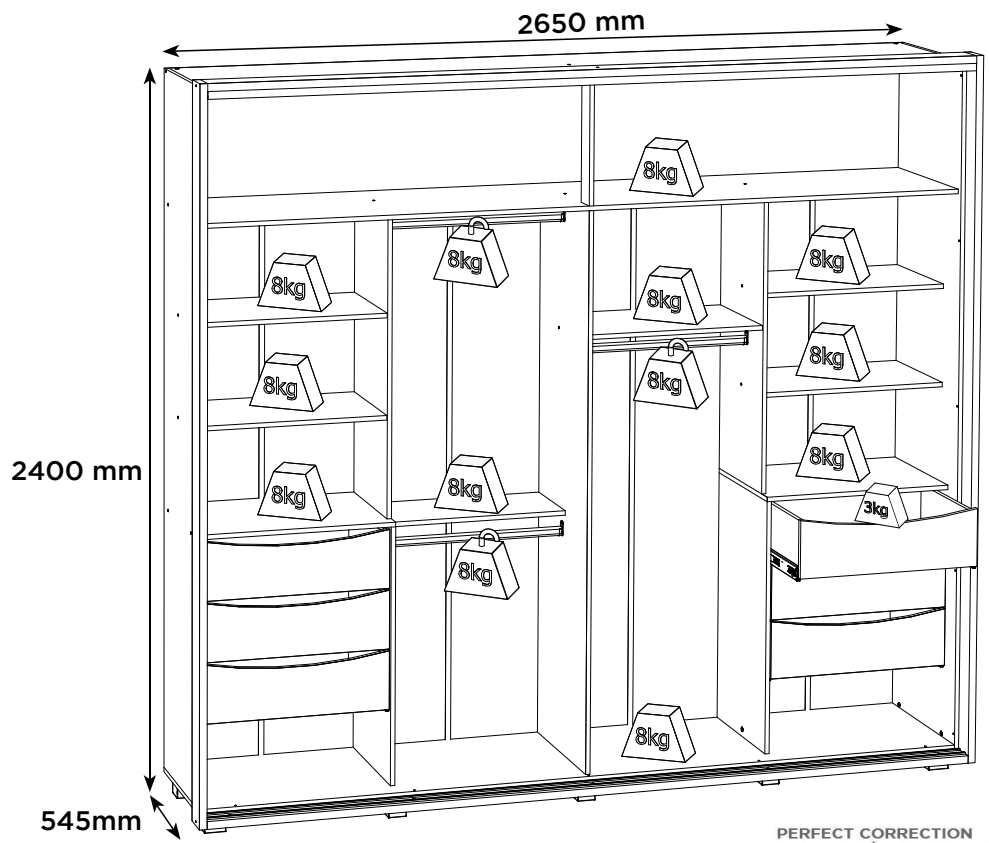

PERFECT CORRECTION  
CORRECCIÓN PERFECTA

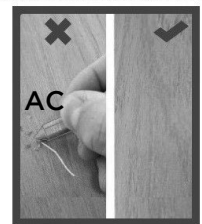

Pesos máximos recomendados com carga distribuída  
Peso máximo recomendado con la carga distribuida  
Recommended maximum weight with distributed load.

# PASSO 20

ITM/D313-

## PEÇAS REQUERIDAS

32	FRENTE DE GAVETA	x6
----	------------------	----

## ACESSÓRIOS REQUERIDOS

G		12
H		84
I		24
P		12
W		06
AB		

## FERRAMENTAS NECESSÁRIAS

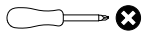

6x  
3º

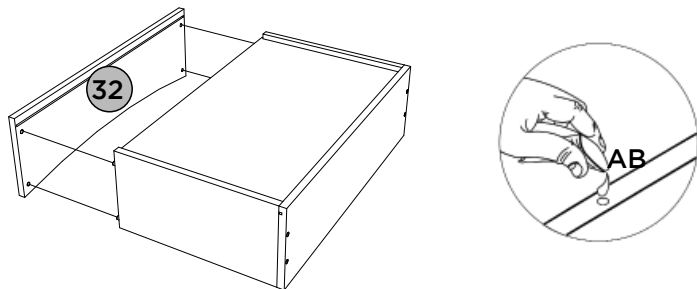

6x  
4º

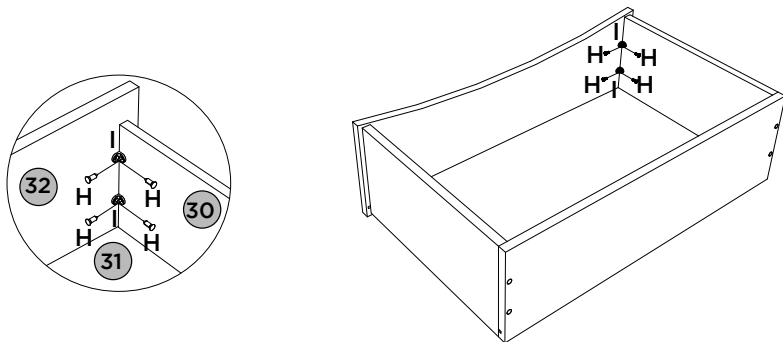

6x  
5º

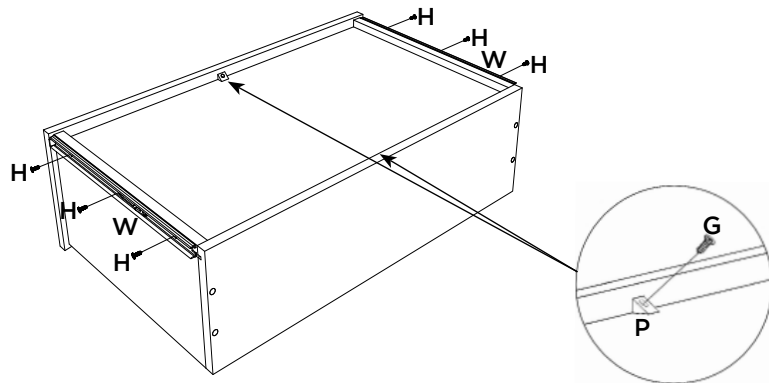

# ACESSÓRIOS | ACCESORIOS | ACCESSORIES

ITM/D313-

S

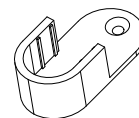

x6

T

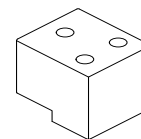

x10

U

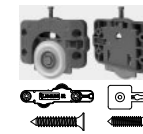

x1 KIT

V



x4

W



x6 PAR

X



x3

Y



x4

Z



x1

AA



x1

AB

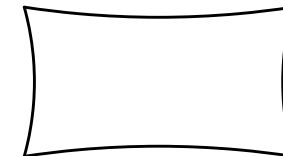

x3

AC



x2

AD

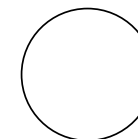

x7

AE

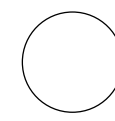

x20

AF

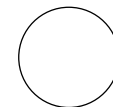

x50

AG



HENN

x1

# LISTA DE PEÇAS | LISTA DE PIEZAS | LIST OF PIECES



Item	Caixa Caja Box	Qty Ctd Qty	Descrição Descripción Description	Dimensões (mm)   Dimensiones (mm)   Dimensions (mm)		
				Comprimento Largo Length	Largura Ancho Width	Espesura Grosor Thickness
1	2/5	01	BASE   BASE   BASE	2573	470	15
2	3/5	02	TRAVESSA LATERAL BASE   CARRIL LATERAL BASE   BASE SIDE CROSSBAR	450	90	15
3	3/5	03	TRAVESSA CENTRAL BASE   CARRIL CENTRAL BASE   CENTRAL BASE RAIL	450	70	15
4	2/5	01	TRAVESSA FRONTAL BASE   CARRIL DELANTERA DE LA BASE   BASE FRONT CROSSBAR	2603	90	25
5	1/5	02	TAMPO DAS GAVETAS   TAPA DE LOS CAJONES   DRAWER TOP	647	400	15
6	1/5	01	DIVISÃO ESQUERDA MENOR   DIVISIÓN IZQUIERDA MENOR   MINOR LEFT DIVISION	985	355	15
7	1/5	01	DIVISÃO DIREITA MENOR   DIVISION DE DERECHO MENOR   MINOR RIGHT DIVISION	985	355	15
8	3/5	01	LATERAL ESQUERDA   LATERAL IZQUIERDA   LEFT SIDE	2300	470	15
9	4/5	01	DIVISÃO GAVETA ESQUERDA   DIVISIÓN DEL CAJÓN IZQUIERDO   LEFT DRAWER DIVISION	841	400	15
10=14=16	4/5	02	PRATELEIRA   ESTANTE   SHELF	632	350	15
11	4/5	01	DIVISÃO CENTRAL   DIVISIÓN CENTRAL   CENTRAL DIVISION	1841	450	15
12	4/5	01	PRATELEIRA DO CALCEIRO   ESTANTE DE CALCEIRO   CALCEIRO'S SHELF	632	250	15
13	4/5	01	DIVISÃO GAVETA DIREITA   DIVISIÓN DEL CAJÓN DERECHO   RIGHT DRAWER DIVISION	841	400	15
14=10=16	4/5	01	PRATELEIRA   ESTANTE   SHELF	632	350	15
15	3/5	01	LATERAL DIREITA   LATERAL DERECHA   RIGHT SIDE	2300	470	15
16=10=14	4/5	02	PRATELEIRA   ESTANTE   SHELF	632	350	15
17	3/5	01	CHÃO DO MALEIRO   PISO DEL PORTA EQUIPAJES   FLOOR OF THE CLOSET TOP SHELF	2573	450	15
18	3/5	01	RIPA DO MALEIRO   LISTÓN DAL AMRMARIO DE EQUIPAJE   CLAP-BOAR LUGGAGE	414	73	15
19	2/5	01	TAMPO SUPERIOR   TAPA SUPERIOR   TOP PANEL	2573	470	15
20	2/5	01	FUNDO SUPERIOR   FONDO SUPERIOR   SUPERIOR BACKGROUND	2579	436	3
21	3/5 e 4/5	08	FUNDO   FONDO   BOTTOM	1863	321	3
22	2/5	02	MOLDURA LATERAL   MARCO LATERAL   SIDE FRAME	2350	90	25
23	2/5	02	MOLDURA SUPERIOR   MARCO SUPERIOR   UPPER FRAME	2603	90	25
24	5/5	02	PAINEL MENOR   PANEL PEQUENO   SMALL PANEL	2268	170	12
25	5/5	02	PAINEL COM APLIQUE   PANEL CON ALIQUE   PANEL WITH AP-PLIQUE	2268	490	9
26	2/5	08	MOLDURA 1780MM   MARCO 1780MM   FRAME 1780MM	1780	15	9
27	2/5	06	MOLDURA 680MM   MARCO 680MM   FRAME 680MM	680	15	9
28	5/5	02	PAINEL MAIOR   PANEL MÁS GRANDE   BIGGER PANEL	2268	780	12
29	4/5	06	RIPA DE TRÁS   MALLA DETRÁS   REAR LATH	607	180	15
30	1/5	12	LADO DE GAVETA   LADO DEL CAJÓN   SIDE OF DRAWER	350	180	15
31	4/5	06	FUNDO DE GAVETA RECORTADO   FONDO DEL CAJÓN RECORTADO   CROPPED DRAWER BOTTOM	588	361	3
32	3/5	06	FRENTE DE GAVETA   FRENTE DE CAJÓN   FRONT OF DRAWER	624	192	15

## PASSO 18

### PEÇAS REQUERIDAS

30	LADO DE GAVETA	x12
----	----------------	-----

### ACESSÓRIOS REQUERIDOS

K		48
AB		

### FERRAMENTAS NECESSÁRIAS

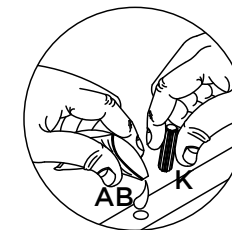
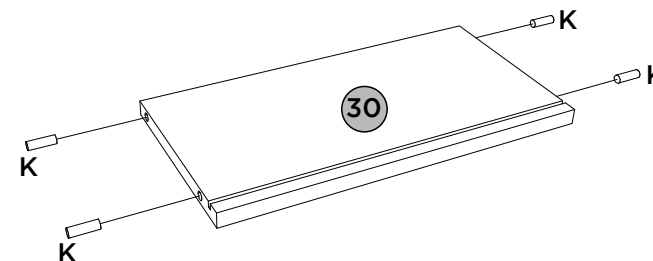



## PASSO 19

### PEÇAS REQUERIDAS

29	RIPA DE TRÁS	x6
30	LADO DE GAVETA	x12
31	FUNDO DE GAVETA RECORTADO	x6

### ACESSÓRIOS REQUERIDOS

E		24
AB		

### FERRAMENTAS NECESSÁRIAS

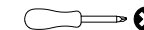

6x

1º

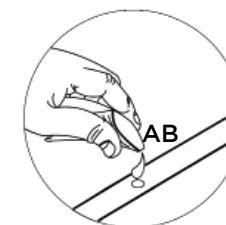
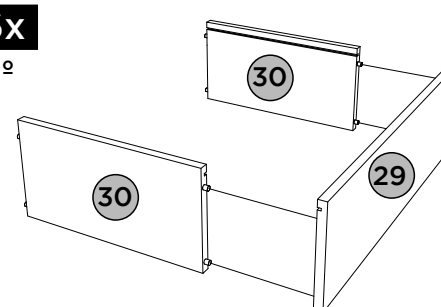

6x

2º

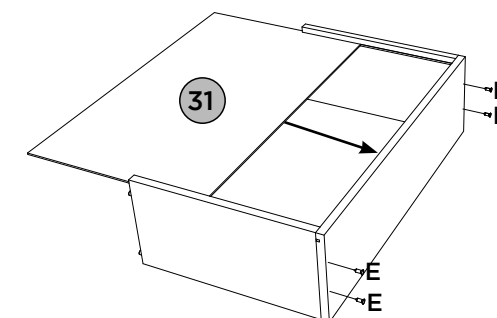

# PASSO 16

ITM/D313-

## PEÇAS REQUERIDAS

## ACESSÓRIOS REQUERIDOS

## FERRAMENTAS NECESSÁRIAS

26	MOLDURA 1780MM	x8
27	MOLDURA 680MM	x6

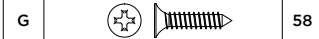

2x

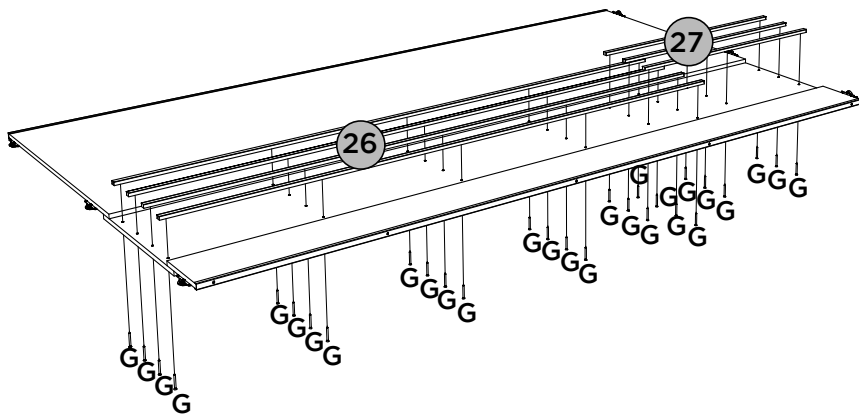

# PASSO 17

## PEÇAS REQUERIDAS

## ACESSÓRIOS REQUERIDOS

24	PAINEL MENOR	x2
25	PAINEL COM APLIQUE	x2
28	PAINEL MAIOR	x2

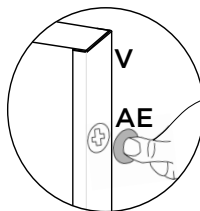
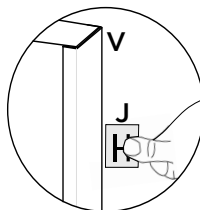
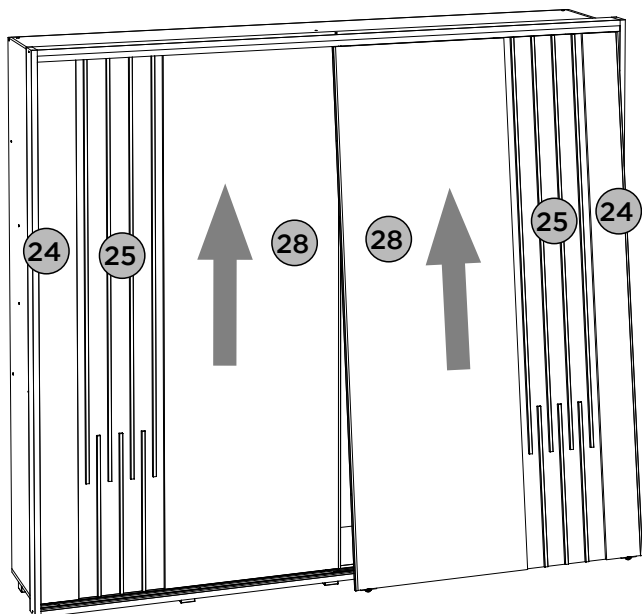
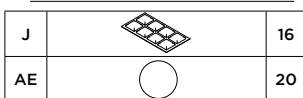

Para a colocação das portas nos trilhos encaixe primeira a porta no trilho superior (AA) e em seguida no trilho de alumínio inferior (Z).

Para la colocación de las puertas en la pista instalación de la puerta en la primera banda superior (AA) y luego el riel de aluminio inferior (Z).

For placing the doors on the rails fitting the door on the rail first (AA) and then on the lower aluminum rail (Z).

# LISTA DE PEÇAS | LISTA DE PIEZAS | LIST OF PIECES

ITM/D313-

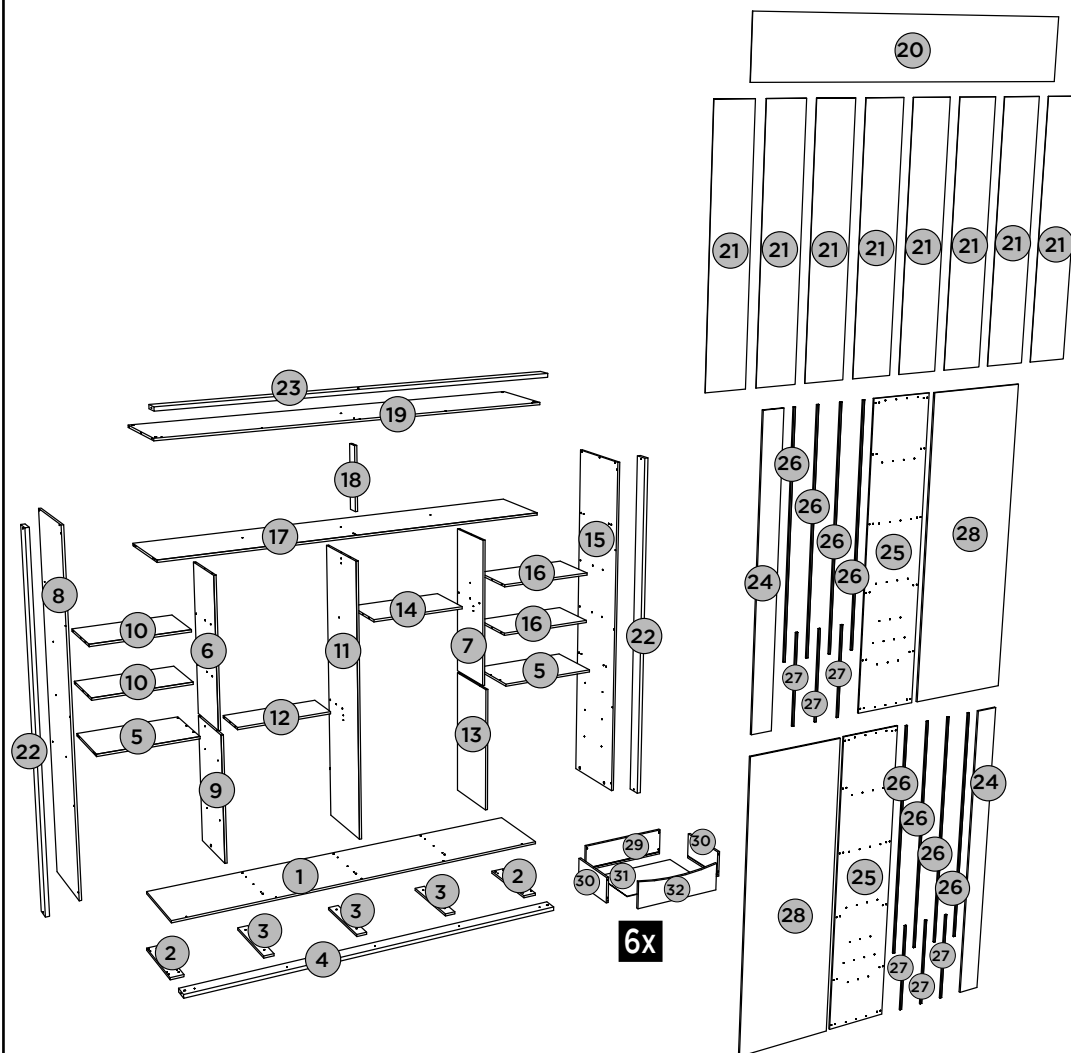



# PASSO 1

ITM/D313-

## PEÇAS REQUERIDAS

1	BASE	x1
2	TRAVESSA LATERAL BASE	x2
4	TRAVESSA FRONTAL BASE	x1
17	CHÃO DO MALEIRO	x1
18	RIPA DO MALEIRO	x1
19	TAMPO SUPERIOR	x1
23	MOLDURA SUPERIOR	x1

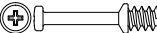
## ACESSÓRIOS REQUERIDOS

K		08
N		07
R		08

## FERRAMENTAS NECESSÁRIAS

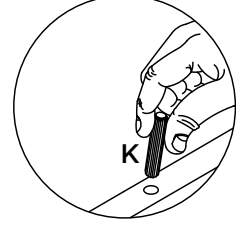
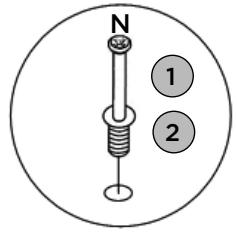
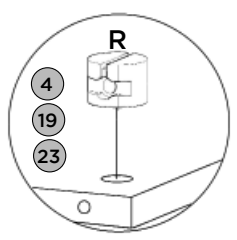
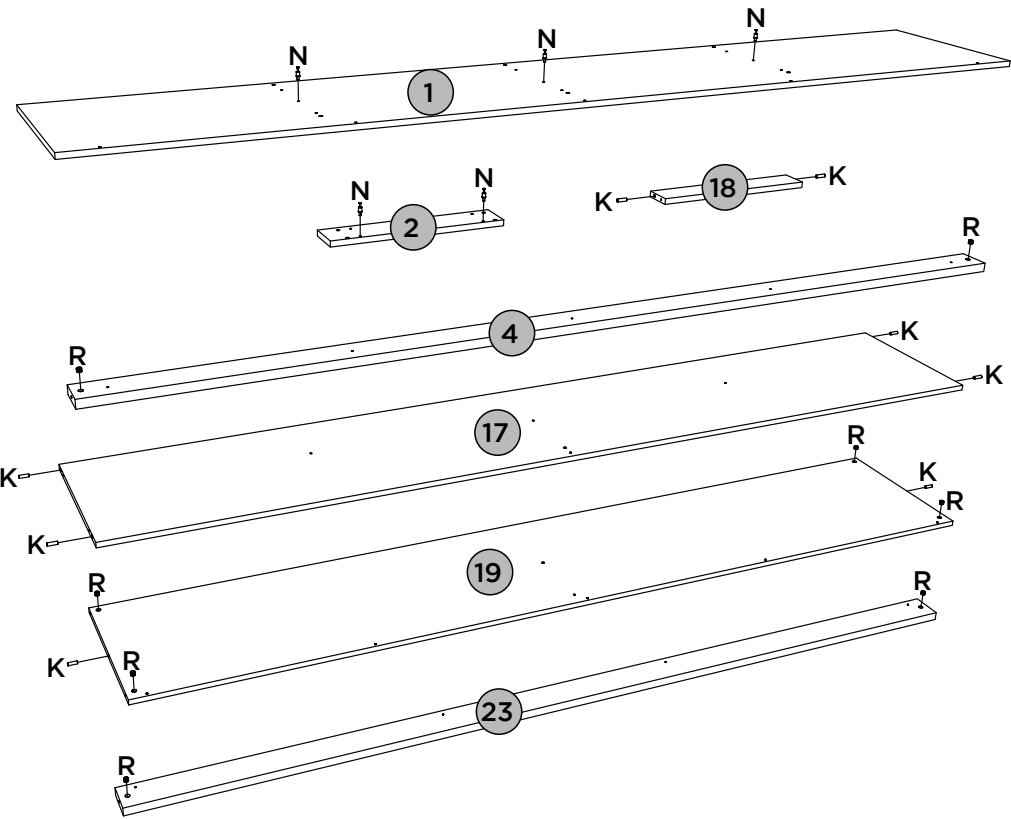
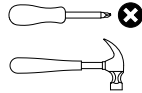



# PASSO 15

ITM/D313-

## PEÇAS REQUERIDAS

24	PAINEL MENOR	x2
25	PAINEL COM APLIQUE	x2
28	PAINEL MAIOR	x2

## ACESSÓRIOS REQUERIDOS

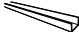
G		68
U		01
V		04

## FERRAMENTAS NECESSÁRIAS

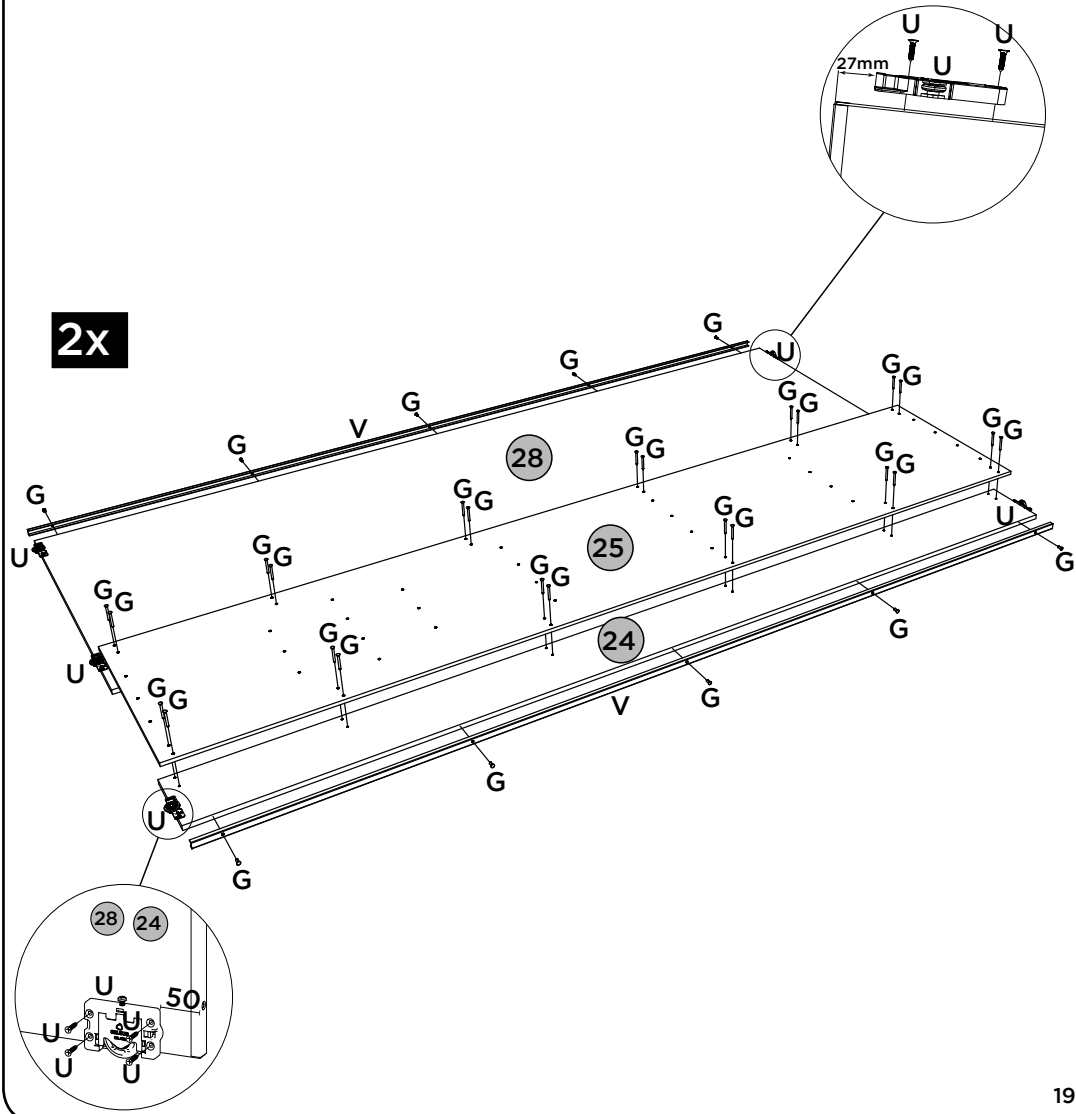
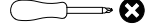

# PASSO 14

ITM/D313-

## PEÇAS REQUERIDAS

22	MOLDURA LATERAL	x2
23	MOLDURA SUPERIOR	x1

## ACESSÓRIOS REQUERIDOS

A		04
F		15
H		12
X		03
Z		01
AA		01

## FERRAMENTAS NECESSÁRIAS

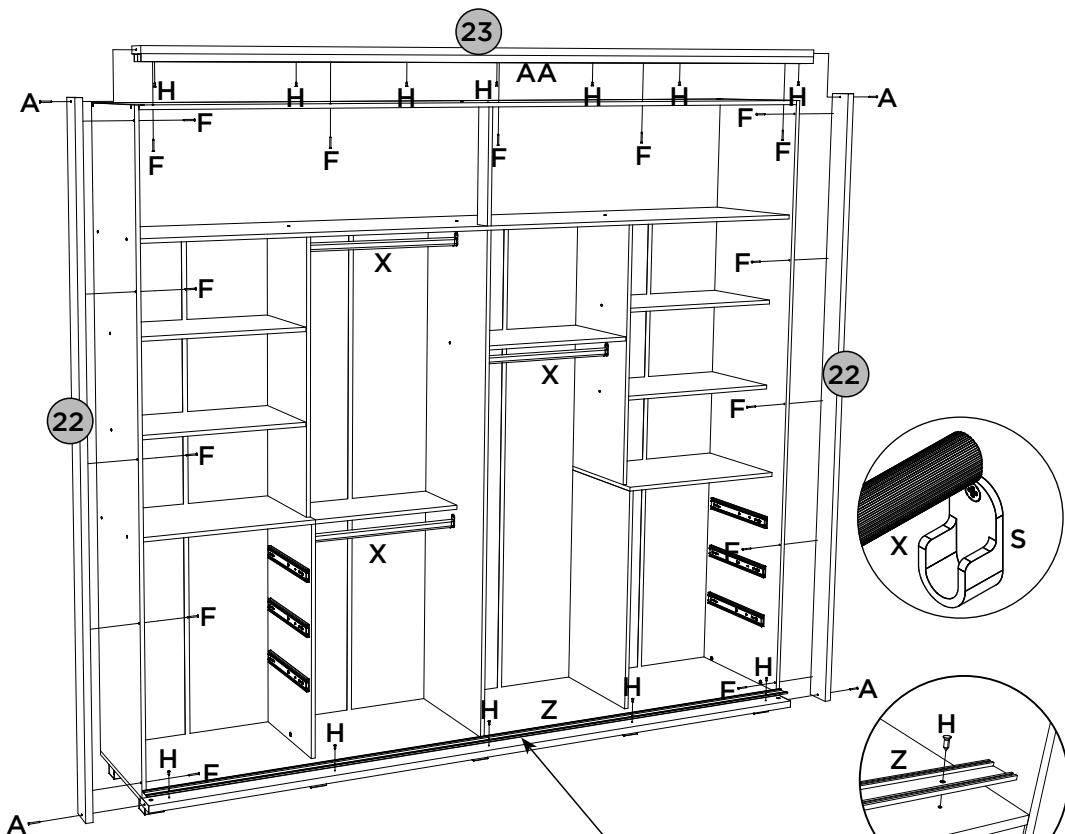
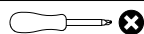

- Trilho Inferior (Z) deverá ficar sobre a peça (04) e encostado na Base (01)
- El Riel Inferior (Z) debe estar en la parte (04) y apoyado contra la Base (01)
- Lower Rail (Z) should be on the part (04) and leaning against the Base (01)

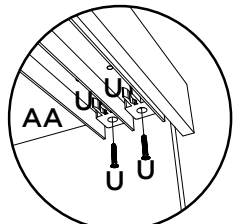
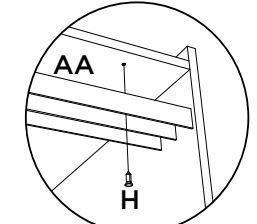

# PASSO 2

ITM/D313-

## PEÇAS REQUERIDAS

5	TAMPO DAS GAVETAS	x2
6	DIVISÃO ESQUERDA MENOR	x1
8	LATERAL ESQUERDA	x1
9	DIVISÃO GAVETA ESQUERDA	x1

## ACESSÓRIOS REQUERIDOS

H		22
K		14
S		02
W		06

## FERRAMENTAS NECESSÁRIAS

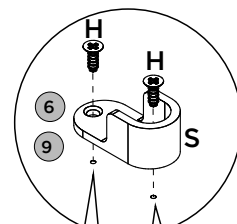
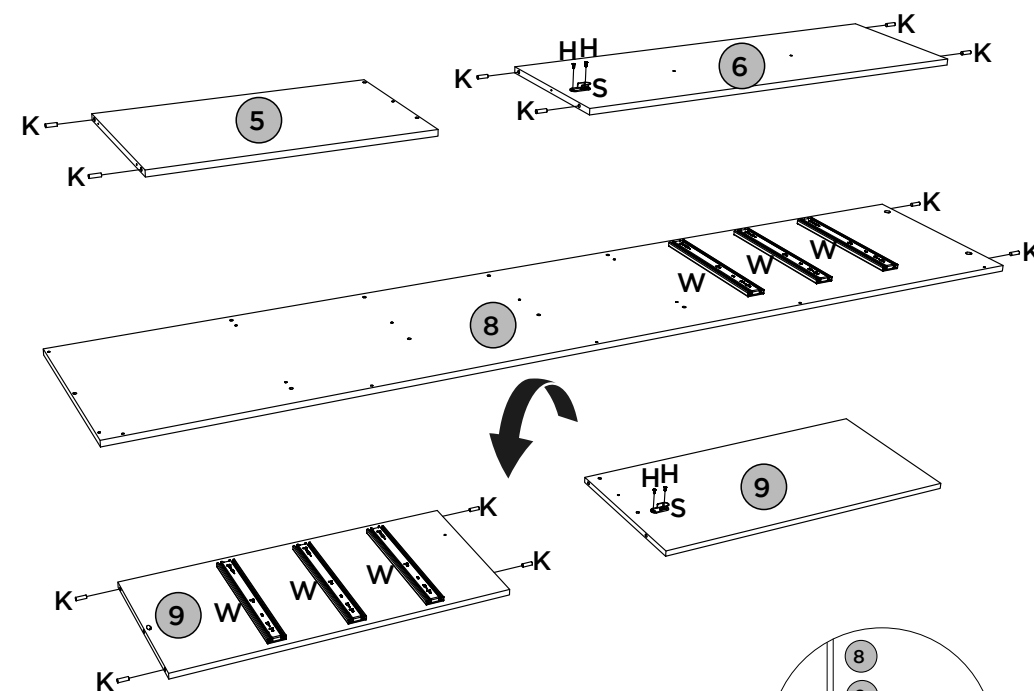
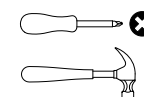

Observe:  
Furos  
pré-marcados

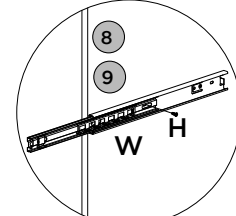
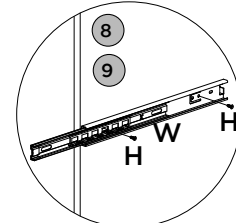
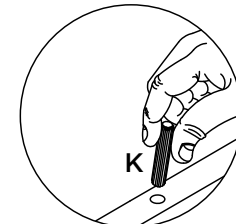



### PASSO 3

ITM/D313-

#### PEÇAS REQUERIDAS

10=14=16	PRATELEIRA	x5
11	DIVISÃO CENTRAL	x1
12	PRATELEIRA DO CALCEIRO	x1

#### ACESSÓRIOS REQUERIDOS

H		06
K		28
S		03

#### FERRAMENTAS NECESSÁRIAS

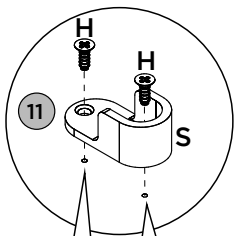
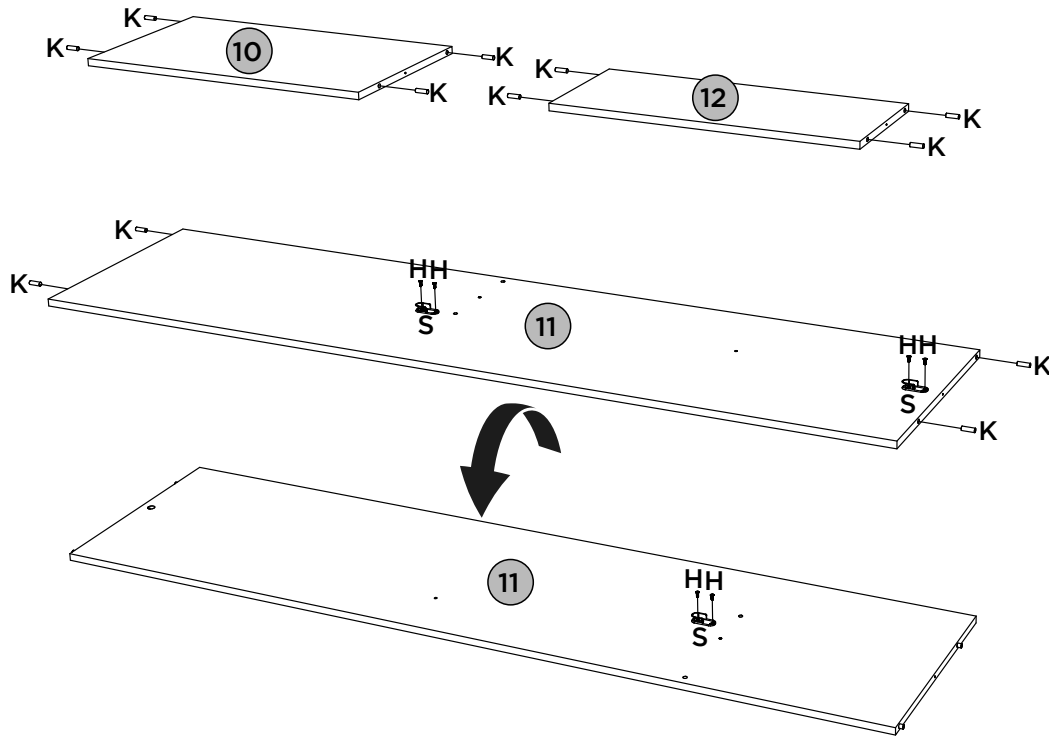
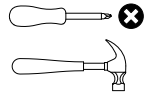

Observe:  
Furos  
pré-marcados

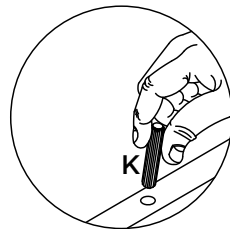



### PASSO 13

ITM/D313-

#### PEÇAS REQUERIDAS

20	FUNDO SUPERIOR	x1
21	FUNDO	x8

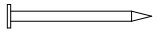
#### ACESSÓRIOS REQUERIDOS

L		217
M		75
Y		04

#### FERRAMENTAS NECESSÁRIAS

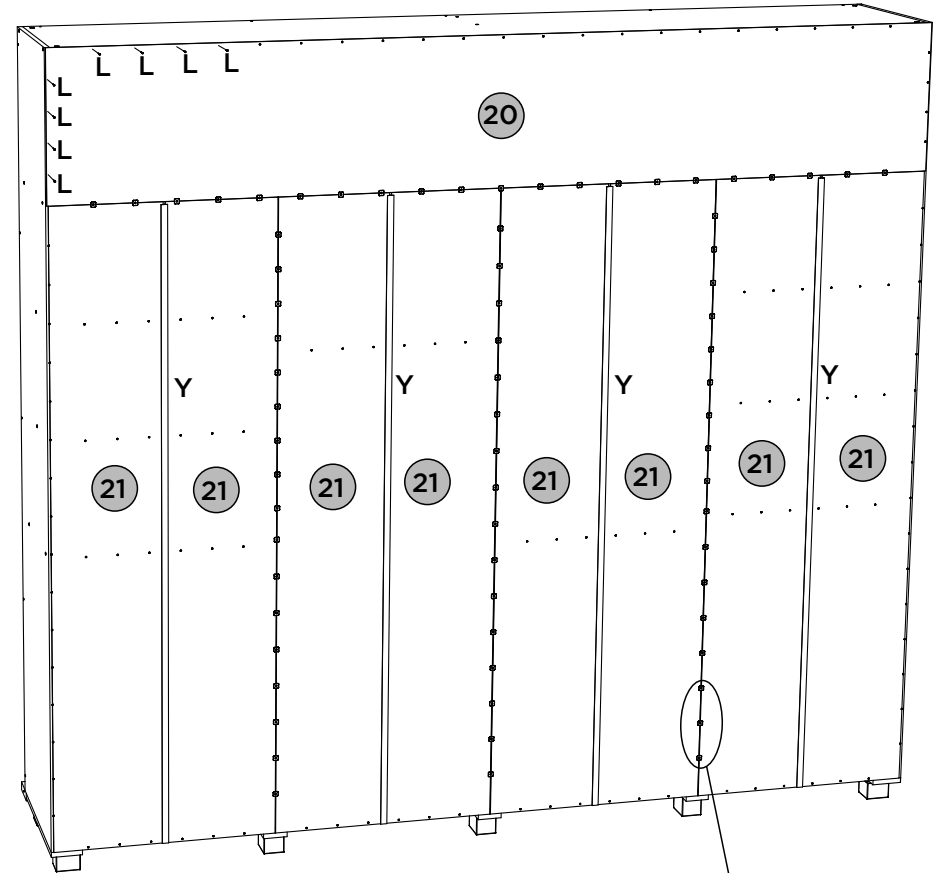
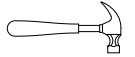

Fixar os pregos a uma distância de 100mm de um para outro.

Fijar las uñas a un distancia de 100mm uno a otro.

Fix the nails at a distance of 100mm from one to the other

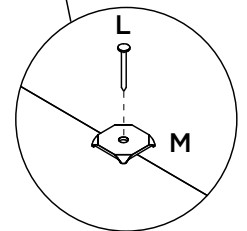



# PASSO 12

ITM/D313-

## PEÇAS REQUERIDAS

15	LATERAL DIREITA	x1
16	PRATELEIRA	x2
17	CHÃO DO MALEIRO	x1
18	RIPA DO MALEIRO	x1
19	TAMPO SUPERIOR	x1

## ACESSÓRIOS REQUERIDOS

B		04
C		15
Q		02

## FERRAMENTAS NECESSÁRIAS

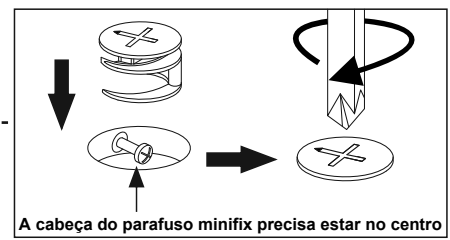
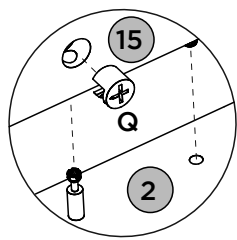
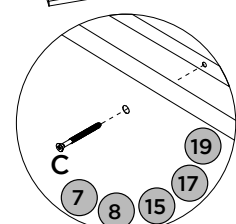
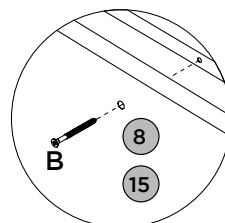
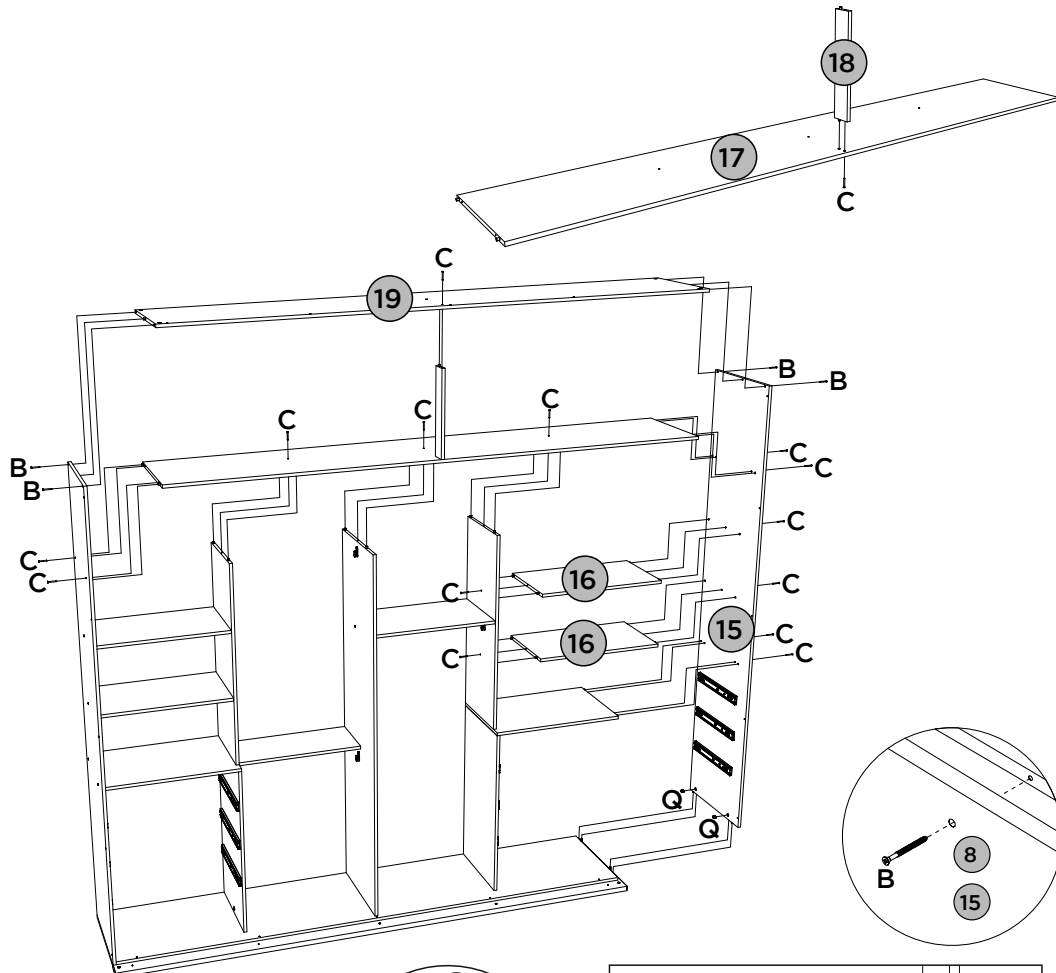
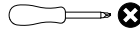

# PASSO 4

ITM/D313-

## PEÇAS REQUERIDAS

7	DIVISÃO DIREITA MENOR	x1
13	DIVISÃO GAVETA DIREITA	x1
15	LATERAL DIREITA	x1

## ACESSÓRIOS REQUERIDOS

H		20
K		10
S		01
W		06

## FERRAMENTAS NECESSÁRIAS

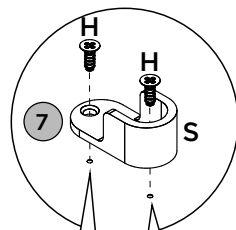
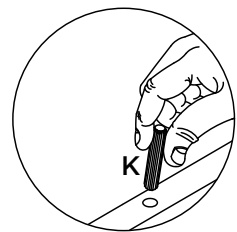
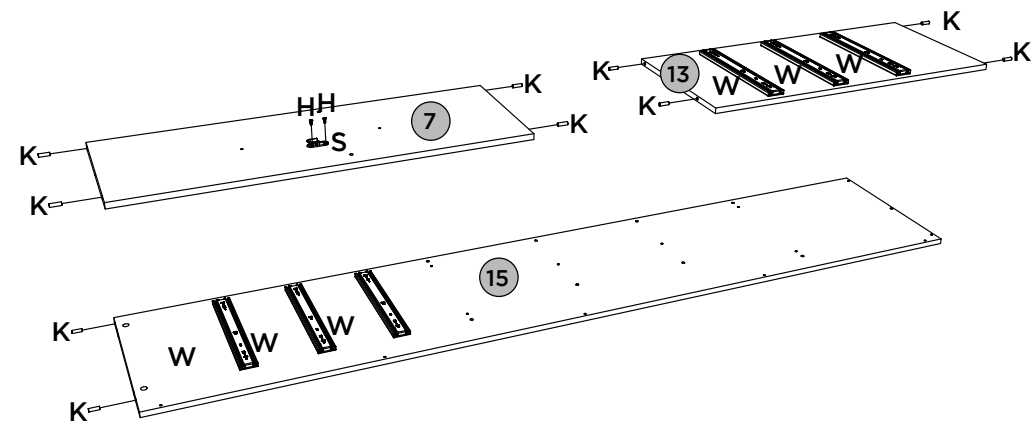
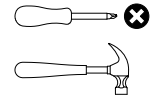

Observe:  
Furos  
pré-marcados

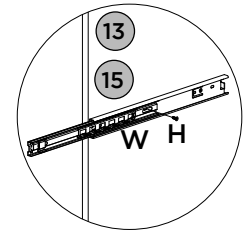
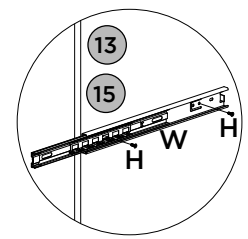



## PASSO 5

ITM/D313-

### PEÇAS REQUERIDAS

1	BASE	x1
2	TRAVESSA LATERAL BASE	x2
3	TRAVESSA CENTRAL BASE	x3

### ACESSÓRIOS REQUERIDOS

F		10
K		10

### FERRAMENTAS NECESSÁRIAS

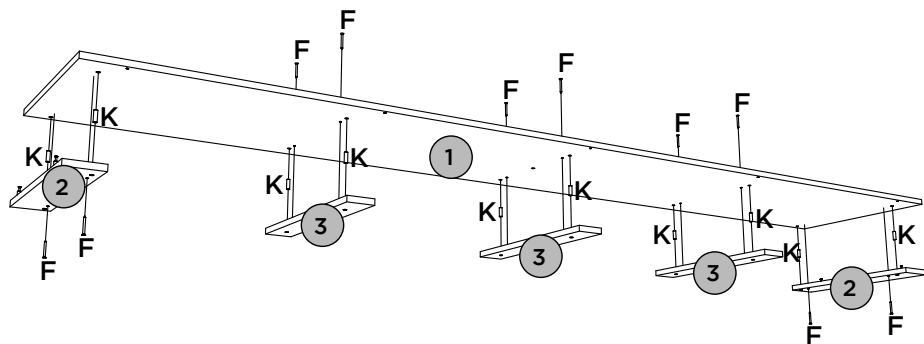
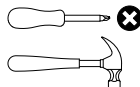

## PASSO 6

### PEÇAS REQUERIDAS

4	TRAVESSA FRONTAL BASE	x1
---	-----------------------	----

### ACESSÓRIOS REQUERIDOS

F		05
---	---	----

### FERRAMENTAS NECESSÁRIAS

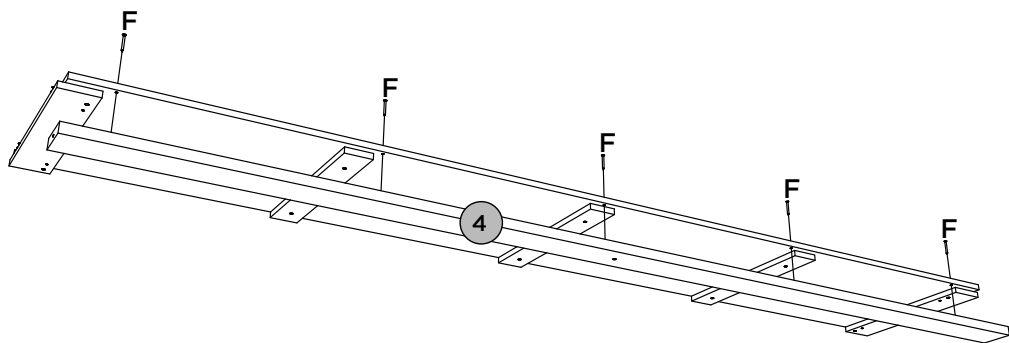
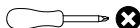



## PASSO 11

ITM/D313-

### PEÇAS REQUERIDAS

13	DIVISÃO GAVETA DIREITA	x1
14	PRATELEIRA	x1

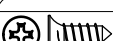
### ACESSÓRIOS REQUERIDOS

C		02
H		02
O		01
Q		01

### FERRAMENTAS NECESSÁRIAS

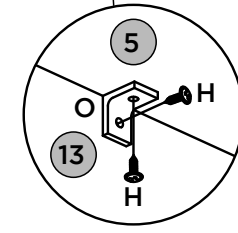
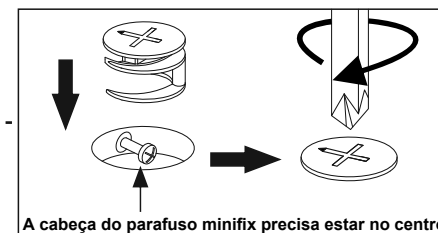
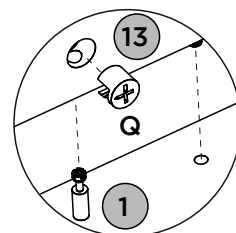
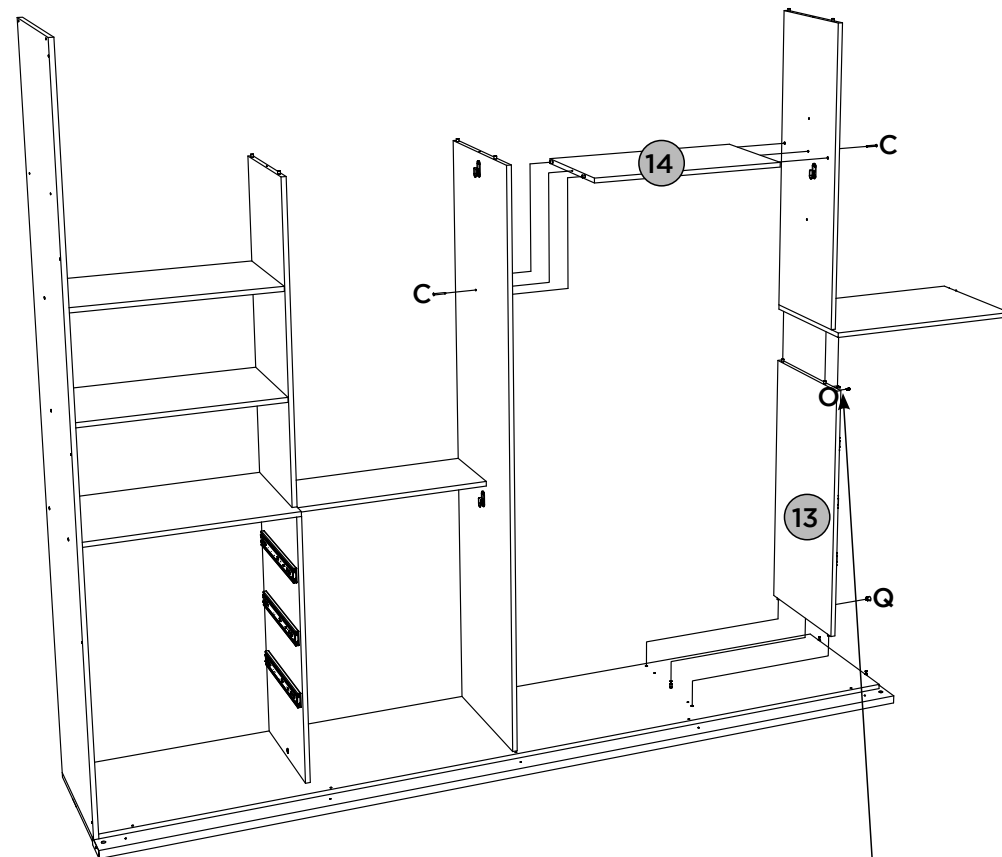
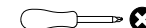



# PASSO 10

ITM/D313-

## PEÇAS REQUERIDAS

11	DIVISÃO CENTRAL	x1
12	PRATELEIRA DO CALCEIRO	x1

## ACESSÓRIOS REQUERIDOS

C		02
Q		01

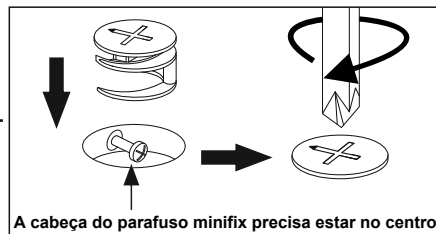
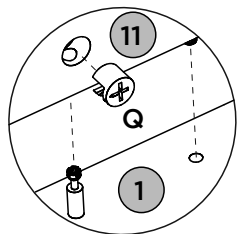
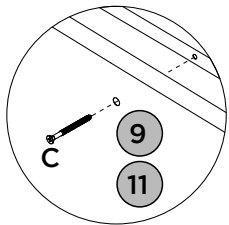
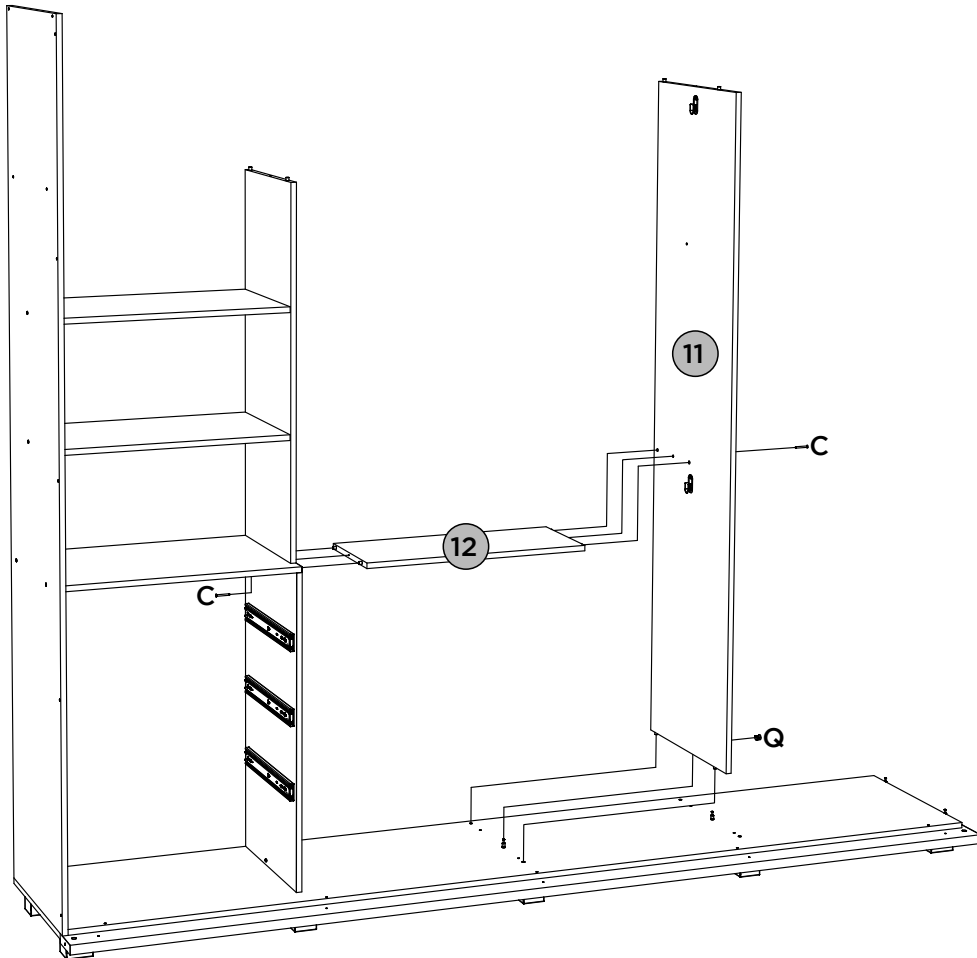
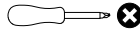

## FERRAMENTAS NECESSÁRIAS



# PASSO 7

ITM/D313-

## ACESSÓRIOS REQUERIDOS

D		25
T		10

## FERRAMENTAS NECESSÁRIAS

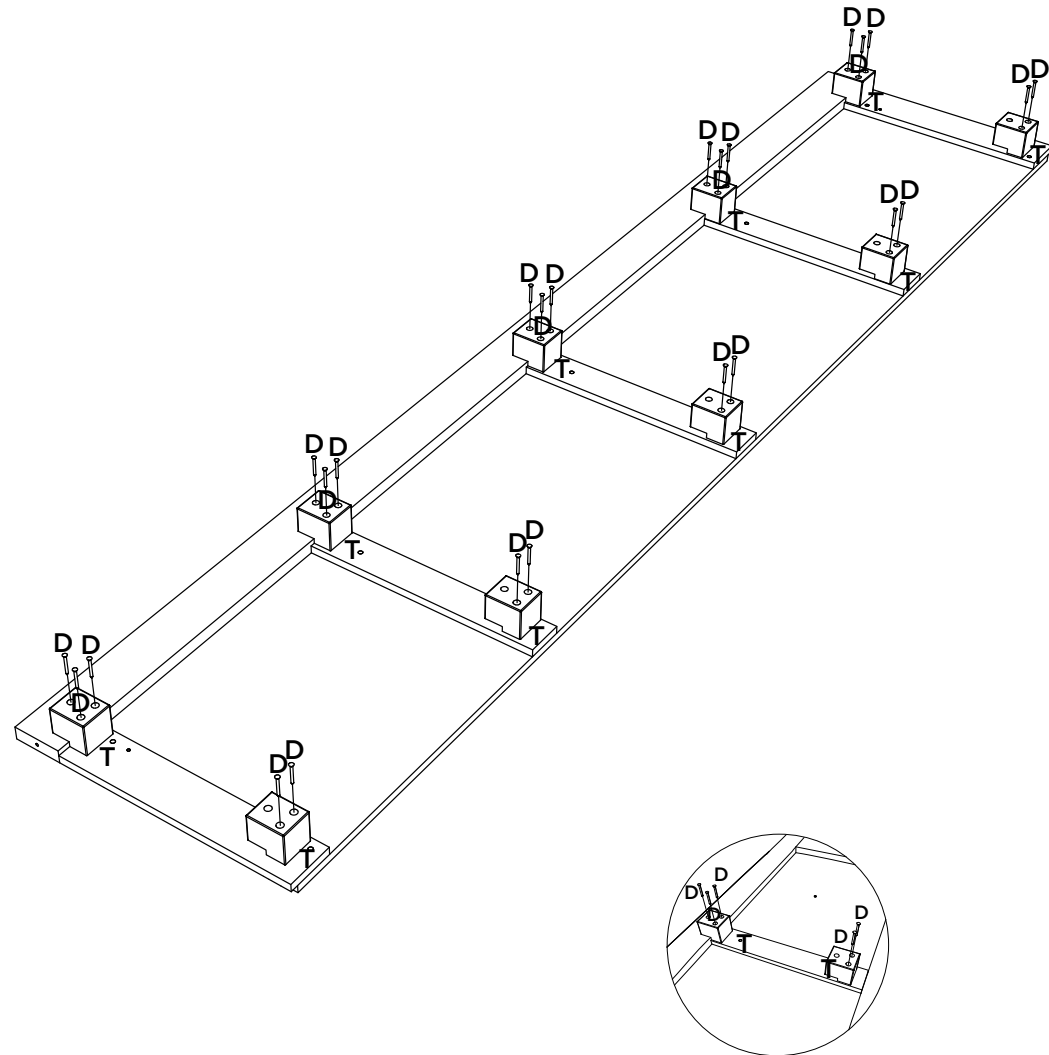
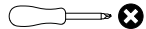

# PASSO 8

ITM/D313-

## PEÇAS REQUERIDAS

## ACESSÓRIOS REQUERIDOS

## FERRAMENTAS NECESSÁRIAS

5	TAMPO DAS GAVETAS	x2
6	DIVISÃO ESQUERDA MENOR	x1
7	DIVISÃO DIREITA MENOR	x1

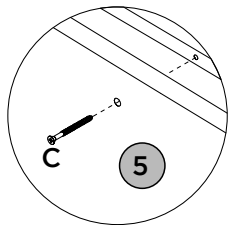
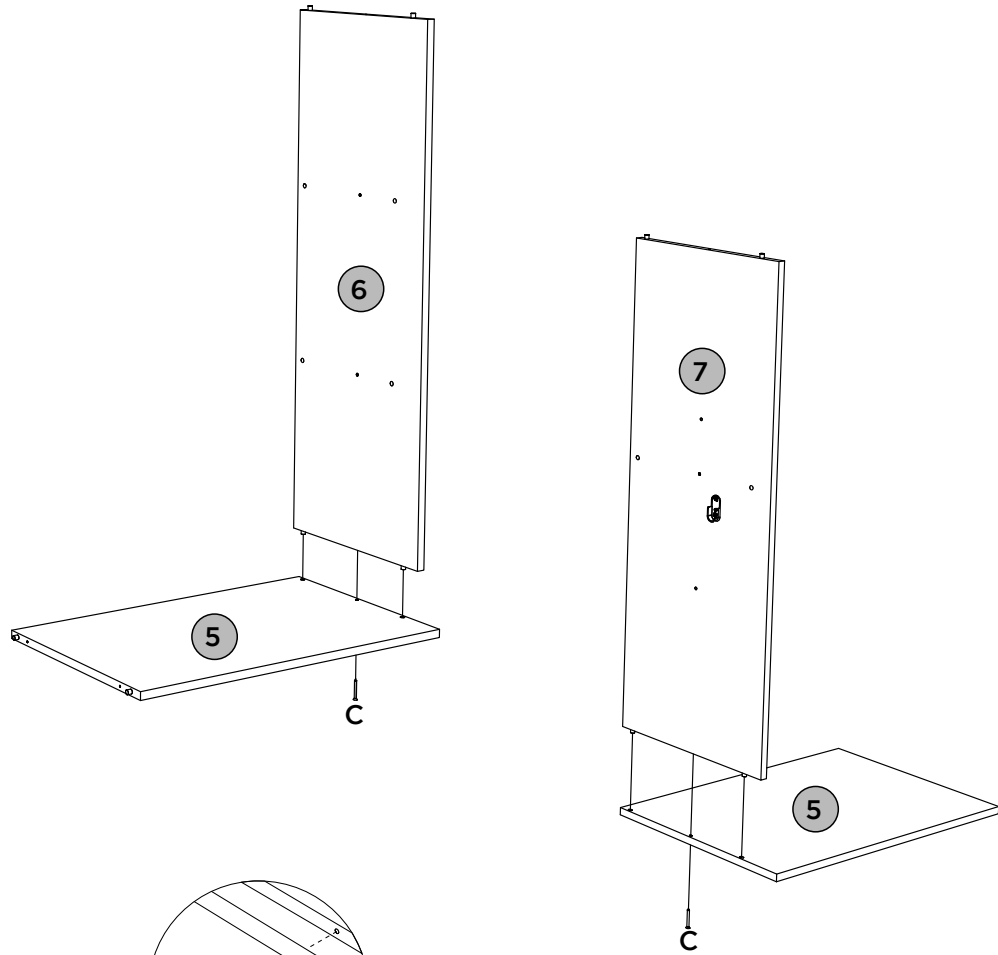
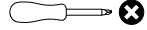
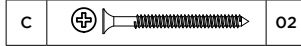

# PASSO 9

ITM/D313-

## PEÇAS REQUERIDAS

## ACESSÓRIOS REQUERIDOS

## FERRAMENTAS NECESSÁRIAS

8	LATERAL ESQUERDA	x1
9	DIVISÃO GAVETA ESQUERDA	x1
10	PRATELEIRA	x2

C	[Screw]	06
H	[Screw]	02
O	[Bracket]	01
Q	[Bracket]	03

