

Item	Caixa Caja Box	Qtd Ctd Qty	Descrição   Descripción   Description	Medidas (mm)   Dimensiones (mm)   Size (measurements) (mm)
01	2/3	01	Rodapé Frontal   Pie de página   Front Footer	1897x120x12
02	2/3	01	Travessa do Rodapé   Carril pie   Baseboard crosspiece	415x120x12
03	2/3	01	Rodapé Traseiro   pie de página trasera   Rear Footer	1897x120x12
04	1/3	01	Lateral esquerda   Lateral izquierda   Left side	2150x445x15
05=10	1/3	01	Base   Base   Base	477x445x12
06	1/3	01	Divisão esquerda   División izquierda   Left Division	1529x445x12
07=18	2/3	01	Prateleira   Estantería   Shelf	465x350x12
08	2/3	01	Divisão das Gavetas   División de los cajones   Drawers Division	445x407x12
09	1/3	02	Travessa Frontal   Travessa Frontal   Front cross member	465x60x12
10=05	1/3	01	Base   Base   Base	477x445x12
11	1/3	01	Divisão direita   División derecha   Right Division	1529x445x12
12	1/3	01	Pilastra da Porta   Pilas de la Puerta   Door Pilaster	1122x80x12
13	1/3	01	Tampa da Cômoda   Cubierta de la Cômoda   Chest of Drawers	943x445x12
14	1/3	02	Prateleira Maior   Estantería Mayor   Largest Shelf	943x365x12
15	1/3	03	Ripa do Maleiro   Portaequipajes de ripa   Lath of the closet top shelf	414x73x12
16	2/3	01	Chão do Maleiro   Piso del portaequipajes   Floor of the closet top shelf	1897x445x12
17	1/3	01	Lateral direita   Lateral derecha   Right side	2150x445x15
18=07	2/3	01	Prateleira   Estantería   Shelf	465x350x12
19	2/3	01	Tampo   Tapa   Top	1897x445x12
20	3/3	01	Fundo Superior   Fondo superior   Top bottom	1921x430x3
21	3/3	04	Fundo   Fondo   Bottom	1546x478x3
22	3/3	01	Chapéu   Sombrero   Hat	1925x55x15
23	3/3	01	Porta Central Espelho   Puerta Central Espejo   Central Mirror Door	1556x315x15
24	3/3	01	Espelho com furo   Espejo con orificio   Mirror with hole	950x250x3
25	2/3	02	Porta Central   Puerta central   Central Door	1556x315x15
26	3/3	02	Porta   Puerta   Door	1963x474x15
27	1/3	04	Frente de gaveta   Frente de cajón   Front of drawer	473x170x15
28	1/3 e 3/3	08	Lado de gaveta   Lado del cajón   Side of drawer	350x110x12
29	1/3	04	Fundo de gaveta   Fondo de cajón   Drawer bottom	427x361x3
30	2/3	04	Ripa de trás   Malla detrás   Rear lath	440x110x12

**HENN**

Ind. e Com. de Móveis Henn  
Mondai - SC - Brasil

+55 49 3674.3500

@moveishenn  
www.henn.com.br

**INSTRUÇÕES DE MONTAGEM**

INSTRUCCIONES DE MONTAJE  
ASSEMBLY INSTRUCTIONS

**ROUPEIRO ALBA 05 PORTAS**  
**ARMARIO ALBA 05 PUERTAS | ALBA 05 WARDROBE DOORS**  
D198-127 Nature/Off White | D198-130 Castanho HP

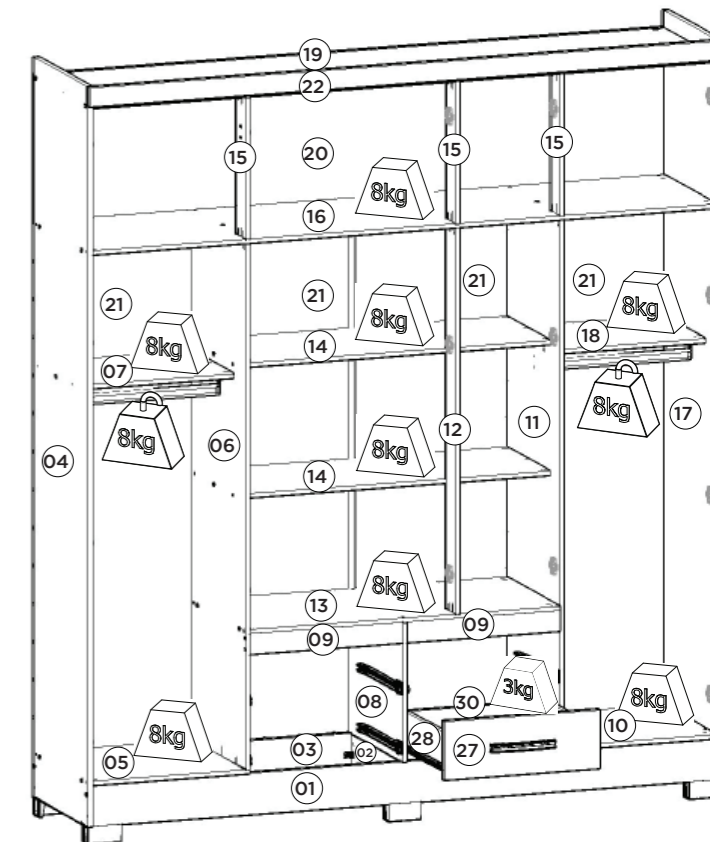
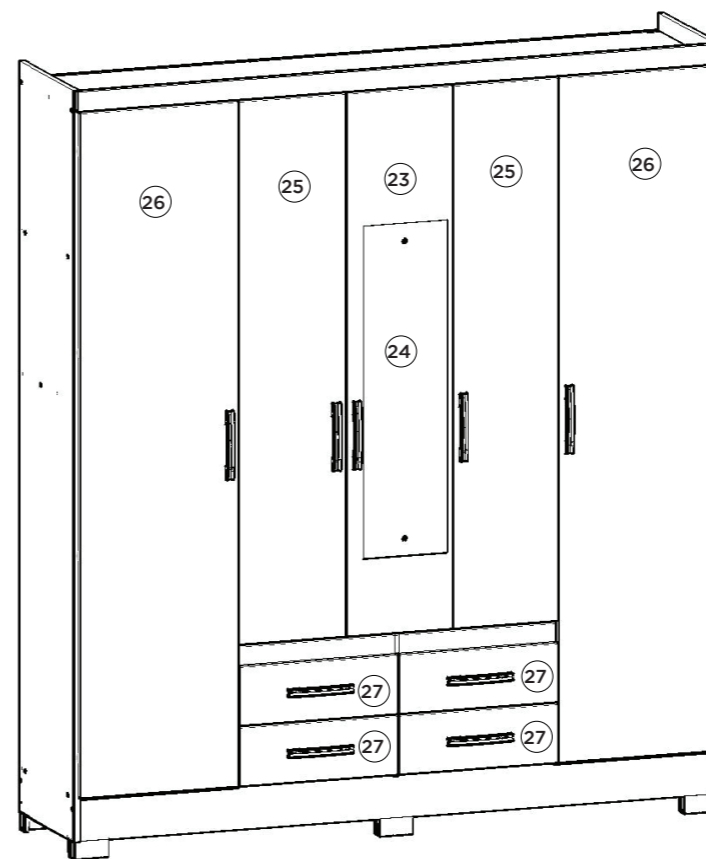

Pesos máximos recomendados com carga distribuída  
Peso máximo recomendado con la carga distribuida  
Recommended maximum weights with evenly distributed.

Requisitos para montagem  
Requisitor para la montaje  
Assembly Requirements

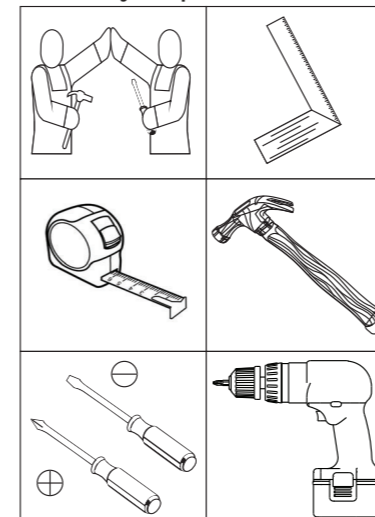

Imagens meramente ilustrativas  
Imágenes meramente ilustrativas  
Images for illustration only

**AVISO**

Para limpeza de seu móvel, use uma flanela seca ou umedecida, e não utilize produtos químicos que possam danificar seu produto.

**SISTEMA DE MONTAGEM**

O sistema de montagem dos produtos, funciona de acordo com a ordem crescente dos números indicados no desenho. Ex: 01, 02, 03, 04... até a conclusão da montagem.

**ADVERTENCIA**

Para limpieza de su móvil, use una flanela seca o húmeda, y no utilice productos químicos que puedan dañar su producto.

**SISTEMA DE MONTAJE**

El sistema de montaje de los productos funciona de acuerdo con el orden creciente de los números indicados en el dibujo. Ej.: 01, 02, 03, 04... hasta la conclusión del montaje.

**NOTICE**

To clean your furniture, use a dry or wet cloth, and do not use chemicals that may damage your product.

**ASSEMBLY SYSTEM**

The products' assembly system works according to the increasing order of the indicated numbers. For example: 01, 02, 03, 04 ... to the end of the assembly.

<b>A</b> 08x Parafuso 4,5x50mm CHT. Tornillo 4,5x50mm CHT. Screw 4,5x50mm CHT.	<b>B</b> 34x Parafuso 3,5x40mm CHT. Tornillo 3,5x40mm CHT. Screw 3,5x40mm CHT.	<b>C</b> 18x Parafuso 3,5x25mm FLA. Tornillo 3,5x25mm FLA. Screw 3,5x25mm FLA.	<b>D</b> 108x Parafuso 3,5x12mm FLA. Tornillo 3,5x12mm FLA. Screw 3,5x12mm FLA.	<b>E</b> 66x Parafuso 3,5x12mm CHT. Tornillo 3,5x12mm CHT. Screw 3,5x12mm CHT.	<b>F</b> 97x Cavilha 5x25mm Cinta 5x25mm Dowel 5x25mm
<b>G</b> 08x Prego 12x12mm Anelado Clavo 12x12mm Anillado Ringed Nails 12x12mm	<b>H</b> 140x Prego 10x10mm Clavo 10x10mm Nail 10x10mm	<b>I</b> 42x Fixador de fundos Fijador de fondos Bottom fixer	<b>J</b> 20x Cantoneira plástica Cantonera plástica Plastic angle brackets	<b>K</b> 08x Porca Cilíndrica Tuerca cilíndrica Cylindrical nut	<b>L</b> 17x Calço metal 5mm Calzado metálico 5mm 5 mm metal shim
<b>M</b> 17x Dobradiça metal 26mm Bisagra de metal 26mm 26 mm metal hinge	<b>N</b> 04x Corrediça metal 350mm Corredera de metal 350mm Sliding metal 350mm	<b>O</b> 01x Perfil "I" 1282mm Perfil "I" 1282mm Profile "I" 1282mm	<b>P</b> 06x Pé "U" 50x40x100mm Pie "U" 50x40x100mm 50x40x100mm "U" Feet	<b>Q</b> 04x Suporte cabideiro Soporte de percha Coat hanger support	<b>R</b> 02x Cabideiro Alum. 457mm Alu 457mm percha Alu coat hanger 457mm
<b>S</b> 09x Puxador Leon 128mm Bronze Tirador Leon 128mm Bronce Leon 128mm Bronze Handle	<b>T</b> 02x Sachê de cola Bolsa de pegamento Glue bag	<b>U</b> 37x Adesivo tapa parafuso 10mm Adhesivo tapón de tornillo 10mm Bolt cover adhesive 10mm	<b>V</b> 01x Suporte metal Soporte metálico Metal support	<b>W</b> 01x <b>HENN</b> Etiqueta resinada Henn Etiqueta resinada Henn Henn resin label	

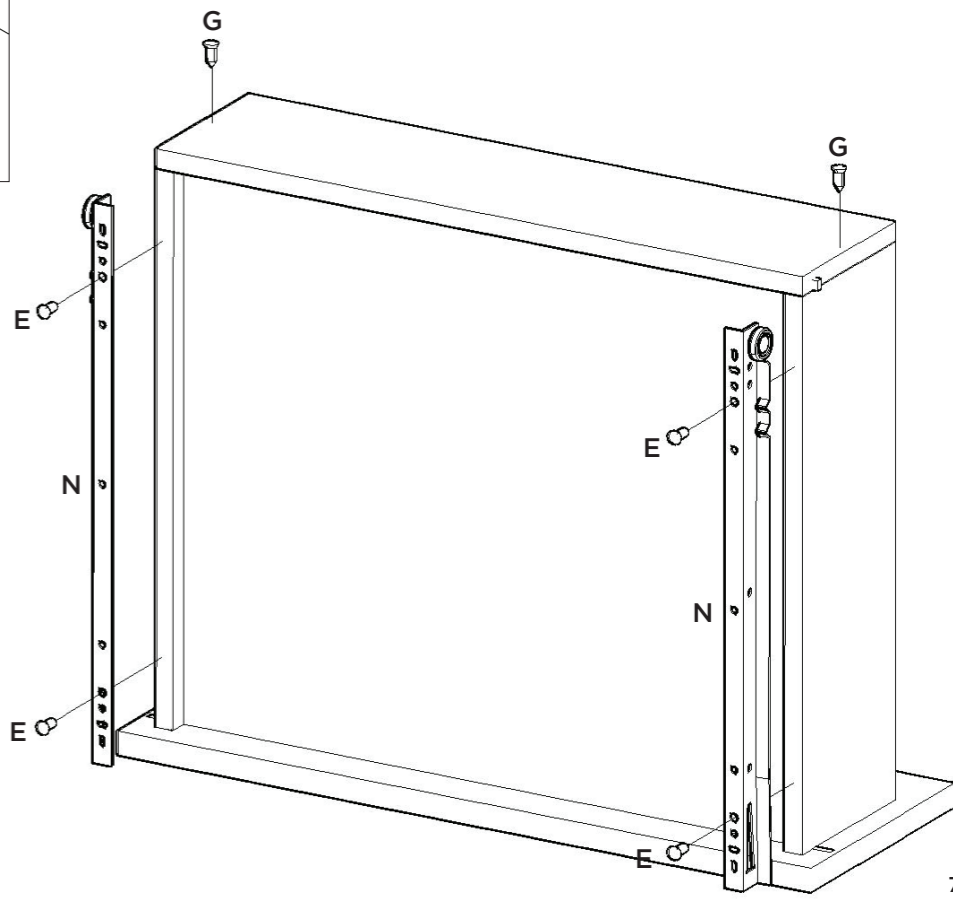
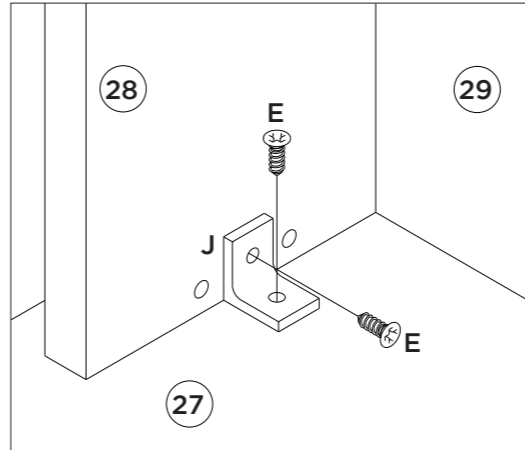
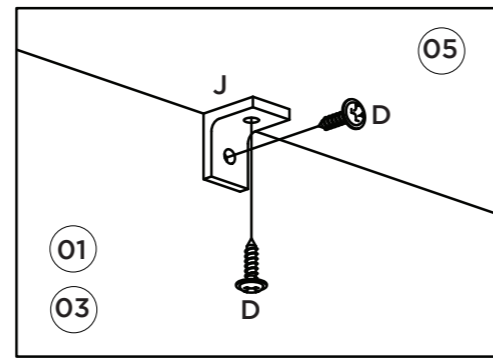
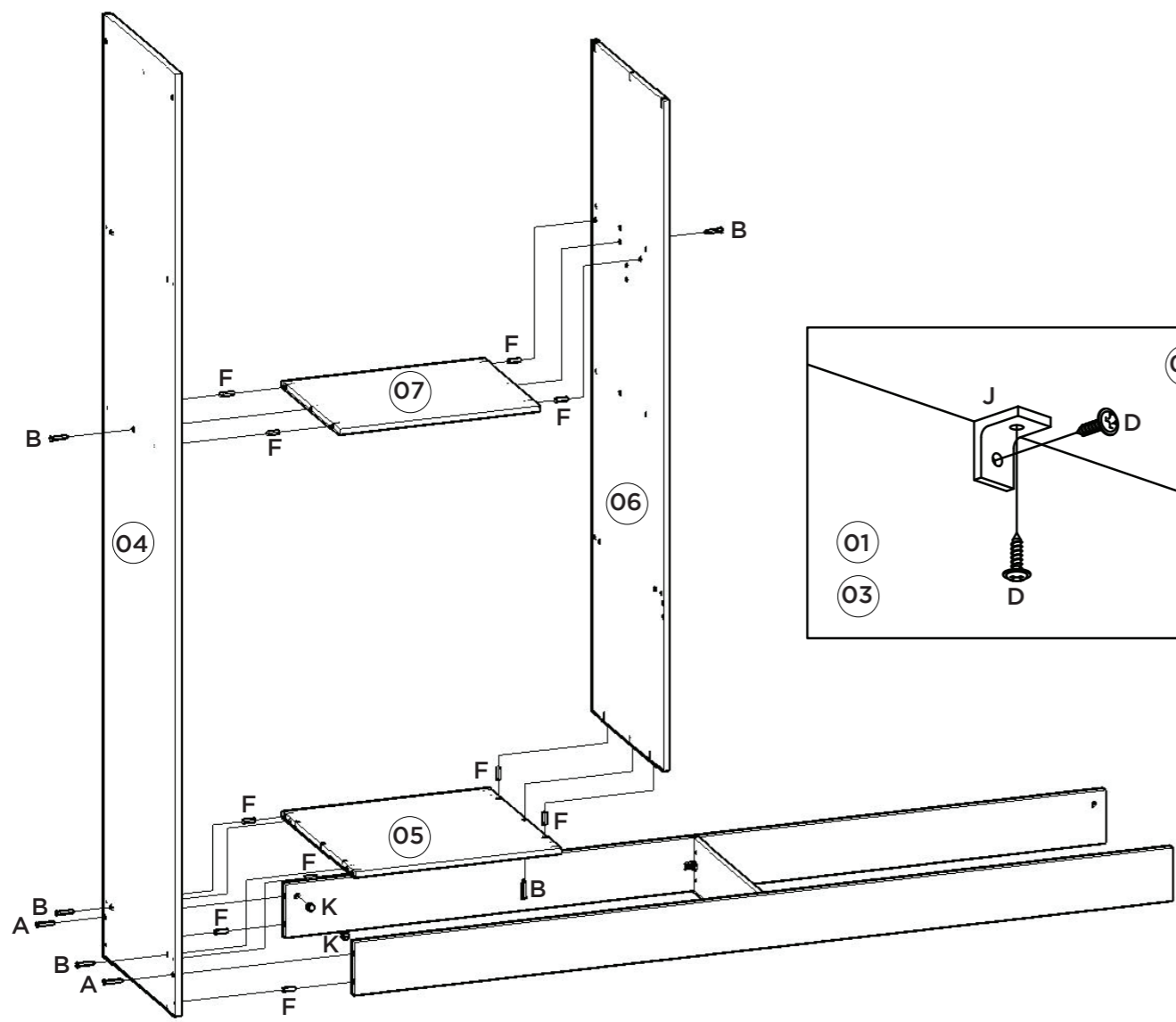
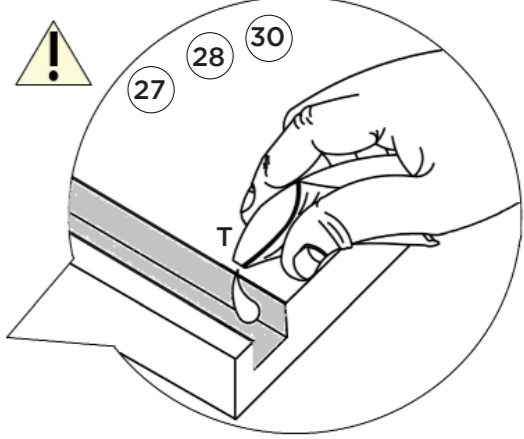
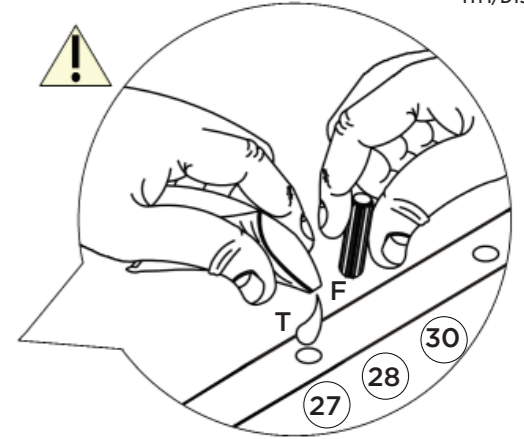
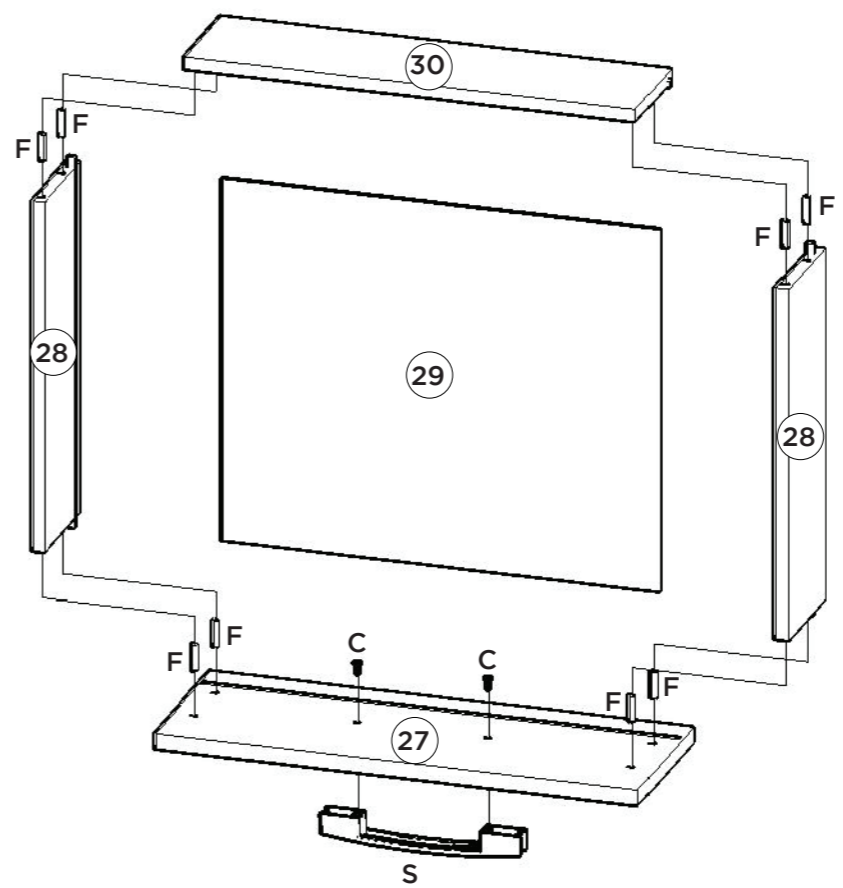
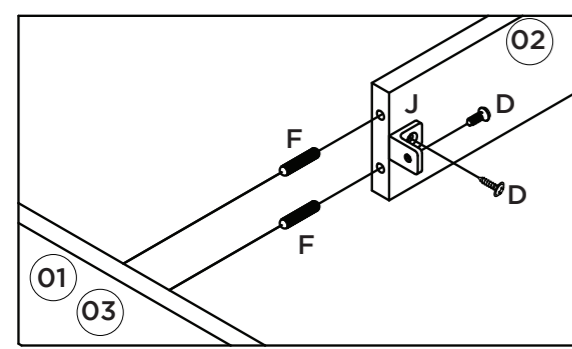
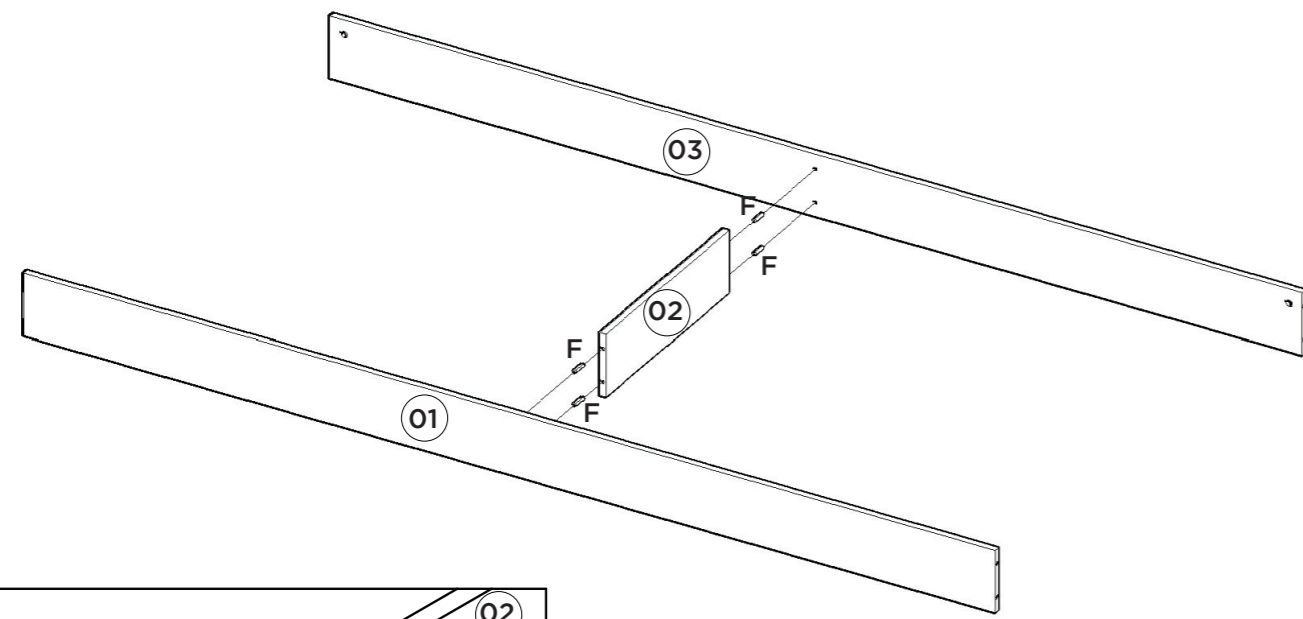

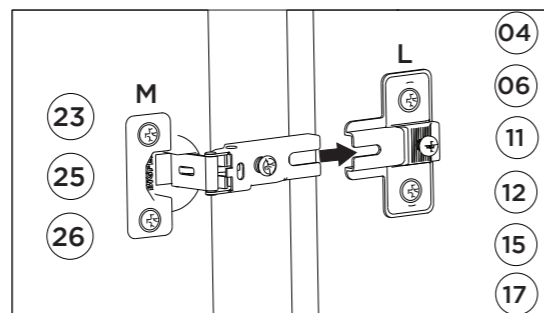
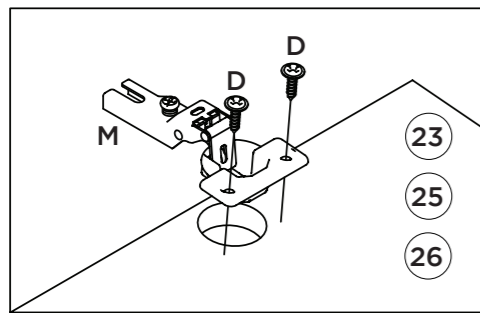
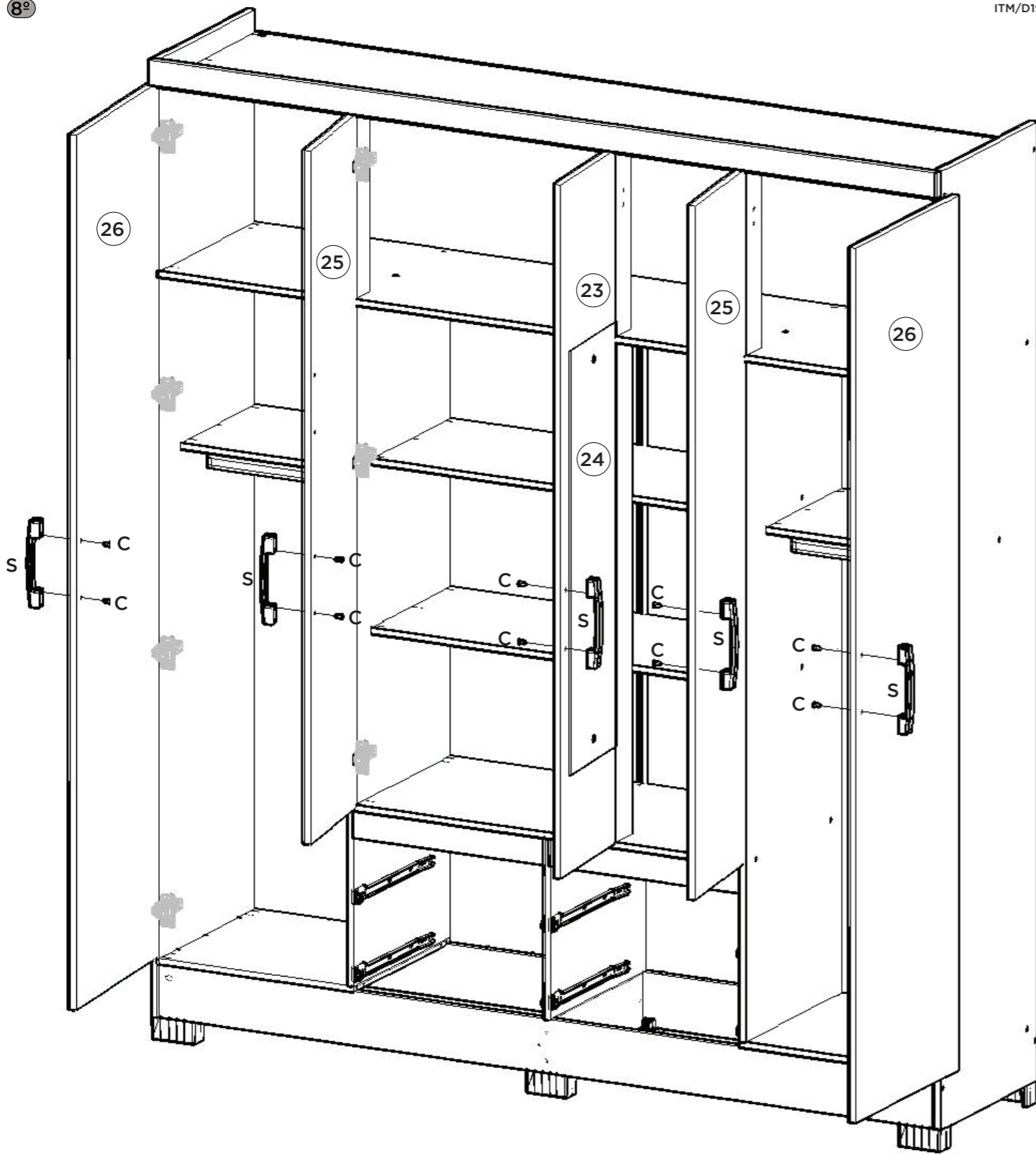

Vídeo: Instalar e regular Dobradiças

Video: Instale y ajuste las bisagras

Video: Install and adjust hinges

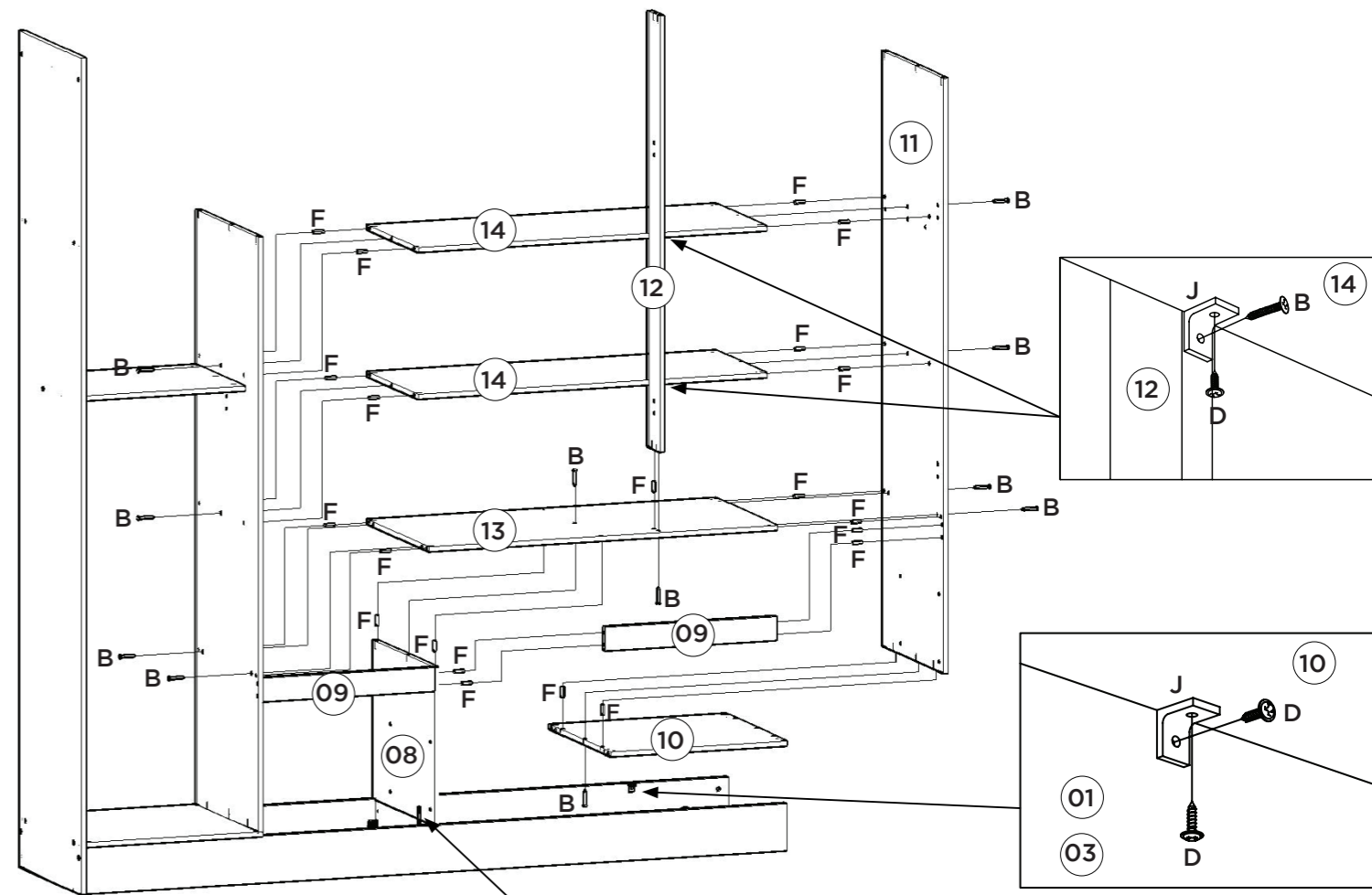

Colocar o suporte de metal (V) bem na frente, conforme desenho

Colocar el soporte de metal (V) en el frente, según el diseño

Attach the metal bracket (V) well in front, according to drawing

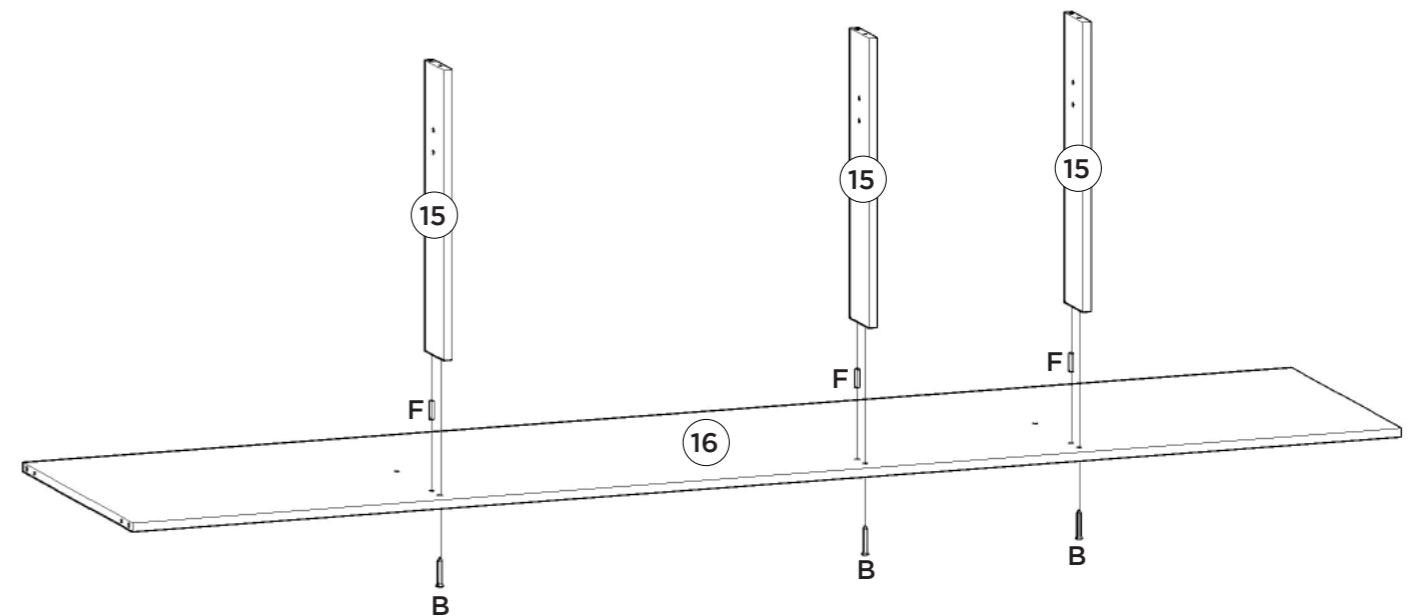
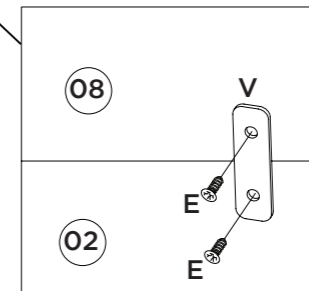

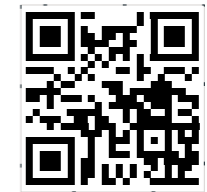
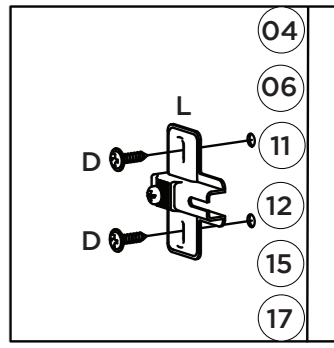
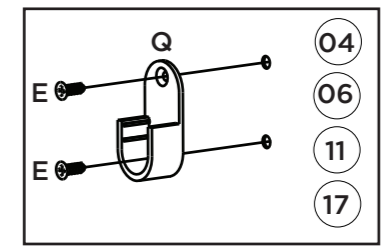
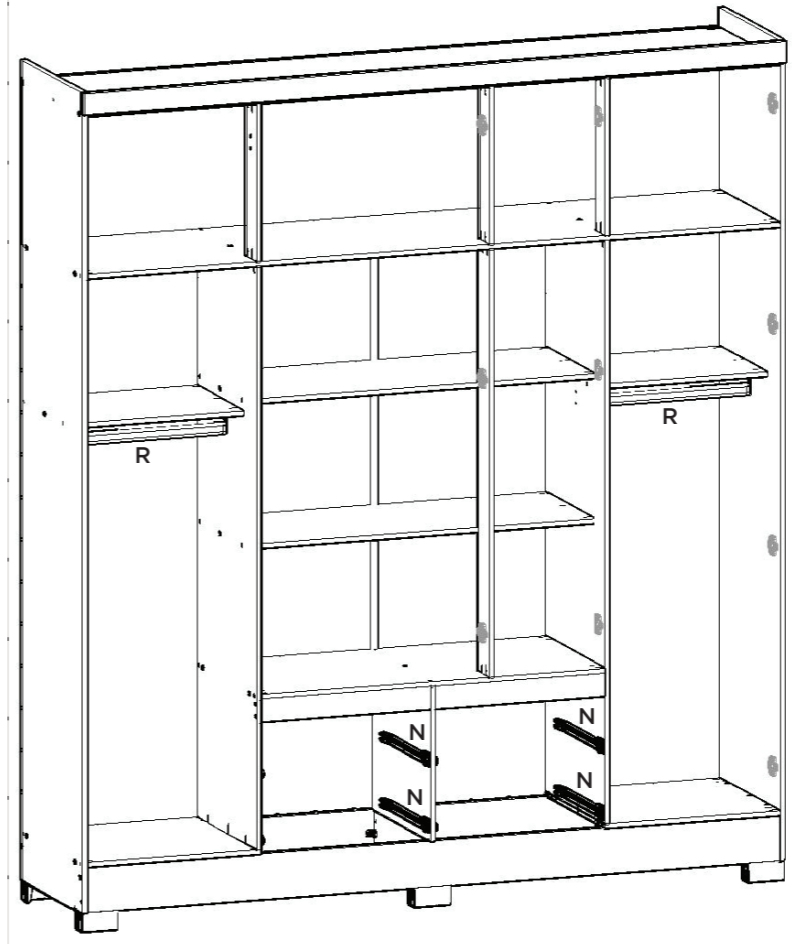
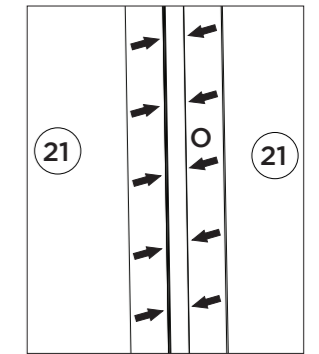
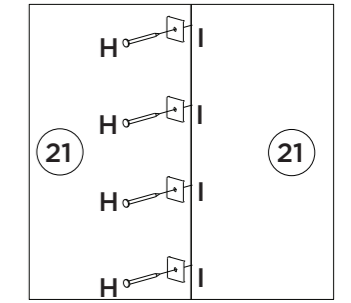
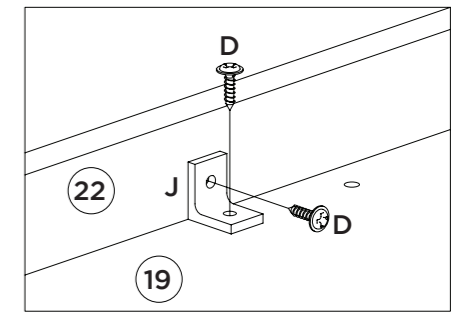
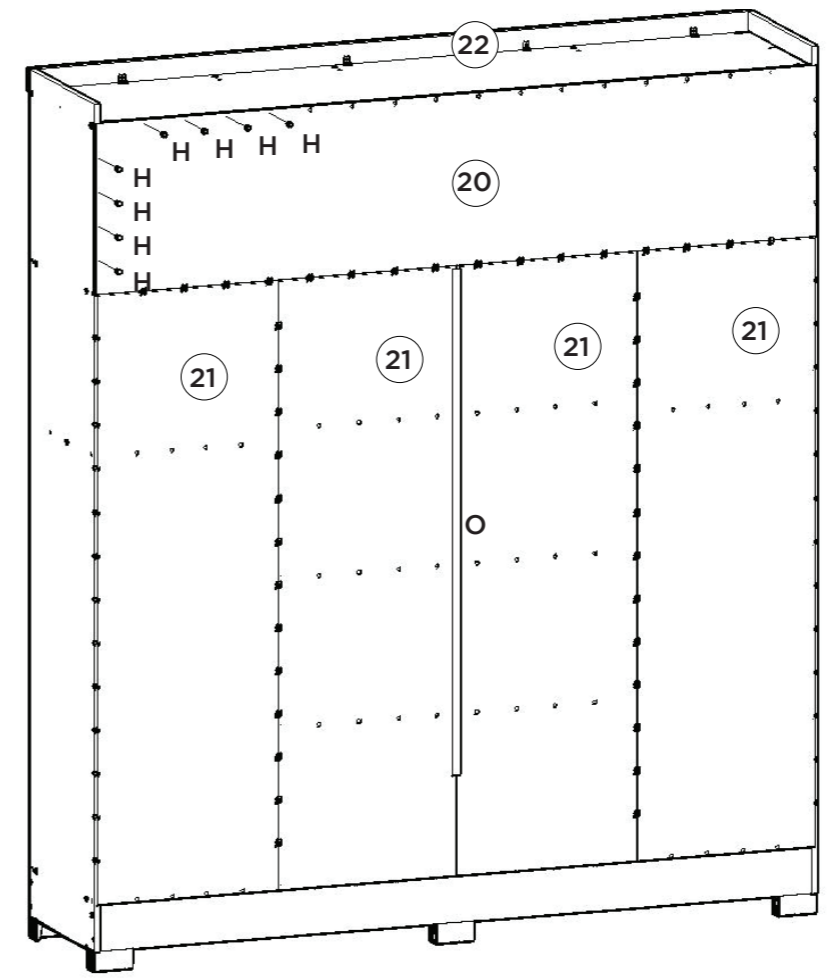
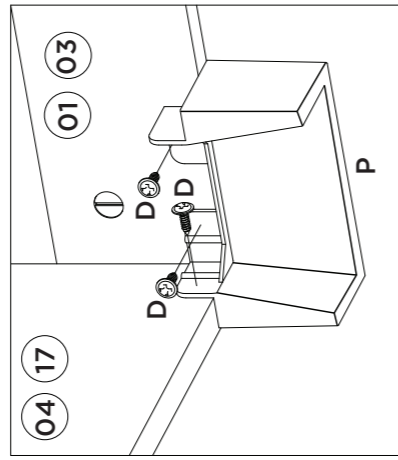
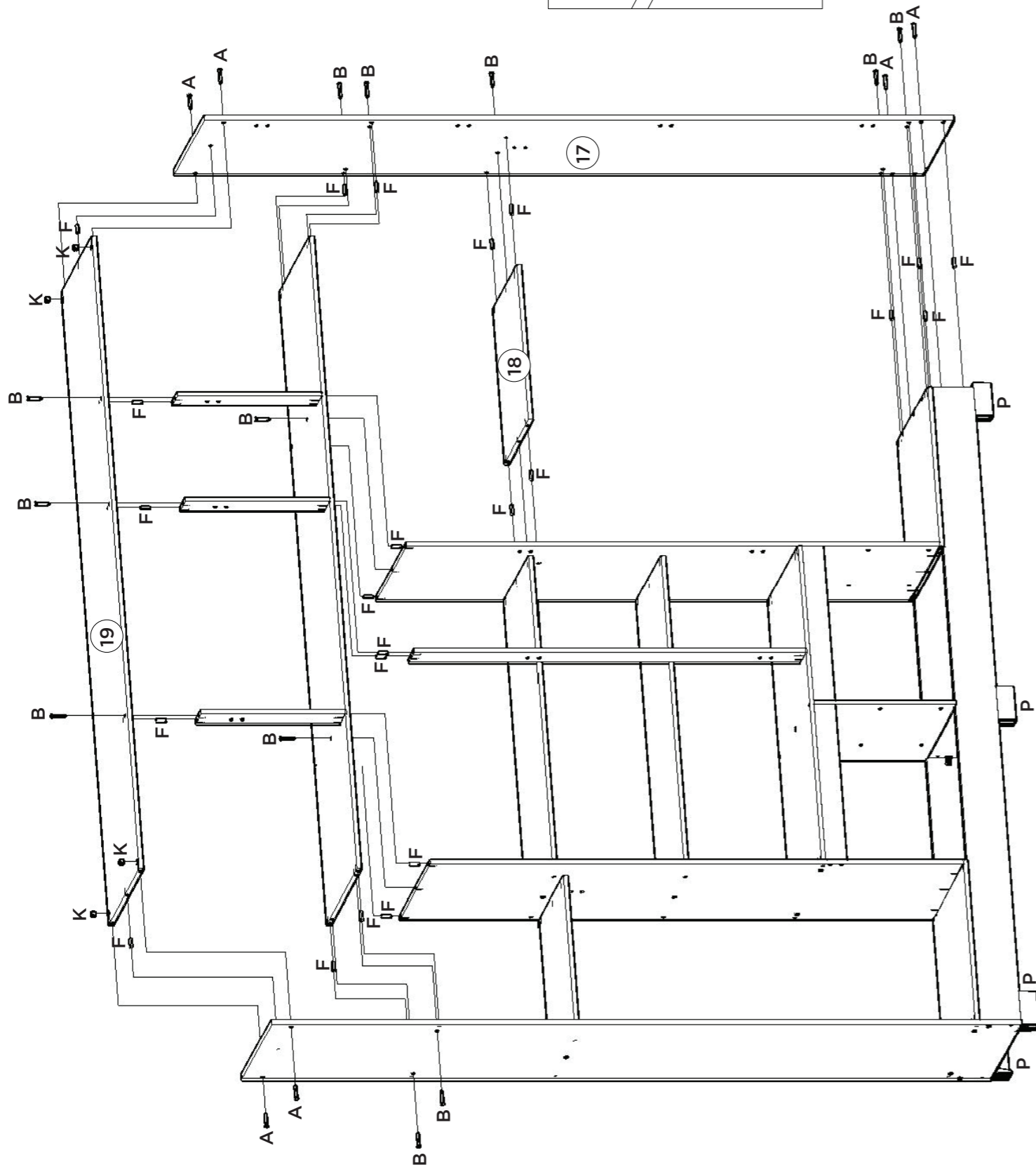

Vídeo: Dicas para instalar corredeira  
 Vídeo: consejos para instalar la diapositiva  
 Video: Tips for installing slide

