

ACESSÓRIOS

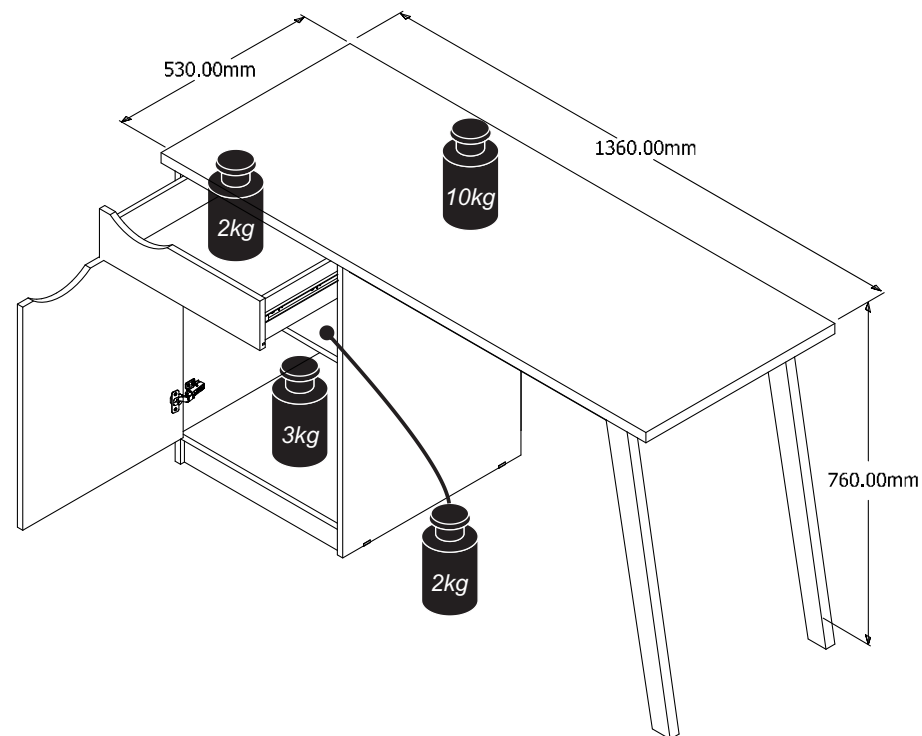
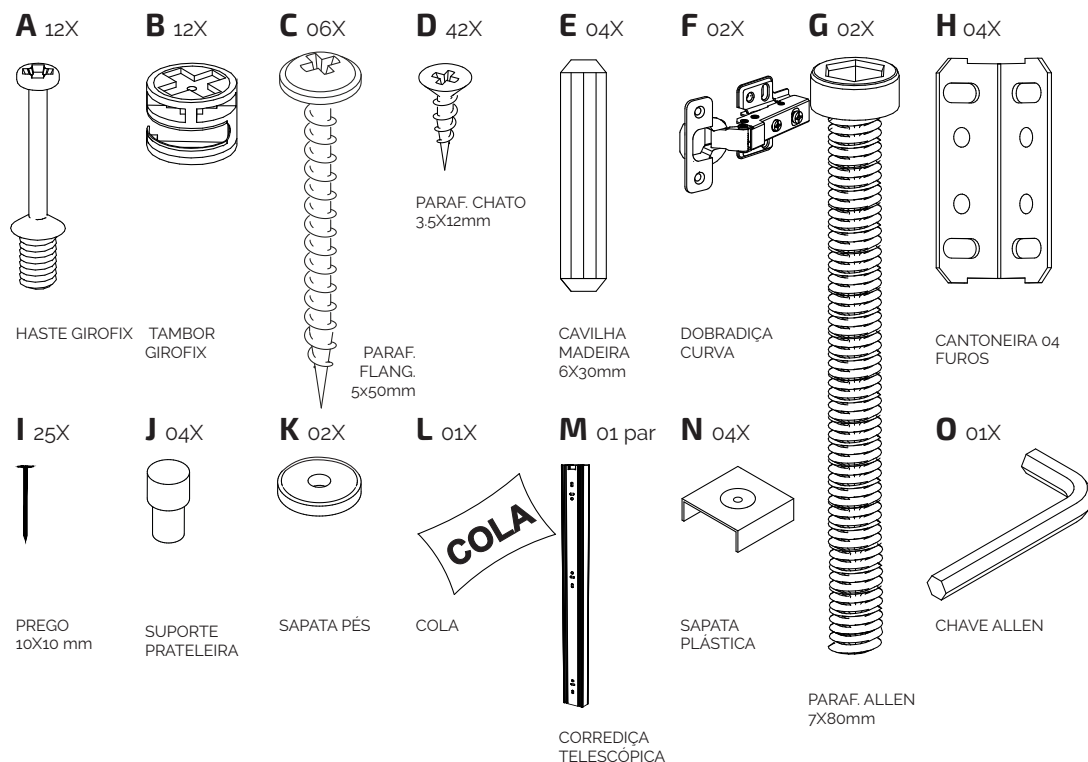

ATENÇÃO

Conferir as medidas dos parafusos e acessórios na escala abaixo antes de utilizá-los

MEDIDAS EM mm

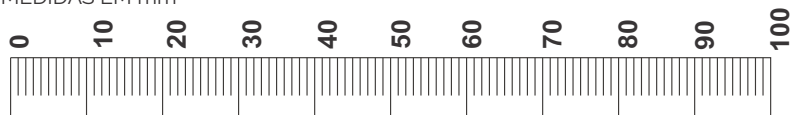

FERRAMENTAS NECESSÁRIAS (NÃO FORNECIDAS)

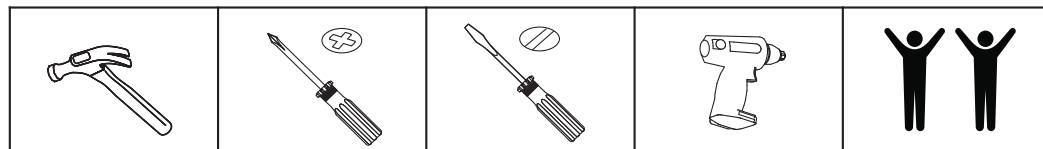

RECOMENDAÇÕES DE USO

- 1- O produto deve ser transportado em sua embalagem para que sejam preservadas suas características;
- 2- A limpeza e manutenção do produto deve ser feita com pano úmido, sem adição de produtos químicos;
- 3- A montagem deve atender aos passos especificados no roteiro de montagem, que se encontra em anexo ao produto;
- 4- Evitar locais úmidos ou com excessiva luz do sol, para maior durabilidade do produto.

| IDENTIFICAÇÃO DE PEÇAS

Nº	QTD.	DESCRIÇÃO	MEDIDAS (mm)
01	01	LATERAL DIREITA	735X503X15
02	01	RODAPÉ	440X60X15
03	01	BASE	500X440X15
04	01	LATERAL ESQUERDA	735X503X15
05	01	TAMPO	1360X530X25
06	01	FUNDO TRASEIRO	685X465X3
07	02	PÉS	735mm
08	01	PRATELEIRA	400X440X15
09	01	FRENTE GAVETA	450X120X15
10	02	LATERAL GAVETA	290X100X12
11	01	FUNDO GAVETA	403X302X3
12	01	CONTRAFUNDO GAVETA	416X100X12
13	01	PORTA	540X450X15

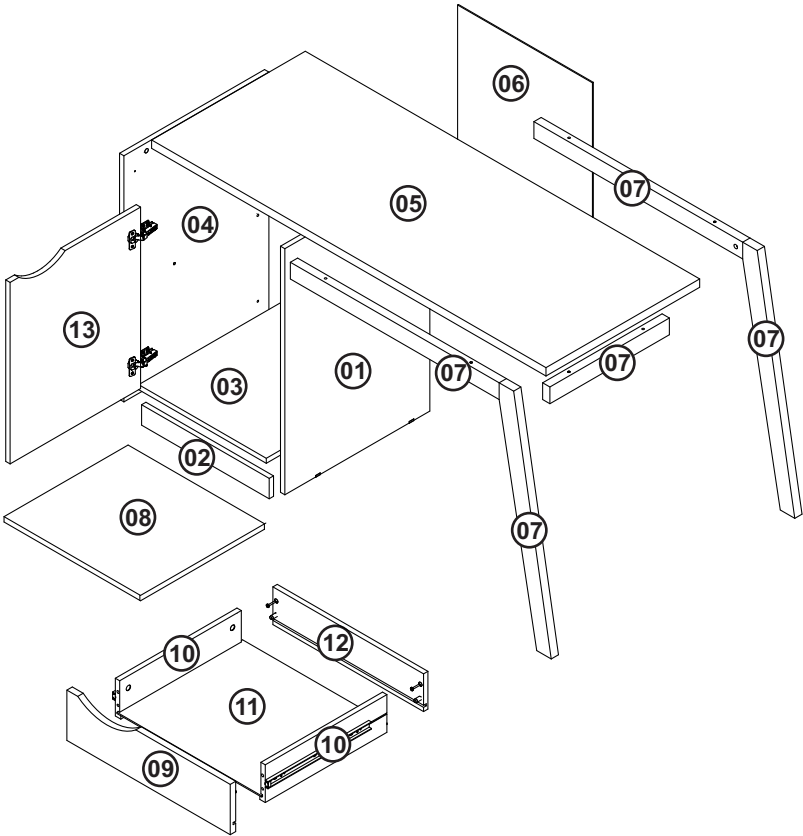

| MONTAGEM

PASSO 01

090921

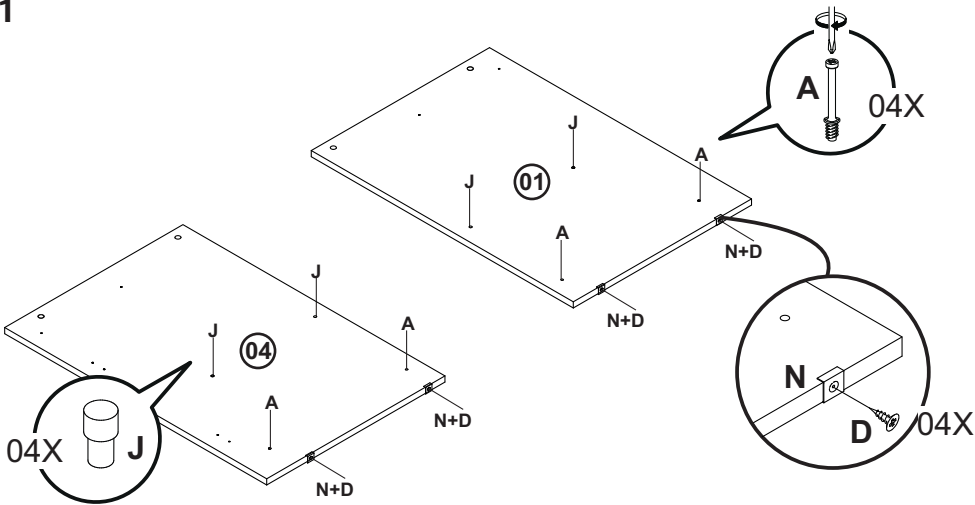

PASSO 02

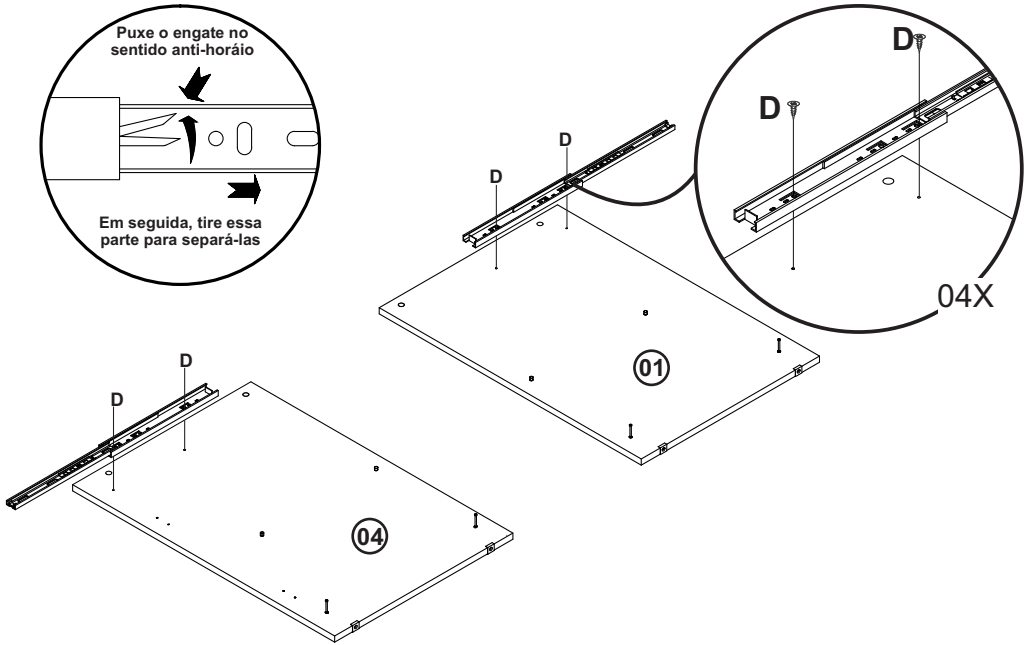

PASSO 03

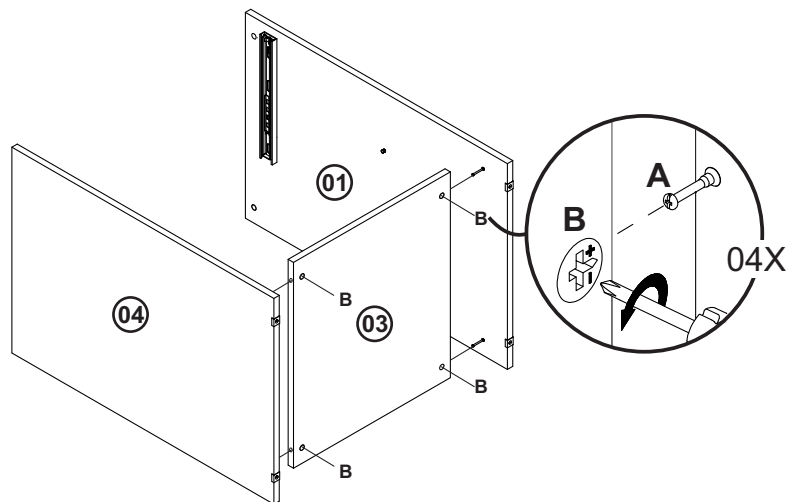

PASSO 04

090921

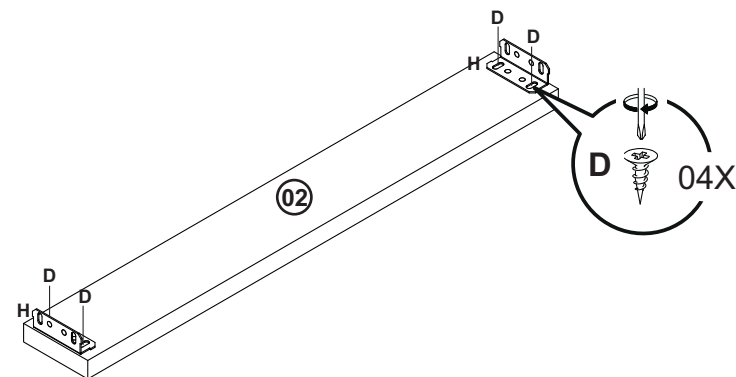

PASSO 05

OBSERVAÇÃO:

Virar peça montada para aparafusar rodapé (02).

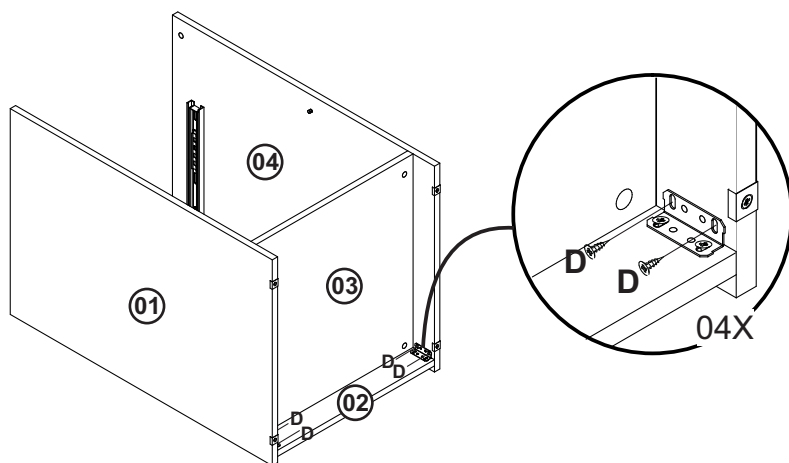

PASSO 06

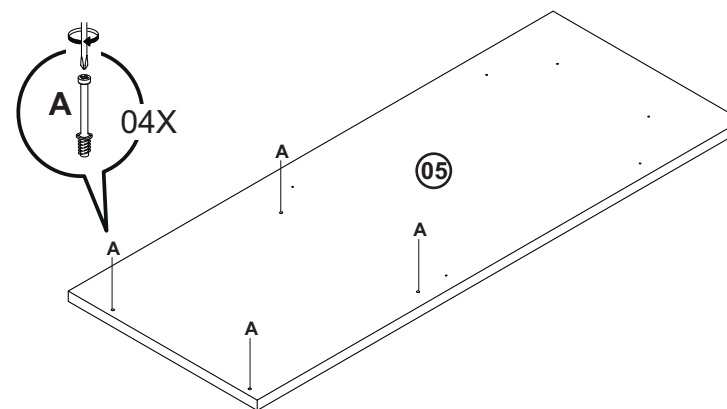

PASSO 07

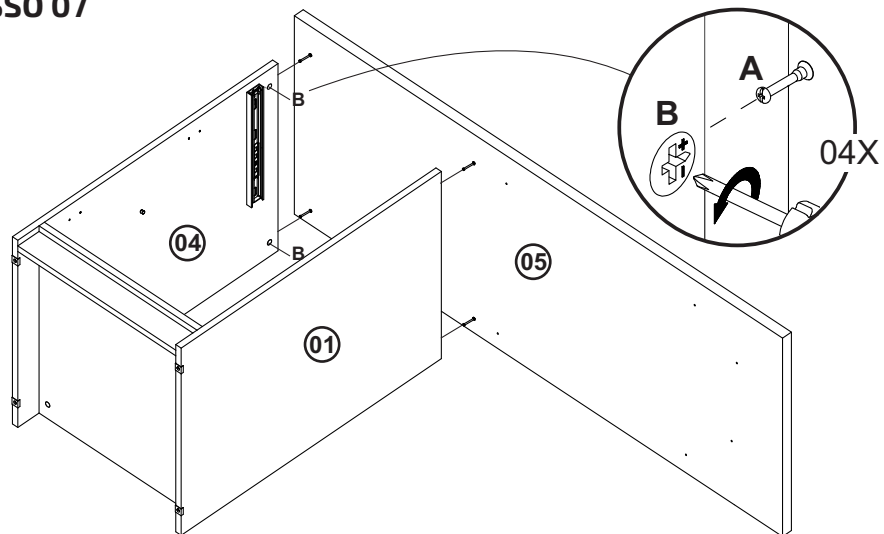

PASSO 08

090921



Passar cola (L) antes de aparafusar as peças que compõem os pés.

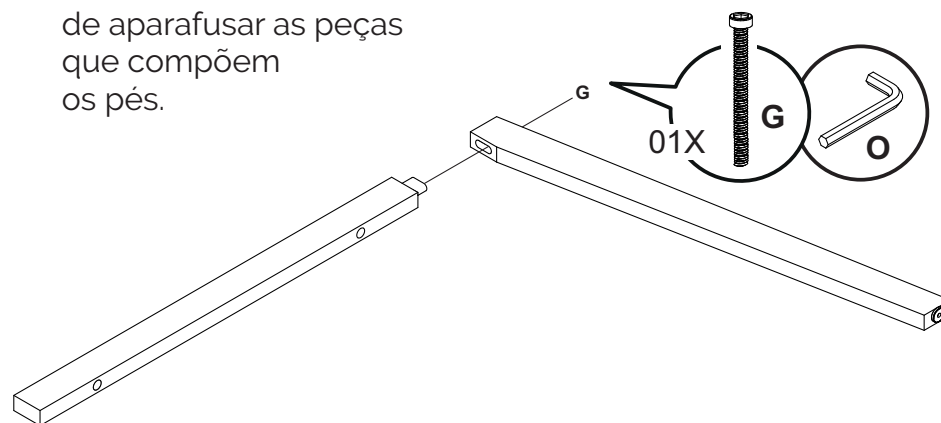

PASSO 09

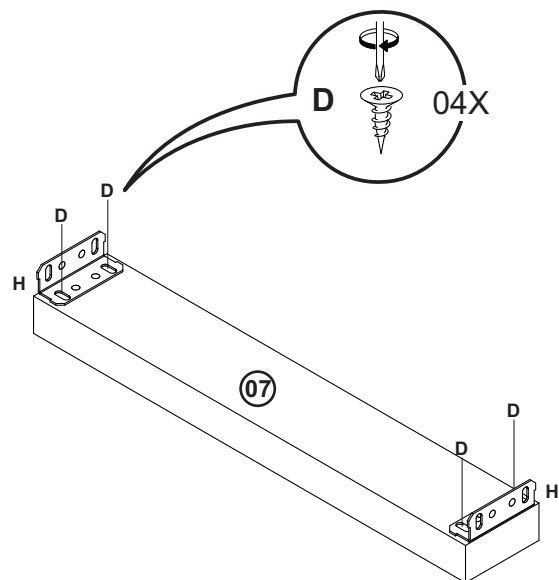

PASSO 10

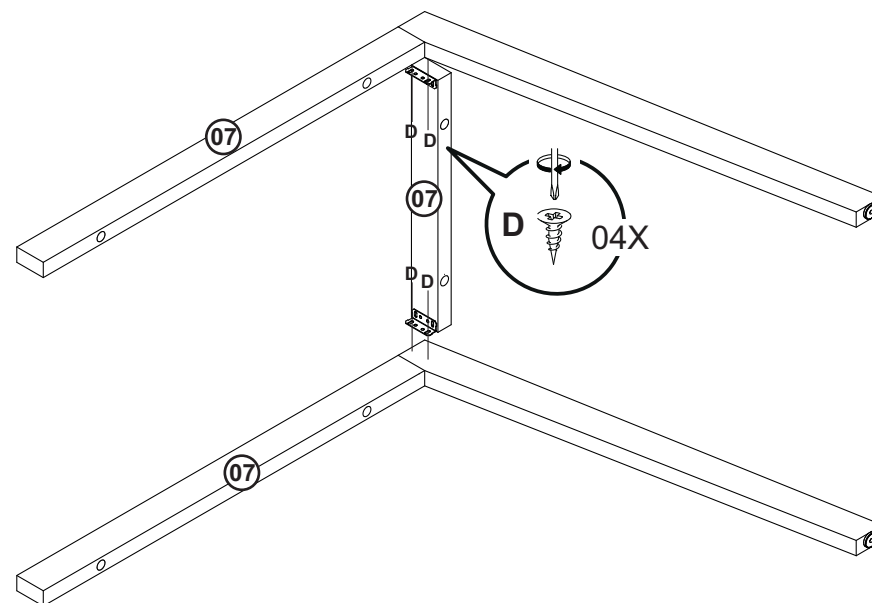

PASSO 11

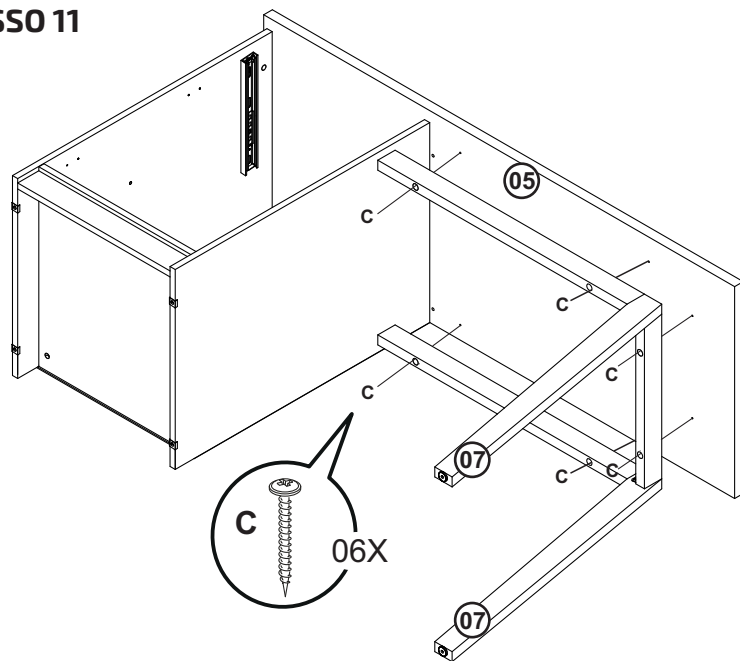

PASSO 12

090921

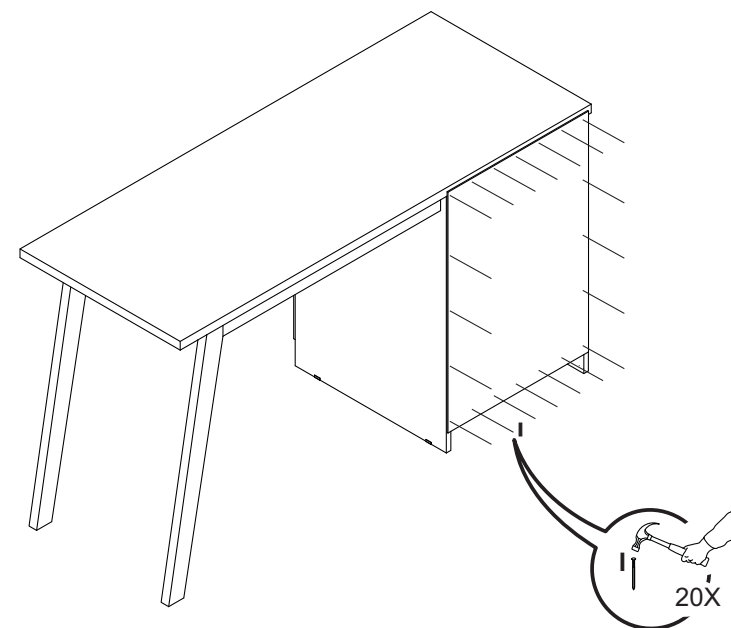

PASSO 13

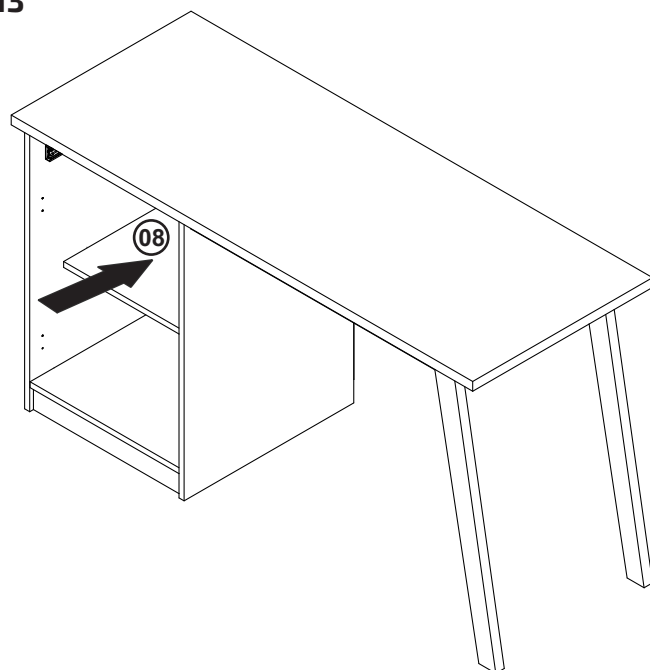

PASSO 14

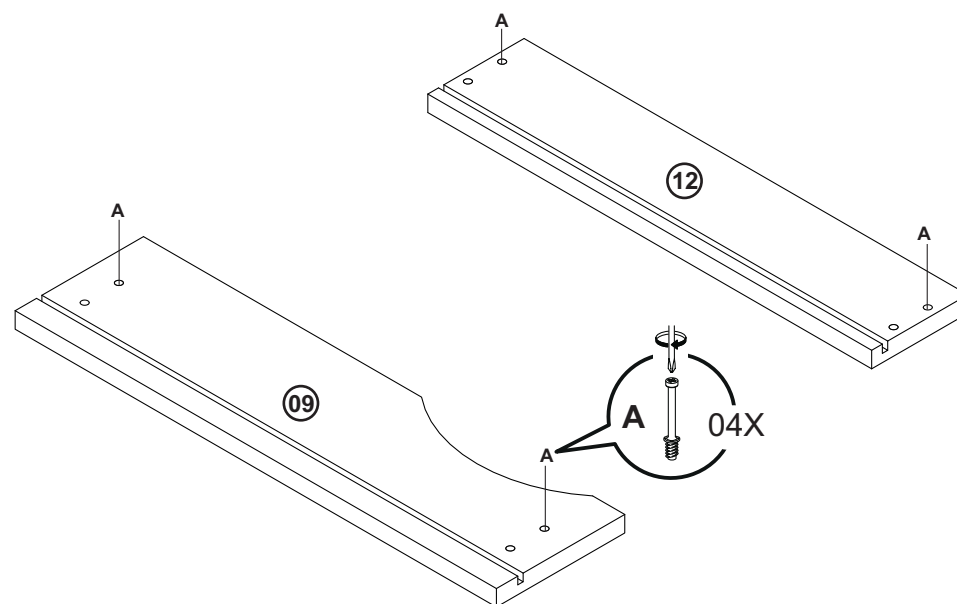

PASSO 15

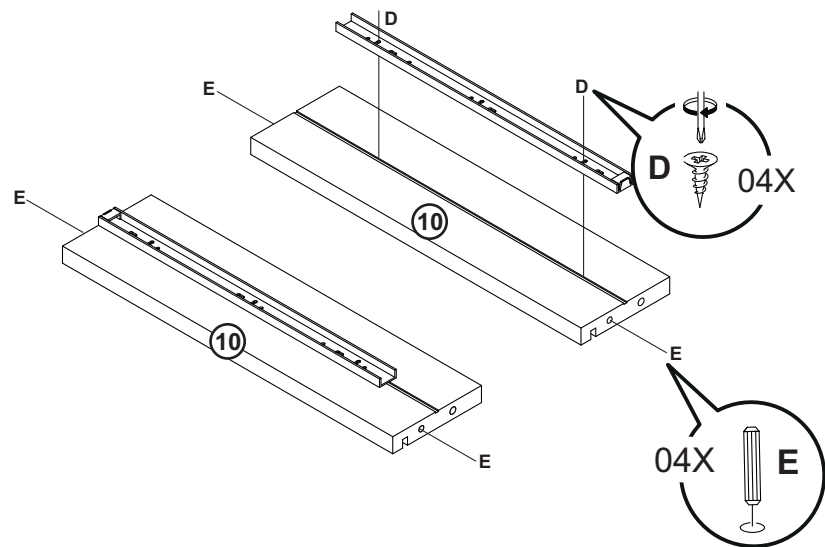

PASSO 16

090921

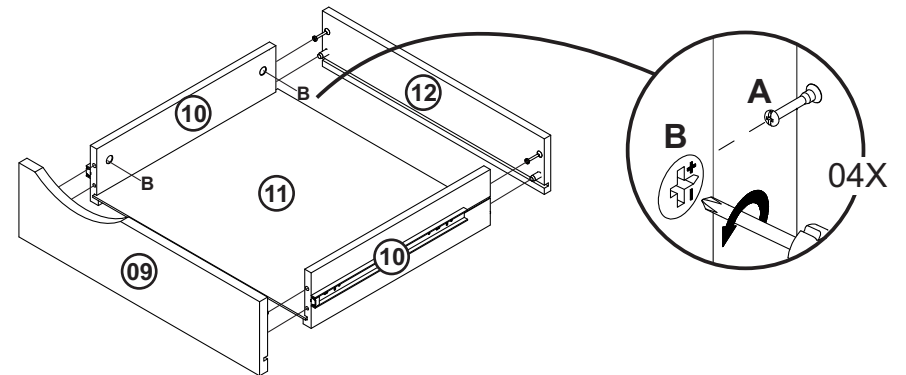

PASSO 17

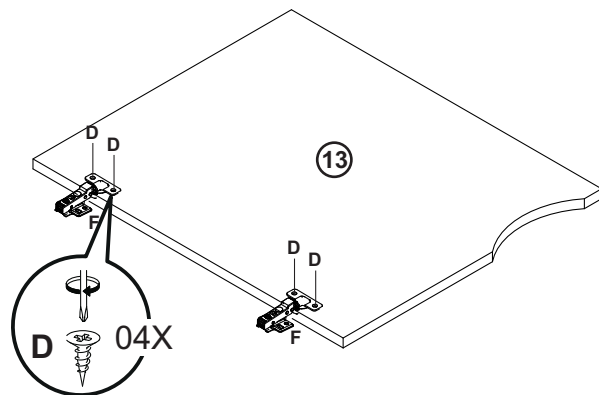

PASSO 18

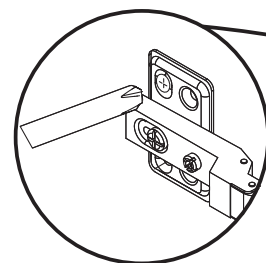

Fixe as dobradiças (F) na lateral (04) com parafusos D.

