

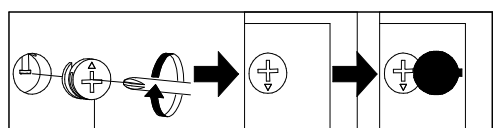

01

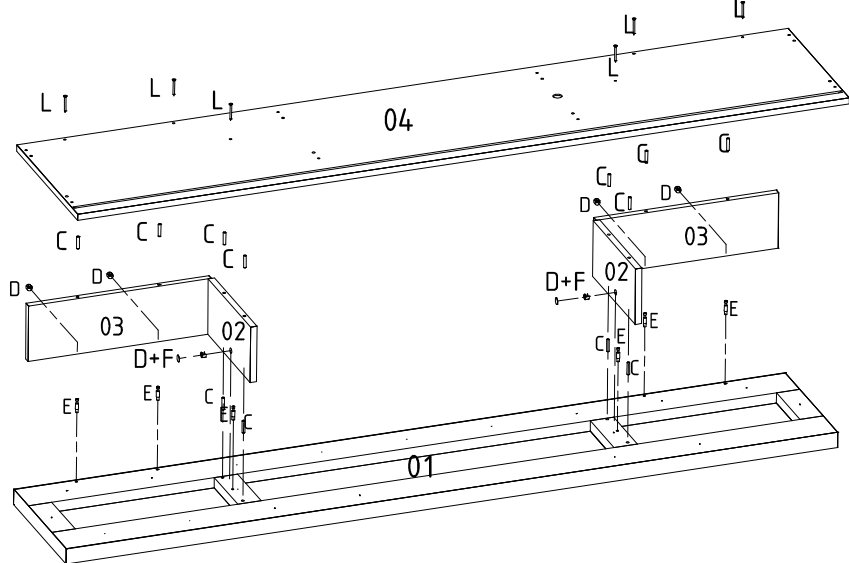

- C 12
- D 06
- E 06
- F 02
- L 06



02

2X

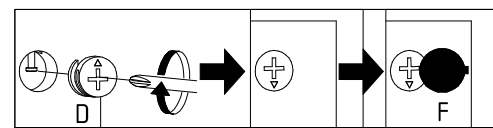

- C 12
- D 08
- E 08
- F 08
- K 06
- M 24

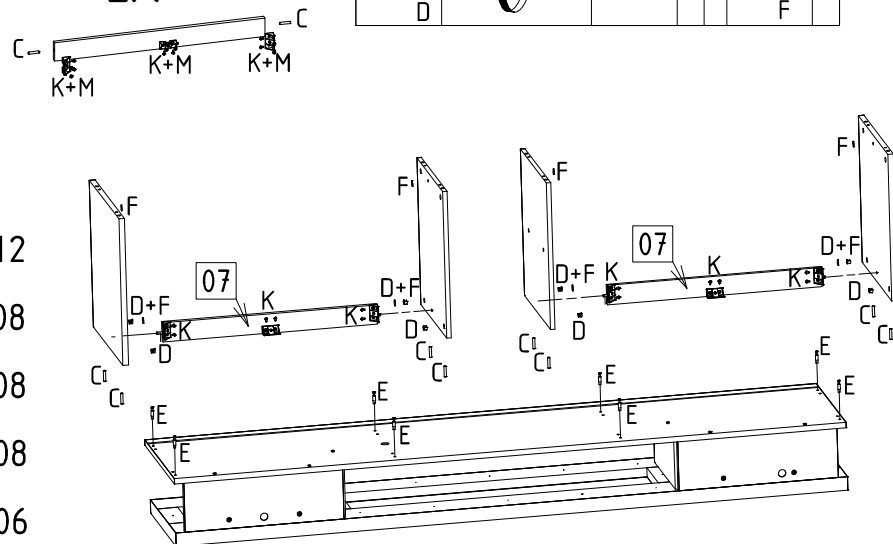

03

- C 12
- D 08
- E 08
- F 08
- K 07
- M 28

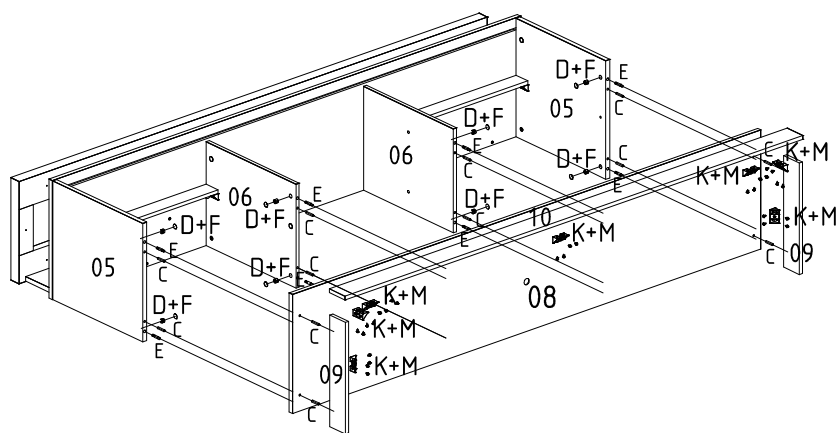

04

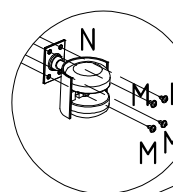

- M 28
- N 07

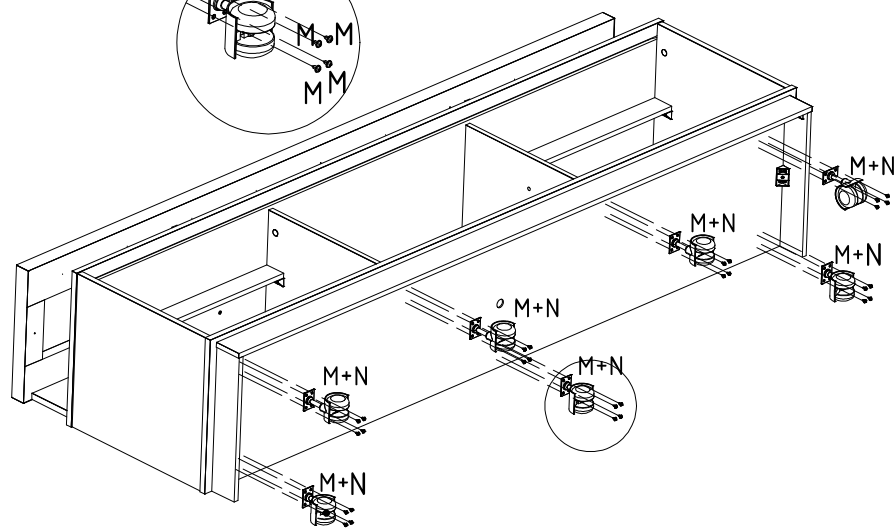

05

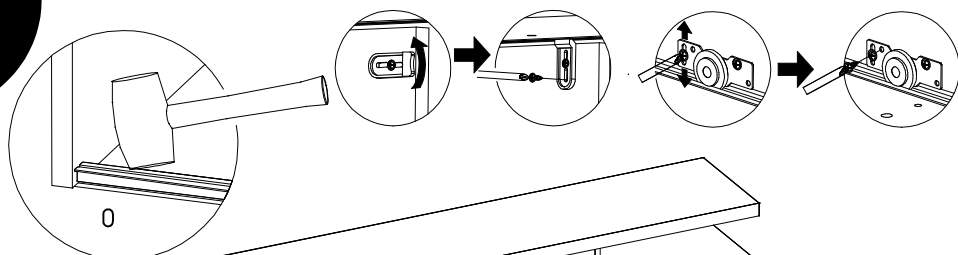

- J 08
- M 32
- O 02
- P 02
- S 16

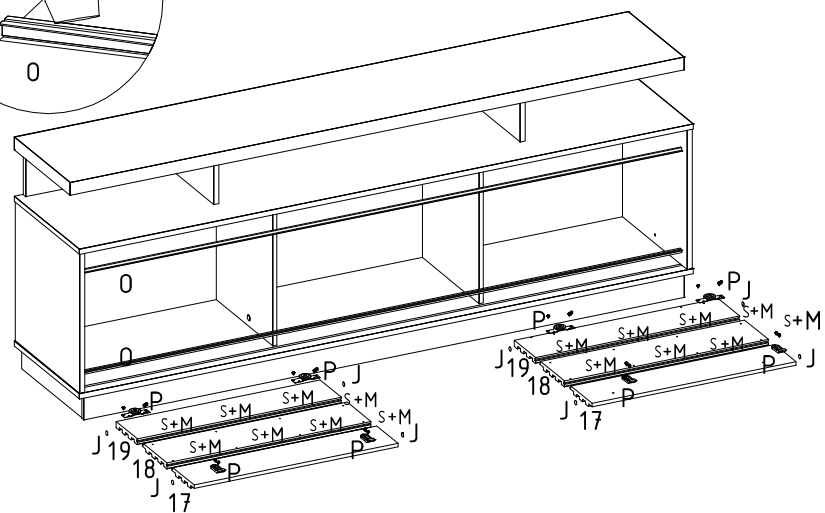

06

- G 58
- H 14
- Q 01
- R 02

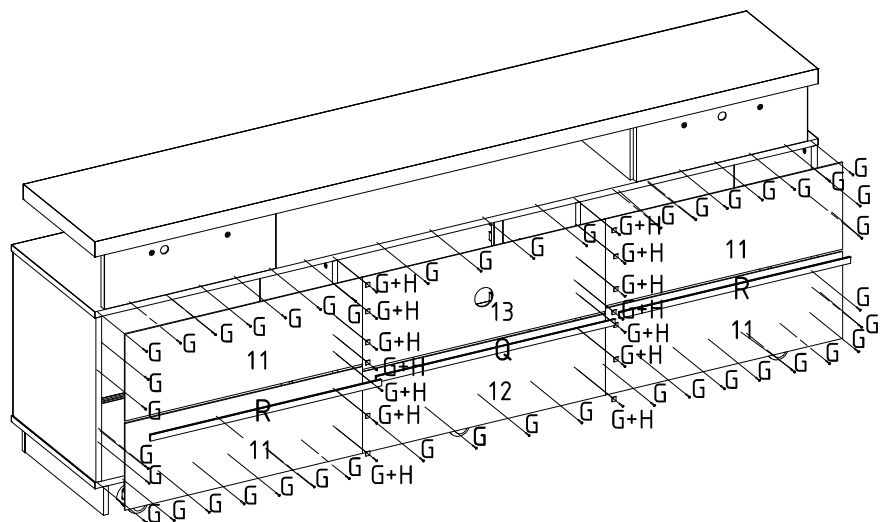

07

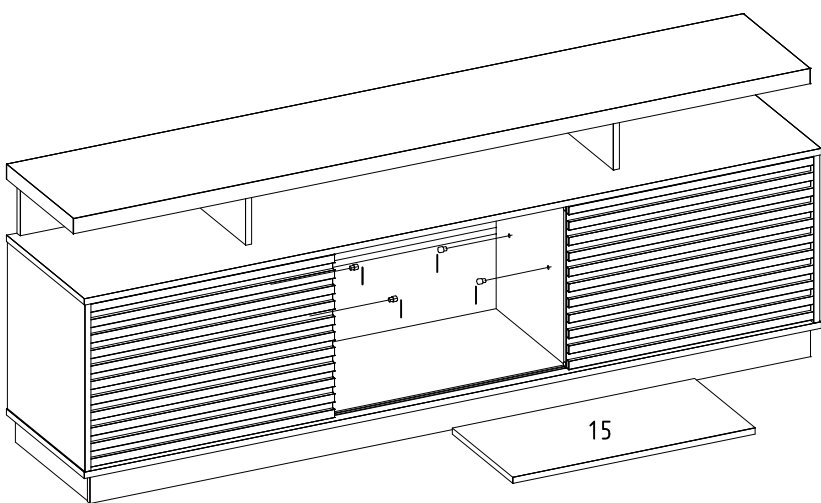

- I 04

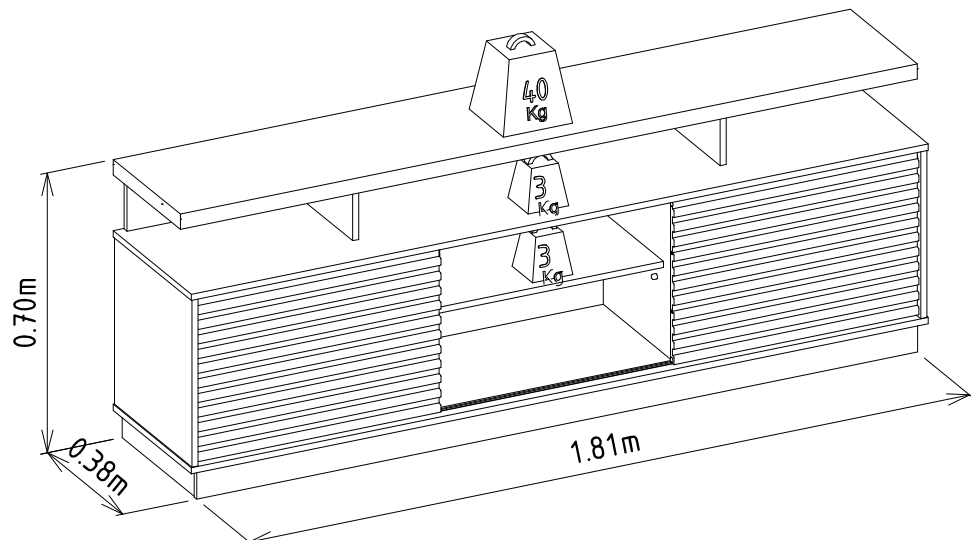





AURORA

810006048

V2 - 27/01/2021



60 min



1

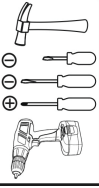

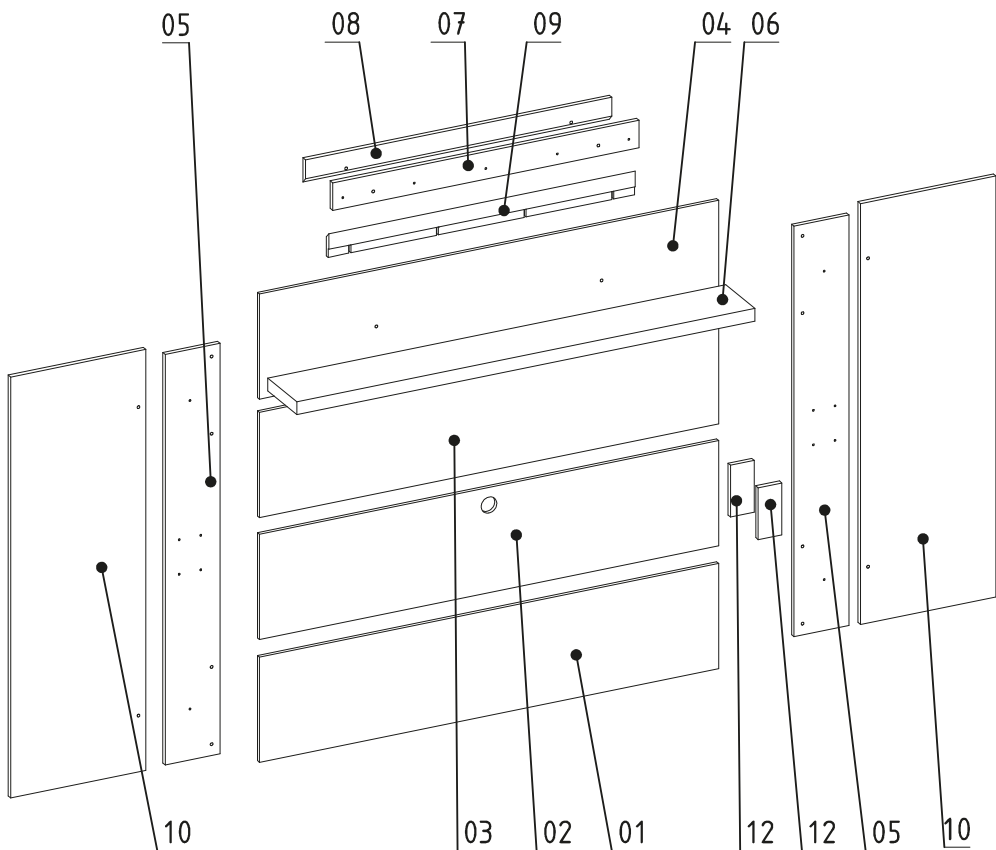

05

08

07

09

04

06

10

03

02

01

12

12

05

10

Vol. 01

Box 01 | Caja 01

01, 02, 03, 04, 05

06, 07, 08, 09, 10

GARANTIA

| Warranty

| Garantia

Nossos produtos são garantidos por 90 dias contra defeitos de fabricação. Ao constatar um problema coberto pela garantia, entre em contato com a loja onde o produto foi comprado. Ela estará capacitada para atendê-lo da melhor forma diante de cada caso. Reclamações de garantia somente poderão ser atendidas se o termo de garantia for apresentado no ato de reivindicação, acompanhado de sua nota fiscal de compra.

Nuestros productos están garantizados contra defectos de fabricación por 90 días, a partir de la compra. Al constatar un problema protegido por la garantía, póngase en contacto con la tienda donde se adquirió el producto. Ella estará capacitada para atenderlo de la mejor manera de acuerdo con cada caso.

Our products are guaranteed against manufacturing defects for 90 days from the date of purchase. When you find a problem covered by the warranty, please contact the store where the product was purchased. The Store will be able to serve you in the best way in each case.

Exclusões

-Desgaste natural ou danos causados por água, maresia, ferrugem, incêndio, calor, cupins e pragas em geral

- Montagem, manutenção e uso inadequado

- Não cumprimento das recomendações técnicas do esquema

- Montagens e desmontagens após a primeira instalação

- Instalações elétricas e outras afins

Exclusiones

- Desgaste natural o daños causados por agua, mares, maresia, incendios, calor, termitas y plagas en general

- Montaje, mantenimiento y uso inadecuado

- No cumplimiento de las recomendaciones técnicas del esquema

- Montaje y desmontaje después de la primera instalación

- Instalaciones eléctricas y otras afines

Exclusions

- Natural wear or damage caused by water, sea, rust, fire, heat, termites and plagues in general

- Assembly, maintenance and improper use

- Failure to comply with the technical recommendations of the assembly instructions

- Assembly and disassembly after first installation

Importante

A Linea Brasil não autoriza nenhuma pessoa, loja ou entidade assumir em seu nome qualquer outra garantia que não conste no certificado. A fabricante reserva-se no direito de efetuar nos produtos eventuais modificações que considerar necessárias, sem prejudicar as características essenciais. Os produtos terão peças de assistência para reposição no período de 1 ano a contar de sua retirada do mercado, desde que haja matéria-prima equivalente, observando o disposto no Art. 32 da Lei 8.078/90 (Cód. Defesa do Consumidor). O atendimento para produtos fora de linha é feito por programação especial, através da loja revendedora sob aprovação de consulta prévia ao fabricante.

Importante

A Linea Brasil no autoriza a ninguna persona, tienda o entidad a asumir en su nombre cualquier otra garantía que no figure en el certificado. El fabricante se reserva el derecho de efectuar en los productos eventuales modificaciones que considere necesarias, sin perjudicar las características esenciales. Los productos tendrán piezas de asistencia para reposición en el período de 1 año a partir de su retirada del mercado. La atención para productos fuera de línea es hecha por programación especial, a través de la tienda revendedora bajo aprobación de consulta previa al fabricante.

Important

Linea Brasil does not authorize any person, store or entity to assume on its behalf any other warranty that does not appear on the certificate. The manufacturer reserves the right to make in the products any modifications that it considers necessary without prejudice to the essential characteristics. The products will have replacement parts within one year of being withdrawn from the market. The service for off-line products is done by special programming, through the store reseller under prior consultation with the manufacturer.

Fixar todos os acessórios antes da montagem

Attach all accessories before starting assembly

Coloque todos los accesorios antes del montaje de partida

A

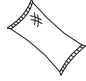

B



C



D



E



F



G

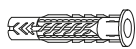

H



I



J



K



L



Código	Descrição	Dimensão	Quantidade	Código	Descrição	Quantidade		
Code	Discripción   Description	Dimensión   Dimension	Cantidad   Amount	Code	Discripción   Description	Cantidad   Amount		
01	510164001	PAINEL INFERIOR TV   PANEL INFERIOR TV   LOWER TV PANEL	1358 x 305 x 12	1	A	160001001	COLA   PEGAMENTO   GLUE	1
02	510164002	PAINEL CENTRAL TV   PANEL CENTRAL TV   CENTRAL TV PANEL	1358 x 305 x 12	1	B	160001003	CAVILHA ESTRIADA 8x20   TARUGO MADERA 8x20 MM   WODDEN DOWL PIN 8x20 MM	8
03	510164003	PAINEL SUPERIOR TV   PANEL SUPERIOR TV   UPPER TV PANEL	1358 x 305 x 12	1	C	160001005	CAVILHA ESTRIADA 8x55   TARUGO MADERA 8x55 MM   WODDEN DOWL PIN 8x55 MM	2
04	510164004	PAINEL SUPERIOR   PANEL SUPERIOR   UPPER PANEL	1358 x 305 x 12	1	D	160001009	ARRUELA TRAVESSA PAREDE   ARANDELA 3/16 15MM   WASHER 3/16 15 MM	4
05	510164005	SUPORTE FIXACAO   SOPORTE FIJACIÓN   FIXING BRACKET	1190 x 162 x 15	2	E	160001034	CHAPA JUNCAO COM 2 FUROs   GRAPAS   STAPLES	12
06	510164006	PRATELEIRA SUPERIOR   ESTANTE SUPERIOR   UPPER SHELF	1354 x 172 x 37	1	F	160002005	GUIA CABO   TAPA PASACABLES   CABLE HIDDEN COVER	1
07	510164007	TRAVESSA APOIO   DIVISIÓN APOYO   SUPPORT DIVISION	906 x 80 x 15	1	G	160002006	BUCHA 8MM   TACOS 8MM   ANCHOR 8MM	4
08	510164008	TRAVESSA PAINEL   DIVISIÓN PANEL   PANEL DIVISION	906 x 70 x 15	1	H	160002012	GIZ DE CORRECAO   TIZA DE CORRECCION   CRAYON REPAIR	2
09	510164009	TRAVESSA PAREDE   DIVISIÓN PARED DEL NICH0   WALL DIVISION	906 x 70 x 15	1	I	160006008	PARAFUSO 4.5X25 CABECA CHATA   TORNILLO CABEZA PLANA 4.5X25   FLAT HEAD SCREW 4.5X25	68
10	510164010	PAINEL LATERAL   PANEL LATERAL   PANEL SIDE	1220 x 400 x 15	2	J	160006010	PARAFUSO 4.5X50 CABECA CHATA   TORNILLO CABEZA PLANA 4.5X50   FLAT HEAD SCREW 4.5X50	7
12	510164012	TRAVESSA APOIO CENTRAL   DIVISIÓN APOYO CENTRAL   SUPPORT CENTRAL DIVISION	150 x 70 x 15	2	K	160006015	PARAFUSO 6,0x75 CABECA CHATA   TORNILLO CABEZA PLANA 6,0x75   FLAT HEAD SCREW 6,0x75	4
					L	160006016	PARAFUSO 3,5X12 CABECA FLANGEADA   TORNILLO CABEZA BRIDA 3.5X12   FLANGE HEAD SCREW 3.5X12	24

mm

0

10

20

30

40

50

60

70

80

90

100

110

120

130

Código	Descrição	Dimensão	Quantidade	Código	Descrição	Quantidade		
Code	Discripción   Description	Dimensión   Dimension	Cantidad   Amount	Code	Discripción   Description	Cantidad   Amount		
01	510164001	PAINEL INFERIOR TV   PANEL INFERIOR TV   LOWER TV PANEL	1358 x 305 x 12	1	A	160001001	COLA   PEGAMENTO   GLUE	1
02	510164002	PAINEL CENTRAL TV   PANEL CENTRAL TV   CENTRAL TV PANEL	1358 x 305 x 12	1	B	160001003	CAVILHA ESTRIADA 8x20   TARUGO MADERA 8x20 MM   WODDEN DOWL PIN 8x20 MM	8
03	510164003	PAINEL SUPERIOR TV   PANEL SUPERIOR TV   UPPER TV PANEL	1358 x 305 x 12	1	C	160001005	CAVILHA ESTRIADA 8x55   TARUGO MADERA 8x55 MM   WODDEN DOWL PIN 8x55 MM	2
04	510164004	PAINEL SUPERIOR   PANEL SUPERIOR   UPPER PANEL	1358 x 305 x 12	1	D	160001009	ARRUELA TRAVESSA PAREDE   ARANDELA 3/16 15MM   WASHER 3/16 15 MM	4
05	510164005	SUPORTE FIXACAO   SOPORTE FIJACIÓN   FIXING BRACKET	1190 x 162 x 15	2	E	160001034	CHAPA JUNCAO COM 2 FUROs   GRAPAS   STAPLES	12
06	510164006	PRATELEIRA SUPERIOR   ESTANTE SUPERIOR   UPPER SHELF	1354 x 172 x 37	1	F	160002005	GUIA CABO   TAPA PASACABLES   CABLE HIDDEN COVER	1
07	510164007	TRAVESSA APOIO   DIVISIÓN APOYO   SUPPORT DIVISION	906 x 80 x 15	1	G	160002006	BUCHA 8MM   TACOS 8MM   ANCHOR 8MM	4
08	510164008	TRAVESSA PAINEL   DIVISIÓN PANEL   PANEL DIVISION	906 x 70 x 15	1	H	160002012	GIZ DE CORRECAO   TIZA DE CORRECCION   CRAYON REPAIR	2
09	510164009	TRAVESSA PAREDE   DIVISIÓN PARED DEL NICH0   WALL DIVISION	906 x 70 x 15	1	I	160006008	PARAFUSO 4.5X25 CABECA CHATA   TORNILLO CABEZA PLANA 4.5X25   FLAT HEAD SCREW 4.5X25	68
10	510164010	PAINEL LATERAL   PANEL LATERAL   PANEL SIDE	1220 x 400 x 15	2	J	160006010	PARAFUSO 4.5X50 CABECA CHATA   TORNILLO CABEZA PLANA 4.5X50   FLAT HEAD SCREW 4.5X50	7
12	510164012	TRAVESSA APOIO CENTRAL   DIVISIÓN APOYO CENTRAL   SUPPORT CENTRAL DIVISION	150 x 70 x 15	2	K	160006015	PARAFUSO 6,0x75 CABECA CHATA   TORNILLO CABEZA PLANA 6,0x75   FLAT HEAD SCREW 6,0x75	4
					L	160006016	PARAFUSO 3,5X12 CABECA FLANGEADA   TORNILLO CABEZA BRIDA 3.5X12   FLANGE HEAD SCREW 3.5X12	24

mm

0

10

20

30

40

50

60

70

80

90

100

110

120

130



01

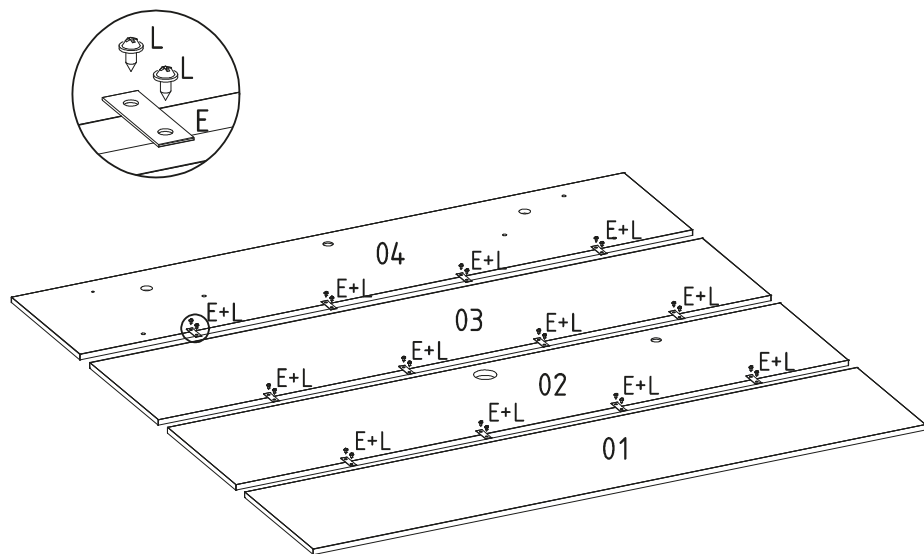

E 12

L 24

02

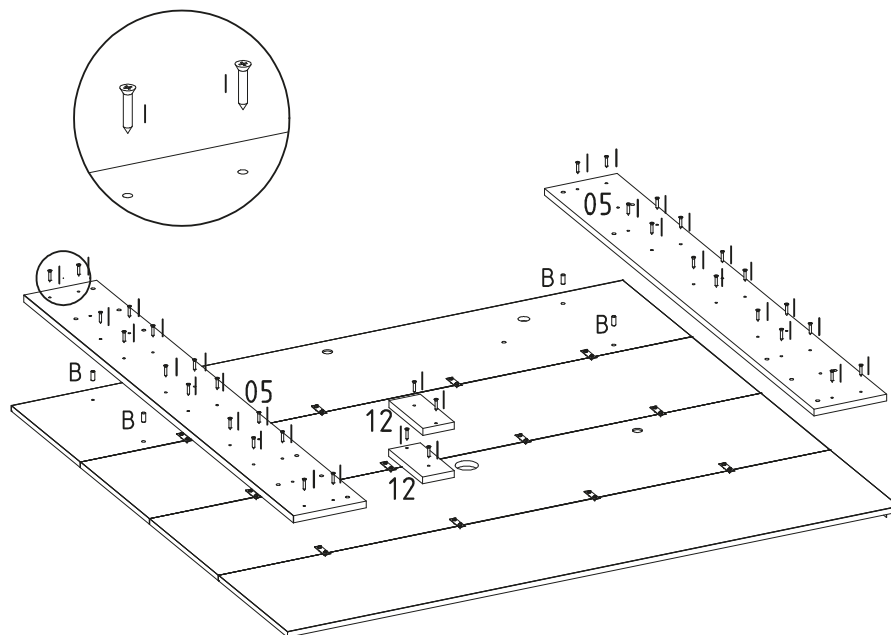

B 04

I 36

03

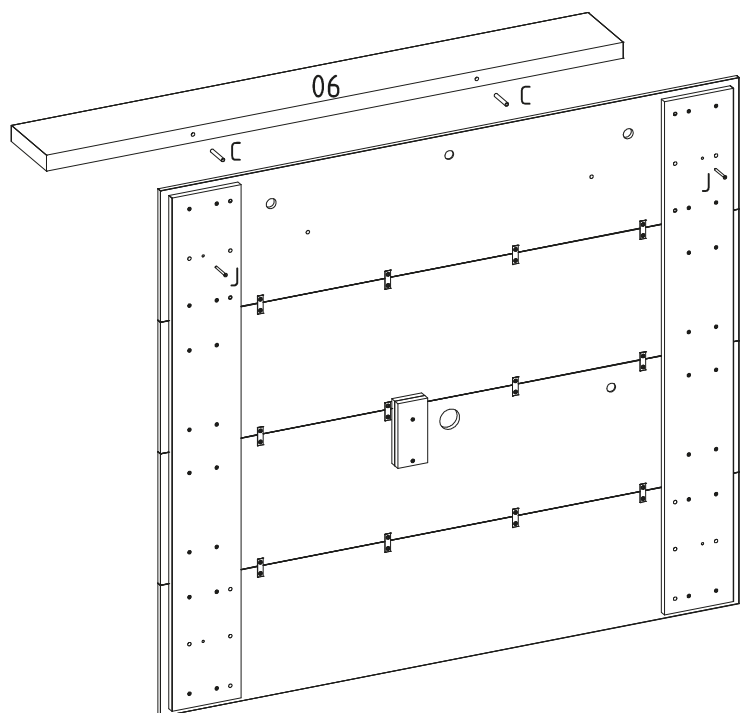

C 02

J 02

04

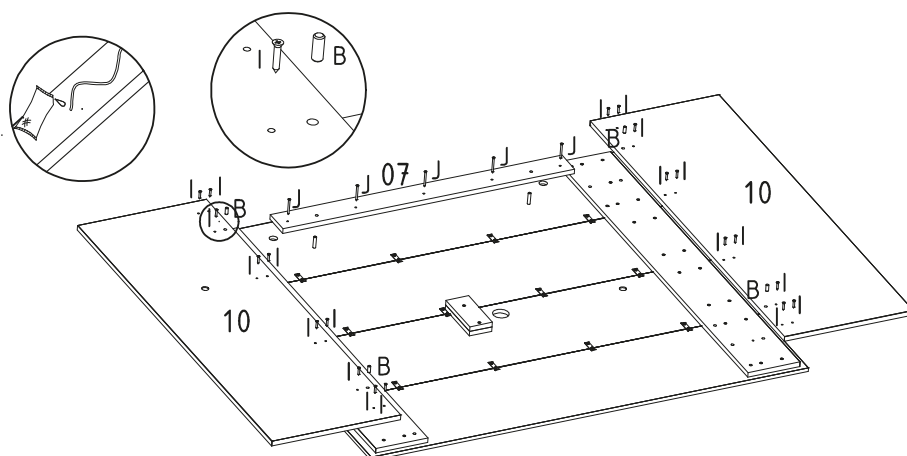
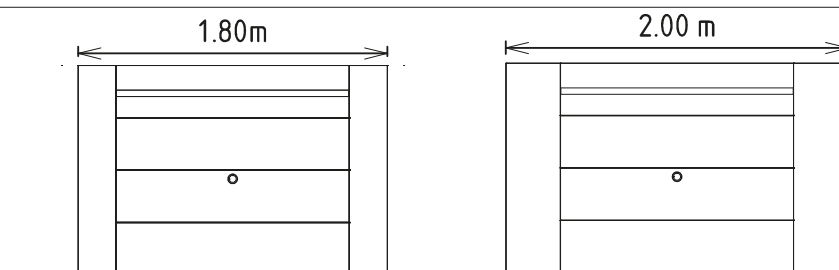

B 04

I 20

J 05

05

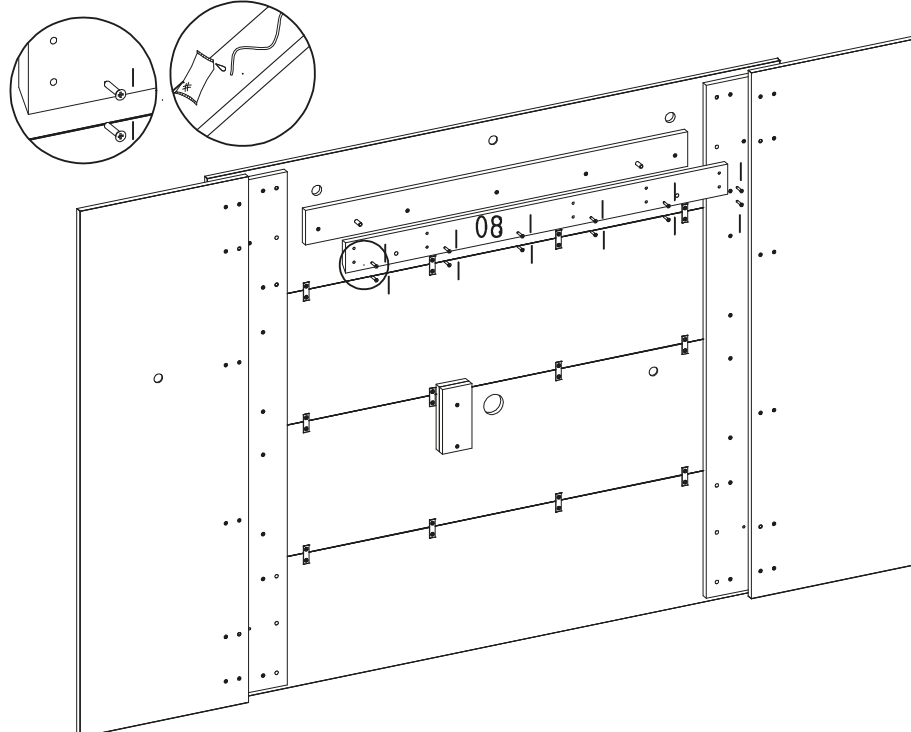

I 12

06

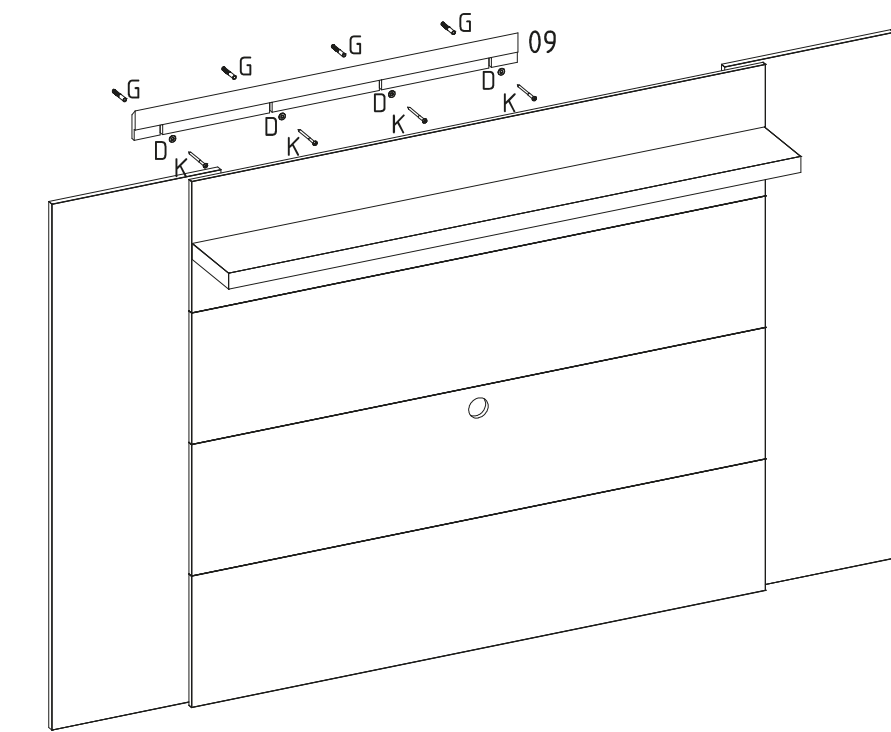

D 04

G 04

K 04

07

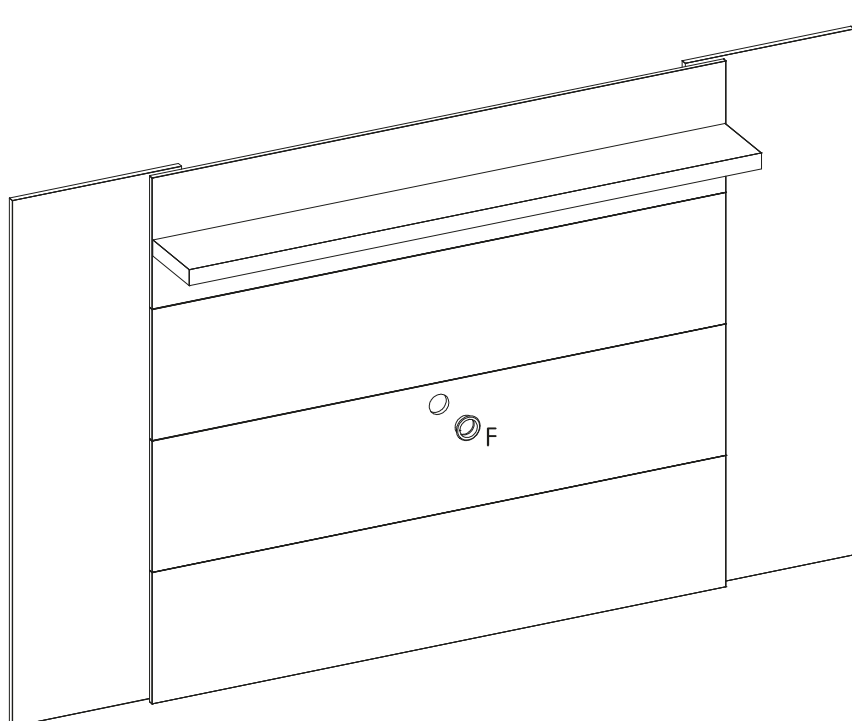

F 01

