

ARTEMOBILI

móveis com encaixe perfeito

Rack Flat

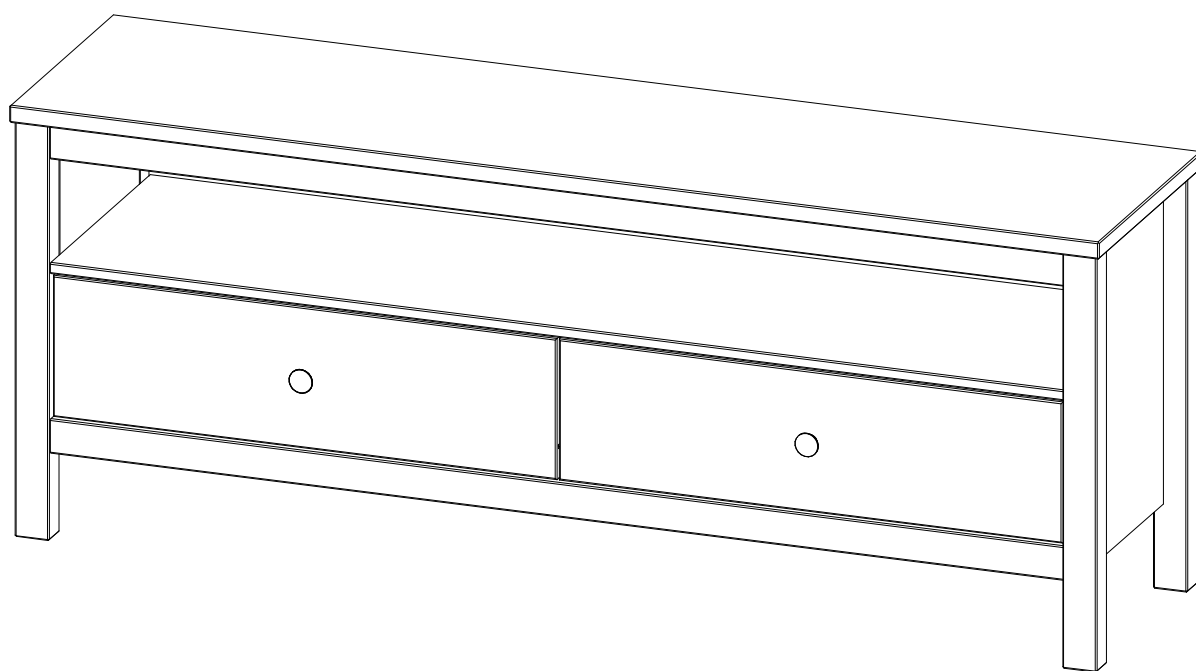

Identificação das Peças

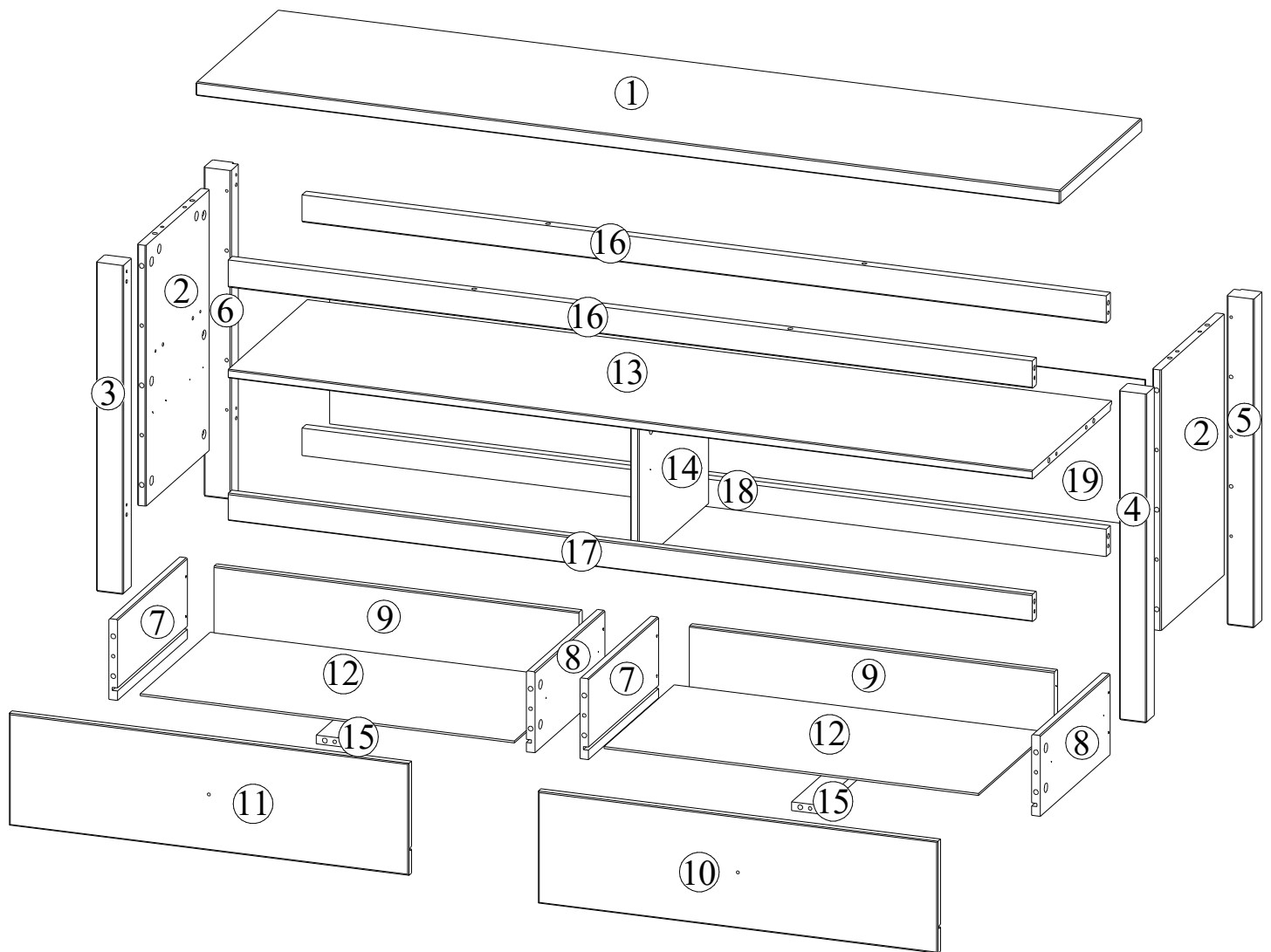

Partes do Produto

1	Tampo	(1x) - 1400 x 350 x 22
2	Pé Frontal Esquerdo	(1x) - 529 x 36 x 44
3	Pé Frontal Direito	(1x) - 529 x 36 x 44
4	Pé Traseiro Direito	(1x) - 529 x 36 x 44
5	Pé Traseiro Esquerdo	(1x) - 529 x 36 x 44
6	Lateral	(2x) - 419 x 273 x 14
7	Lateral esquerda de gaveta	(2x) - 130 x 300 x 14
8	Lateral direita da gaveta	(2x) - 130 x 300 x 14
9	Costa de gaveta	(2x) - 127 x 591 x 14
10	Frente direita da gaveta	(1x) - 647 x 180 x 14
11	Frente esquerda da gaveta	(1x) - 647 x 180 x 14
12	Fundo de gaveta	(2x) - 606 x 300 x 3
13	Prateleira	(1x) - 1302 x 340 x 14
14	Divisória	(1x) - 224 x 299 x 14
15	Travessa da gaveta	(2x) - 286 x 44 x 14
16	Travessa Superior	(2x) - 1302 x 44 x 18
17	Travessa Inferior	(1x) - 1302 x 44 x 18
18	Travessa Inferior Traseira	(1x) - 1302 x 44 x 18
19	Fundo	(1x) - 1320 x 235 x 3

Identificação das Ferragens

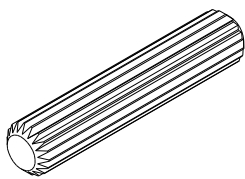

A - Cavilha 6x30 (35x)

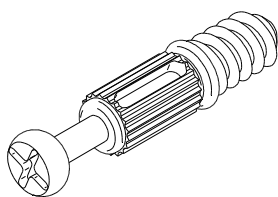

B - Parafuso minifix (46x)

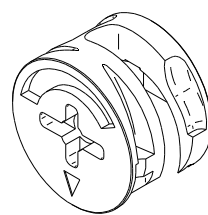

C - Tambor minifix (46x)

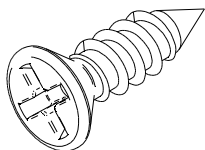

D - Parafuso 3,5x12 CCH (25x)

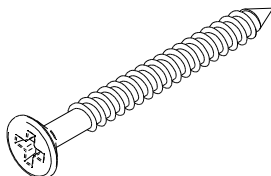

E- Parafuso 3,5x35 CCH (9x)

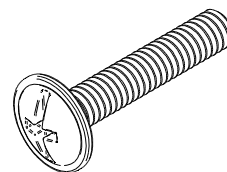

F - Parafuso M4X22 CFLA (2x)

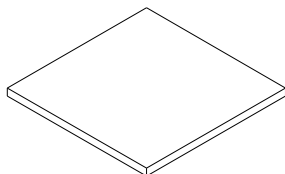

G - Feltro adesivo (4x)

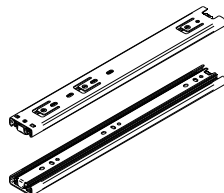

H - Trilho Light (2x)

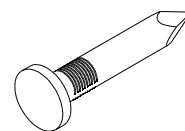

I - Prego 10x7 (26x)

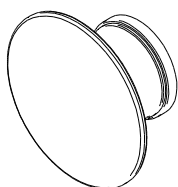

J - Puxador (2x)

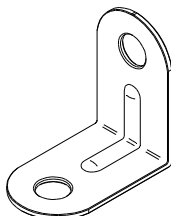

K - Cantoneira metálica (1x)

PASSO 1:

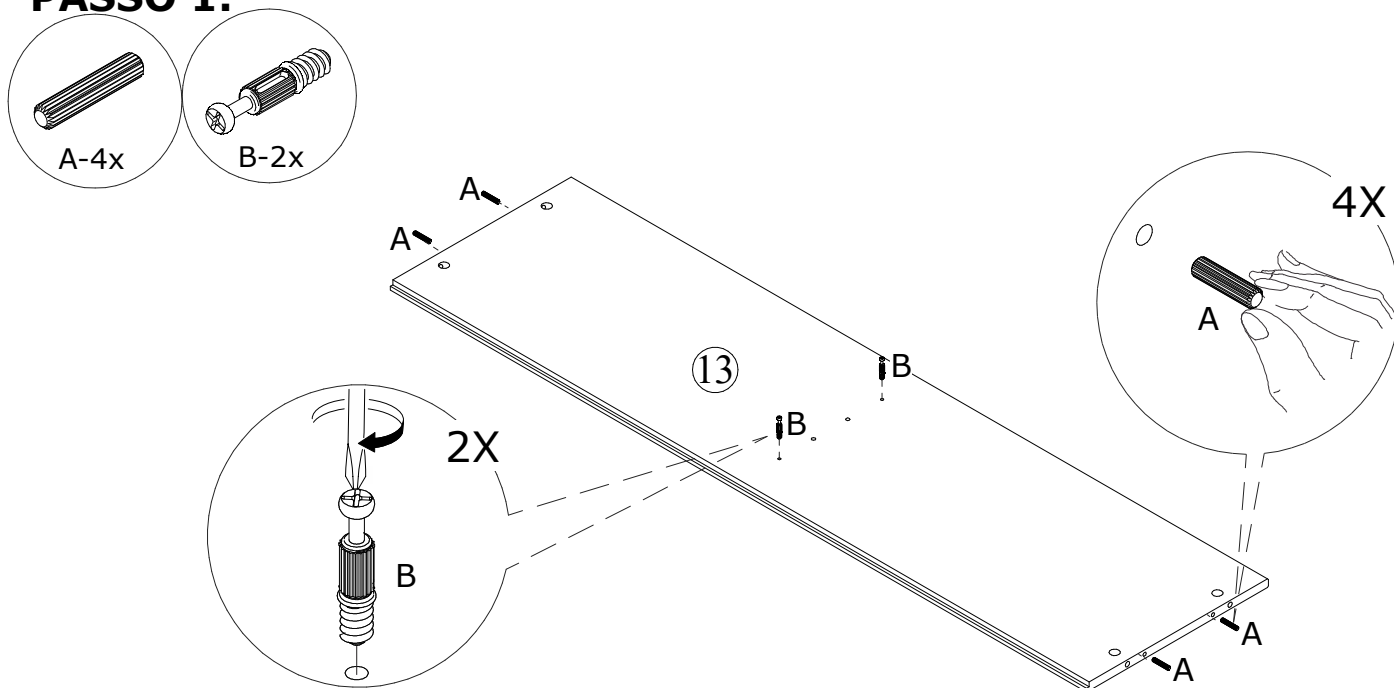

PASSO 2:

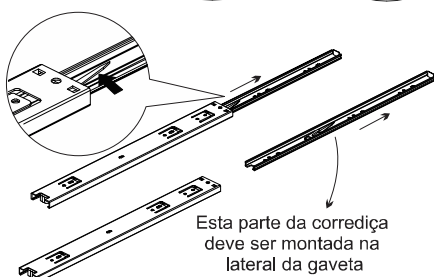
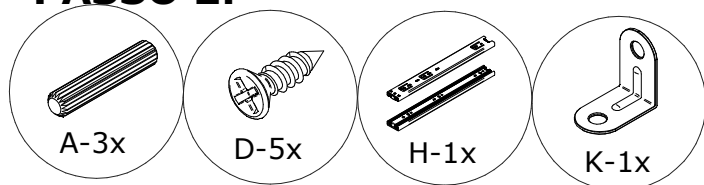

*Para maiores esclarecimentos busque orientação na página 25.

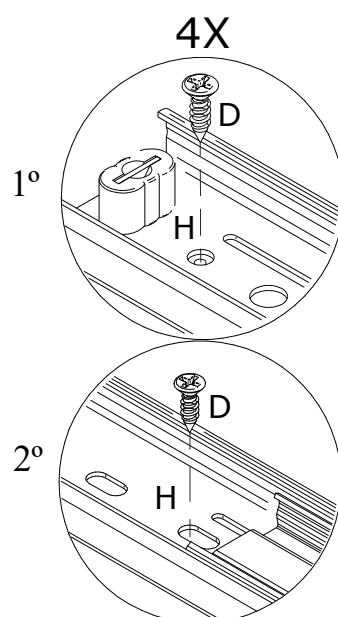
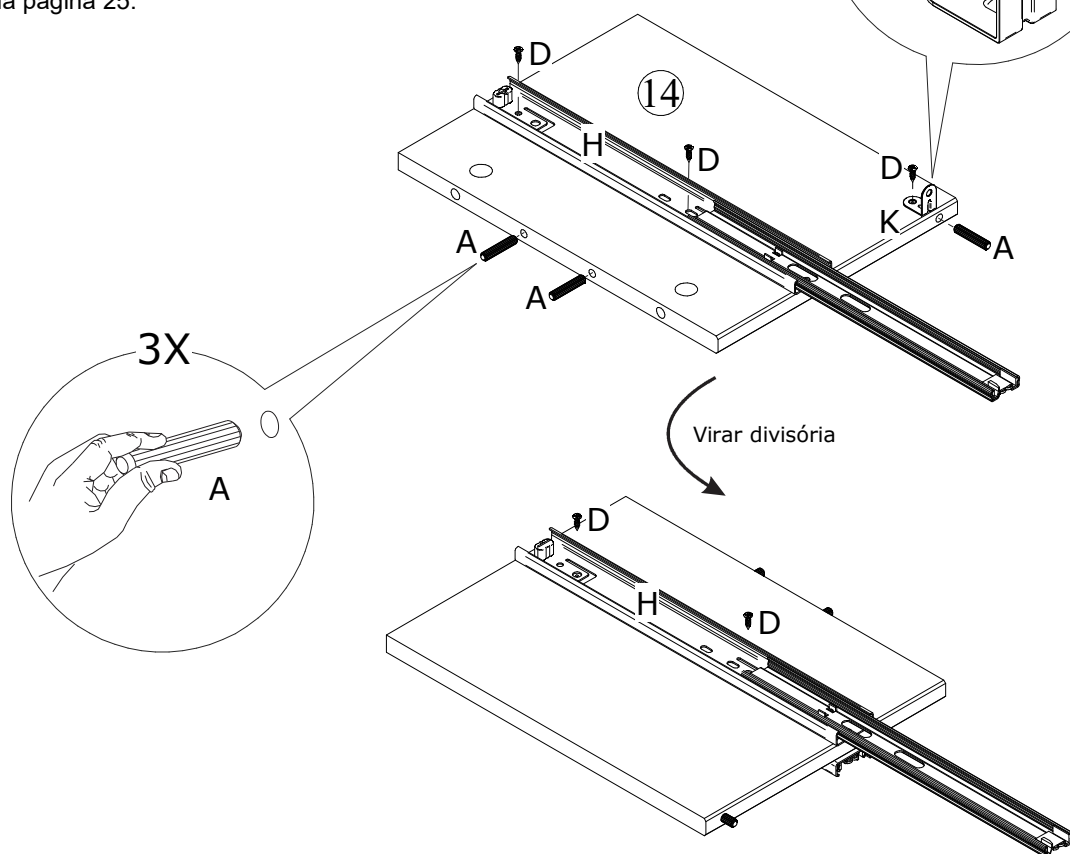
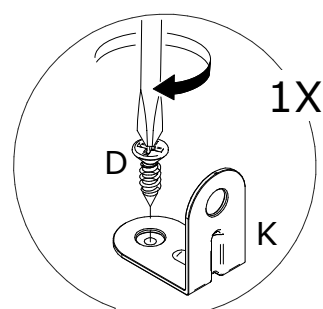

PASSO 3:

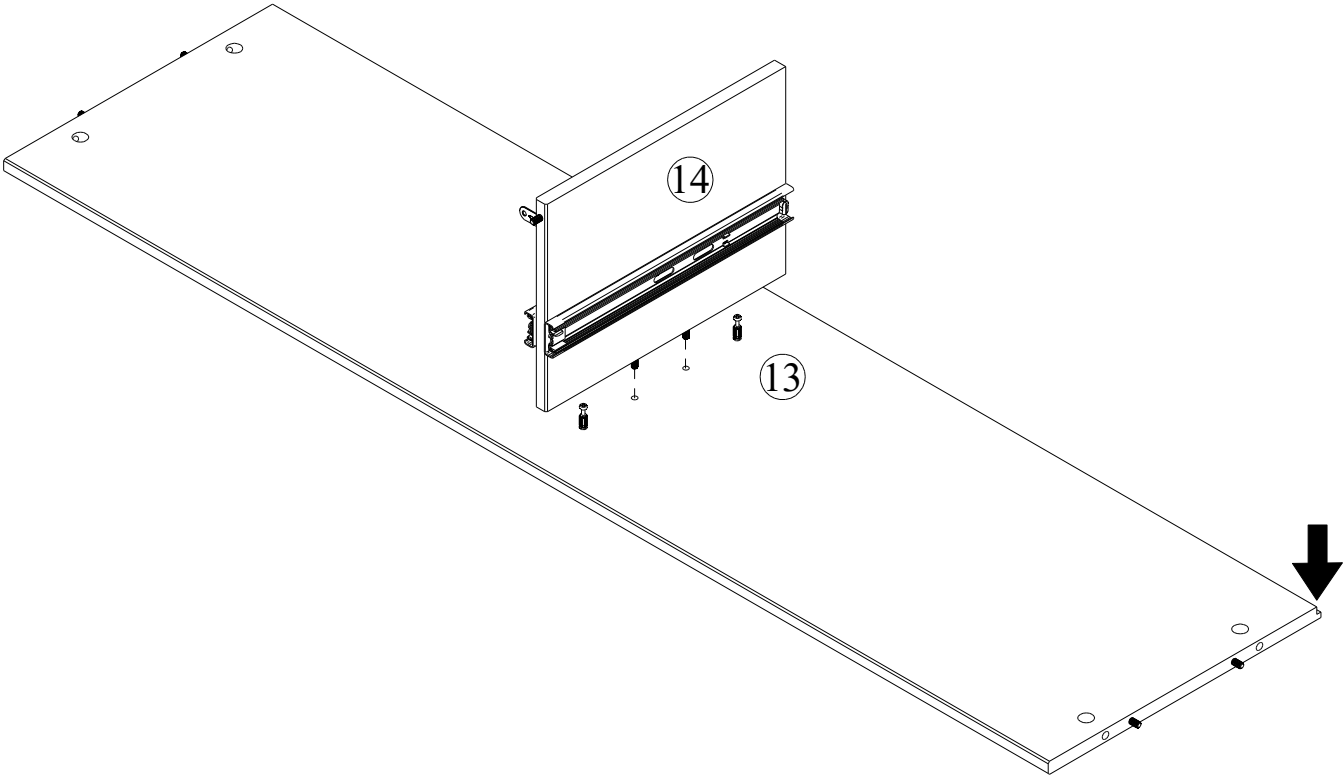

PASSO 4:

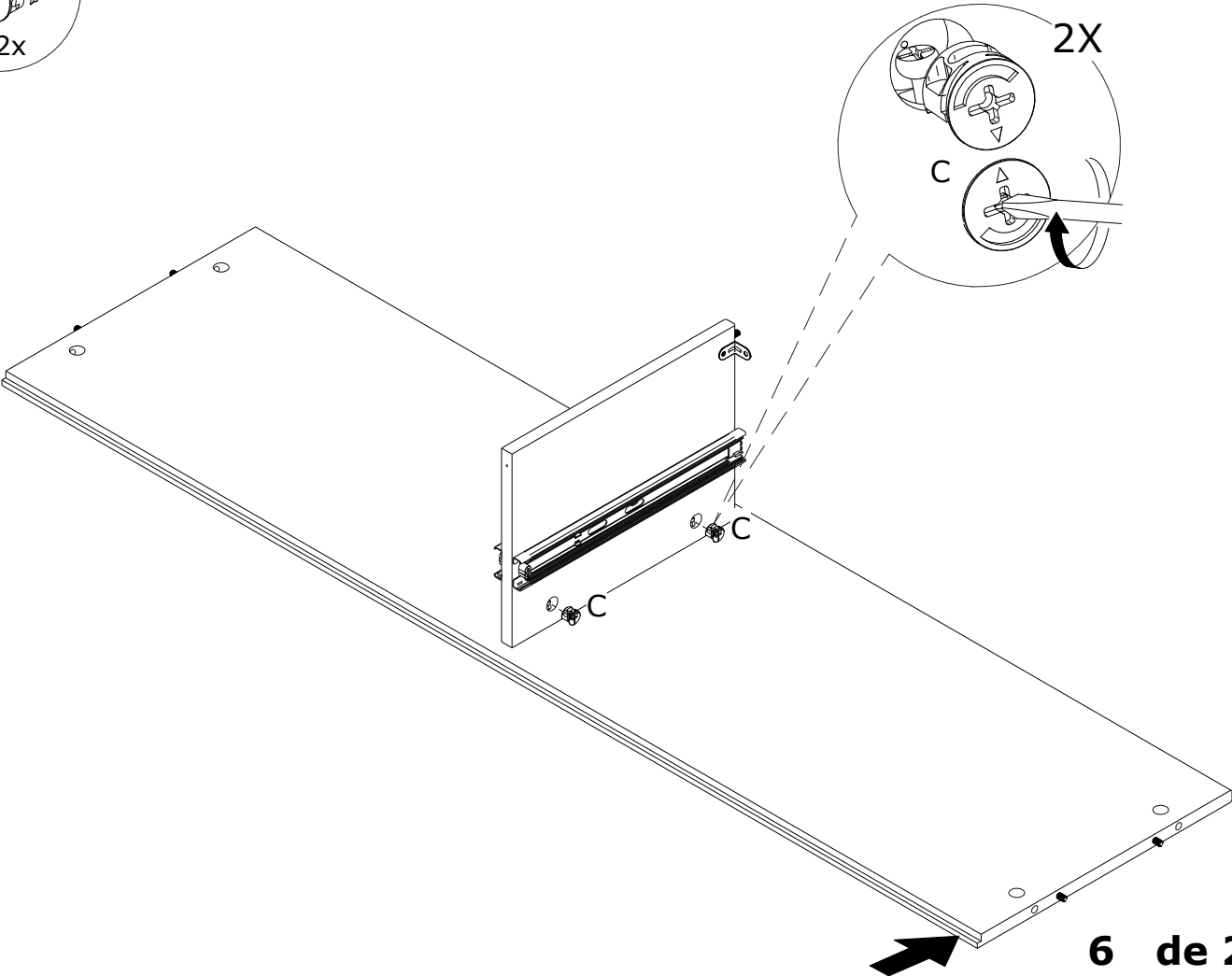

PASSO 5:

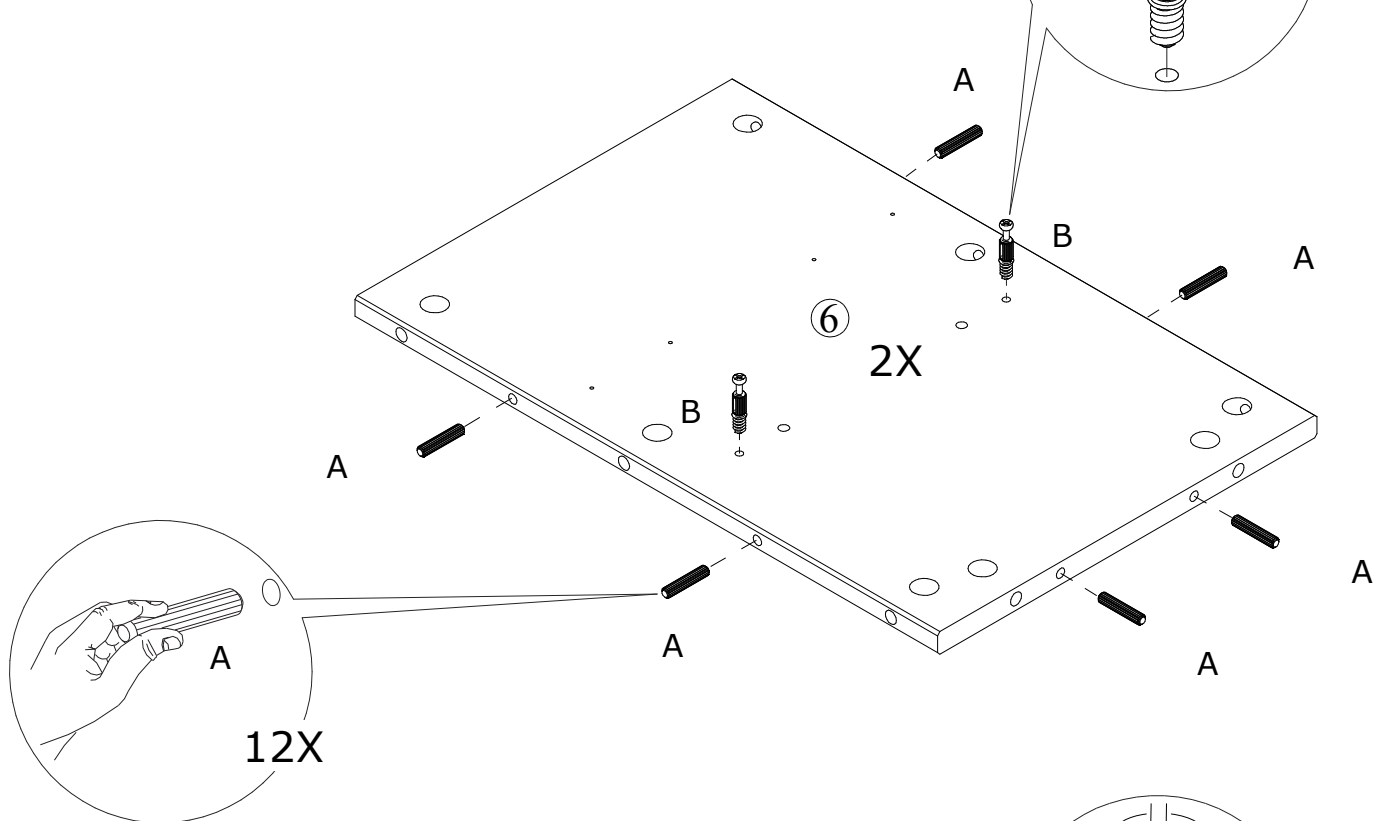
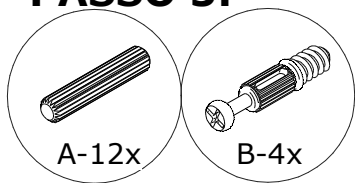

PASSO 6:

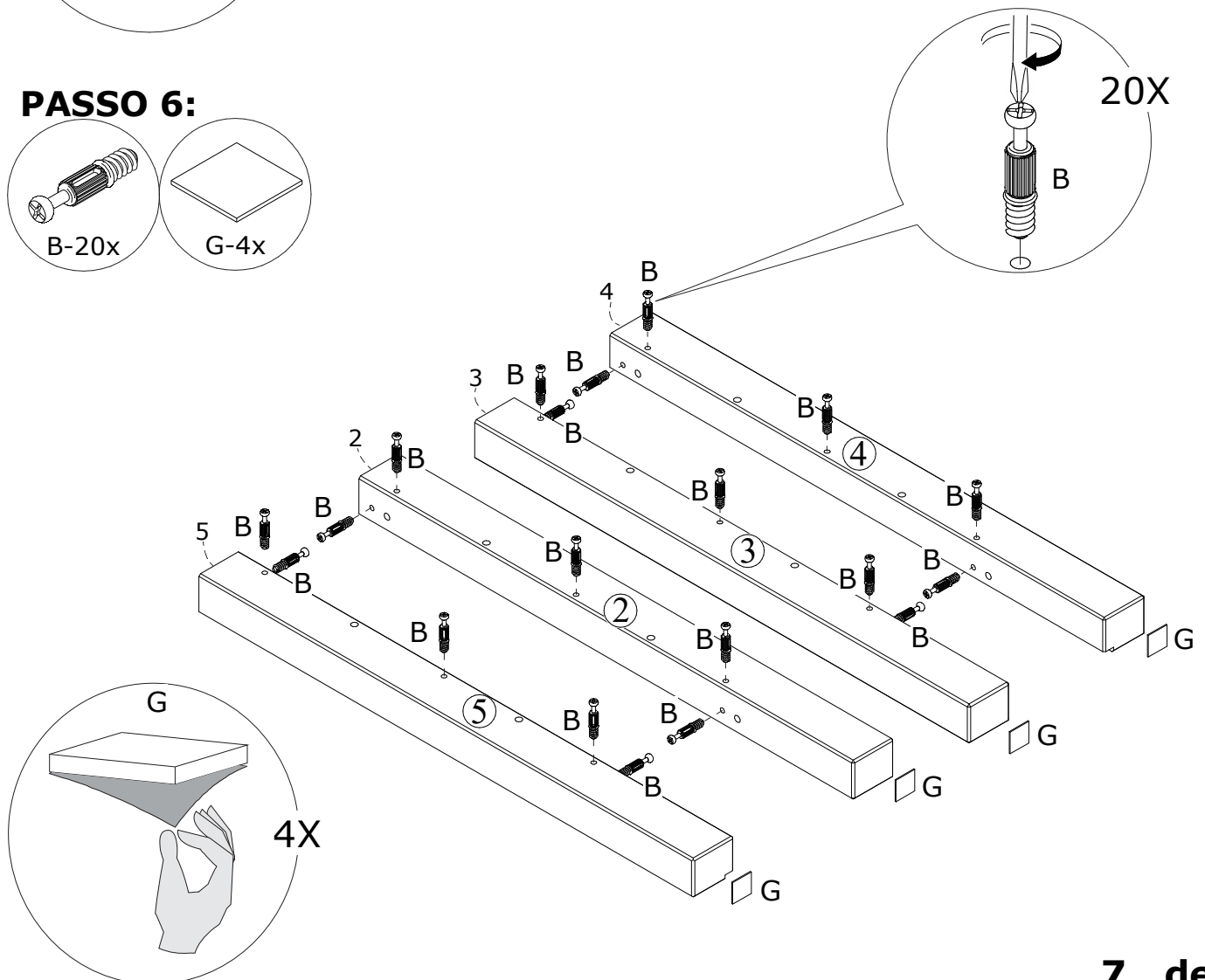
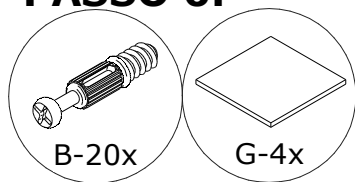

PASSO 7:

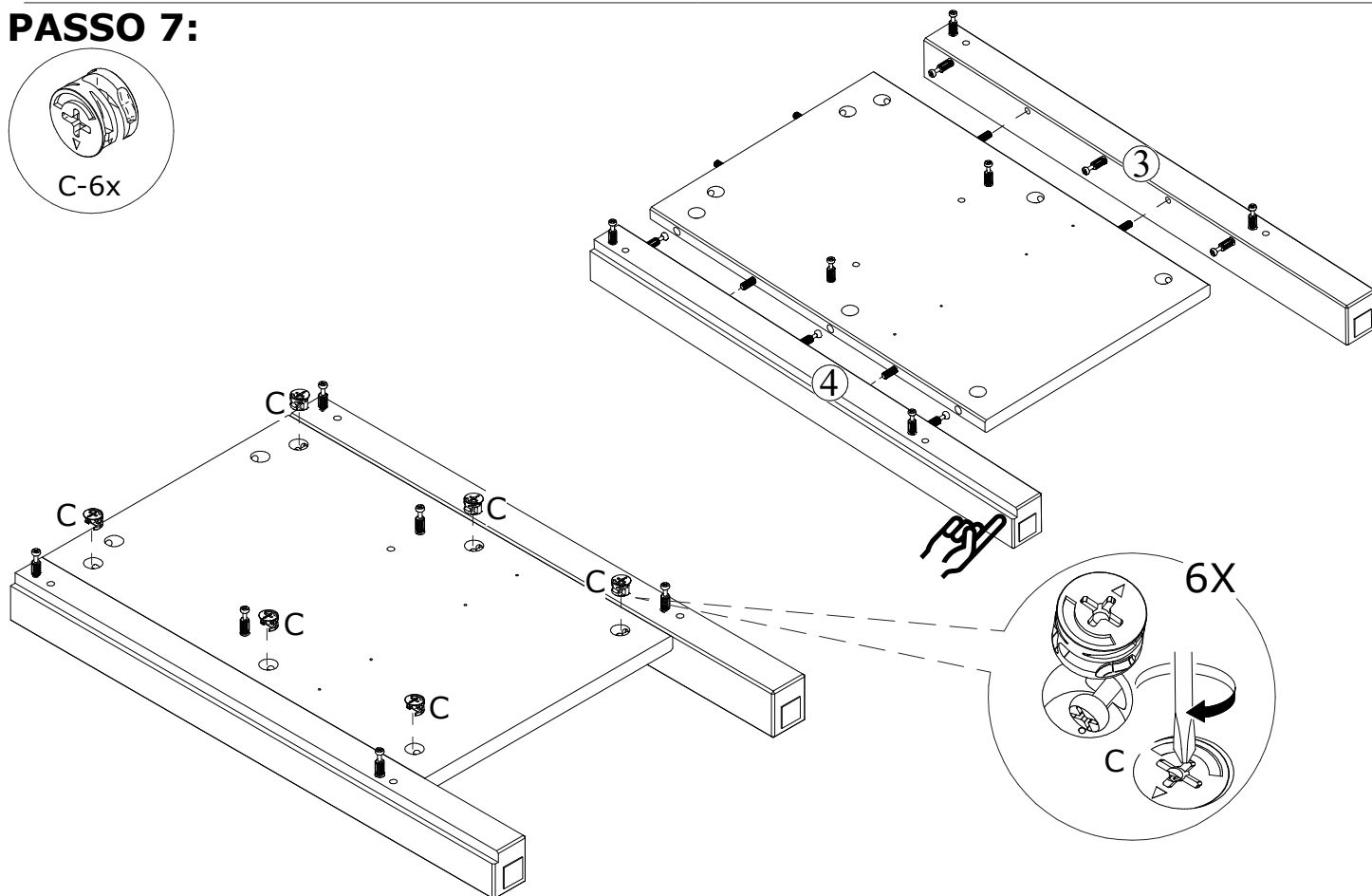
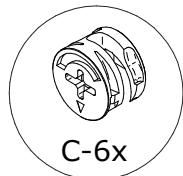

PASSO 8:

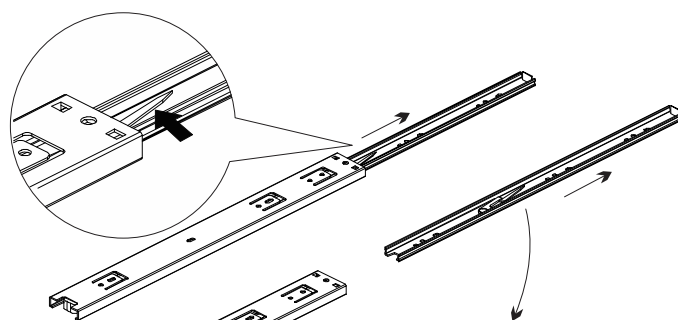
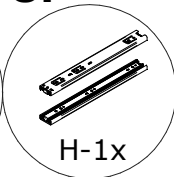
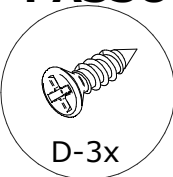

Esta parte da corrediça deve ser montada na lateral da gaveta

*Para maiores esclarecimentos busque orientação na página 25.

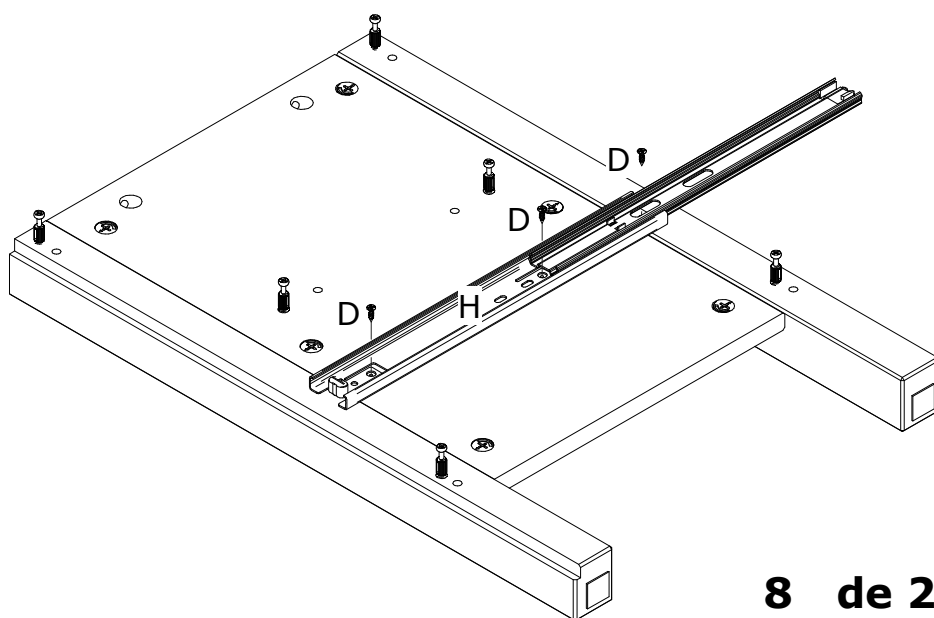
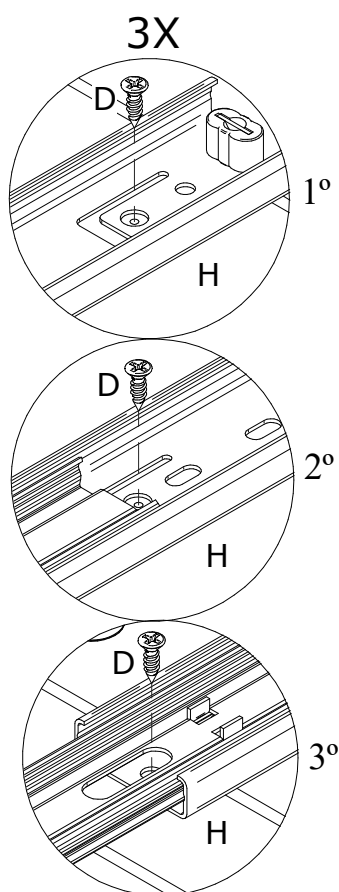

PASSO 9:

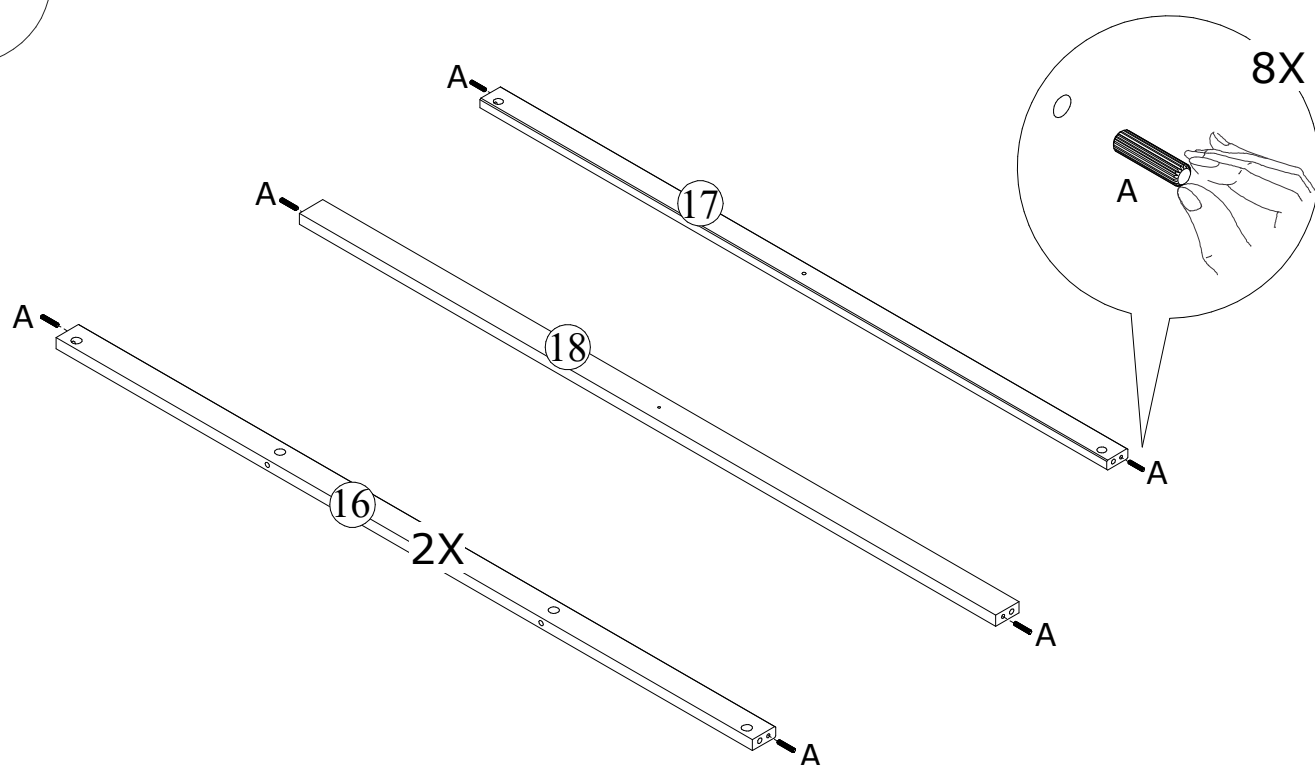
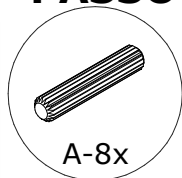

PASSO 10:

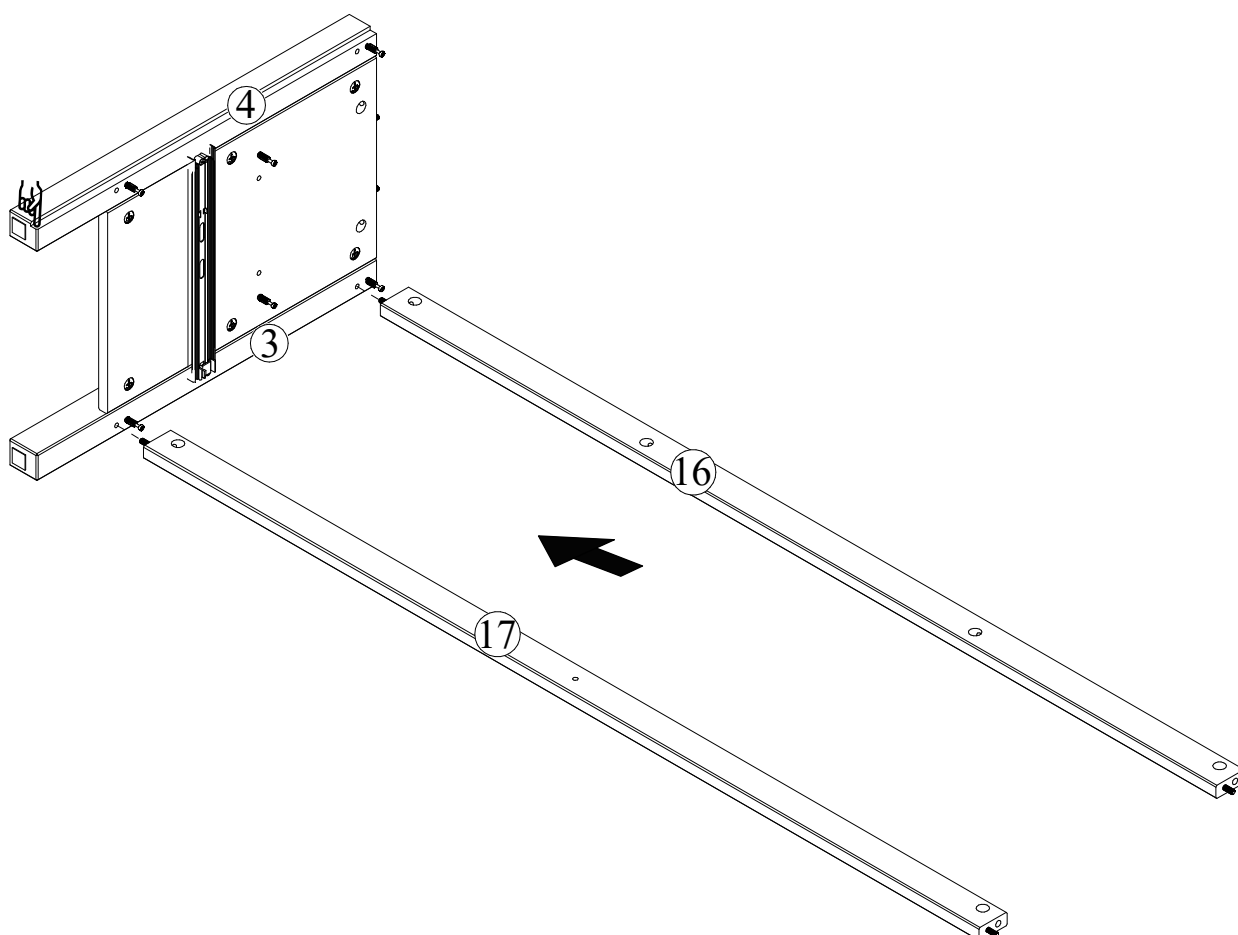

PASSO 11:

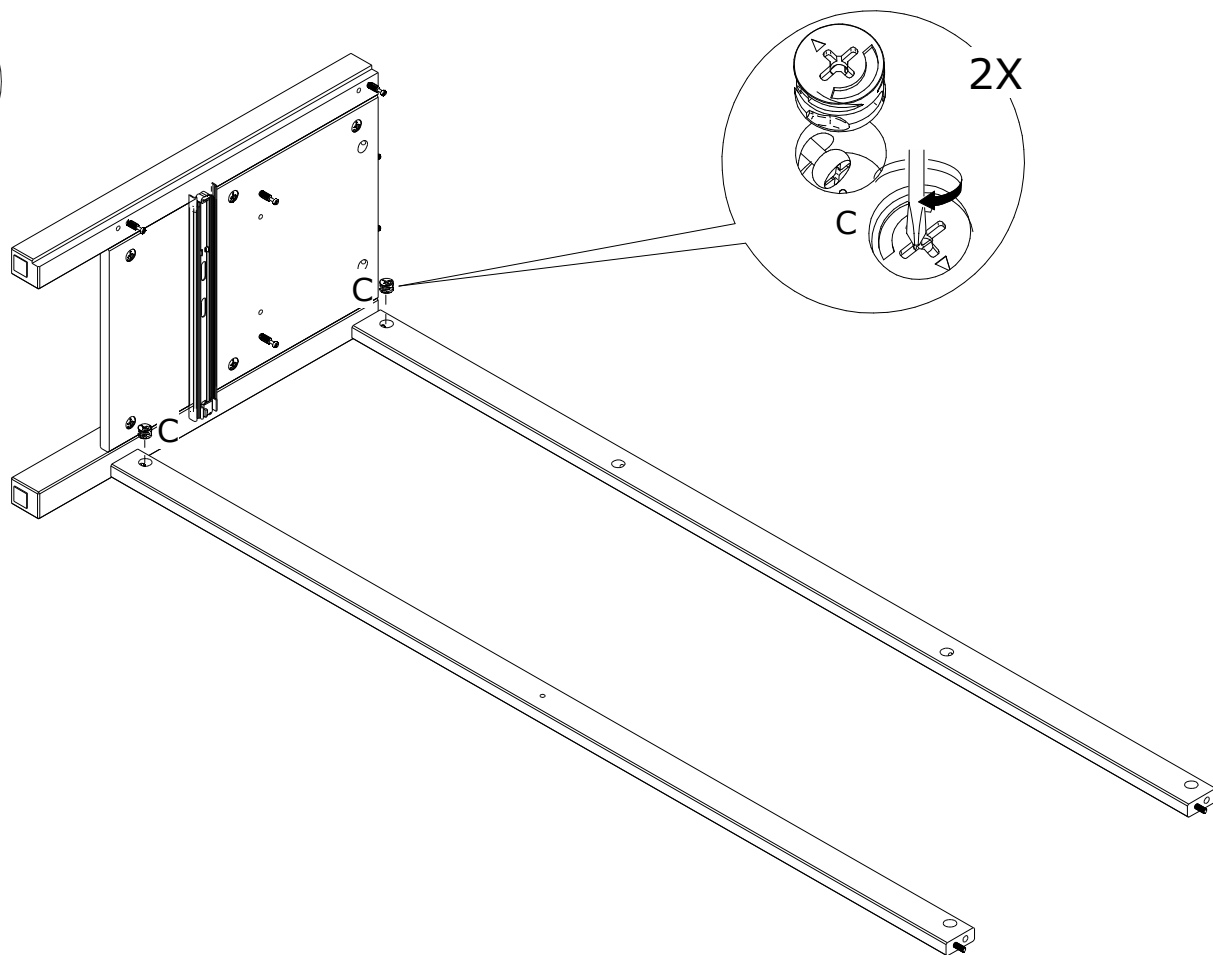
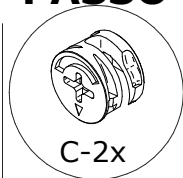

PASSO 12:

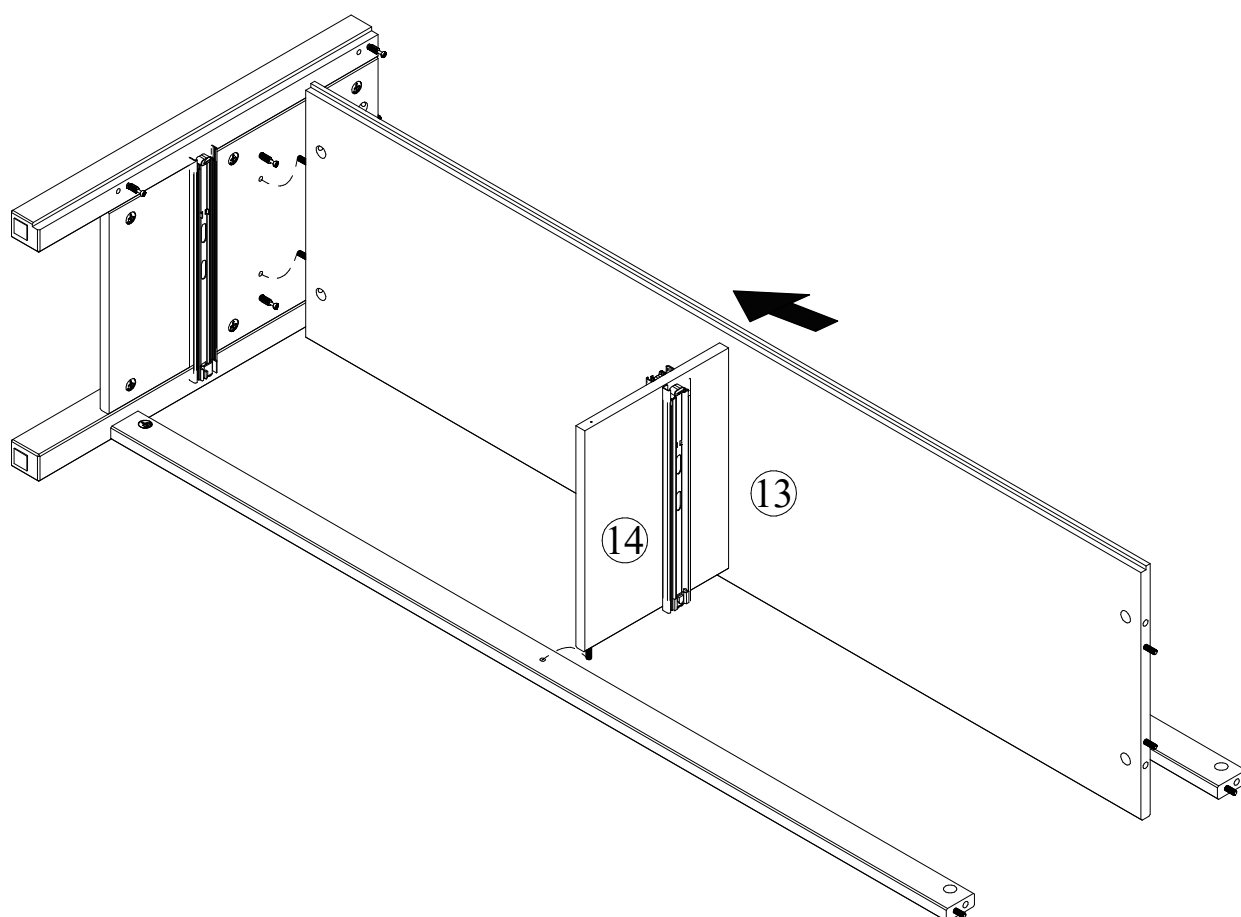

PASSO 13:

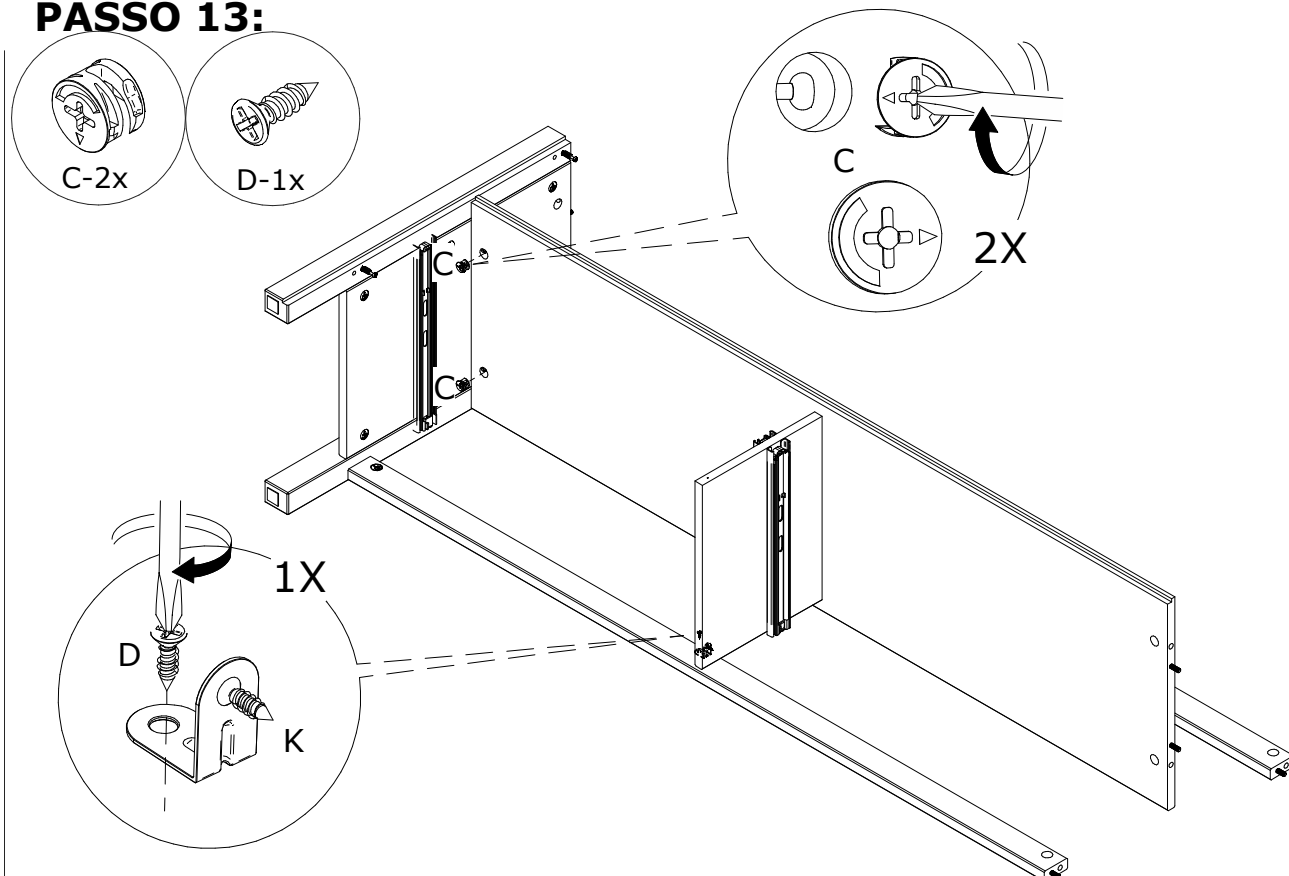

PASSO 14:

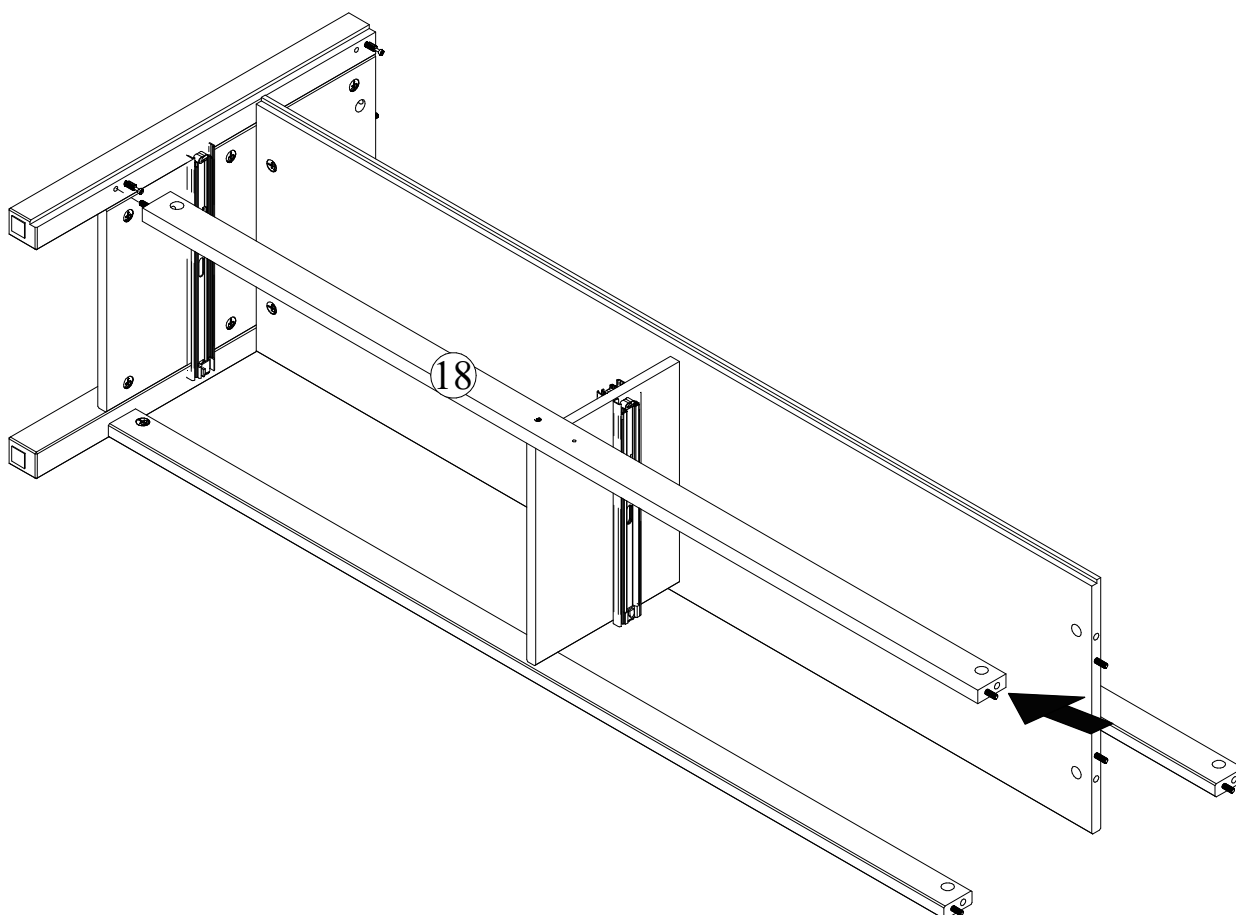

PASSO 15:

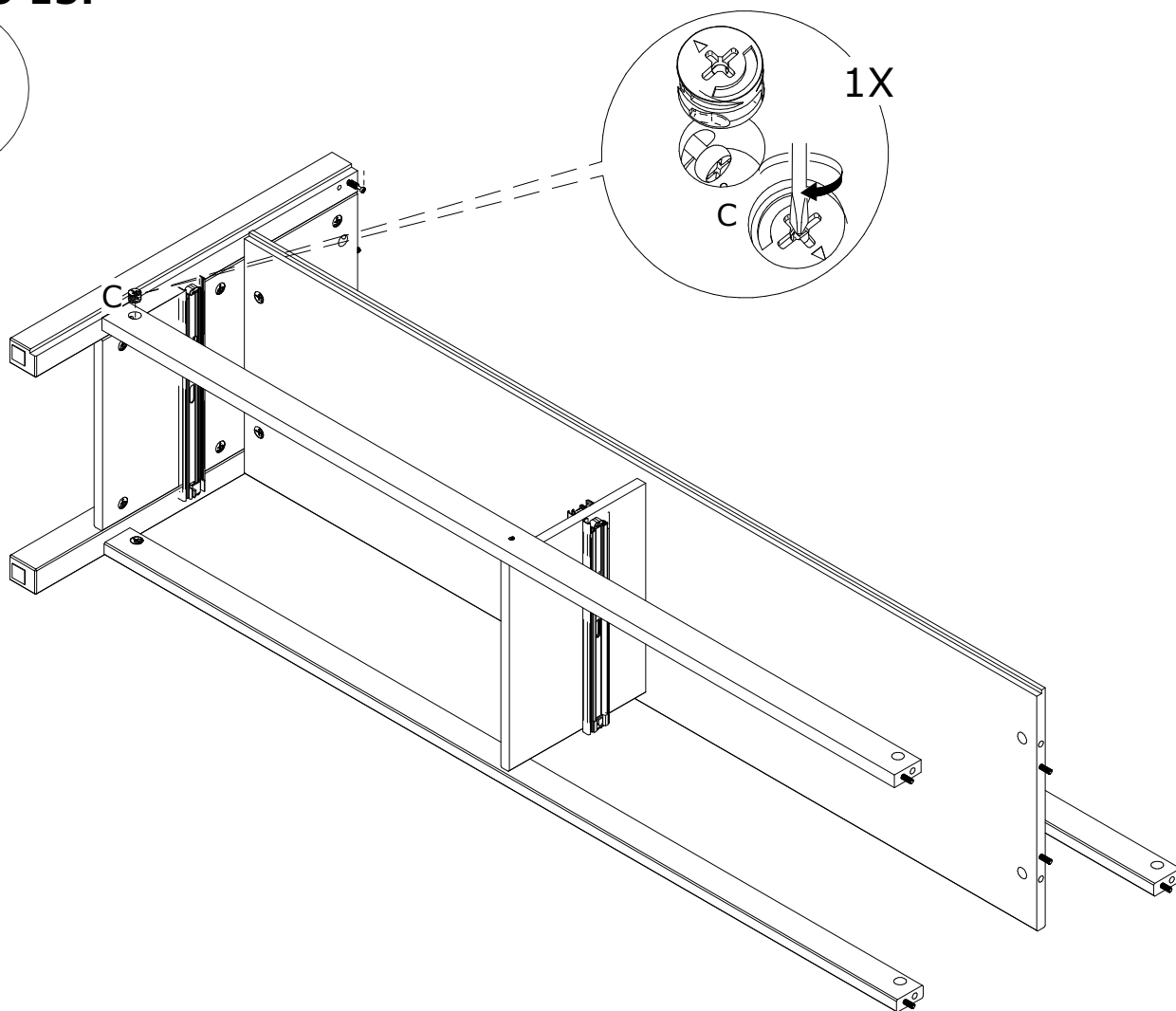

PASSO 16:

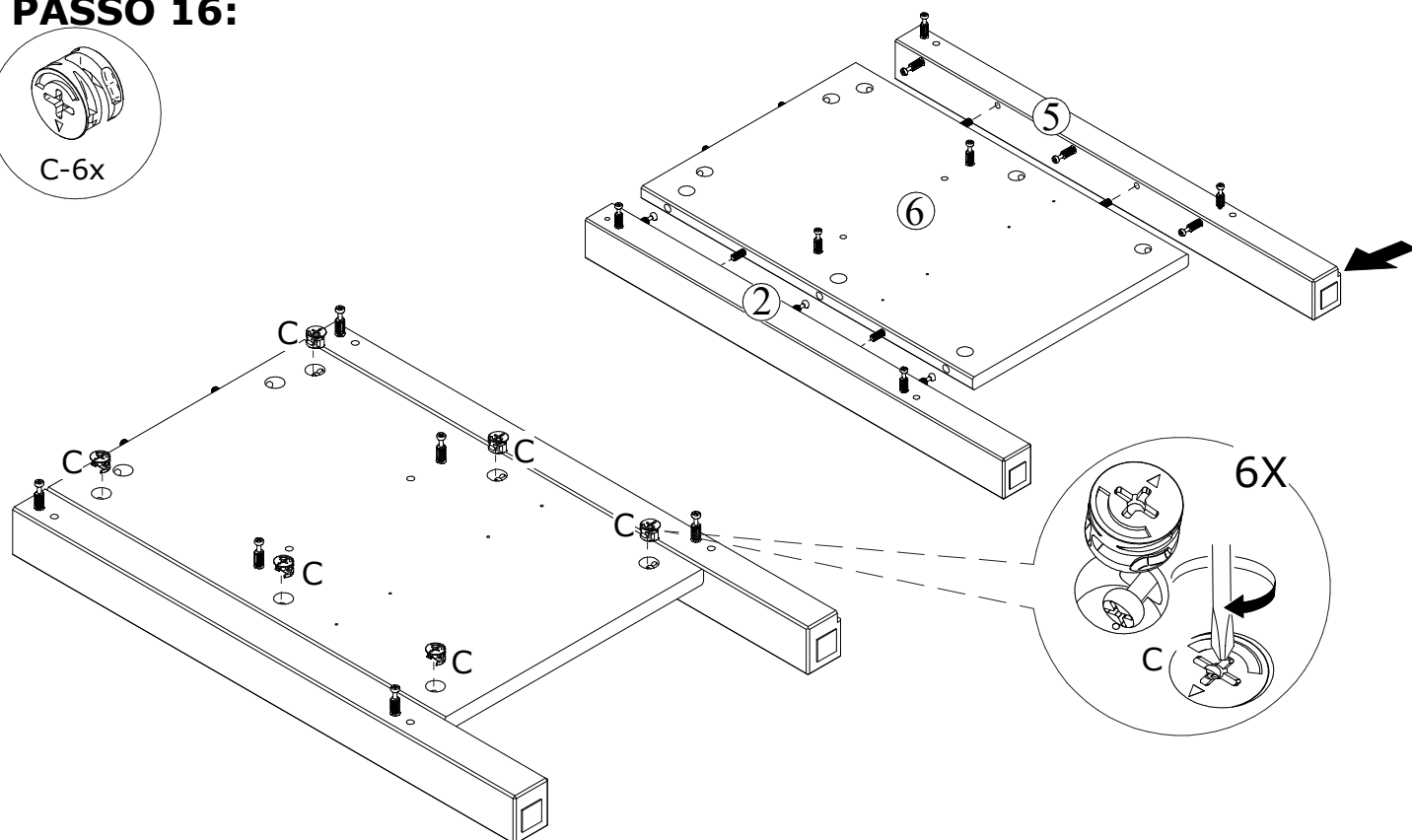
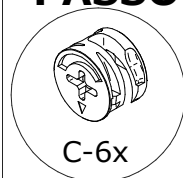

PASSO 17:

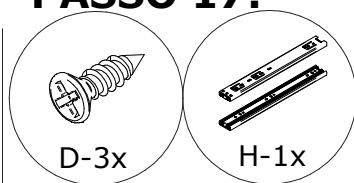

3X

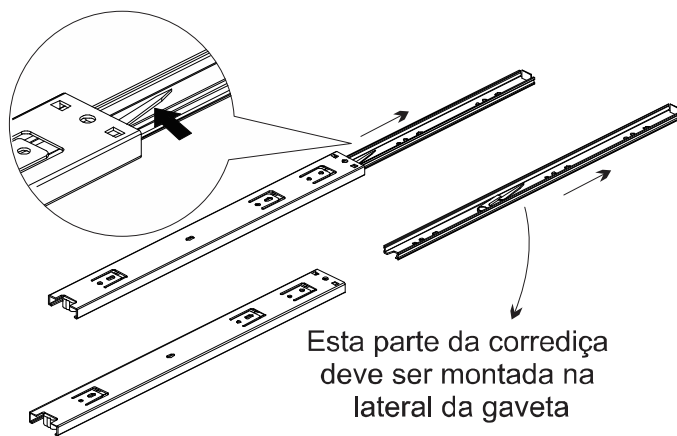
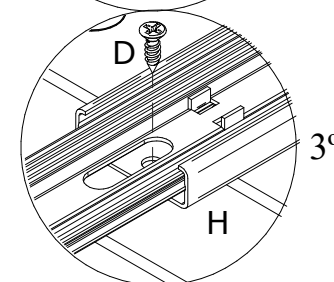
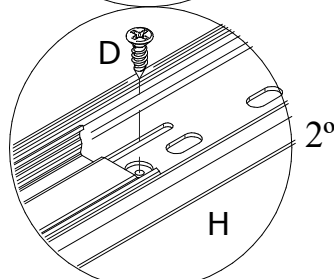
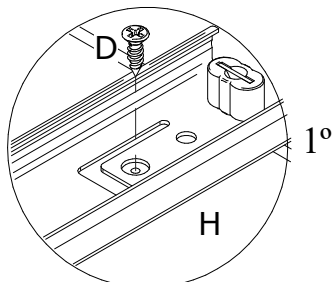

*Para maiores esclarecimentos busque orientação na página 25.

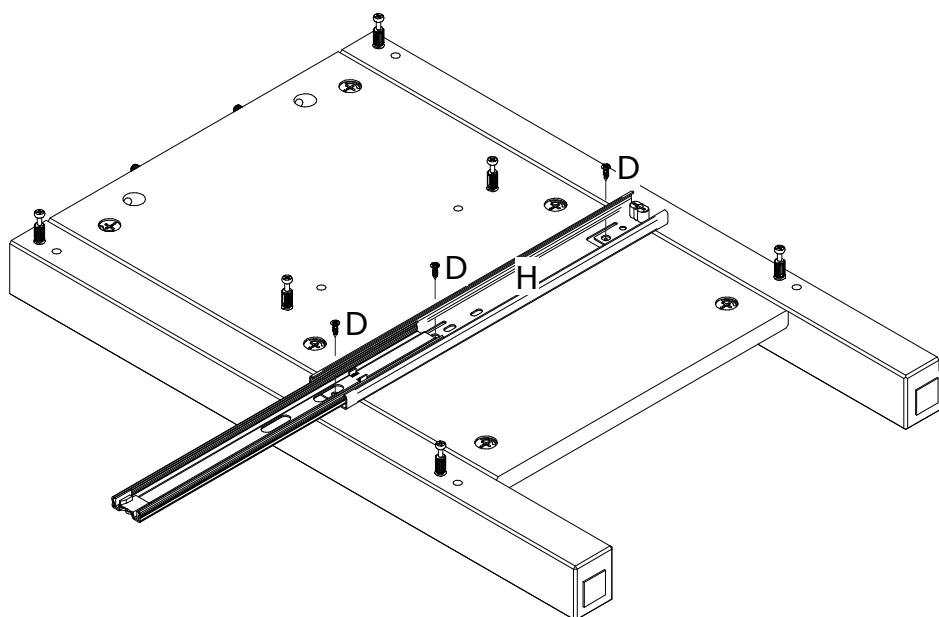

PASSO 18:

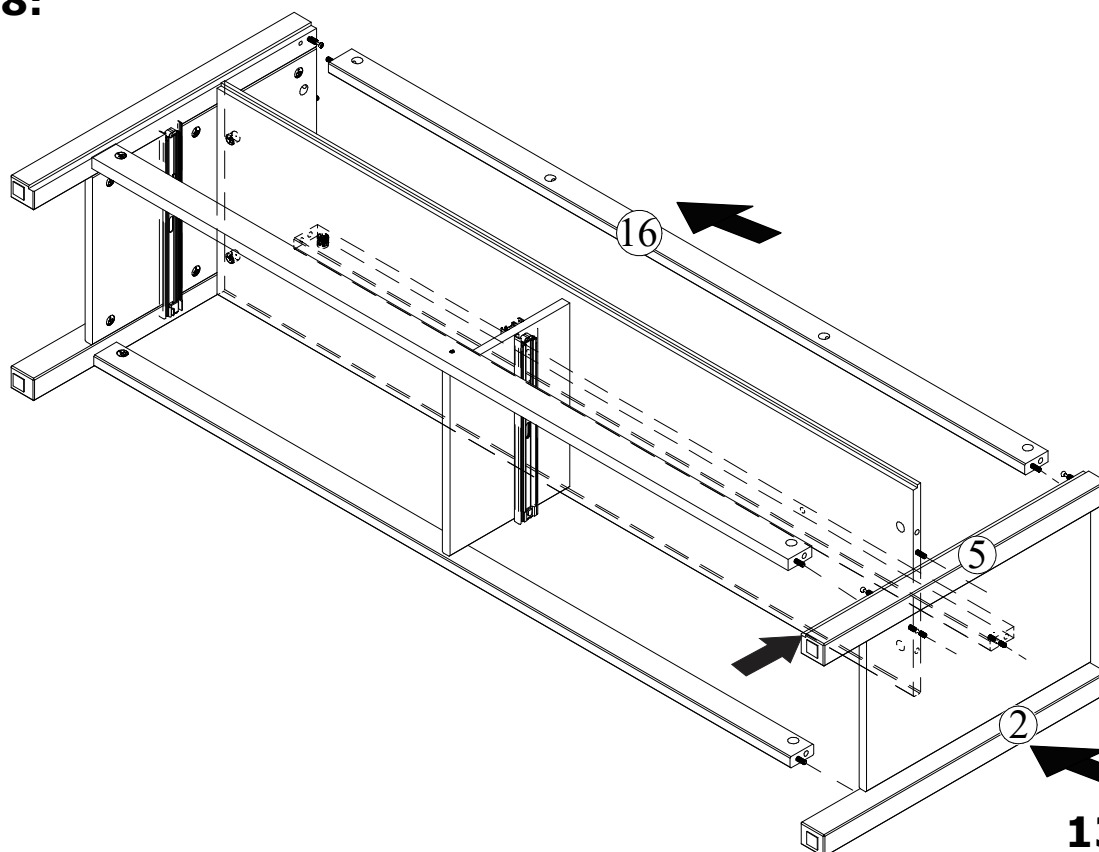

PASSO 19:

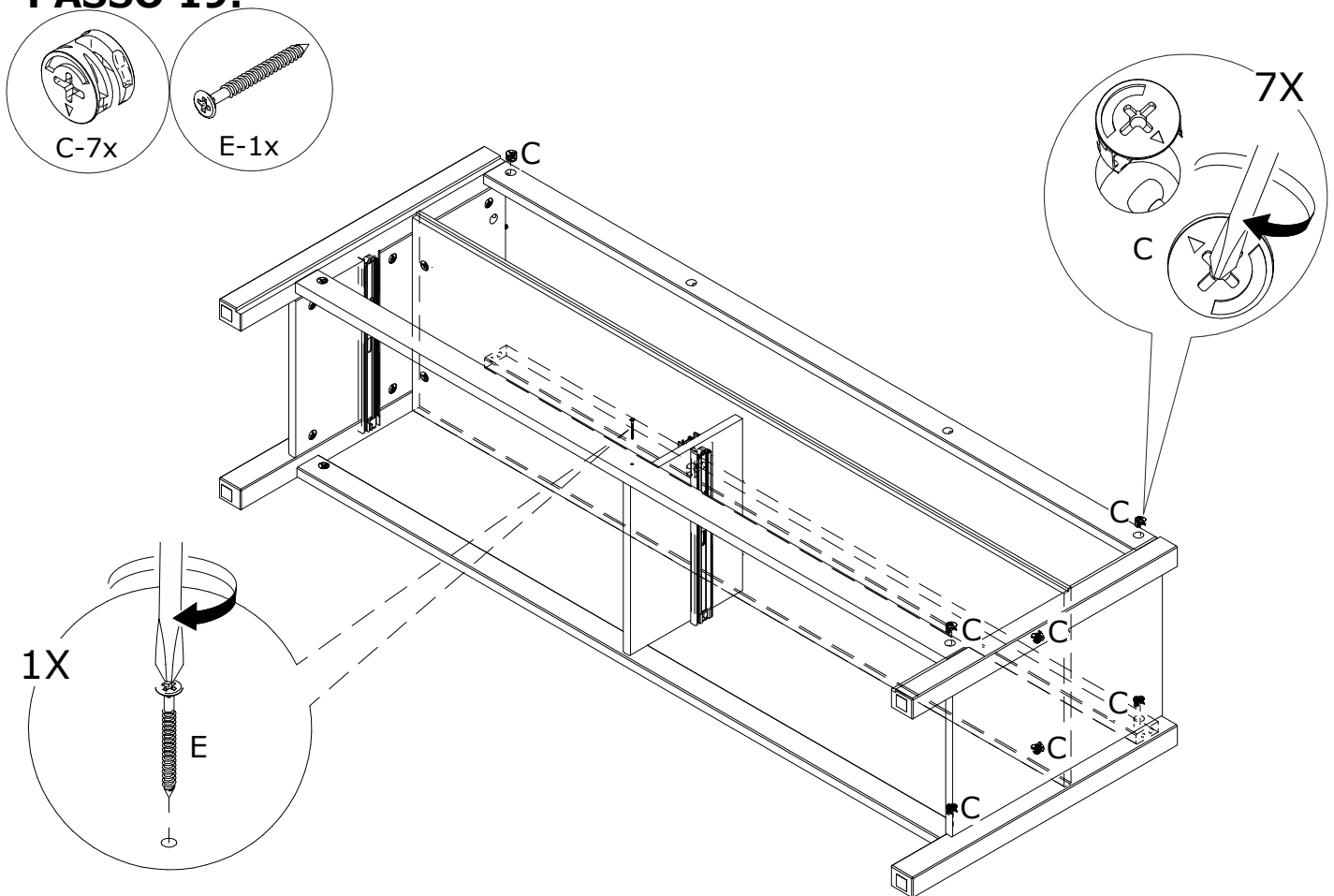

PASSO 20:

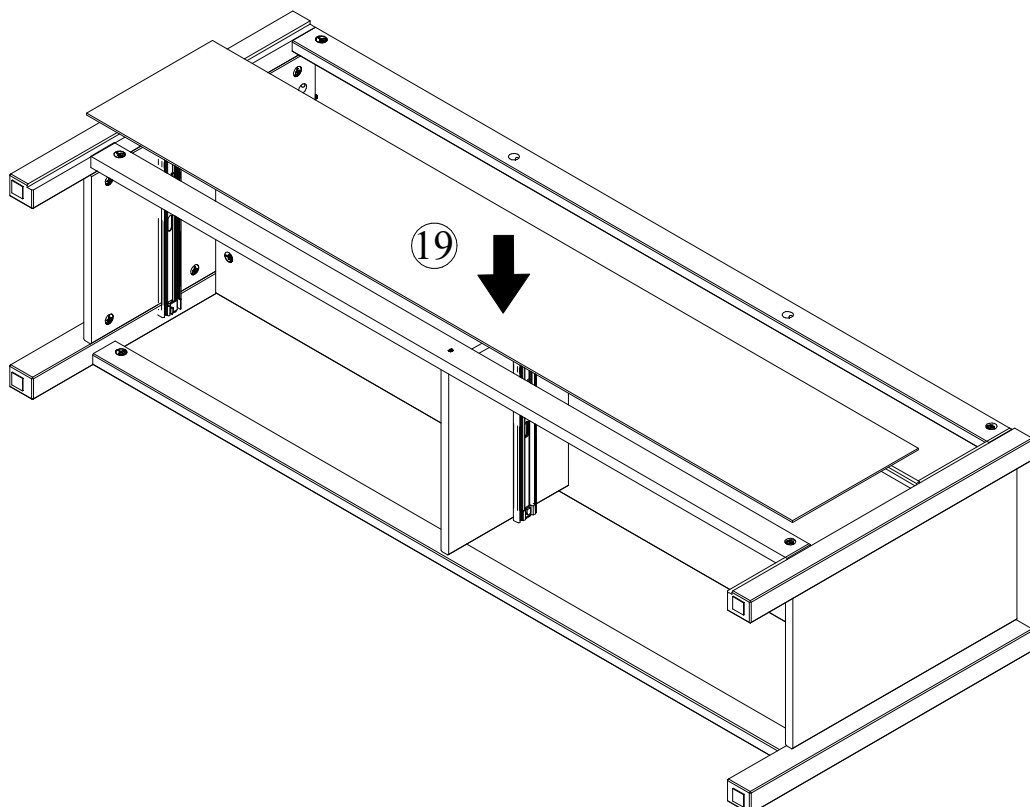

PASSO 21:

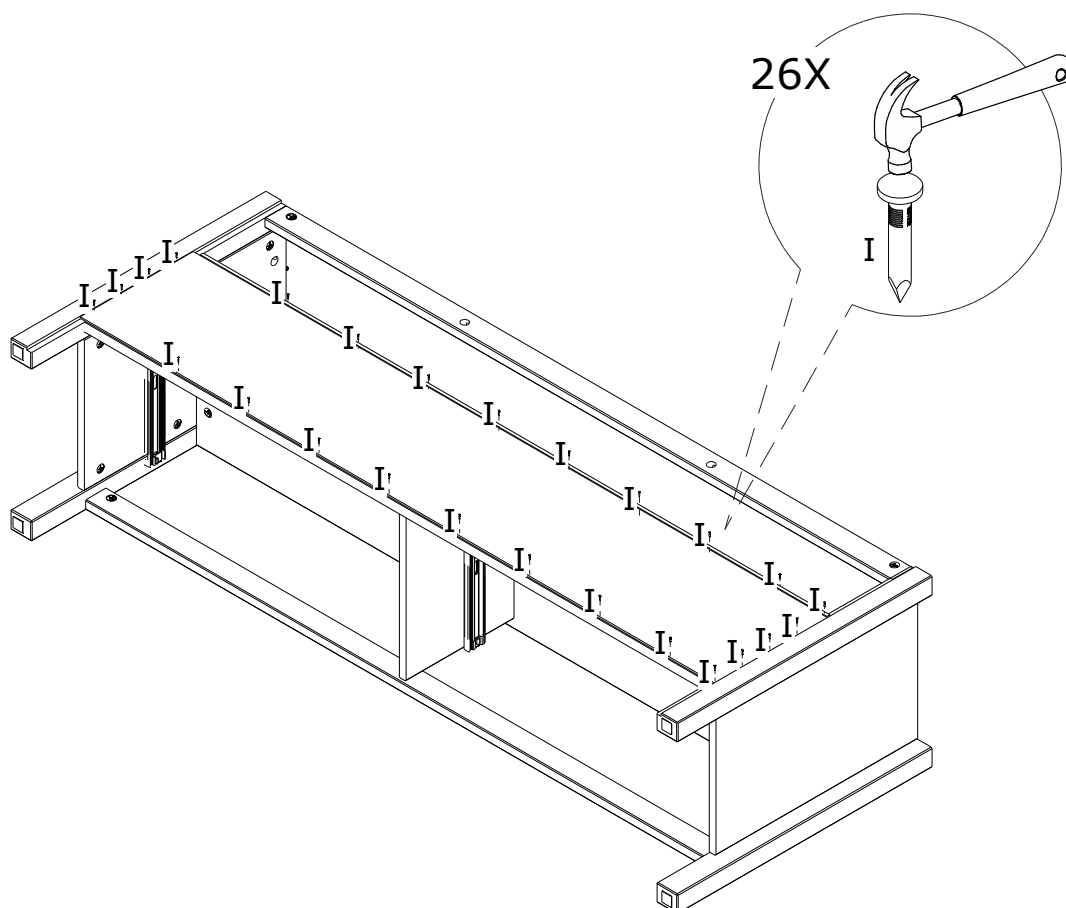
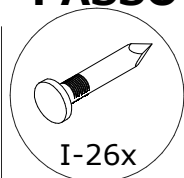

PASSO 22:

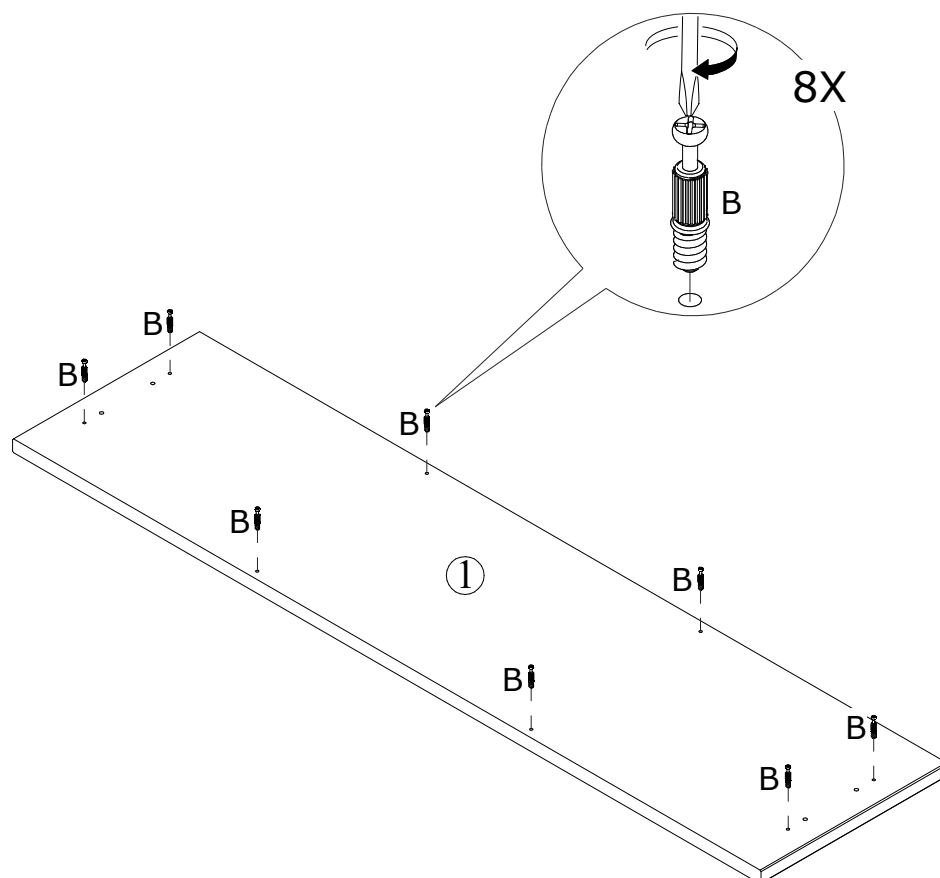
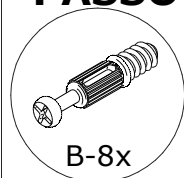

PASSO 23:

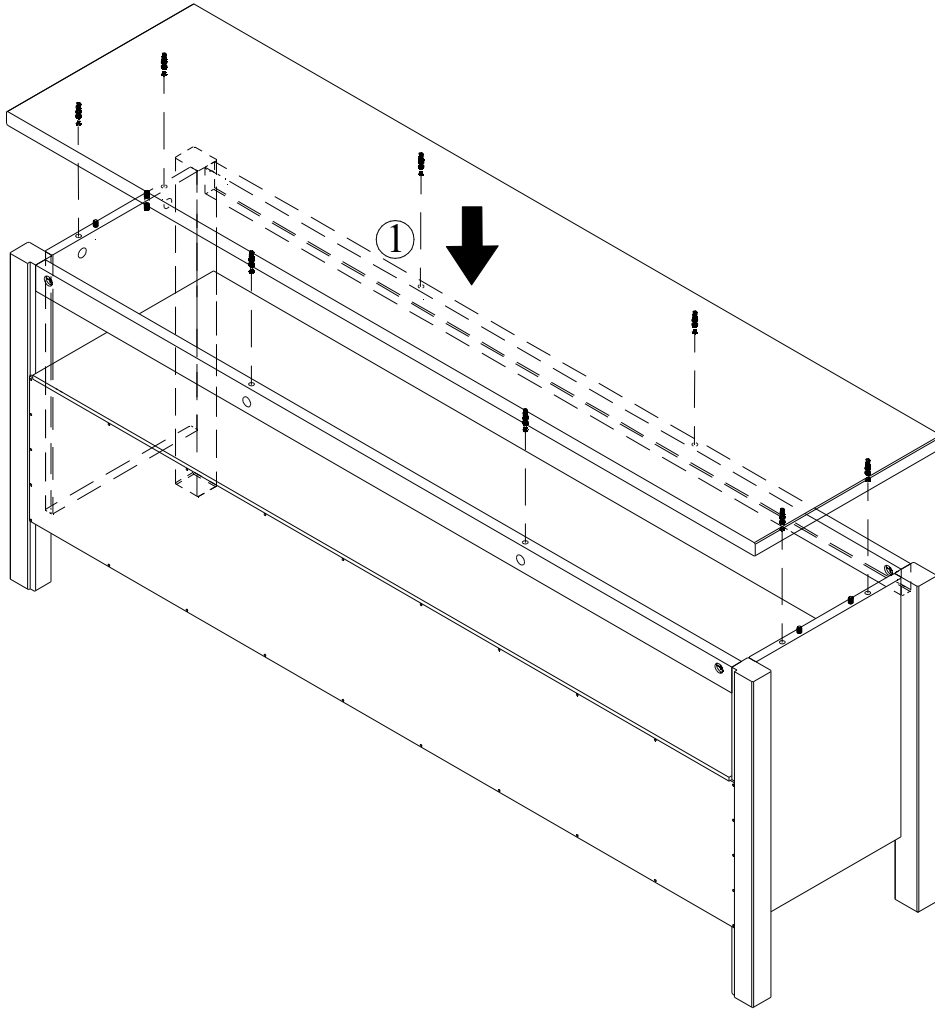

PASSO 24:

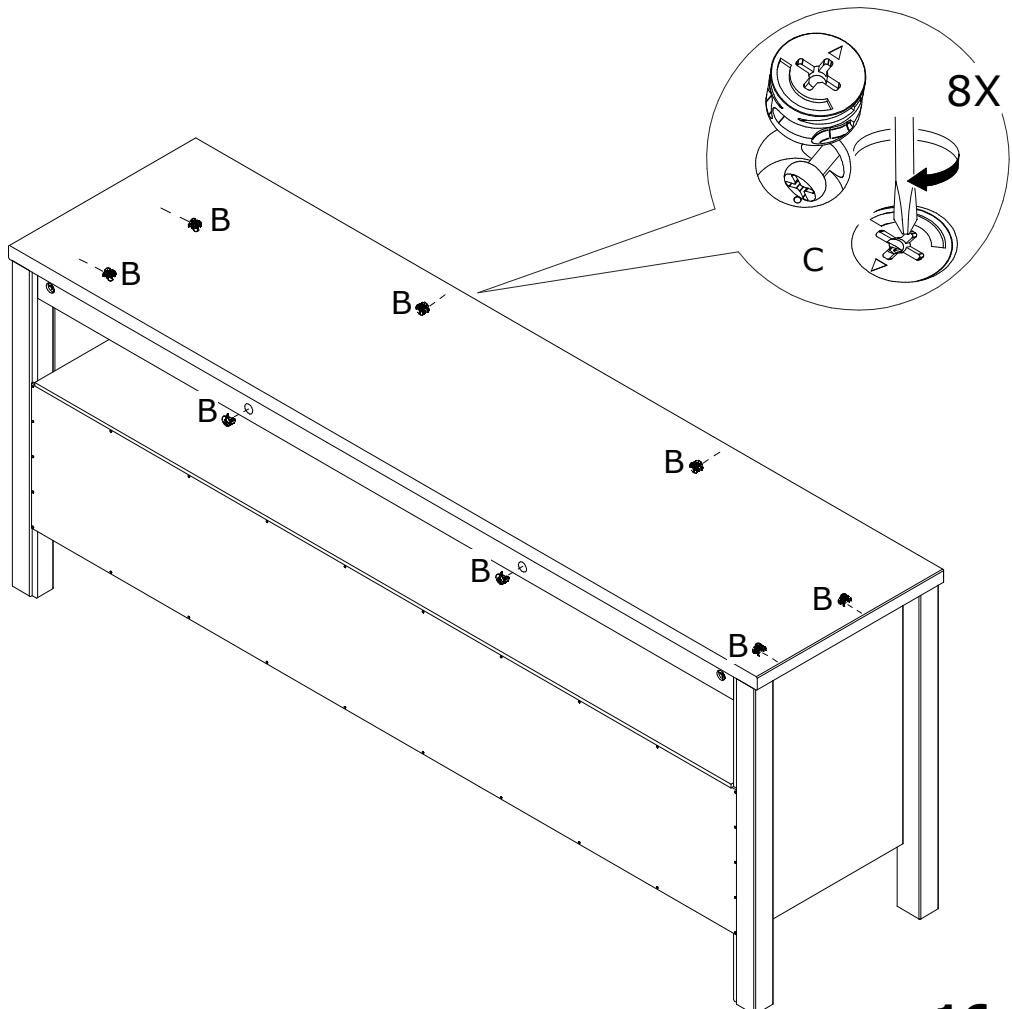
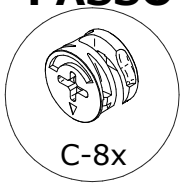

PASSO 25:

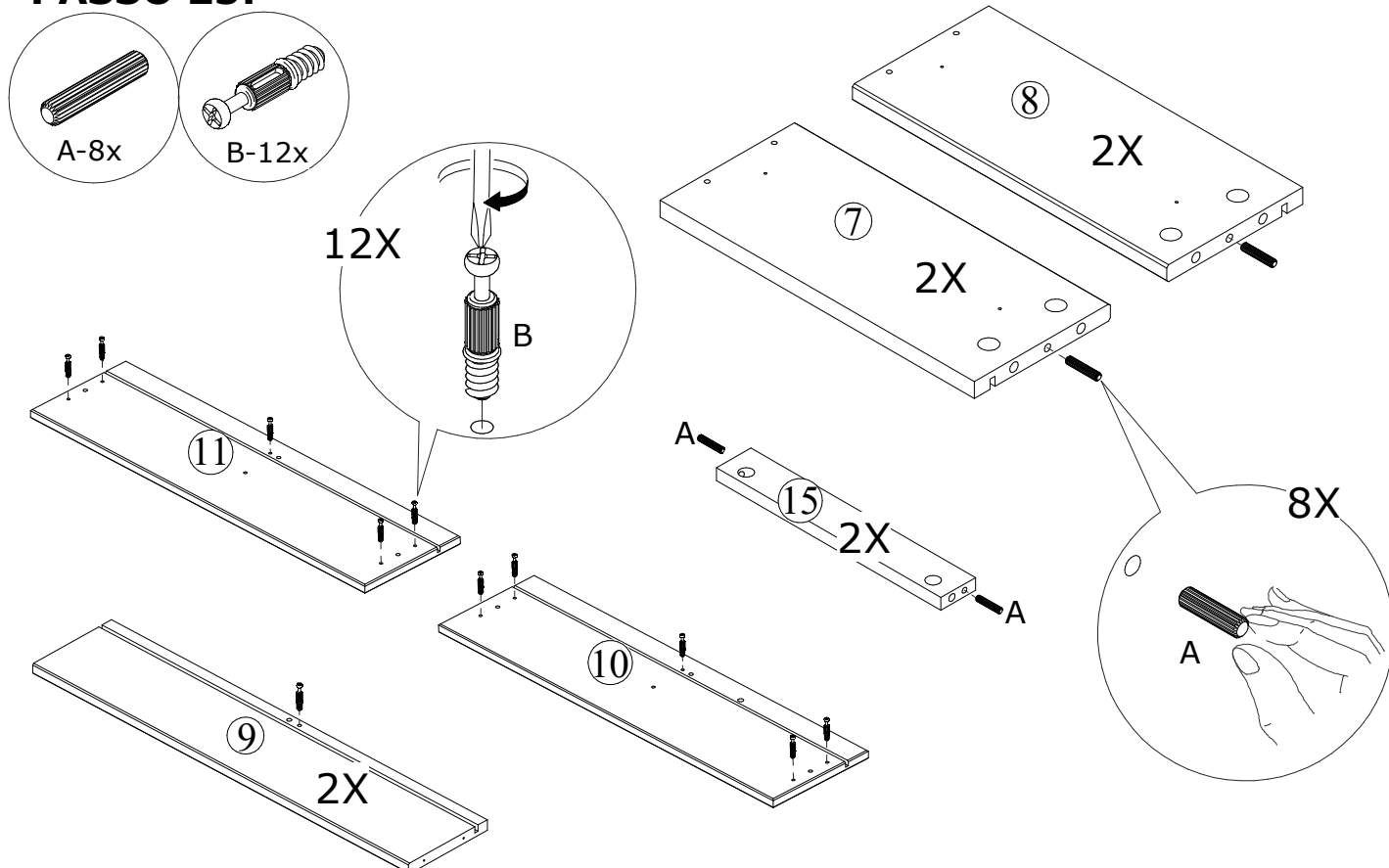

PASSO 26:

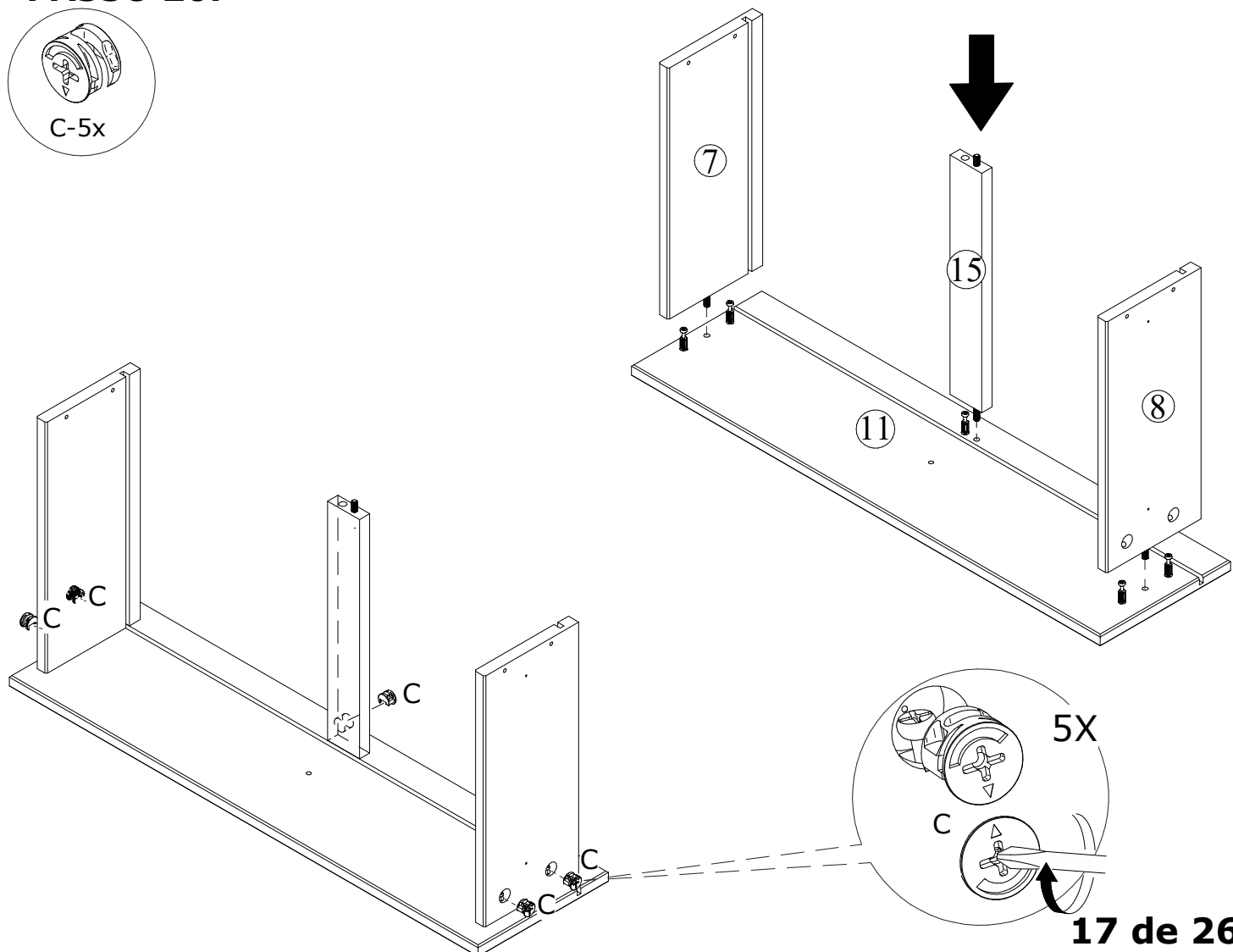

PASSO 27:

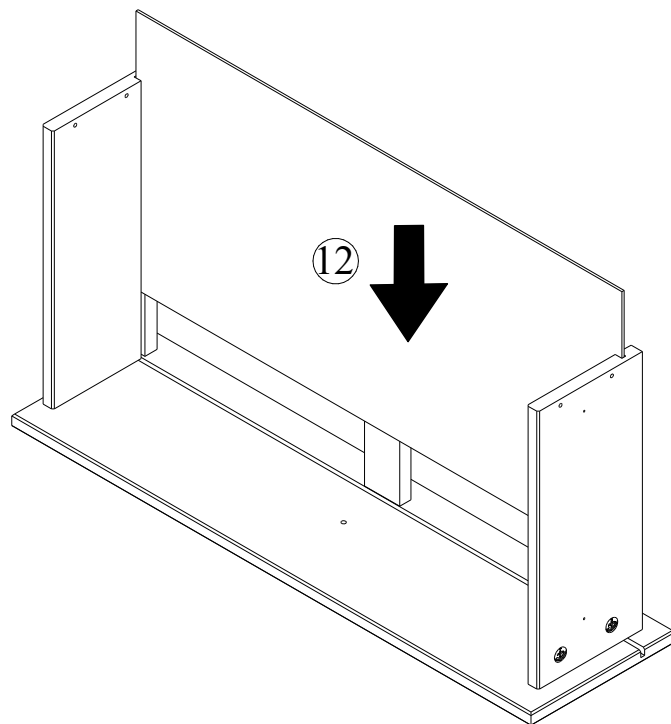
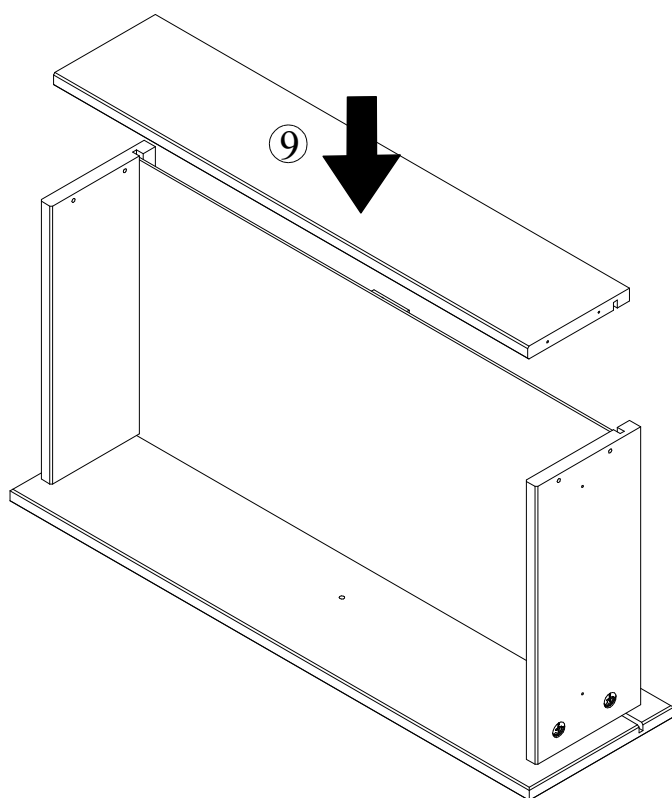

PASSO 28:

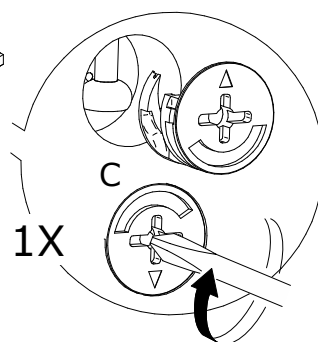
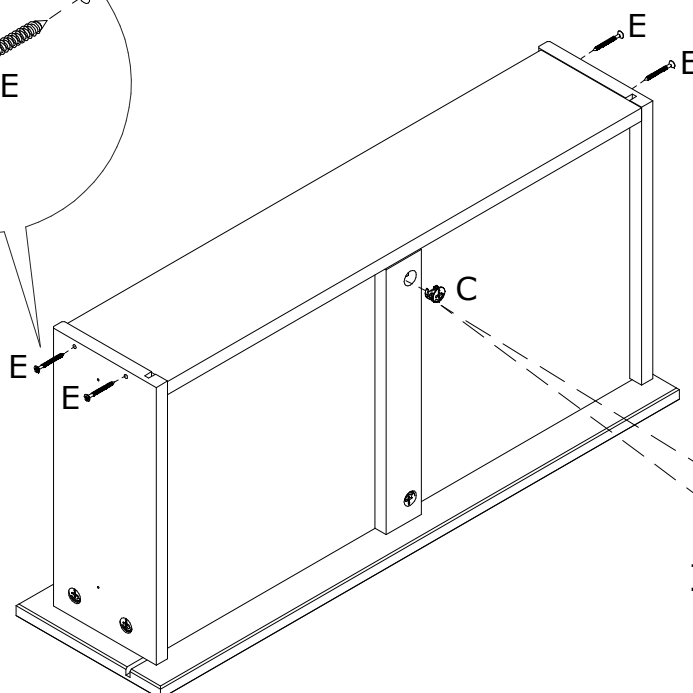
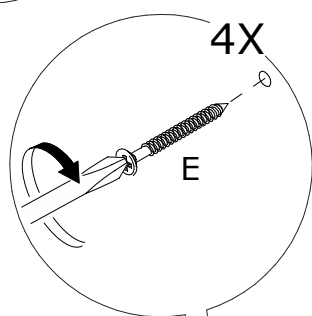
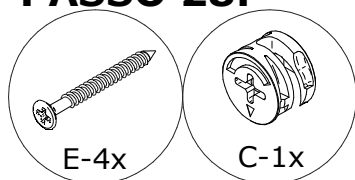

PASSO 29:

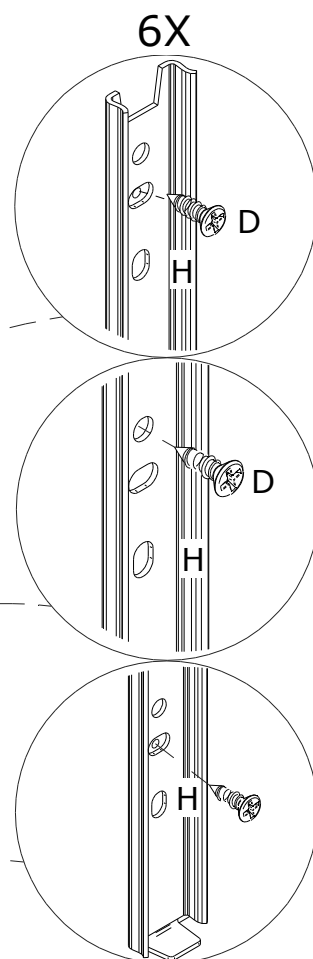
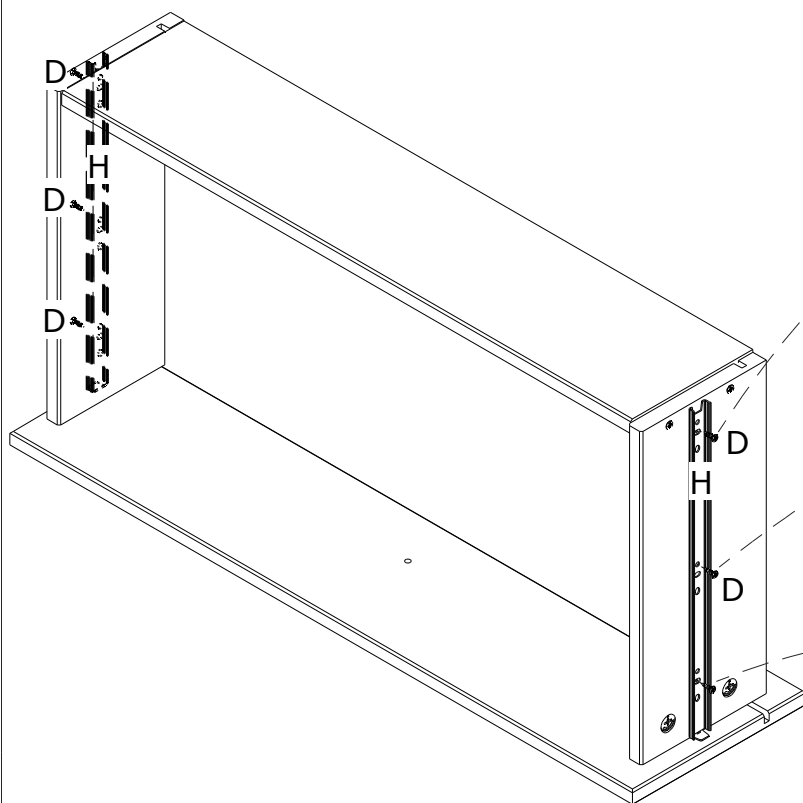
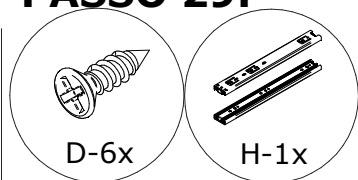

PASSO 30:

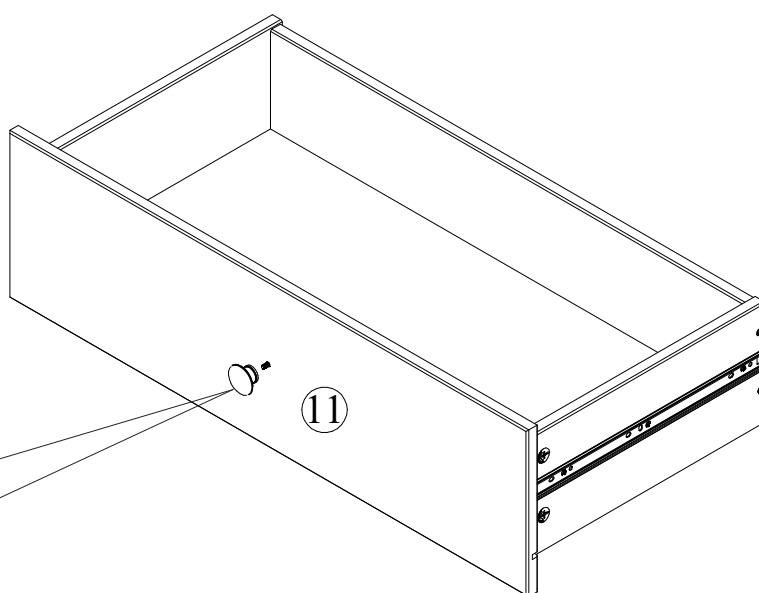
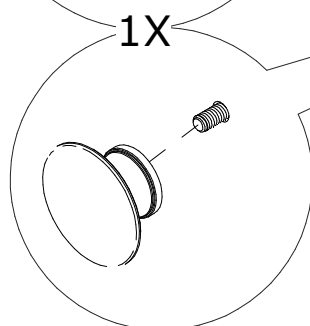
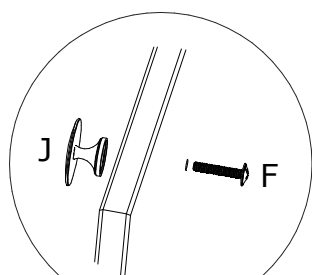
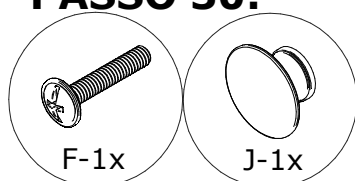

PASSO 31:

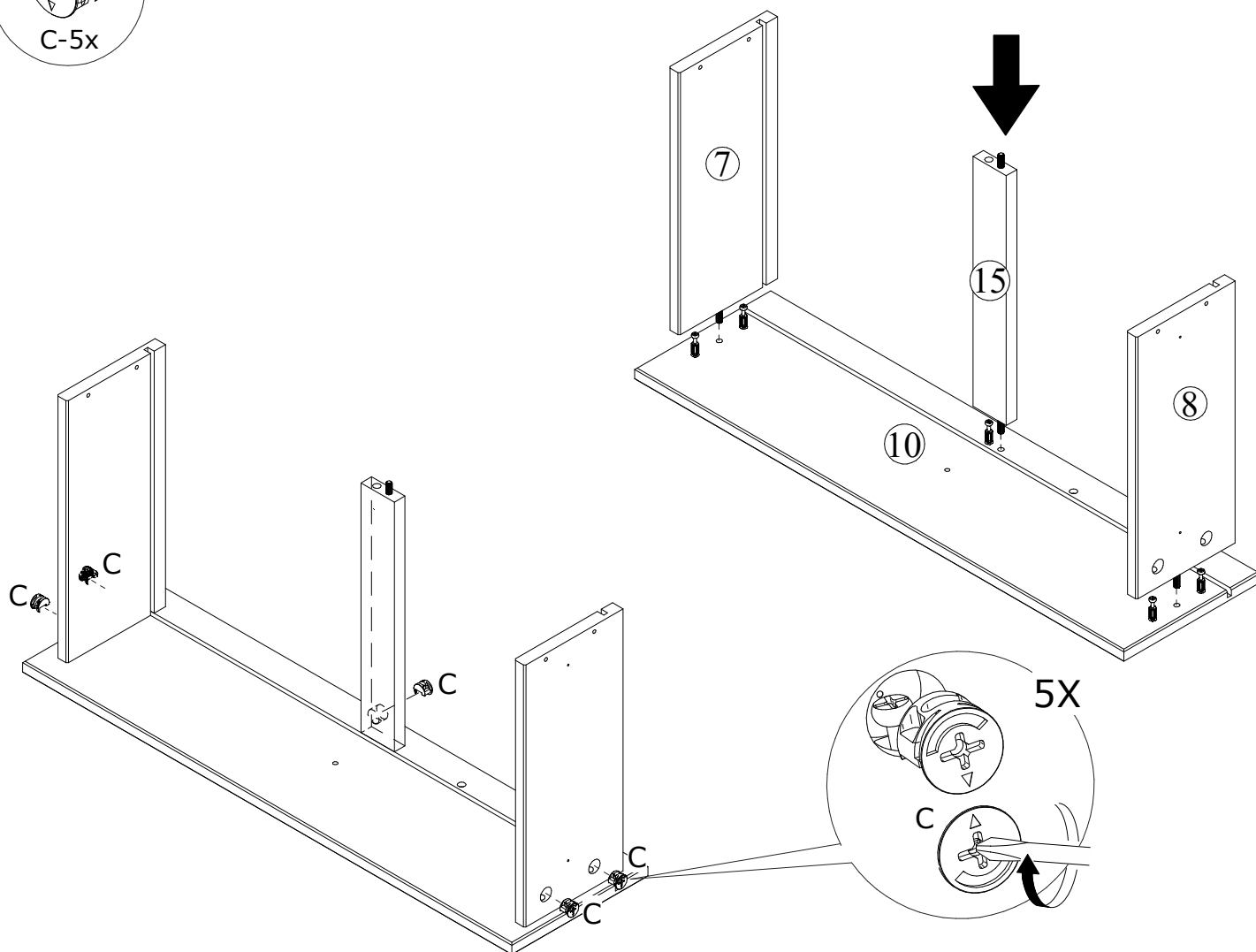
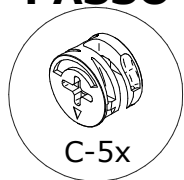

PASSO 32:

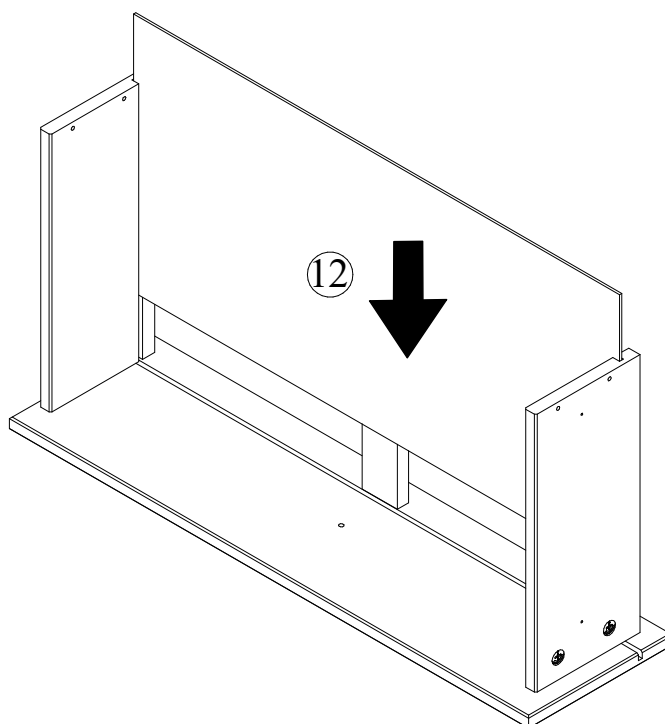

PASSO 33:

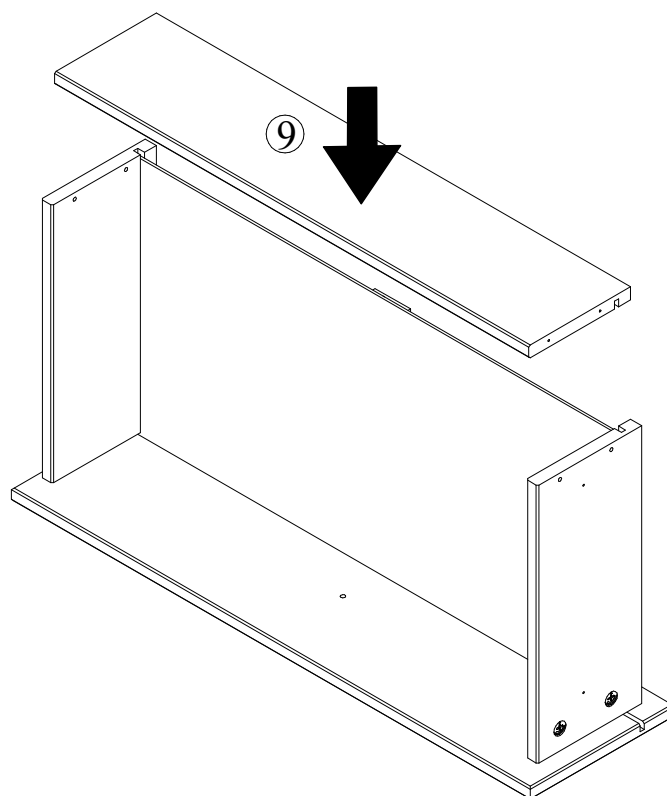

PASSO 34:

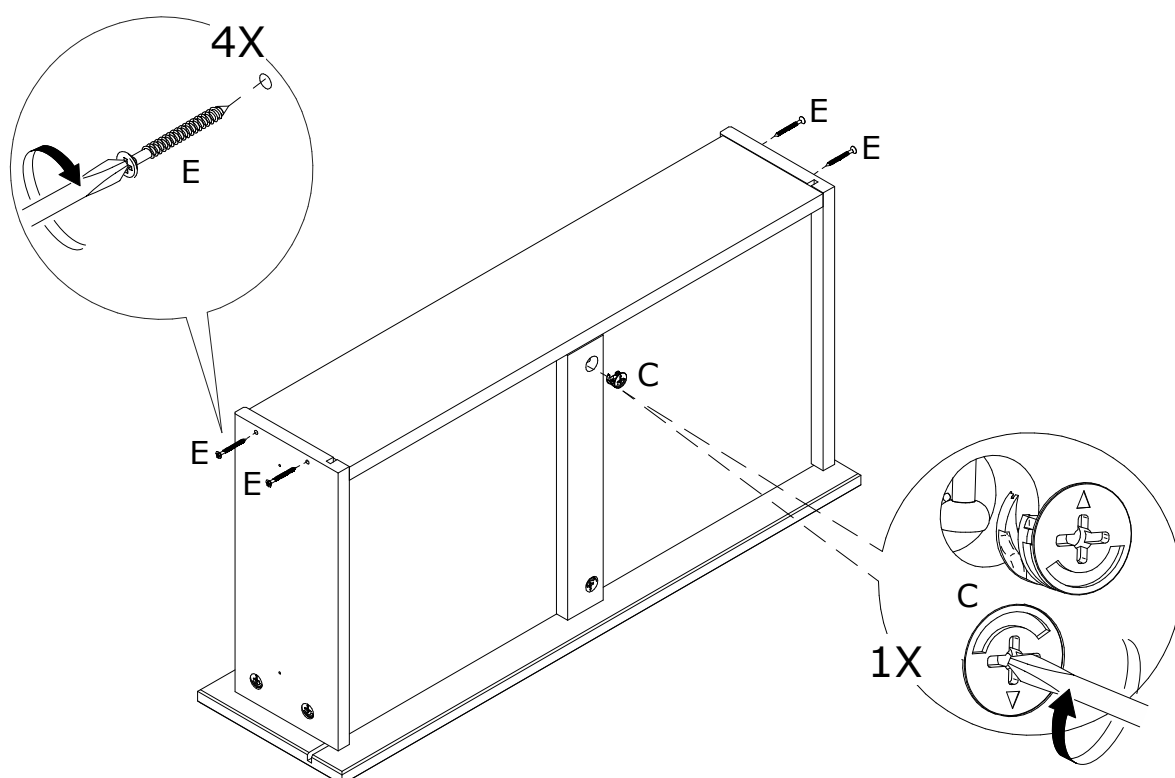
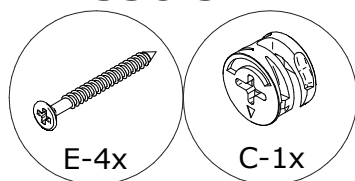

PASSO 35:

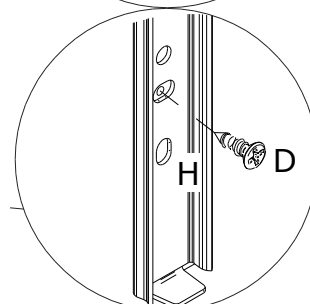
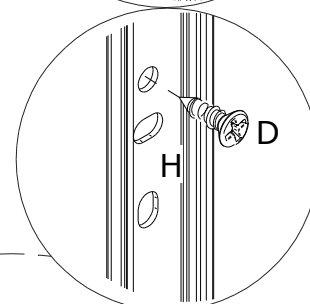
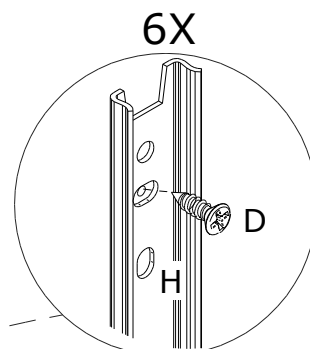
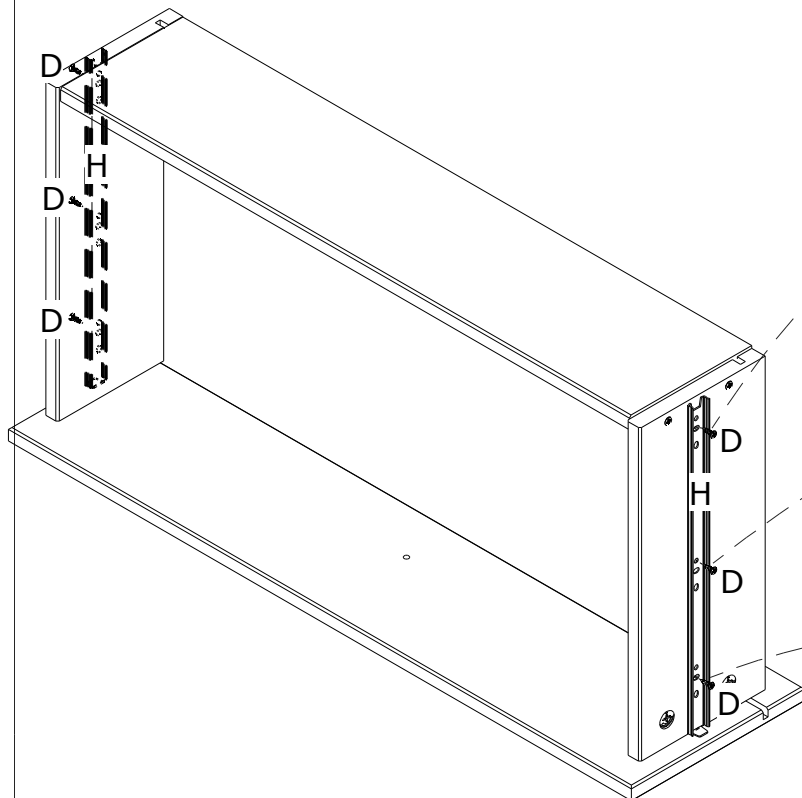
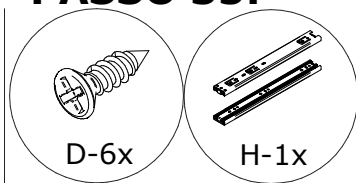

6X

PASSO 36:

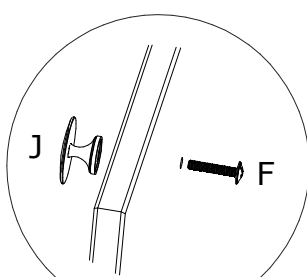
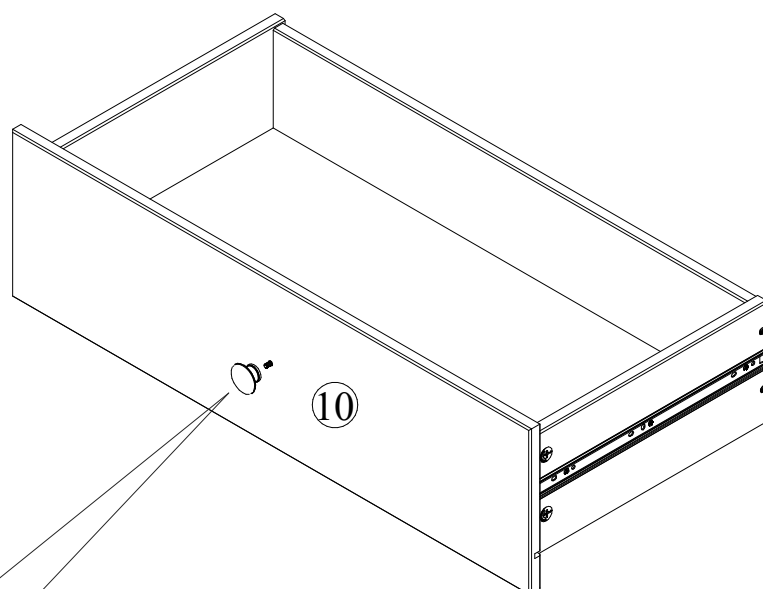
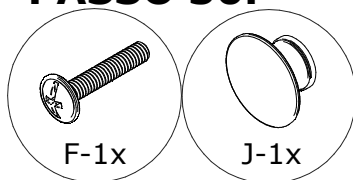

1X

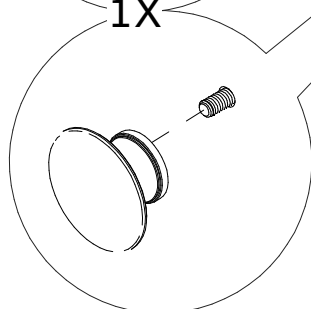

PASSO 37:

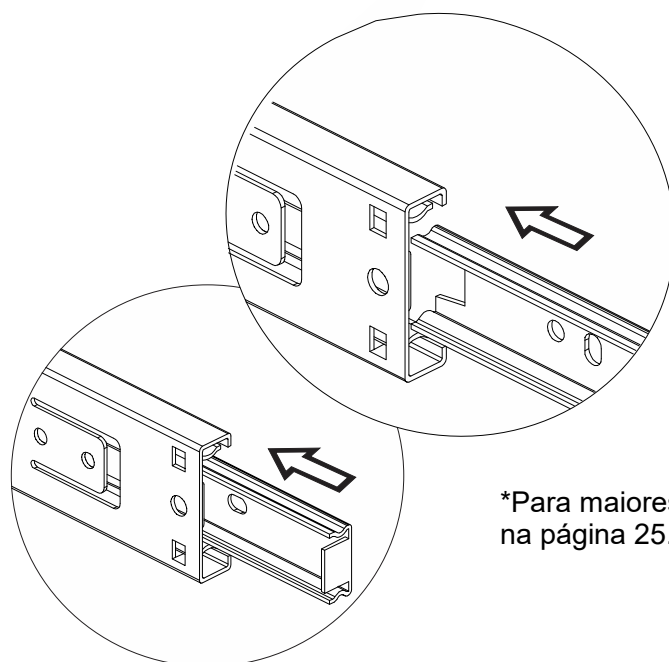
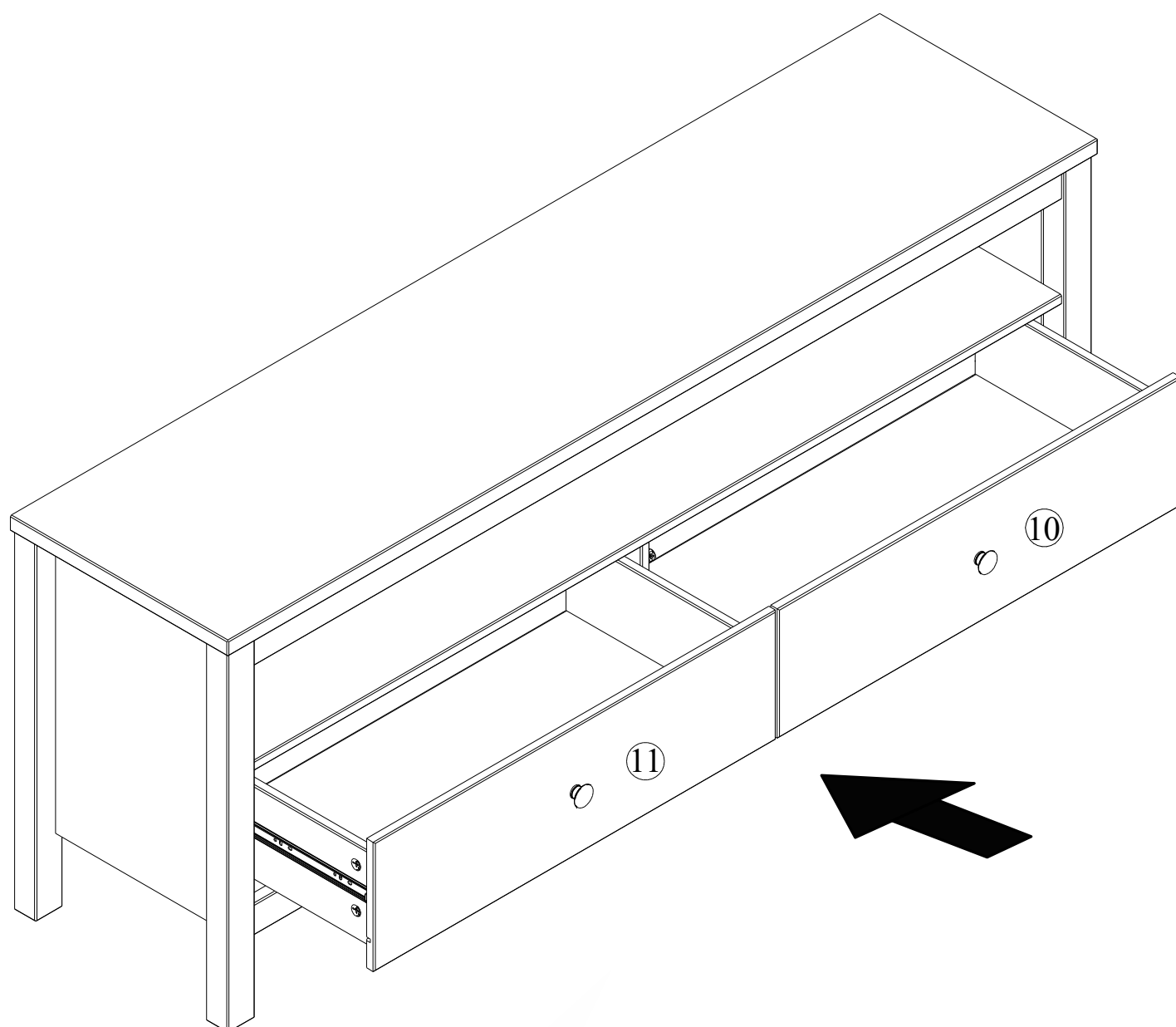

*Para maiores esclarecimentos busque orientação na página 25.

CUIDADOS COM O MÓVEL

Para limpeza e conservação deste produto, use apenas um pano macio, umedecido com água e sabão neutro (sem amônia).

Não use álcool, detergentes, abrasivos, etc...

Não deixe este produto em contato com o sol, fonte de calor ou ambiente com muito pó.

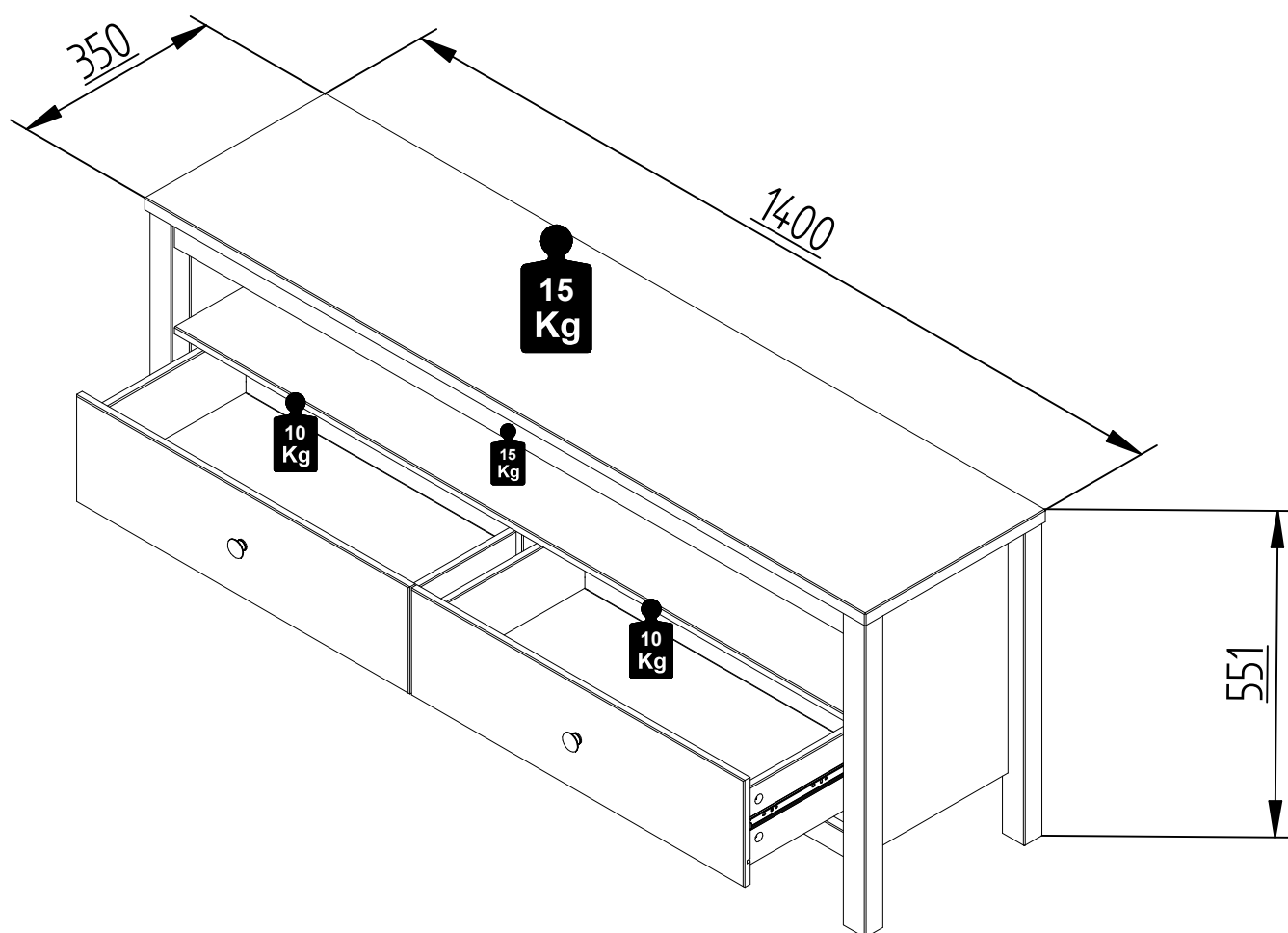



IMPORTANTE

Instrução extra para montagem e ajuste de corrediça telescópica de gaveta

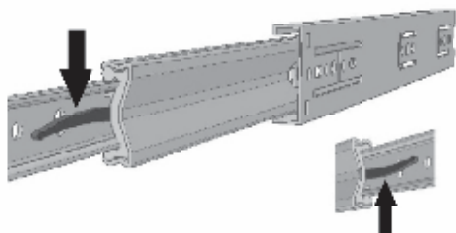

Abra a corrediça até o limite máximo e desconecte o trilho menor, pressionando a parte central da alavanca.

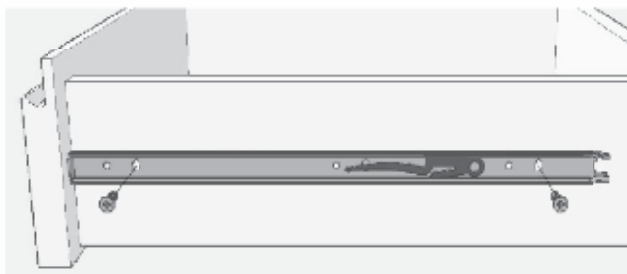

Fixe o trilho retirado na lateral de gaveta, usando o furo de regulagem.



Com o trilho principal aberto, fixe o conjunto na lateral do produto, usando os furos indicados (pré-furo na lateral).

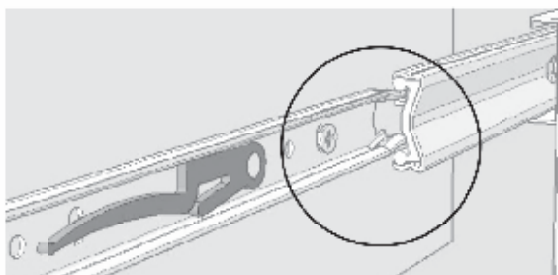

Encaixe os trilhos (direito e esquerdo) da gaveta nos conjuntos fixado nas laterais do produto. Observe o encaixe perfeito e empurre a gaveta até o seu fechamento total. OBS: É normal que a gaveta pareça emperrada nesse primeiro fechamento. Nesse caso, certifique-se do encaixe perfeito e force o seu fechamento total. Ao reabrir a gaveta, o funcionamento deve ser suave e leve.

Ajuste de altura da gaveta

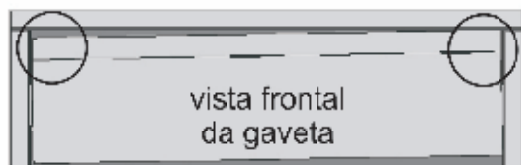

vista frontal
da gaveta

Solte o parafuso da lateral da gaveta e ajuste a altura, fixando-o em seguida. Depois de regulado, fixe o parafuso trava.

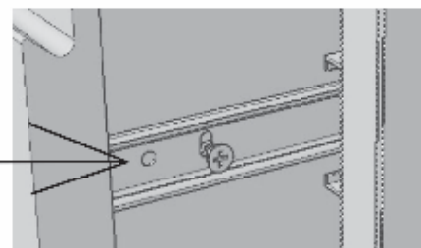

Ajuste do fechamento da gaveta

Se, ao fechar a gaveta, um dos lados ficar para fora da lateral, como no desenho, solte o parafuso e dobre a lingüeta indicada. Aperte o parafuso na sequência.

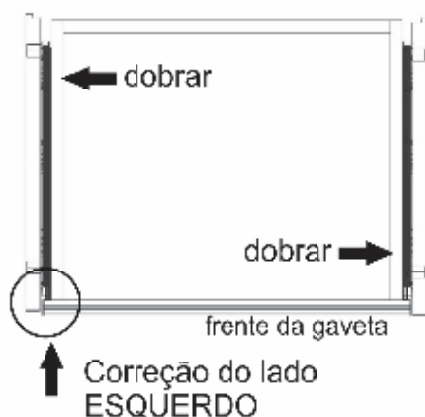

Correção do lado
ESQUERDO

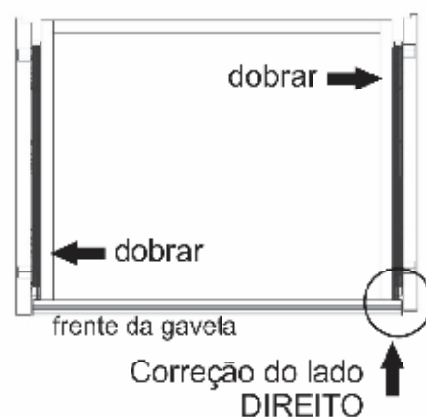
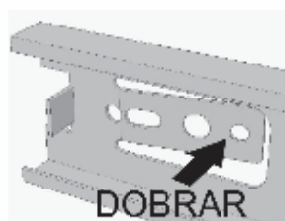

Correção do lado
DIREITO

Certificado de garantia

Rack Flat

Com o intuito de garantir a sua satisfação e confirmar o nosso compromisso com a qualidade, queremos que leia atentamente nossas recomendações para o cuidado do seu móvel.

1. Proteja-o da incidência direta da luz solar.
2. Evite coloca-lo próximo de estufas ou saídas de ar condicionado.
3. Não deixe em lugar úmido e ambientes com muito pó.
4. Evite objetos pontiagudos sobre a superfície.
5. Para limpeza deste produto, use apenas um pano macio, umidecido com água e sabão neutro.
6. Não use álcool, detergentes, abrasivos, etc...
7. A montagem deverá obedecer as instruções do manual, a montagem efetuada de maneira incorreta acarreta na perda de garantia.
8. Em caso de mudança de endereço possíveis avarias no transporte perderão a garantia.
9. Aperte os parafusos periodicamente.

IMPORTANTE: todas não conformidades deverão ser apontadas no momento do recebimento do produto.

Prazo de garantia:

Será de seis (06) meses a garantia do móvel por defeitos de fabricação, ressalvadas condições normais de uso e as demais condições do presente certificado, contados da data da emissão da nota fiscal.

**** O certificado de garantia só será válido se apresentado juntamente com a nota fiscal.**