

madeiramadeira
CABECASA

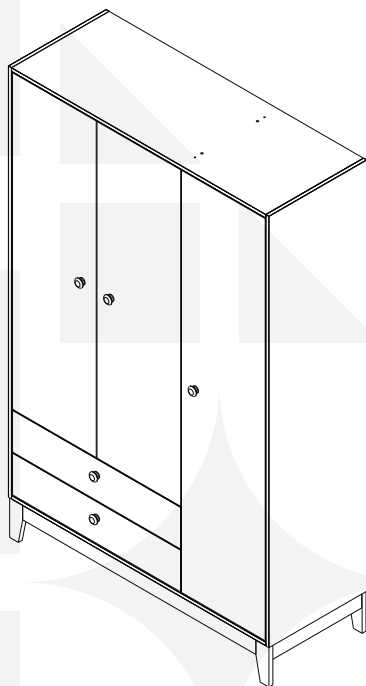

**GUARDA ROUPAS
ALECRIM**

CabeCasa

Casa e Decoração por MadeiraMadeira

Caber é fazer dar certo.

E para caber na sua vida, criamos a CabeCasa.

Ao invés da gente dizer o que cabe

Fomos perguntar para quem sabe: você, cliente Madeira.

Agora cabe no bolso, cabe na vida

Cabe o que você quiser que caiba.

Cabe em casa.

CabeCasa é a primeira marca
original MadeiraMadeira,
conheça nossa loja:



+ de **10 anos**
de mercado



+ de **8 mil**
entregas por dia



+ de **5 milhões**
de clientes

Como trocar seu produto

Para caber na sua vida, tem que caber mais transparência. Se o seu produto CabeCasa chegou com algum defeito, **você tem 7 dias para solicitar a troca**, saiba como agora mesmo.

- 1 Tenha em mãos: as fotos das peças com defeito; nome; código (como está aqui no manual) e quantidade de peças com defeito
- 2 Acesse o chat em nosso site, clicando no ícone 
- 3 Selecione o seu pedido, e depois a opção "Quero trocar um produto".
- 4 Pronto, agora é só preencher as informações e enviar. Vamos entrar em contato por e-mail e te dar todas as instruções.

CABE NO BOLSO • CABE NA VIDA • CABE EM CASA

ABEGASAGA SAGABEGA

Prepare-se para a montagem

- ☒ Confira as peças, componentes e se já tem em mãos as ferramentas necessárias.
- ☒ Para proteger seu móvel, coloque as peças sobre um tapete.
- ☒ Para realizar a montagem é necessário 2 pessoas. Convide sua família ou amigos pra montar com você.

Para realizar a montagem você vai precisar dessas ferramentas:



Se ficar alguma dúvida, é só falar com a gente pelo chat do site.

LISTA DE PEÇAS

Nº PEÇA	CÓD. FORNECEDOR	DESCRIÇÃO	QTD	DIMENSÕES (mm)			PESO UNT (KG)
				COMP.	LARG.	ESP.	
1	00000	Tampo	01	1170	450	15	5,53
2	00000	Lateral esquerda	01	1720	450	15	8,13
3	00000	Divisória maior	01	1690	434	15	7,70
4	00000	Lateral direita	01	1720	450	15	8,13
5	00000	Fundo	01	1170	450	15	5,53
6	00000	Prateleira fixa	02	772	434	15	3,52
7	00000	Prateleira fixa menor	02	418	383	15	1,68
8	00000	Prateleira móvel	02	417	383	15	1,68
9	00000	Porta menor	02	1343	386	15	5,44
10	00000	Porta maior	01	1684	386	15	6,83
11	00000	Frente gaveta	02	775	167,5	15	1,36
12	00000	Lateral gaveta direita	02	400	150	15	0,63
13	00000	Lateral gaveta esquerda	02	400	150	15	0,63
14	00000	Traseiro gaveta	02	747	150	15	1,18
15	00000	Fundo gaveta	02	727	410	3	0,63
16	00000	Traseiro central	02	1043	384	3	0,85
17	00000	Traseiro lateral	01	1968	391	3	1,39
18	00000	Traseiro superior	01	780	298	3	0,49
19	00000	Traseiro inferior	01	780	343	3	0,56
20	00000	Base montada	02	1194	160	36	1,20
21	00000	Lateral base	02	411	60	18	1,68
22	00000	Travessa gaveta	02	400	40	15	0,18

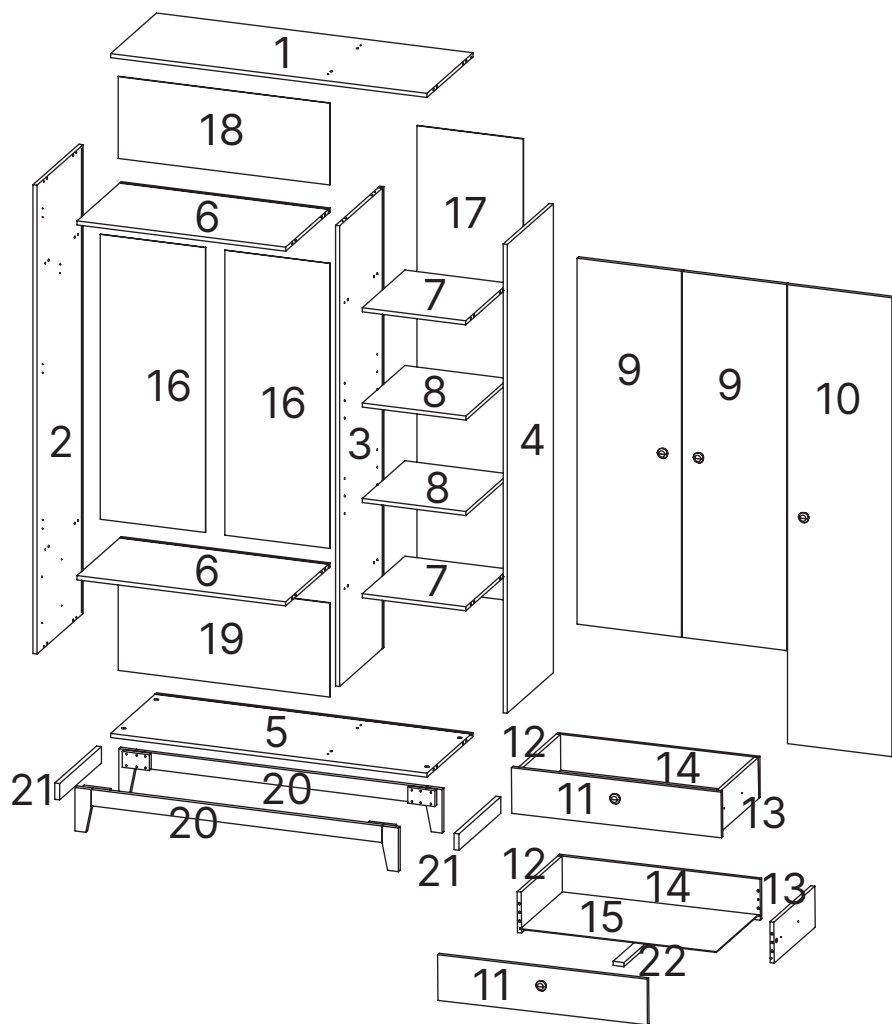

As ferragens do manual estão em proporção real

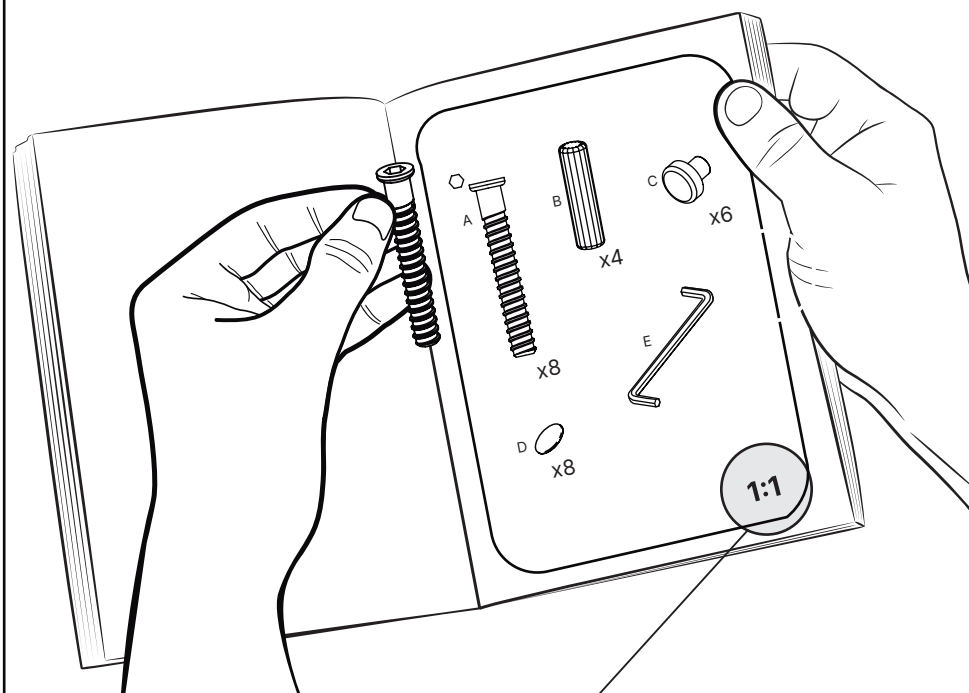

Símbolos

- + Parafuso Phillips
- Parafuso Fenda
- ⬡ Parafuso Allen

Atenção!

As ferragens são representadas na mesma proporção da vida real. Se ficar alguma dúvida sobre qual é a ferragem correta, coloque ao lado do desenho para conferir.

A

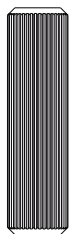

x44

+

B



x28

+

C

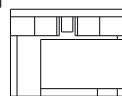

x28

+

D



x48

+

E



x8

+

F



x12

G



x8

H

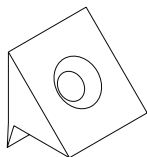

x18

I



x4

J

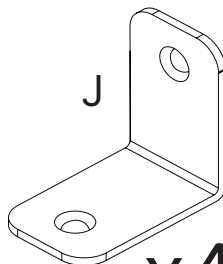

x4 1:1

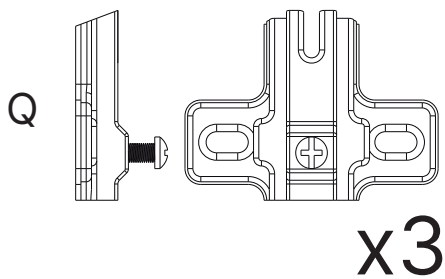
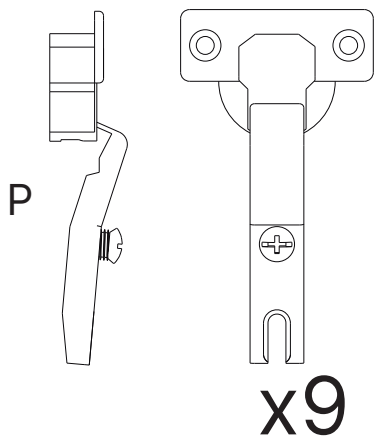
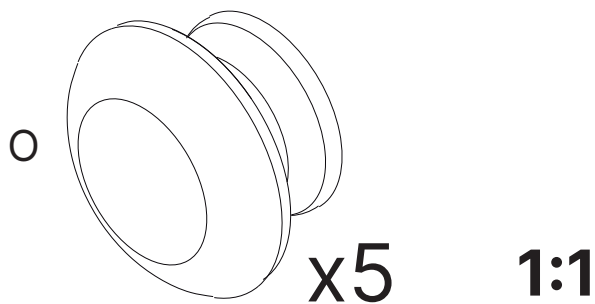
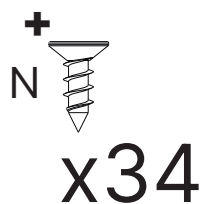
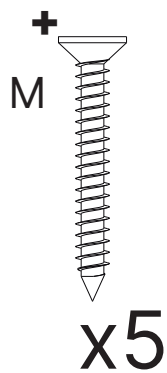
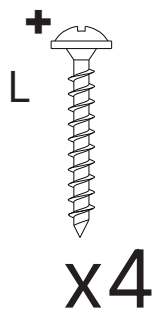
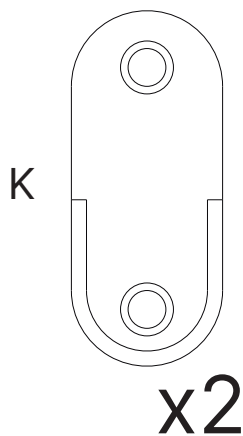

R

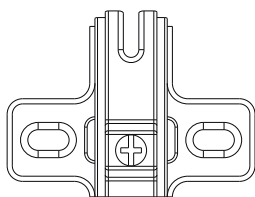
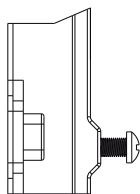

x6

S

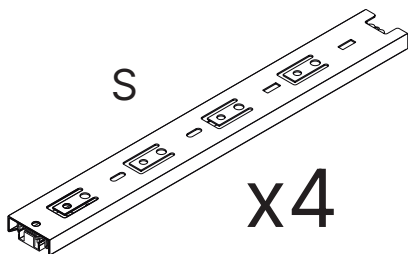

x4

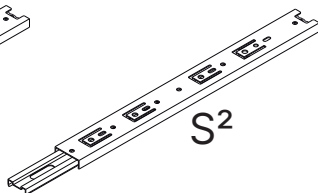
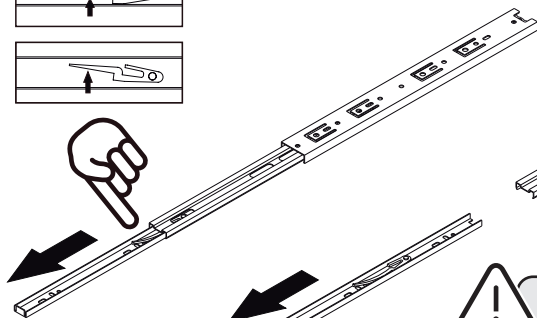
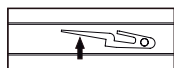
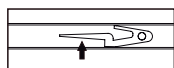

S²

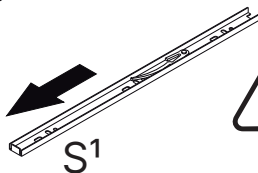

S¹



Separe a coreiça
conforme ilustração

T

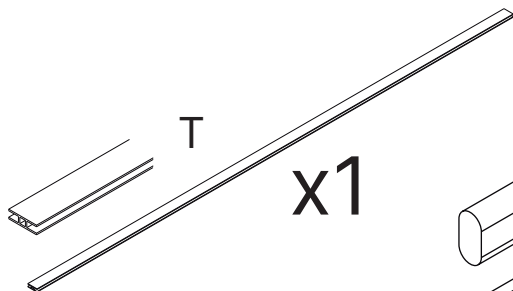

x1

U

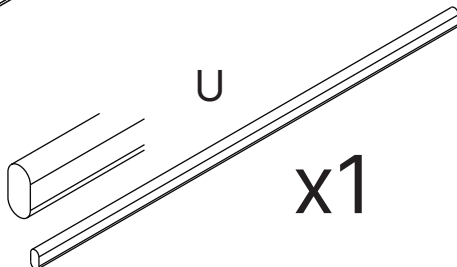

x1

1

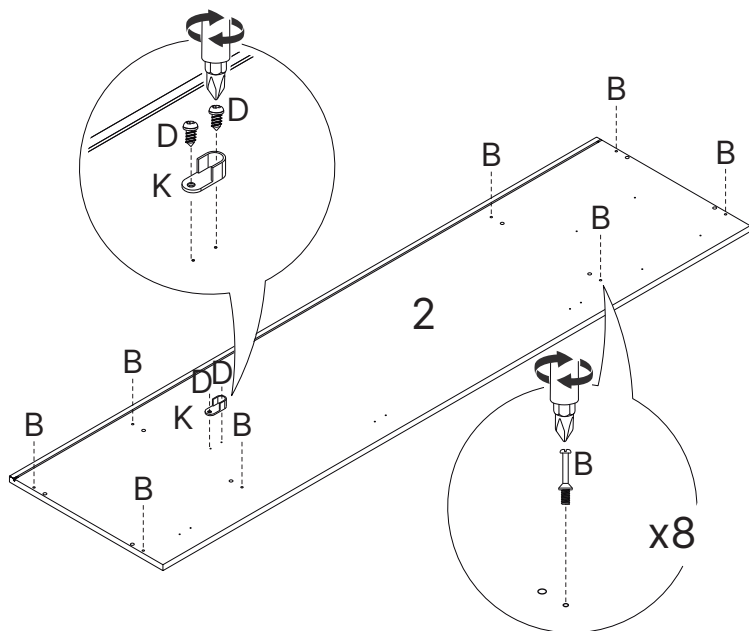

2

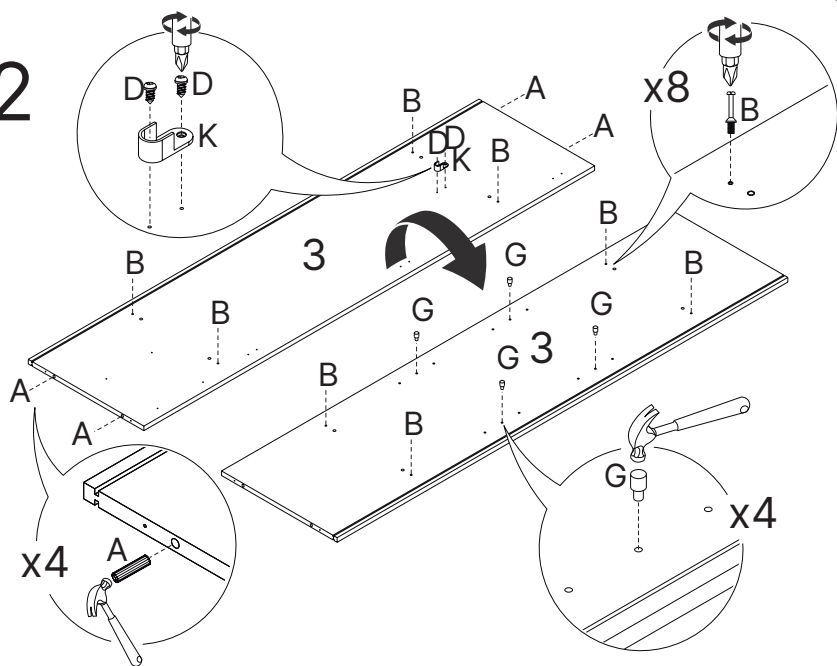

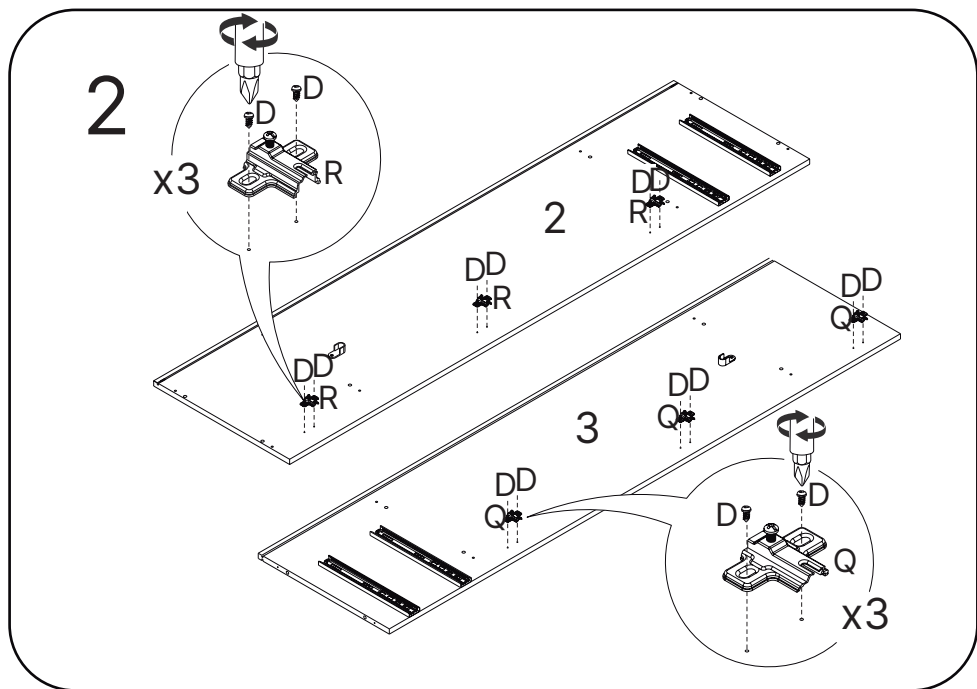
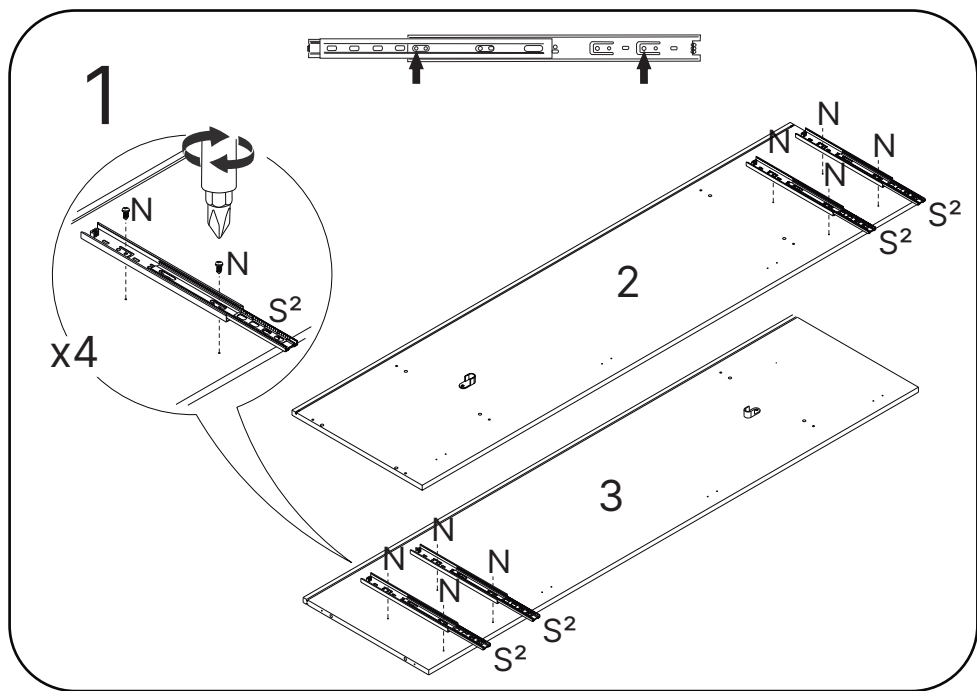

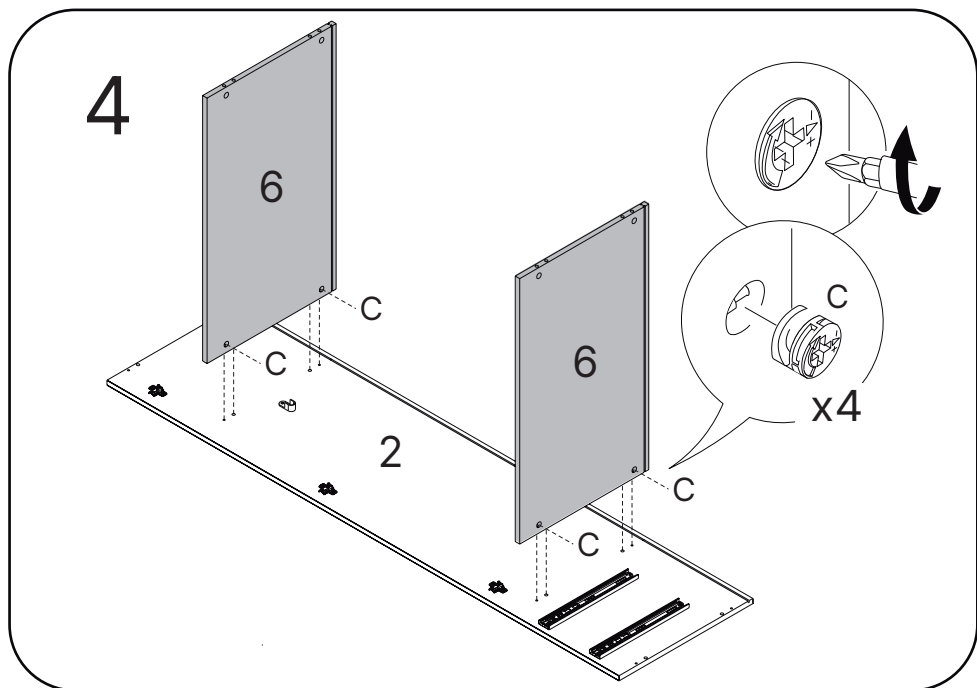
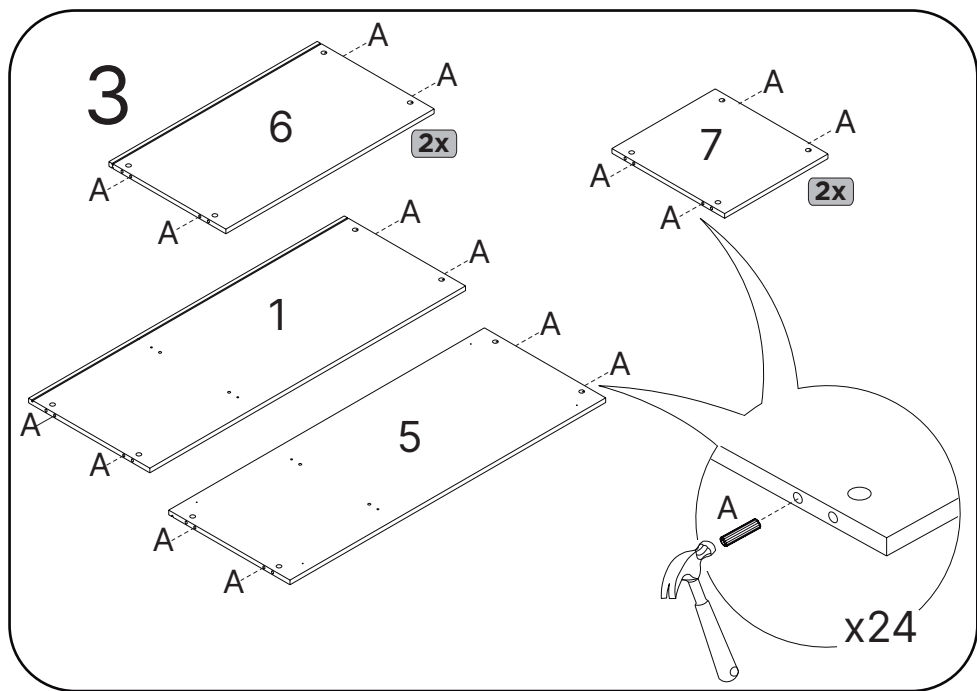

5

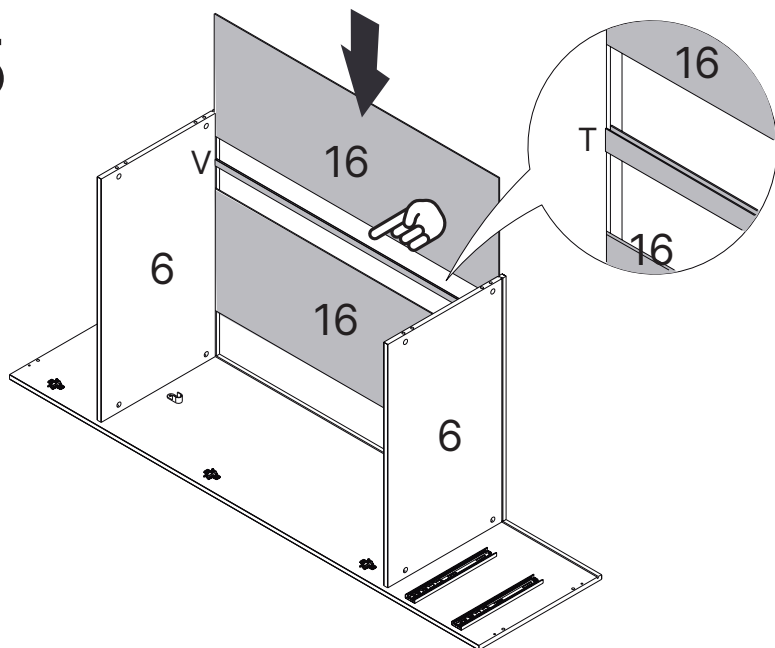

6

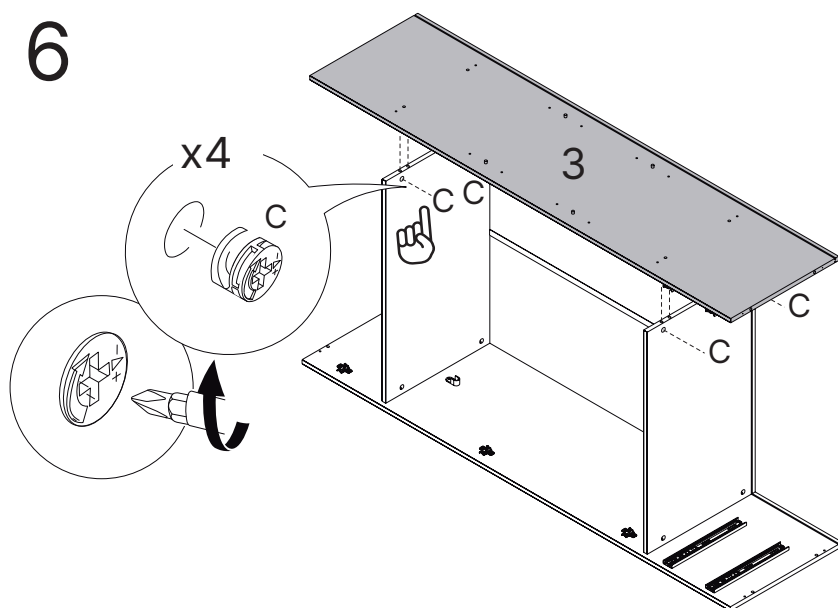

7

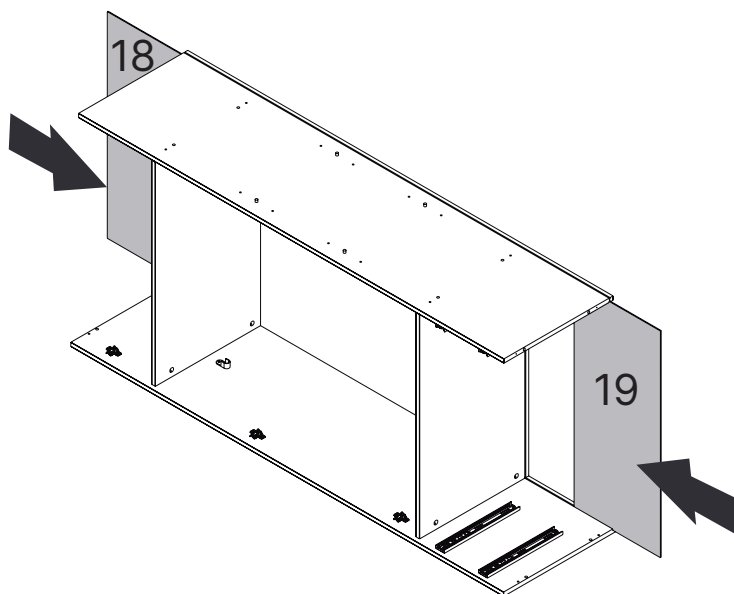

8

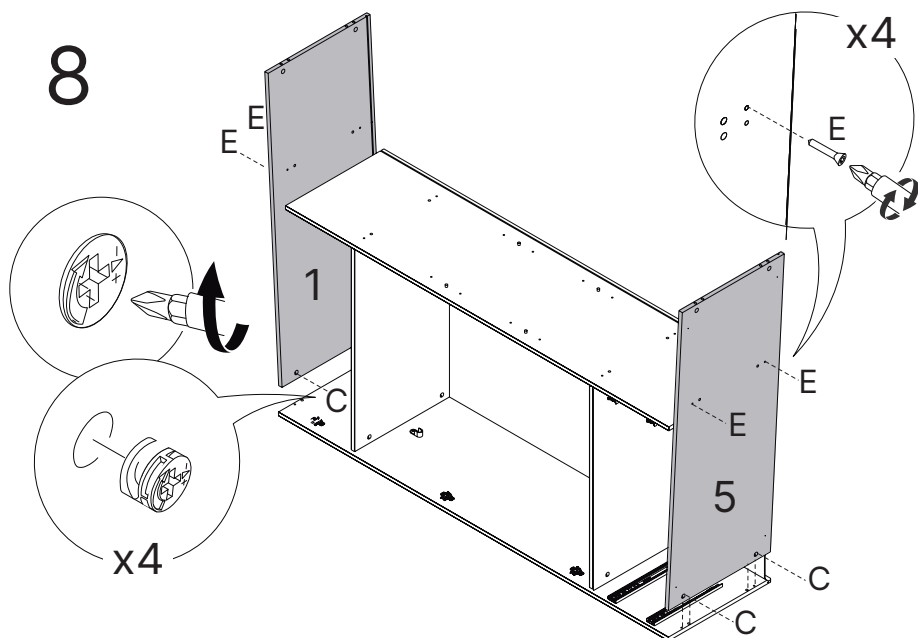

9

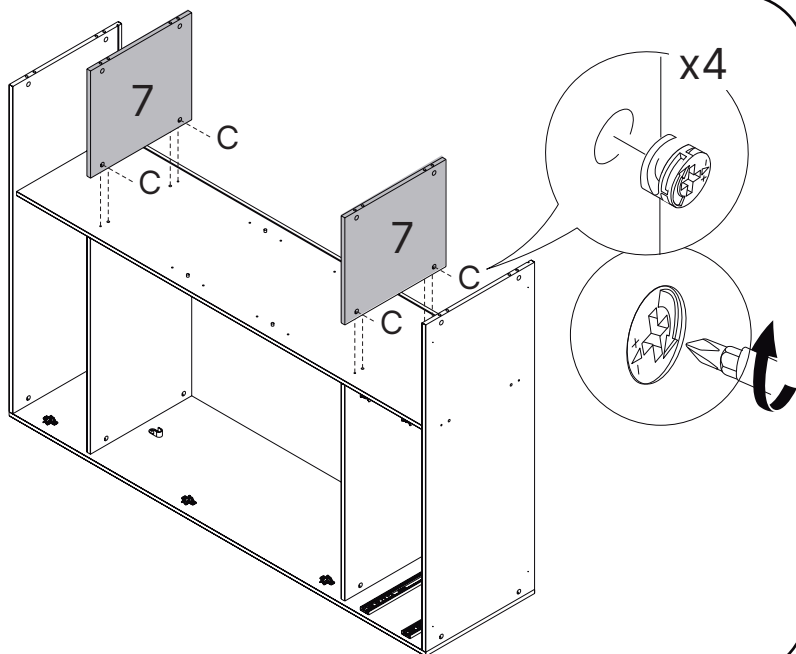

10

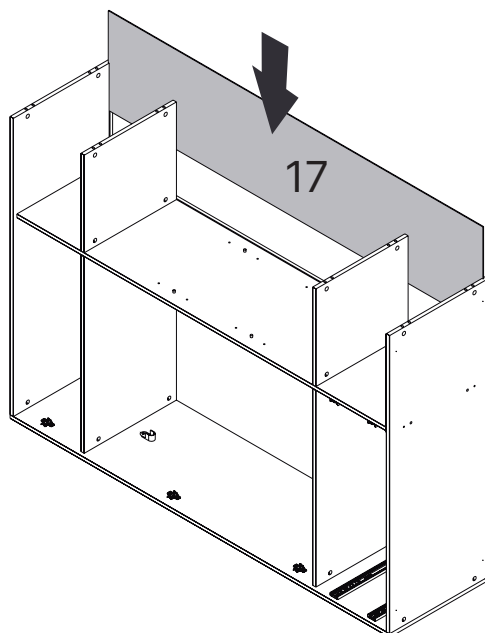

11

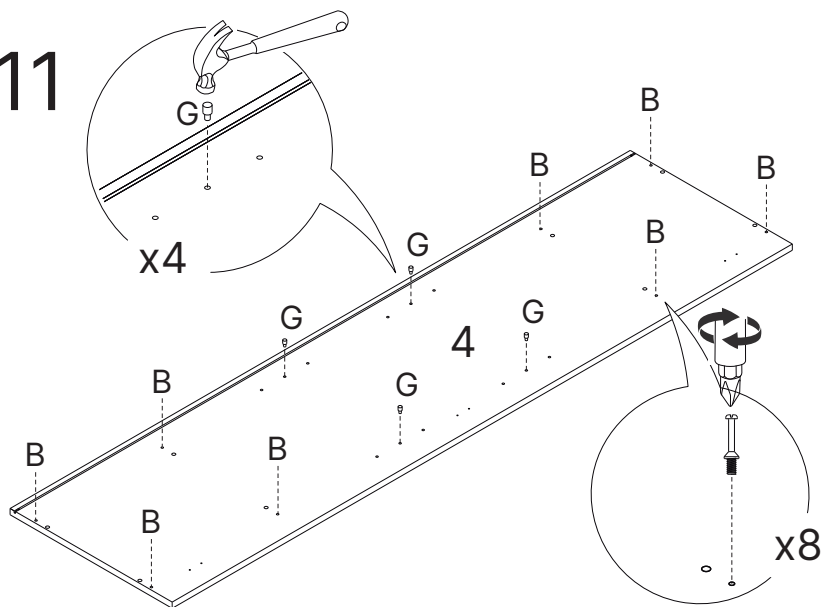

12

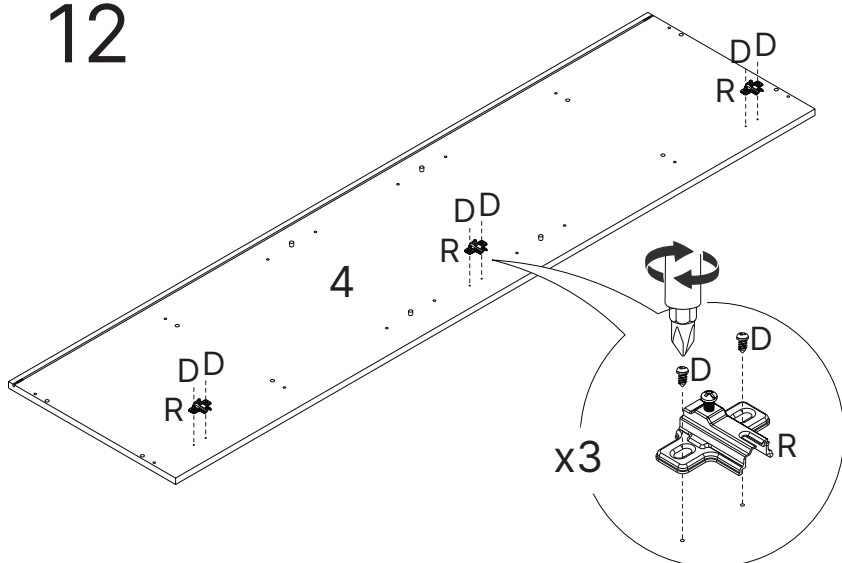

13

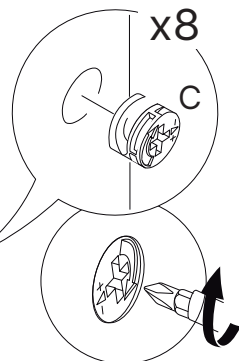
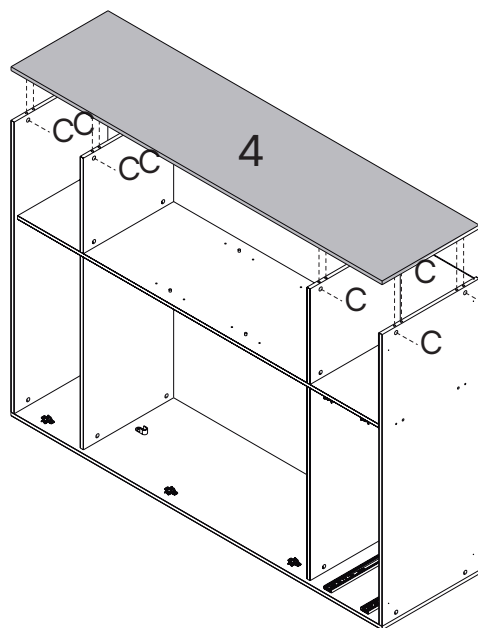

14

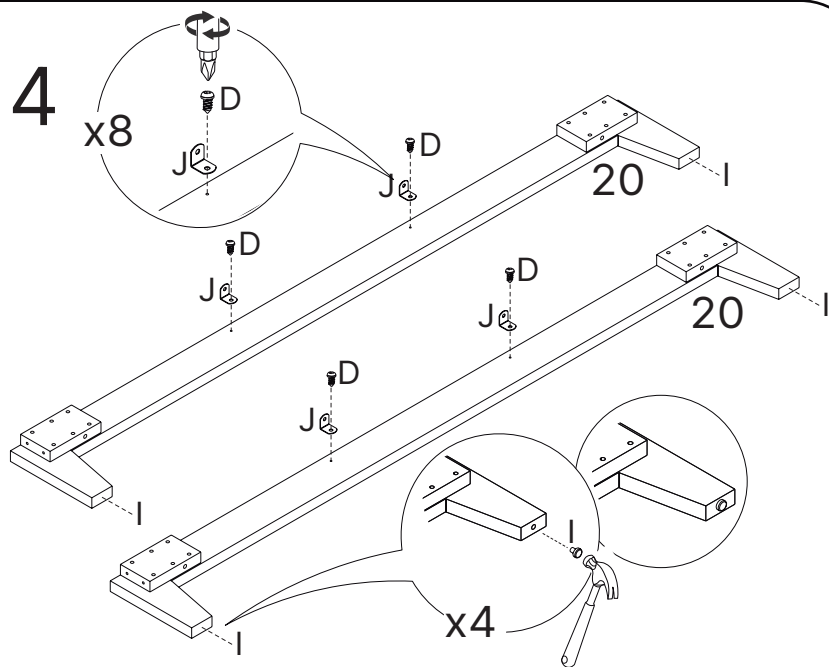

15

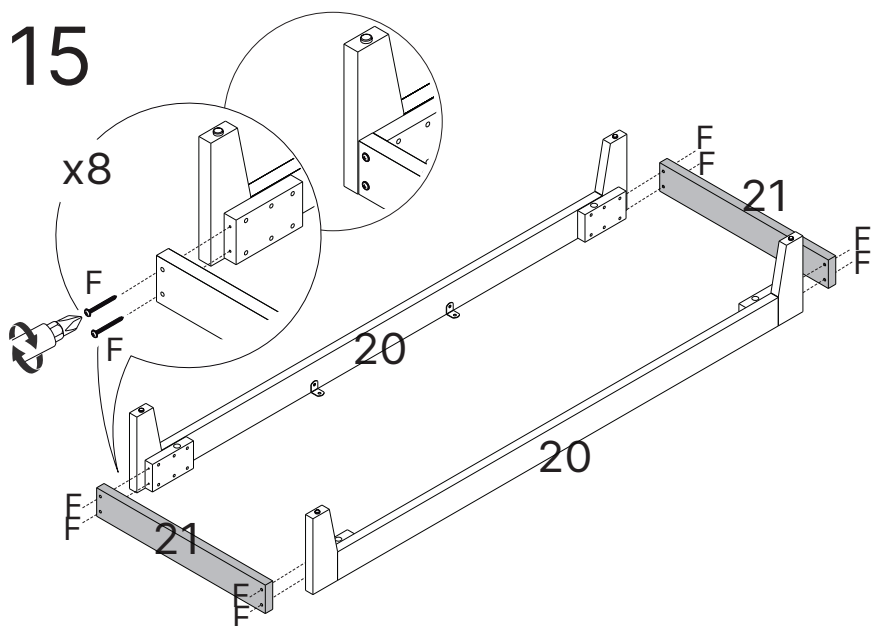

16

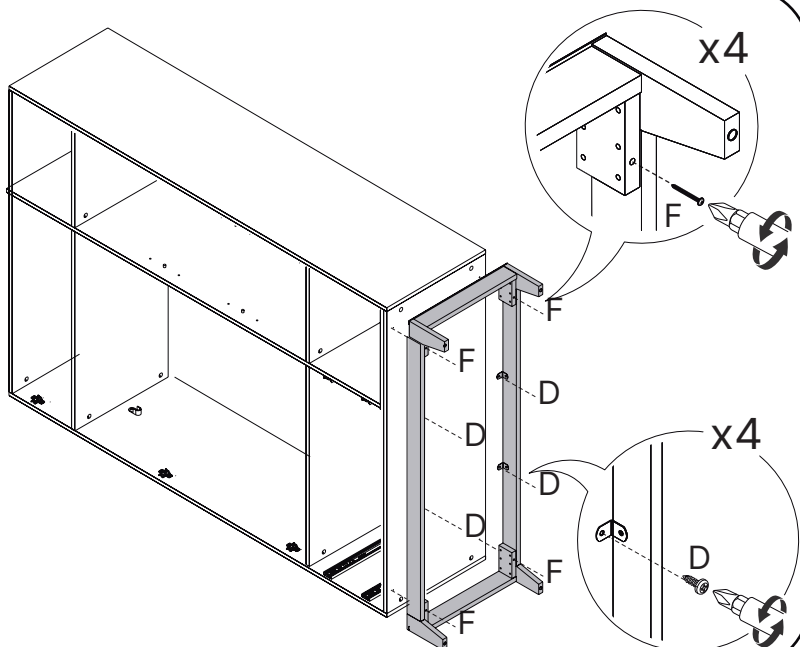

17

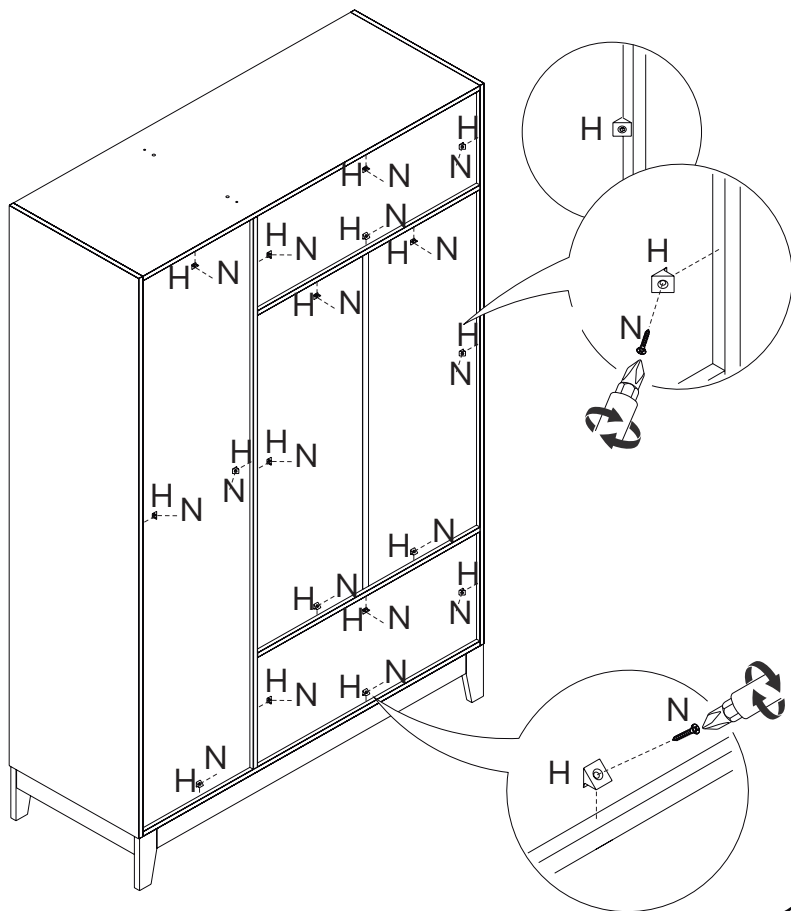
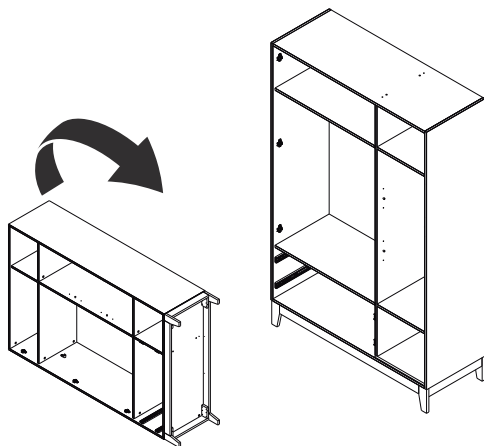

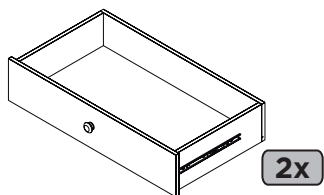

15

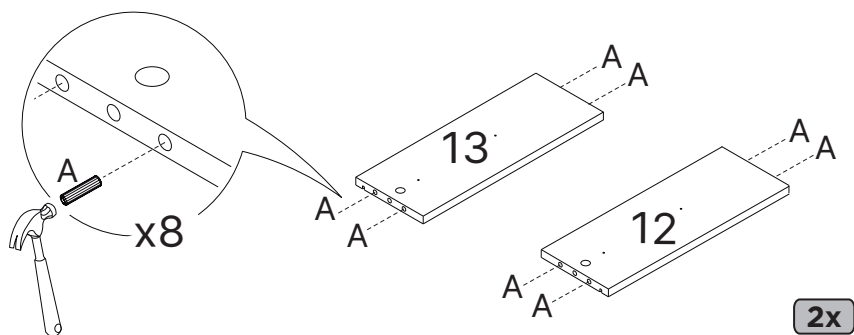

16

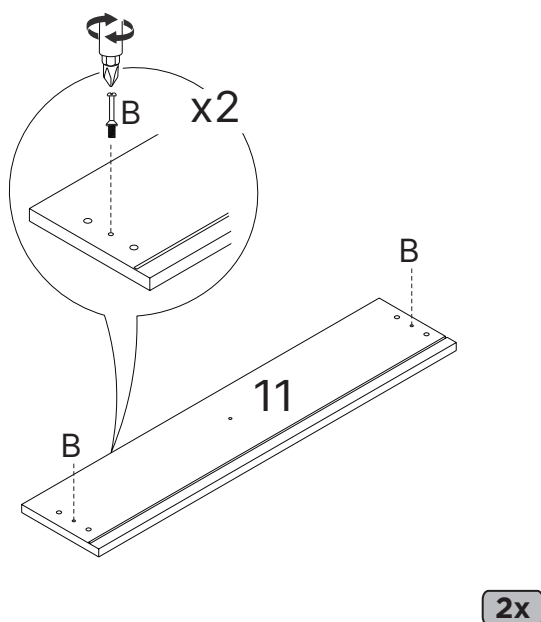

23

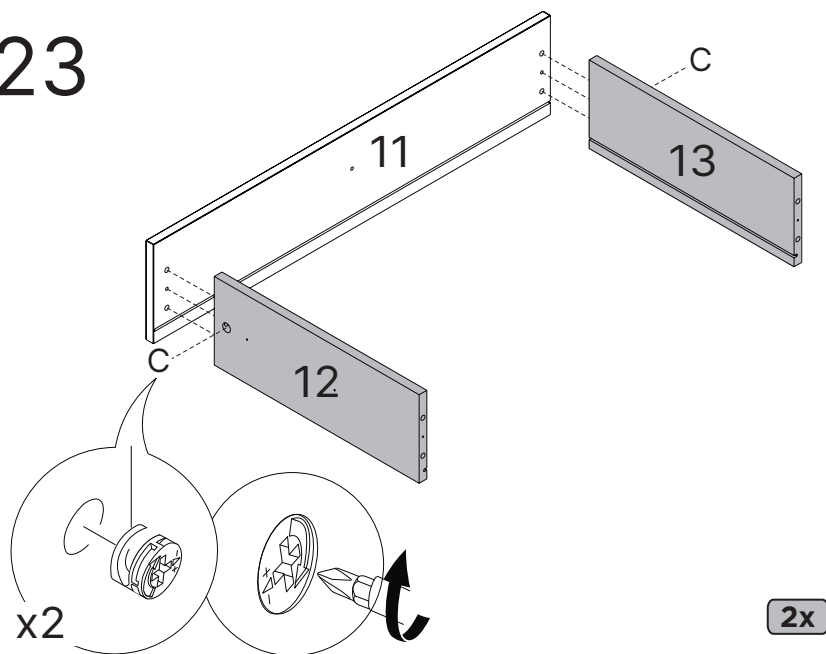

24

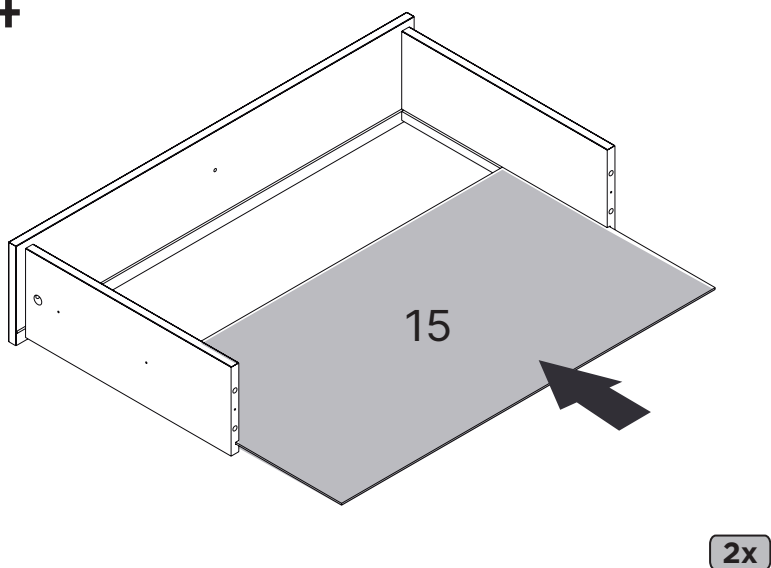

25

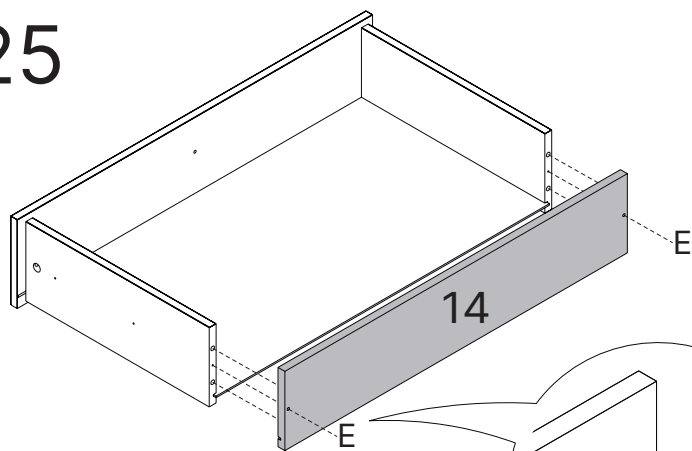

2x

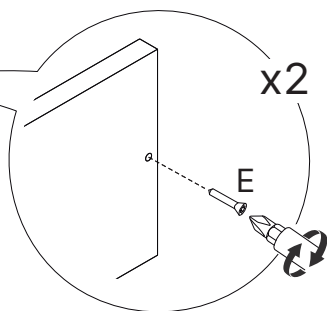

26

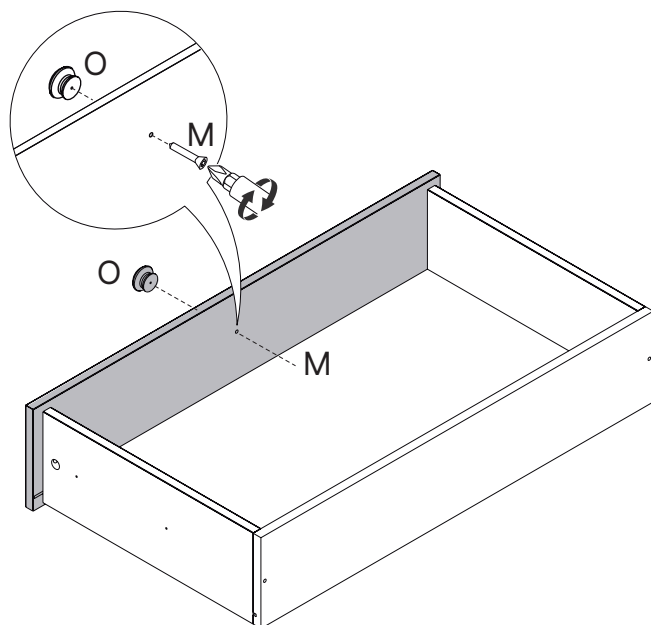

2x

27

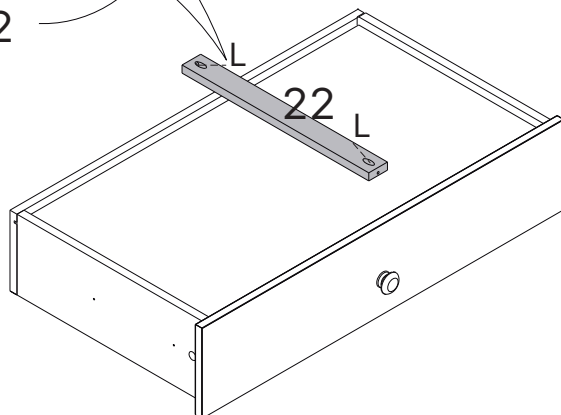
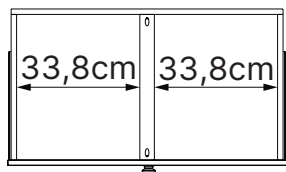
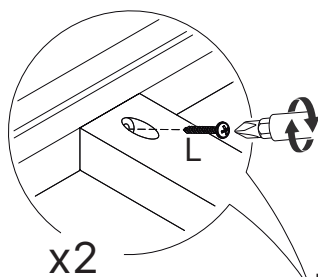

2x

28

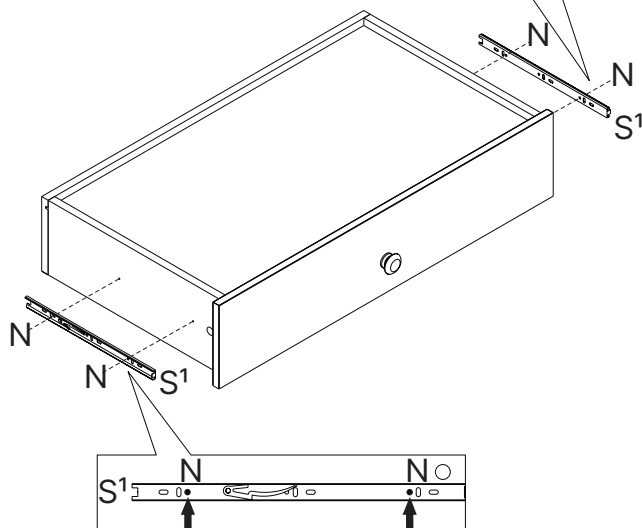
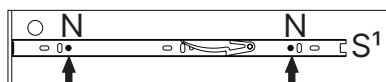

2x

29

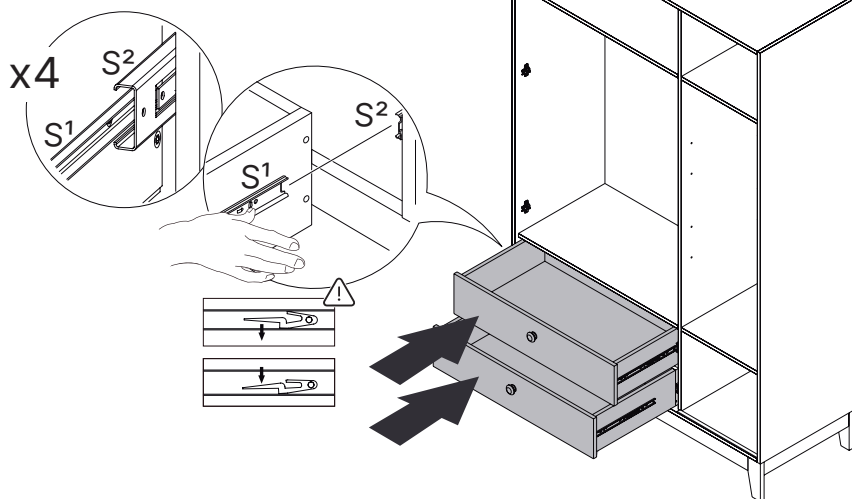

30

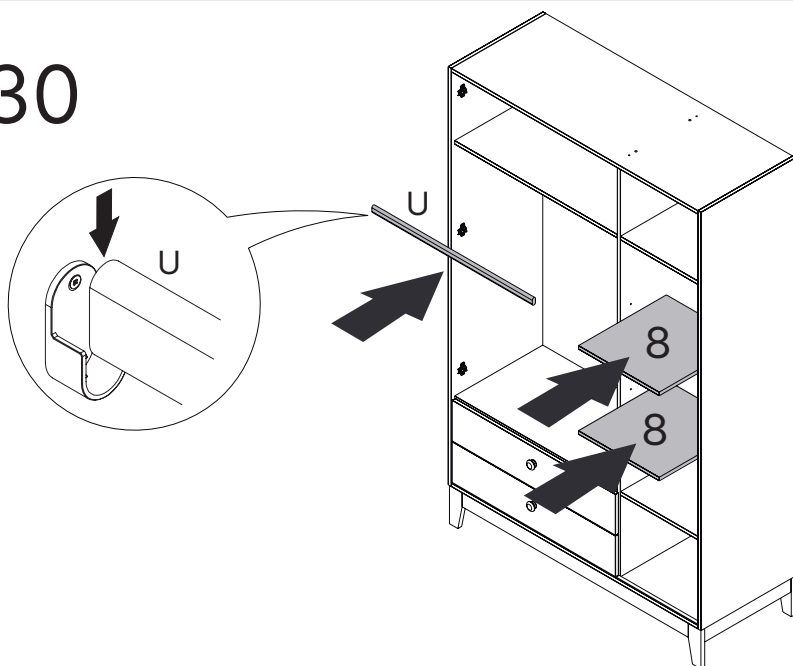

31

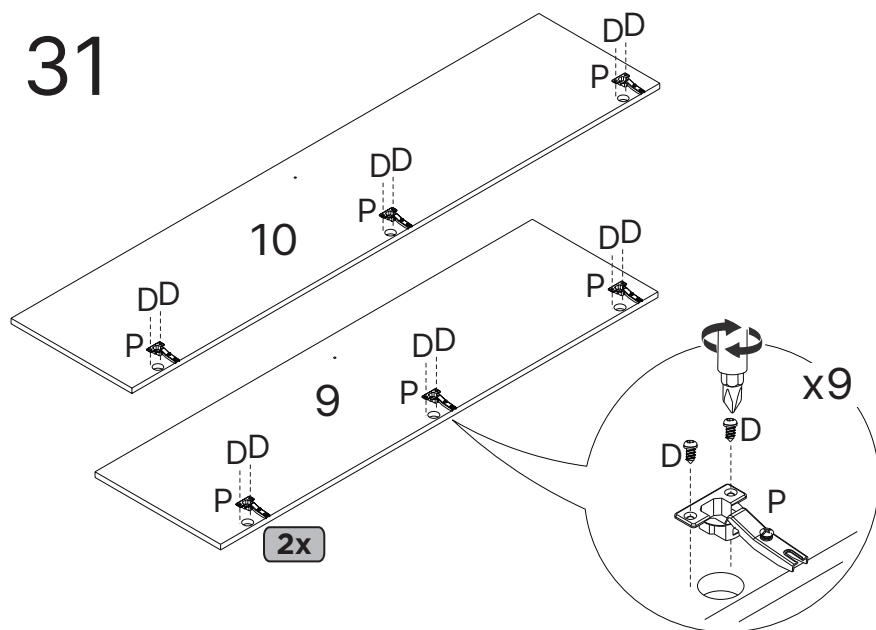

32

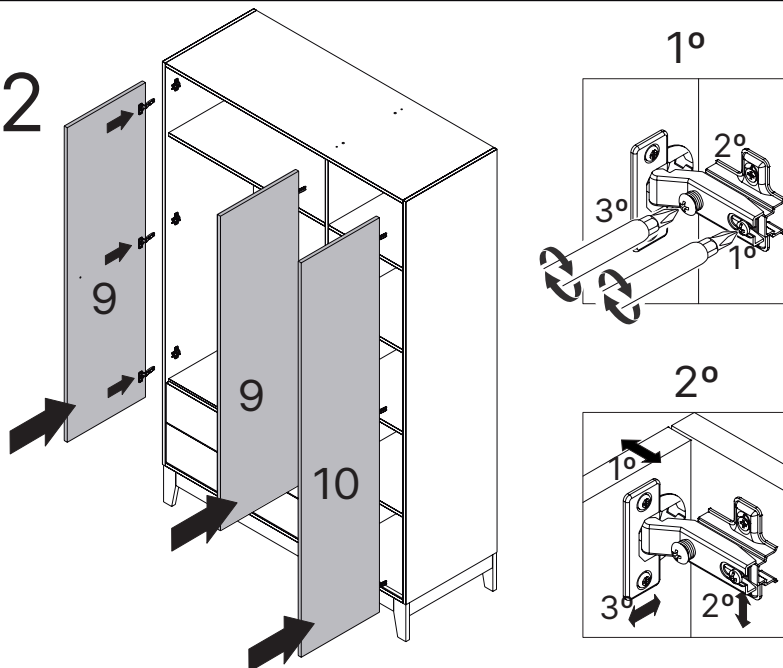

13

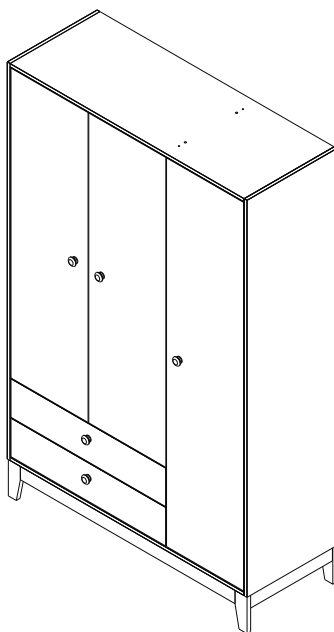
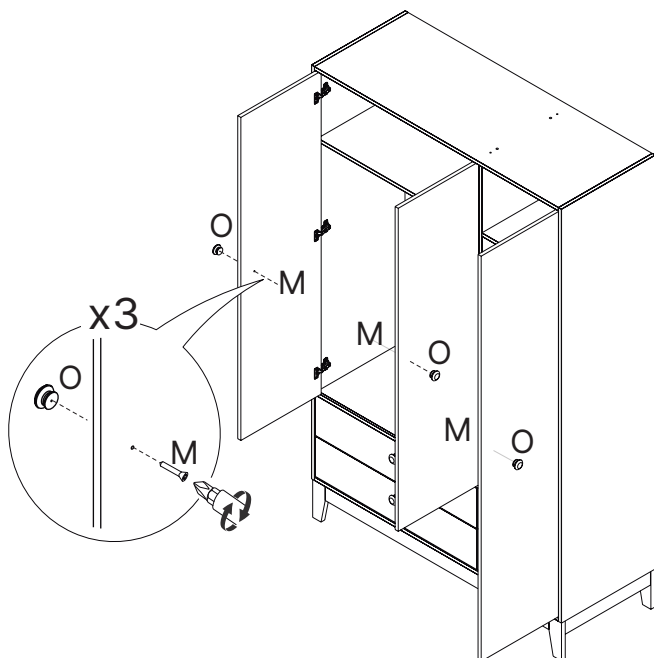

Dicas para assegurar a garantia e prolongar a vida útil do seu móvel

Limpeza

Use um pano macio, levemente umedecido com água. É possível o uso de detergente neutro, ou sabão neutro com água.

Manutenção

Para garantir estabilidade e durabilidade, é recomendado reapertar os parafusos de tempos em tempos.

Ventilação

A falta de ventilação e excesso de calor pode prejudicar a durabilidade e acabamento do produto.

madeira
madeira
CABE
CASA

V.03

