

GUARDA ROUPA PEÔNIA

Informações Úteis

Para assegurar a garantia, é recomendada a prévia conferência das peças e componentes, bem como a leitura do guia de montagem.

Qualquer dúvida sobre os nossos produtos você pode entrar em contato via nosso canal de atendimento: **<https://www.madeira-madeira.com.br/atendimento>**

Limpeza

- Para começar a limpeza, retire o pó com fanela seca, depois use um pano macio, levemente umedecido com água. É possível o uso de detergente neutro, ou sabão neutro com água.
- De tempos em tempos, reaperte os parafusos do produto para garantir sua estabilidade e durabilidade.
- Tenha cuidado com a disposição de aparelhos eletrônicos sobre o móvel, a falta de ventilação e excesso de calor pode prejudicar a durabilidade e acabamento do seu produto.

Para mais dicas amigas e inspirações de decoração acesse nosso Blog: **<https://www.madeiramadeira.com.br/central-de-dicas>**

Siga MadeiraMadeira:



[madeiramadeira.com.br](https://www.madeiramadeira.com.br)

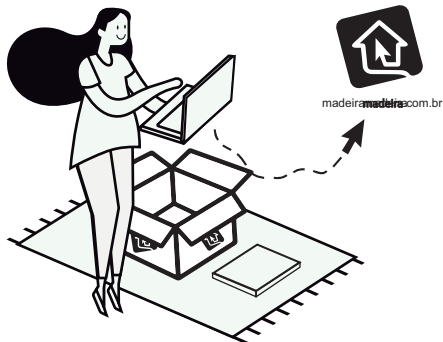
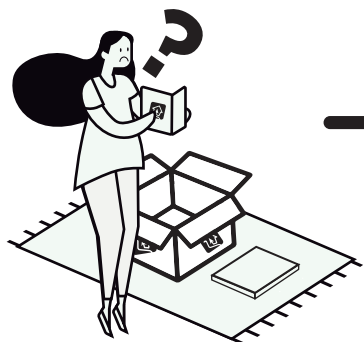
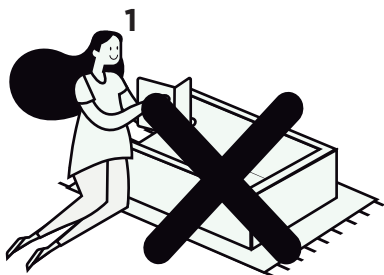

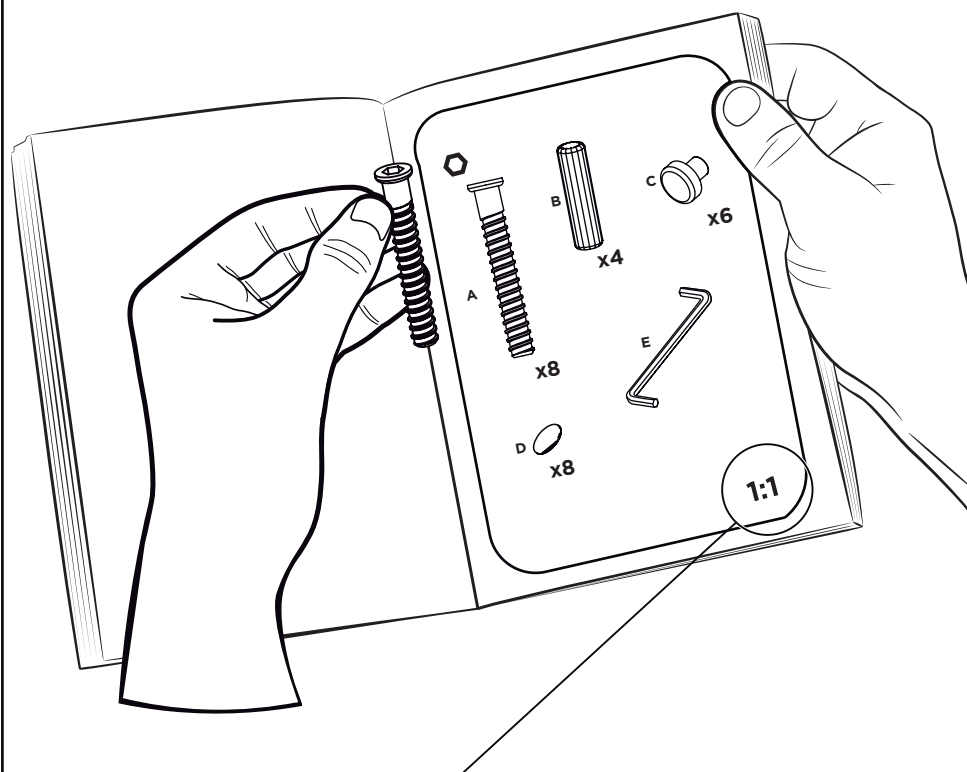

Preste Atenção!

As ferragens dos nossos manuais são sempre apresentadas nas mesmas proporções da peça na vida real. Caso apareça alguma dúvida no decorrer do processo de montagem, coloque a ferragem ao lado do desenho e faça a consulta :D



Símbolos:

- + Parafuso Phillips
- Parafuso Fenda
- ⬡ Parafuso Allen

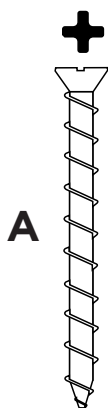

A

x22

B

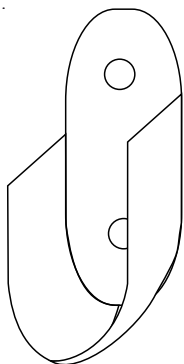

x4

C



X50

D



X60

E

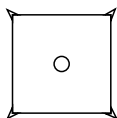

X18

F

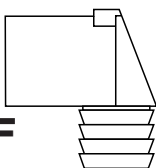

X8

G



X8

H



X8

I

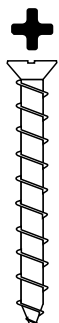

X8

J



X18

K



X32

L



X12

1:1

M



X6

N

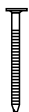

X12

O



X22

P



X08

+

R



Q



X12

X12

1:1

S



X4

T



X2

U



X1

V



X1

X



X2

Y



X4

W



X4

Z



X2

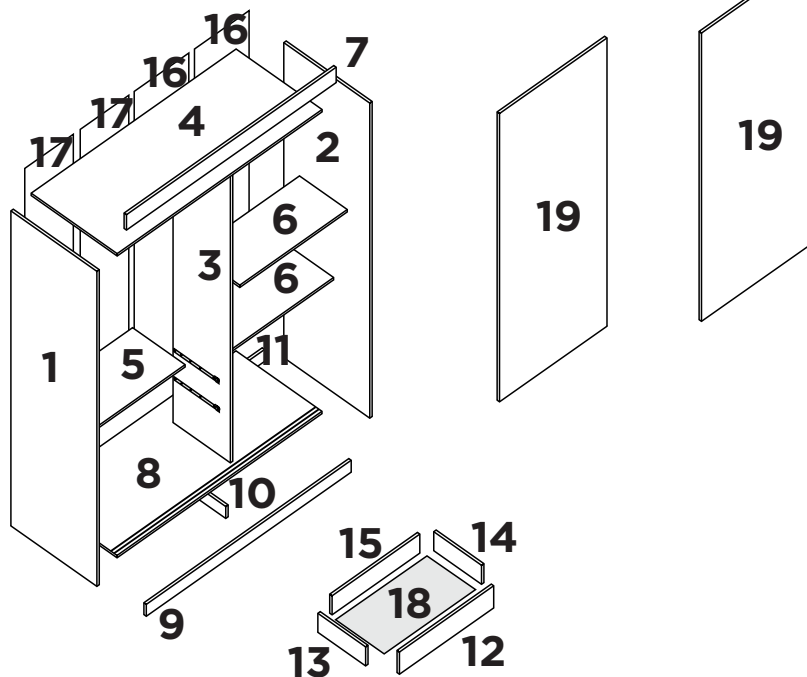

VERSÕES:					2 Portas de Correr sem Espelho							
Nº	Característica	Mat / Prim a	Medidas		Qtd	Branco	Int / Ext	Branco C/ Macadâmia	Int / Ext	Preto	Int / Ext	
						20033290		20493290		20913290		
01	Lateral Esquerda	Mdp	1987	X 540 X	12	01	32901.1	B	32901.2	B	32901.3	P
02	Lateral Direita	Mdp	1987	X 540 X	12	01	32902.1	B	32902.2	B	32902.3	P
03	Divisória	Mdp	1831	X 360 X	12	01	32903.1	B	32903.2	B	32903.3	P
04	Chapéu	Mdp	1287	X 540 X	12	01	32904.1	B	32904.2	B	32904.3	P
05	Tampo das Gavetas	Mdp	583	X 330 X	12	01	32905.1	B	32905.2	B	32905.3	P
06	Prateleiras	Mdp	692	X 330 X	12	02	32906.1	B	32906.2	B	32906.3	P
07	Frontal do Chapéu	Mdp	1311	X 97 X	27	01	32907.1	B	32907.2	B	32907.3	P
08	Base	Mdp	1287	X 540 X	12	01	32908.1	B	32908.2	B	32908.3	P
09	Rodapé Dianteiro	Mdp	1287	X 75 X	12	01	32909.1	B	32909.2	B	32909.3	P
10	Travessa do Rodapé	Mdp	500	X 75 X	12	01	32910.1	B	32910.2	B	32910.3	P
11	Rodapé Traseiro	Mdp	1287	X 75 X	12	01	32911.1	S/ Pad	32911.2	S/ Pad	32911.3	S/ Pad
12	Fronte das Gavetas	Mdp	575	X 140 X	12	02	32912.1	S/ Pad	32912.2	S/ Pad	32912.3	S/ Pad
13	Laterais de Gaveta Esquerda	Mdp	300	X 120 X	12	02	32913.1	B	32913.2	B	32913.3	P
14	Laterais de Gaveta Direita	Mdp	300	X 120 X	12	02	32914.1	B	32914.2	B	32914.3	P
15	Contra Fundo	Mdp	534	X 120 X	12	02	32915.1	B	32915.2	B	32915.3	P
16	Fundo do Armário Direito	Mdf	1855	X 350 X	2,8	02	32916.1	B	32916.2	B	32916.3	P
17	Fundo do Armário Esquerdo	Mdf	1855	X 295 X	2,8	02	32917.1	B	32917.2	B	32917.3	P
18	Fundo das Gavetas	Mdf	556	X 305 X	2,8	02	32918.1	B	32918.2	B	32918.3	P
19	Portas	Mdp	1820	X 645 X	15	02	32919.1	B	32919.2	B/ M	32919.3	B/ P
24	Espelho		637	X 605 X	3		32924.1		32924.2		32924.3	

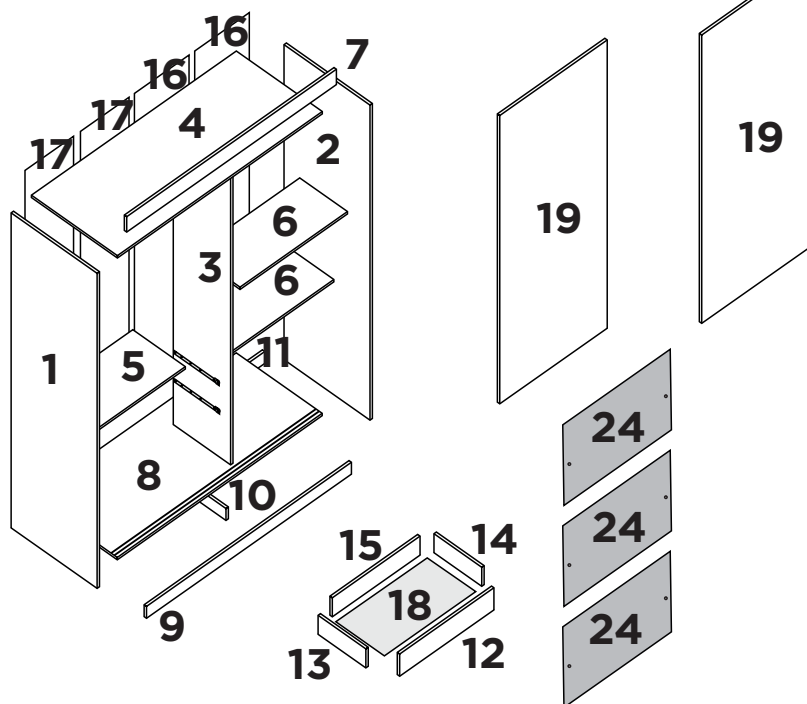

VERSÕES:								2 Portas de Correr C/ 1 Porta com Espelho						
Nº	Característica	Mat / Prim a	Medidas				Qtd	Branco	Int / Ext	Branco C/ Macadâmia	Int / Ext	Preto	Int / Ext	
								20033270		20493270		20913270		
01	Lateral Esquerda	Mdp	1987	X	540	X	12	01	32701.1	B	32701.2	B	32701.3	P
02	Lateral Direita	Mdp	1987	X	540	X	12	01	32702.1	B	32702.2	B	32702.3	P
03	Divisória	Mdp	1831	X	360	X	12	01	32703.1	B	32703.2	B	32703.3	P
04	Chapéu	Mdp	1287	X	540	X	12	01	32704.1	B	32704.2	B	32704.3	P
05	Tampo das Gavetas	Mdp	583	X	330	X	12	01	32705.1	B	32705.2	B	32705.3	P
06	Prateleiras	Mdp	692	X	330	X	12	02	32706.1	B	32706.2	B	32706.3	P
07	Frontal do Chapéu	Mdp	1311	X	97	X	27	01	32707.1	B	32707.2	B	32707.3	P
08	Base	Mdp	1287	X	540	X	12	01	32708.1	B	32708.2	B	32708.3	P
09	Rodapé Dianteiro	Mdp	1287	X	75	X	12	01	32709.1	B	32709.2	B	32709.3	P
10	Travessa do Rodapé	Mdp	500	X	75	X	12	01	32710.1	B	32710.2	B	32710.3	P
11	Rodapé Traseiro	Mdp	1287	X	75	X	12	01	32711.1	S / Pad	32711.2	S / Pad	32711.3	S / Pad
12	Frete das Gavetas	Mdp	575	X	140	X	12	02	32712.1	S / Pad	32712.2	S / Pad	32712.3	S / Pad
13	Laterais de Gaveta Esquerda	Mdp	300	X	120	X	12	02	32713.1	B	32713.2	B	32713.3	P
14	Laterais de Gaveta Direita	Mdp	300	X	120	X	12	02	32714.1	B	32714.2	B	32714.3	P
15	Contra Fundo	Mdp	534	X	120	X	12	02	32715.1	B	32715.2	B	32715.3	P
16	Fundo do Armário Direito	Mdf	1855	X	350	X	3	02	32716.1	B	32716.2	B	32716.3	P
17	Fundo do Armário Esquerdo	Mdf	1855	X	295	X	3	02	32717.1	B	32717.2	B	32717.3	P
18	Fundo das Gavetas	Mdf	556	X	305	X	3	02	32718.1	B	32718.2	B	32718.3	P
19	Portas	Mdp	1820	X	645	X	15	02	32719.1	B	32719.2	B / M	32719.3	B / P
24	Espelho		637	X	605	X	3	03	32724.1		32724.2		32724.3	

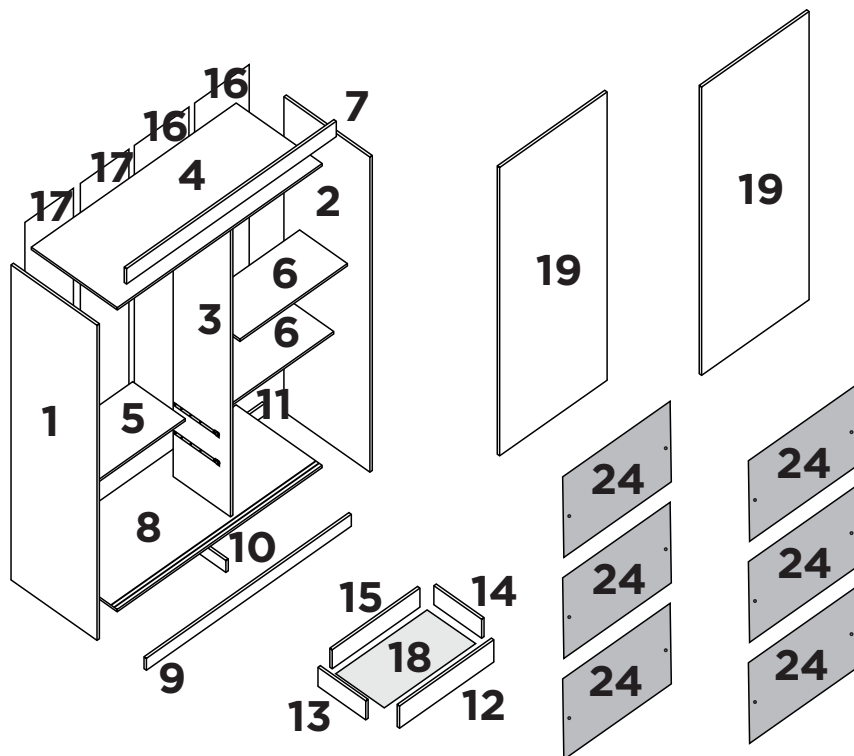

VERSÕES:

2 Portas de Correr com Espelho

Nº	Característica	Mat / Prim a	Medidas					Qtd	Branco	Int / Ext	Preto	Int / Ext
									20033280		20913280	
01	Lateral Esquerda	Mdp	1987	X	540	X	12	01	32801.1	B	32801.3	P
02	Lateral Direita	Mdp	1987	X	540	X	12	01	32802.1	B	32802.3	P
03	Divisória	Mdp	1831	X	360	X	12	01	32803.1	B	32803.3	P
04	Chapéu	Mdp	1287	X	540	X	12	01	32804.1	B	32804.3	P
05	Tampo das Gavetas	Mdp	583	X	330	X	12	01	32805.1	B	32805.3	P
06	Prateleiras	Mdp	692	X	330	X	12	02	32806.1	B	32806.3	P
07	Frontal do Chapéu	Mdp	1311	X	97	X	27	01	32807.1	B	32807.3	P
08	Base	Mdp	1287	X	540	X	12	01	32808.1	B	32808.3	P
09	Rodapé Dianteiro	Mdp	1287	X	75	X	12	01	32809.1	B	32809.3	P
10	Travessa do Rodapé	Mdp	500	X	75	X	12	01	32810.1	B	32810.3	P
11	Rodapé Traseiro	Mdp	1287	X	75	X	12	01	32811.1	S / Pad	32811.3	S / Pad
12	Frete das Gavetas	Mdp	575	X	140	X	12	02	32812.1	S / Pad	32812.3	S / Pad
13	Laterais de Gaveta Esquerda	Mdp	300	X	120	X	12	02	32813.1	B	32813.3	P
14	Laterais de Gaveta Direita	Mdp	300	X	120	X	12	02	32814.1	B	32814.3	P
15	Contra Fundo	Mdp	534	X	120	X	12	02	32815.1	B	32815.3	P
16	Fundo do Armário Direito	Mdf	1855	X	350	X	3	02	32816.1	B	32816.3	P
17	Fundo do Armário Esquerdo	Mdf	1855	X	295	X	3	02	32817.1	B	32817.3	P
18	Fundo das Gavetas	Mdf	556	X	305	X	3	02	32818.1	B	32818.3	P
19	Portas	Mdp	1820	X	645	X	15	02	32819.1	B	32819.3	B / P
24	Espelho		637	X	605	X	3	06	32824.1		32824.3	

1

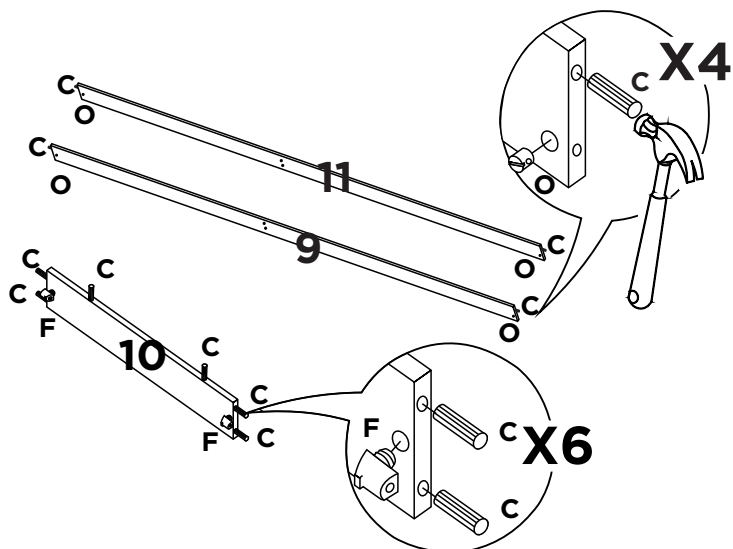

2

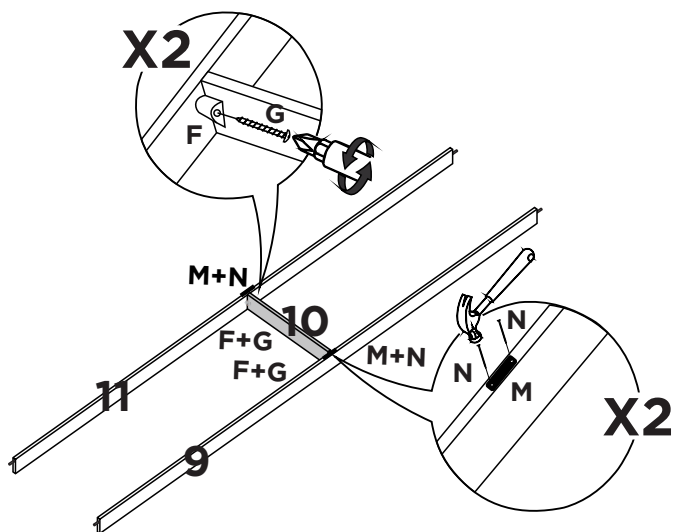

3

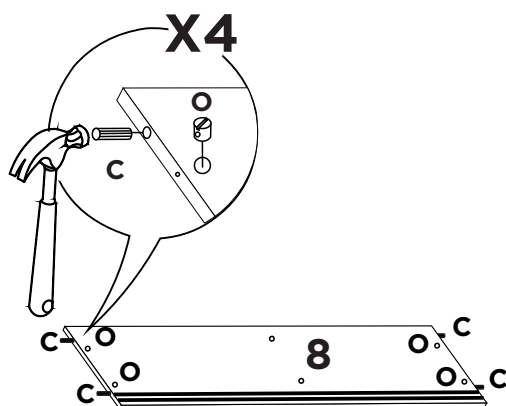

4

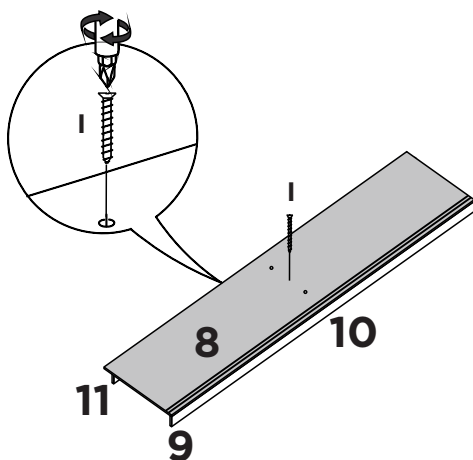

5

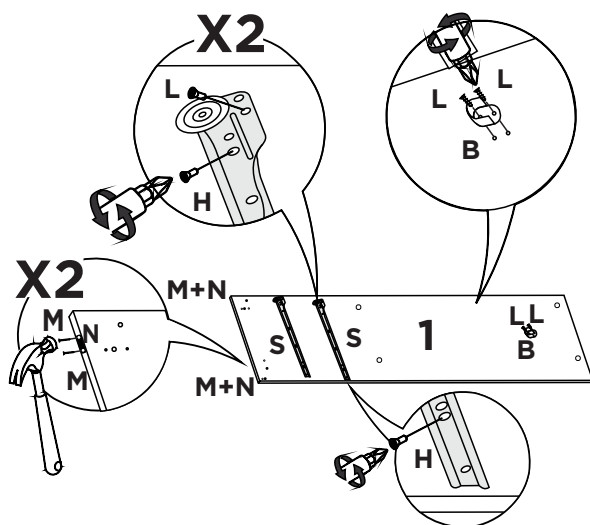

6

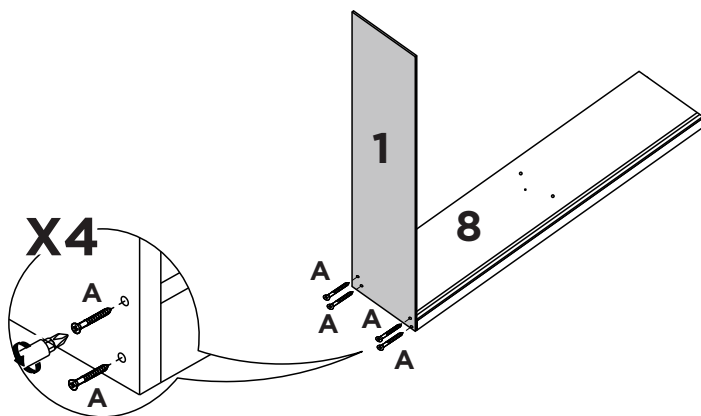

7

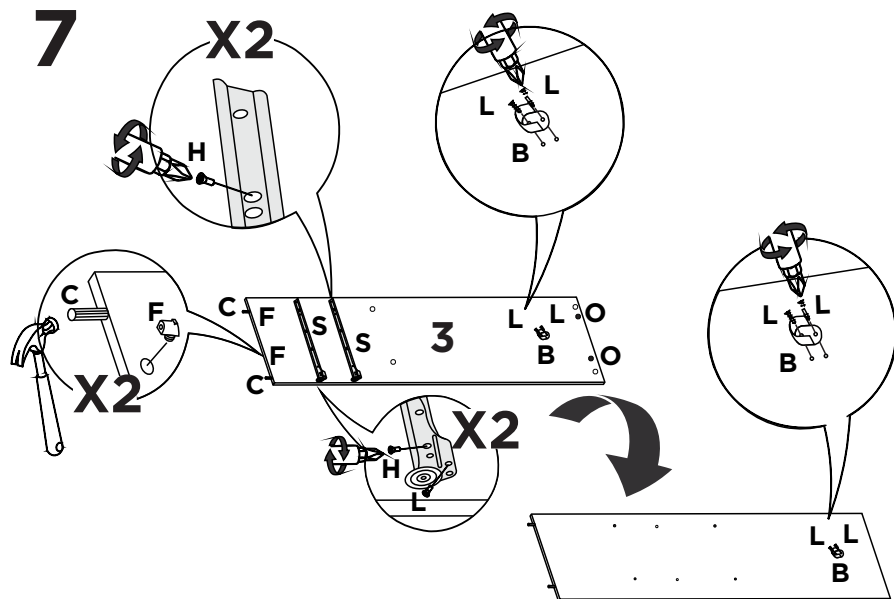

8

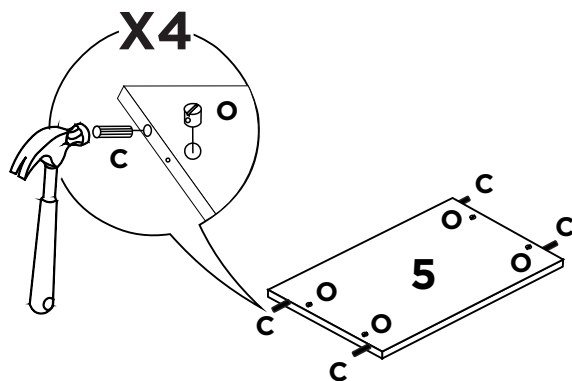

9

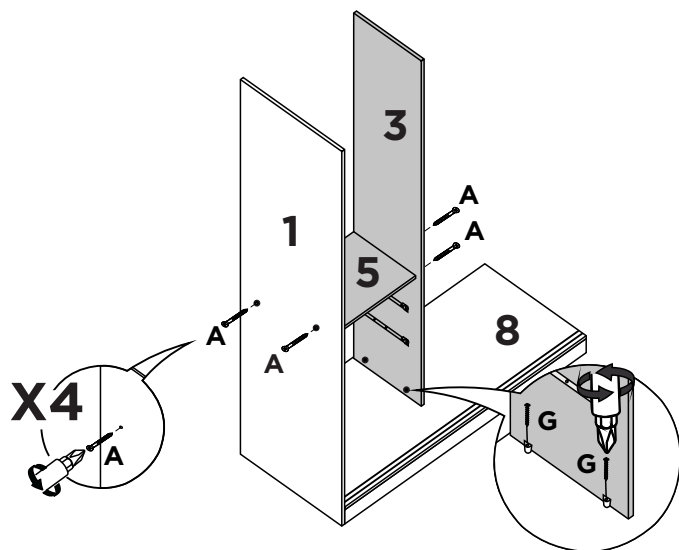

10

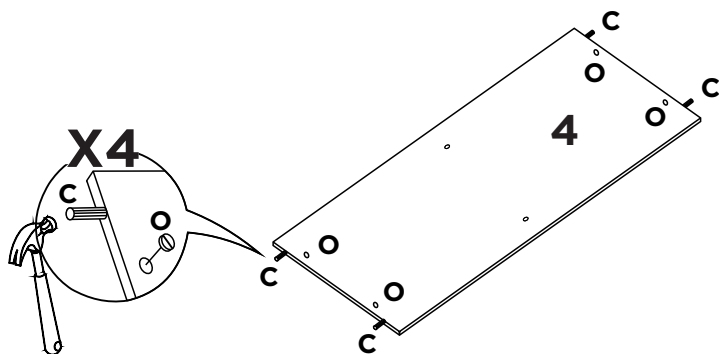

11

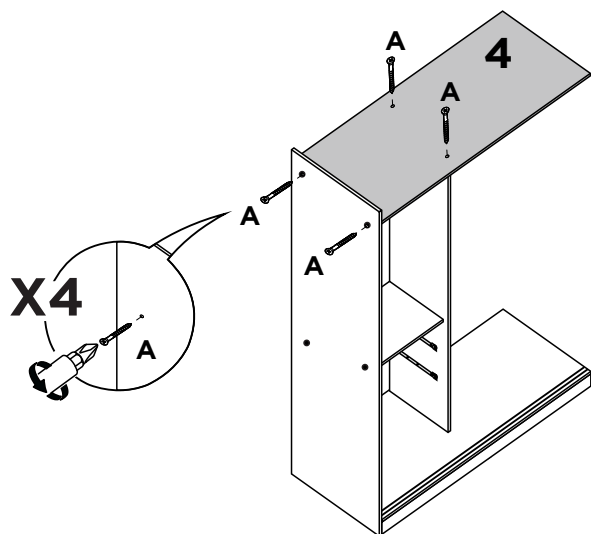

12

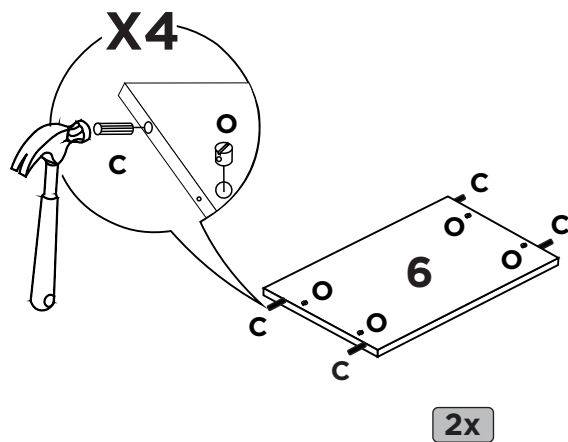

13

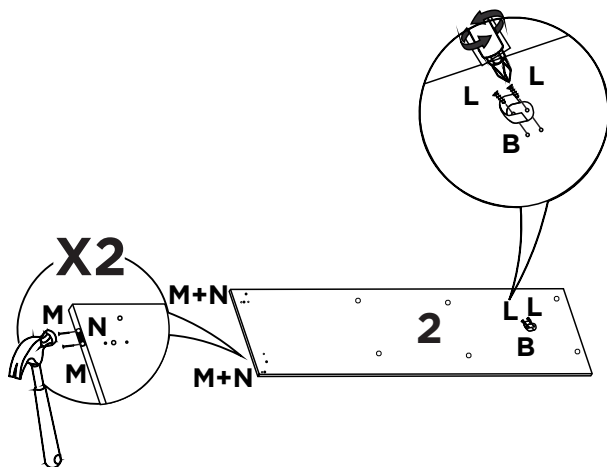

14

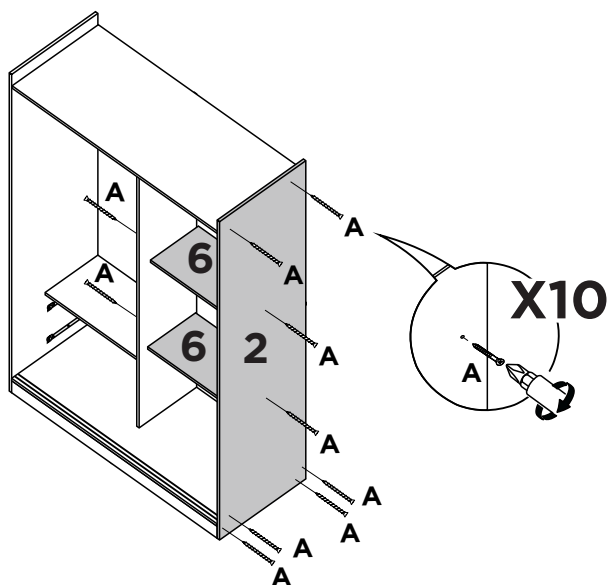

15

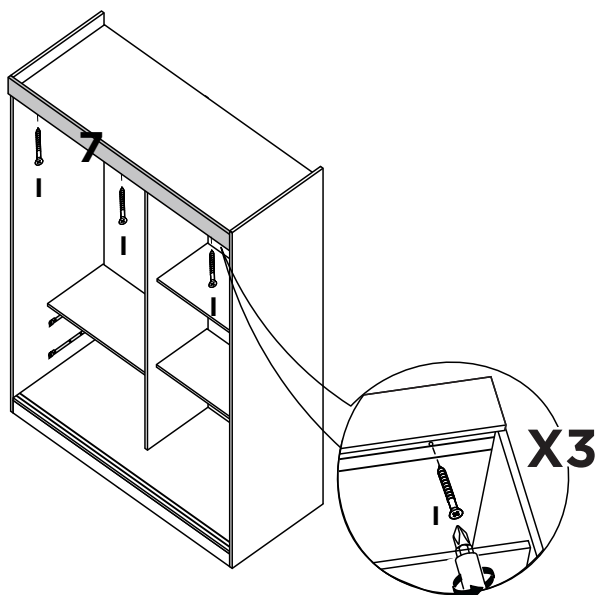

16

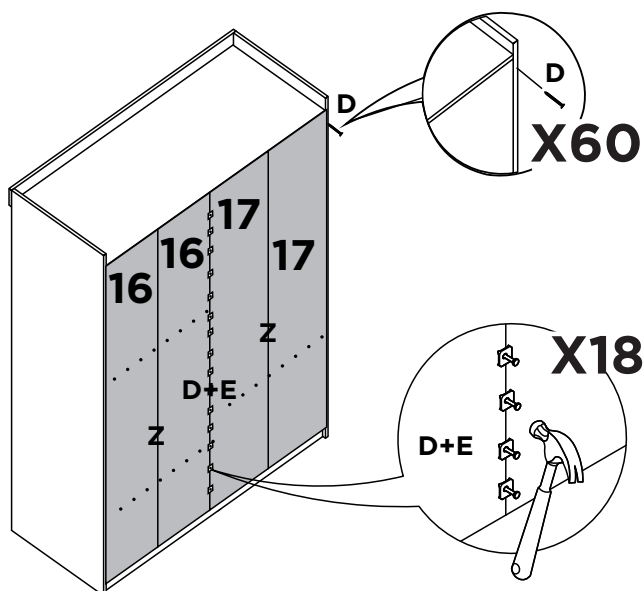

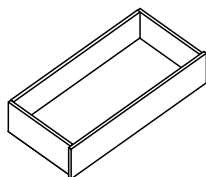

2x

17

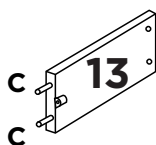

2x

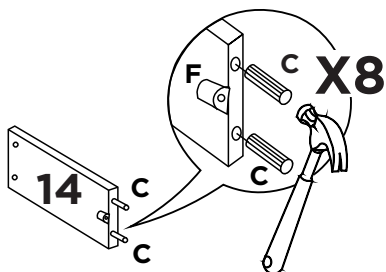

18

2x

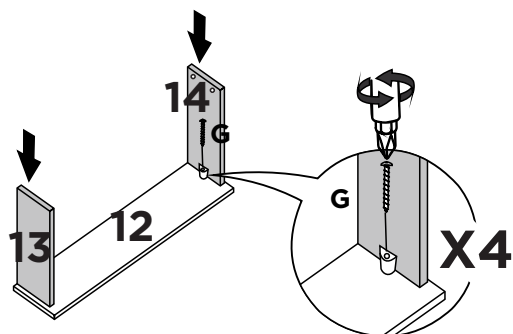

19

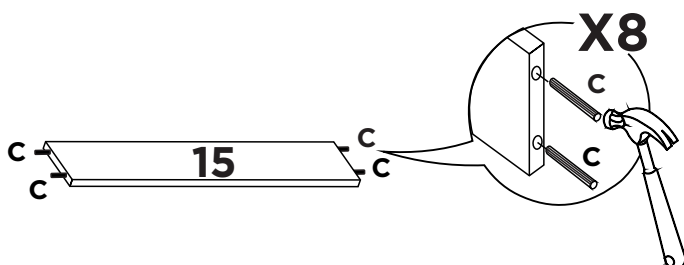

2x

20

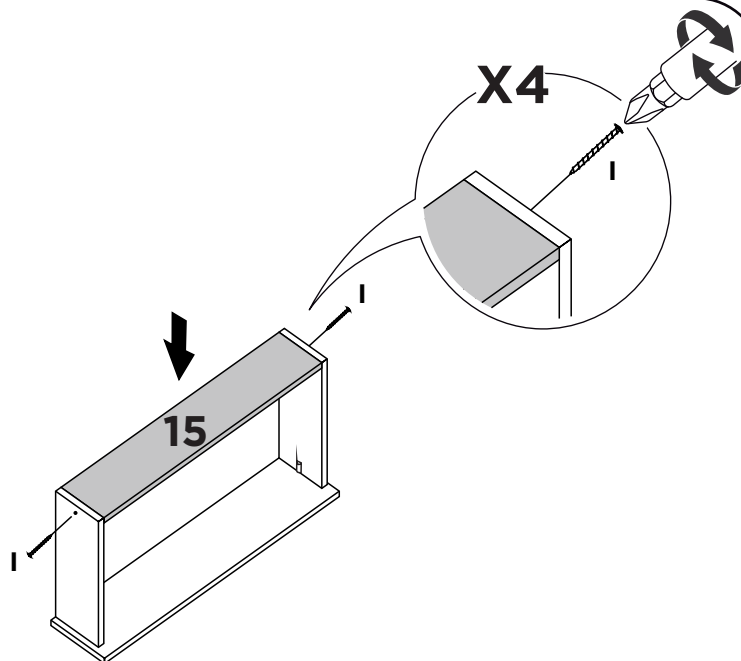

2x

21

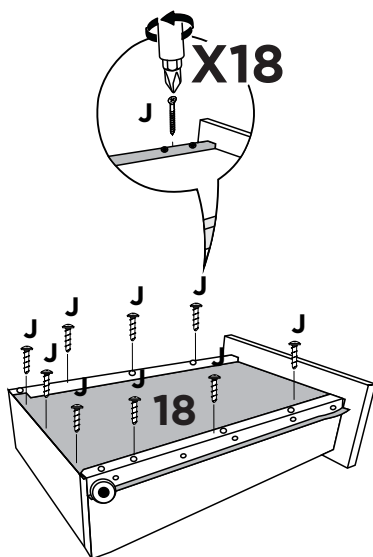

2x

22

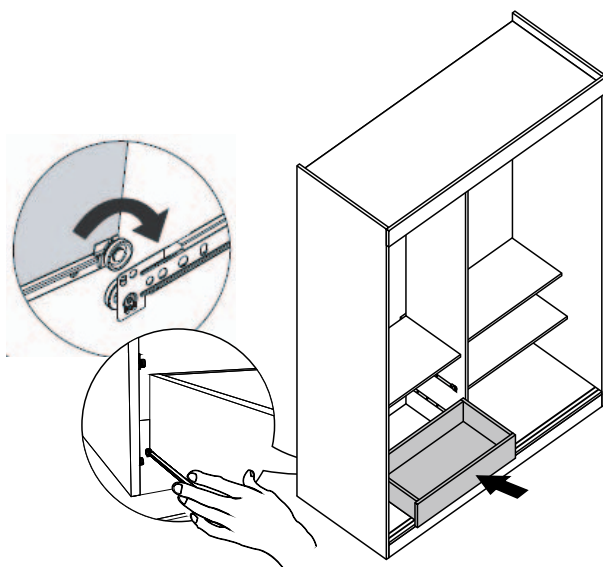

23

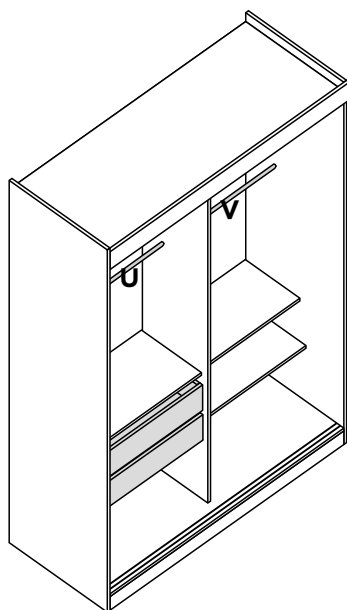

24

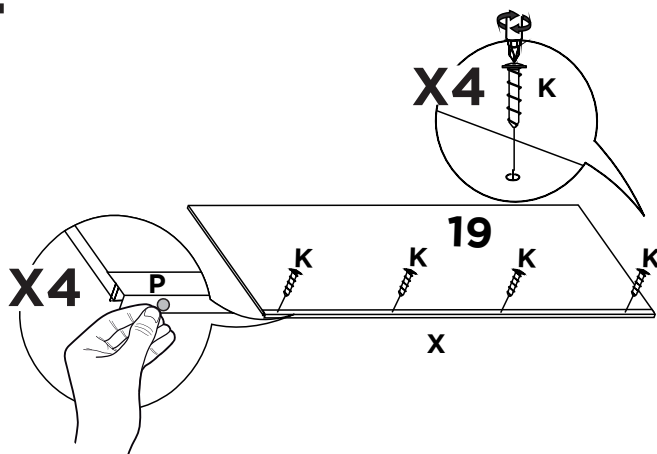

2x

25

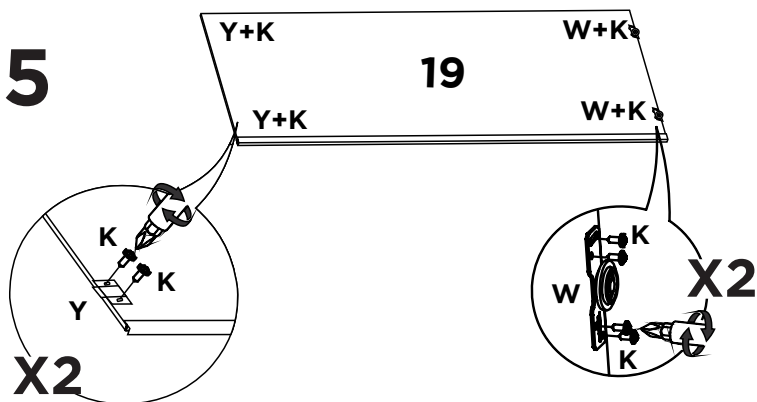

ATENÇÃO

Atenção na fita dupla face , para não ter avarias.

26

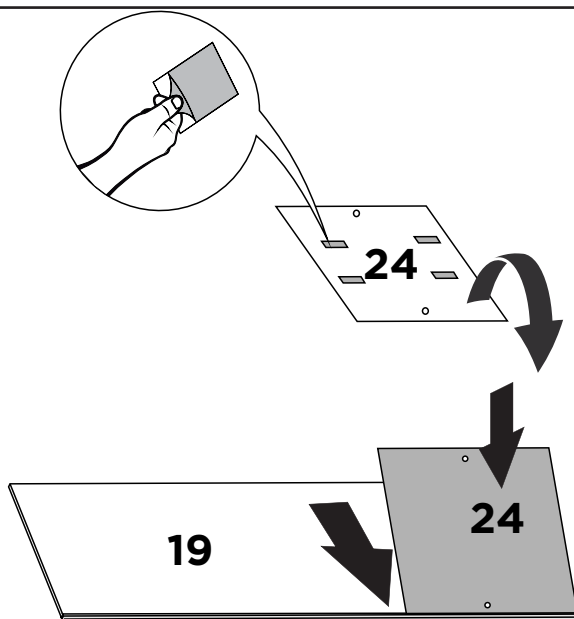

ATENÇÃO NA MONTAGEM!

Retirar a fita dupla face, encostar o espelho no puxador faceando com o topo da porta,
É obrigatório a fixação dos parafusos.

27

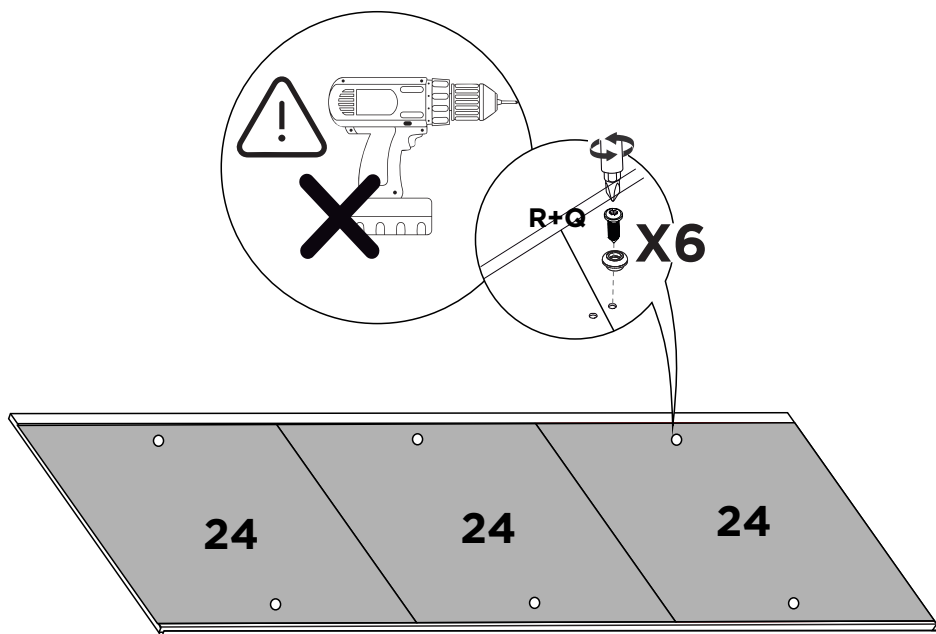

ATENÇÃO NA MONTAGEM!

Obrigatório a utilização da chave philips p/ fixação dos espelhos, apertar devagar e com cuidado para não estourar o espelho.

28

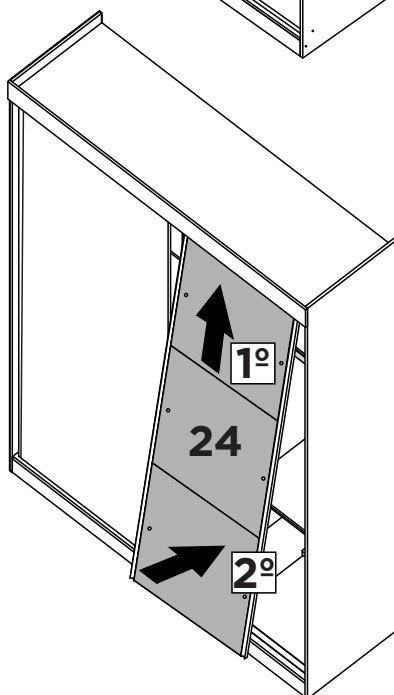
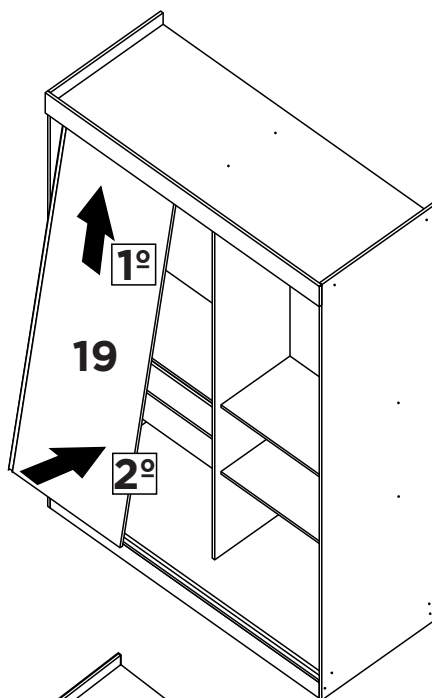
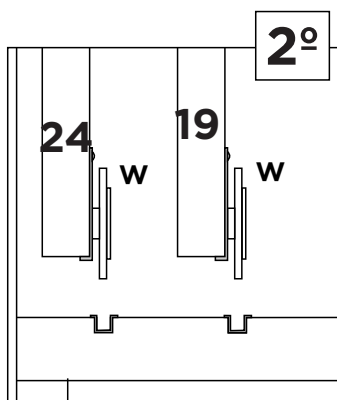
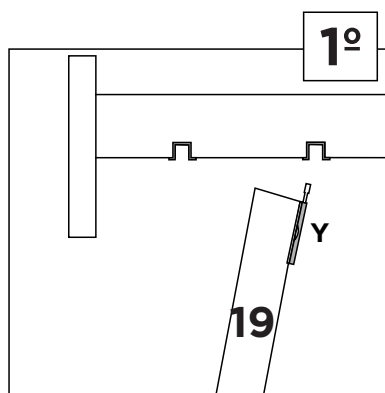

29

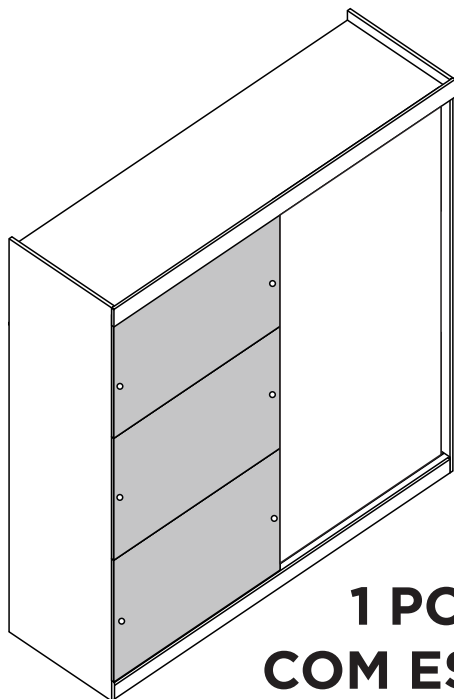

**1 PORTA
COM ESPELHO**

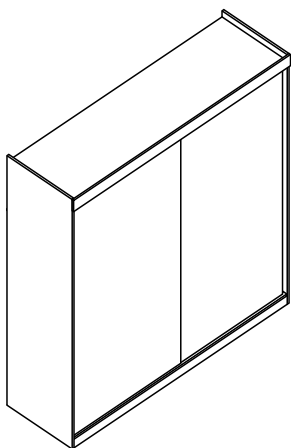

SEM ESPELHO

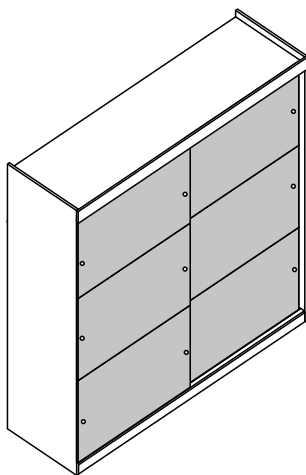

**2 PORTAS
COM ESPELHO**



yes casa
madeiramadeira
v01.