

CZ-101V

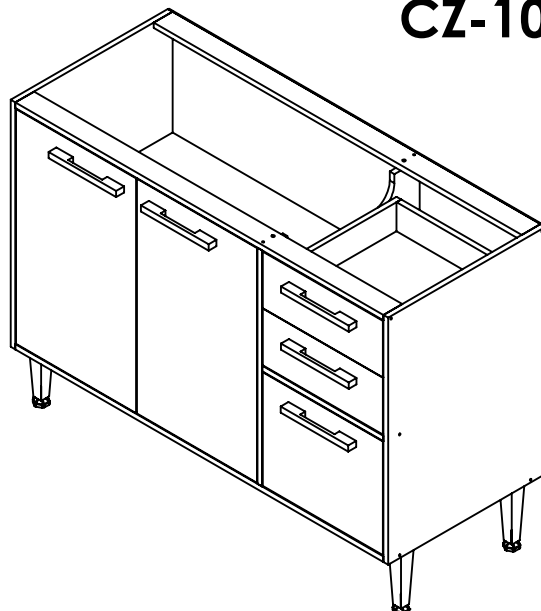

CZ-101S

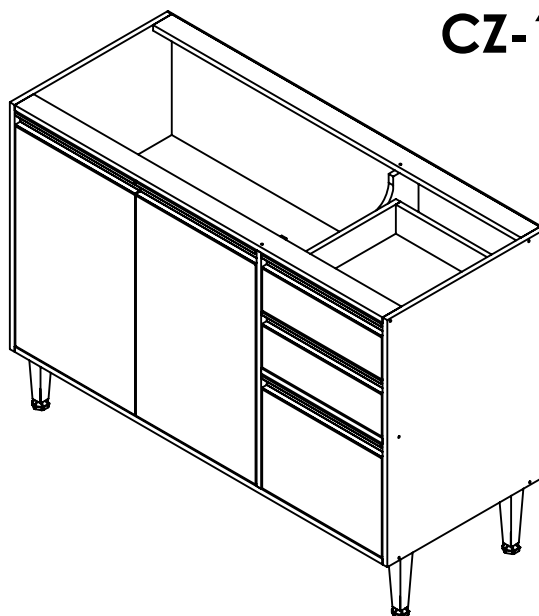

DICAS DE CONSERVAÇÃO

- Não utilizar na limpeza produtos abrasivos tais como: palha de aço, álcool, vinagre, limão, saponáceo, ou produtos corrosivos que possam riscar ou descolar a película protetora dos móveis;
- Na limpeza de móveis em geral, deve ser utilizado um pano levemente umedecido e sabão neutro;
- Para a movimentação do móvel, é importante que este seja levantado do chão, pois ao arrastá-lo pode causar avarias estruturais;
- Não deixe o móvel em exposição a intempéries;

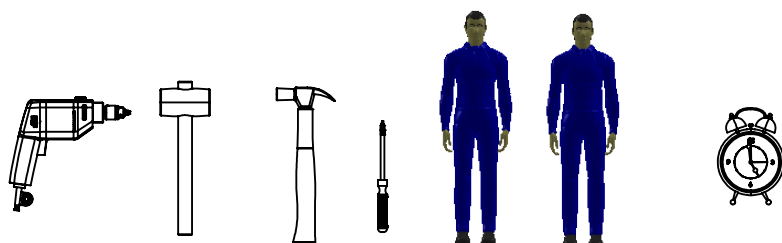

40 Min

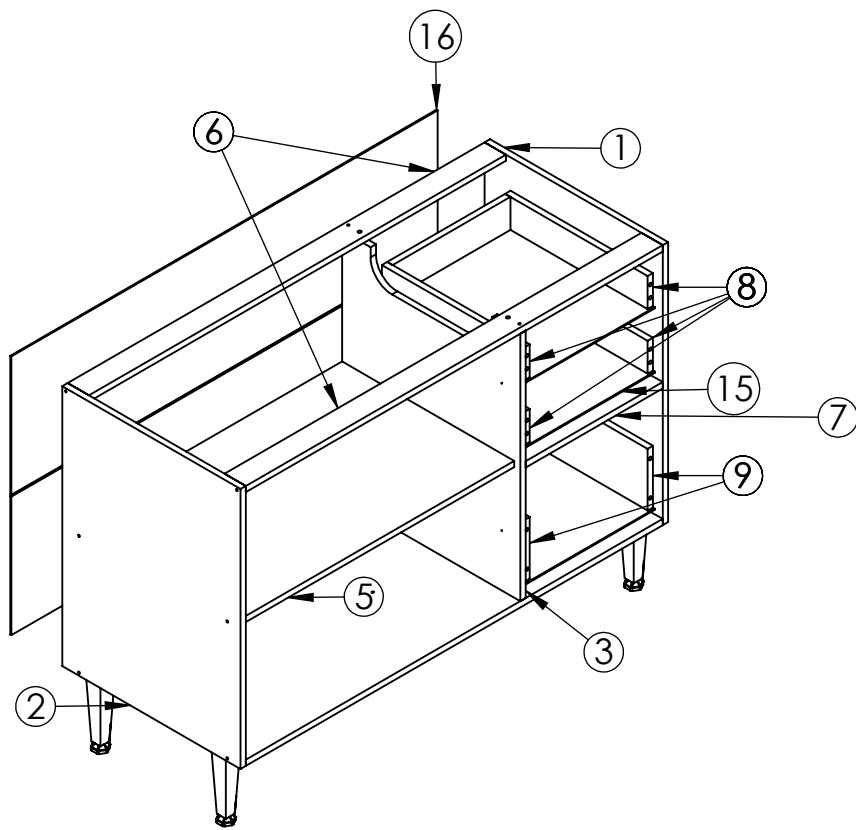

Nº	DESCRIÇÃO	QTD.
1	Lateral Direita	1
2	Lateral Esquerda	1
3	Divisão	1
4	Base	1
5	Prateleira	1
6	Travessa Maior	2
7	Travessa Menor	1
8	Lateral de Gaveta Menor	4
9	Lateral de Gaveta Maior	2
10	Costa de Gaveta Menor	2
11	Costa de Gaveta Maior	1
12	Porta	2
13	Frente de Gaveta Maior	1
14	Frente de Gaveta Menor	2
15	Fundo de Gaveta	3
16	Costa	2

CC - Cabeça Chata Cp - Cabeça Panela Cf - Cabeça Flangeada

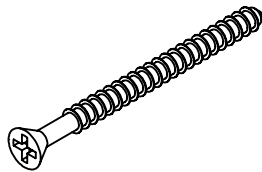

A Parafuso 4,5 x 45 CC 27

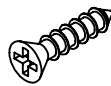

B Parafuso 3,5x12 CC 24



C Parafuso 3,5x12 CP 60

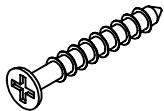

D Parafuso 4x25 CC 14

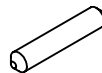

E Cavilha Madeira 8x30 30

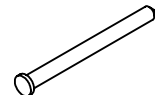

G Prego 10x10 100

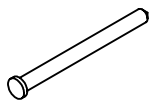

P Prego 12 x 12 14



H Chapa "L" 12

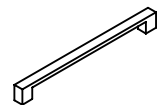

M Puxador 5



R Garra Costa 5

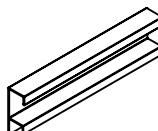

M Puxador 5

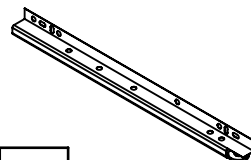

o Corrediça 3

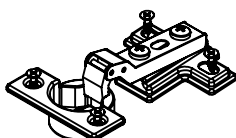

i DOBRADIÇA 4

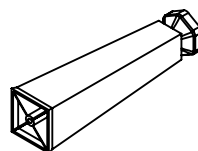

j Pé Plastico 5

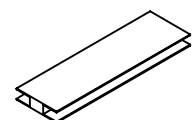

L PERFIL "H" 1

1

Montar as corrediças
conforme marcação na lateral

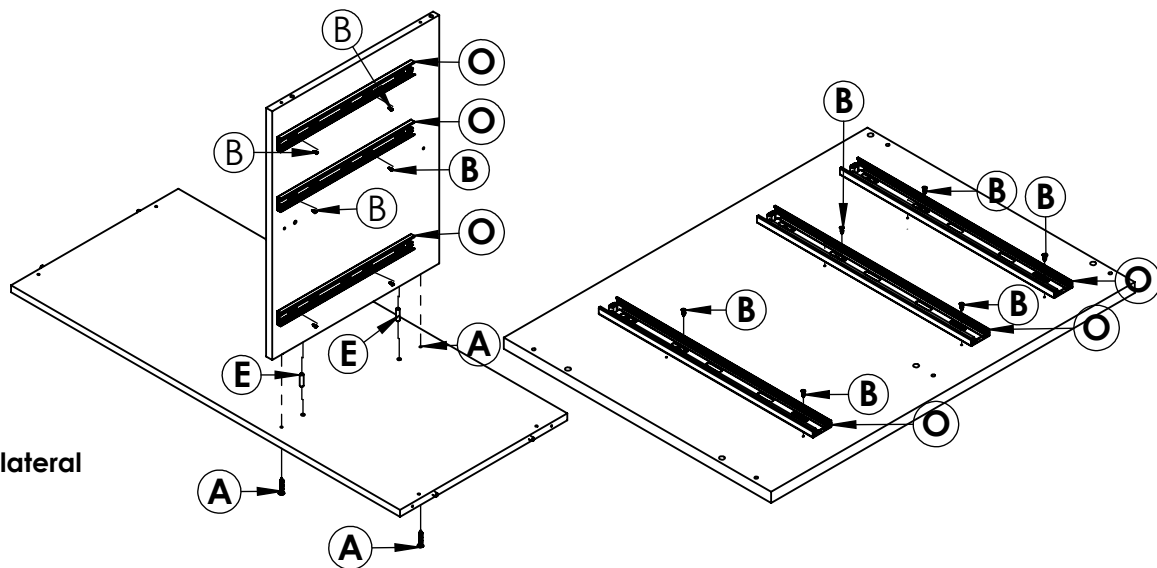

Utilizar Cola
nas Cavilhas

2

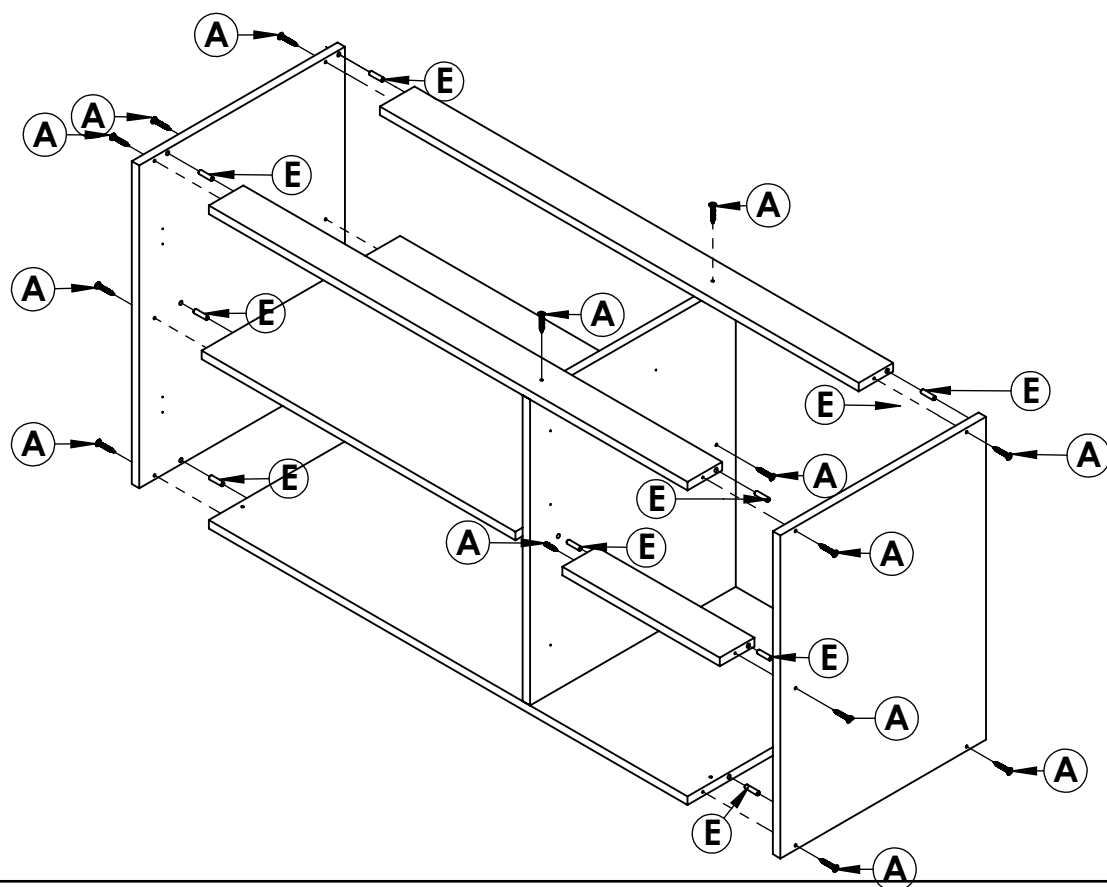

3

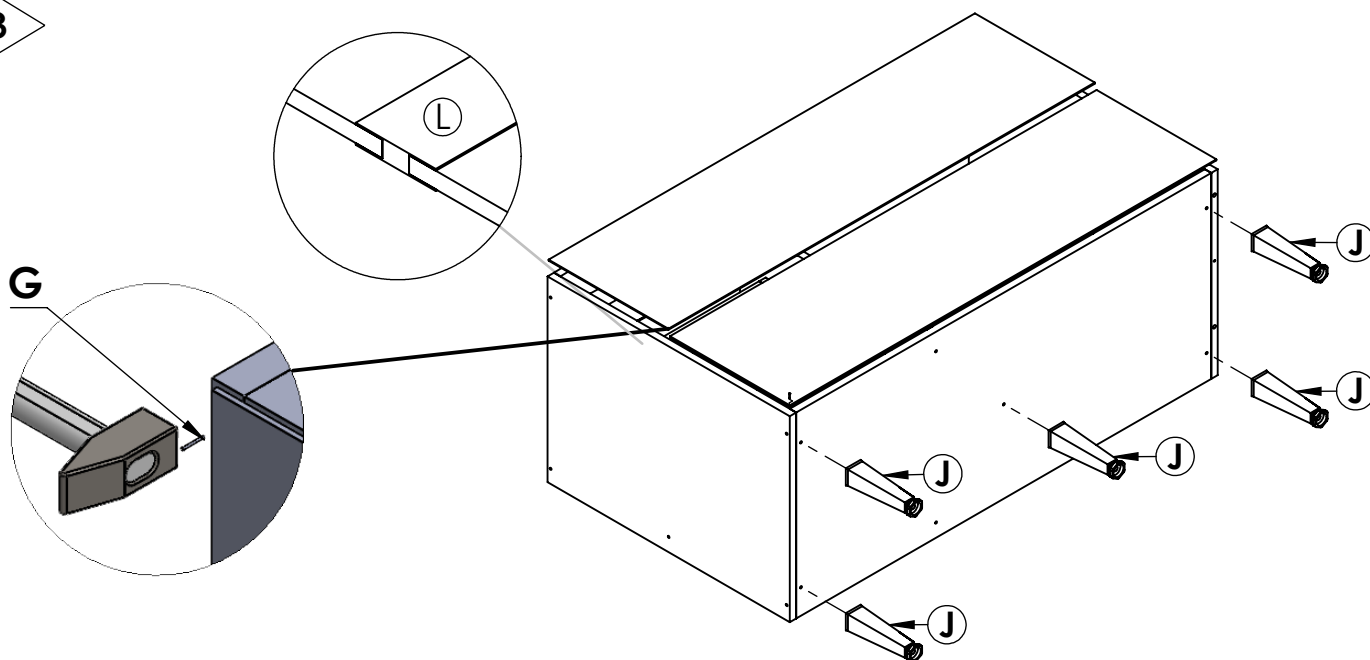

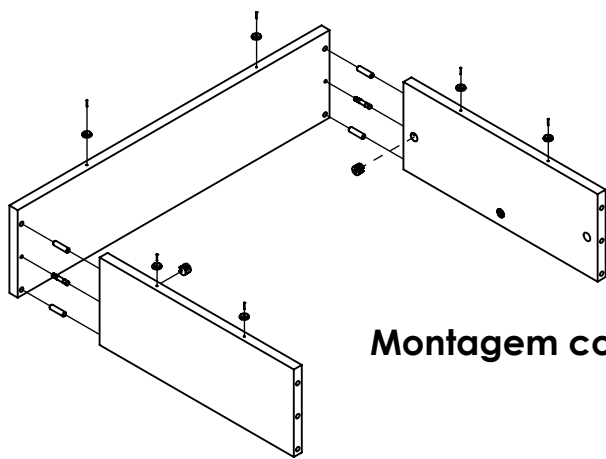

Montagem com rodapé

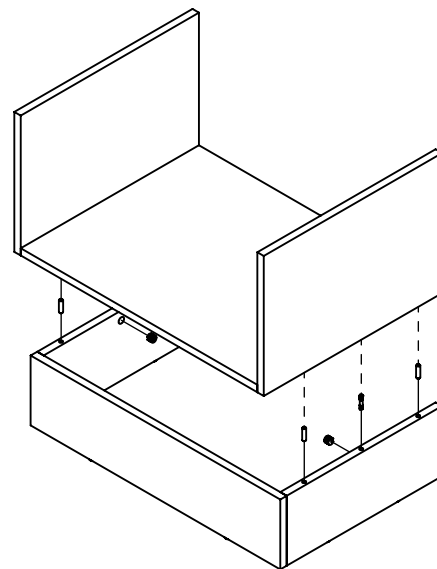

4

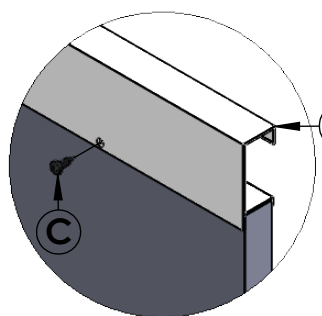
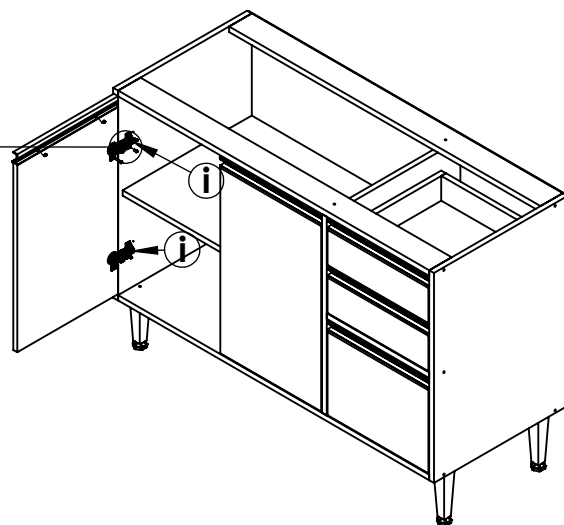
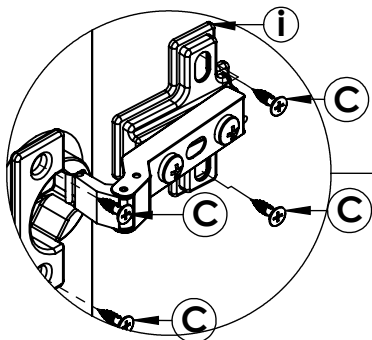

Montagem Puxador

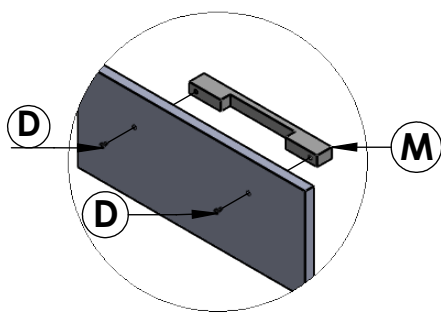

Montagem das Gavetas

5

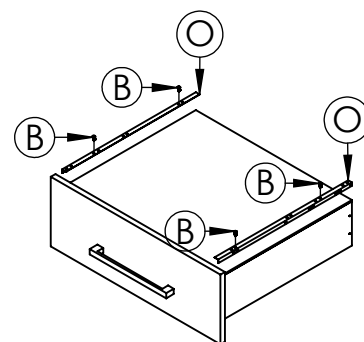
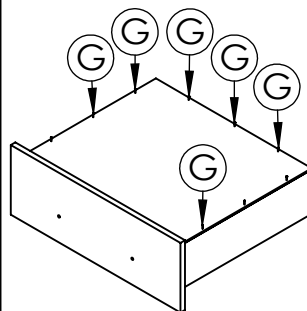
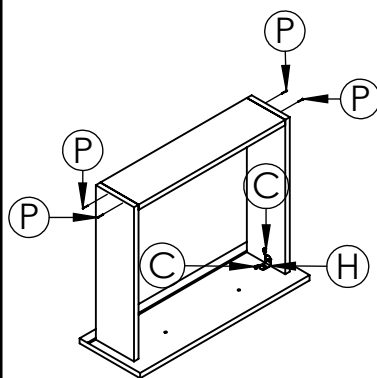
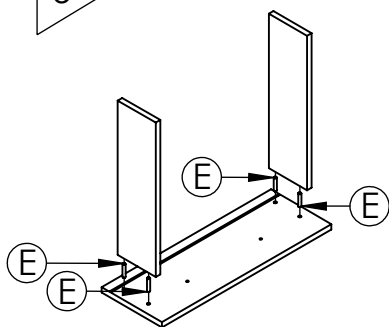

Regulagem da Porta

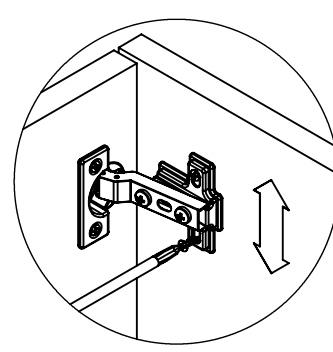
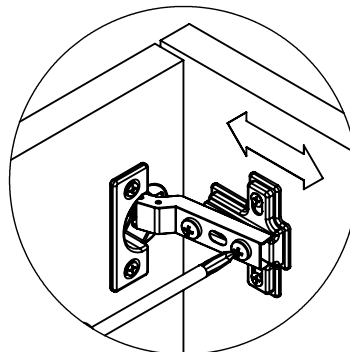
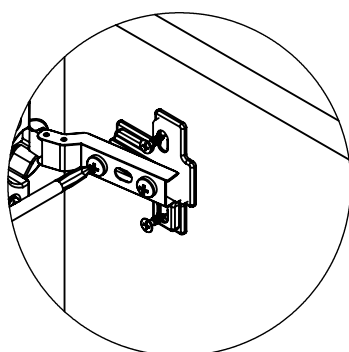
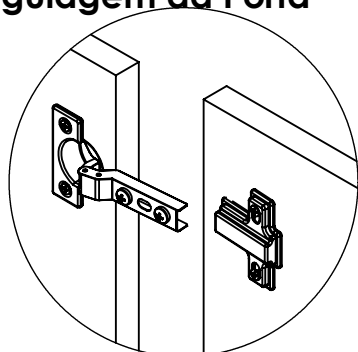

CZ-118/119V

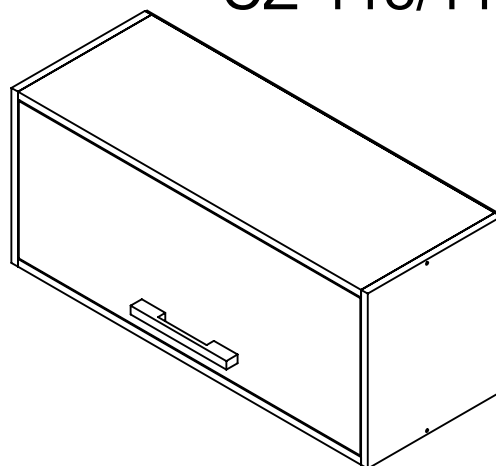

CZ-118/119S

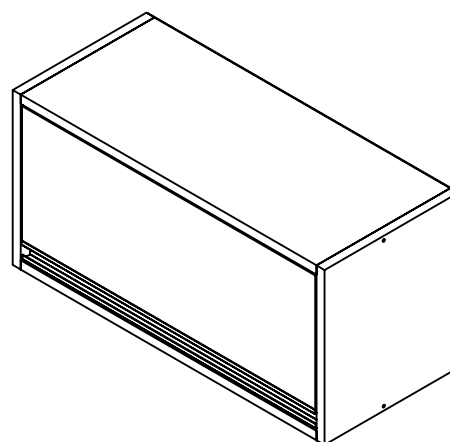

DICAS DE CONSERVAÇÃO

- Não utilizar na limpeza produtos abrasivos tais como: palha de aço, álcool, vinagre, limão, saponáceo, ou produtos corrosivos que possam riscar ou descolar a película protetora dos móveis;
- Na limpeza de móveis em geral, deve ser utilizado um pano levemente umedecido e sabão neutro;
- Para a movimentação do móvel, é importante que este seja levantado do chão, pois ao arrastá-lo pode causar avarias estruturais;
- Não deixe o móvel em exposição a intempéries;

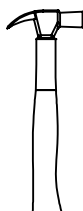
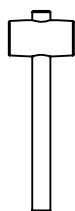
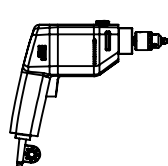

10 MIN

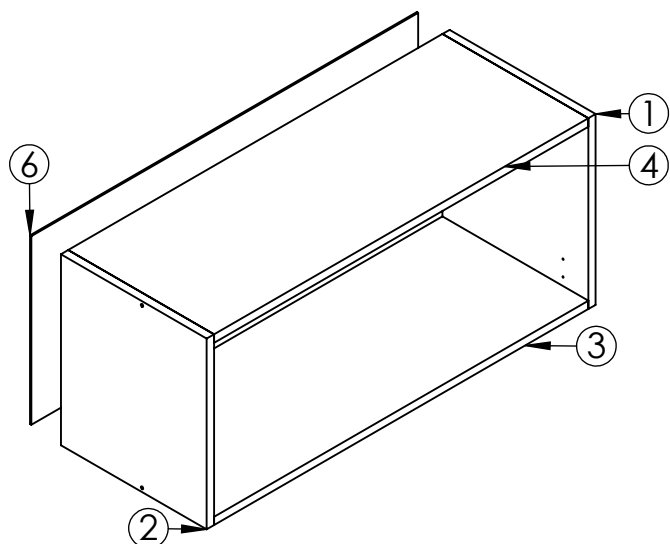

Nº	DESCRIÇÃO	QTD.
1	Lateral Direita	1
2	Lateral Esquerda	1
3	Base Inferior	1
4	Base Superior	1
5	Porta	1
6	Costa	1

CC - Cabeça Chata Cp - Cabeça Panela Cf - Cabeça Flangeada

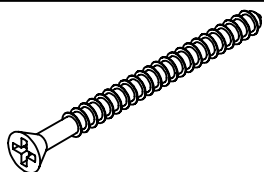

A	Parafuso 4,5 x 45 CC	4
---	----------------------	---



B	Parafuso 3,5x12 CP	22
---	--------------------	----



C	Parafuso 5x60 CF	2
---	------------------	---

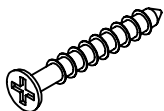

D	Parafuso 4x25 CC	6
---	------------------	---



E	Cavilha Madeira 8x30	8
---	----------------------	---

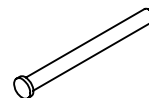

G	Prego 10x10	20
---	-------------	----



O	Bucha	2
---	-------	---

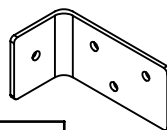

P	Suporte Fixação	2
---	-----------------	---

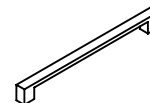

M	Puxador	1
---	---------	---

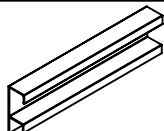

M	Puxador	1
---	---------	---

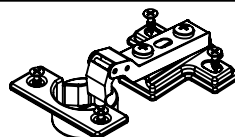

i	DOBRADIÇA	2
---	-----------	---

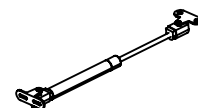

L	Pistão a Gas	1
---	--------------	---

1

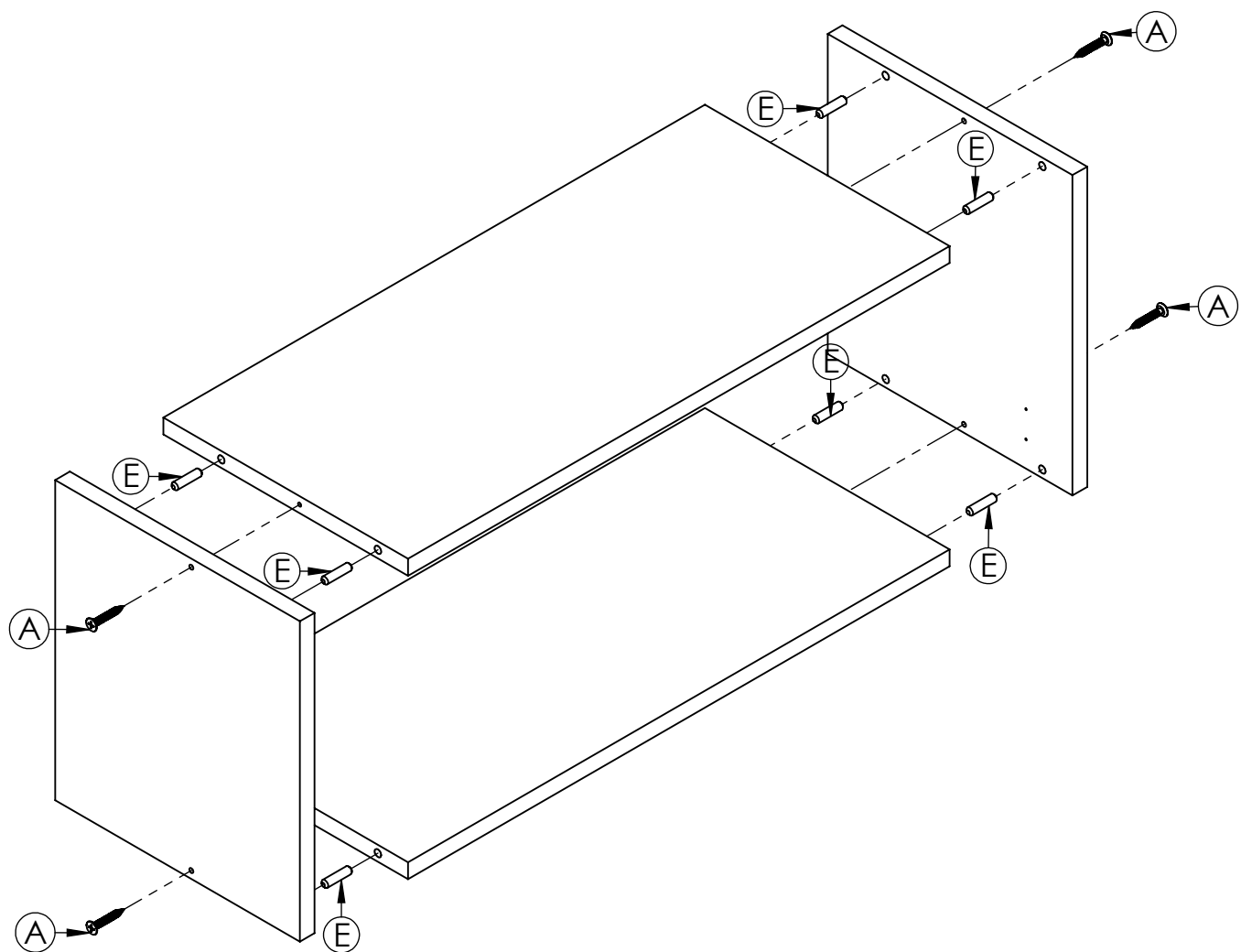

2

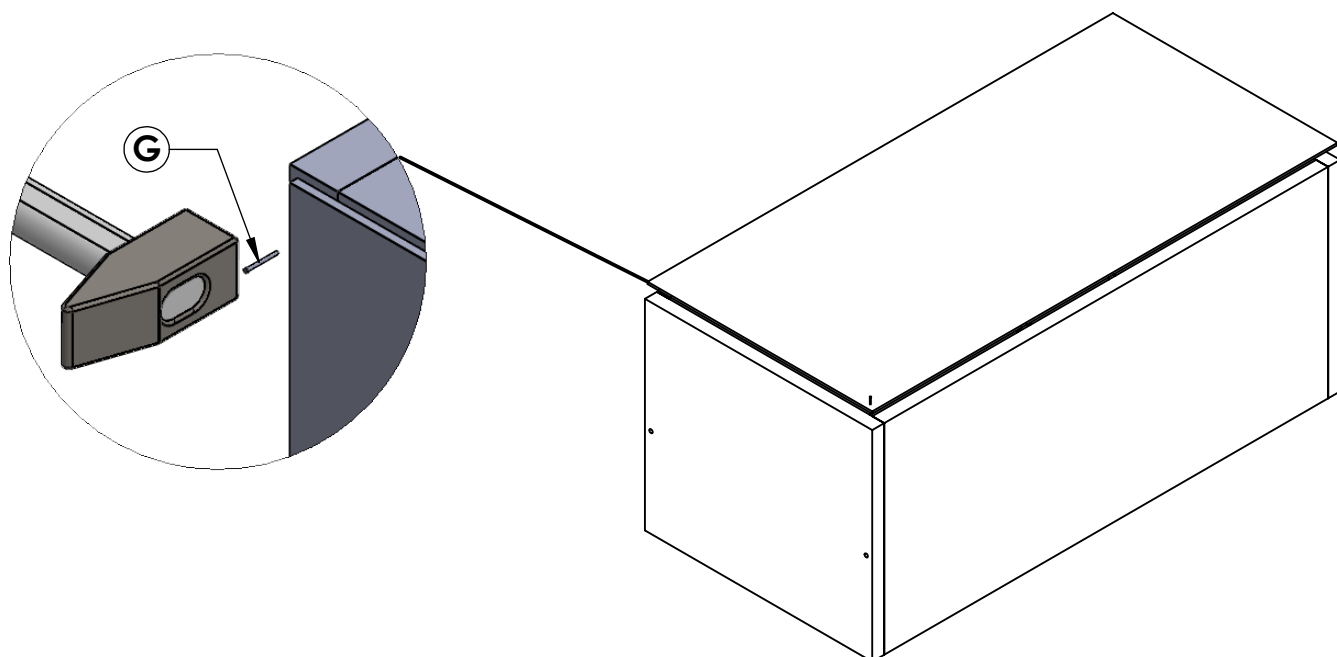

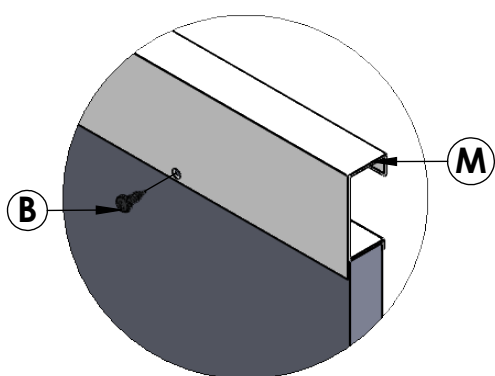
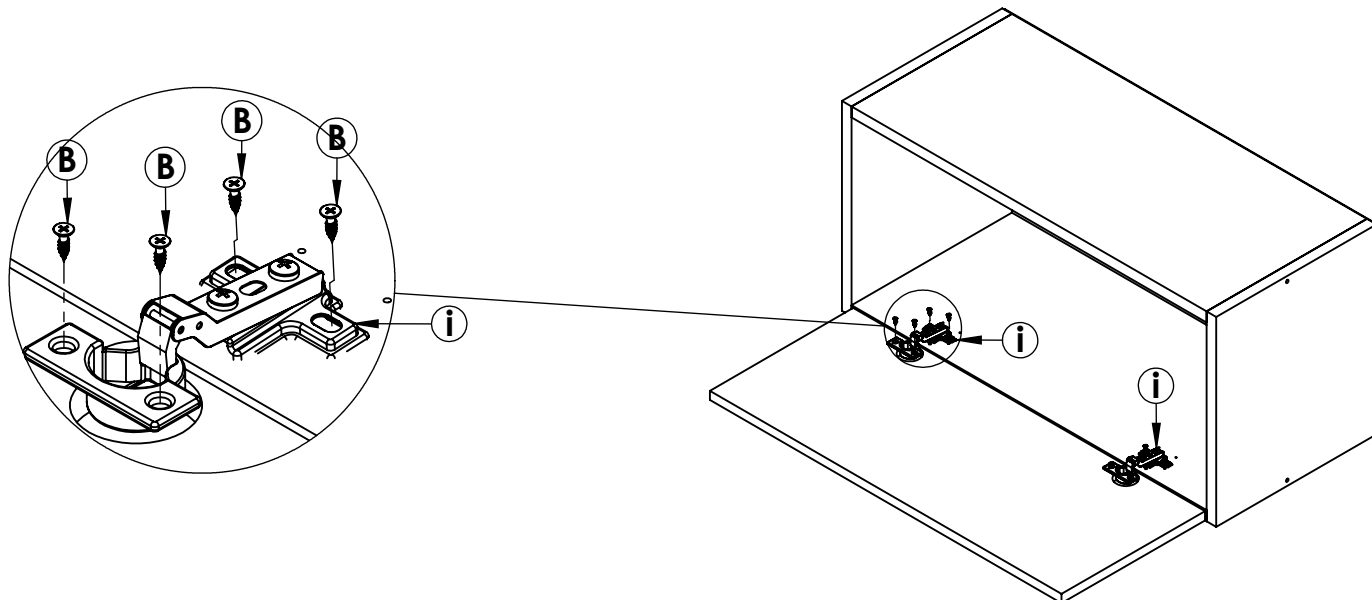

Montagem Puxador Gola

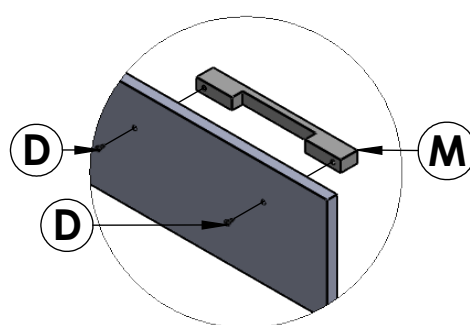

Montagem Puxador Alça

Obs: Para fixar o pistão a gás, utilizar o manual que o acompanha

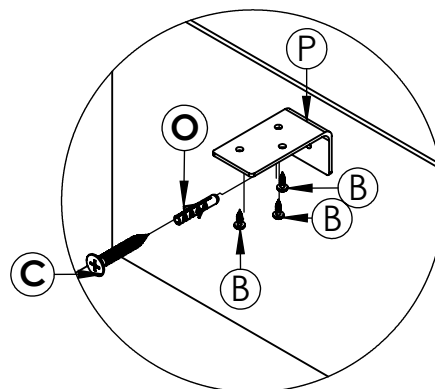
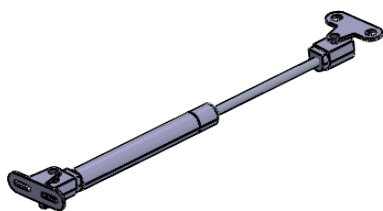

Fixação na Parede

Regulagem da porta

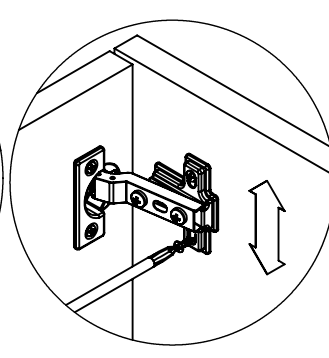
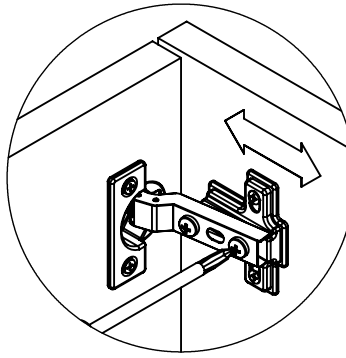
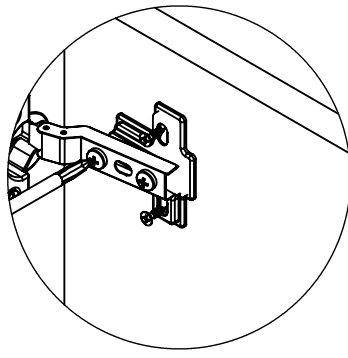
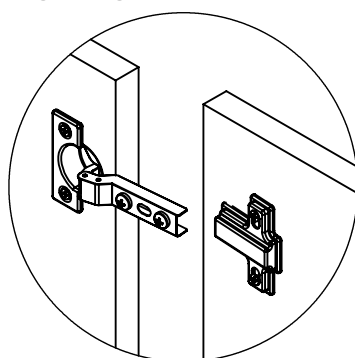

CZ-105/106V

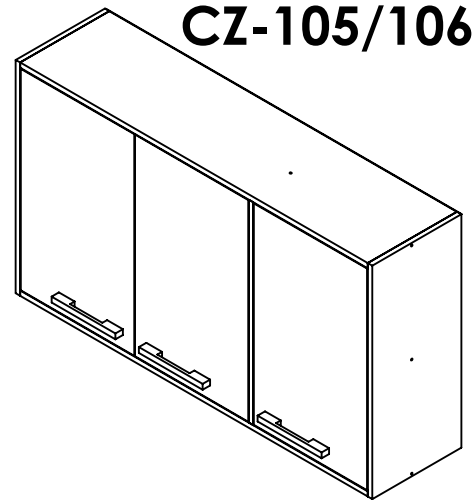

CZ-105/106S

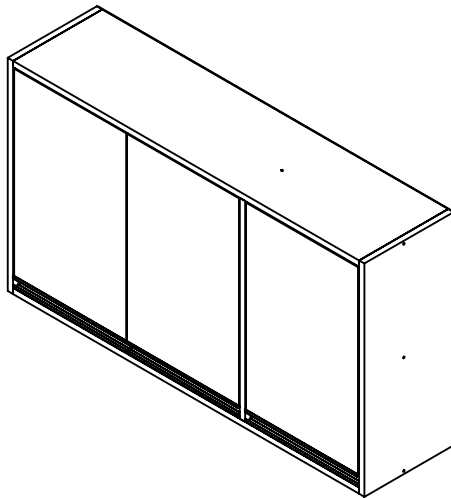

DICAS DE CONSERVAÇÃO

- Não utilizar na limpeza produtos abrasivos tais como: palha de aço, álcool, vinagre, limão, saponáceo, ou produtos corrosivos que possam riscar ou descolar a película protetora dos móveis;
- Na limpeza de móveis em geral, deve ser utilizado um pano levemente umedecido e sabão neutro;
- Para a movimentação do móvel, é importante que este seja levantado do chão, pois ao arrastá-lo pode causar avarias estruturais;
- Não deixe o móvel em exposição a intempéries;

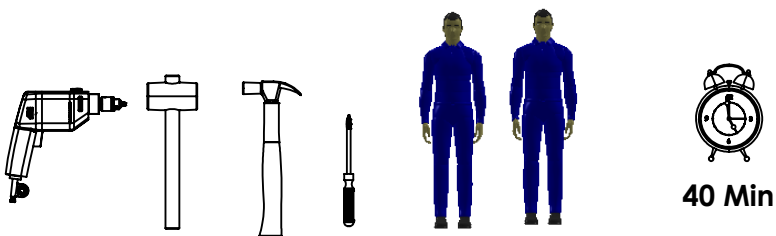

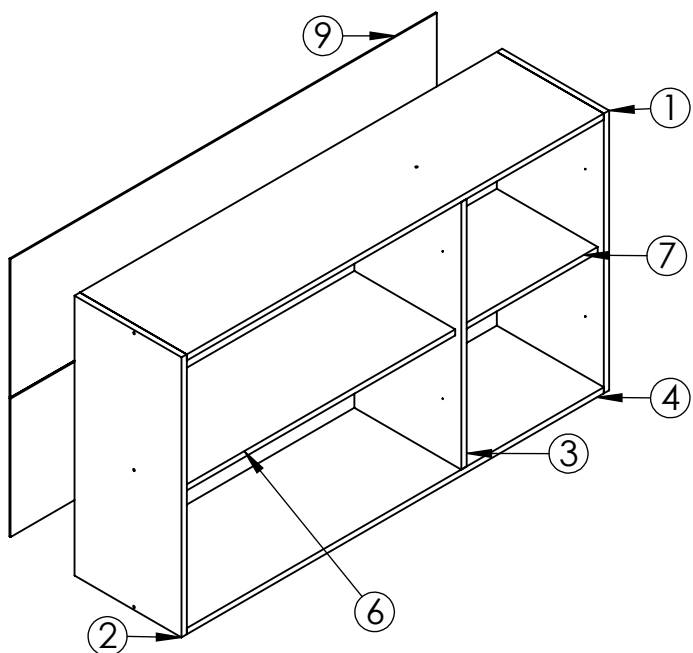

Nº	DESCRIÇÃO	QTD.
1	Lateral Direita	1
2	Lateral Esquerda	1
3	Divisão	1
4	Base Inferior	1
5	Base Superior	1
6	Prateleira Maior	1
7	Prateleira Menor	1
8	Porta	3
9	Costa	2

CC - Cabeça Chata Cp - Cabeça Panela Cf - Cabeça Flangeada

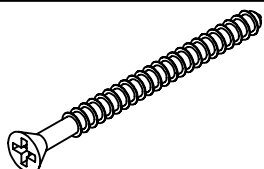

A Parafuso 4,5 x 45 CC 9



B Parafuso 3,5x12 CP 48

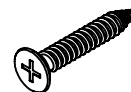

C Parafuso 5x60 CF 4

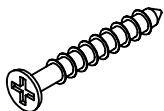

D Parafuso 4x25 CC 10



E Cavilha 8x30 16

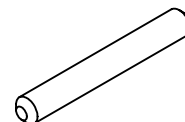

F Cavilha 8x50 2

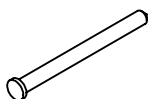

G Prego 10x10 50



O Bucha 4

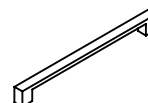

M Puxador 3



R Garra Costa 8

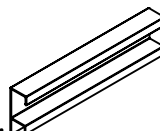

M Puxador 3

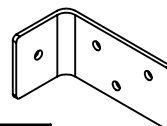

P Suporte Fixação 4

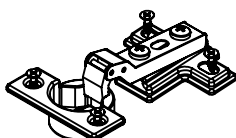

i DOBRADIÇA 6

1

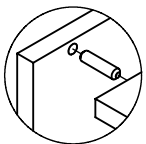

Utilizar Cola
nas Cavilhas

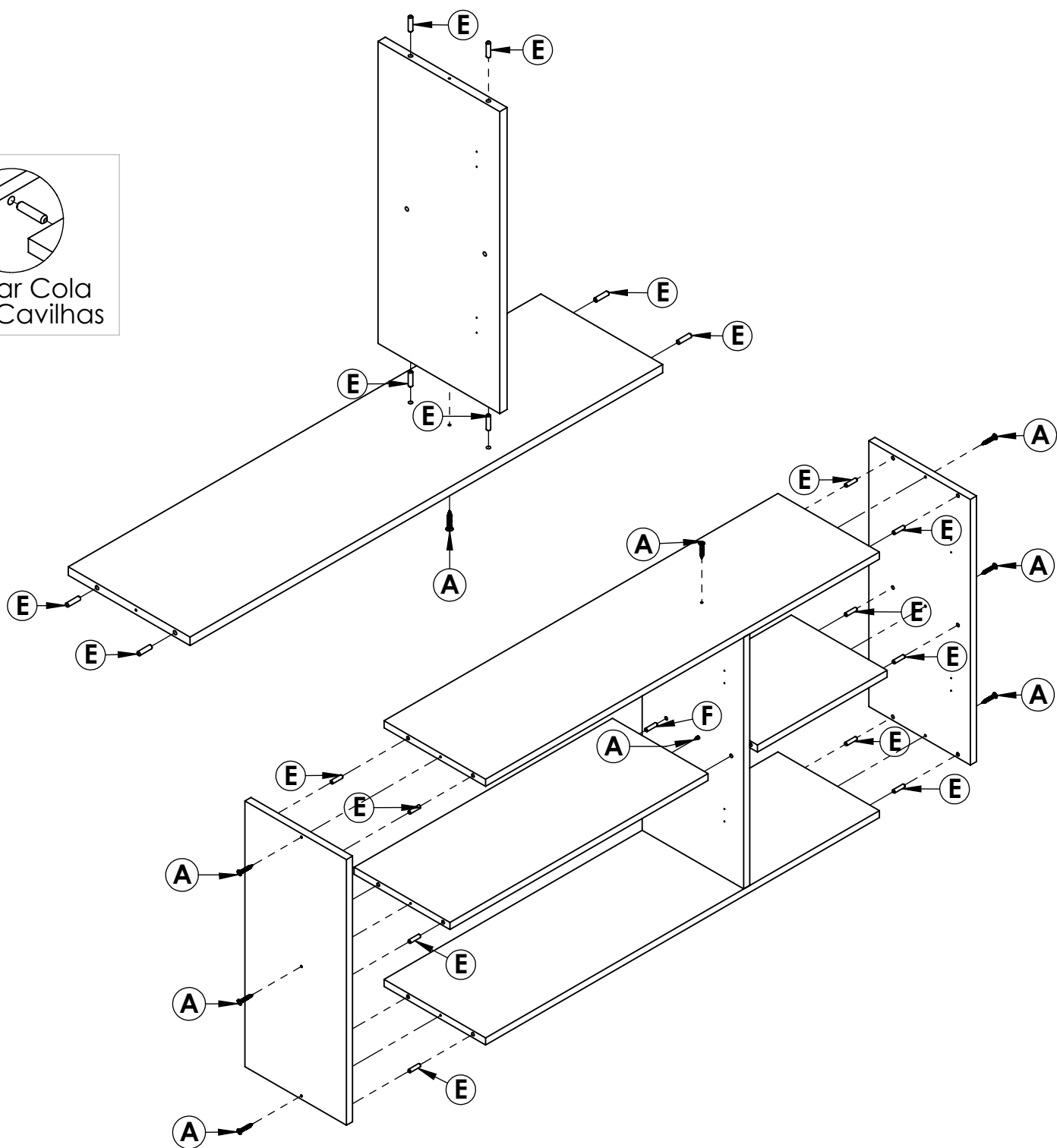

2

3

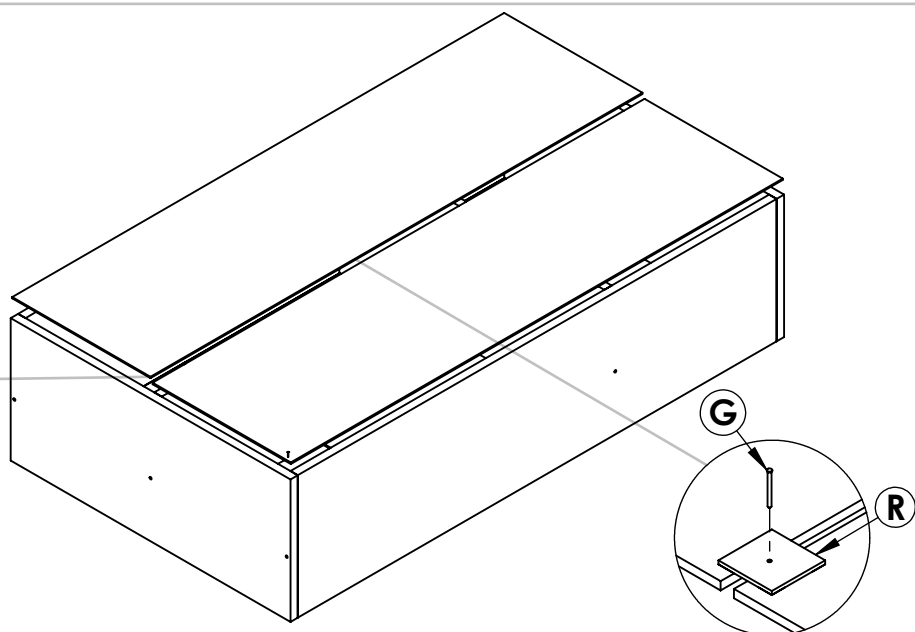
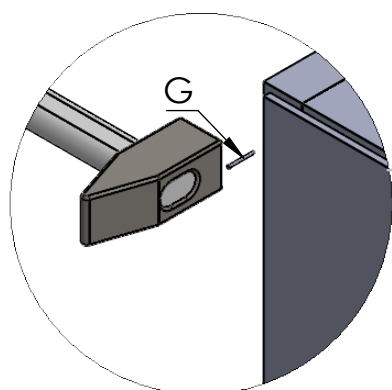

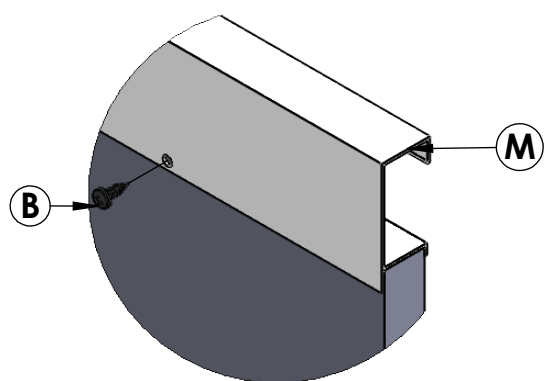
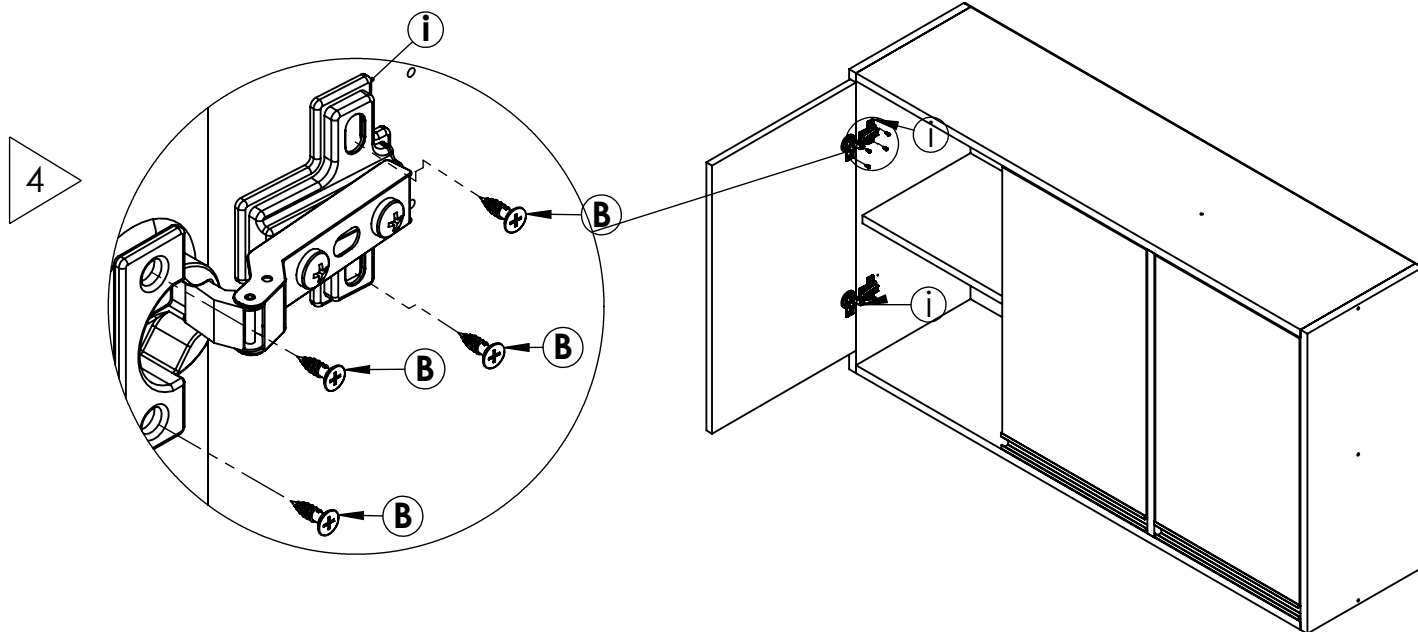

Montagem Puxador Gola

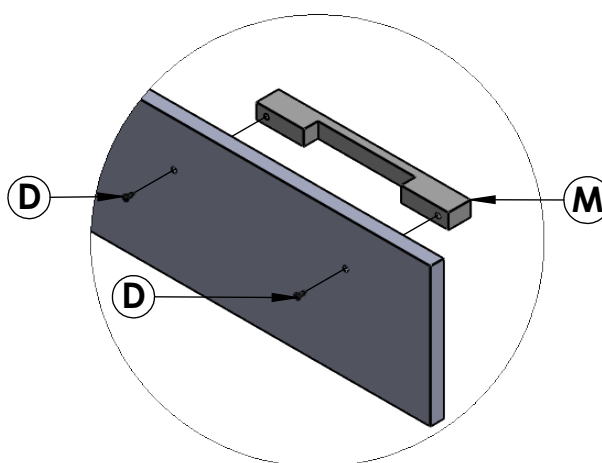

Montagem Puxador Alça

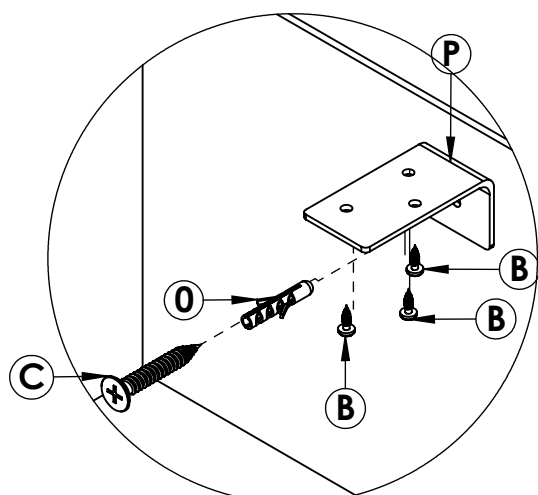

Fixação na Parede

Regulagem Porta

