

# ESTANTE CREATIVE

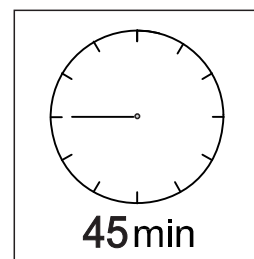

tresirmaos

- ANTES DA MONTAGEM, SEPRE UM ESPAÇO, DE PREFERÊNCIA UMA ÁREA COM CARPETE OU COLOQUE UM COBERTOR OU ALGO QUE PROTEJA AS PEÇAS DA SUPERFÍCIE DURA DO CHÃO.

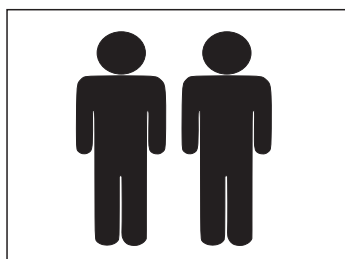
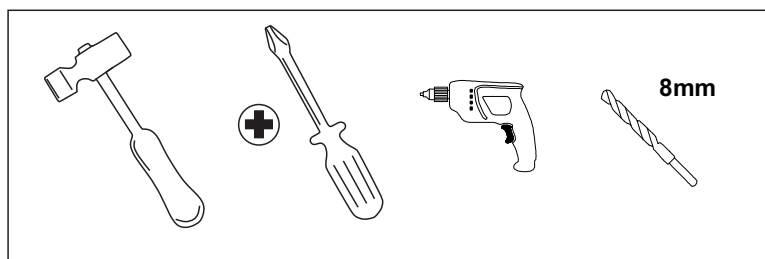
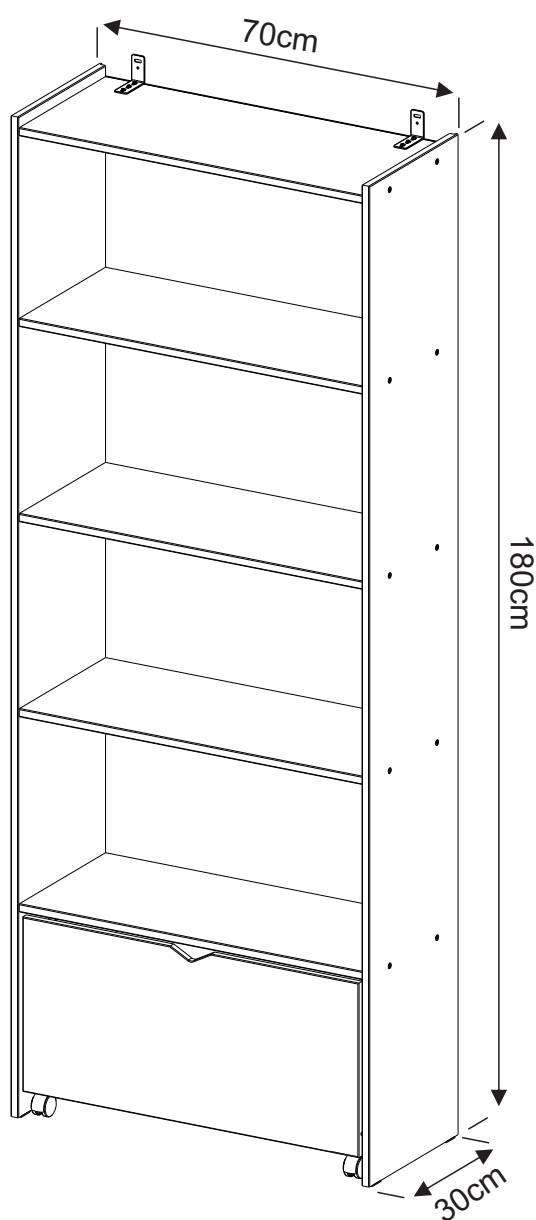
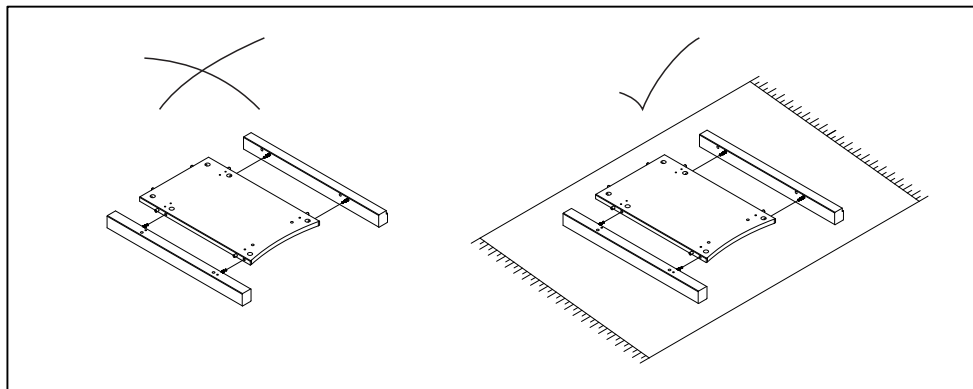

- LEIA O ESQUEMA INTEIRO ATENTAMENTE ANTES DE INICIAR A MONTAGEM.
- AS FERRAGENS QUE FIXAM O MÓVEL DEVEM SER APERTADAS ADEQUADAMENTE E REAPERTADAS SEMPRE QUE NECESSÁRIO.
- O MÓVEL DEVE SER LIMPO COM PANO MACIO E DETERGENTE NEUTRO, NÃO UTILIZAR NENHUM TIPO DE ABRASIVO OU SOLVENTE.

#### GARANTIA

A GARANTIA SERÁ DE 3 (TRÊS) MESES POR DEFEITOS DE FABRICAÇÃO, RESSALVADAS CONDIÇÕES NORMAIS DE USO, CONTADOS A PARTIR DA ENTREGA AO CONSUMIDOR MEDIANTE A NOTA FISCAL DE COMPRA, QUE PASSA A FAZER PARTE INTEGRANTE DESTES CERTIFICADO.

MONTAGENS FEITAS DE MANEIRA INCORRETA ACARRETAM NA PERDA DA GARANTIA.

EM CASO DE MUDANÇAS (ENDEREÇO/LOCAL) POSSÍVEIS AVARIAS NO TRANSPORTE PERDERÃO A GARANTIA.

A GARANTIA AQUI CONFERIDA COMPREENDE O REPARO OU SUBSTITUIÇÃO DAS PEÇAS COM DEFEITO DE FABRICAÇÃO. NÃO ESTÁ COBERTA PELA GARANTIA A QUEBRA DO MÓVEL EM FUNÇÃO DO EXCESSO DE PESO OU MAU USO.

EM CASO DE DUVIDAS FAVOR CONTATAR NOSSO SAC PELO E-MAIL: [SAC@TRESIRMAOS.NET](mailto:SAC@TRESIRMAOS.NET)

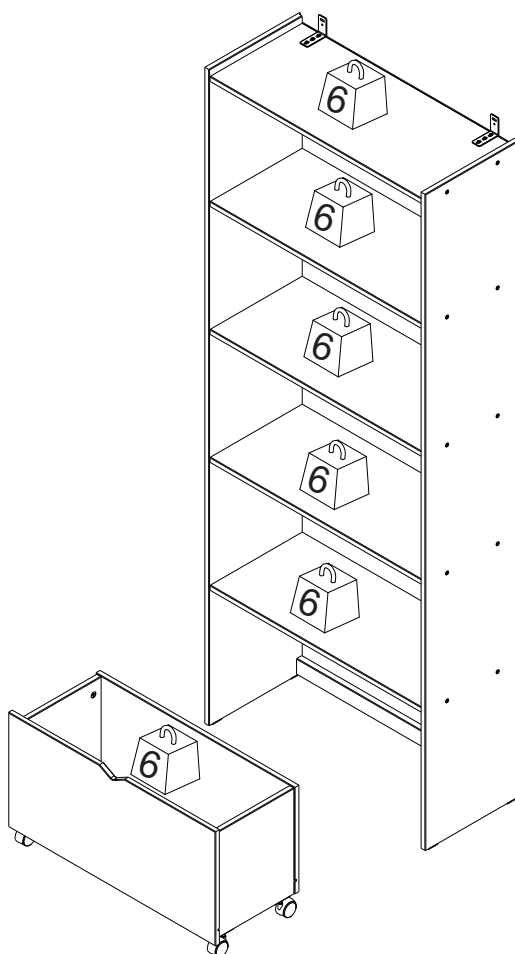

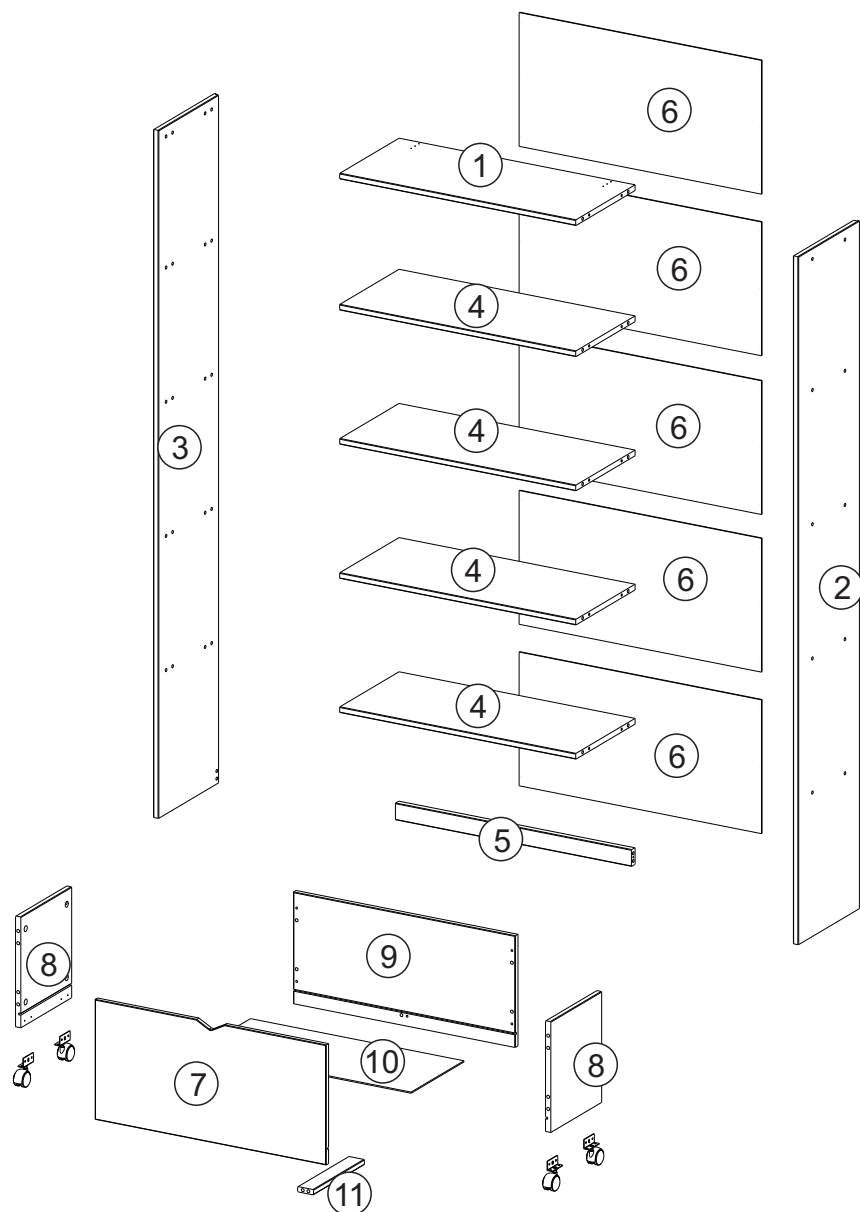

Ax34

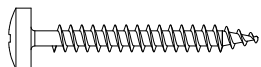

Bx2

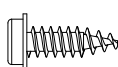

Cx14

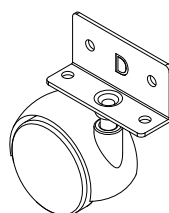

Dx2

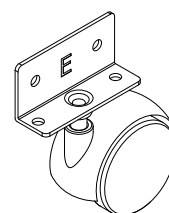

Ex2

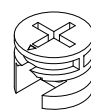

Fx10



Gx10

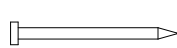

Hx50

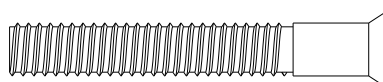

Ix20

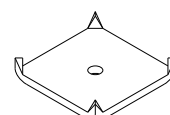

Jx12

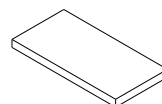

Kx4

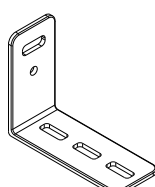

Lx2

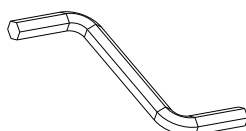

Mx1

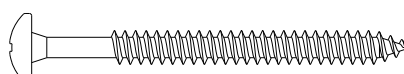

Nx2

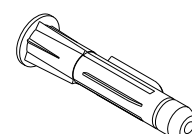

Ox2

1

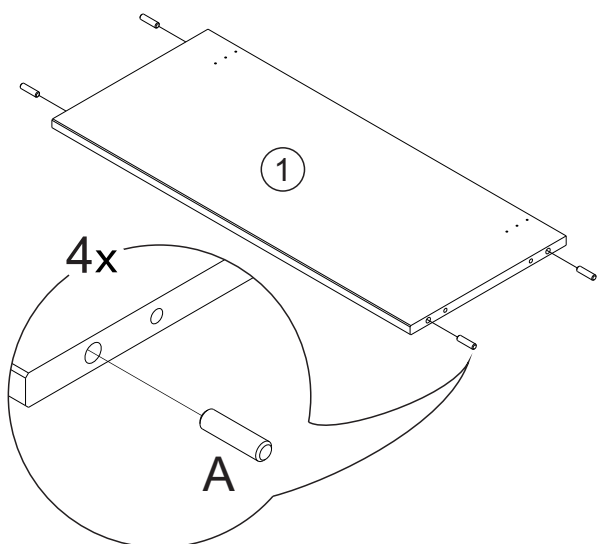

2

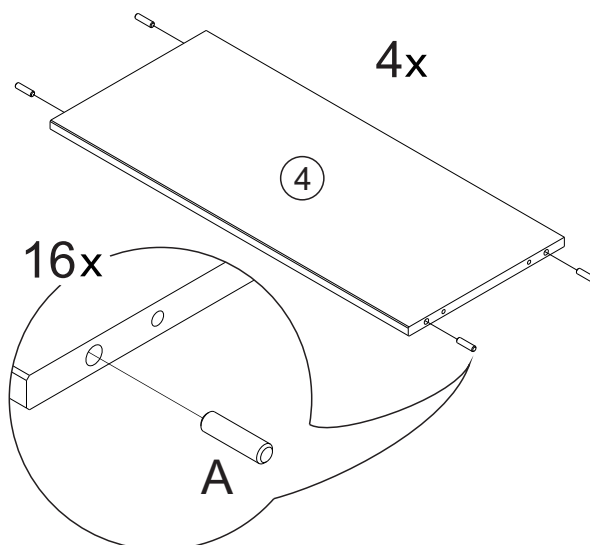

3

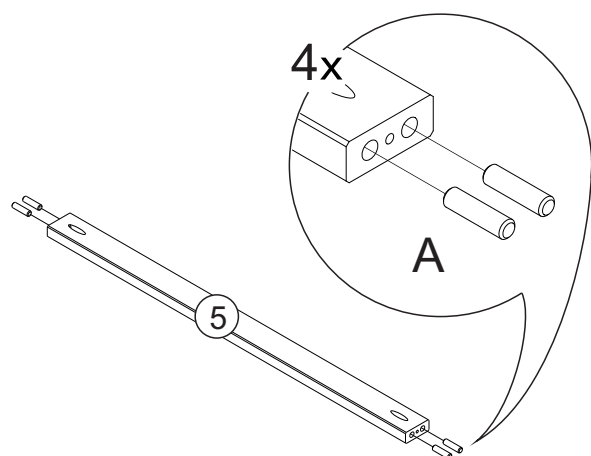

4

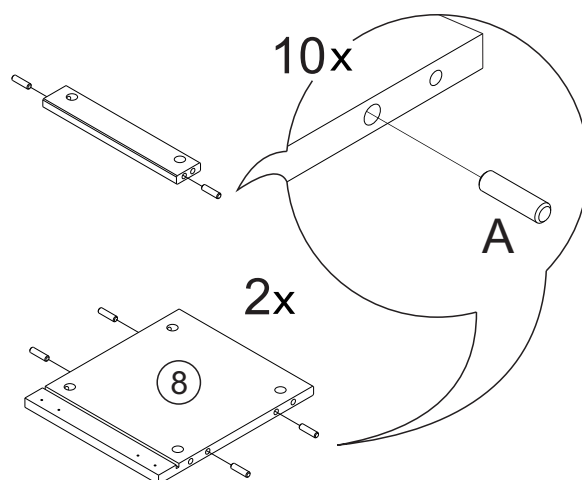

5

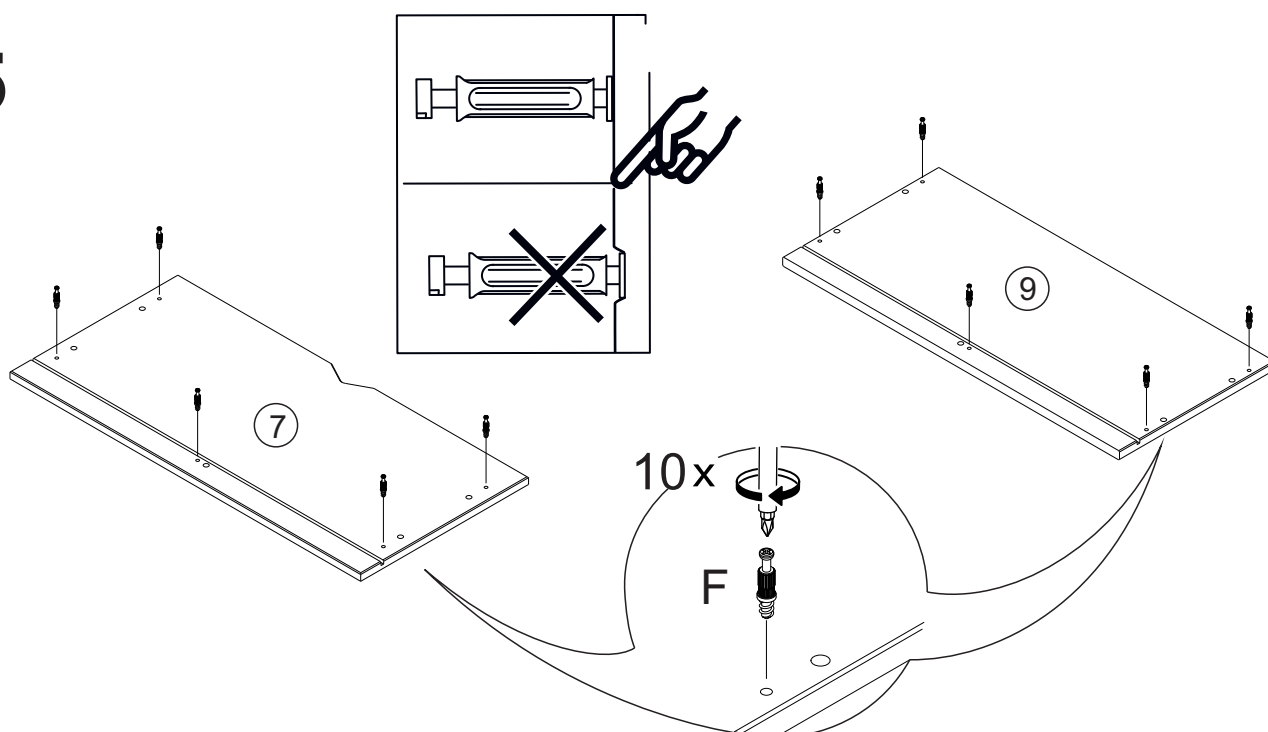

# 6

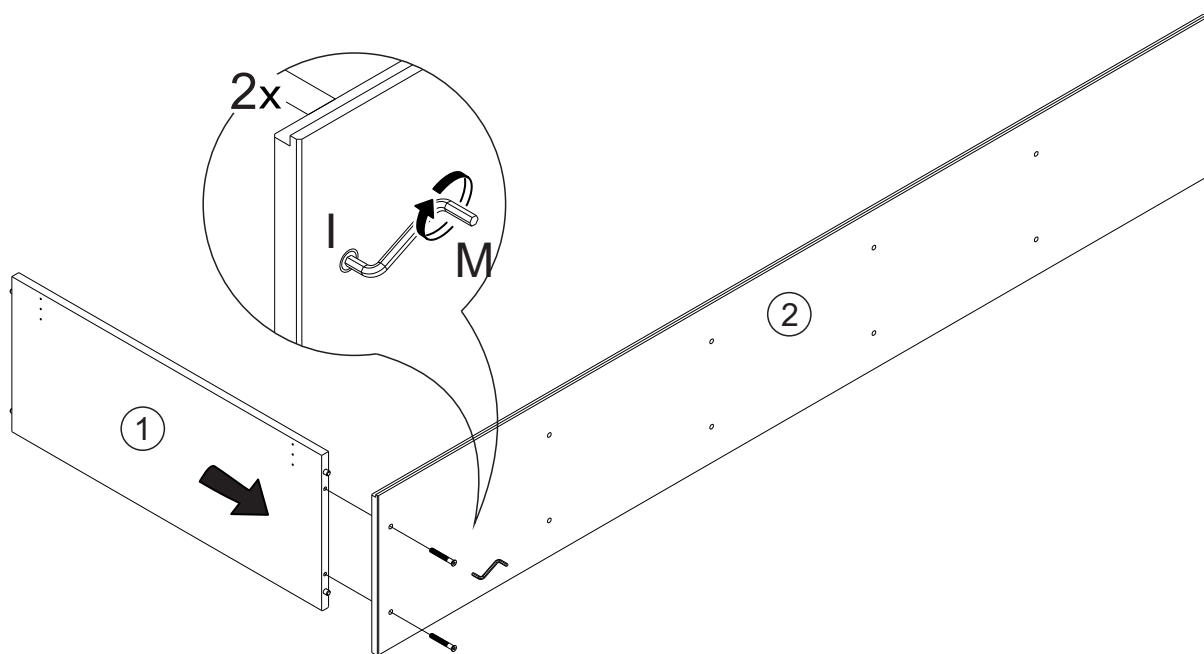

# 7

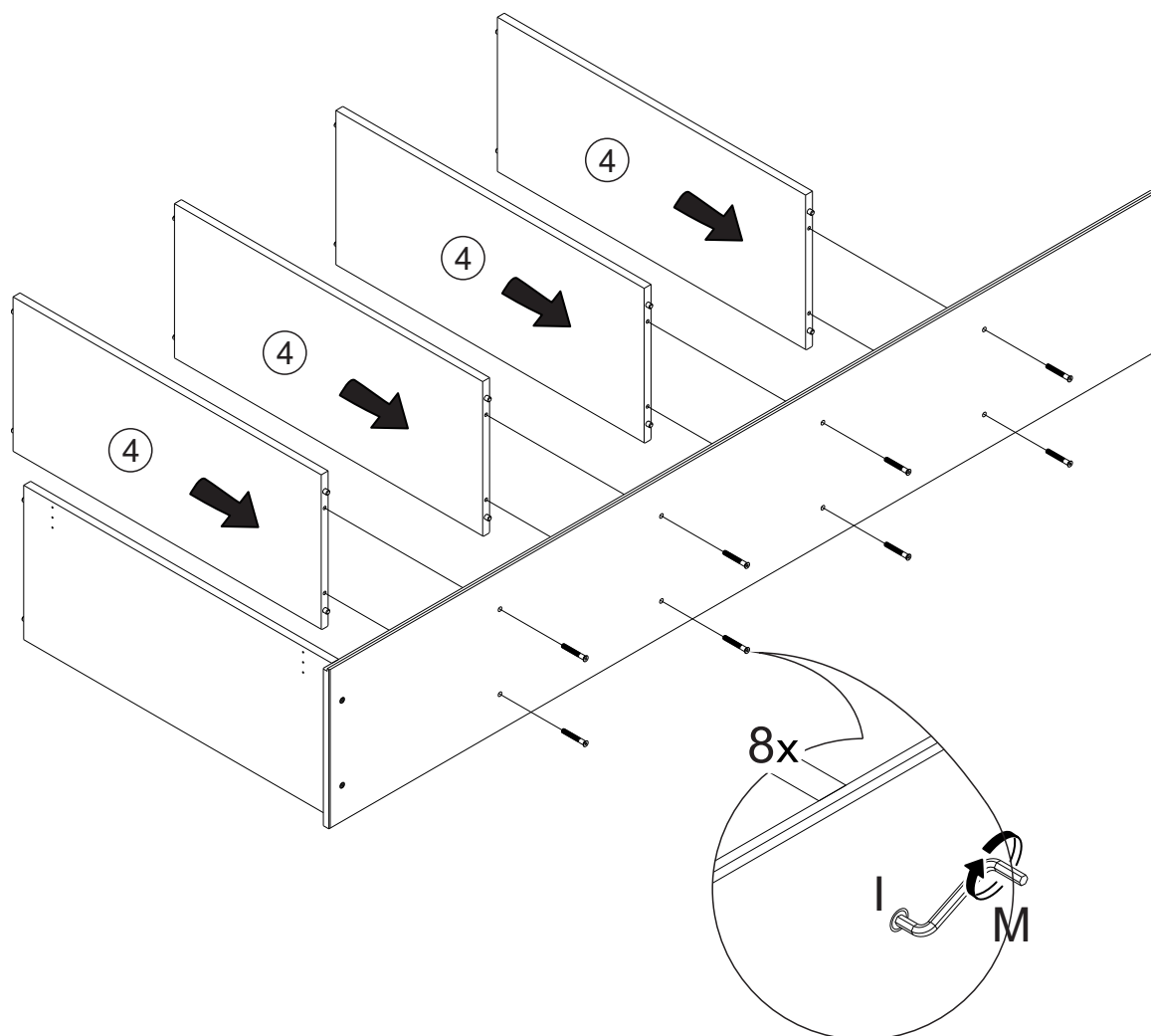

8

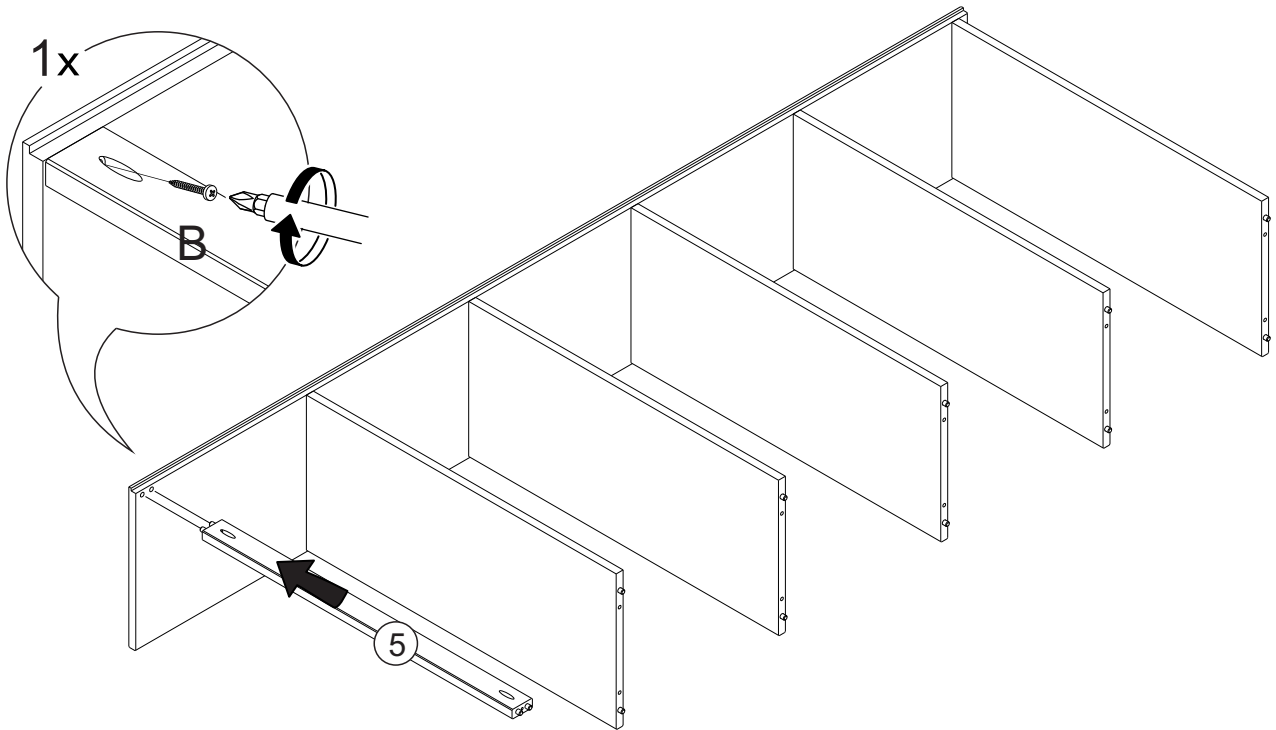

9

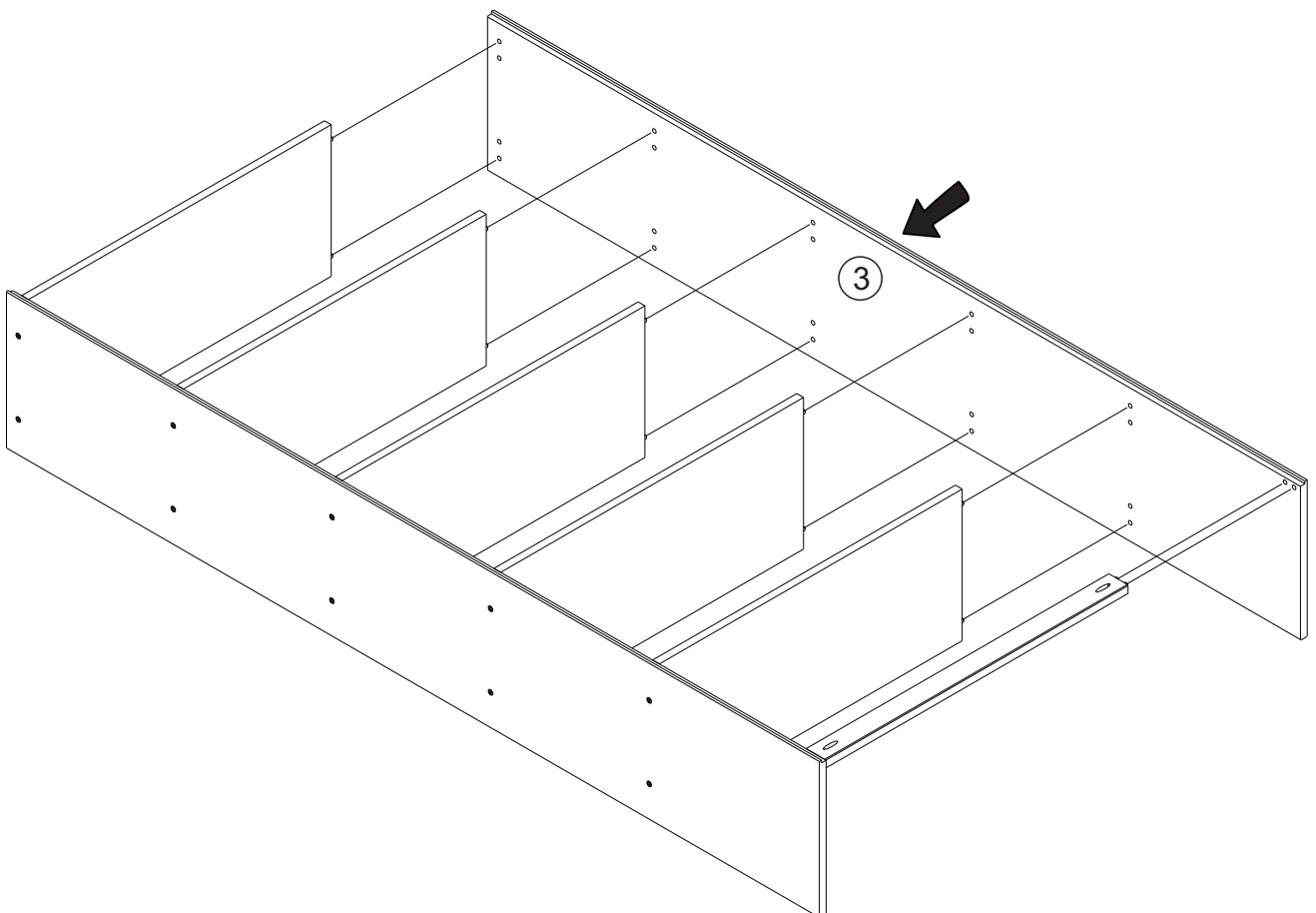

# 10

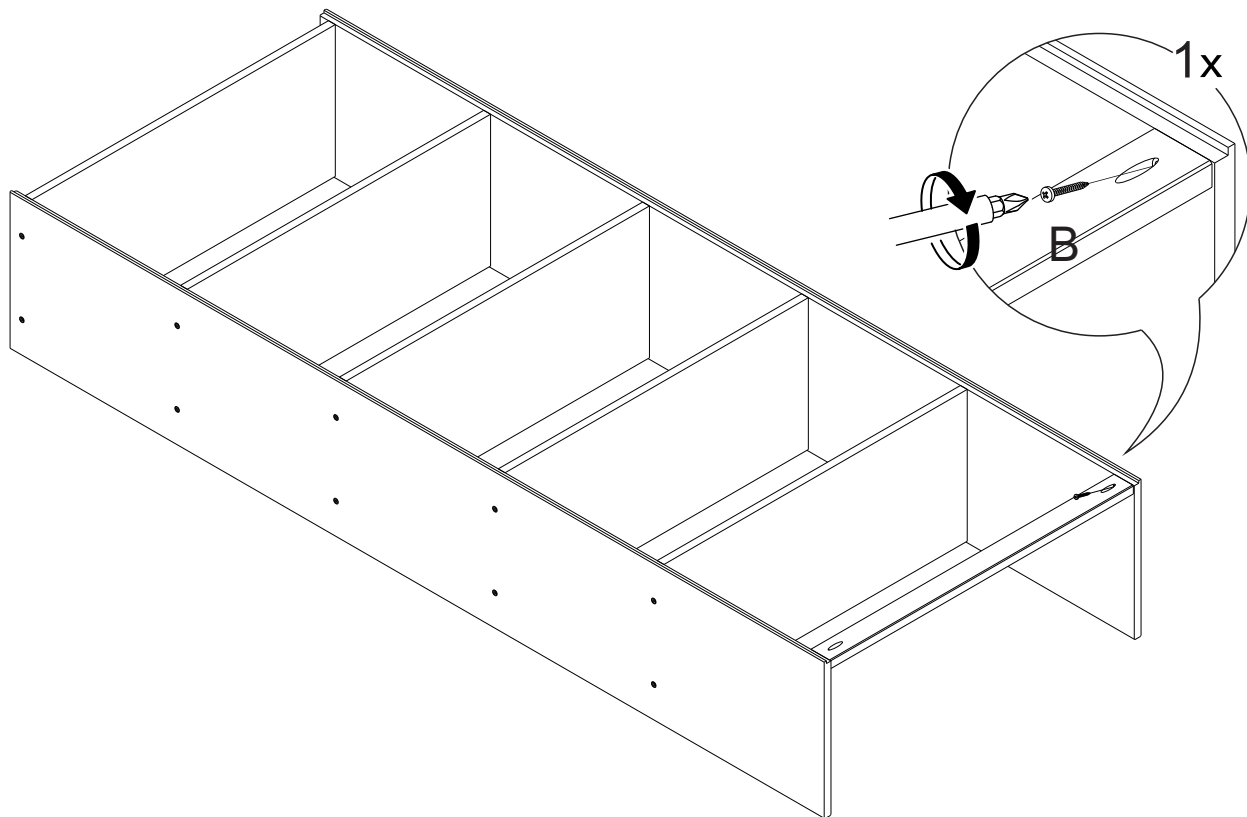

# 11

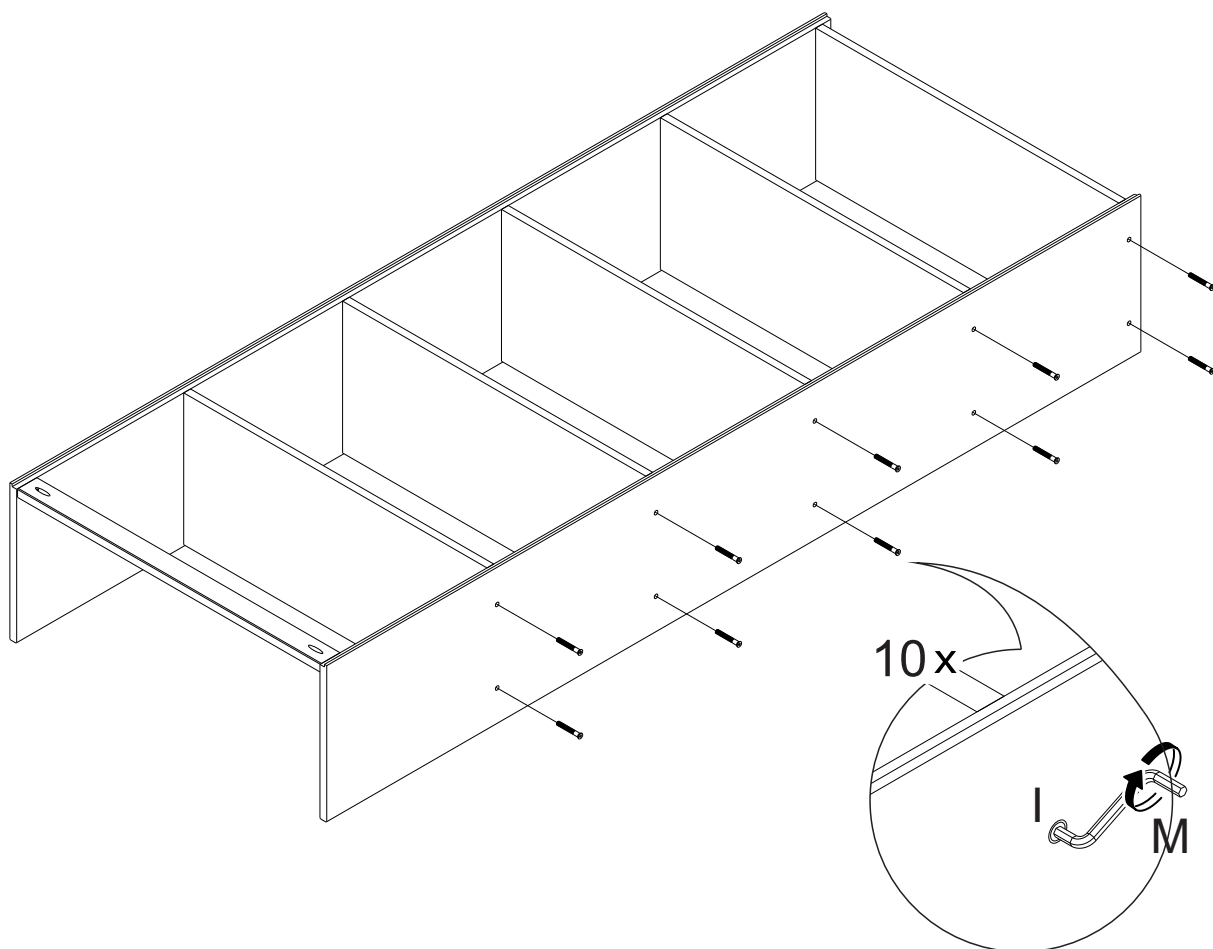

# 12

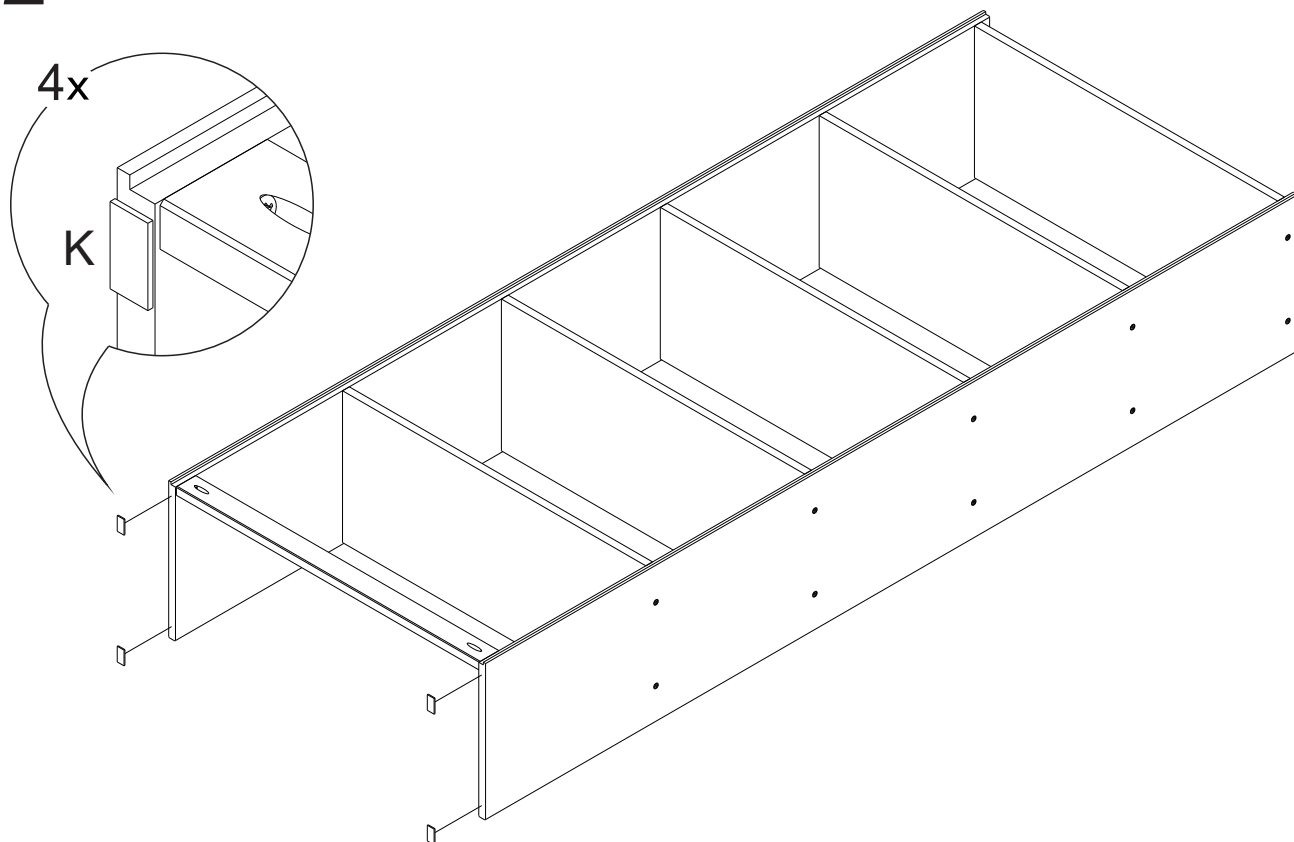

# 13

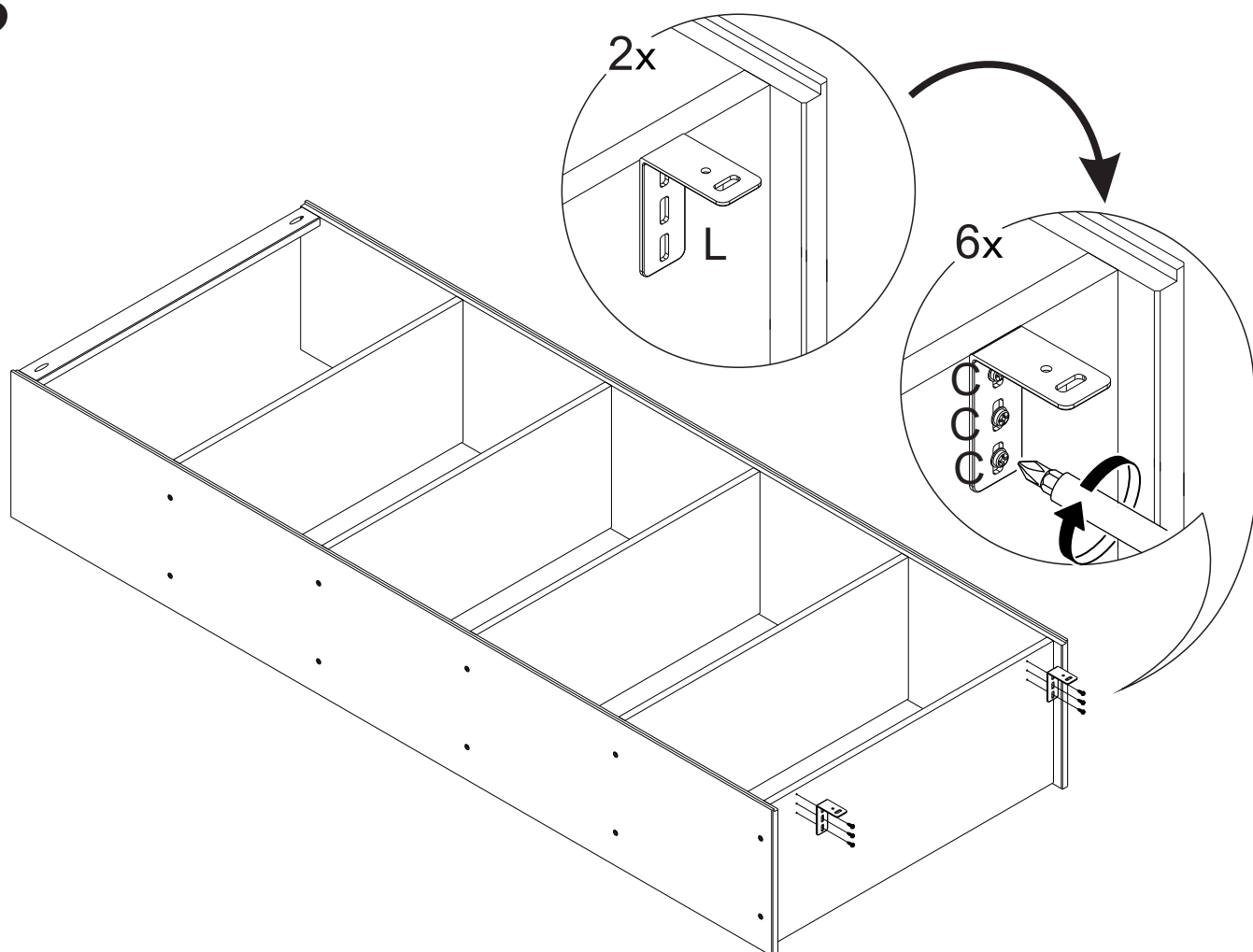



14

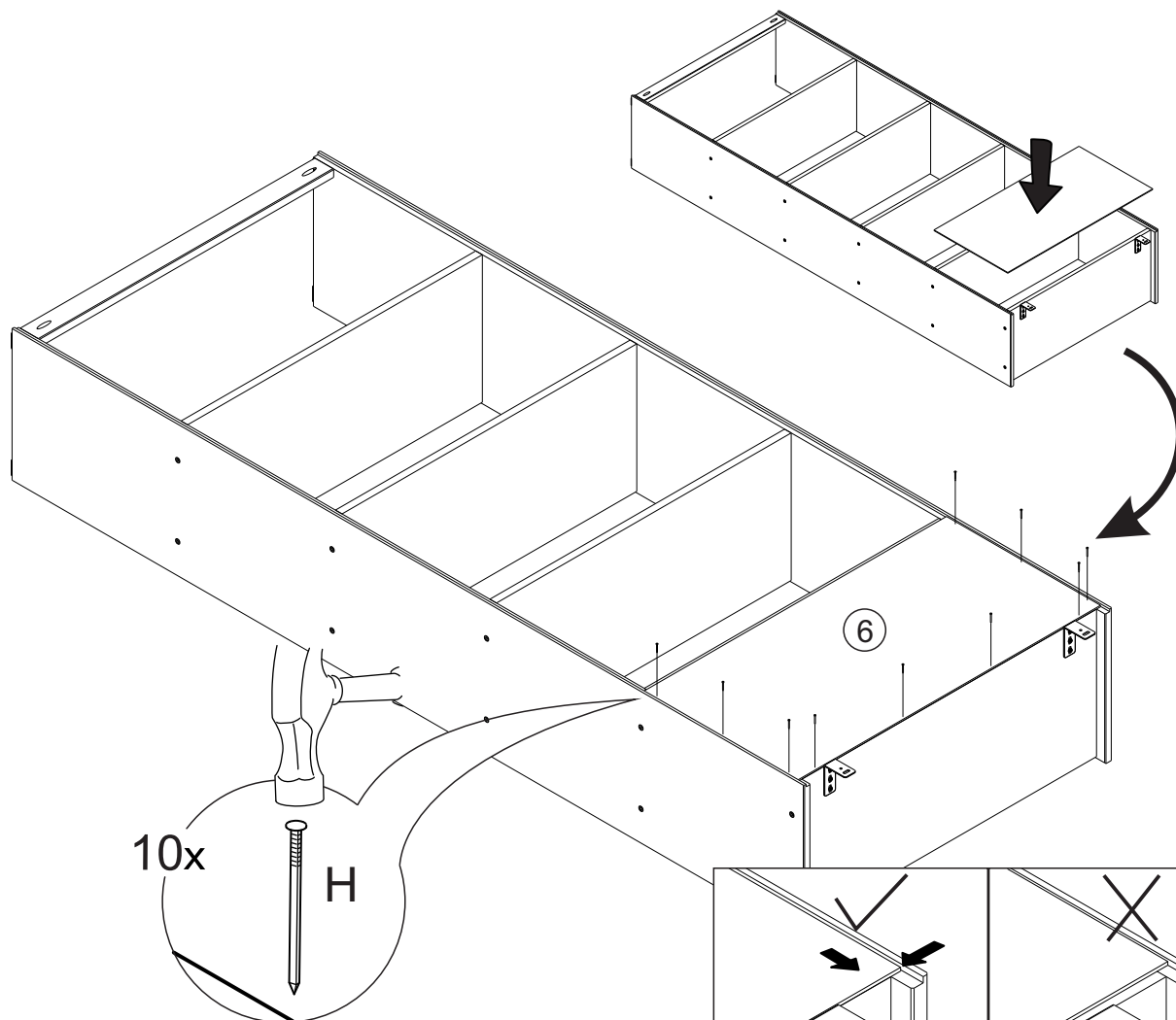

15

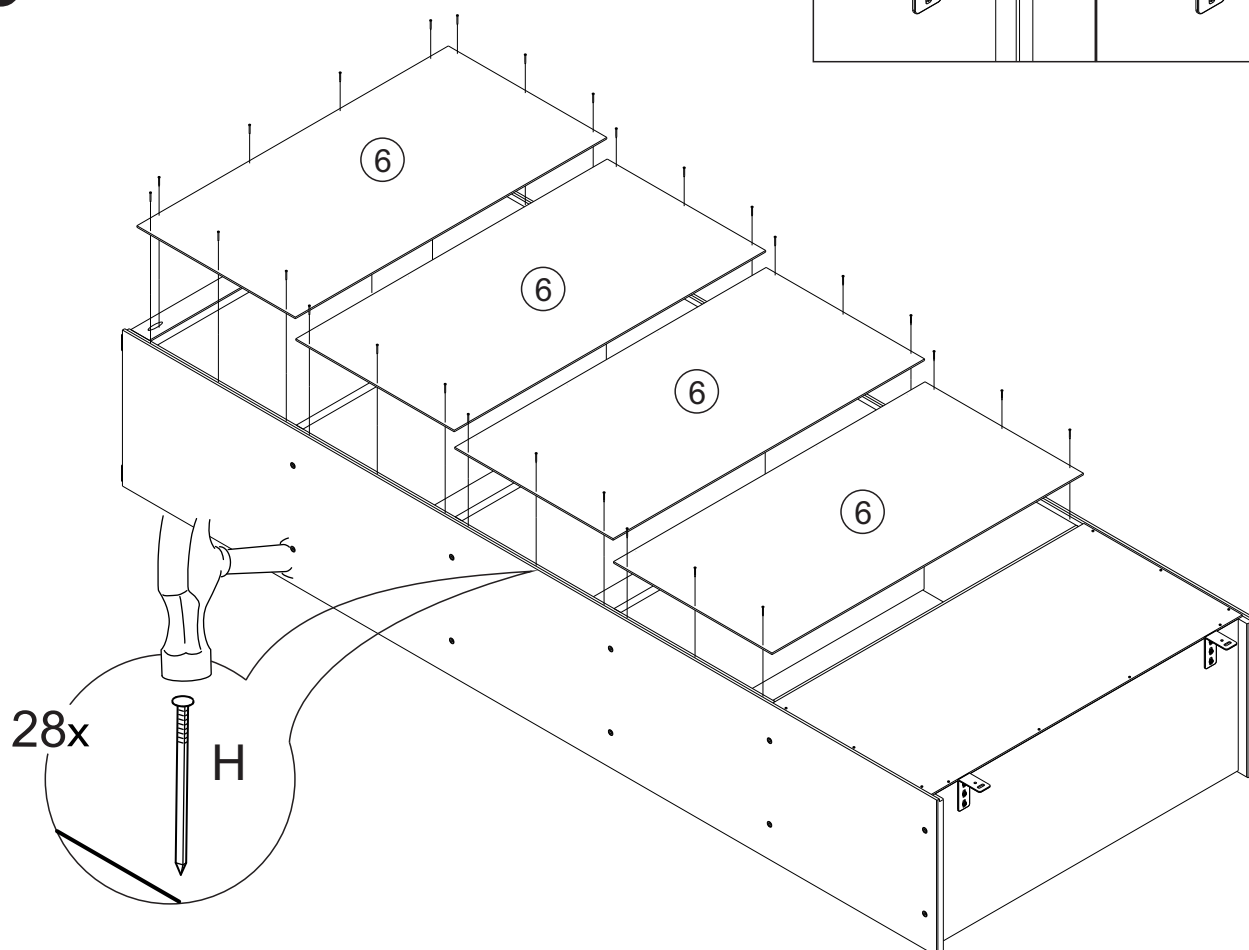

# 16

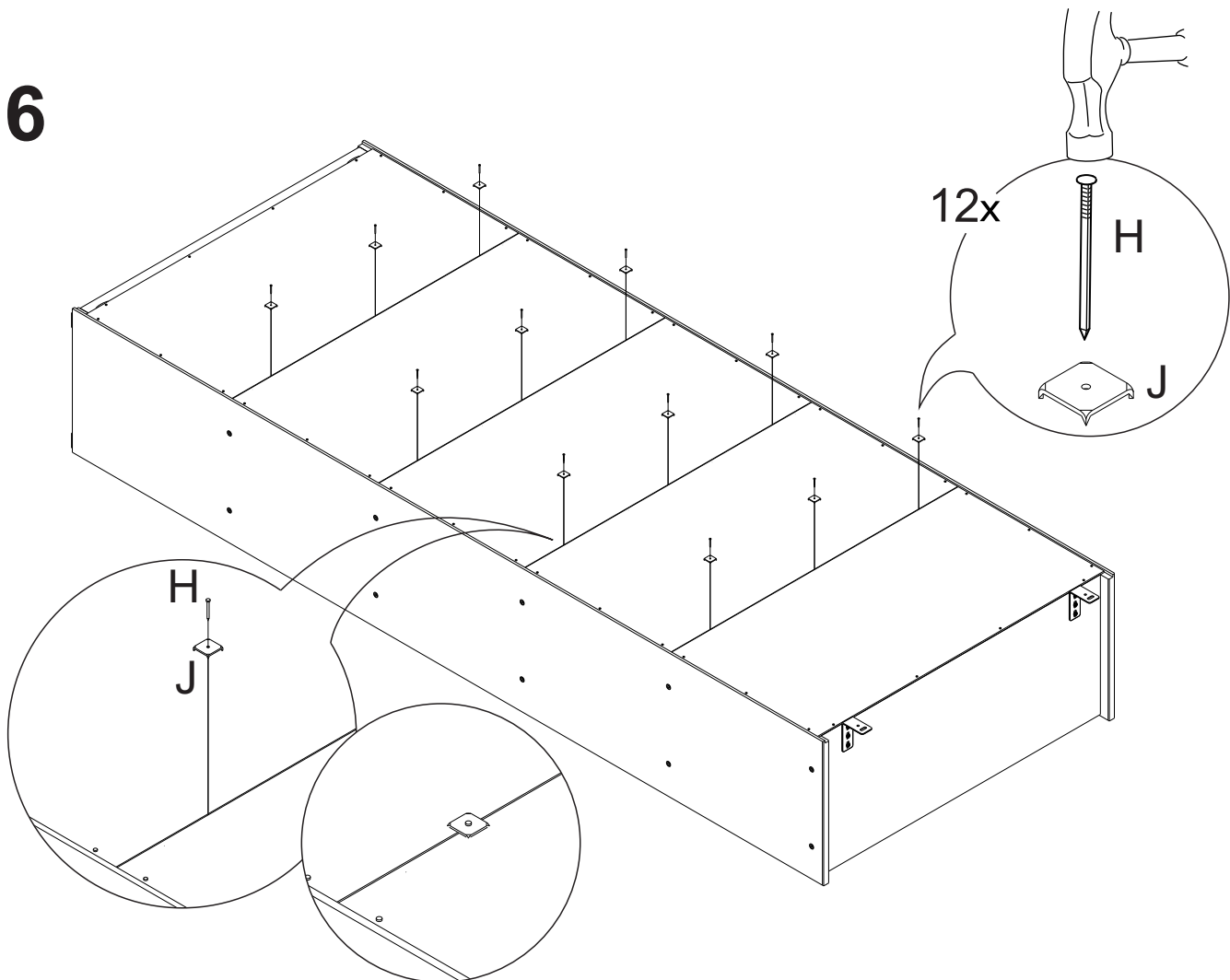

**17** ESCOLHA O LOCAL ONDE SUA ESTANTE IRÁ FICAR, MARQUE COM UM LÁPIS ONDE A PAREDE SERÁ FURADA, RETIRE O MÓVEL DO LOCAL. COM UMA BROCA DE 8MM FAÇA O FURO E INSIRA A BUCHA. VOLTE COM O MÓVEL NO LOCAL E PARAFUSE CONFORME ABAIXO. POR QUESTÃO DE SEGURANÇA O MÓVEL DEVE SER PRESO A PAREDE, CASO A FERRAGEM ENVIADA NÃO ATENDA A SUA PAREDE PROCURE UM COMÉRCIO DE FERRAGEM PARA LHE INDICAR O PRODUTO ADEQUADO.

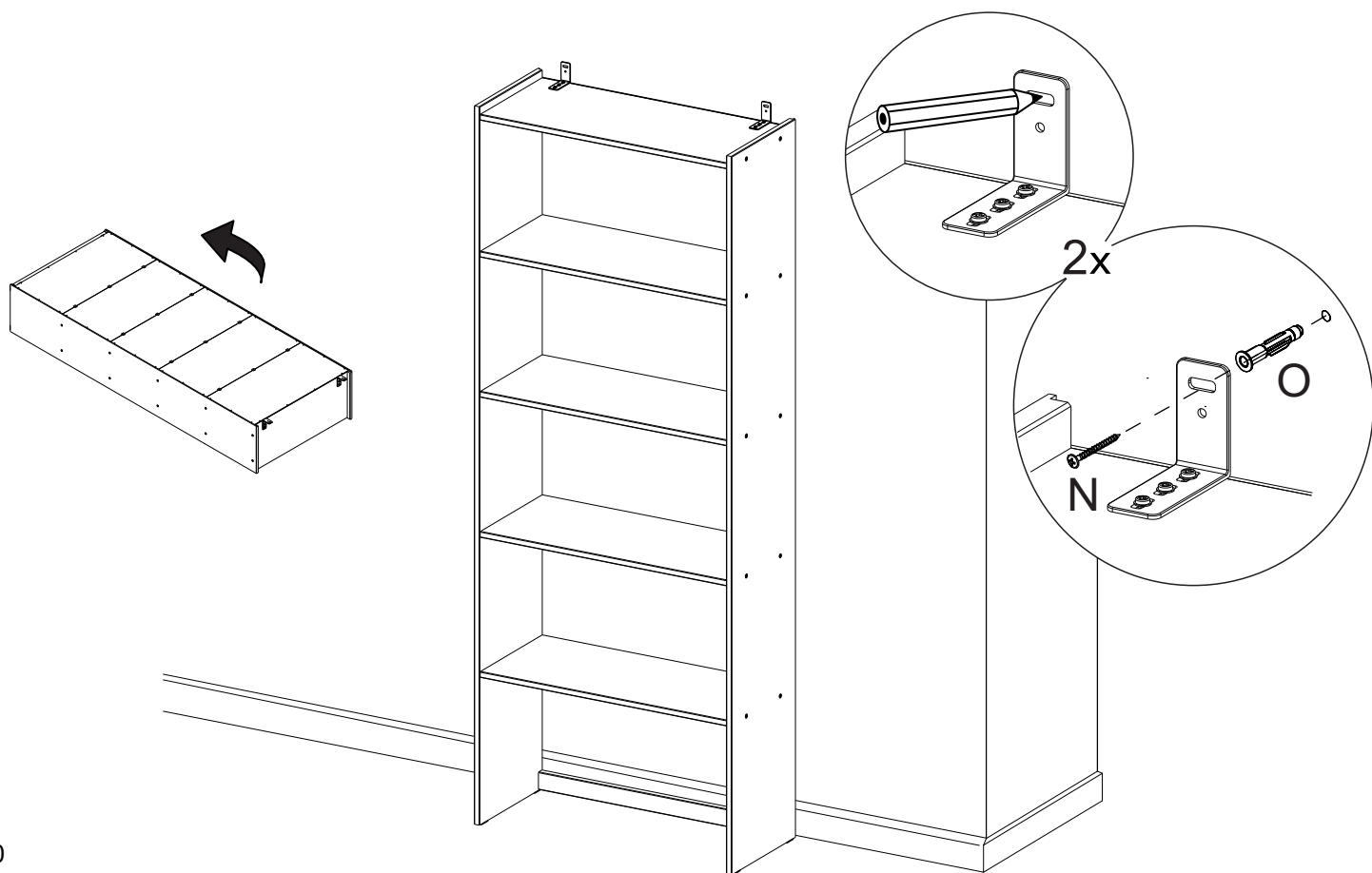

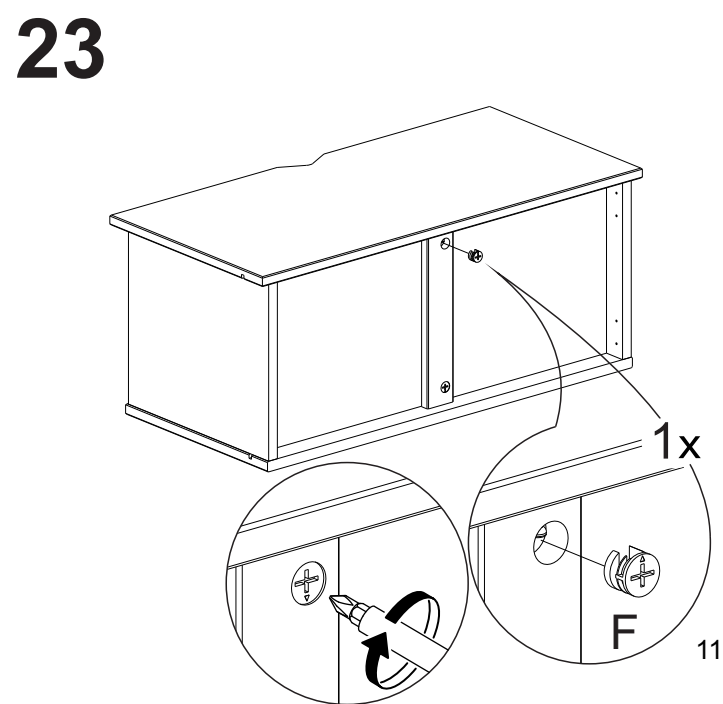
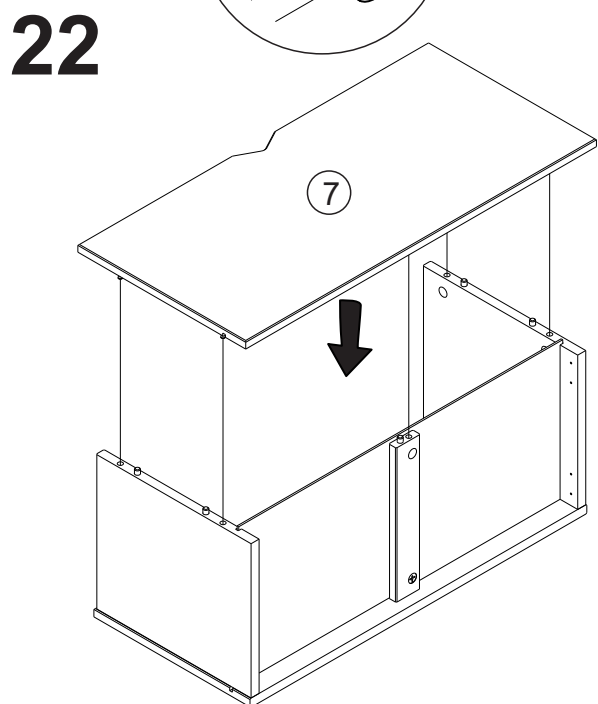
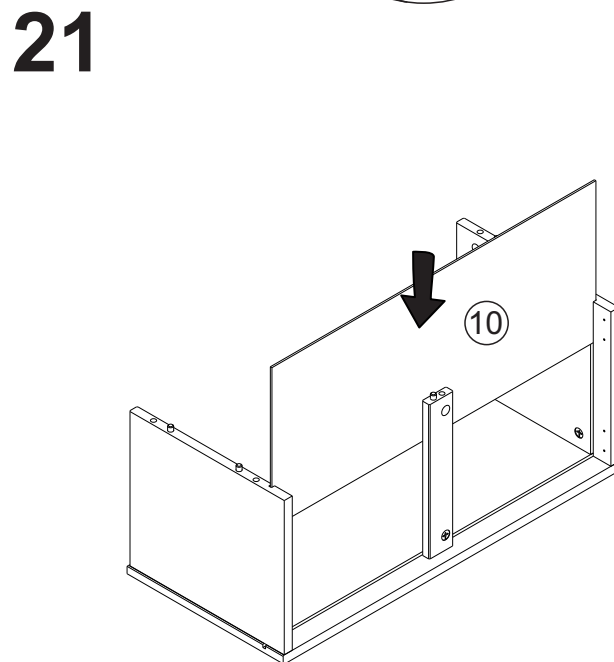
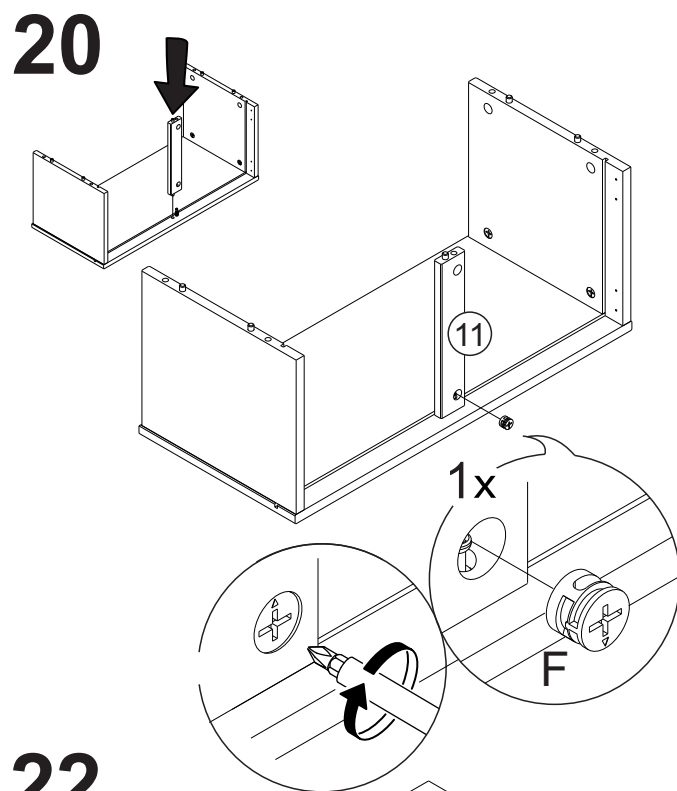
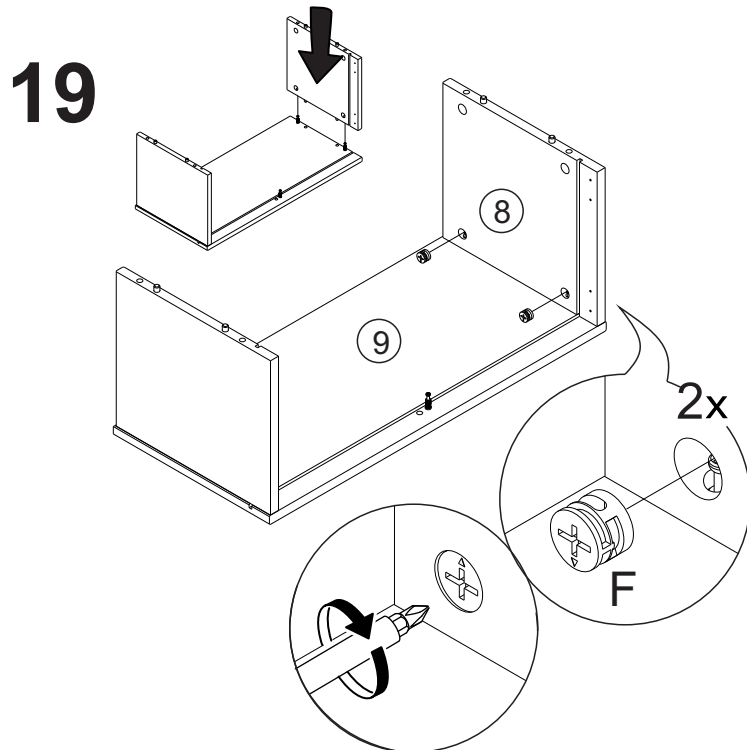
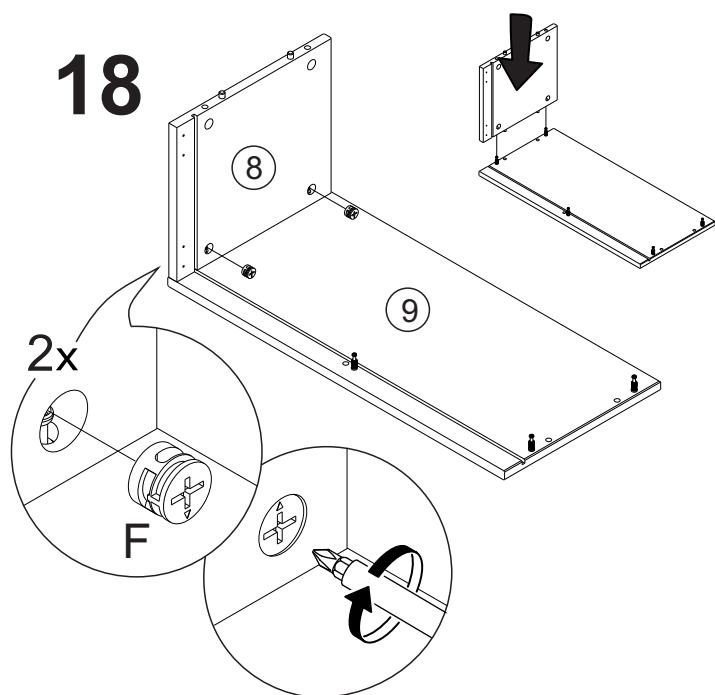

# 24

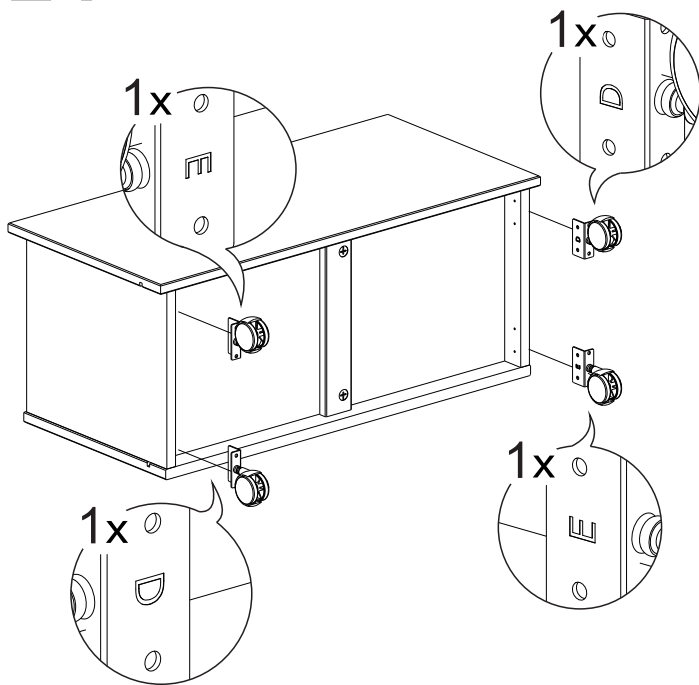

# 25

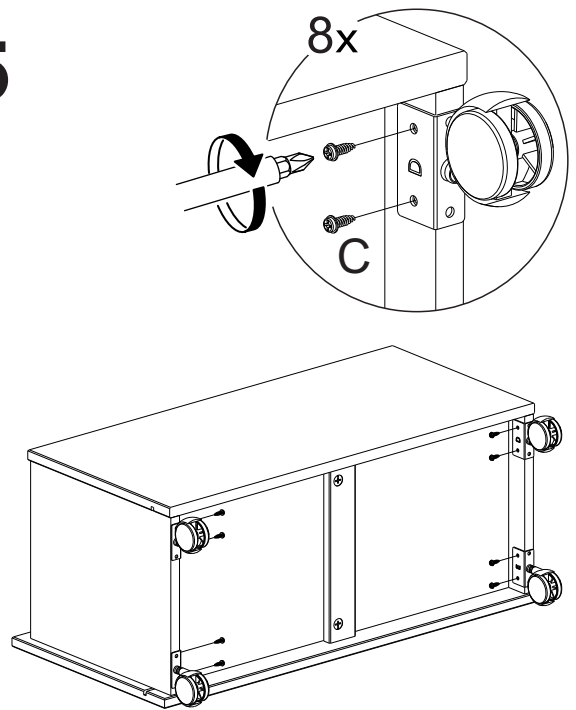

# 26

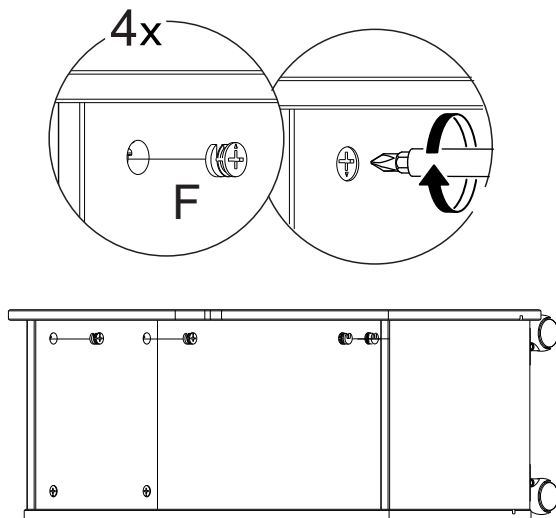

# 28

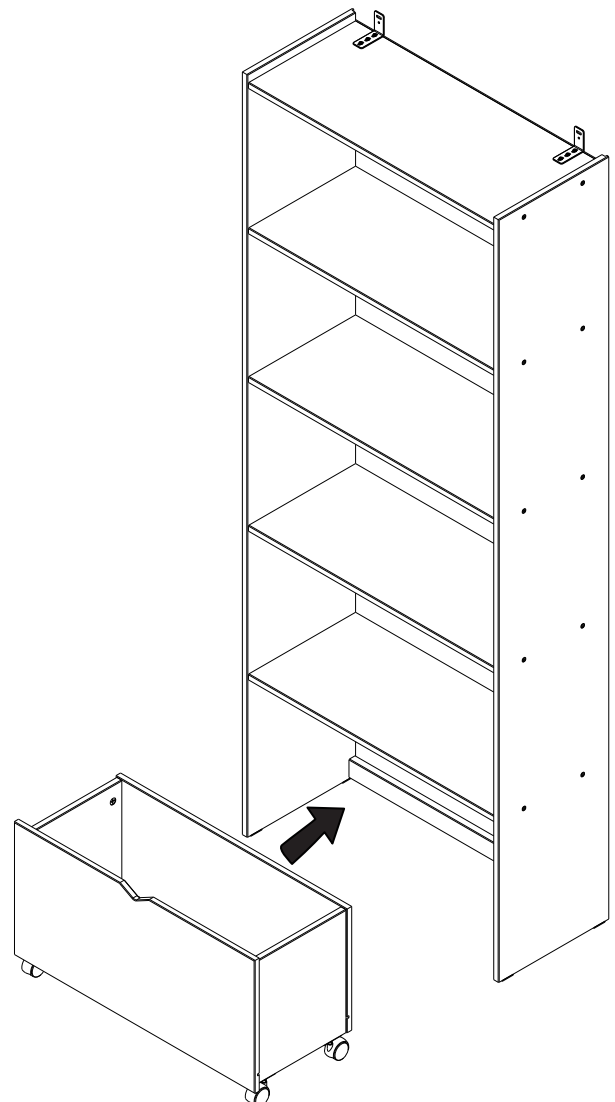

# 27

