

Item	Caixa Box	Qtd Qty	Descrição / Descripción	Medidas (mm) Dimensions (mm) Size (measurements) (mm)	Código das Peças Código de las piezas Parts Code
01	2/3	01	Rodapé Frontal Pie de página Front Footer	1897x120x12	03271388
02	2/3	01	Travessa do Rodapé Carril pie Baseboard crosspiece	415x120x12	03301393
03	2/3	01	Rodapé Traseiro pie de página traseira Rear Footer	1897x120x12	03271389
04	1/3	01	Lateral esquerda Lateral izquierda Left side	2150x445x15	03153340
05=10	1/3	01	Base Base Base	477x445x12	03293247
06	1/3	01	Divisão esquerda División izquierda Left Division	1529x445x12	03061467
07=18	2/3	01	Prateleira Estantería Shelf	465x350x12	03221373
08	2/3	01	Divisão das Gavetas División de los cajones Drawers Division	445x407x12	03061468
09	1/3	02	Travessa Frontal Travessa Frontal Front cross member	465x60x12	03301392
10=05	1/3	01	Base Base Base	477x445x12	03293247
11	1/3	01	Divisão direita División derecha Right Division	1529x445x12	03061466
12	1/3	01	Pilastra da Porta Pilas de la Puerta Door Pilaster	1122x80x12	03250666
13	1/3	01	Tampa da Cômoda Cubierta de la Cômoda Chest of Drawers	943x445x12	03293249
14	1/3	02	Prateleira Maior Estantería Mayor Largest Shelf	943x365x12	03221374
15	1/3	03	Ripa do Maleiro Portaequipajes de ripa Lath of the closet top shelf	414x73x12	03250667
16	2/3	01	Chão do Maleiro Piso del portaequipajes Floor of the closet top shelf	1897x445x12	03293248
17	1/3	01	Lateral direita Lateral derecha Right side	2150x445x15	03153339
18=07	2/3	01	Prateleira Estantería Shelf	465x350x12	03221373
19	2/3	01	Tampo Tapa Top	1897x445x12	03293250
20	3/3	01	Fundo Superior Fondo superior Top bottom	1921x430x3	03111633
21	3/3	04	Fundo Fondo Bottom	1546x478x3	03111632
22	3/3	01	Chapéu Sombrero Hat	1925x55x15	03050427
23	3/3	01	Porta Central Espelho Puerta Central Espejo Central Mirror Door	1556x315x15	03212222
24	3/3	01	Espelho com furo Espejo con orificio Mirror with hole	950x250x3	03039164
25	2/3	02	Porta Central Puerta central Central Door	1556x315x15	03212221
26	3/3	02	Porta Puerta Door	1963x474x15	03212220
27	1/3	04	Frente de gaveta Frente de cajón Front of drawer	473x170x15	03131260
28	1/3 e 3/3	08	Lado de gaveta Lado del cajón Side of drawer	350x110x12	03140607
29	1/3	04	Fundo de gaveta Fondo de cajón Drawer bottom	427x361x3	03120536
30	2/3	04	Ripa de trás Malla detrás Rear lath	440x110x12	03240713



Ind. e Com. de Móveis Henn
Mondai - SC - Brasil

+55 49 3674.3500

@moveishenn
www.henn.com.br

INSTRUÇÕES DE MONTAGEM

INSTRUCCIONES DE MONTAJE
ASSEMBLY INSTRUCTIONS

ROUPEIRO ALBA 05 PORTAS ARMARIO ALBA 05 PUERTAS | ALBA 05 WARDROBE DOORS D198-94 RÚSTICO | D198-101 CAFÉ

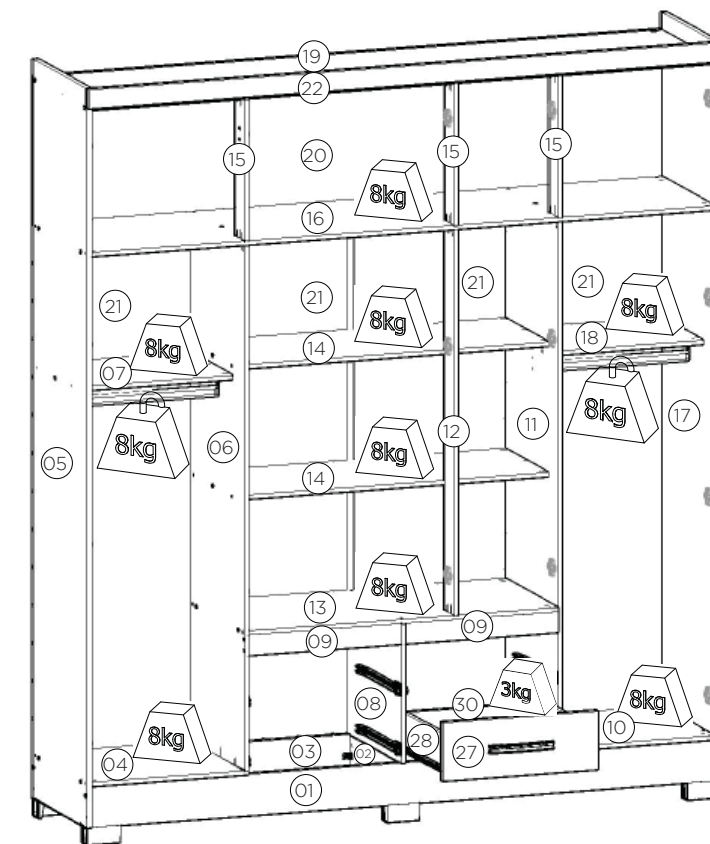
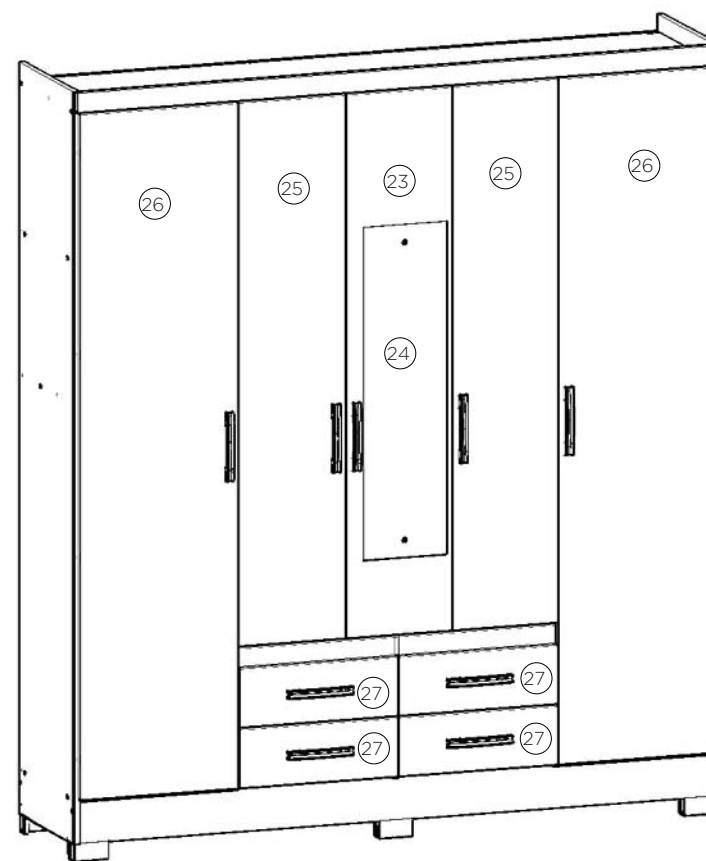

Pesos máximos recomendados com carga distribuída
Peso máximo recomendado con la carga distribuida
Recommended maximum weights with evenly distributed.

Ferragens | Herrajes | Hardware

A 08x Parafuso 4,5x50mm CHT. Tornillo 4,5x50mm CHT. Screw 4,5x50mm CHT.	B 34x Parafuso 3,5x40mm CHT. Tornillo 3,5x40mm CHT. Screw 3,5x40mm CHT.	C 18x Parafuso 3,5x25mm FLA. Tornillo 3,5x25mm FLA. Screw 3,5x25mm FLA.	D 110x Parafuso 3,5x12mm FLA. Tornillo 3,5x12mm FLA. Screw 3,5x12mm FLA.	E 64x Parafuso 3,5x12mm CHT. Tornillo 3,5x12mm CHT. Screw 3,5x12mm CHT.	F 97x Cavilha 5x25mm Cinta 5x25mm Dowel 5x25mm
G 08x Prego 12x12mm Anelado Clavo 12x12mm Anillado Ringed Nails 12x12mm	H 140x Prego 10x10mm Clavo 10x10mm Nail 10x10mm	I 42x Fixador de fundos Fijador de fondos Bottom fixer	J 20x Cantoneira plástica Cantenera plástica Plastic angle brackets	K 08x Porca Cilíndrica Tuerca cilíndrica Cylindrical nut	L 17x Calço metal 5mm Calzado metálico 5mm 5 mm metal shim
M 17x Dobradiça metal 26mm Bisagra de metal 26mm 26 mm metal hinge	N 04x Corrediça metal 350mm Corredera de metal 350mm Sliding metal 350mm	O 01x Perfil "I" 1282mm Perfil "I" 1282mm Profile "I" 1282mm	P 06x Pé "U" 50x40x100mm Pie "U" 50x40x100mm 50x40x100mm "U" Feet	Q 04x Suporte cabideiro Soporte de percha Coat hanger support	R 02x Cabideiro Alum. 457mm Alu 457mm percha Alu coat hanger 457mm
S 09x Puxador Leon 128mm Bronze Tirador Leon 128mm Bronce Leon 128mm Bronze Handle	T 02x Sachê de cola Bolsa de pegamento Glue bag	U 37x Adesivo tapa parafuso 10mm Adhesivo tapón de tornillo 10mm Bolt cover adhesive 10mm	V 01x Suporte metal Soporte metálico Metal support	W 01x HENN Etiqueta resinada Henn Etiqueta resinada Henn Henn resin label	

Requisitos para montagem

Requisitor para la montaje
Assembly Requirements

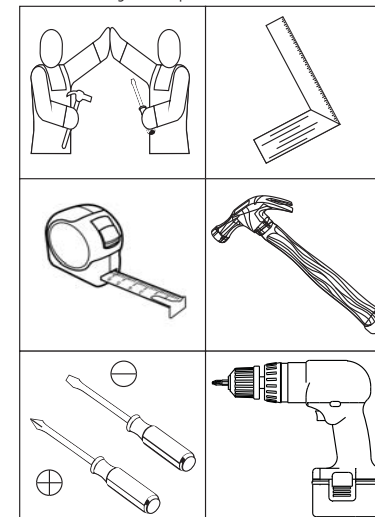

Imagens meramente ilustrativas
Imágenes meramente ilustrativas
Images for illustration only

AVISO

Para limpeza de seu móvel, use uma flanela seca ou umedecida, e não utilize produtos químicos que possam danificar seu produto.

SISTEMA DE MONTAGEM

O sistema de montagem dos produtos, funciona de acordo com a ordem crescente dos números indicados no desenho. Ex: 01, 02, 03, 04... até a conclusão da montagem.

ADVERTENCIA

Para limpieza de su móvil, use una flanela seca o húmeda, y no utilice productos químicos que puedan dañar su producto.

SISTEMA DE MONTAJE

El sistema de montaje de los productos funciona de acuerdo con el orden creciente de los números indicados en el dibujo. Ej.: 01, 02, 03, 04... hasta la conclusión del montaje.

NOTICE

To clean your furniture, use a dry or wet cloth, and do not use chemicals that may damage your product.

ASSEMBLY SYSTEM

The products' assembly system works according to the increasing order of the indicated numbers. For example: 01, 02, 03, 04 ... to the end of the assembly.

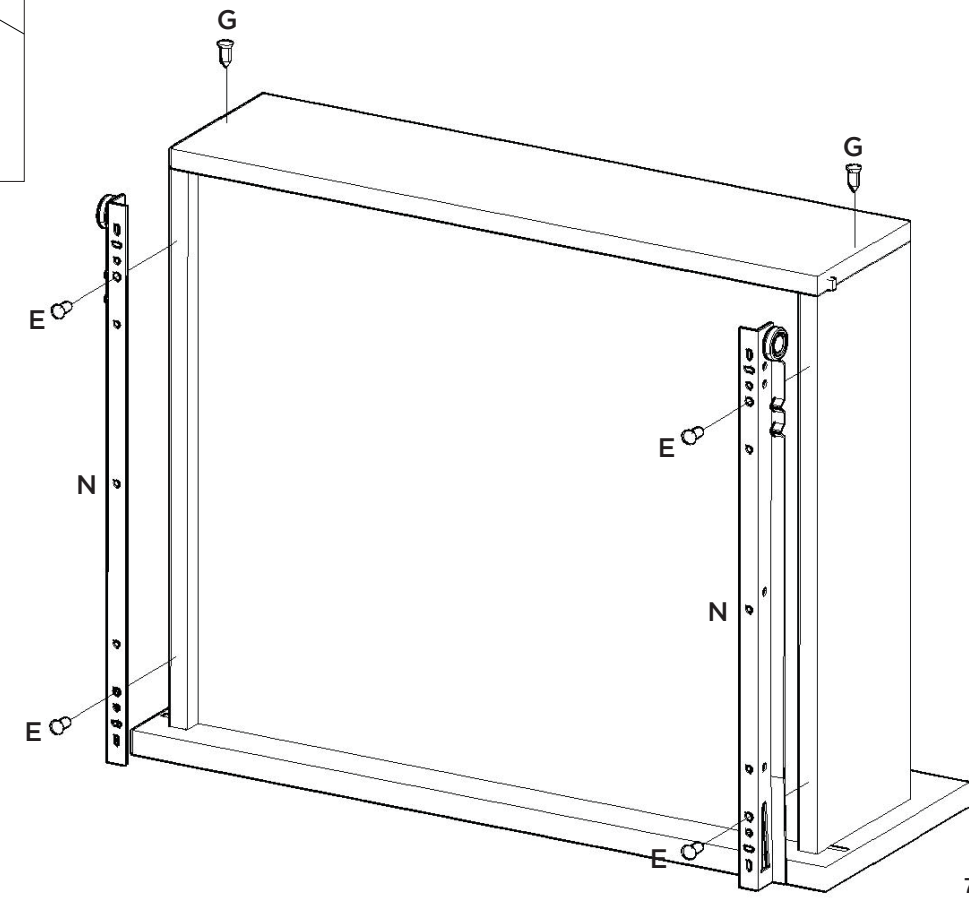
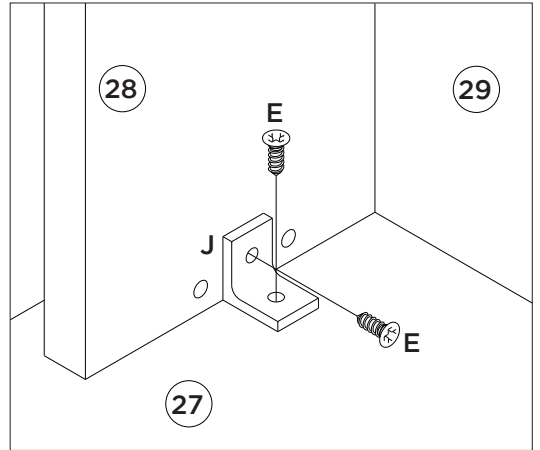
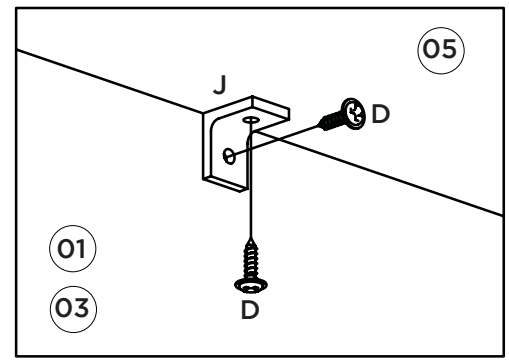
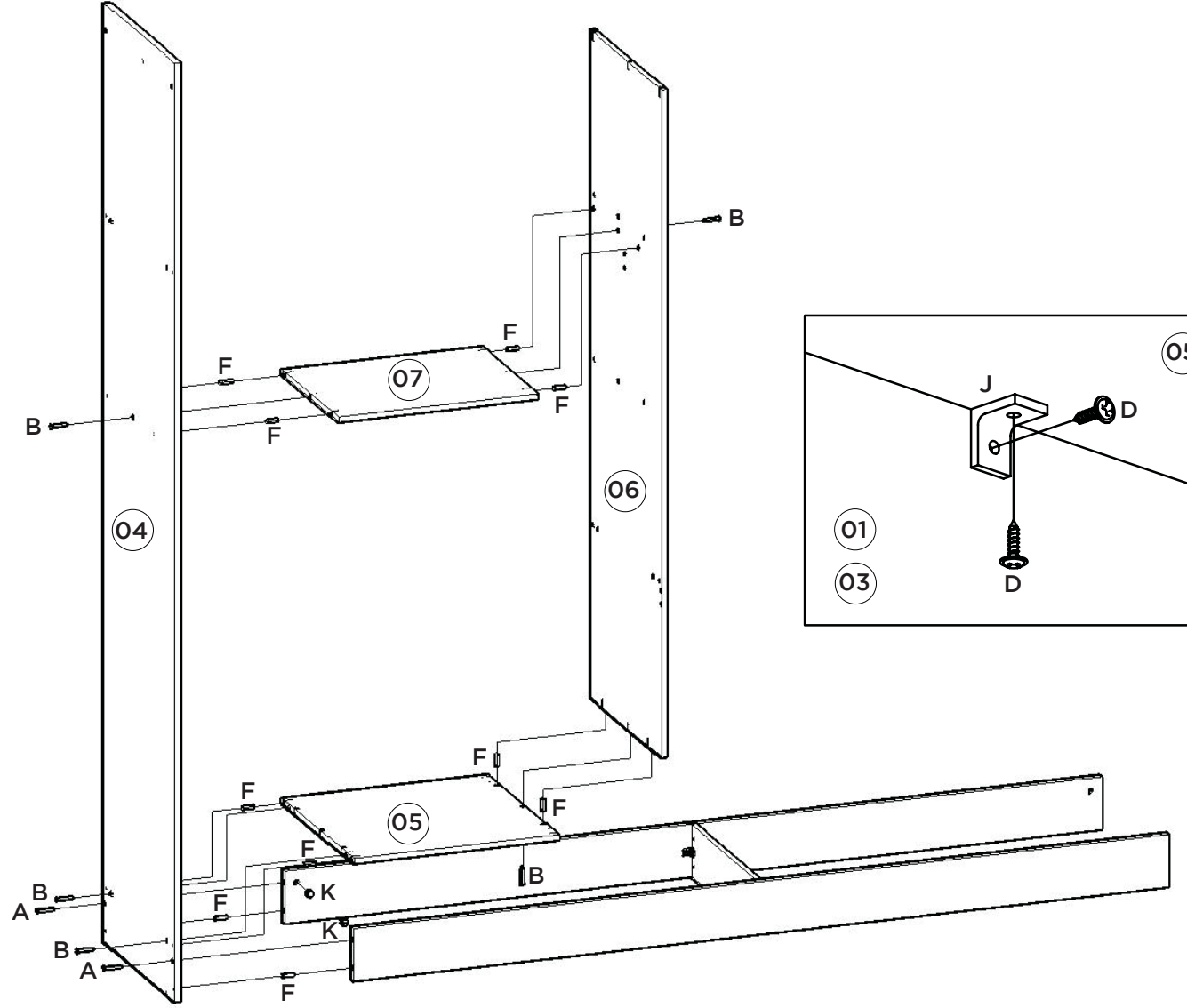
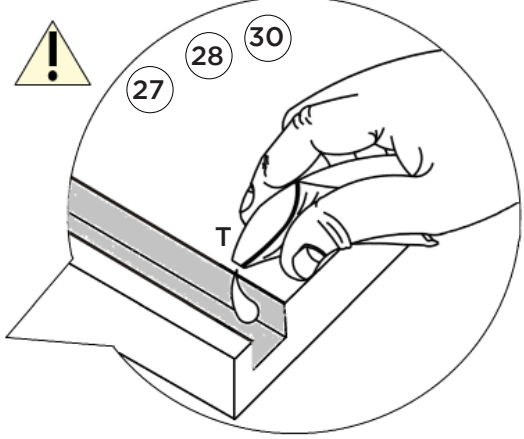
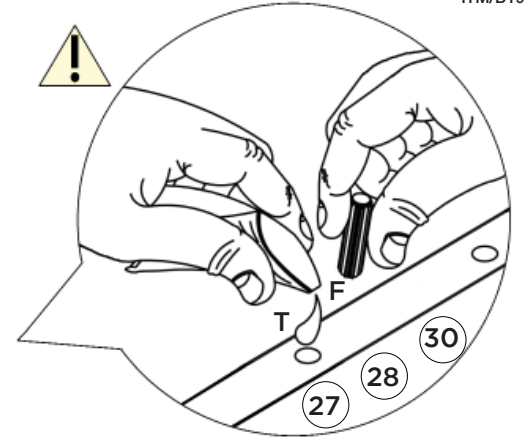
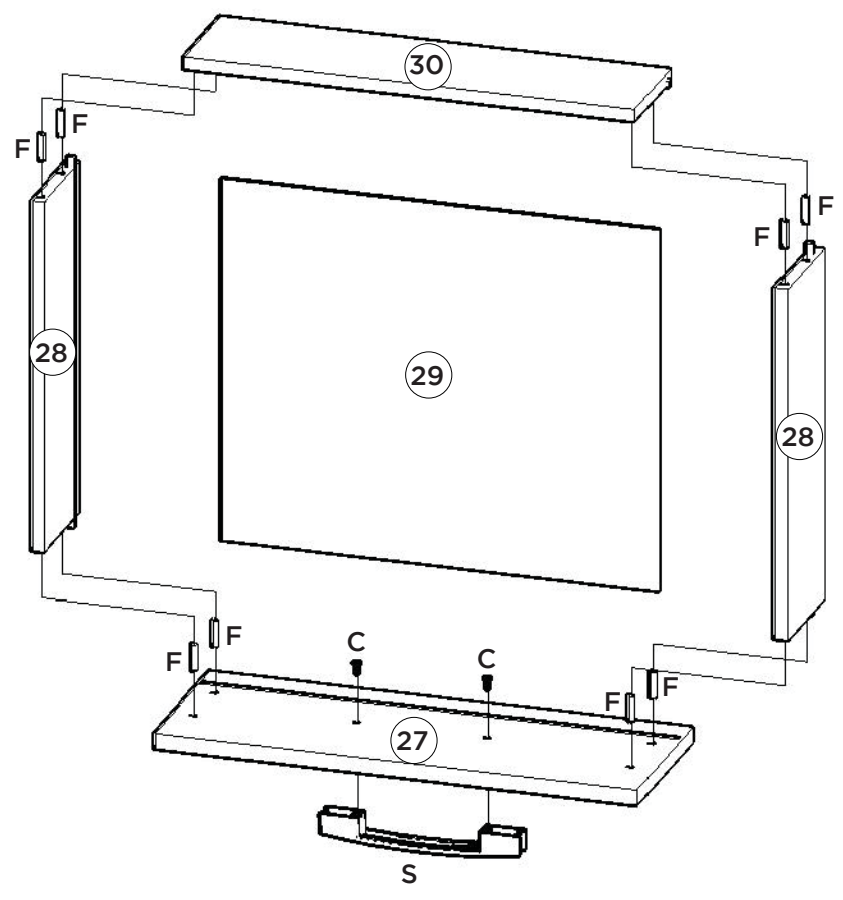
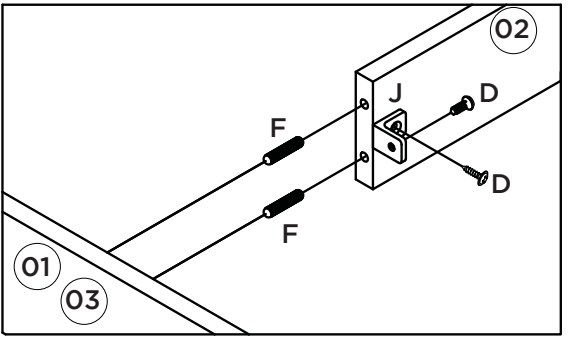
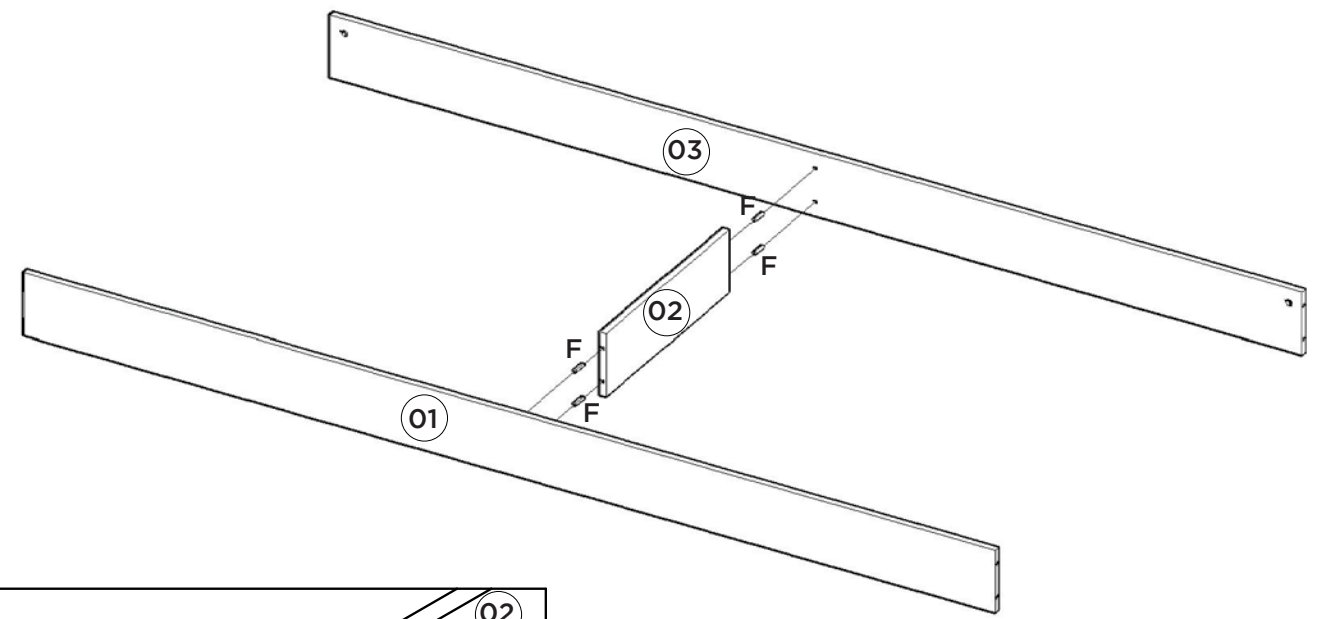

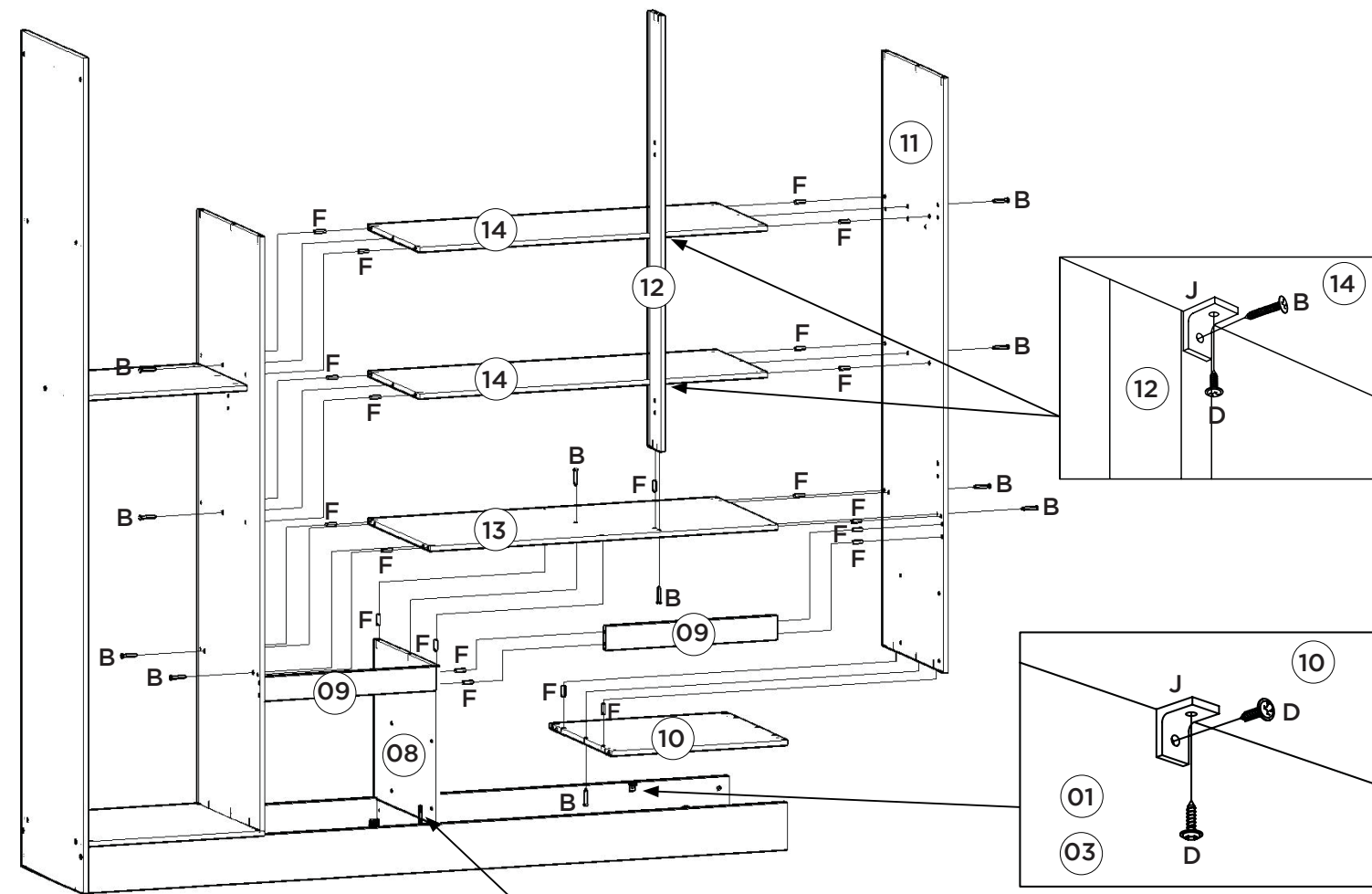
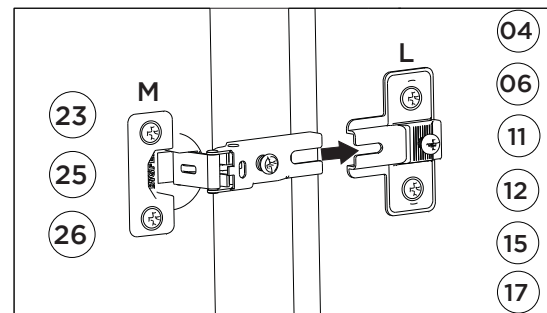
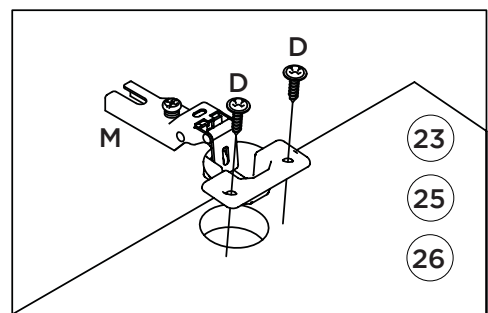
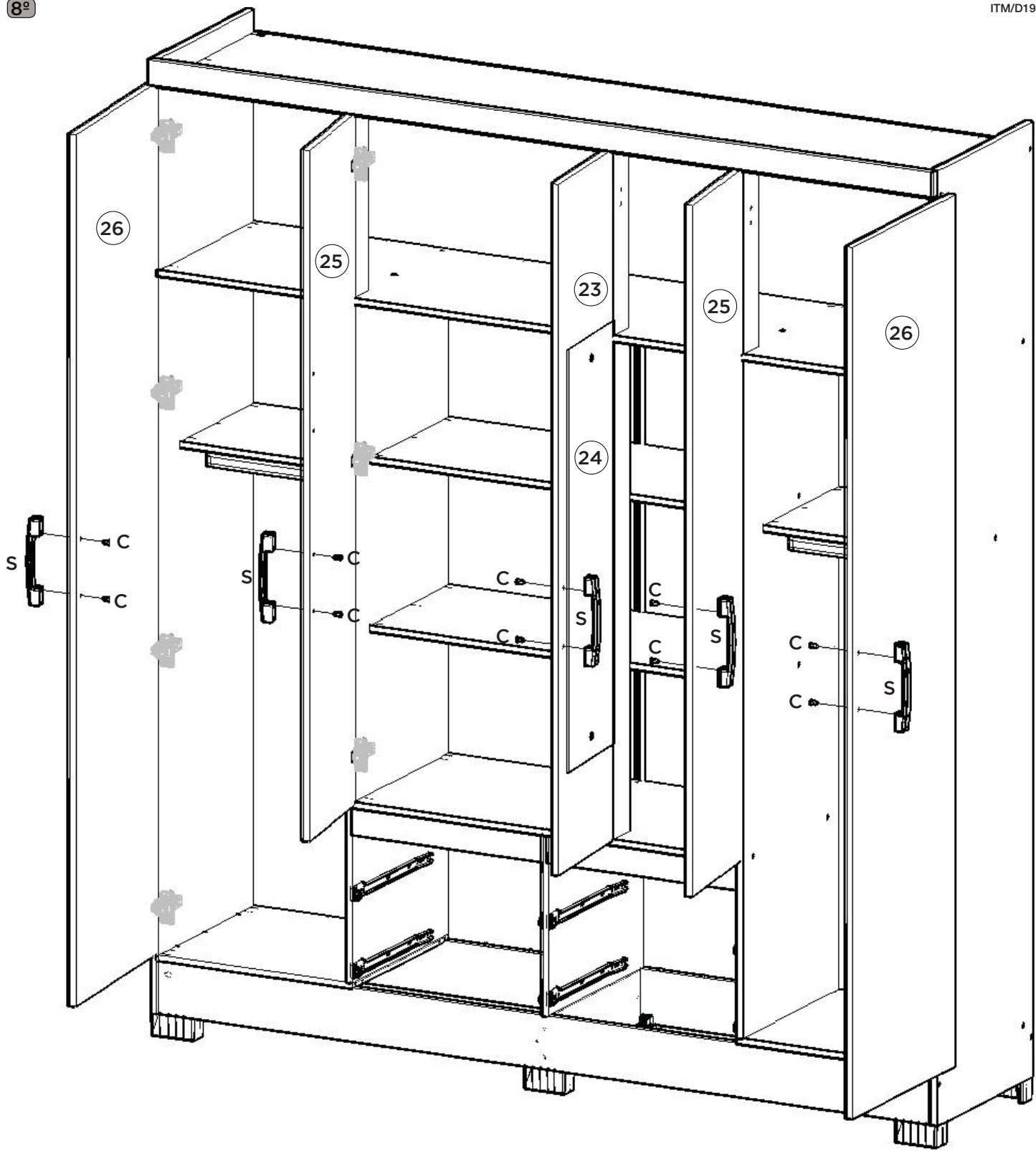

Colocar o suporte de metal (V) bem na frente, conforme desenho

Colocar el soporte de metal (V) en el frente, según el diseño

Attach the metal bracket (V) well in front, according to drawing

