



# RACK RETRÔ 85

## ATENÇÃO/ ATTENTION / ATENCION

VÍDEO DE MONTAGEM DISPONÍVEL NO SITE / ASSEMBLY VIDEO AVAILABLE ON THE SITE  
VÍDEO DE MONTAJE DISPONIBLE EN EL SITIO

[www.olivar.com.br](http://www.olivar.com.br)

DIMENSÕES DO PRODUTO / PRODUCT DIMENSIONS / DIMENSIONS PRODUCT - WxDxH / LxDxA - 1620 X 388 X 547 MM

### ATENÇÃO/ ATENCION/ ATTENTION

ESTE PRODUTO NÃO PODE SER ARRASTADO.  
THIS PRODUCT MUSTNOT BE DRAGGED.  
ESTE PRODUCTO NO SE PUEDE ARRASTRAR

PEÇAS NUMERADAS/ NUMBERED PARTS/  
PIEZAS NUMERADAS

EX: 1915X-X 05(peça/ piece/ pieza number)



Vídeo de Montagem  
Assembly video  
Video de Montaje

TV 48"

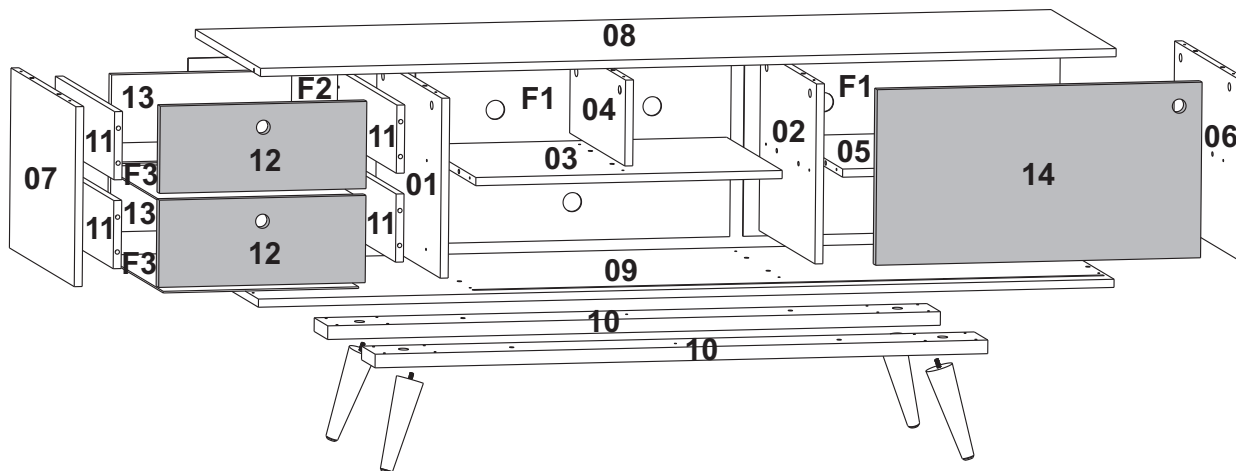
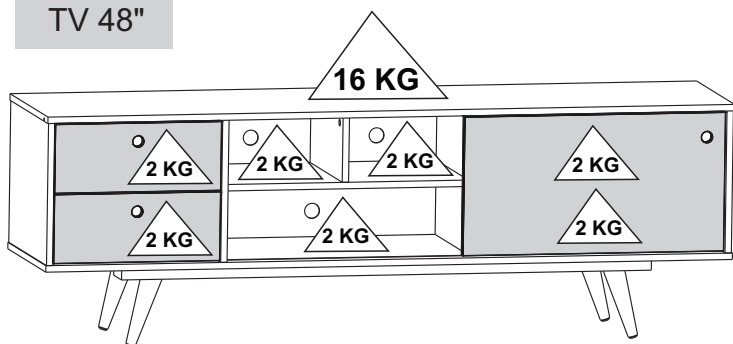

#### CUIDADOS ESPECIAIS

LIMPEZA- Pano limpo umedecido em água e sabão neutro.  
BRILHO- Fianela seca.

#### SPECIAL CARE

CLEANING-Clean cloth moistened with water and mild soap.  
SHINE- Dry cloth.

#### CUIDADOS ESPECIALES:

LIMPIEZA- Paño limpio humedecido con agua y un jabón suave.  
BRIGHT- Franela seco.

#### ATENÇÃO / ATTENTION / ATENCION

Nunca utilizar óleos, lustra móveis; produtos abrasivos, saponáceos, esponja de aço e outros.

Never use oils, polish furniture , abrasive products, soaps, steel sponge and others.

Nunca use aceites, pulimentos; abrasivos, jabones, esponja de acero y otros.

MONTAR O PRODUTO SOBRE A EMBALAGEM,  
EVITANDO DANOS NA PINTURA.  
ACONSELHAMOS QUE A MONTAGEM DO PRODUTO  
SEJA POR UM PROFISSIONAL.

SETUP THE PRODUCT ON TOP OF THE PACKAGING, AVOIDING  
DAMAGE TO THE PAINT.  
WE RECOMMEND THAT THE INSTALLATION IS DONE BY  
A PROFESSIONAL.

MONTAR EL PRODUCTO EN EL PAQUETE,  
EVITAR LESIONES EN PINTURA.  
AVISAMOS QUE EL MONTAJE DEL PRODUCTO  
SEA UN PROFESIONAL.

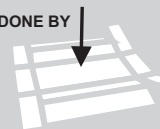

Ferramentas necessárias / Necessary tools / Herramientas Necesarias  
(não fornecidas) (not provided) (No proporcionadas)



**MEDIDA UTILIZADA EM MM /  
UNIT MEASURE USED IS MILLIMETERS (MM)**

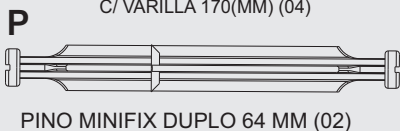
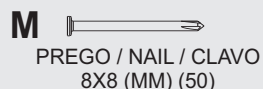
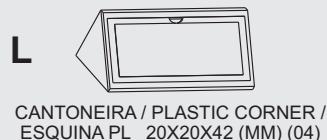
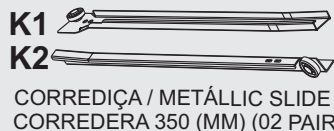
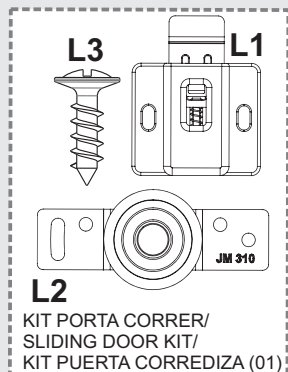
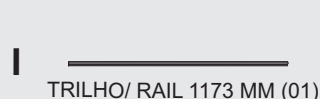
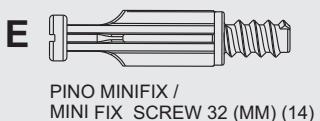
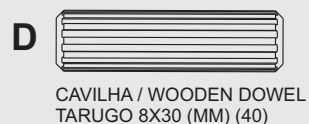
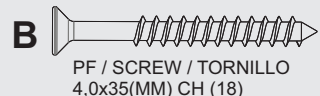

ITEM	DESCRIÇÃO DA PEÇAS / DESCRIPTION OF PARTS / UNIT MEASURE USED IS MILLIMETERS (MM)				CORES / COLORS / COLORES						
	CÓDIGO CODE	Nº	NOME/NAME/NOMBRE	MEDIDAS / MEASURES (MM)	TIPO TYPE	QUANT AMOUNT CANTIDAD	BCO WHITE BLANCO	PTO BLACK NEGR O	TURQ	AMARELO YELLOW AMARILLO	RUSTIK
10814	01	DIVISOR ESQUERDO/ LEFT DIVIDER		330X383X15	MDP	01	01/05	01/07			01/24
10815	02	DIVISOR DIREITO/ RIGHT DIVIDER		330X330X15	MDP	01	02/05	02/07			02/24
10817	03	PRATELEIRA/ SHELF/ESTANTE		580X328X15	MDP	01	03/05	03/07			03/24
10819	04	DIVISOR SUPERIOR./ TOP DIVIDER		326X157X15	MDP	01	04/05	04/07			04/24
10818	05	PRATELEIRA DIREITA/ SHELF RIGHT/ ESTANTE DERECHA		580X328X15	MDP	01	05/05	05/07			05/24
10816	06	LATERAL DIREITA/ RIGHT SIDE/ LADO DERECHO		330X383X15	MDP	01	06/05	06/07			06/24
10813	07	LATERAL ESQUERDA/ LEFT SIDE/ LADO IZQUIERDO		330X383X15	MDP	01	07/05	07/07			07/24
10820	08	TAMPO/ TOP		1620X385X15	MDP	01	08/05	08/07			08/24
10812	09	BASE		1620X385X15	MDP	01	09/05	09/07			09/24
10825	10	REFOR. PÉ/ FOOT REINFORCEMENT/ REFUERZO PIE		1160X80X25	MDF	02	10/05	10/07			10/24
10821	11	LAT.GAV./ LEFT SIDE/ LAD. CAJON		350X125X15	MDP	04	11/05	11/07			11/24
10823	12	FRENTE GAVETA/ DRAWER FRONT / FRENTE DEL CAJON		391X160X15	MDF	02	12/05	12/07	12/21	12/23	
10822	13	CONT. FRENT. GAV./AGAINST DRAWER FRONT/ CONTRA EL FRENTE DEL CAJON		341X125X15	MDP	02	13/05	03/07			13/24
10824	14	PORTA CORRER/ SLIDING DOOR/ PUERTA CORREDIZA		615X322X15	MDF	01	14/05	01/07	14/21	14/23	
10826	F1	FUNDO TRÁS / BACK / TRASEIRO		596X350X3	TRI	02	F1/05	F1/07			F1/24
10827	F2	FUNDO TRÁS / BACK / TRASEIRO		417X350X3	TRI	01	F2/05	F2/07			F2/24
10828	F3	FUNDO GAV. / DRAWER BACKGROUND/ FONDO CAJON		370X358X3	TRI	02	F3/05	F3/07			F3/24
438	A	PF. / Screw / Tornillo 4,0x40(MM) CH				18					
437	B	PF. / Screw / Tornillo 4,0x35(MM) CH				18					
986	C	PF. / Screw / Tornillo 3,5x14(MM) CRR				40					
137	D	Cavilha / Wooden Dowel / Tarugo 8x30(MM)				40					
532	E	Pino Minifix / Minifix Screw 32(MM)				14					
508	F	Tambor Minifix / Minifix Round Nut 15(MM)				18					
509	G	Tampa Minifix / Minifix Cover Cap 15(MM)				06	BCO	PTO			CAFÉ
3441	H	Amortecedor/ Pu Bumber/ Parachoques				04					
11212	I	Trilho PL. / Rail Plastic PL 1173(MM)				01	BCO	PTO			CAFÉ
9002	J	Kit porta de correr/ Sliding Door Kit				01					
139	K	Corred./Metallic Slid 350(MM) (02 Pair)				02					
15175	L	Cantoneira PL/Plast. corner with lid / Esquina PL. 20X20X42(MM)				04	CINZA	CINZA			CINZA
248	M	Prego / Nail / Clavo 8x8(MM)				58					
911	N	Garra/ Jont Metal Plate/ Embragues				08					
10203							MEL				
10365	O	Pé Palito Mad. c/ haste/ Wooden Leg 170 (MM) wiht stem/ Pies Pallilo Madera c/varilla				04					CAST
15207								MOGNO			
4035	P	Pino Duplo Minifix/ Minifix Double Pin/ Pin Double Minifix 64 MM				02					
15203	Q	Porca Garra de aço/ Steel Claw Nut/ Tuerc a de Garra de Acero				04					
		Certif. de Garant./ Warranty Certif.				01					

**FIXAR PINO DE MINIFIX, TAMBOR E TAMP A / FIXING THE MINIFIX PIN, DRUM AND MINIFIX COVER  
COLOQUE EL PINO E TAMBOR MINIFIX Y LA TAMP A**

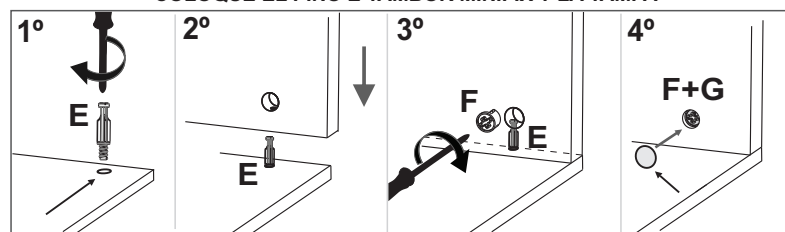

**1** Obs: As peças pintadas nos passos são apenas ilustrativas.  
The parts painted in the steps are illustrative only.  
Las partes pintadas en los pasos son solo ilustrativas.

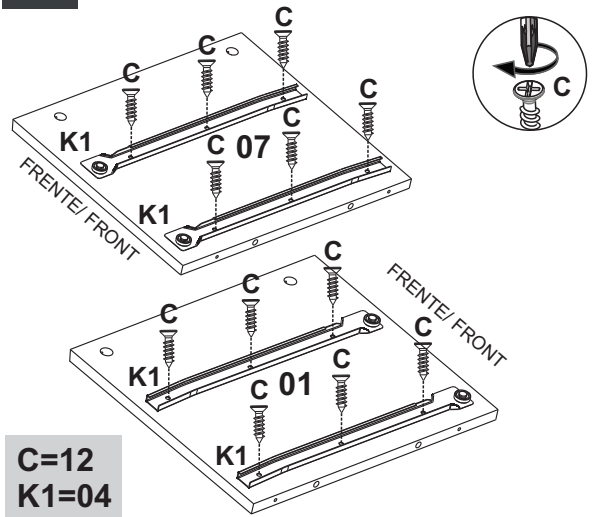

**C=12**  
**K1=04**



**2** **ATENÇÃO/ ATTENTION / ATENCION**

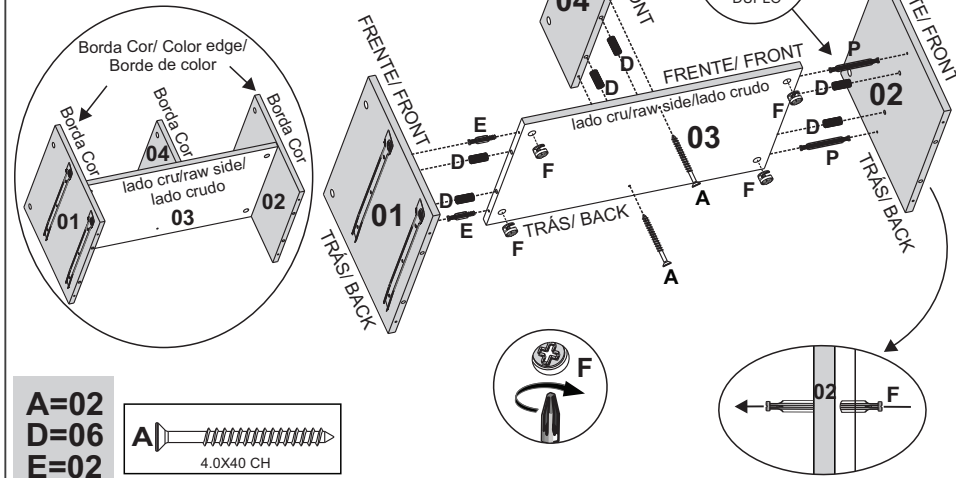

**A=02**  
**D=06**  
**E=02**  
**F=04**  
**P=02**

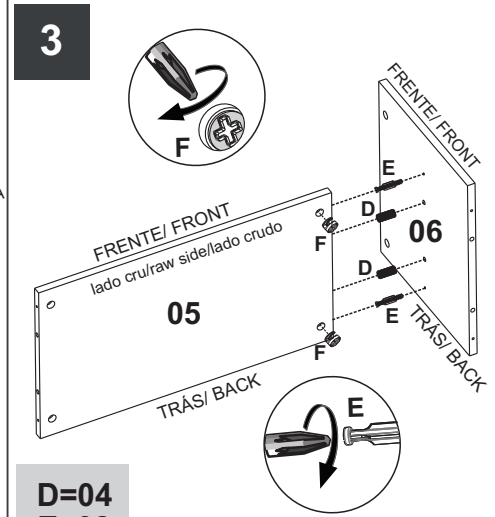
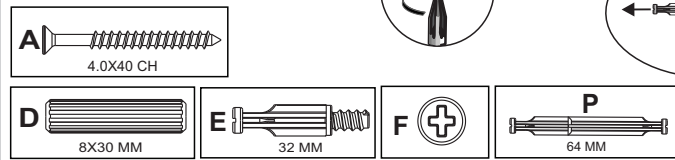

**D=04**  
**E=02**  
**F=02**

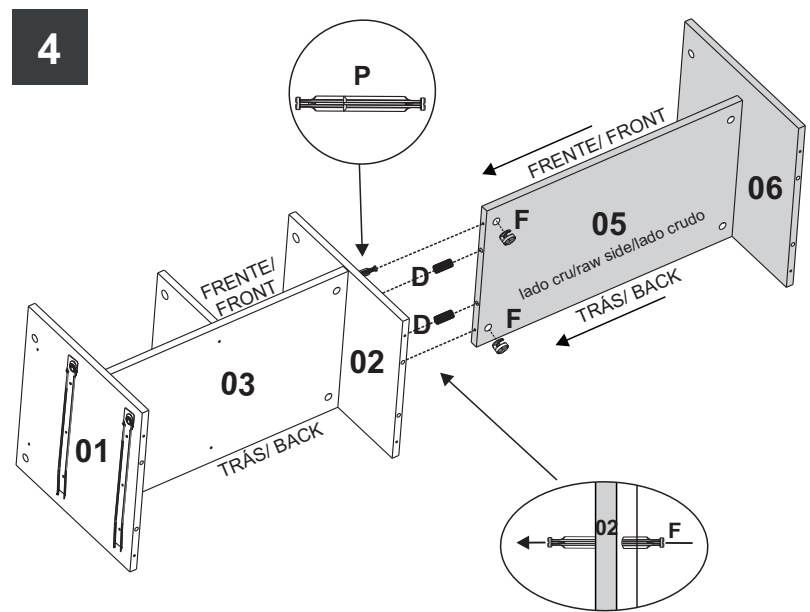

**D=04**  
**F=02**

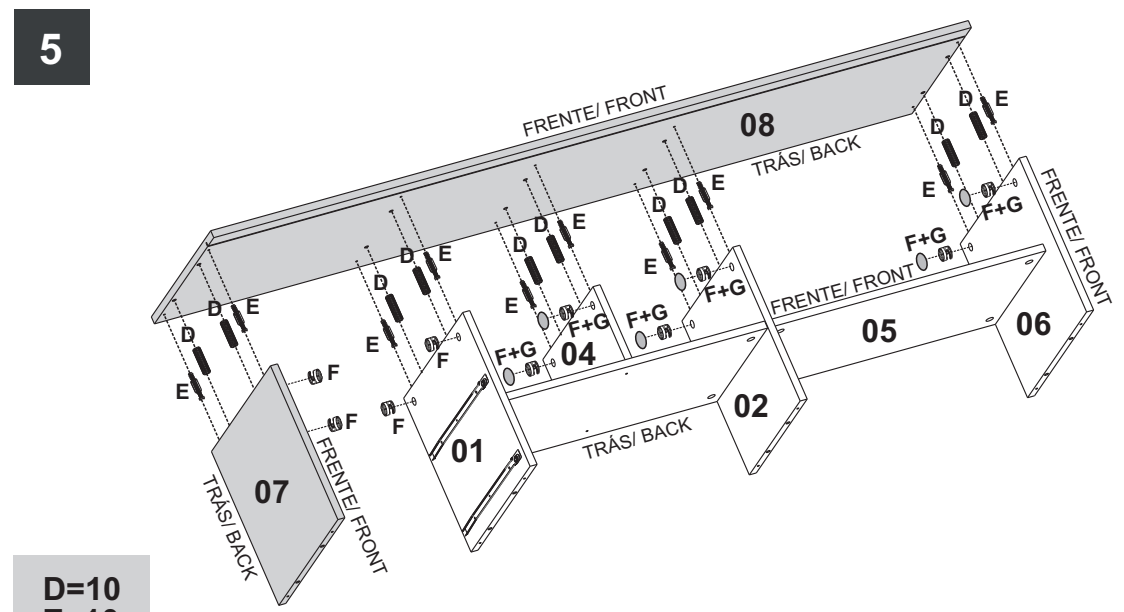

**D=10**  
**E=10**  
**F=10**  
**G=06**

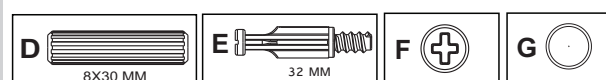



9

ATENÇÃO/ ATTENTION / ATENCION

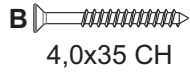

borda cor p/ trás/  
colorfur edge back  
borde color atras

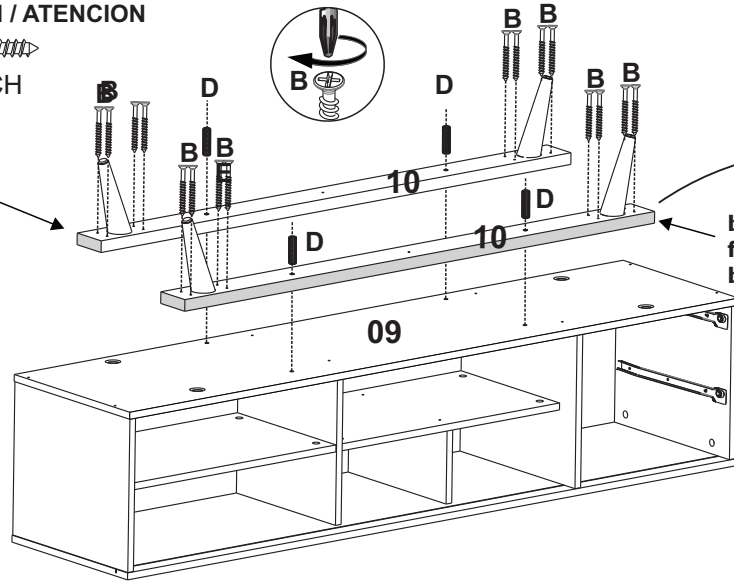

borda cor p frente/  
fur edge front/  
borde color frontal

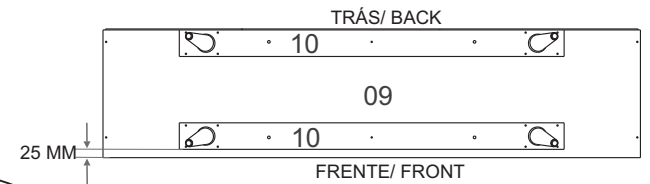

POSICÃO DOS PÉS/  
LEGS POSITION  
POSICION DE PIES

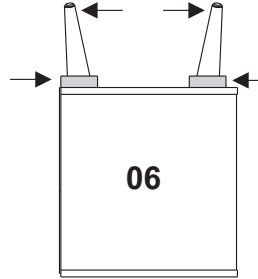

B=18  
D=04

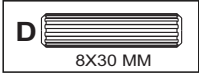
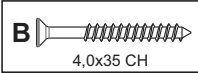

10

MONTAGEM GAVETA / ASSEMBLY OF THE DRAWER / MONTAJE LE CÁJON

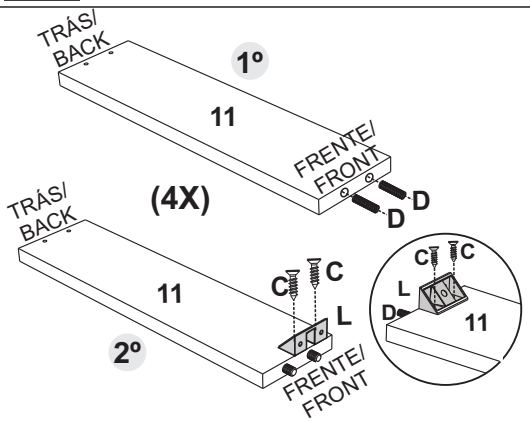

Parafusar as cantoneiras entre as cavilhas.  
Screw the plastic corner between the wooden dowel.  
Atornillar las esquinas entre las tarugos.

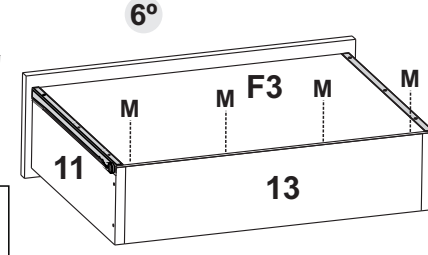
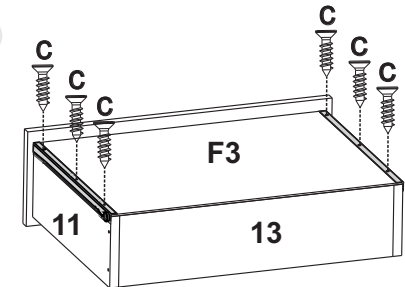
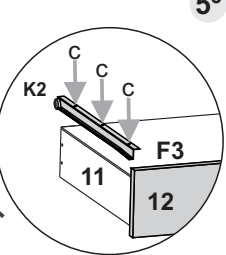
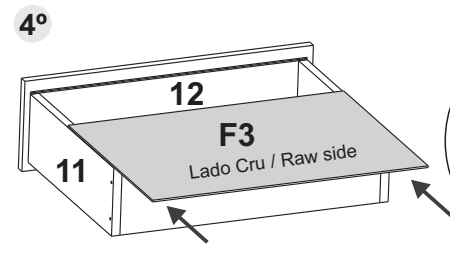
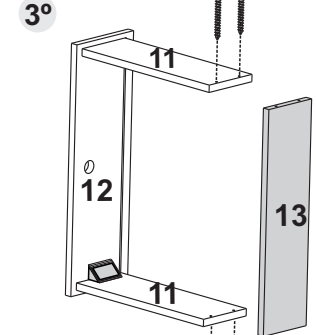
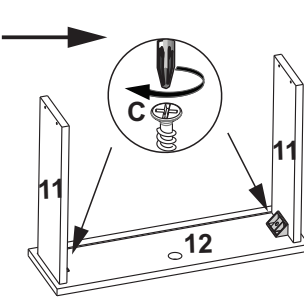
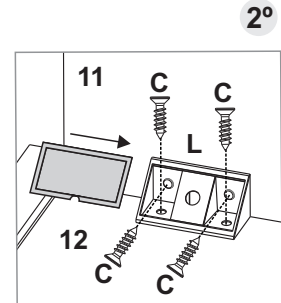
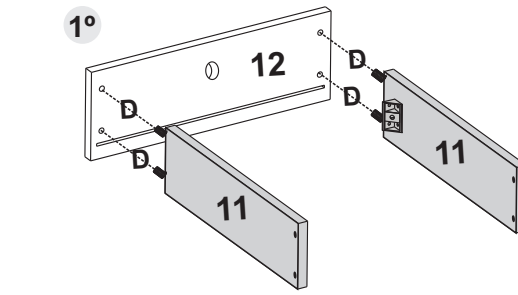

A=08  
C=28  
D=08  
K2=04  
L=04  
M=08

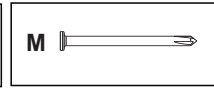
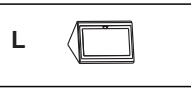
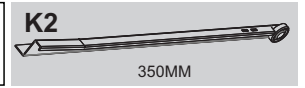
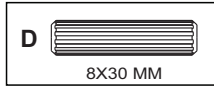
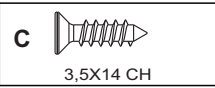
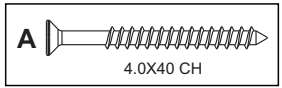



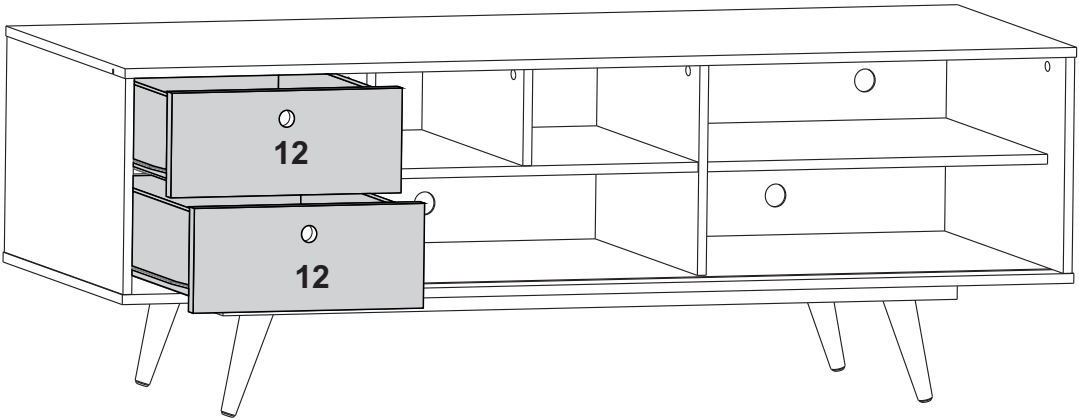

ATENÇÃO/ ATTENTION / ATENCION

REGULAR O PARAFUSO/  
SCREW ADJUSTMENT/  
AJUSTE EL TORNILLO

ABAIXAR E ENCAIXAR/  
LOWER THE DEVICE/  
FOR IT TO FIT IN  
ABAJAR E AJUSTAR

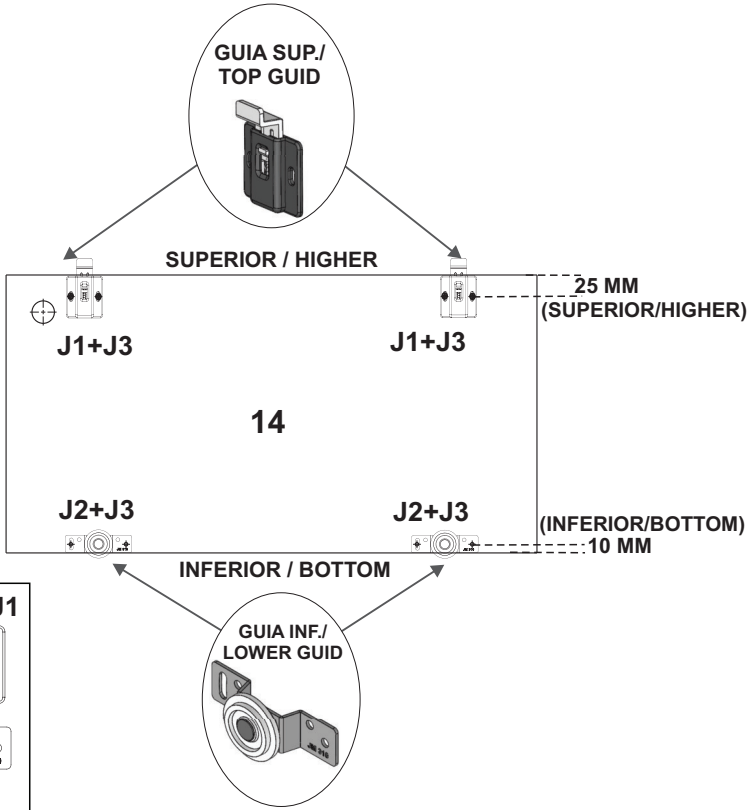
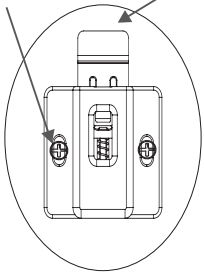

- H=04
- J1=02
- J2=02
- J3=08

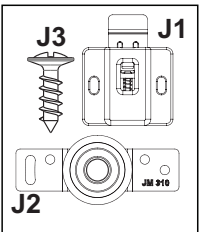

! COLOCAR "H" NA PEÇA 14  
PUT "H" IN PART 14  
PONER "H" LA PIEZA 14

